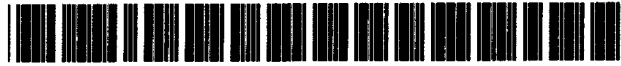

Exhibit 29



US005789878A

United States Patent [19]

Kroeker et al.

[11] Patent Number: **5,789,878**

[45] Date of Patent: **Aug. 4, 1998**

[54] **DUAL PLANE ROBOT**

[75] Inventors: **Tony Kroeker**, Georgetown; **Ben Mooring**, Austin, both of Tex.

[73] Assignee: **Applied Materials, Inc.**, Santa Clara, Calif.

[21] Appl. No.: **679,868**

[22] Filed: **Jul. 15, 1996**

[51] Int. Cl.⁶ **B25J 18/00**; B65G 49/07

[52] U.S. Cl. **318/45**; 901/14; 901/23; 464/29; 74/490.03; 318/625

[58] **Field of Search** 318/15, 45, 568.11, 318/625; 901/14, 15, 23, 24, 25; 464/29; 74/490.01, 490.03, 490.05; 414/222, 225, 744.1, 744.4, 744.5, 744.6, 749, 750, 751, 917

[56] **References Cited**

U.S. PATENT DOCUMENTS

4,712,971 12/1987 Flyer .

4,897,015	1/1990	Abbe et al. .	
4,990,047	2/1991	Wagner et al.	414/217
5,102,280	4/1992	Poduje et al. .	
5,227,708	7/1993	Lowrance	318/640
5,324,155	6/1994	Goodwin et al. .	
5,522,275	6/1996	Mauletti .	

Primary Examiner—Bentsu Ro
Attorney, Agent, or Firm—Patterson & Streets, L.L.P.

[57] **ABSTRACT**

The present invention provides a robot assembly for transferring objects, namely substrates, through a process system. A robot linkage is provided to a multi-plane, multi-arm robot assembly driven by two motors. In one embodiment, a linkage is provided which is driven by two magnetic retaining rings. In another embodiment, a linkage is provided which is driven by three magnetic retaining rings, two of which are coupled to the same motor. Both embodiments enable a substrate shuttle operation to be performed wherein a pair of substrates can be shuttled into and out of a selected chamber without having the robot assembly rotate in the transfer and by actuation of only two motors.

45 Claims, 9 Drawing Sheets

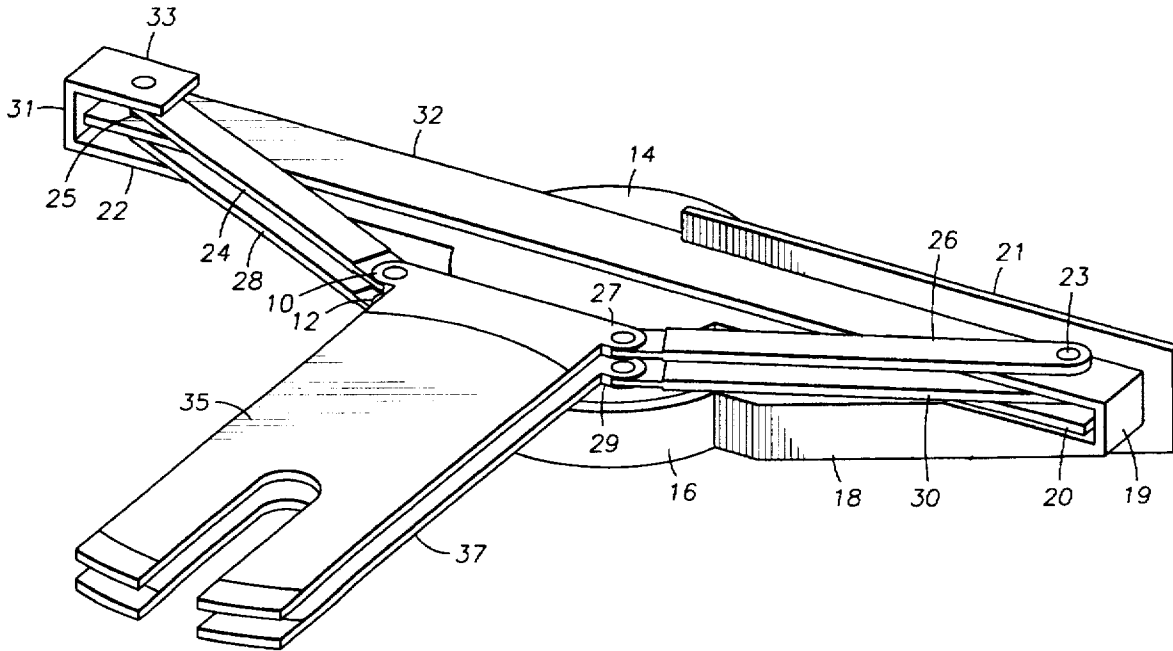

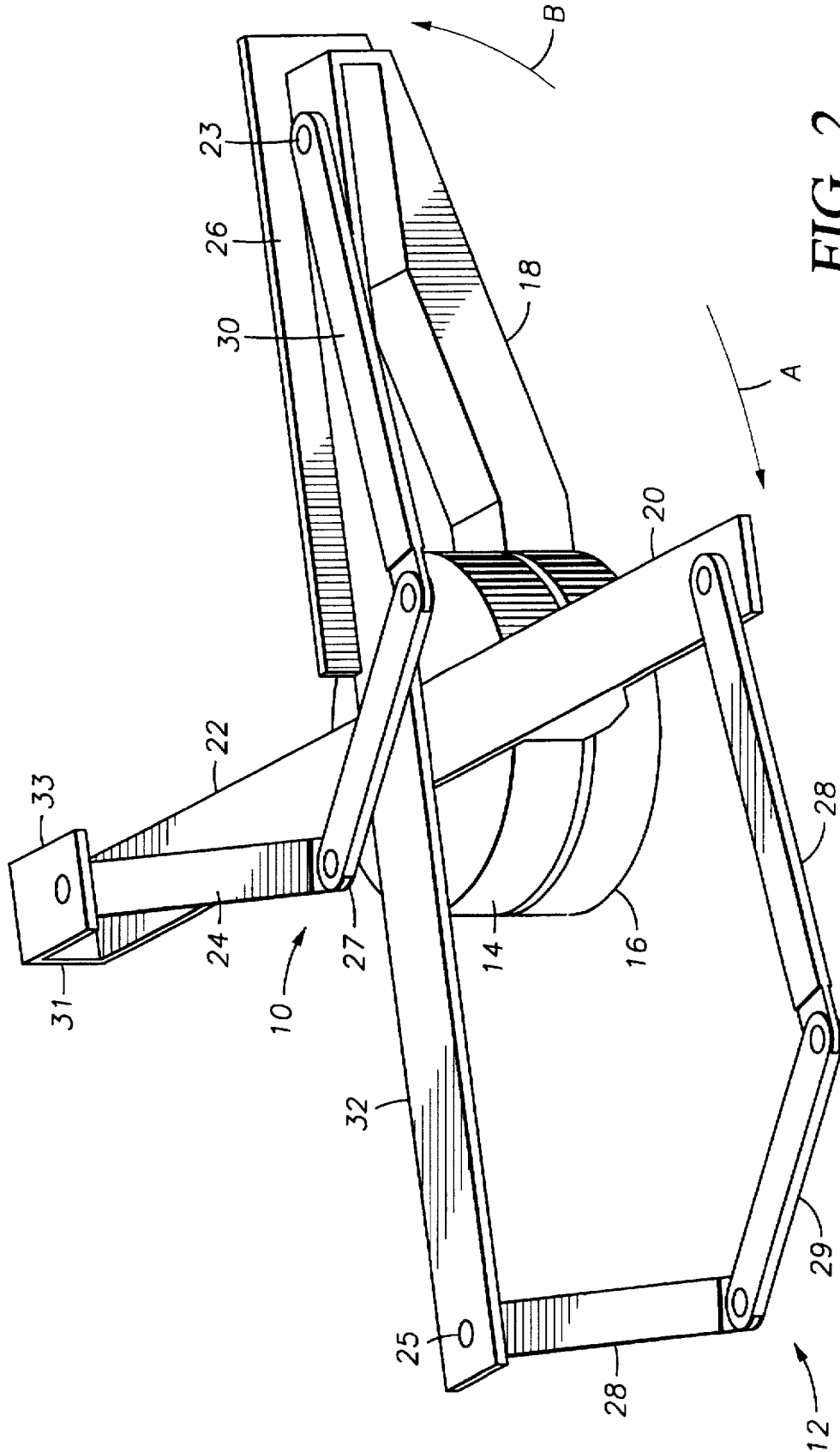

FIG. 2

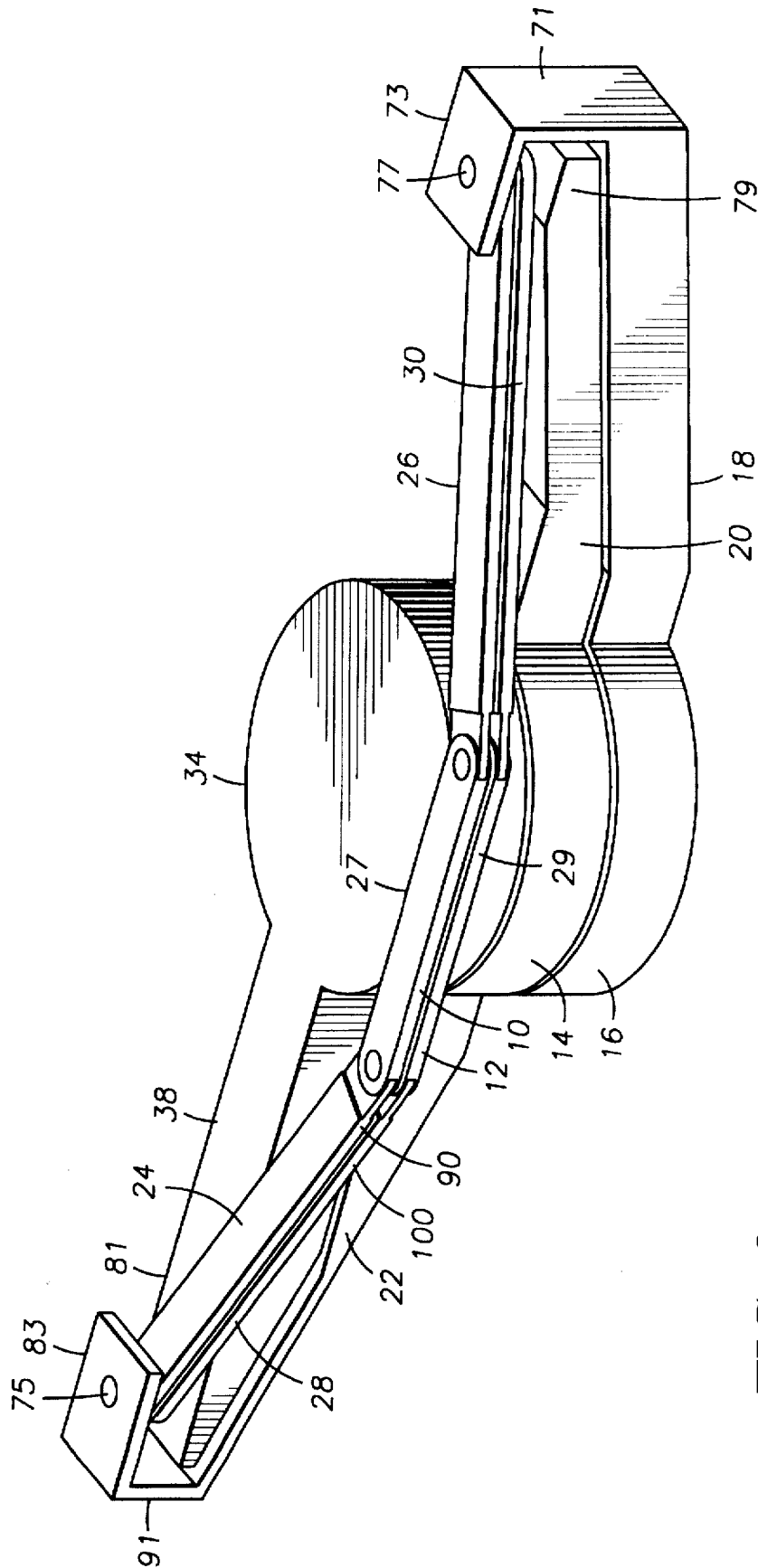

FIG. 3

Explore Litigation Insights

Docket Alarm provides insights to develop a more informed litigation strategy and the peace of mind of knowing you're on top of things.

Real-Time Litigation Alerts



Keep your litigation team up-to-date with **real-time alerts** and advanced team management tools built for the enterprise, all while greatly reducing PACER spend.

Our comprehensive service means we can handle Federal, State, and Administrative courts across the country.

Advanced Docket Research



With over 230 million records, Docket Alarm's cloud-native docket research platform finds what other services can't. Coverage includes Federal, State, plus PTAB, TTAB, ITC and NLRB decisions, all in one place.

Identify arguments that have been successful in the past with full text, pinpoint searching. Link to case law cited within any court document via Fastcase.

Analytics At Your Fingertips



Learn what happened the last time a particular judge, opposing counsel or company faced cases similar to yours.

Advanced out-of-the-box PTAB and TTAB analytics are always at your fingertips.

API

Docket Alarm offers a powerful API (application programming interface) to developers that want to integrate case filings into their apps.

LAW FIRMS

Build custom dashboards for your attorneys and clients with live data direct from the court.

Automate many repetitive legal tasks like conflict checks, document management, and marketing.

FINANCIAL INSTITUTIONS

Litigation and bankruptcy checks for companies and debtors.

E-DISCOVERY AND LEGAL VENDORS

Sync your system to PACER to automate legal marketing.