

[54] **PORTABLE ELECTRONIC CAMERA**

[76] Inventor: **Malcolm G. Campbell**, P.O. Box
 8760, Ponsonby, Auckland, New
 Zealand

[21] Appl. No.: **546,194**

[22] Filed: **Oct. 27, 1983**

[30] **Foreign Application Priority Data**

Nov. 23, 1982 [NZ] New Zealand 202578
 Jan. 13, 1983 [NZ] New Zealand 203022

[51] Int. Cl.³ **H04N 7/18**

[52] U.S. Cl. **358/108; 358/213;**
 358/209; 358/229

[58] **Field of Search** 358/88, 93, 94, 103,
 358/108, 109, 213, 209, 229, 91, 92; 179/107 S

[56] **References Cited**

U.S. PATENT DOCUMENTS

2,955,156	10/1960	Heilig	358/88
3,293,358	12/1966	Ratliff, Jr.	358/88
3,376,381	4/1968	Ratliff, Jr.	358/88
3,504,122	3/1970	Ratliff, Jr.	358/88
3,614,314	10/1971	Rossier	358/103
3,670,097	6/1972	Jones	358/88
3,784,738	1/1974	Natter	358/88
3,993,407	11/1976	Moricca et al.	358/94
4,214,267	7/1980	Roese et al.	358/88
4,310,849	1/1982	Glass	358/88

4,395,731 7/1983 Schoolman 358/88
 4,398,799 8/1983 Swift 358/109

FOREIGN PATENT DOCUMENTS

56-42500 4/1981 Japan 179/107

Primary Examiner—John C. Martin
Assistant Examiner—Edward L. Coles
Attorney, Agent, or Firm—Young & Thompson

[57] **ABSTRACT**

A video recording device is arranged to be worn by the user like a pair of spectacles. In the recording mode, the scene in front of the user is recorded on a miniature television camera mounted on the spectacle frame (or two cameras if the recording is to be used for 3-D viewing). The miniature camera or cameras may be concealed within the spectacle frame, and allows the user to view the scene normally, and also to examine a view finder showing the portion of the scene available to the television camera. This enables the user to perform hands free photography and provides almost instantaneous recording of a scene as the act of looking at the scene points the camera and the view finder towards that portion of the scene to be captured. The device can be used to record moving pictures or still pictures as in an electronic still camera.

9 Claims, 7 Drawing Figures

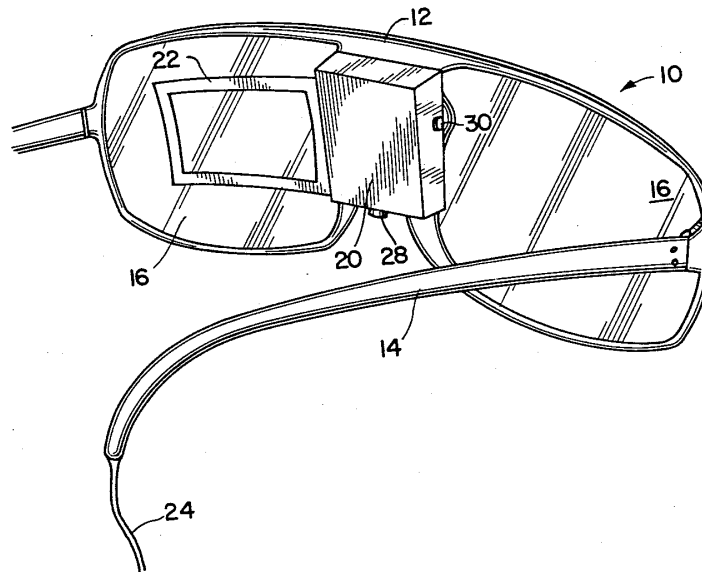

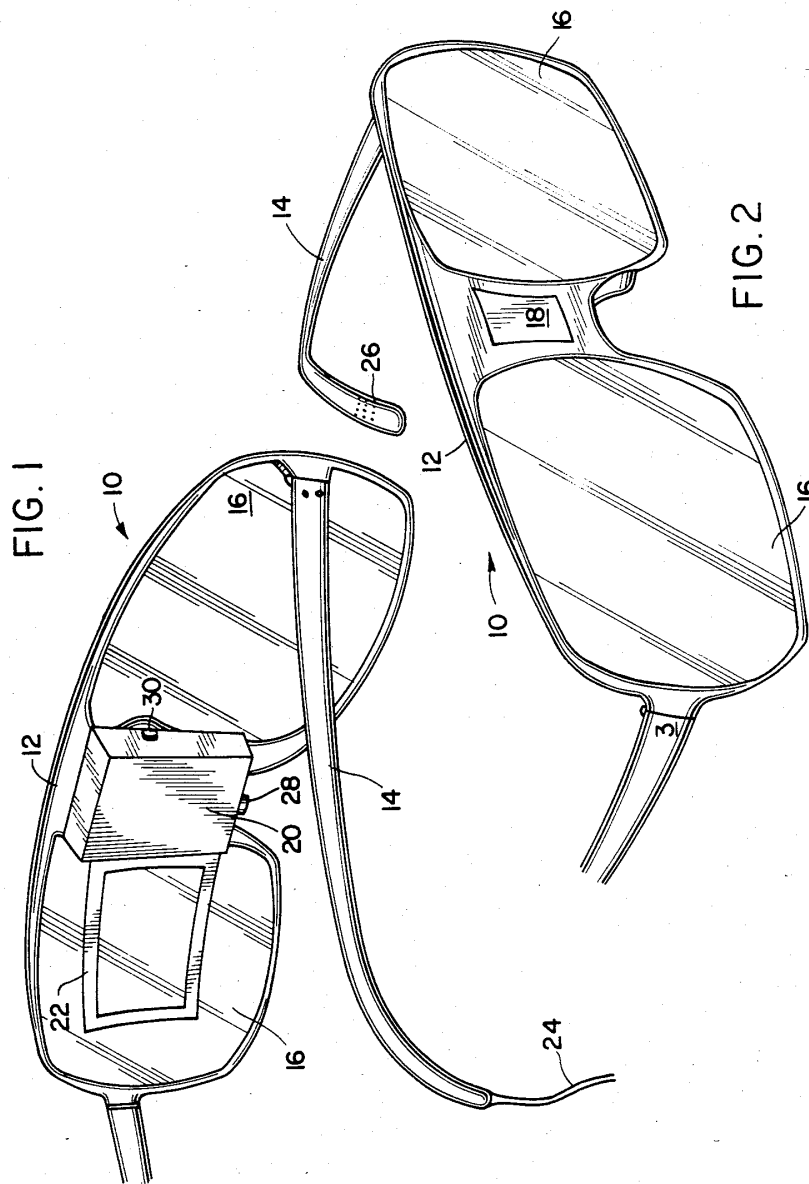

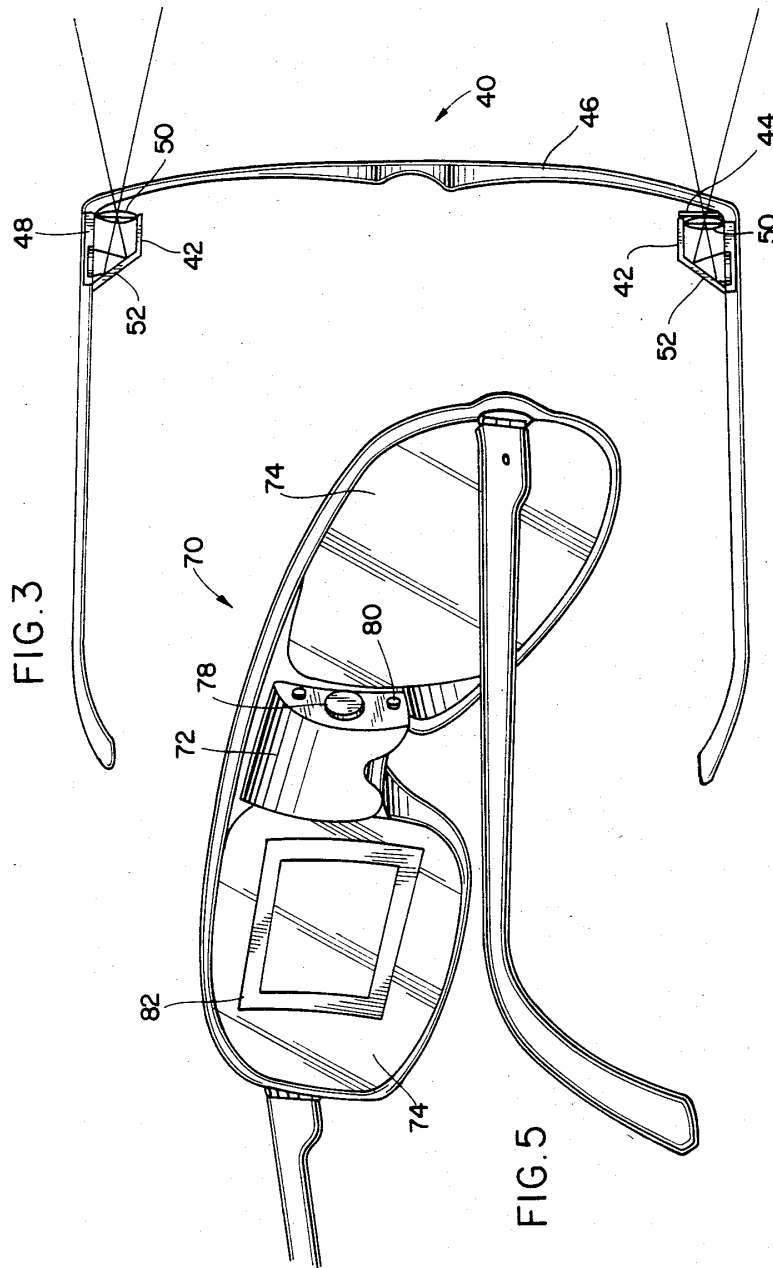

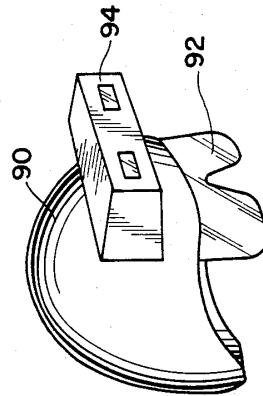
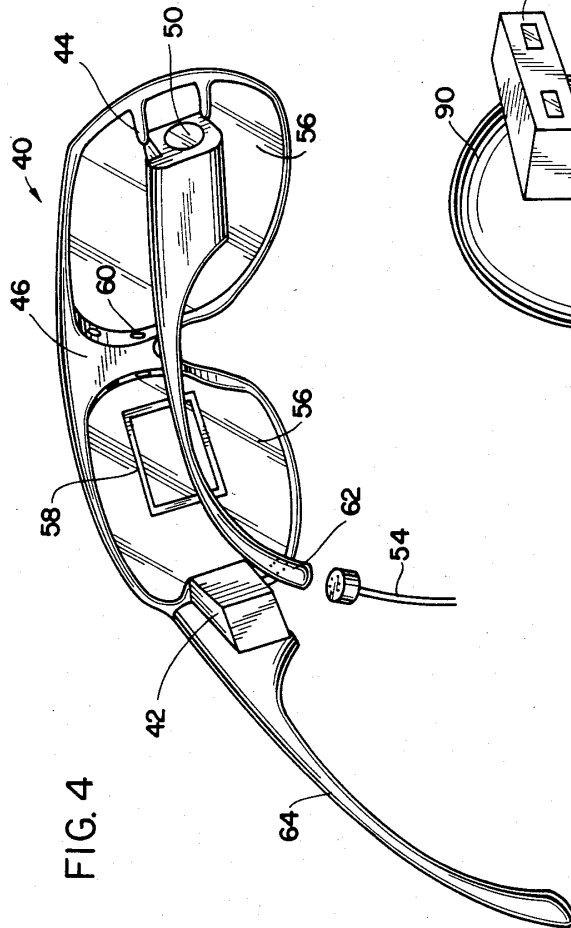

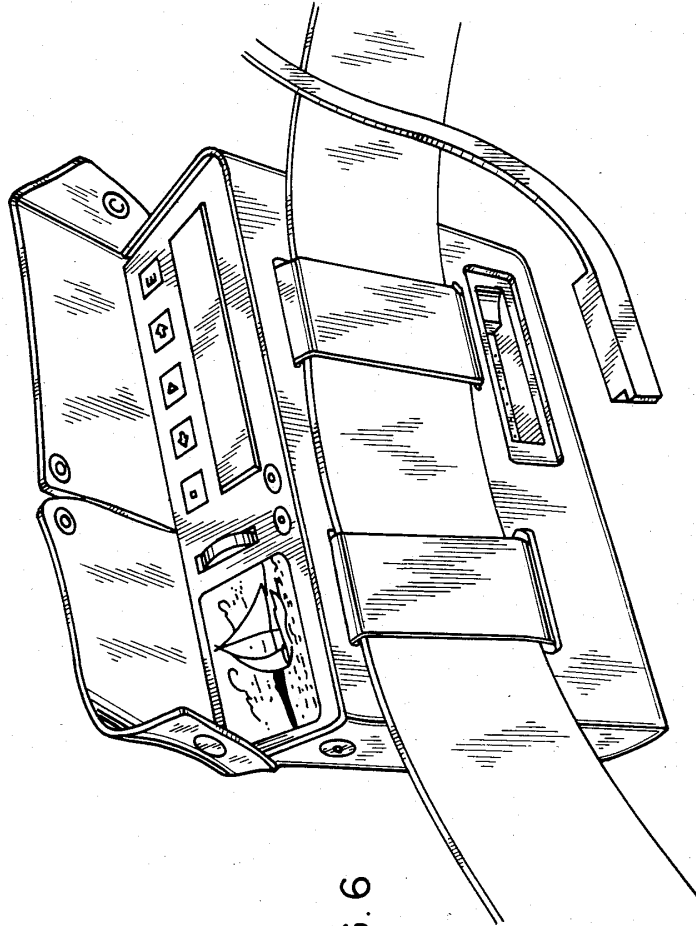

FIG. 6

Explore Litigation Insights

Docket Alarm provides insights to develop a more informed litigation strategy and the peace of mind of knowing you're on top of things.

Real-Time Litigation Alerts



Keep your litigation team up-to-date with **real-time alerts** and advanced team management tools built for the enterprise, all while greatly reducing PACER spend.

Our comprehensive service means we can handle Federal, State, and Administrative courts across the country.

Advanced Docket Research



With over 230 million records, Docket Alarm's cloud-native docket research platform finds what other services can't. Coverage includes Federal, State, plus PTAB, TTAB, ITC and NLRB decisions, all in one place.

Identify arguments that have been successful in the past with full text, pinpoint searching. Link to case law cited within any court document via Fastcase.

Analytics At Your Fingertips



Learn what happened the last time a particular judge, opposing counsel or company faced cases similar to yours.

Advanced out-of-the-box PTAB and TTAB analytics are always at your fingertips.

API

Docket Alarm offers a powerful API (application programming interface) to developers that want to integrate case filings into their apps.

LAW FIRMS

Build custom dashboards for your attorneys and clients with live data direct from the court.

Automate many repetitive legal tasks like conflict checks, document management, and marketing.

FINANCIAL INSTITUTIONS

Litigation and bankruptcy checks for companies and debtors.

E-DISCOVERY AND LEGAL VENDORS

Sync your system to PACER to automate legal marketing.