



US008931932B2

(12) **United States Patent**  
**Lipscomb et al.**

(10) **Patent No.:** **US 8,931,932 B2**  
(45) **Date of Patent:** **Jan. 13, 2015**

(54) **MOISTURE RELEASE VALVE FOR AN OUTDOOR LIGHT FIXTURE**

(58) **Field of Classification Search**  
USPC ..... 362/362, 363, 364, 373, 96, 202, 205, 362/208  
See application file for complete search history.

(75) Inventors: **John M. Lipscomb**, Cedarburg, WI (US); **Keith H. Hamm**, Oshkosh, WI (US); **Stanley L. Suring**, Cedarburg, WI (US); **Walter J. Fiedorowicz**, North Prairie, WI (US); **Harley A. Reabe**, Green Lake, WI (US); **Walter E. Frohboese, Jr.**, Cedarburg, WI (US)

(56) **References Cited**

U.S. PATENT DOCUMENTS

4,220,981 A *	9/1980	Koether	362/486
4,272,802 A *	6/1981	Steadman	362/385
5,980,074 A	11/1999	Hwang	
6,254,258 B1 *	7/2001	Case	362/373
6,732,947 B2 *	5/2004	McKenna	239/99
6,883,948 B2 *	4/2005	VanDuyn et al.	362/547
7,175,297 B2 *	2/2007	Hagen	362/153.1
7,182,659 B2 *	2/2007	Noda et al.	440/89 E

(73) Assignees: **G.H.L. International, Inc.**, Cedarburg, WI (US); **Magnum Power Products, LLC**, Berlin, WI (US)

\* cited by examiner

(\* ) Notice: Subject to any disclaimer, the term of this patent is extended or adjusted under 35 U.S.C. 154(b) by 1126 days.

*Primary Examiner* — Jong-Suk (James) Lee  
*Assistant Examiner* — Mark Tsidulko

(21) Appl. No.: **12/761,699**

(74) *Attorney, Agent, or Firm* — Boyle Fredrickson S.C.

(22) Filed: **Apr. 16, 2010**

(57) **ABSTRACT**

(65) **Prior Publication Data**

US 2011/0255293 A1 Oct. 20, 2011

A moisture release valve for an outdoor light including a valve body having a stem received in a valve guide and having a head seating with a valve seat integrally formed of part of a sidewall of a light casing of the light fixture. Valve body is gravity displaced between a closed position and an open position depending upon light fixture orientation and can include a counterweight carried by its stem interiorly disposed within the fixture helping to cause displacement of the valve body toward the desired open or closed position in response to a change in light fixture orientation. Valve body can be a rivet, such as a split rivet, and the counterweight can be a washer, such as an annular washer, having an opening generally in registry with the valve guide permitting fluid within the fixture to drain from the fixture when the valve is open.

(51) **Int. Cl.**

<b>F21V 15/00</b>	(2006.01)
<b>F21L 14/04</b>	(2006.01)
<b>F21V 17/00</b>	(2006.01)
<b>F21V 21/22</b>	(2006.01)
<b>F21V 21/30</b>	(2006.01)
<b>F21W 131/10</b>	(2006.01)

(52) **U.S. Cl.**

CPC ..... **F24V 31/03** (2013.01); **F21L 14/04** (2013.01); **F21V 17/007** (2013.01); **F21V 21/22** (2013.01); **F21V 21/30** (2013.01); **F21W 2131/10** (2013.01); **Y02B 20/72** (2013.01)  
USPC ..... **362/362**; 362/363; 362/364; 362/373

**22 Claims, 8 Drawing Sheets**

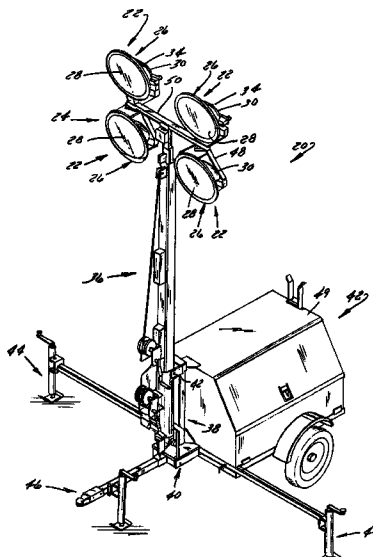

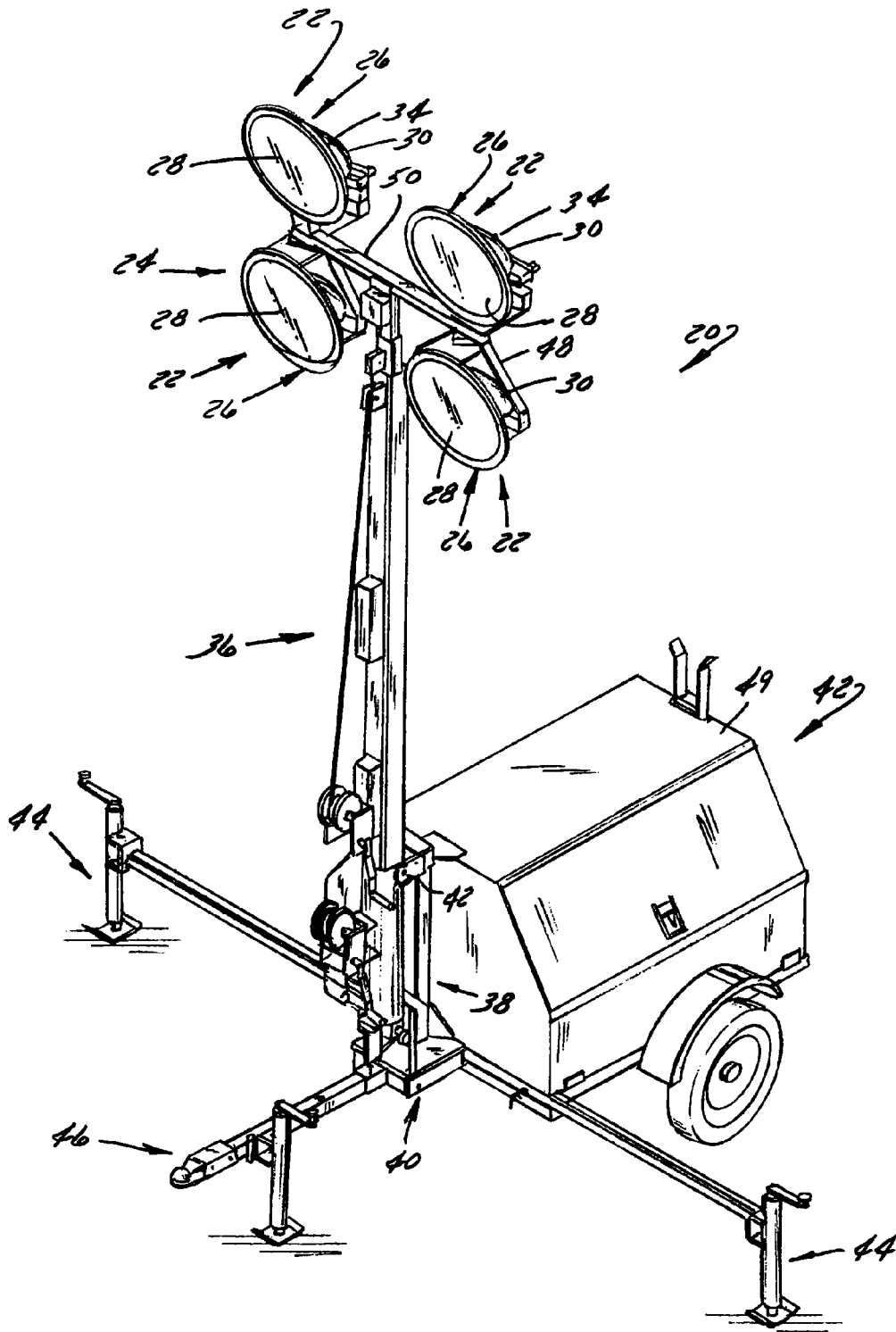

FIG. 1

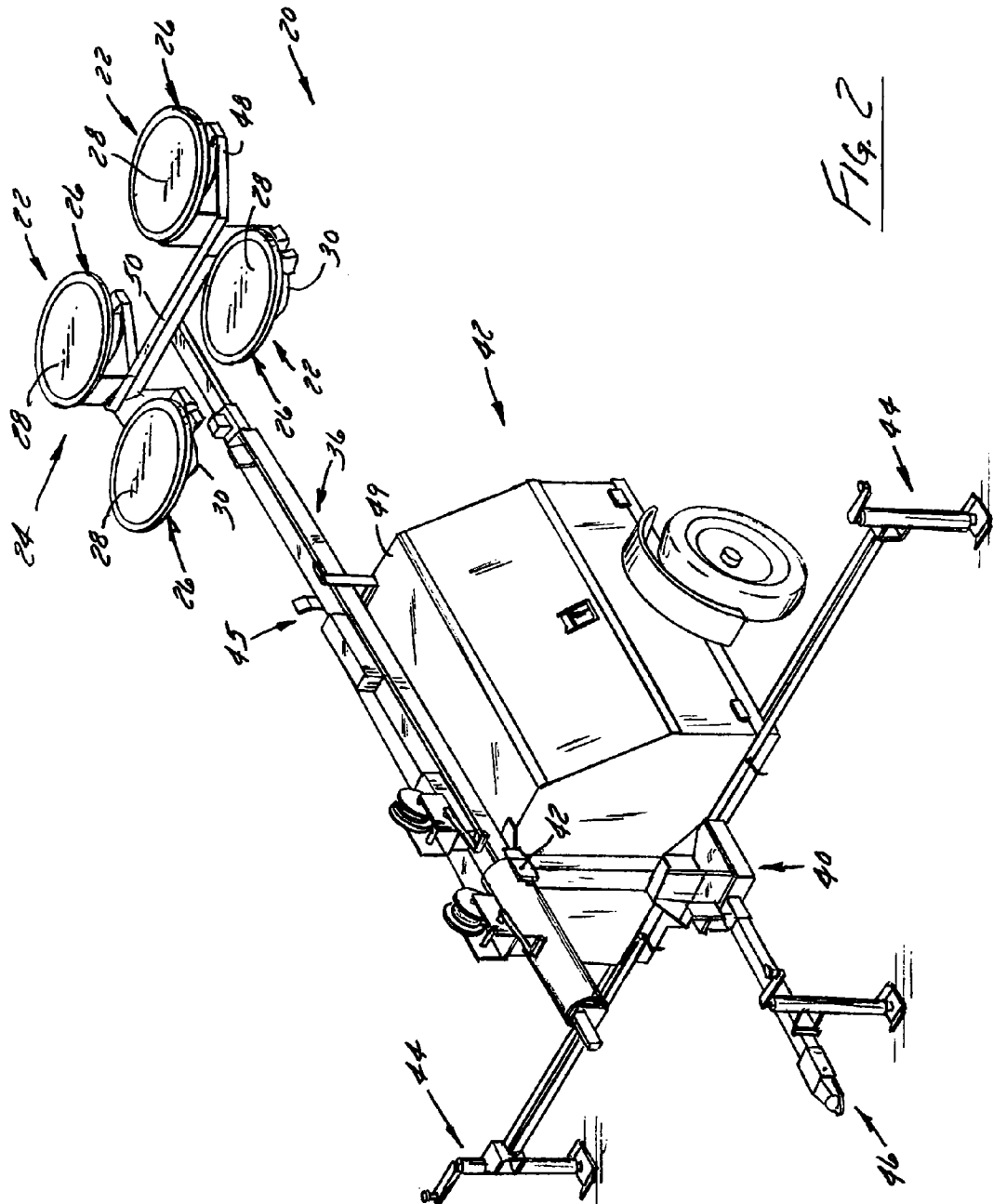

Fig. 2

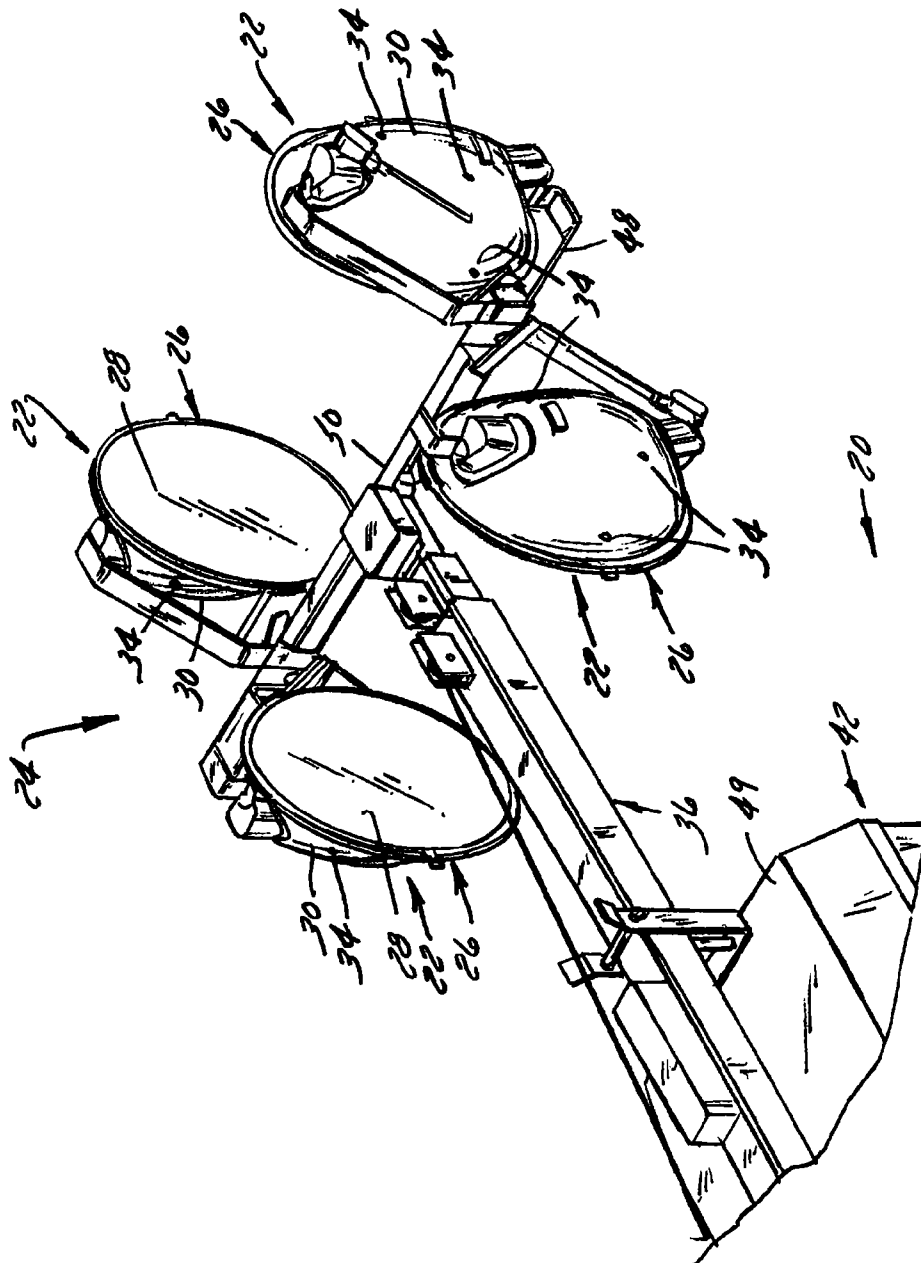

FIG. 3

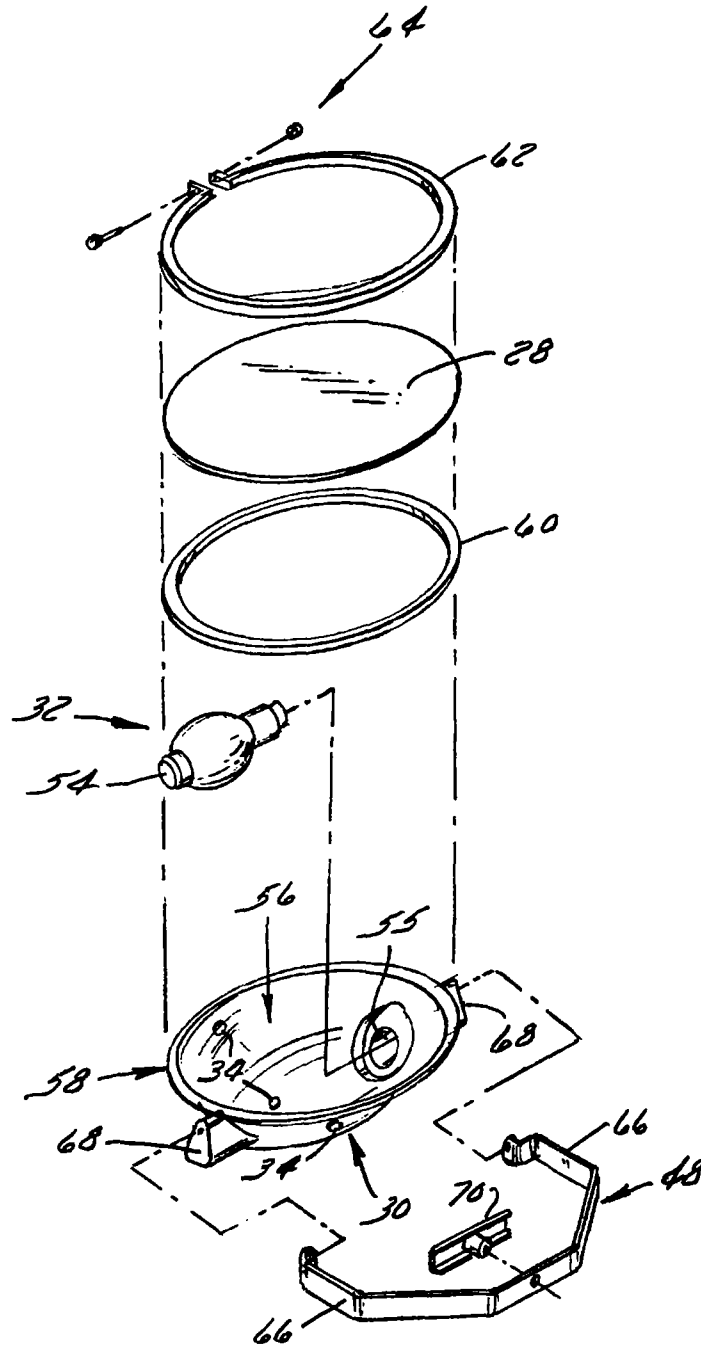

FIG. 4

# Explore Litigation Insights

Docket Alarm provides insights to develop a more informed litigation strategy and the peace of mind of knowing you're on top of things.

## Real-Time Litigation Alerts



Keep your litigation team up-to-date with **real-time alerts** and advanced team management tools built for the enterprise, all while greatly reducing PACER spend.

Our comprehensive service means we can handle Federal, State, and Administrative courts across the country.

## Advanced Docket Research



With over 230 million records, Docket Alarm's cloud-native docket research platform finds what other services can't. Coverage includes Federal, State, plus PTAB, TTAB, ITC and NLRB decisions, all in one place.

Identify arguments that have been successful in the past with full text, pinpoint searching. Link to case law cited within any court document via Fastcase.

## Analytics At Your Fingertips



Learn what happened the last time a particular judge, opposing counsel or company faced cases similar to yours.

Advanced out-of-the-box PTAB and TTAB analytics are always at your fingertips.

## API

Docket Alarm offers a powerful API (application programming interface) to developers that want to integrate case filings into their apps.

## LAW FIRMS

Build custom dashboards for your attorneys and clients with live data direct from the court.

Automate many repetitive legal tasks like conflict checks, document management, and marketing.

## FINANCIAL INSTITUTIONS

Litigation and bankruptcy checks for companies and debtors.

## E-DISCOVERY AND LEGAL VENDORS

Sync your system to PACER to automate legal marketing.