



US 20060176708A1

(19) **United States**(12) **Patent Application Publication**
Gordin et al.(10) **Pub. No.: US 2006/0176708 A1**(43) **Pub. Date: Aug. 10, 2006**(54) **SINGLE ARM MOGUL MOUNT FOR
SPORTS LIGHTING FIXTURES**(75) Inventors: **Myron K. Gordin**, Oskaloosa, IA (US);
Timothy J. Boyle, Oskaloosa, IA (US)

Correspondence Address:

MCKEE, VOORHEES & SEASE, P.L.C.
801 GRAND AVENUE
SUITE 3200
DES MOINES, IA 50309-2721 (US)(73) Assignee: **MUSCO CORPORATION**, Oskaloosa,
IA (US)(21) Appl. No.: **11/333,996**(22) Filed: **Jan. 18, 2006****Related U.S. Application Data**(60) Provisional application No. 60/644,687, filed on Jan.
18, 2005. Provisional application No. 60/644,639,
filed on Jan. 18, 2005. Provisional application No.
60/644,536, filed on Jan. 18, 2005. Provisional appli-
cation No. 60/644,747, filed on Jan. 18, 2005. Pro-
visional application No. 60/644,534, filed on Jan. 18,
2005. Provisional application No. 60/644,720, filed
on Jan. 18, 2005. Provisional application No. 60/644,688, filed on Jan. 18, 2005. Provisional application
No. 60/644,636, filed on Jan. 18, 2005. Provisional
application No. 60/644,517, filed on Jan. 18, 2005.
Provisional application No. 60/644,609, filed on Jan.
18, 2005. Provisional application No. 60/644,516,
filed on Jan. 18, 2005. Provisional application No.
60/644,546, filed on Jan. 18, 2005. Provisional appli-
cation No. 60/644,547, filed on Jan. 18, 2005. Pro-
visional application No. 60/644,638, filed on Jan. 18,
2005. Provisional application No. 60/644,537, filed
on Jan. 18, 2005. Provisional application No. 60/644,
637, filed on Jan. 18, 2005. Provisional application
No. 60/644,719, filed on Jan. 18, 2005. Provisional
application No. 60/644,784, filed on Jan. 18, 2005.**Publication Classification**(51) **Int. Cl.**
F21S 8/00 (2006.01)(52) **U.S. Cl.** **362/427**(57) **ABSTRACT**

An apparatus and method for a high intensity lighting fixture. One aspect, a knuckle for mounting the light fixture by its bulb cone to a cross arm is attached along the side of the bulb cone. This has various potential advantages including decreased effective projected area, protection of watering to the bulb cone, and decreased moment.

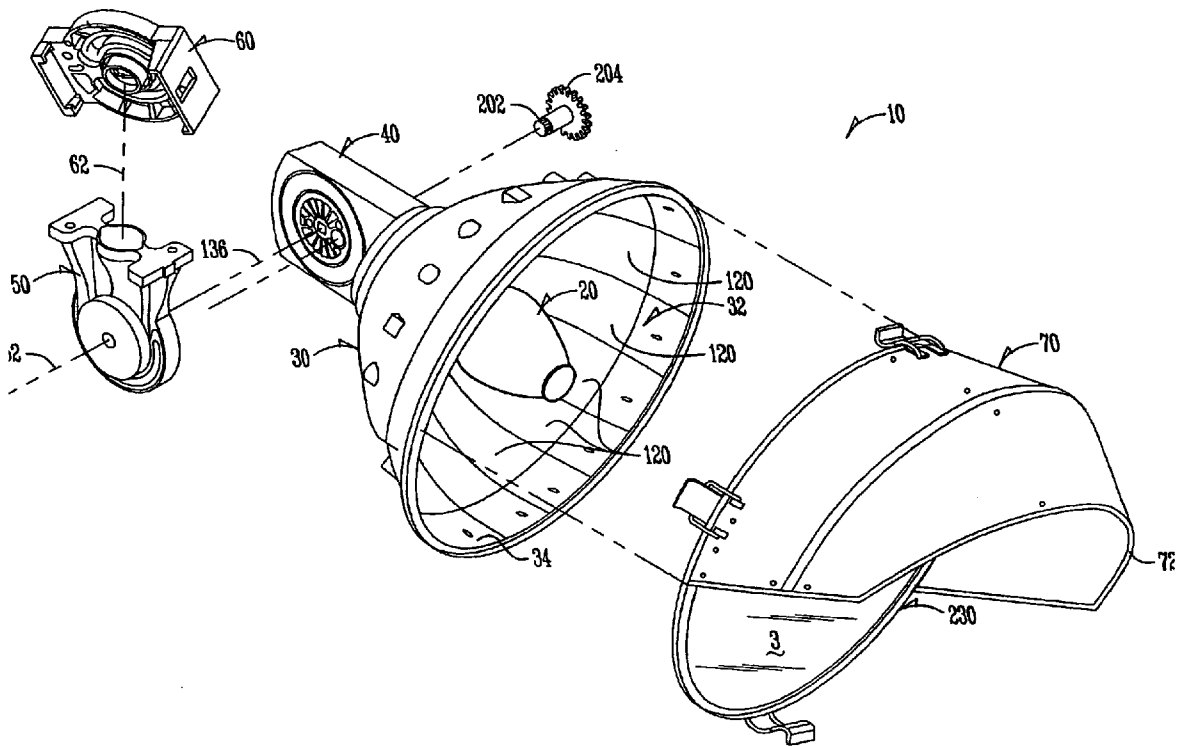

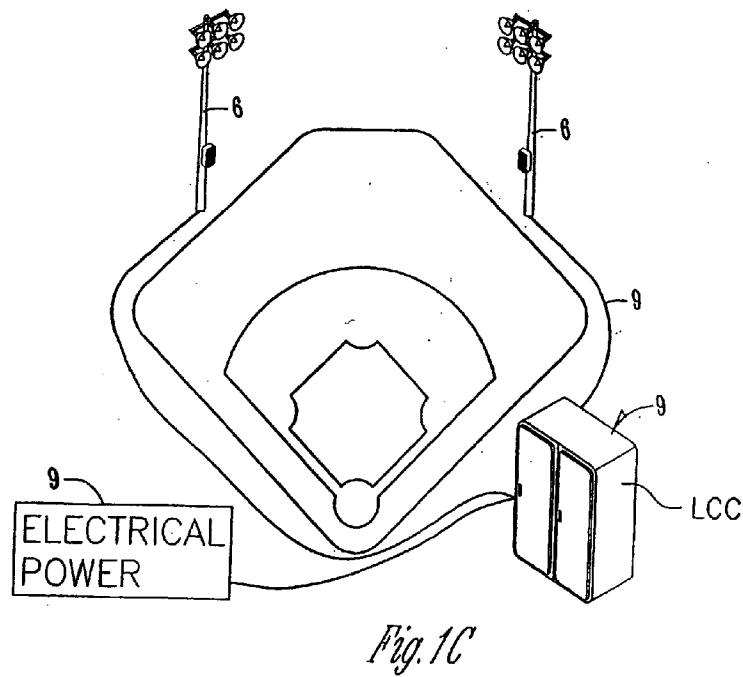
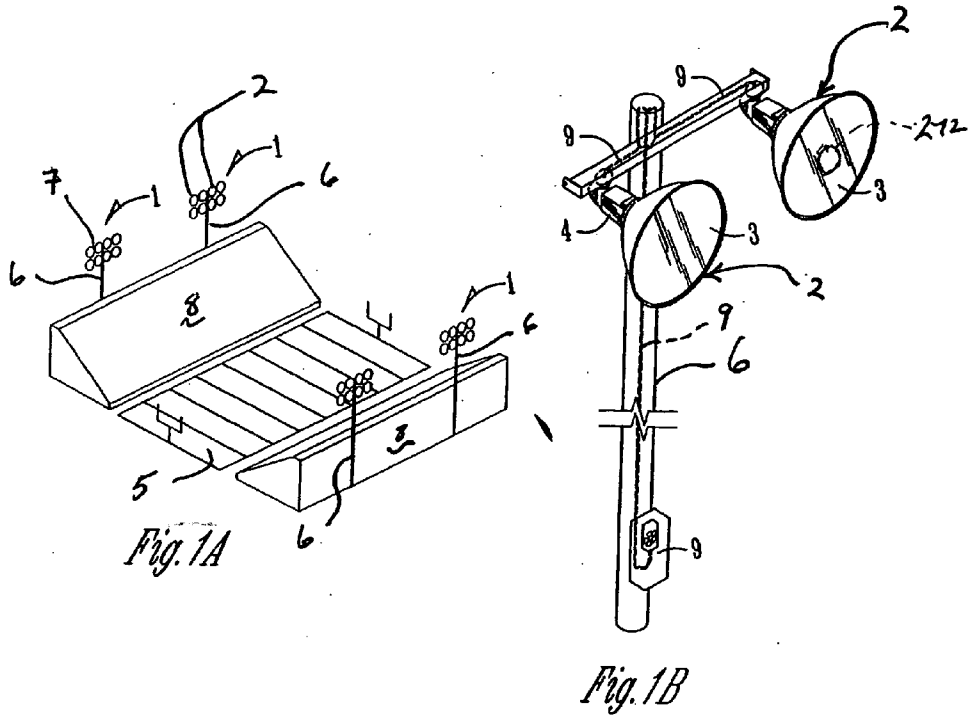

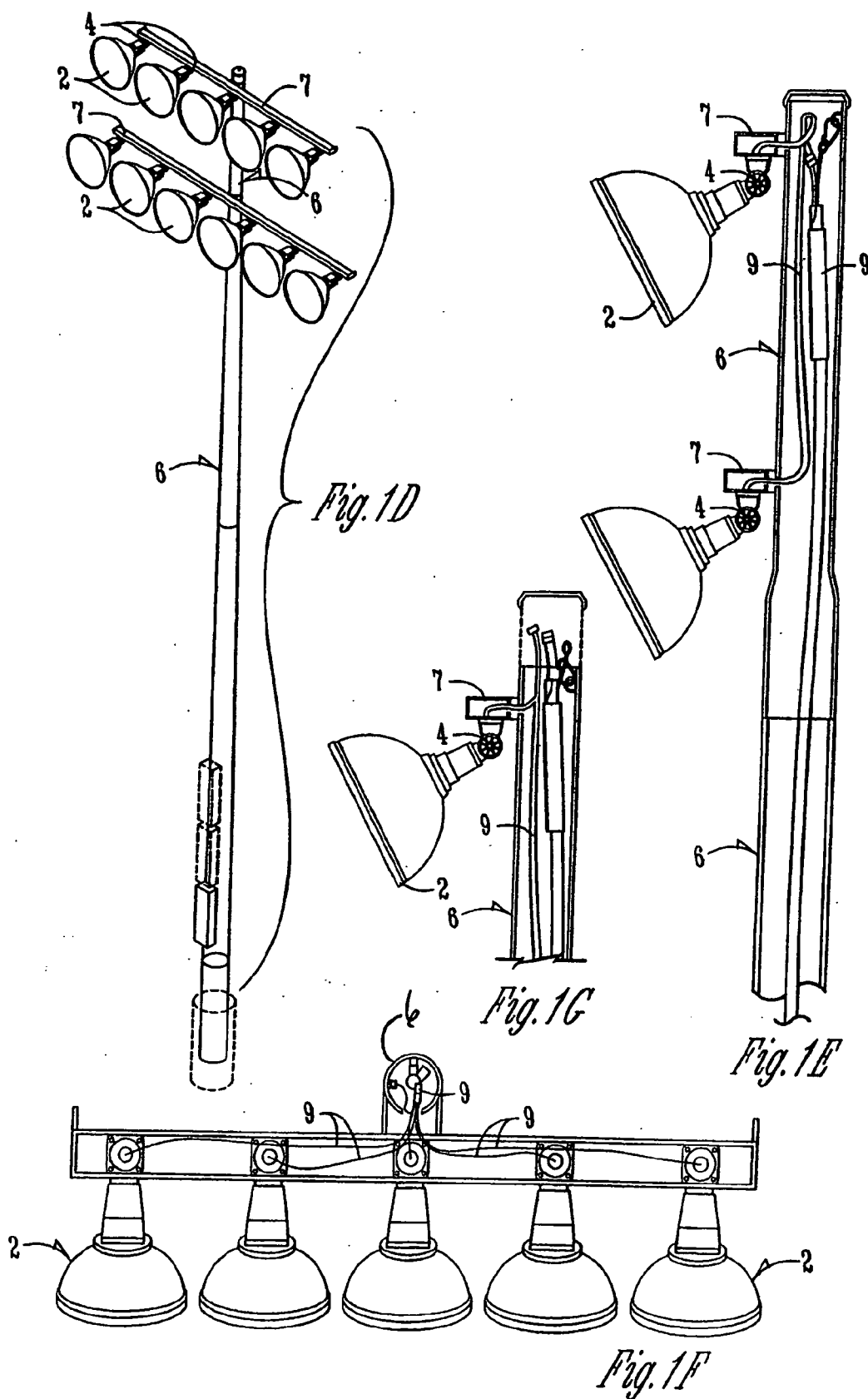

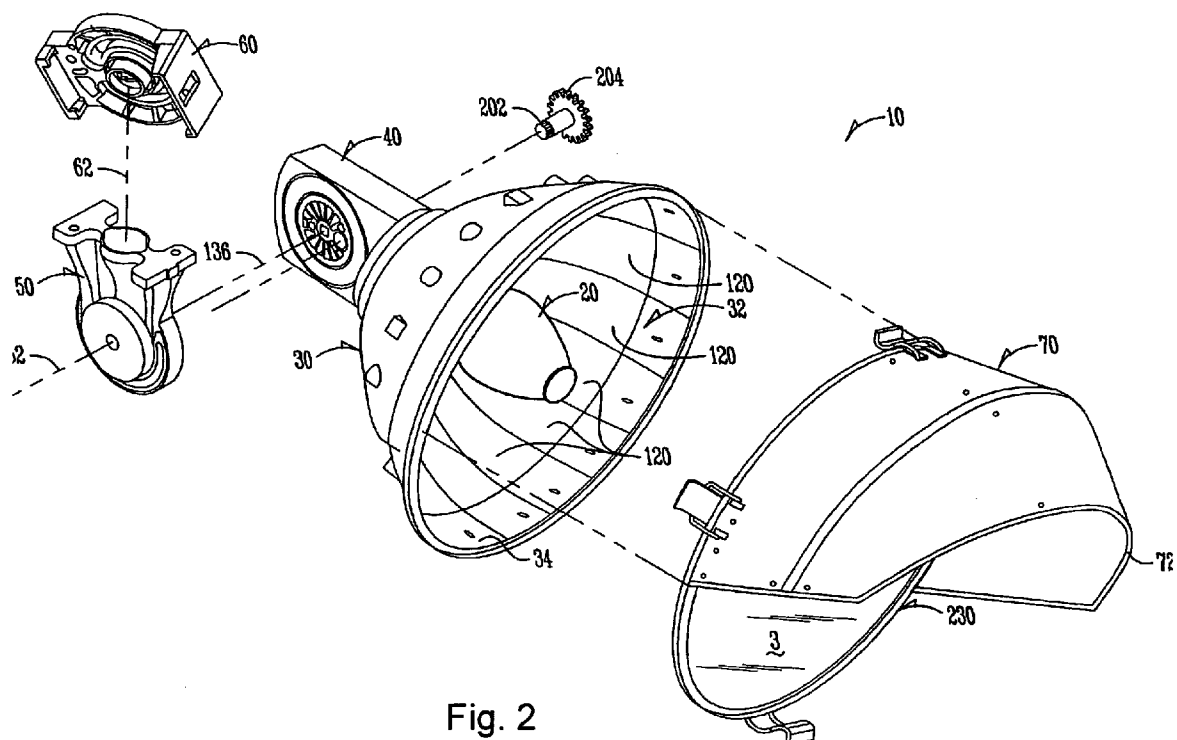

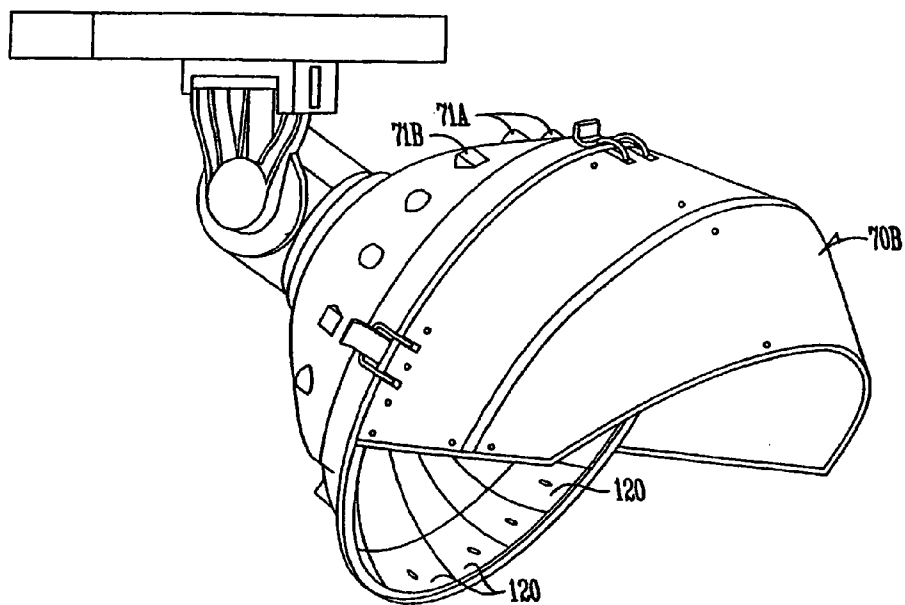

Fig. 3A

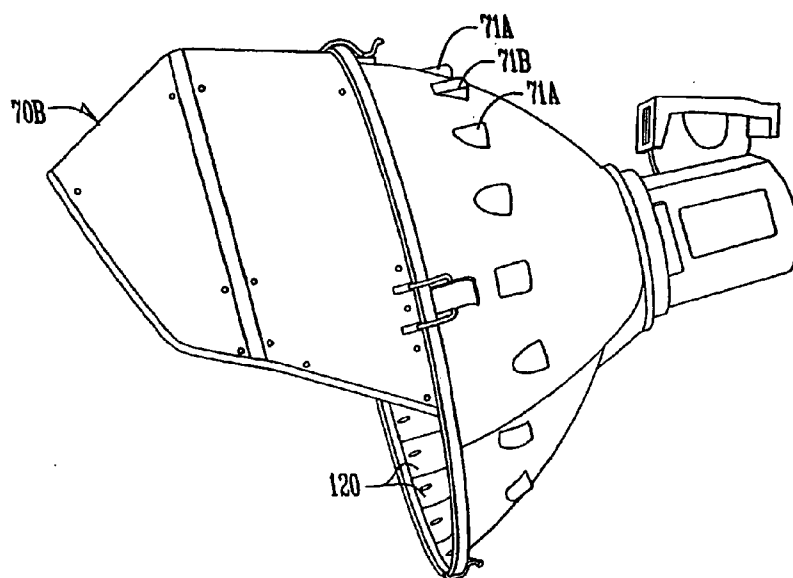

Fig. 3B

Explore Litigation Insights

Docket Alarm provides insights to develop a more informed litigation strategy and the peace of mind of knowing you're on top of things.

Real-Time Litigation Alerts



Keep your litigation team up-to-date with **real-time alerts** and advanced team management tools built for the enterprise, all while greatly reducing PACER spend.

Our comprehensive service means we can handle Federal, State, and Administrative courts across the country.

Advanced Docket Research



With over 230 million records, Docket Alarm's cloud-native docket research platform finds what other services can't. Coverage includes Federal, State, plus PTAB, TTAB, ITC and NLRB decisions, all in one place.

Identify arguments that have been successful in the past with full text, pinpoint searching. Link to case law cited within any court document via Fastcase.

Analytics At Your Fingertips



Learn what happened the last time a particular judge, opposing counsel or company faced cases similar to yours.

Advanced out-of-the-box PTAB and TTAB analytics are always at your fingertips.

API

Docket Alarm offers a powerful API (application programming interface) to developers that want to integrate case filings into their apps.

LAW FIRMS

Build custom dashboards for your attorneys and clients with live data direct from the court.

Automate many repetitive legal tasks like conflict checks, document management, and marketing.

FINANCIAL INSTITUTIONS

Litigation and bankruptcy checks for companies and debtors.

E-DISCOVERY AND LEGAL VENDORS

Sync your system to PACER to automate legal marketing.