



US 20110023652A1

(19) **United States**

(12) **Patent Application Publication**  
**Cosby et al.**

(10) **Pub. No.: US 2011/0023652 A1**

(43) **Pub. Date: Feb. 3, 2011**

(54) **MODULAR PEDAL ASSEMBLY FOR VEHICLES**

(60) Provisional application No. 60/442,577, filed on Jan. 24, 2003.

(76) Inventors: **Christopher D. Cosby**, Augusta, GA (US); **Douglas T. Crow**, Evans, GA (US); **David R. Hardy**, Hephzibah, GA (US); **Paul E. Morgan**, Appling, GA (US); **Duane E. Newman**, Evans, GA (US); **Geoff D. Stewart**, Evans, GA (US); **Michael L. Welsh**, Evans, GA (US)

**Publication Classification**

(51) **Int. Cl.**  
**G05G 1/36** (2008.04)  
(52) **U.S. Cl.** ..... **74/513**

(57) **ABSTRACT**

A modular pedal assembly for use with a vehicle that includes a prime mover, a control circuit, and a brake assembly. The modular pedal assembly including a base that is removably connectable with the vehicle, a brake pedal, an accelerator pedal that is displaceable between a first position and a second position, and a control output regulator that includes a first sensor and a second sensor. In a vehicle having an electric motor prime mover, the first sensor is a limit switch electrically connected to the control circuit, and the second sensor is a variable resistor. In a vehicle having an internal combustion engine prime mover, the first sensor is a limit switch operable to control a starter motor, and the second sensor is a limit switch operable to control a spark plug ignition.

Correspondence Address:  
**MICHAEL BEST & FRIEDRICH LLP**  
**100 E WISCONSIN AVENUE, Suite 3300**  
**MILWAUKEE, WI 53202 (US)**

(21) Appl. No.: **12/903,289**

(22) Filed: **Oct. 13, 2010**

**Related U.S. Application Data**

(62) Division of application No. 10/543,344, filed on May 19, 2006, filed as application No. PCT/US04/02120 on Jan. 26, 2004.

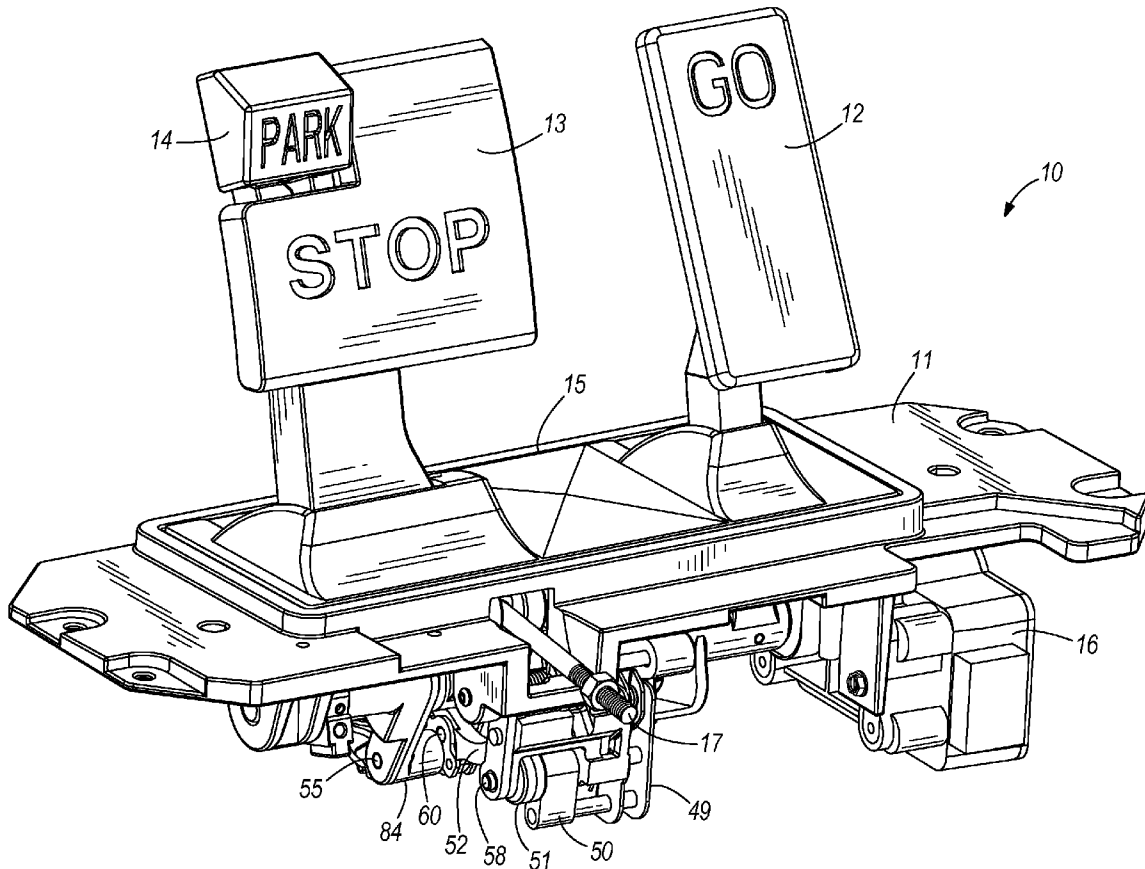

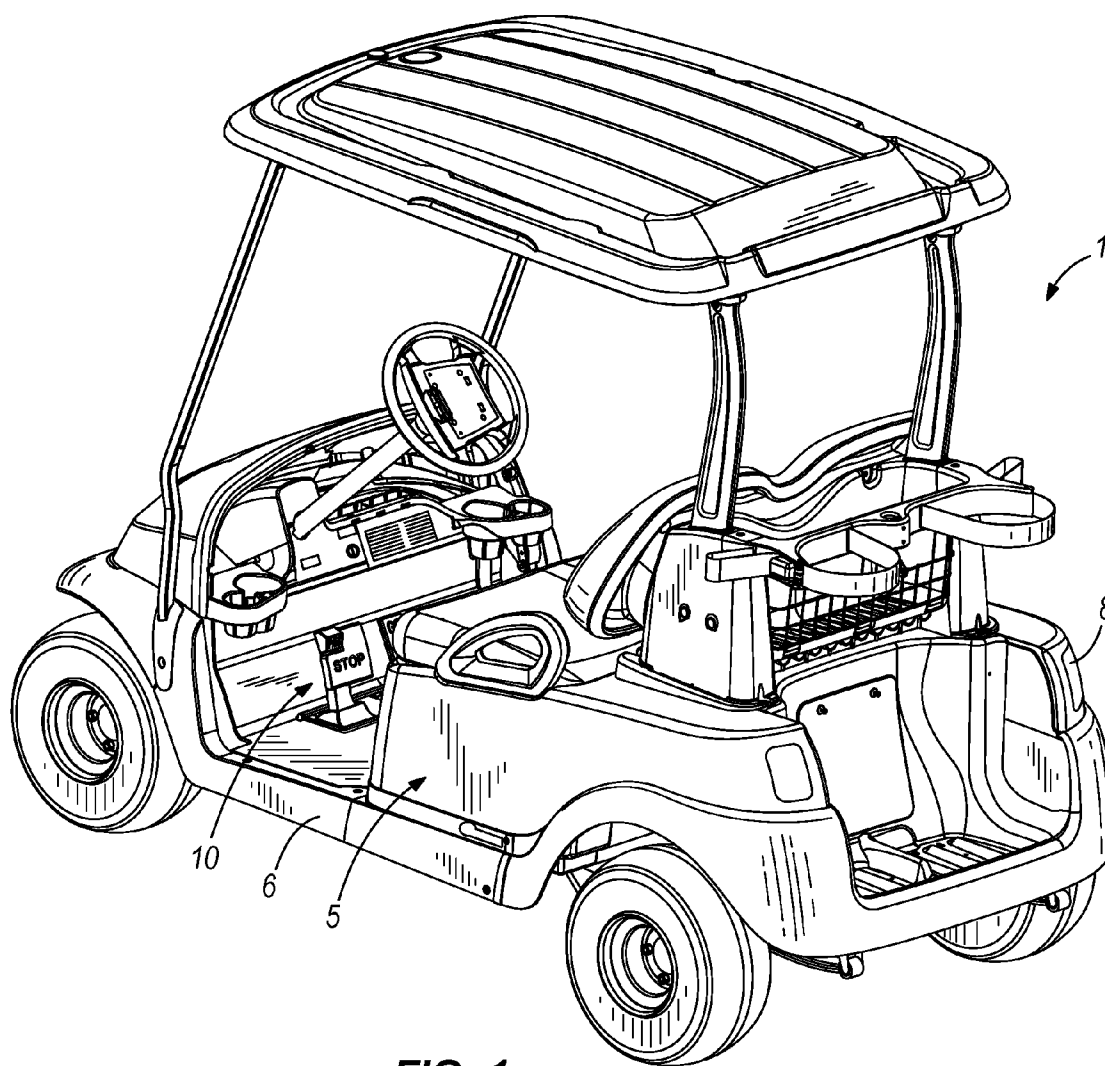

**FIG. 1**

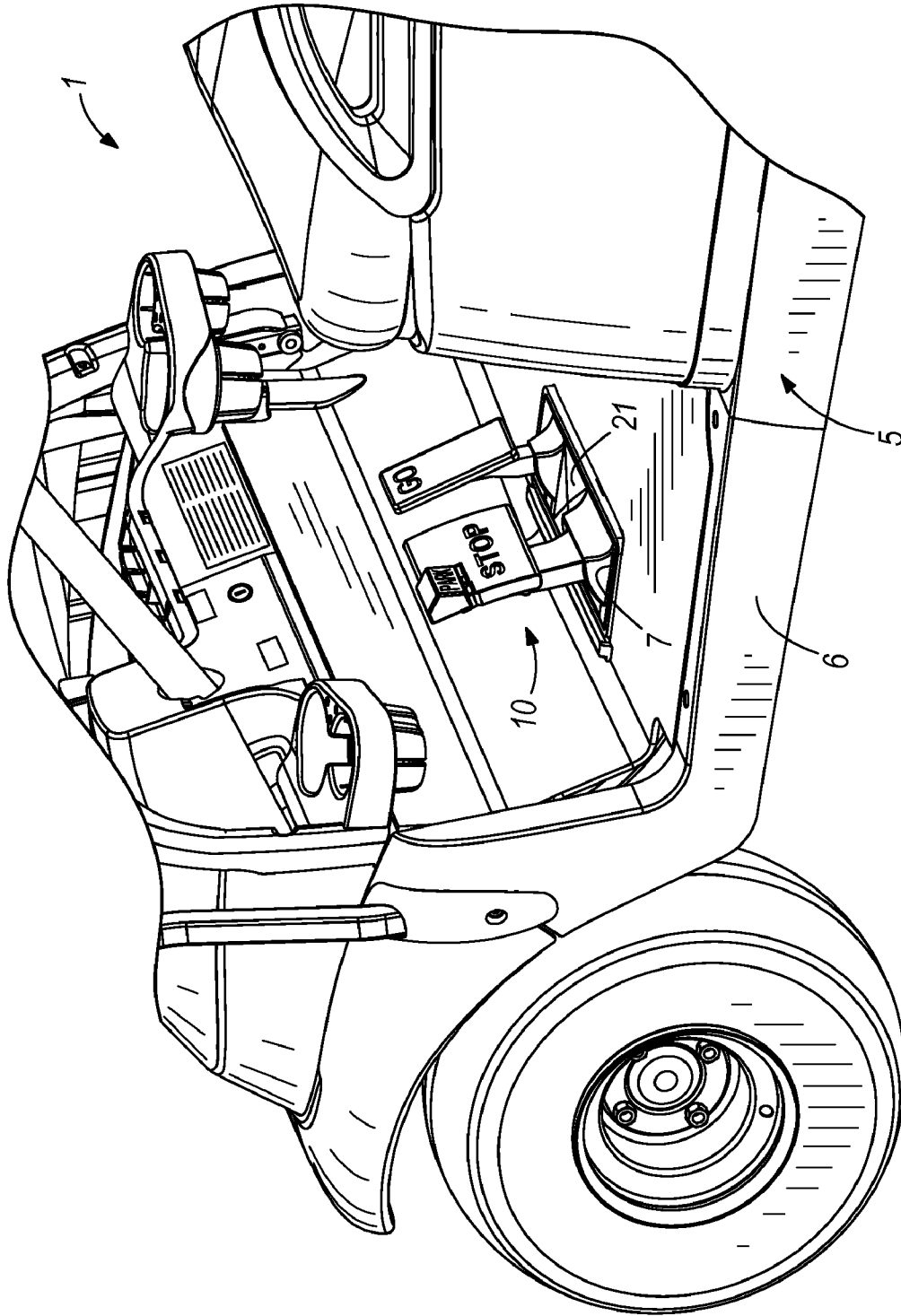

FIG. 2

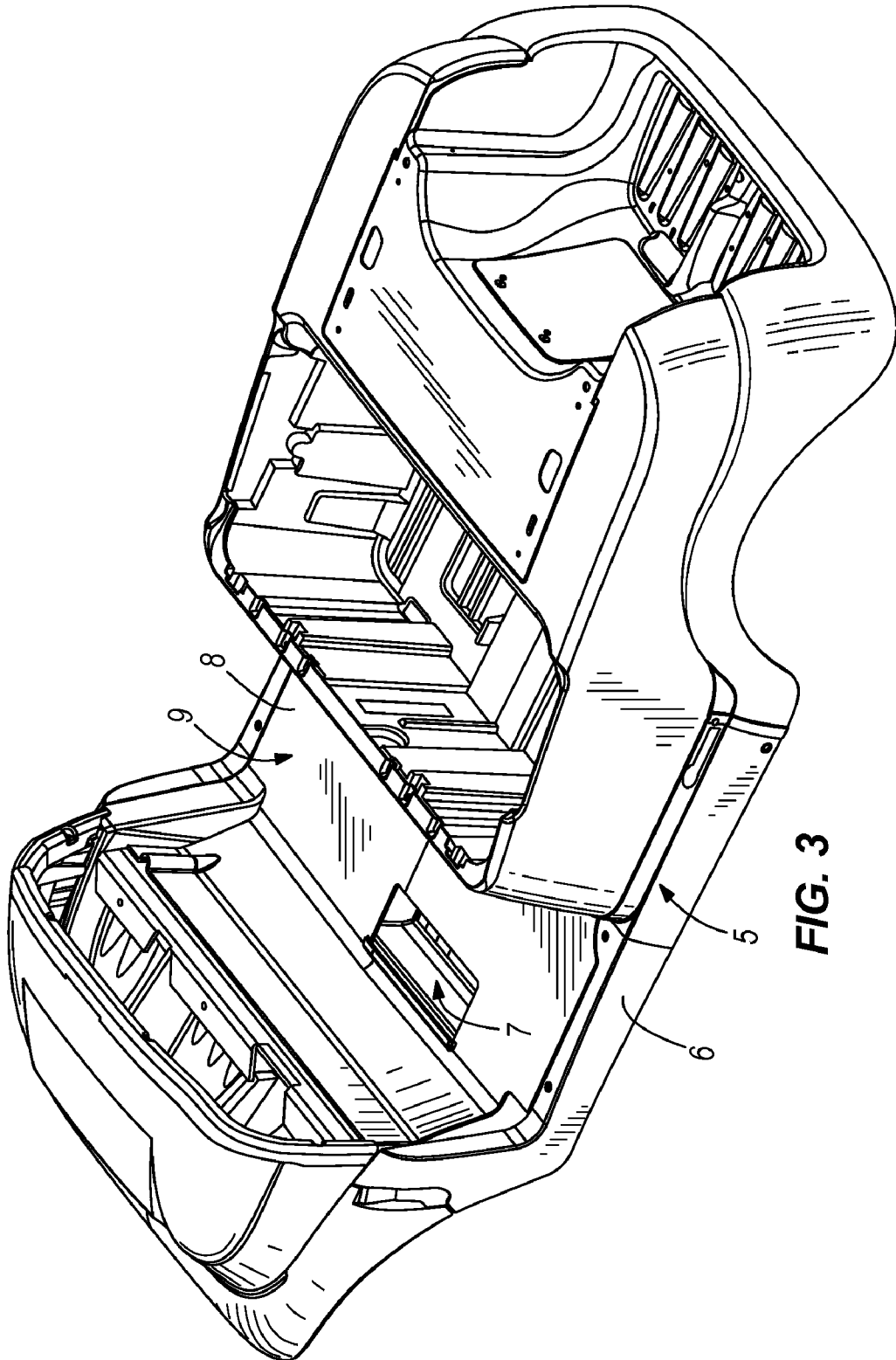

FIG. 3

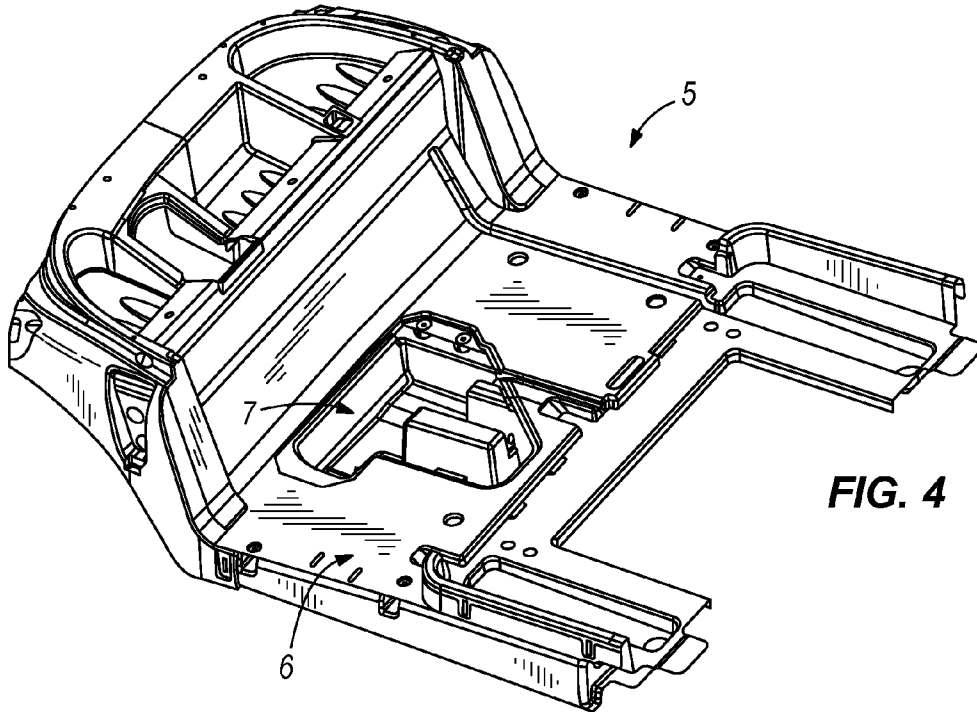

FIG. 4

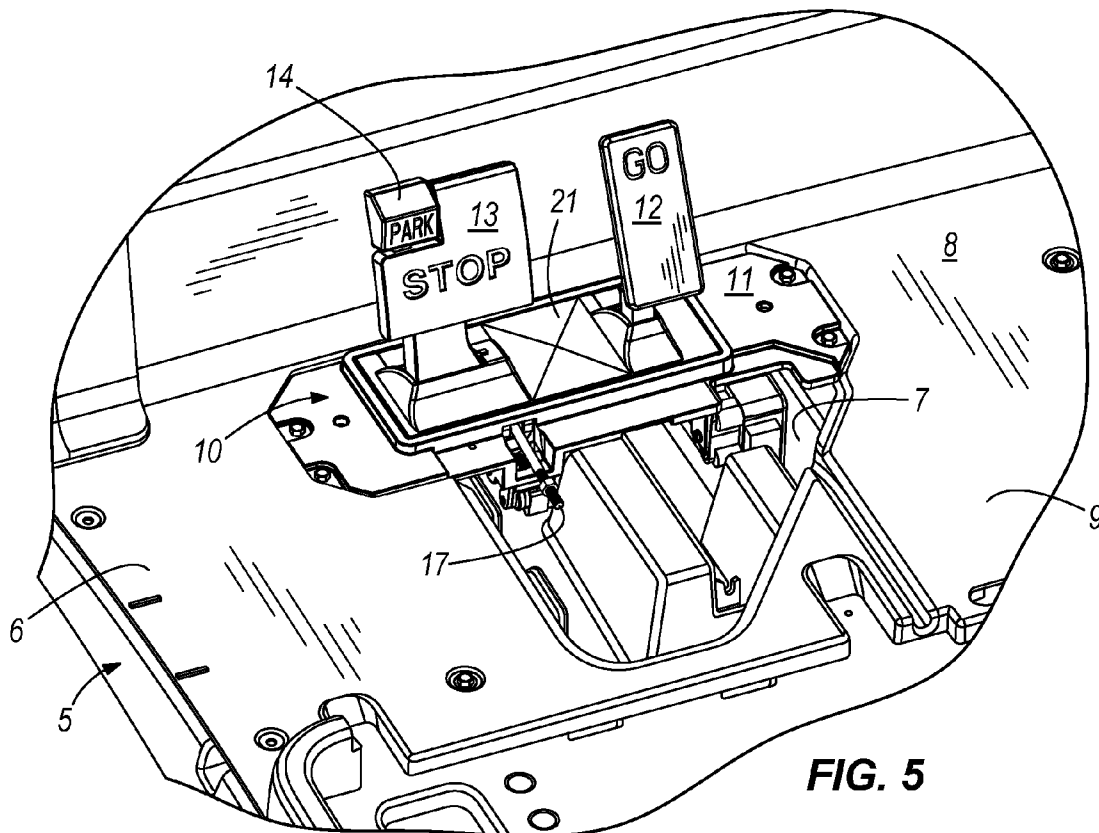

FIG. 5

# Explore Litigation Insights

Docket Alarm provides insights to develop a more informed litigation strategy and the peace of mind of knowing you're on top of things.

## Real-Time Litigation Alerts



Keep your litigation team up-to-date with **real-time alerts** and advanced team management tools built for the enterprise, all while greatly reducing PACER spend.

Our comprehensive service means we can handle Federal, State, and Administrative courts across the country.

## Advanced Docket Research



With over 230 million records, Docket Alarm's cloud-native docket research platform finds what other services can't. Coverage includes Federal, State, plus PTAB, TTAB, ITC and NLRB decisions, all in one place.

Identify arguments that have been successful in the past with full text, pinpoint searching. Link to case law cited within any court document via Fastcase.

## Analytics At Your Fingertips



Learn what happened the last time a particular judge, opposing counsel or company faced cases similar to yours.

Advanced out-of-the-box PTAB and TTAB analytics are always at your fingertips.

## API

Docket Alarm offers a powerful API (application programming interface) to developers that want to integrate case filings into their apps.

## LAW FIRMS

Build custom dashboards for your attorneys and clients with live data direct from the court.

Automate many repetitive legal tasks like conflict checks, document management, and marketing.

## FINANCIAL INSTITUTIONS

Litigation and bankruptcy checks for companies and debtors.

## E-DISCOVERY AND LEGAL VENDORS

Sync your system to PACER to automate legal marketing.