



[54] FINGERPRINT ACTUATION OF CUSTOMIZED VEHICLE FEATURES

[75] Inventors: Shi-Ping Hsu, Pasadena; Bruce W. Evans; Arthur F. Messenger, both of Redondo Beach; Denes L. Zsolnay, Rolling Hills Estates, all of Calif.

[73] Assignee: TRW Inc., Redondo Beach, Calif.

[*] Notice: This patent issued on a continued prosecution application filed under 37 CFR 1.53(d), and is subject to the twenty year patent term provisions of 35 U.S.C. 154(a)(2).

[21] Appl. No.: 08/995,564

[22] Filed: Dec. 22, 1997

[51] Int. Cl.⁷ G06F 7/04

[52] U.S. Cl. 340/825.31; 340/825.3; 340/825.34; 340/430; 340/539; 340/825.69; 382/115; 382/124; 382/125; 382/126

[58] Field of Search 340/825.31, 825.3, 340/825.34, 430, 539, 825.69; 382/115, 224, 126, 124, 125

[56] References Cited

U.S. PATENT DOCUMENTS

4,451,887	5/1984	Harada et al.	364/424
4,754,255	6/1988	Sanders et al.	340/430
4,997,053	3/1991	Drori et al.	180/287
5,054,569	10/1991	Scott et al.	180/167
5,067,162	11/1991	Driscoll, Jr. et al.	382/126

5,559,504	9/1996	Itsumi et al.	340/825.3
5,572,597	11/1996	Chang et al.	382/125
5,631,971	5/1997	Sparrow	382/125
5,802,199	9/1998	Pare, Jr. et al.	382/115

Primary Examiner—Michael Horabik
Assistant Examiner—Yves Dalencourt
Attorney, Agent, or Firm—Michael S. Yatsko

[57] ABSTRACT

Apparatus, and a corresponding method for its use, for gaining access to and operating a vehicle, such as a car (10), by means of at least one fingerprint sensor (16) installed inside the vehicle at a convenient location and, optionally, outside the vehicle (at 14), in or near a door handle (12). Once an authorized user's identify has been verified in a fingerprint matching device (30), various vehicle subsystems are automatically adjusted to the identified user's preferred settings, which are stored in a memory (98). In addition, starting the vehicle engine is enabled if an interior fingerprint sensor has been used, or the vehicle is unlocked if an exterior fingerprint sensor has been used. Vehicle subsystems that are automatically adjusted to the user preferences include seats (38), mirrors (40), steering wheel (42), climate control (44), airbag (52), telephone (46), radio (50) and onboard computer (54), as well as performance control features (48) such as suspension and transmission adjustment. Door locks (34) and security system features (36) are also automatically controlled, as is a radio transmitter (56) that is automatically customized to open the user's home garage door or office parking entry gate. Features of a number of different fingerprints are stored in the device to allow for operation of the vehicle (10) by different family members, as authorized by a primary user.

26 Claims, 7 Drawing Sheets

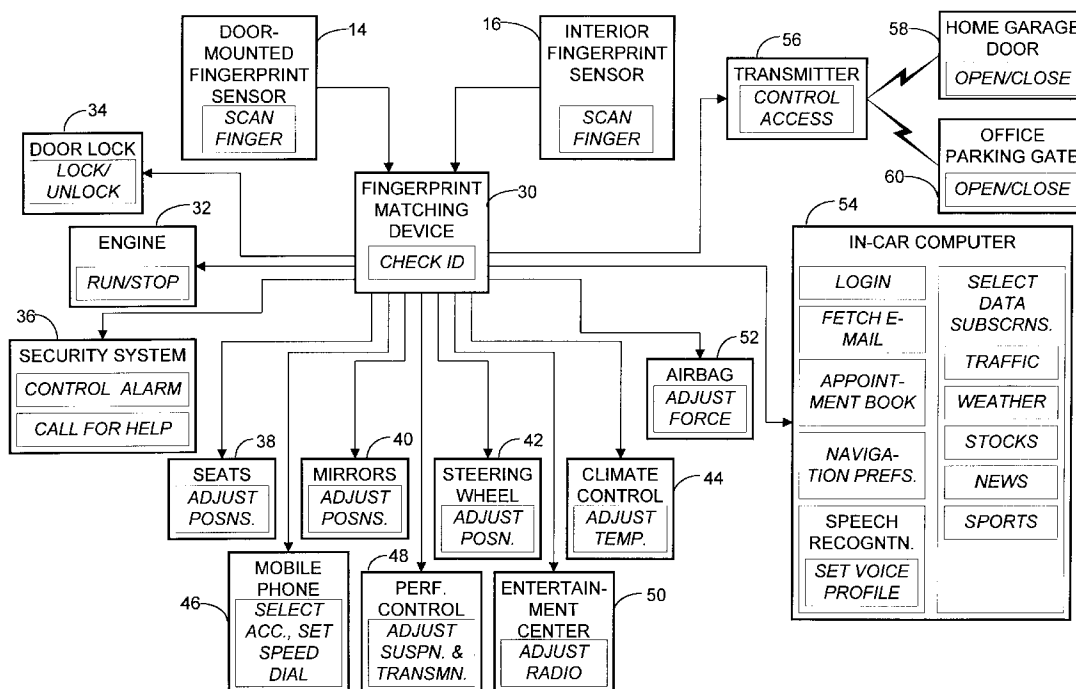

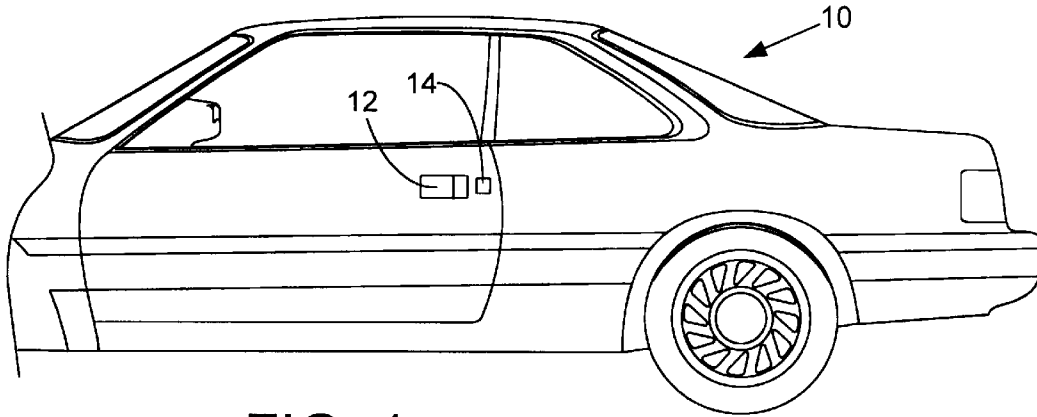

FIG. 1

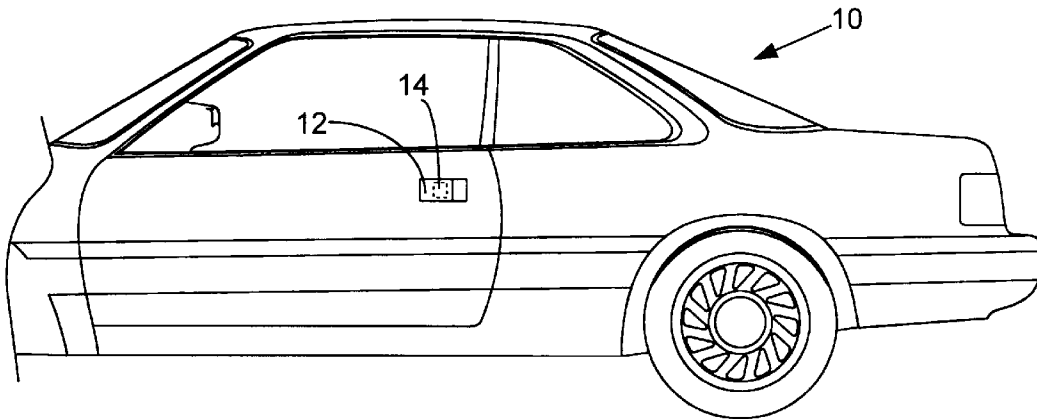

FIG. 2

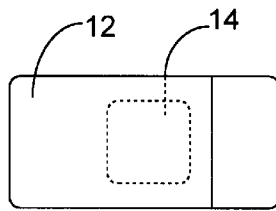

FIG. 3

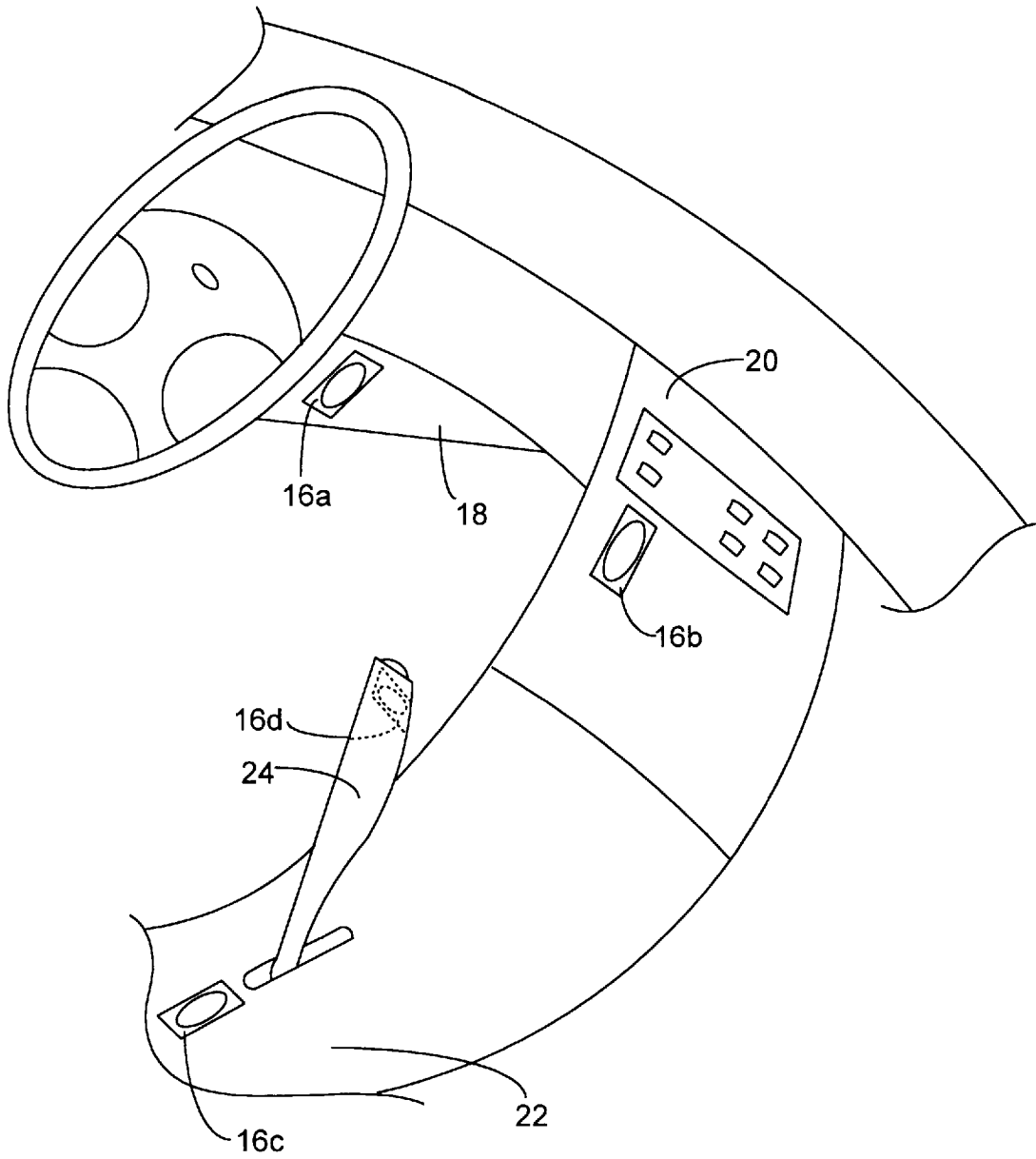

FIG. 4

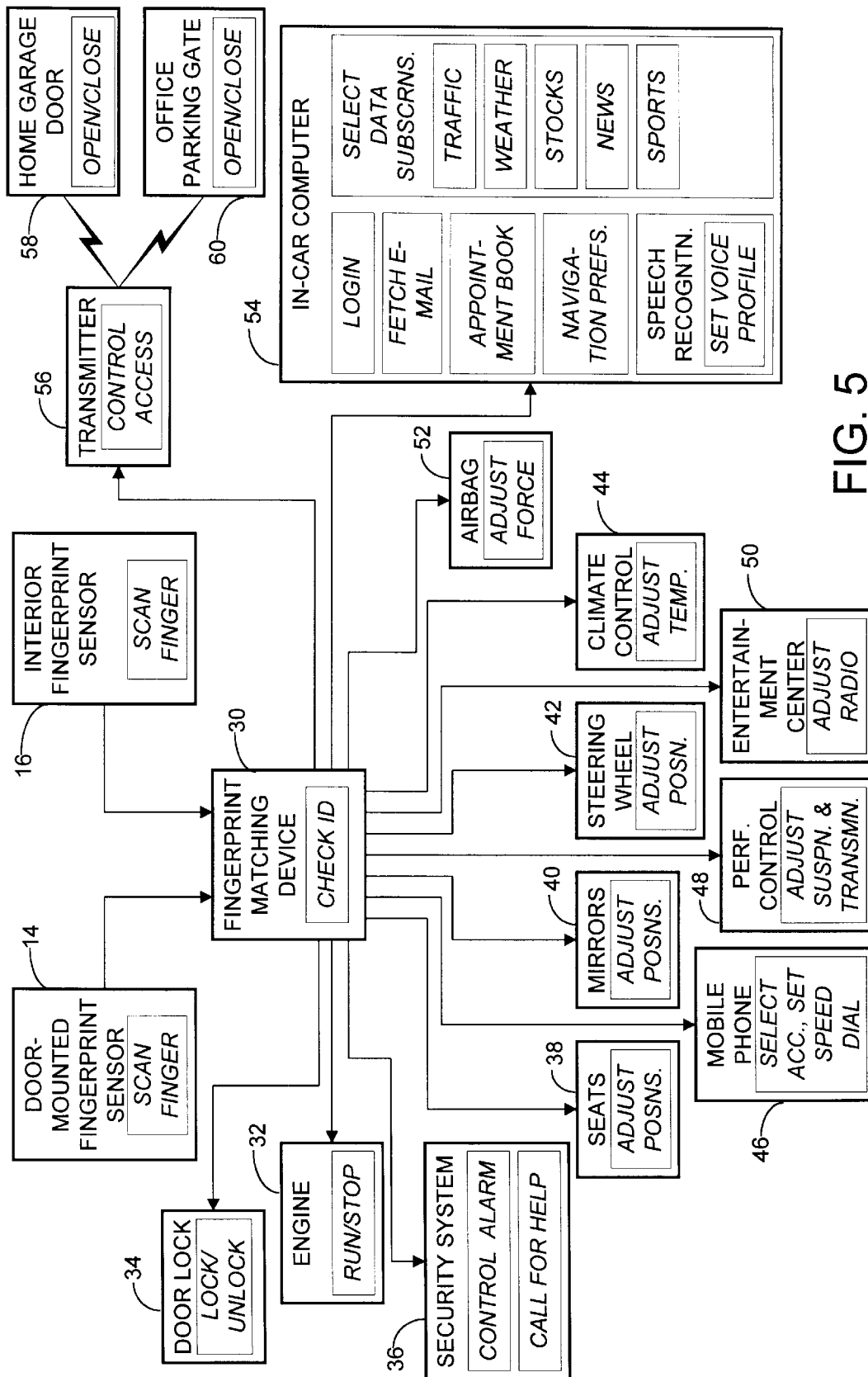

FIG. 5

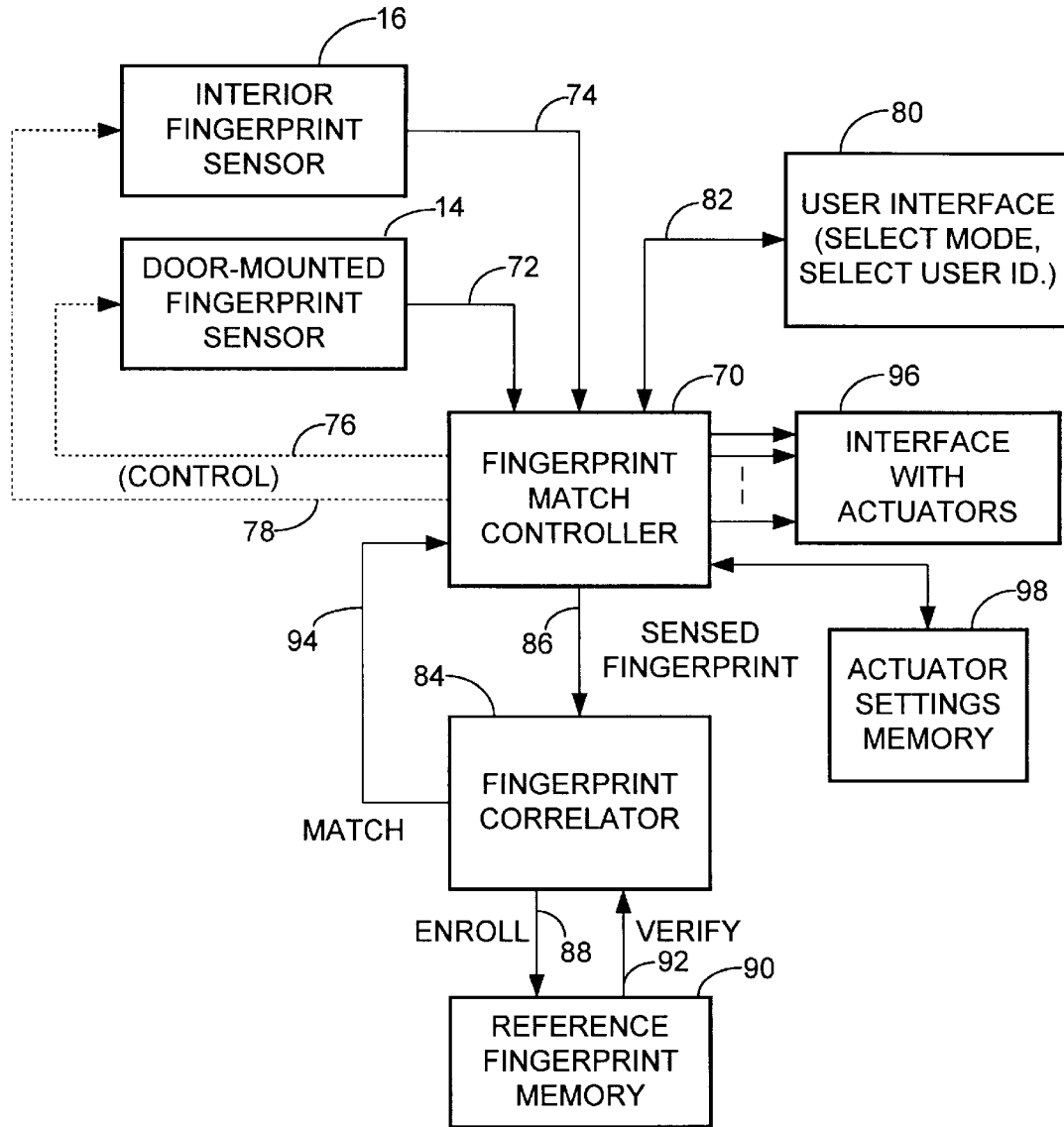

FIG. 6

Explore Litigation Insights

Docket Alarm provides insights to develop a more informed litigation strategy and the peace of mind of knowing you're on top of things.

Real-Time Litigation Alerts



Keep your litigation team up-to-date with **real-time alerts** and advanced team management tools built for the enterprise, all while greatly reducing PACER spend.

Our comprehensive service means we can handle Federal, State, and Administrative courts across the country.

Advanced Docket Research



With over 230 million records, Docket Alarm's cloud-native docket research platform finds what other services can't. Coverage includes Federal, State, plus PTAB, TTAB, ITC and NLRB decisions, all in one place.

Identify arguments that have been successful in the past with full text, pinpoint searching. Link to case law cited within any court document via Fastcase.

Analytics At Your Fingertips



Learn what happened the last time a particular judge, opposing counsel or company faced cases similar to yours.

Advanced out-of-the-box PTAB and TTAB analytics are always at your fingertips.

API

Docket Alarm offers a powerful API (application programming interface) to developers that want to integrate case filings into their apps.

LAW FIRMS

Build custom dashboards for your attorneys and clients with live data direct from the court.

Automate many repetitive legal tasks like conflict checks, document management, and marketing.

FINANCIAL INSTITUTIONS

Litigation and bankruptcy checks for companies and debtors.

E-DISCOVERY AND LEGAL VENDORS

Sync your system to PACER to automate legal marketing.