



US005934554A

# United States Patent [19]

[11] Patent Number: **5,934,554**

Charles et al.

[45] Date of Patent: **Aug. 10, 1999**

[54] **ROOM TEMPERATURE SENSOR AND THERMOSTAT CONTROL DEVICE**

[75] Inventors: **Donald E. Charles**, Wauconda;  
**Christopher Wojtowicz**, Mt. Prospect;  
**Kenneth F. Wolfinger**, Skokie, all of Ill.

[73] Assignee: **Siemens Building Technologies, Inc.**, Buffalo Grove, Ill.

[21] Appl. No.: **09/119,924**

[22] Filed: **Jul. 21, 1998**

4,504,922	3/1985	Johnson et al. ....	374/170 X
4,505,600	3/1985	Suzuki et al. ....	374/170 X
4,562,554	12/1985	Stixrud et al. ....	364/900
4,588,308	5/1986	Saito .....	374/181
4,607,962	8/1986	Nagao et al. ....	374/103
4,728,199	3/1988	Murai et al. ....	374/163 X
4,730,941	3/1988	Levine et al. ....	236/94 X
4,838,707	6/1989	Ozawa et al. ....	374/171
4,882,564	11/1989	Monroe et al. ....	340/449
5,085,526	2/1992	Sawtell et al. ....	374/101
5,116,136	5/1992	Newman et al. ....	374/102
5,135,045	8/1992	Moon .....	236/51 X
5,249,863	10/1993	Brown .....	374/102
5,495,722	3/1996	Manson et al. ....	236/94 X
5,682,949	11/1997	Ratcliffe et al. ....	236/51 X

### Related U.S. Application Data

[62] Division of application No. 08/684,551, Jul. 19, 1996, Pat. No. 5,816,492.

[51] Int. Cl.<sup>6</sup> ..... **F24F 3/00**; G05D 23/00

[52] U.S. Cl. .... **236/46 R**; 236/51; 165/209

[58] Field of Search ..... 236/46 R, 51, 236/47; 165/209

### FOREIGN PATENT DOCUMENTS

1277207	6/1972	United Kingdom .
2122390	1/1984	United Kingdom .

*Primary Examiner*—William Wayner  
*Attorney, Agent, or Firm*—Greer, Burns & Crain, LLP

### [57] ABSTRACT

A thermostat control having improved user controls wherein an analog version contains a binary coded switch for selectively setting a setpoint temperature. The binary coded switch is configured to have discrete positions corresponding to a plurality of setpoint temperature settings. It contains, among other things, a resistor network configured to produce a setpoint signal indicative of the binary coded switch position and a setpoint adjust switch for setting the binary coded switch position. Also, digital version having a man-machine interface port, wherein point information from a controller can be viewed and modified with the thermostat control device controls when a hardware passkey is inserted into the man-machine interface port.

### References Cited

#### U.S. PATENT DOCUMENTS

3,043,517	7/1962	Hanna .....	236/46 R
3,351,280	11/1967	Harris .....	236/46 R
4,314,666	2/1982	Schotten .....	236/78 D
4,379,520	4/1983	Tomsu .....	236/94 X
4,395,139	7/1983	Namiki et al. ....	374/183 X
4,406,550	9/1983	Gray .....	374/110
4,455,096	6/1984	Brandstedt .....	374/170
4,466,749	8/1984	Cunningham et al. ....	374/134
4,471,354	9/1984	Smith .....	128/631 X
4,475,685	10/1984	Grimado et al. ....	236/46 R
4,480,312	10/1984	Wingate .....	374/170 X

**4 Claims, 10 Drawing Sheets**

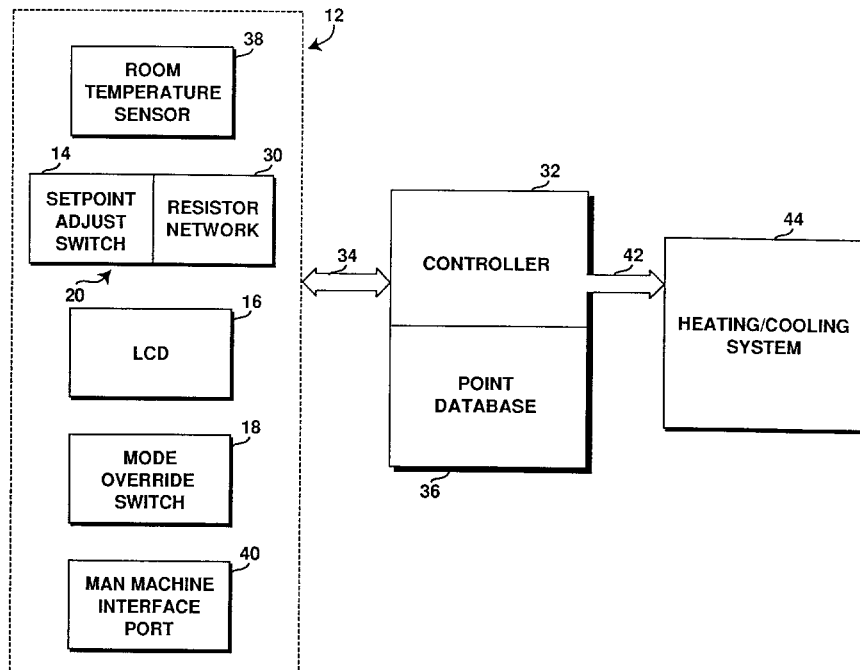

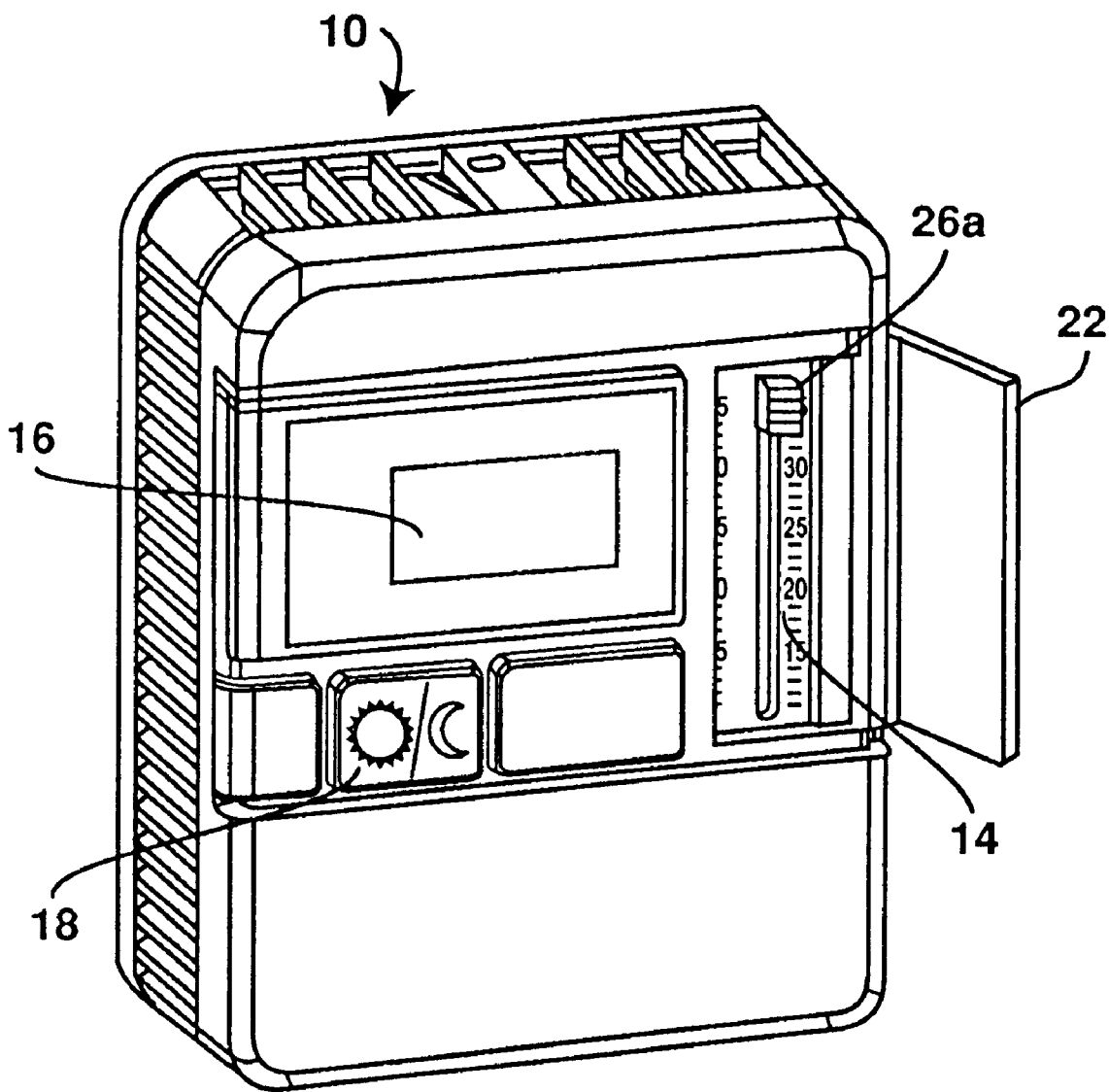

**FIGURE 1**

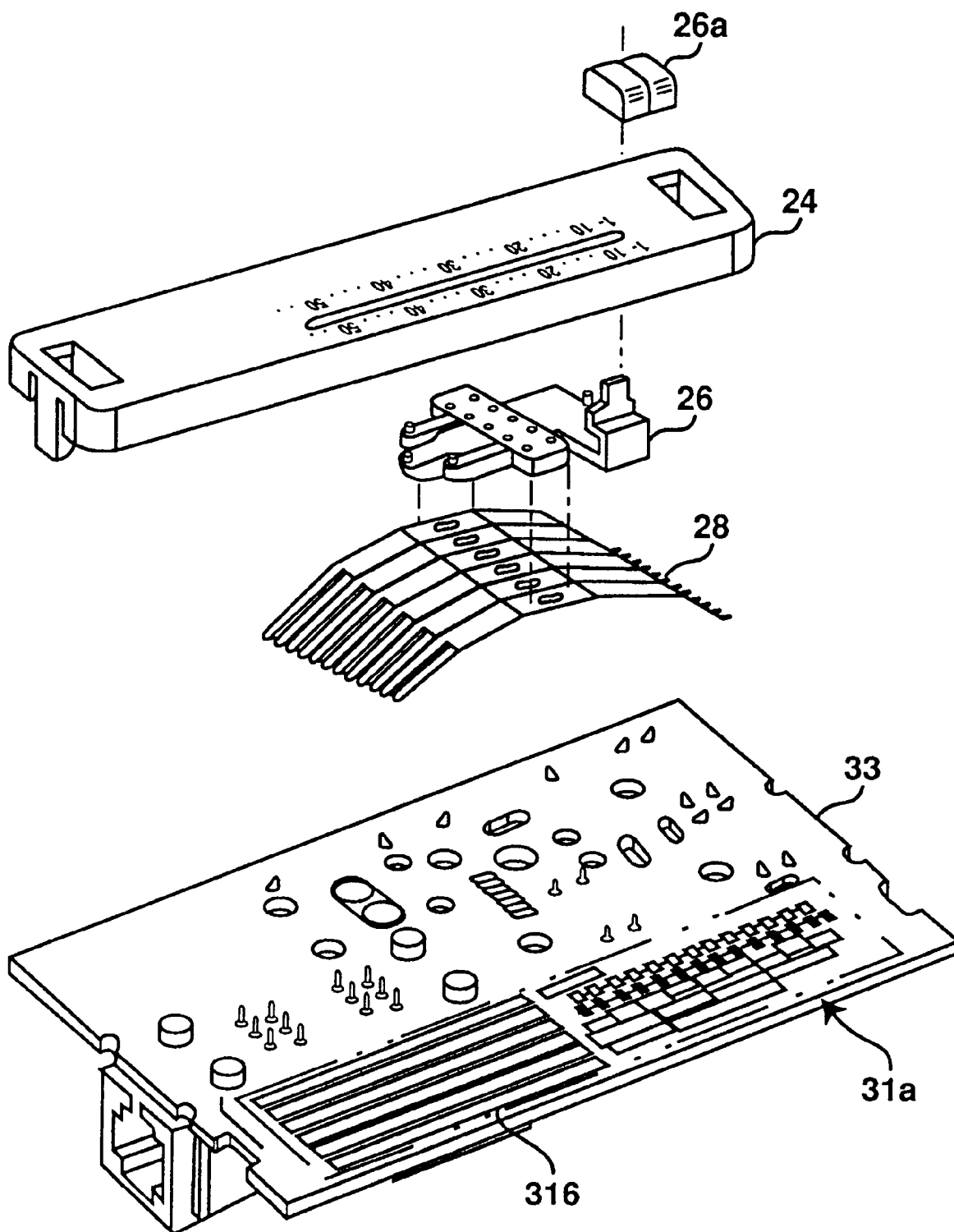

FIGURE 2

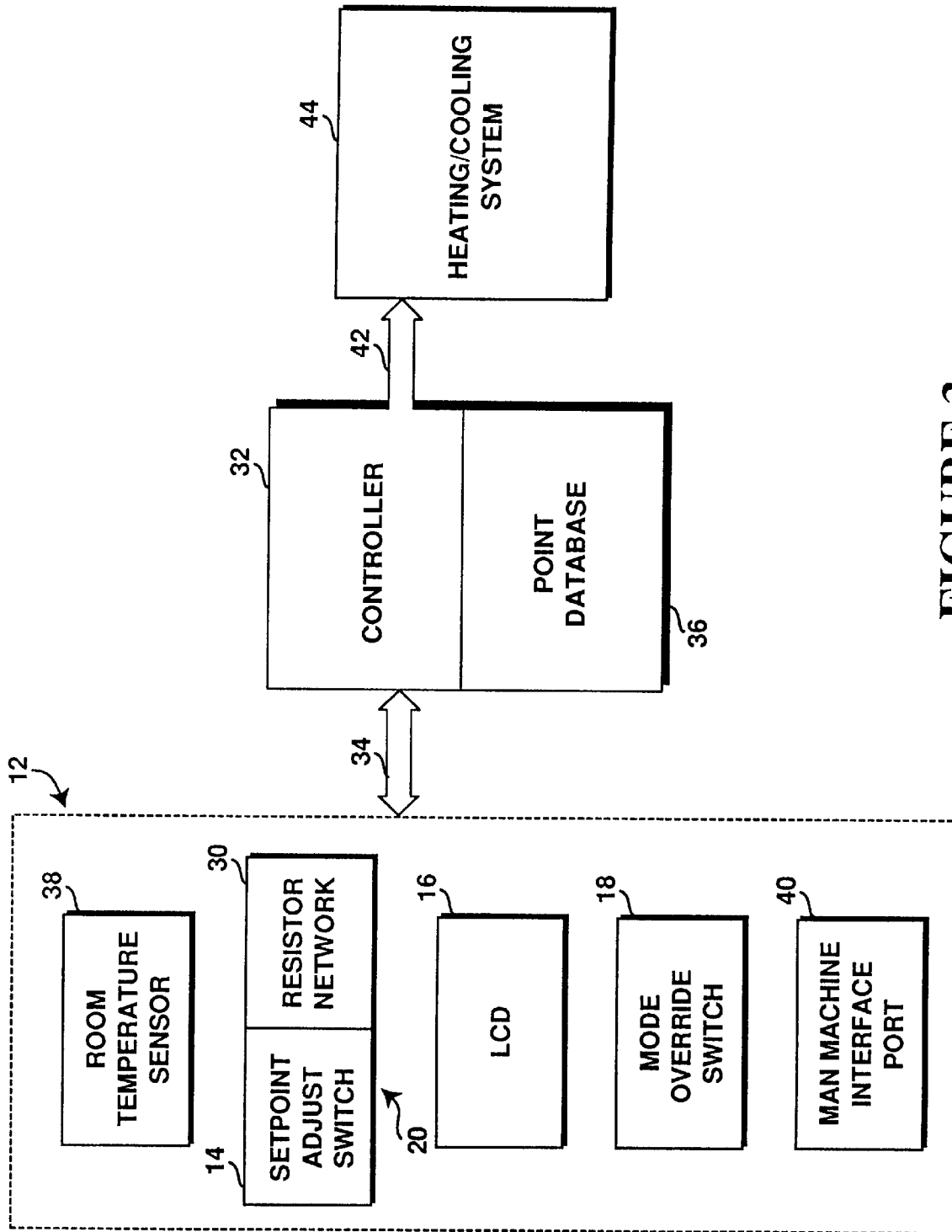
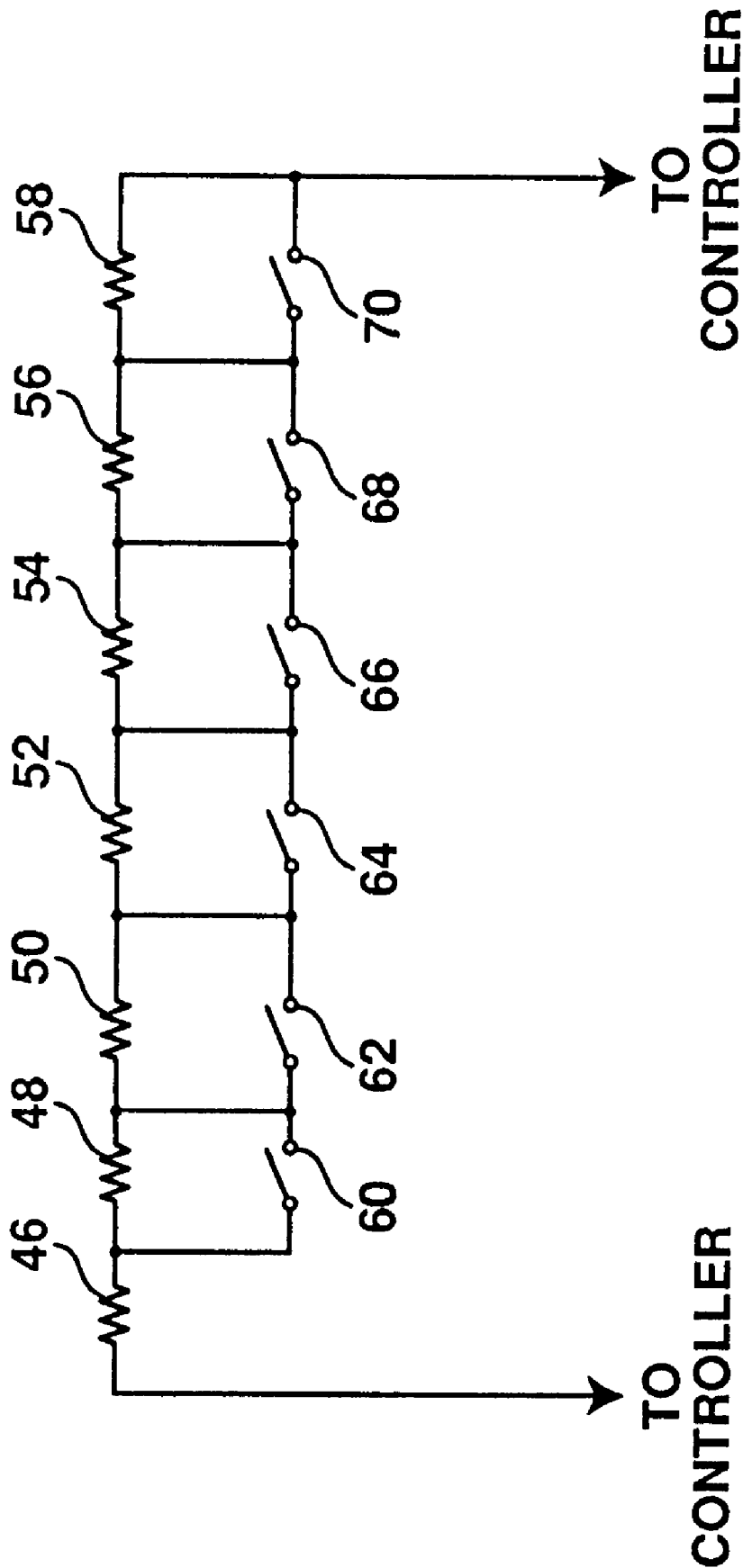

FIGURE 3



**FIGURE 4**

# Explore Litigation Insights

Docket Alarm provides insights to develop a more informed litigation strategy and the peace of mind of knowing you're on top of things.

## Real-Time Litigation Alerts



Keep your litigation team up-to-date with **real-time alerts** and advanced team management tools built for the enterprise, all while greatly reducing PACER spend.

Our comprehensive service means we can handle Federal, State, and Administrative courts across the country.

## Advanced Docket Research



With over 230 million records, Docket Alarm's cloud-native docket research platform finds what other services can't. Coverage includes Federal, State, plus PTAB, TTAB, ITC and NLRB decisions, all in one place.

Identify arguments that have been successful in the past with full text, pinpoint searching. Link to case law cited within any court document via Fastcase.

## Analytics At Your Fingertips



Learn what happened the last time a particular judge, opposing counsel or company faced cases similar to yours.

Advanced out-of-the-box PTAB and TTAB analytics are always at your fingertips.

## API

Docket Alarm offers a powerful API (application programming interface) to developers that want to integrate case filings into their apps.

## LAW FIRMS

Build custom dashboards for your attorneys and clients with live data direct from the court.

Automate many repetitive legal tasks like conflict checks, document management, and marketing.

## FINANCIAL INSTITUTIONS

Litigation and bankruptcy checks for companies and debtors.

## E-DISCOVERY AND LEGAL VENDORS

Sync your system to PACER to automate legal marketing.