



US 20050134717A1

(19) **United States**

(12) **Patent Application Publication** (10) **Pub. No.: US 2005/0134717 A1**

Misawa (43) **Pub. Date: Jun. 23, 2005**

(54) **PORTABLE DEVICE WITH CAMERA**

Publication Classification

(75) **Inventor: Atsushi Misawa, Saitama-ken (JP)**

(51) **Int. Cl.⁷ H04N 5/22**

(52) **U.S. Cl. 348/333.06**

Correspondence Address:

**BIRCH STEWART KOLASCH & BIRCH
PO BOX 747
FALLS CHURCH, VA 22040-0747 (US)**

(57) **ABSTRACT**

(73) **Assignee: Fuji Photo Film Co., Ltd., Minami-Ashigara-shi (JP)**

A portable telephone with a camera which is capable of close-up photography. A first casing body is equipped with a control portion and a second casing body is equipped with a monitor. The first and second casing bodies are openably/closeably joined by a uni-axial hinge portion. The hinge portion enables rotation of the first casing body and second casing body by more than 180°. The first casing body and second casing body can be invertedly stood on a flat surface with the hinge portion oriented upward and the control portion and the monitor facing outward.

(21) **Appl. No.: 10/992,338**

(22) **Filed: Nov. 19, 2004**

(30) **Foreign Application Priority Data**

Nov. 26, 2003 (JP) 2003-395738

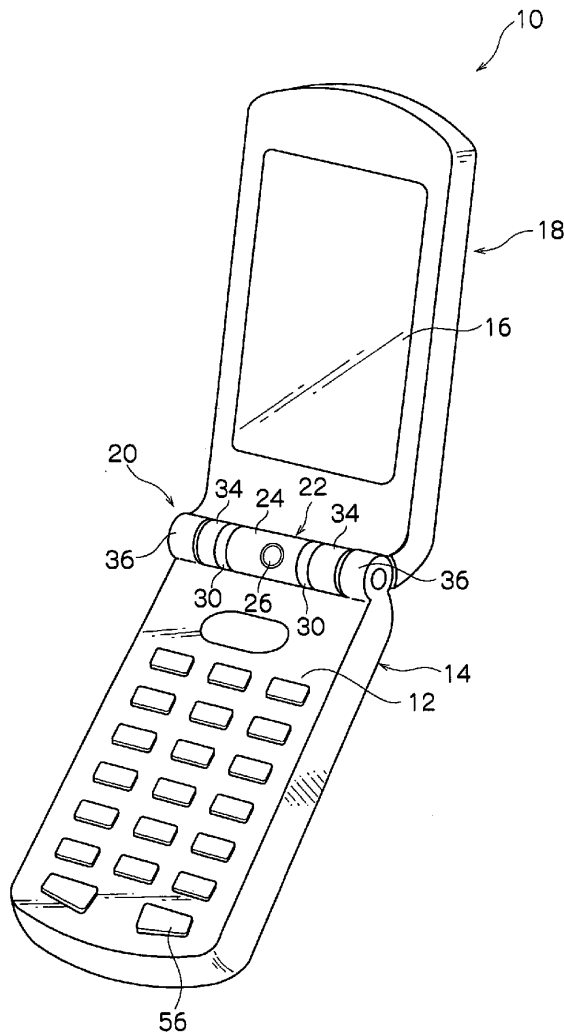

FIG. 1

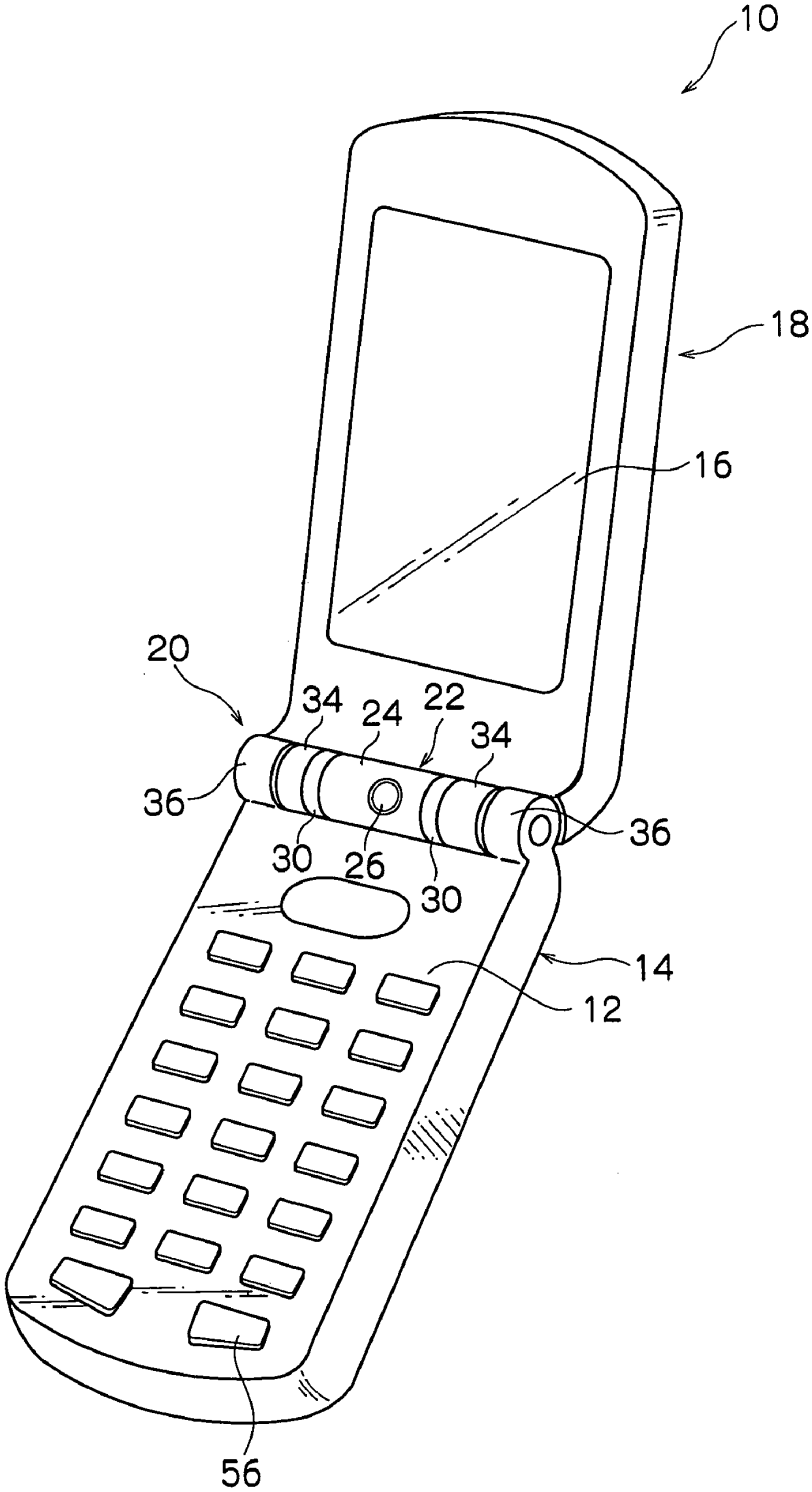

FIG.2

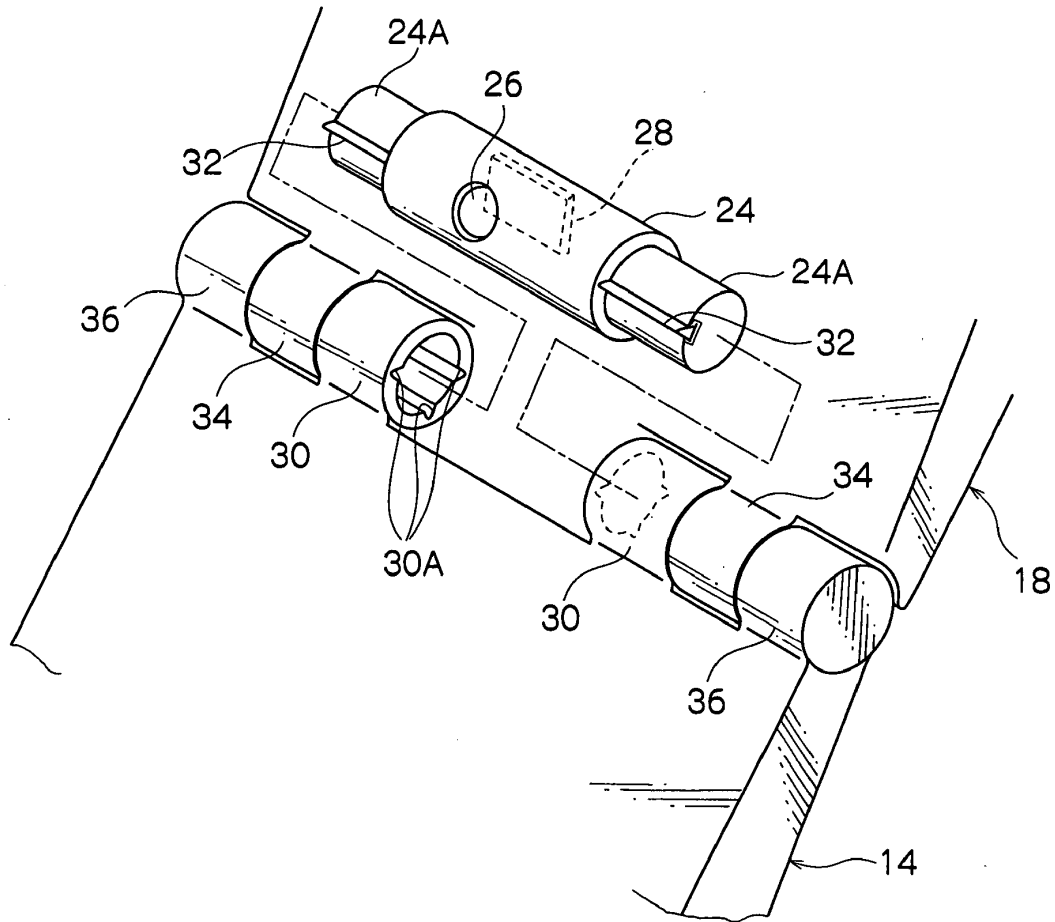

FIG.3D

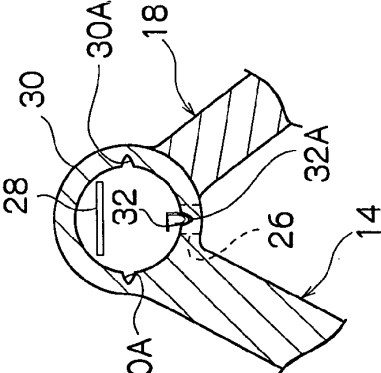

FIG.3C

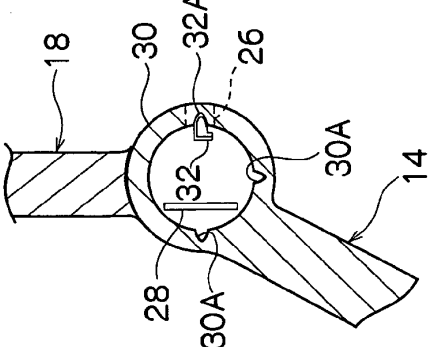

FIG.3B

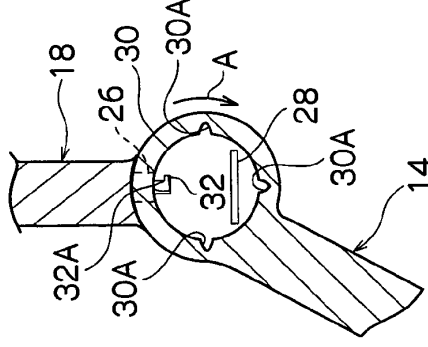
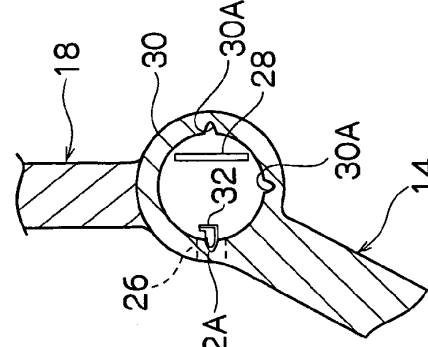
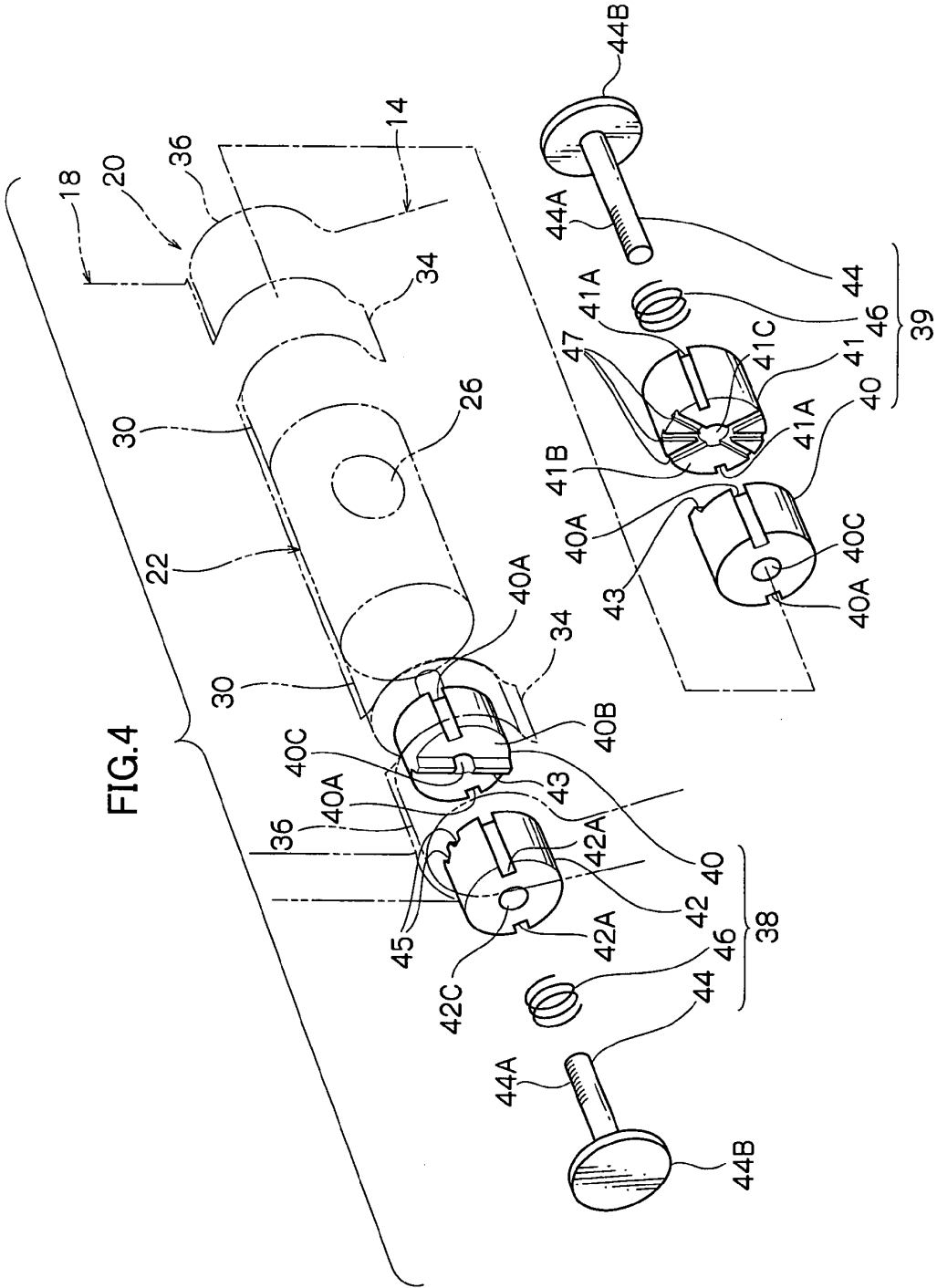

FIG.3A





Explore Litigation Insights

Docket Alarm provides insights to develop a more informed litigation strategy and the peace of mind of knowing you're on top of things.

Real-Time Litigation Alerts



Keep your litigation team up-to-date with **real-time alerts** and advanced team management tools built for the enterprise, all while greatly reducing PACER spend.

Our comprehensive service means we can handle Federal, State, and Administrative courts across the country.

Advanced Docket Research



With over 230 million records, Docket Alarm's cloud-native docket research platform finds what other services can't. Coverage includes Federal, State, plus PTAB, TTAB, ITC and NLRB decisions, all in one place.

Identify arguments that have been successful in the past with full text, pinpoint searching. Link to case law cited within any court document via Fastcase.

Analytics At Your Fingertips



Learn what happened the last time a particular judge, opposing counsel or company faced cases similar to yours.

Advanced out-of-the-box PTAB and TTAB analytics are always at your fingertips.

API

Docket Alarm offers a powerful API (application programming interface) to developers that want to integrate case filings into their apps.

LAW FIRMS

Build custom dashboards for your attorneys and clients with live data direct from the court.

Automate many repetitive legal tasks like conflict checks, document management, and marketing.

FINANCIAL INSTITUTIONS

Litigation and bankruptcy checks for companies and debtors.

E-DISCOVERY AND LEGAL VENDORS

Sync your system to PACER to automate legal marketing.