



US006918159B2

(12) **United States Patent**  
**Choi**

(10) **Patent No.:** **US 6,918,159 B2**  
(45) **Date of Patent:** **Jul. 19, 2005**

(54) **HINGE APPARATUS**

(75) Inventor: **Kang-ho Choi, Yongin (KR)**

(73) Assignee: **Samsung Electronics Co., Ltd., Suwon-si (KR)**

(\* ) Notice: Subject to any disclaimer, the term of this patent is extended or adjusted under 35 U.S.C. 154(b) by 0 days.

(21) Appl. No.: **10/223,476**

(22) Filed: **Aug. 20, 2002**

(65) **Prior Publication Data**

US 2003/0046791 A1 Mar. 13, 2003

(30) **Foreign Application Priority Data**

Sep. 11, 2001 (KR) ..... 2001-55731

(51) **Int. Cl.**<sup>7</sup> ..... **E05D 11/10**

(52) **U.S. Cl.** ..... **16/347; 16/293; 16/297; 16/321; 16/337**

(58) **Field of Search** ..... **16/293, 297, 304, 16/321, 337, 343-344, 347**

(56) **References Cited**

**U.S. PATENT DOCUMENTS**

4,620,344 A	*	11/1986	Lewis, Jr.	16/337
5,022,778 A	*	6/1991	Lu	16/273
5,028,913 A		7/1991	Kitamura	
5,075,929 A	*	12/1991	Chung	16/342
5,109,570 A	*	5/1992	Okada et al.	16/289
5,231,734 A	*	8/1993	Rude	16/342
5,771,539 A	*	6/1998	Wahlstedt et al.	16/342
5,894,633 A	*	4/1999	Kaneko	16/306
5,940,936 A	*	8/1999	Lu	16/337

5,970,580 A	*	10/1999	Katoh	16/337
6,125,507 A	*	10/2000	Katoh	16/329
6,481,057 B2	*	11/2002	Lin	16/340
6,539,582 B1	*	4/2003	Chae	16/340
6,568,034 B2	*	5/2003	Cho	16/337

**FOREIGN PATENT DOCUMENTS**

JP	06017570 A	*	1/1994	.....	E05D/11/10
WO	95/33392		12/1995		

\* cited by examiner

*Primary Examiner*—Daniel P. Stodola  
*Assistant Examiner*—Christopher Boswell  
(74) *Attorney, Agent, or Firm*—Staas & Halsey LLP

(57) **ABSTRACT**

A hinge apparatus disposes a panel to be opened and closed with respect to a body of an appliance. The hinge apparatus includes a fixing bracket fixed on the body, a supporting bracket fixed on the panel and a hinge shaft fixed on the fixing bracket to rotatably support the supporting bracket. The hinge apparatus also includes an automatic pivot unit to cause the panel to be opened with respect to the body by a predetermined free rotation angle when a locking state between the panel and the body is released. Further, the hinge apparatus includes a manual pivot unit to provide a frictional force between the supporting bracket and the hinge shaft. The frictional force restricts the supporting bracket from being automatically rotated by the automatic pivot unit and also fixes the panel, which is opened further from the predetermined free rotation angle, in a fixed position. The hinge apparatus includes a fixing pin connected to one end of the hinge shaft to restrict the hinge shaft, the supporting bracket, the automatic pivot unit and the manual pivot unit from being separated from each other.

**15 Claims, 6 Drawing Sheets**

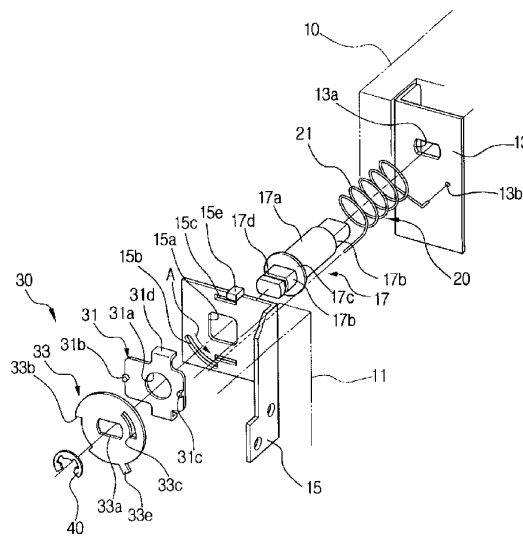

FIG. 1  
(PRIOR ART)

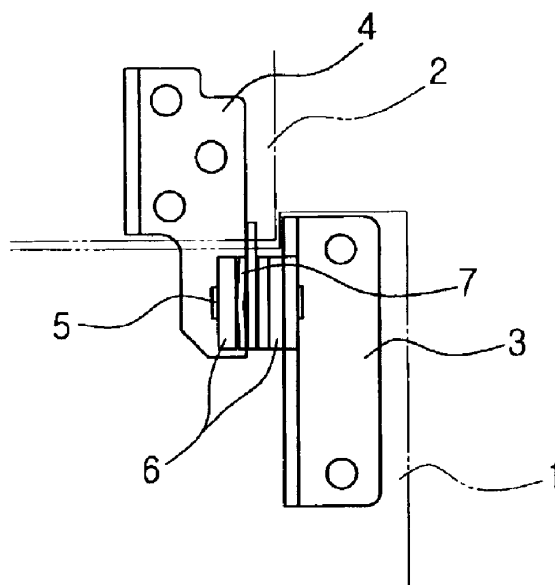



FIG. 3

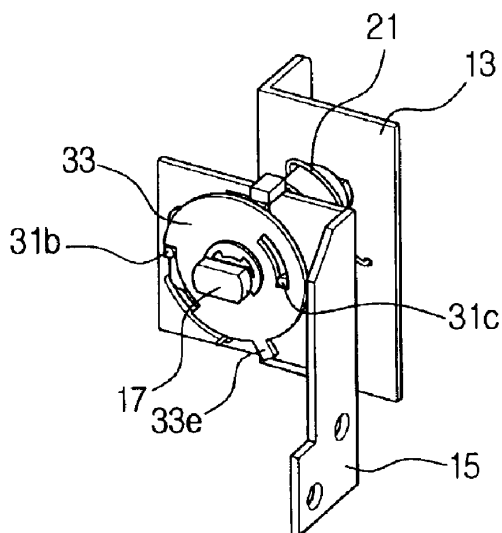

FIG. 4A

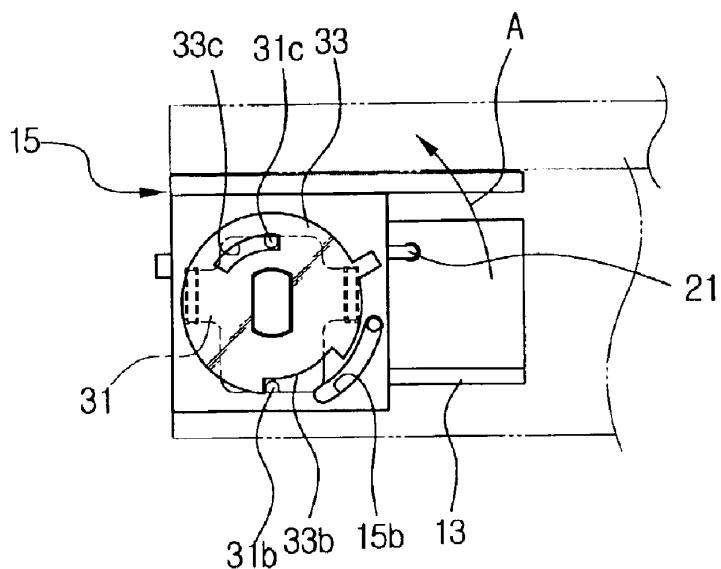

FIG. 4B

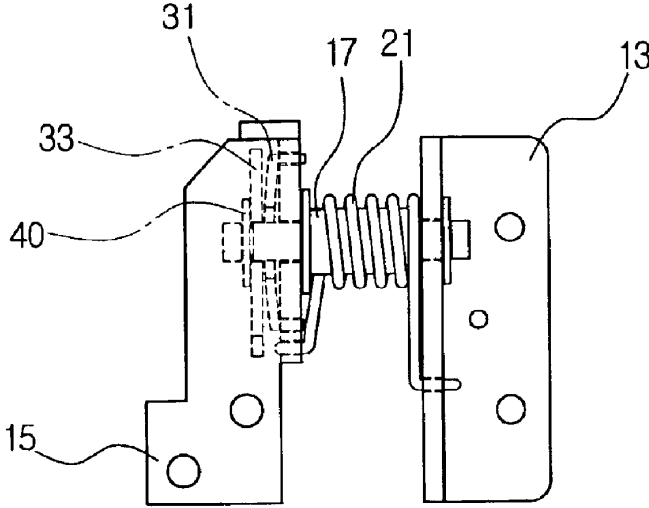
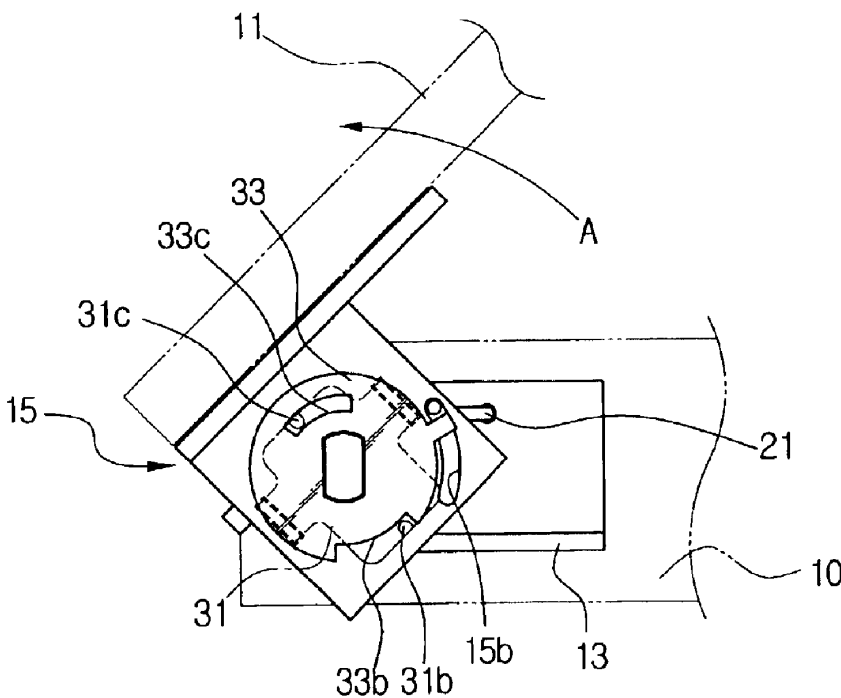

FIG. 5



# Explore Litigation Insights

Docket Alarm provides insights to develop a more informed litigation strategy and the peace of mind of knowing you're on top of things.

## Real-Time Litigation Alerts



Keep your litigation team up-to-date with **real-time alerts** and advanced team management tools built for the enterprise, all while greatly reducing PACER spend.

Our comprehensive service means we can handle Federal, State, and Administrative courts across the country.

## Advanced Docket Research



With over 230 million records, Docket Alarm's cloud-native docket research platform finds what other services can't. Coverage includes Federal, State, plus PTAB, TTAB, ITC and NLRB decisions, all in one place.

Identify arguments that have been successful in the past with full text, pinpoint searching. Link to case law cited within any court document via Fastcase.

## Analytics At Your Fingertips



Learn what happened the last time a particular judge, opposing counsel or company faced cases similar to yours.

Advanced out-of-the-box PTAB and TTAB analytics are always at your fingertips.

## API

Docket Alarm offers a powerful API (application programming interface) to developers that want to integrate case filings into their apps.

## LAW FIRMS

Build custom dashboards for your attorneys and clients with live data direct from the court.

Automate many repetitive legal tasks like conflict checks, document management, and marketing.

## FINANCIAL INSTITUTIONS

Litigation and bankruptcy checks for companies and debtors.

## E-DISCOVERY AND LEGAL VENDORS

Sync your system to PACER to automate legal marketing.