



(12) **United States Patent**
Cho

(10) **Patent No.:** **US 7,130,654 B2**
(45) **Date of Patent:** **Oct. 31, 2006**

(54) **WIRELESS HEADSET HAVING A LOCAL AREA COMMUNICATION MODULE AND BEING DETACHABLE FROM A COMMUNICATION DEVICE**

(75) Inventor: **Sung-Woo Cho, Suwon-shi (KR)**

(73) Assignee: **Samsung Electronics Co., Ltd. (KR)**

(*) Notice: Subject to any disclaimer, the term of this patent is extended or adjusted under 35 U.S.C. 154(b) by 341 days.

(21) Appl. No.: **10/753,824**

(22) Filed: **Jan. 8, 2004**

(65) **Prior Publication Data**
US 2004/0242264 A1 Dec. 2, 2004

(30) **Foreign Application Priority Data**
Jan. 9, 2003 (KR) 10-2003-0001455

(51) **Int. Cl.**
H04M 1/00 (2006.01)

(52) **U.S. Cl.** **455/550.1; 455/575.1; 455/90.3; 455/569.2; 455/347; 379/428.02**

(58) **Field of Classification Search** **455/550.1, 455/575.1-9, 403, 379, 347, 90.3, 569.2**
See application file for complete search history.

(56) **References Cited**

U.S. PATENT DOCUMENTS

5,943,627 A * 8/1999 Kim et al. 455/569.1
2002/0067825 A1* 6/2002 Baranowski et al. 379/430

* cited by examiner

Primary Examiner—Nick Corsaro

Assistant Examiner—Sayed T. Zewari

(74) *Attorney, Agent, or Firm*—Dilworth & Barrese LLP

(57) **ABSTRACT**

Disclosed is a wireless headset apparatus using a local area communication, comprising an attachment recess formed at a designated position of a communication equipment, and a wireless headset detachably attached to the attachment recess.

11 Claims, 8 Drawing Sheets

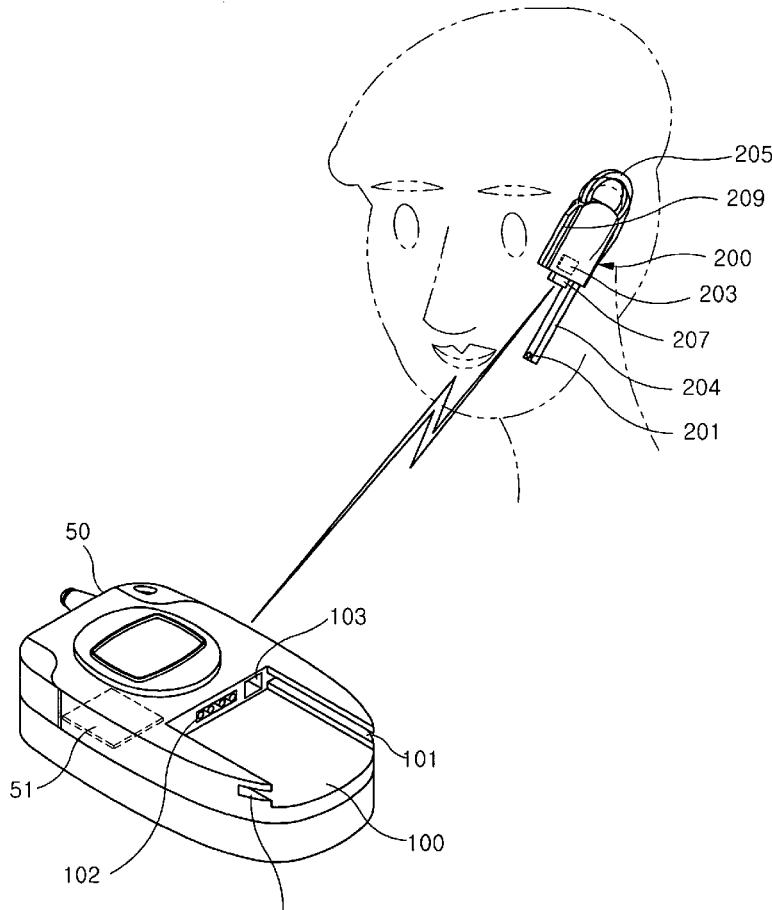

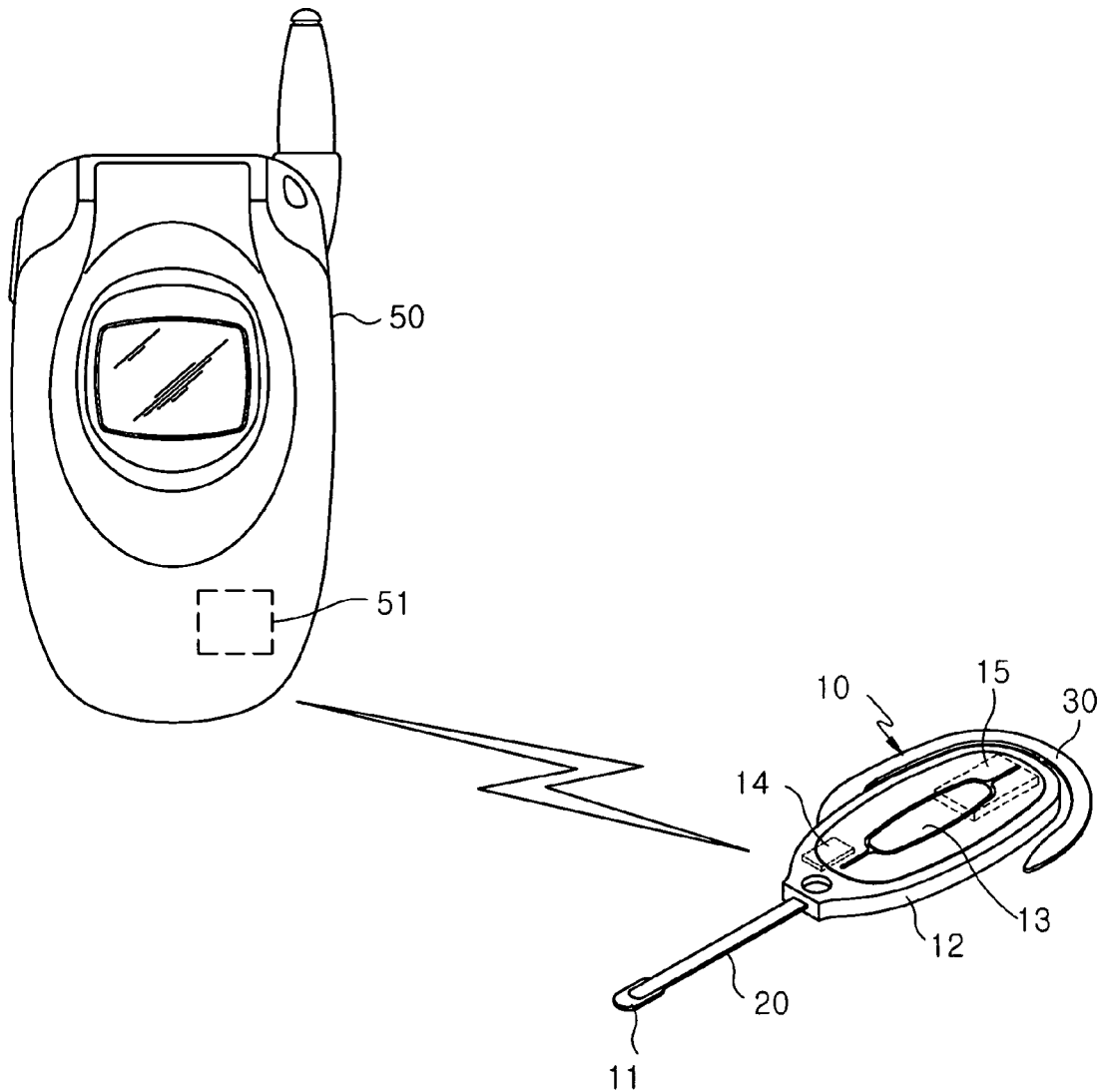

FIG. 1
(PRIOR ART)

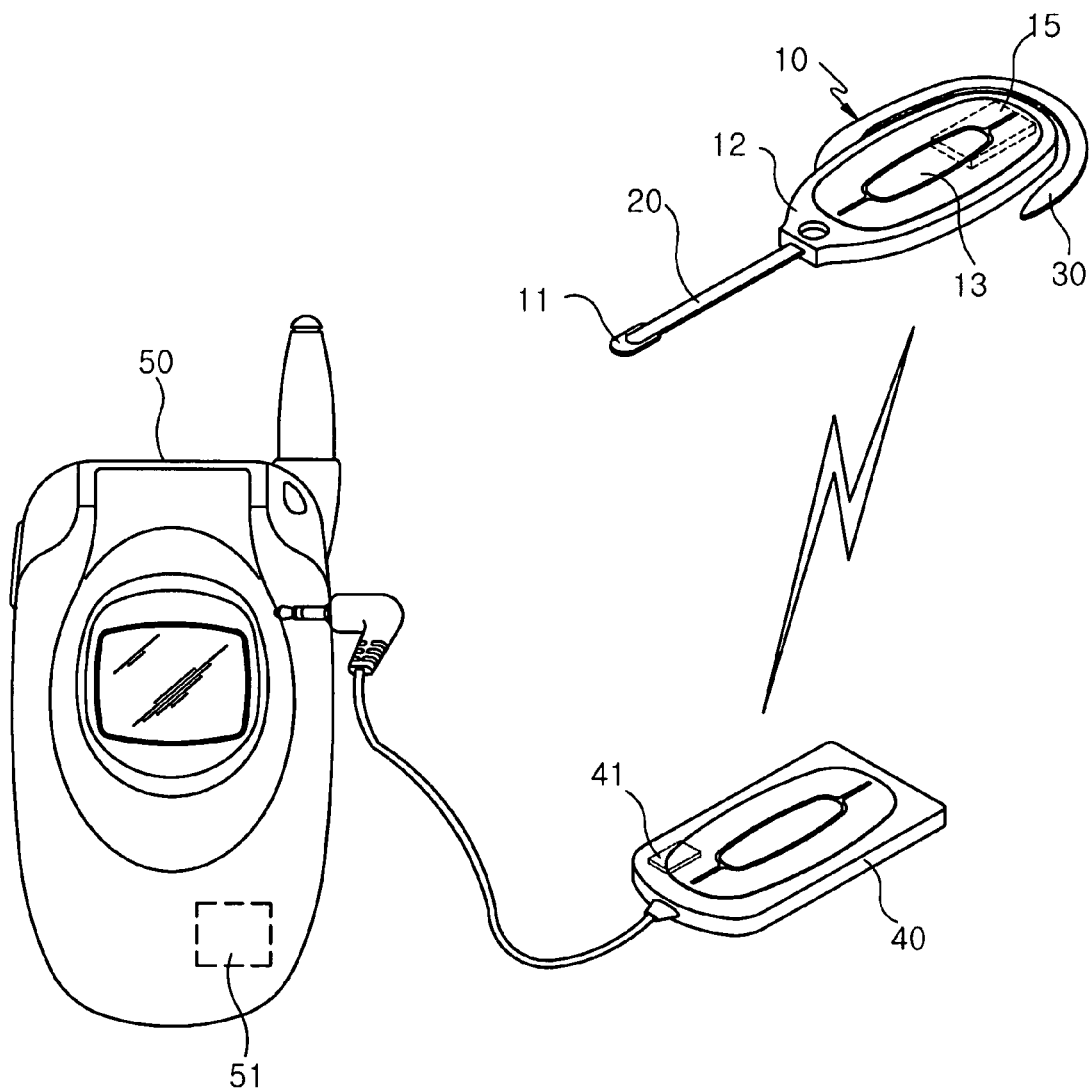

FIG. 2
(PRIOR ART)

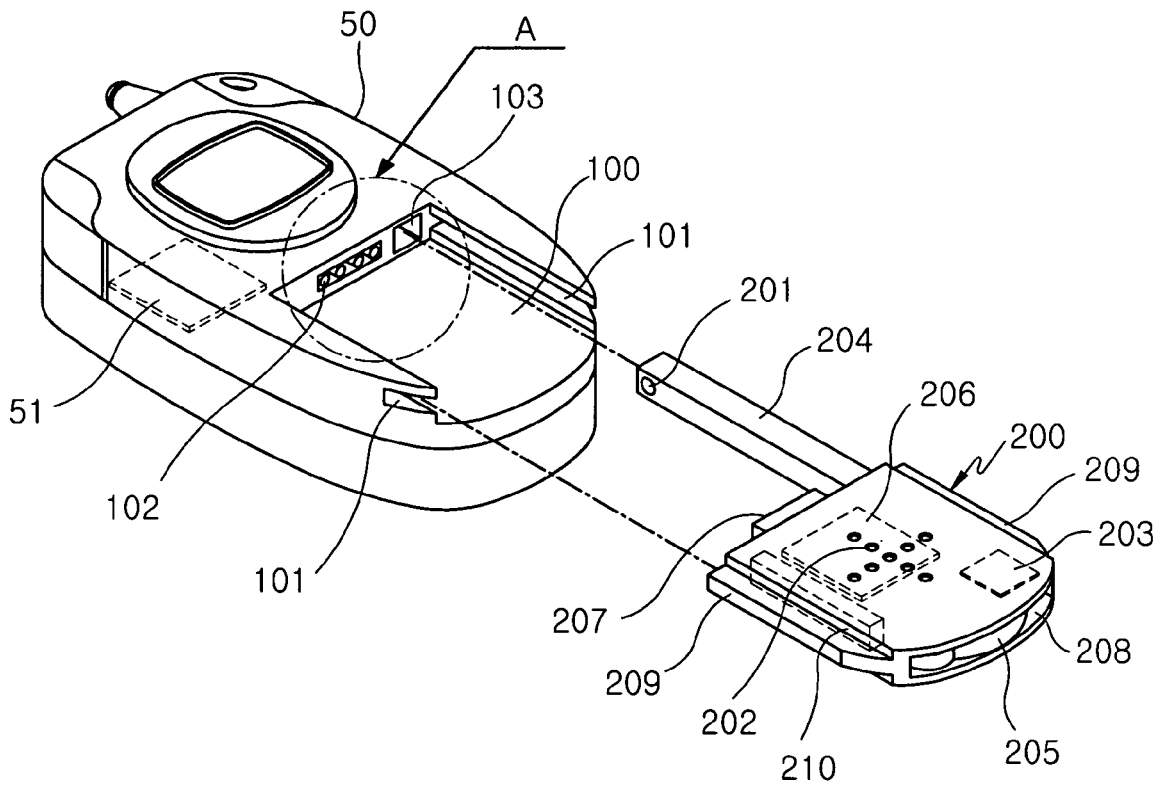

FIG. 3

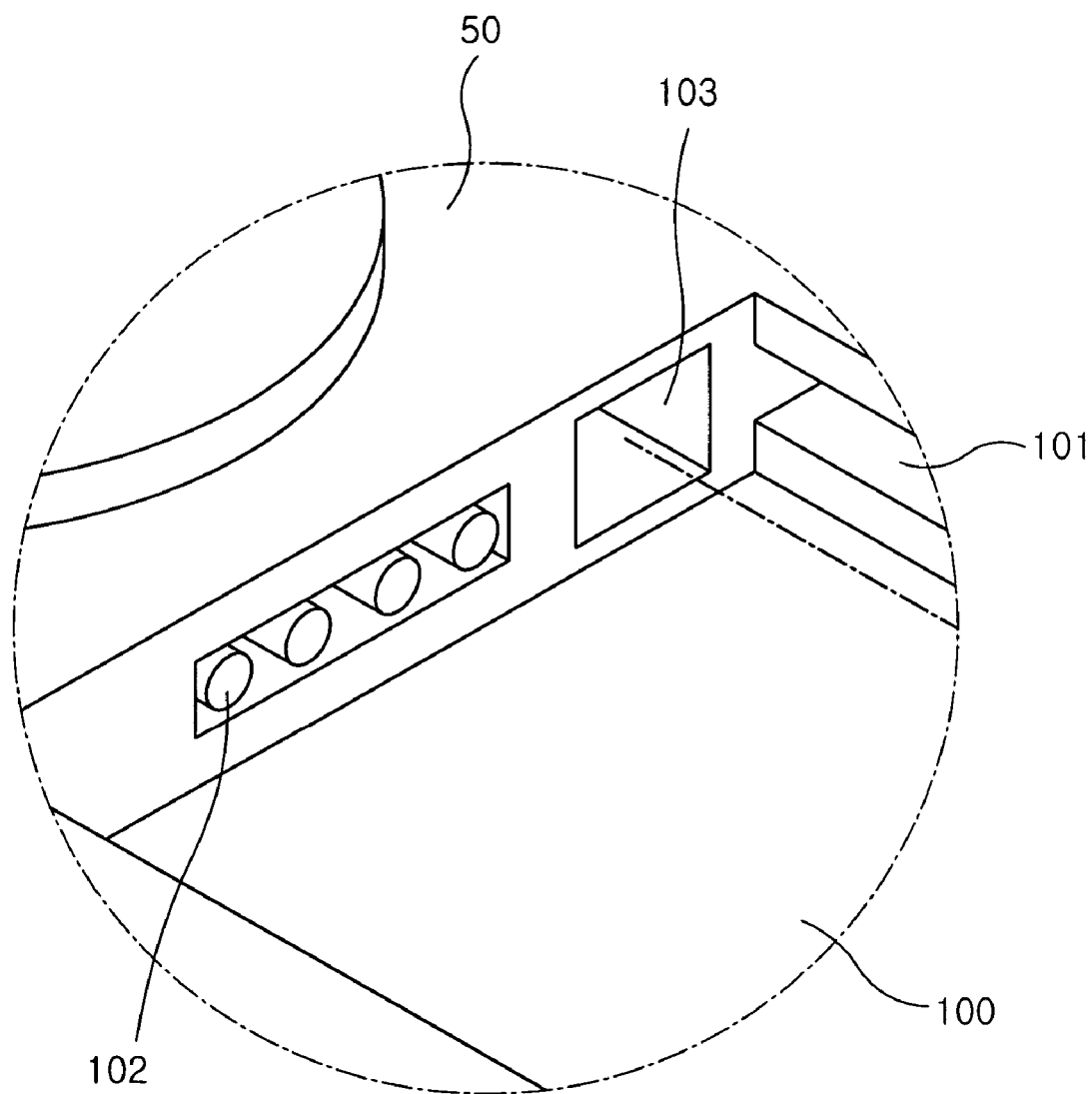

FIG. 4

Explore Litigation Insights

Docket Alarm provides insights to develop a more informed litigation strategy and the peace of mind of knowing you're on top of things.

Real-Time Litigation Alerts



Keep your litigation team up-to-date with **real-time alerts** and advanced team management tools built for the enterprise, all while greatly reducing PACER spend.

Our comprehensive service means we can handle Federal, State, and Administrative courts across the country.

Advanced Docket Research



With over 230 million records, Docket Alarm's cloud-native docket research platform finds what other services can't. Coverage includes Federal, State, plus PTAB, TTAB, ITC and NLRB decisions, all in one place.

Identify arguments that have been successful in the past with full text, pinpoint searching. Link to case law cited within any court document via Fastcase.

Analytics At Your Fingertips



Learn what happened the last time a particular judge, opposing counsel or company faced cases similar to yours.

Advanced out-of-the-box PTAB and TTAB analytics are always at your fingertips.

API

Docket Alarm offers a powerful API (application programming interface) to developers that want to integrate case filings into their apps.

LAW FIRMS

Build custom dashboards for your attorneys and clients with live data direct from the court.

Automate many repetitive legal tasks like conflict checks, document management, and marketing.

FINANCIAL INSTITUTIONS

Litigation and bankruptcy checks for companies and debtors.

E-DISCOVERY AND LEGAL VENDORS

Sync your system to PACER to automate legal marketing.