

[54] METAL OXIDE FILMS

[75] Inventors: Robert David King, Solihull; Robert Hiscutt, Birmingham, both of England

[73] Assignee: Triplex Safety Glass Company Limited, London, England

[22] Filed: Jan. 26, 1972

[21] Appl. No.: 220,899

[30] Foreign Application Priority Data

Feb. 5, 1971 United Kingdom 4234/71

[52] U.S. Cl. 204/192; 204/298; 428/432

[51] Int. Cl.² C23C 15/00

[58] Field of Search 204/192, 298; 428/432, 428/539

[56] References Cited

UNITED STATES PATENTS

3,414,503	12/1968	Brichard	204/192
3,619,402	11/1971	Wurm et al.	204/192
3,630,873	12/1971	Moore et al.	204/192
3,907,660	9/1975	Gillery	204/298

FOREIGN PATENTS OR APPLICATIONS

1,938,131	1/1971	Germany	
1,147,318	1969	United Kingdom	204/192
1,201,743	8/1970	United Kingdom	

Primary Examiner—Oscar R. Vertiz
Assistant Examiner—Wayne A. Langel
Attorney, Agent, or Firm—Sughrue, Rothwell, Mion, Zinn & Macpeak

[57] ABSTRACT

A substantially uniform, transparent, electrically conducting, metal oxide film (e.g. of indium/tin oxide) can be deposited on to a substrate such as glass of large lateral dimensions, e.g. a windscreen for an aircraft or a land vehicle, by low-pressure reactive sputtering from a cathode of the metal, using an atmosphere of oxygen and another gas or gases (preferably an inert gas) at reduced pressure, by providing access for the sputtering atmosphere to penetrate into the whole of the working space between the cathode and the substrate so as to maintain a substantial degree of uniformity in the oxygen concentration in the working space. Access for the atmosphere may be provided by means of passages extending through the cathode assembly, by dividing the cathode assembly into parallel strips separated by gaps, and the atmosphere may be supplied direct to the working space through such gaps. Relative movement is effected between the cathode assembly and the substrate, e.g. by reciprocating the parallel strips of the divided cathode in the direction perpendicular to their length.

48 Claims, 11 Drawing Figures

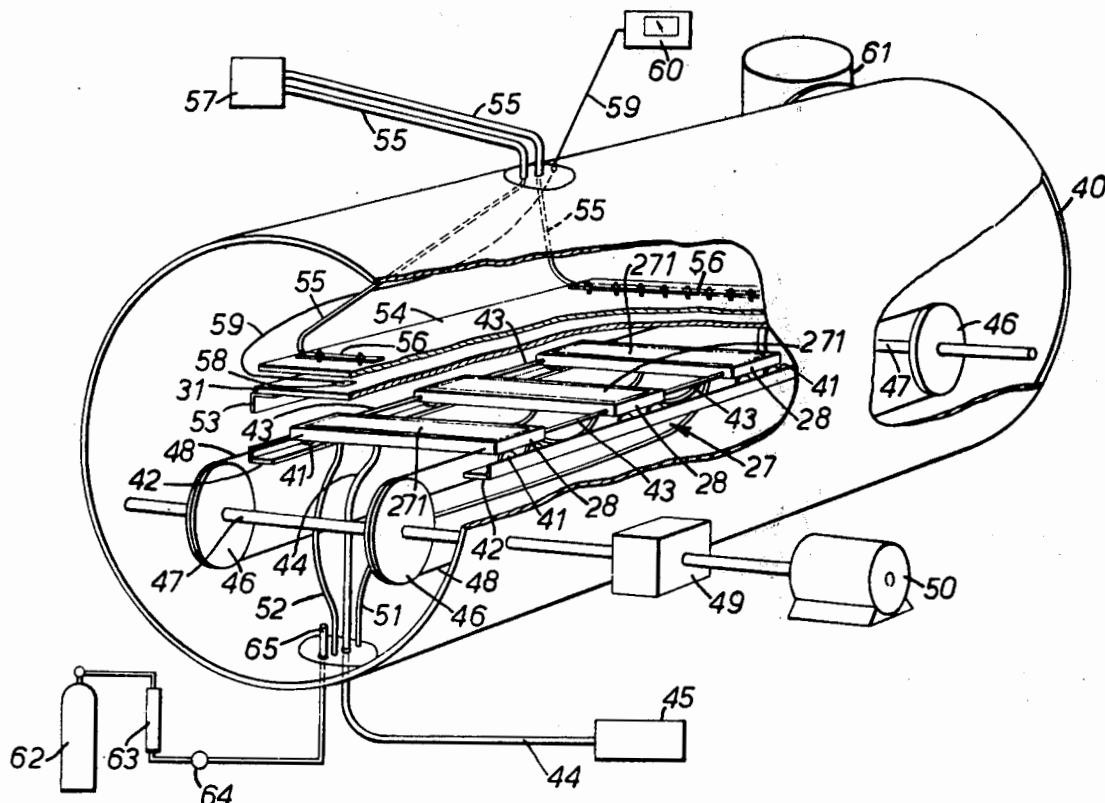

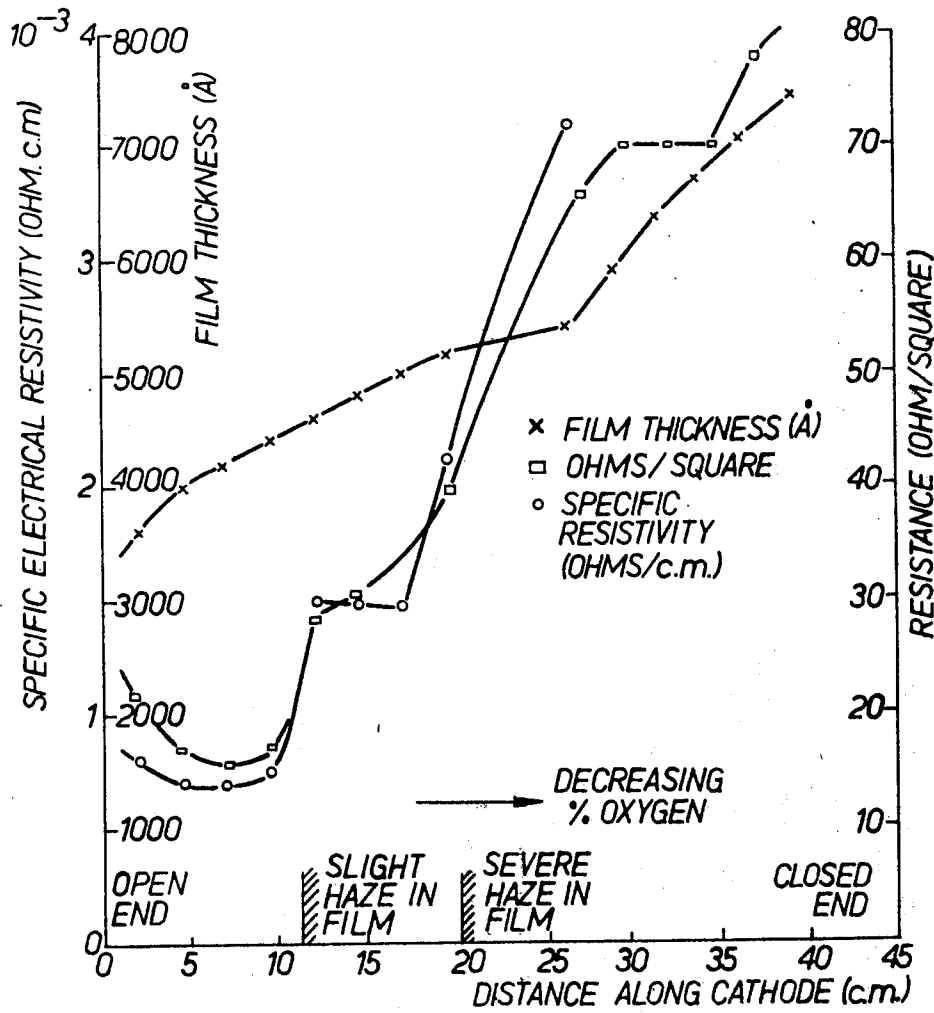

FIG. 2.

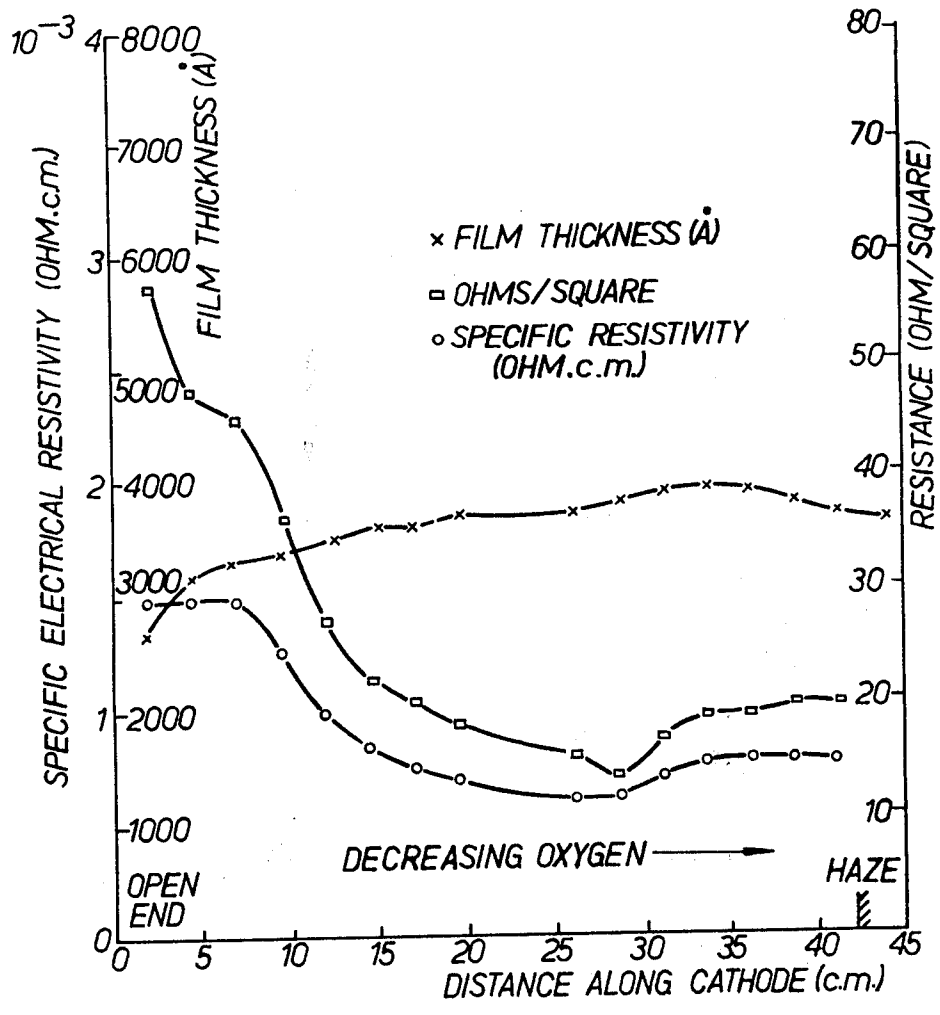

FIG. 3.

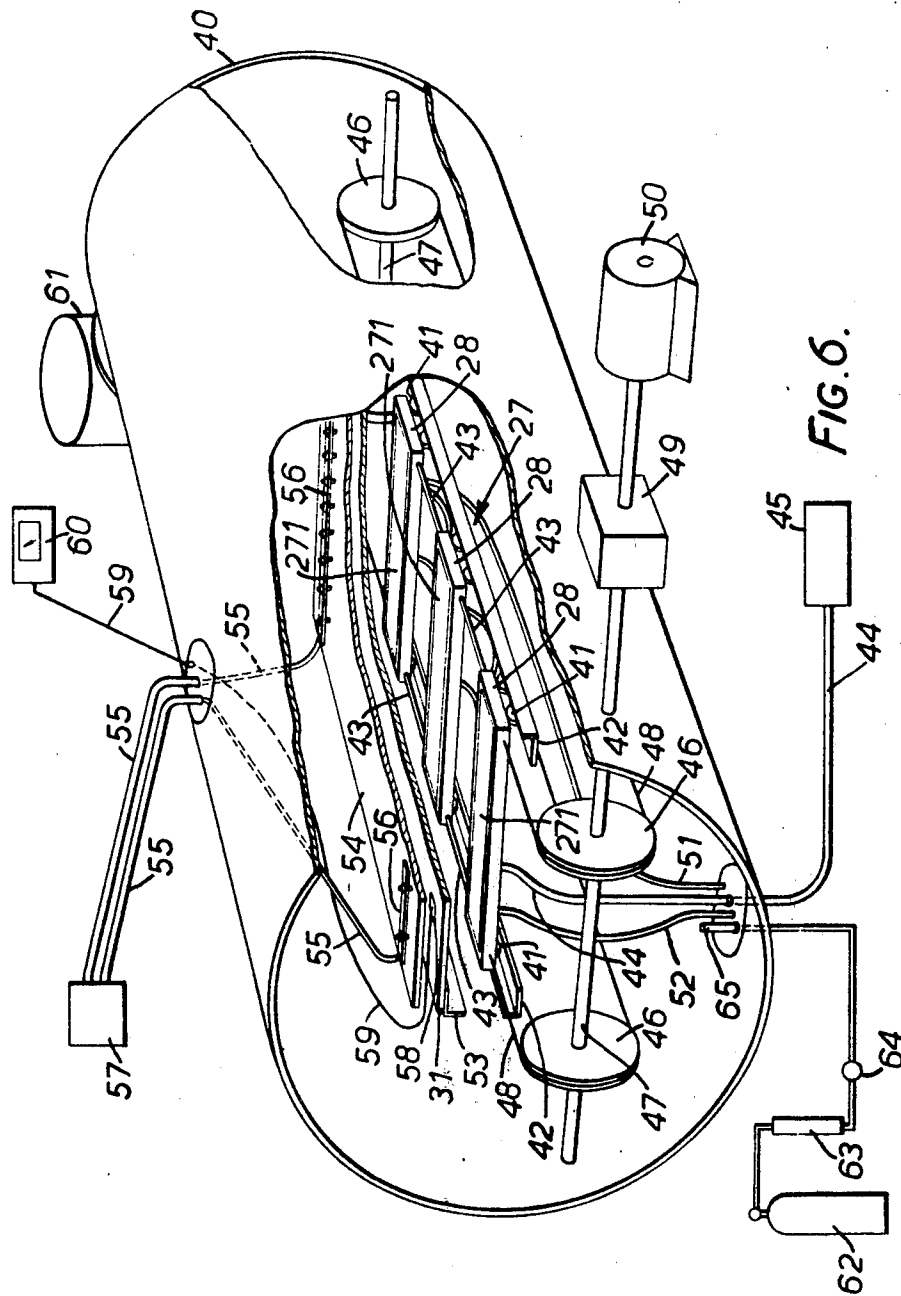

FIG. 6.

Explore Litigation Insights

Docket Alarm provides insights to develop a more informed litigation strategy and the peace of mind of knowing you're on top of things.

Real-Time Litigation Alerts



Keep your litigation team up-to-date with **real-time alerts** and advanced team management tools built for the enterprise, all while greatly reducing PACER spend.

Our comprehensive service means we can handle Federal, State, and Administrative courts across the country.

Advanced Docket Research



With over 230 million records, Docket Alarm's cloud-native docket research platform finds what other services can't. Coverage includes Federal, State, plus PTAB, TTAB, ITC and NLRB decisions, all in one place.

Identify arguments that have been successful in the past with full text, pinpoint searching. Link to case law cited within any court document via Fastcase.

Analytics At Your Fingertips



Learn what happened the last time a particular judge, opposing counsel or company faced cases similar to yours.

Advanced out-of-the-box PTAB and TTAB analytics are always at your fingertips.

API

Docket Alarm offers a powerful API (application programming interface) to developers that want to integrate case filings into their apps.

LAW FIRMS

Build custom dashboards for your attorneys and clients with live data direct from the court.

Automate many repetitive legal tasks like conflict checks, document management, and marketing.

FINANCIAL INSTITUTIONS

Litigation and bankruptcy checks for companies and debtors.

E-DISCOVERY AND LEGAL VENDORS

Sync your system to PACER to automate legal marketing.