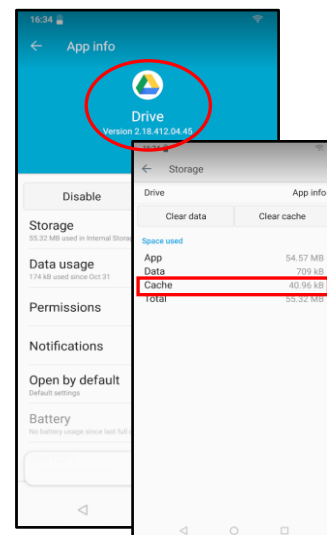
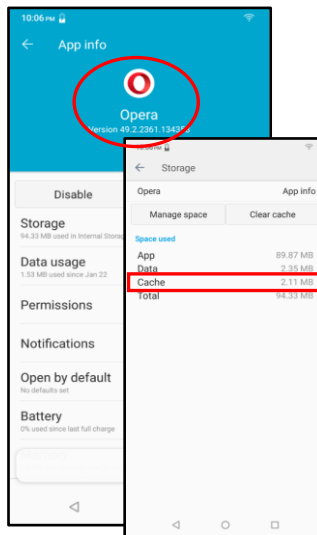

Exhibit 2021 – Claim Chart for U.S. Patent No. 10,000,000

Claim of the '254 Patent	BLU Device Access to Remote Storage
<p>1. A wireless device accessing a remote storage space, the wireless device comprising:</p>	<p>A BLU wireless device (e.g., VIVO One and VIVO XI+ smartphones, etc.)</p> 
<p>at least one cache storage for caching data received from the Internet</p>	<p>The BLU wireless device comprises at least one cache storage (e.g., “Cache”) for caching data received from the Internet</p>

Claim 1 of the '254 Patent

BLU Device Access to Remote



The BLU wireless device comprises at least one wireless interface (e.g., a W

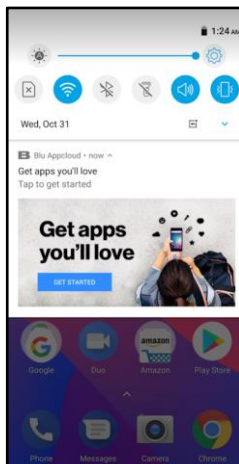

Claim 1 of the '254 Patent

one computer-readable storage device comprising program instructions which, when executed by the wireless device, configure the wireless device accessing the remote storage space, wherein the program instructions comprise:

program instructions for the wireless device establishing a communication link for accessing the remote storage space served by a first server;

program instructions for the wireless device displaying the remote storage space upon receiving information of the remote storage space from the first server; and

BLU Device Access to Remote Storage

The BLU wireless device establishes a wireless link (e.g., WiFi or cellular) to a remote storage space. The BLU wireless device displays screenshots taken on a BLU wireless device (e.g., VIVO One and VIVOXI+) showing 15 GB of storage space exclusively to a user of the BLU wireless device.

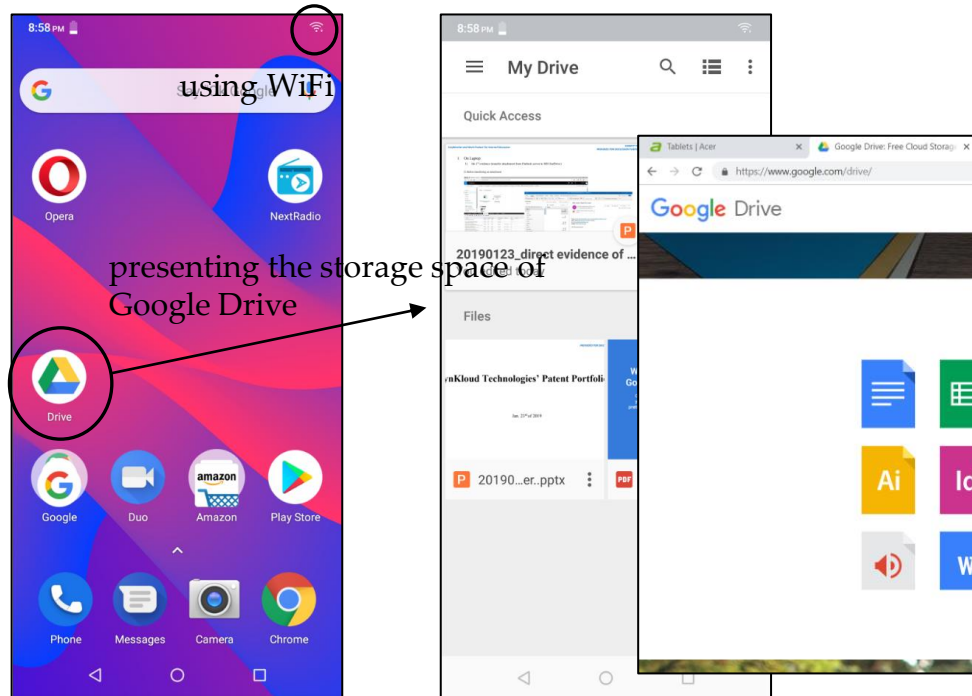

Claim 1 of the '526 Patent

BLU Device Access to Remote

program instructions for the wireless device coupling with the first server to carry out a requested operation for accessing the remote storage space in response to a user, through the remote storage space displayed on the wireless device, performing the operation,

The BLU wireless device couples with the storage server (e.g., pre-installed wireless link (e.g., WiFi or cellular) to carry out a requested operation for r assigned storage space on Google Drive) in response to the user from the E

The operation for remote access to the assigned storage space (e.g., assigne data object therein (e.g., Upload) or retrieving a data object therefrom (e.g.

Wherein the operation being carried out for accessing the remote storage space comprises from the wireless device storing data therein or retrieving data therefrom,

① retrieving data from remote storage space

② st

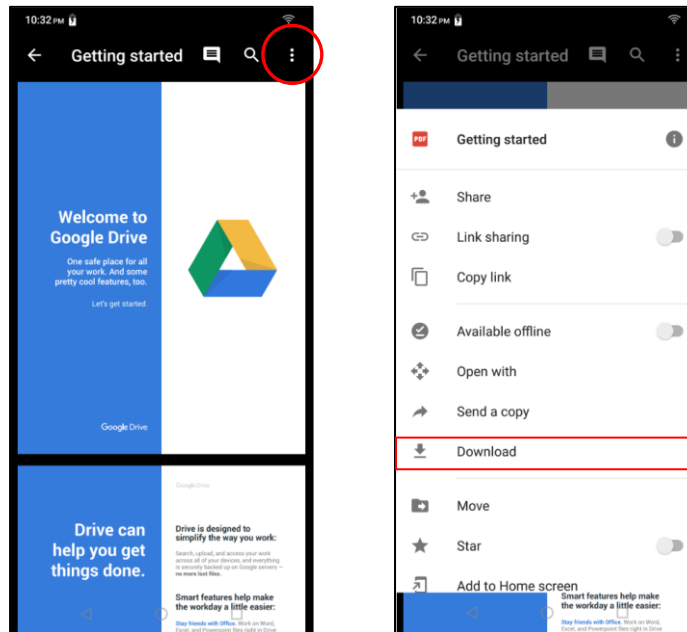

Claim 1 of the '526 Patent

the storing data comprising to download a file from a second server across a network into the remote storage space through utilizing information for the file cached in the cache storage in the wireless device.

BLU Device Access to Remote

The storing of a data object includes downloading a file (e.g., Starbucks logo) from an internet server) into the assigned storage space (e.g., assigned storage space) and the file stored in the cache storage (e.g., "Cache") in response to the user from downloading the file (e.g., Starbucks logo) from the remote server (e.g., remote server) into the assigned storage space on Google Drive).

The next few screenshots illustrate such downloading a file (e.g., downloading a news article) via the Opera browser into the user's assigned storage space on the storage device.

[1st step] access news article via preinstalled Opera app

[2nd step]

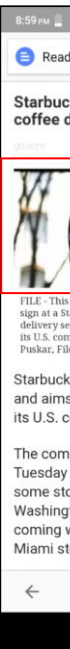
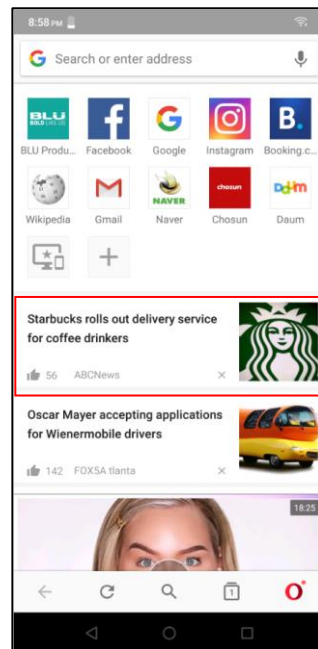

Explore Litigation Insights

Docket Alarm provides insights to develop a more informed litigation strategy and the peace of mind of knowing you're on top of things.

Real-Time Litigation Alerts



Keep your litigation team up-to-date with **real-time alerts** and advanced team management tools built for the enterprise, all while greatly reducing PACER spend.

Our comprehensive service means we can handle Federal, State, and Administrative courts across the country.

Advanced Docket Research



With over 230 million records, Docket Alarm's cloud-native docket research platform finds what other services can't. Coverage includes Federal, State, plus PTAB, TTAB, ITC and NLRB decisions, all in one place.

Identify arguments that have been successful in the past with full text, pinpoint searching. Link to case law cited within any court document via Fastcase.

Analytics At Your Fingertips



Learn what happened the last time a particular judge, opposing counsel or company faced cases similar to yours.

Advanced out-of-the-box PTAB and TTAB analytics are always at your fingertips.

API

Docket Alarm offers a powerful API (application programming interface) to developers that want to integrate case filings into their apps.

LAW FIRMS

Build custom dashboards for your attorneys and clients with live data direct from the court.

Automate many repetitive legal tasks like conflict checks, document management, and marketing.

FINANCIAL INSTITUTIONS

Litigation and bankruptcy checks for companies and debtors.

E-DISCOVERY AND LEGAL VENDORS

Sync your system to PACER to automate legal marketing.