

[54] COLLAPSIBLE CANOPY WITH TELESCOPING ROOF SUPPORT STRUCTURE

[76] Inventor: James P. Lynch, 13 South Field, Lakewood, Colo. 80226

[21] Appl. No.: 89,441

[22] Filed: Aug. 26, 1987

[51] Int. Cl.<sup>4</sup> ..... E04H 15/18; E04H 15/50

[52] U.S. Cl. .... 135/97; 135/110; 52/109

[58] Field of Search ..... 135/103, 97, 106, 98, 135/107, 108, 109, 110, 111, 112, 113; 52/109

[56] References Cited

U.S. PATENT DOCUMENTS

684,130	10/1901	Taubert	135/110
1,326,006	12/1919	Sterhardt	135/109
1,493,915	5/1924	Baker	135/109
1,712,836	5/1929	Mills	135/110
1,728,356	9/1929	Morgan	135/109
1,853,367	4/1932	Mace	135/110
2,135,961	11/1938	Chemoweth	135/109
2,440,557	4/1948	Power	135/90
2,770,243	11/1956	Miller	135/109
2,928,404	3/1960	Klages	135/109
3,174,397	3/1965	Sandborn	52/109
3,199,518	8/1965	Glidewell	135/109
3,335,815	8/1967	Oakes	52/109
3,375,625	4/1968	Mikulin	52/109
3,496,687	2/1970	Greenberg et al.	52/109
3,526,066	9/1970	Hagar et al.	52/27
4,156,433	5/1979	Beaulieu	52/109
4,607,656	8/1986	Carter	135/110
4,641,676	2/1987	Lynch	135/110

FOREIGN PATENT DOCUMENTS

15851 of 1886 United Kingdom ..... 135/111

656361 8/1951 United Kingdom ..... 135/97

Primary Examiner—J. Karl Bell

Attorney, Agent, or Firm—Timothy J. Martin; J. Preston Oxenham

[57] ABSTRACT

A canopy structure is provided and includes a framework unit and a flexible covering. The framework unit is formed by a plurality of upright corner members and a plurality of roof support members that are pivotally connected at the top ends of the corner members and, in an erected position, extend upwardly and inwardly to a central apex where they are pivotally connected to one another. The roof support members are formed of extendable sections which preferably telescope with respect to one another so that the framework unit may move into a collapsed state with the corner support and roof support members oriented in closely spaced, parallel relation. Latches are provided to prevent the framework unit from collapsing from the erected position. Constraining and support structure, preferably in the form of scissor assemblies, interconnect adjacent corner support members to prevent them from moving apart past the erect state. The scissor assemblies have one portion pivotally connected to the tops of its associated corner supports and another portion pivotally connected to slide brackets on its associated corner support member. A cantilever member interconnects each roof support member and the slide bracket on its associated corner support member. The central apex may include a spring biased central post to support the peak of the covering placed on the framework unit. Several framework units may be formed together into a larger canopy structure.

34 Claims, 4 Drawing Sheets

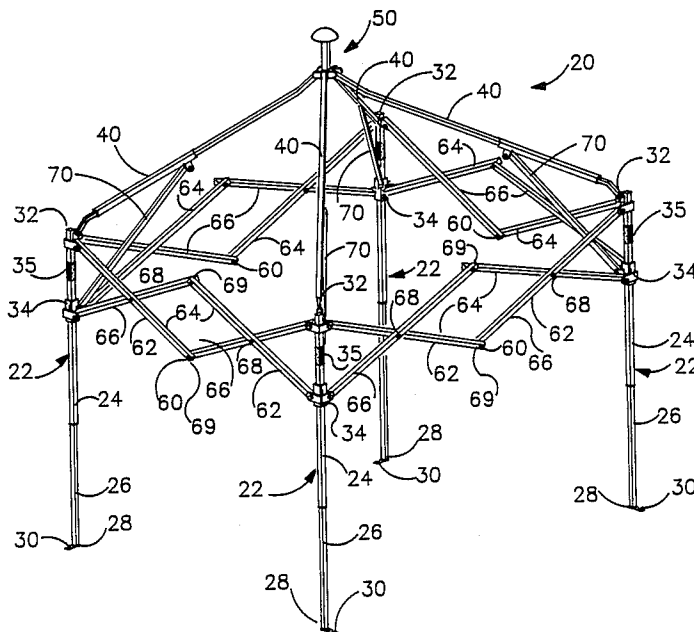

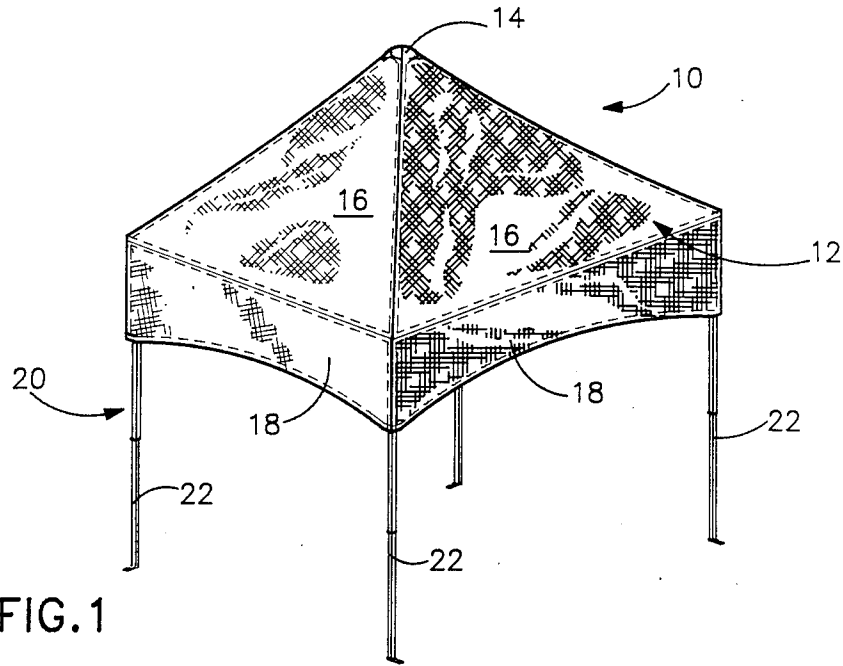

FIG. 1

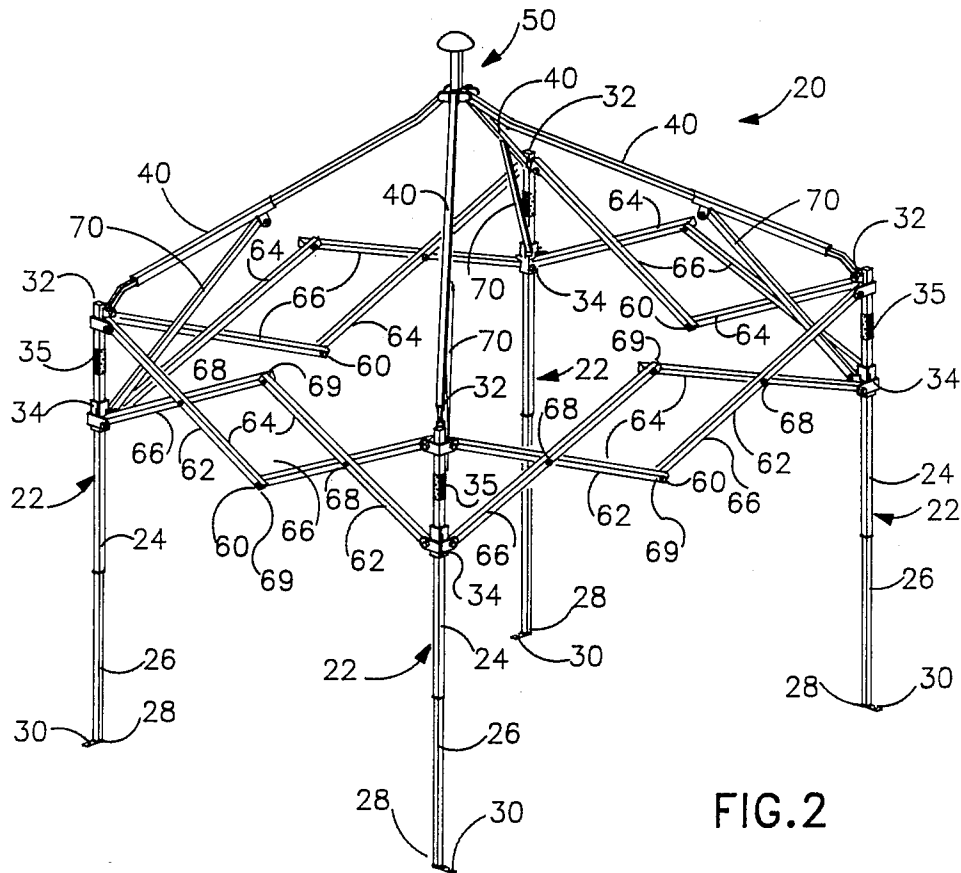
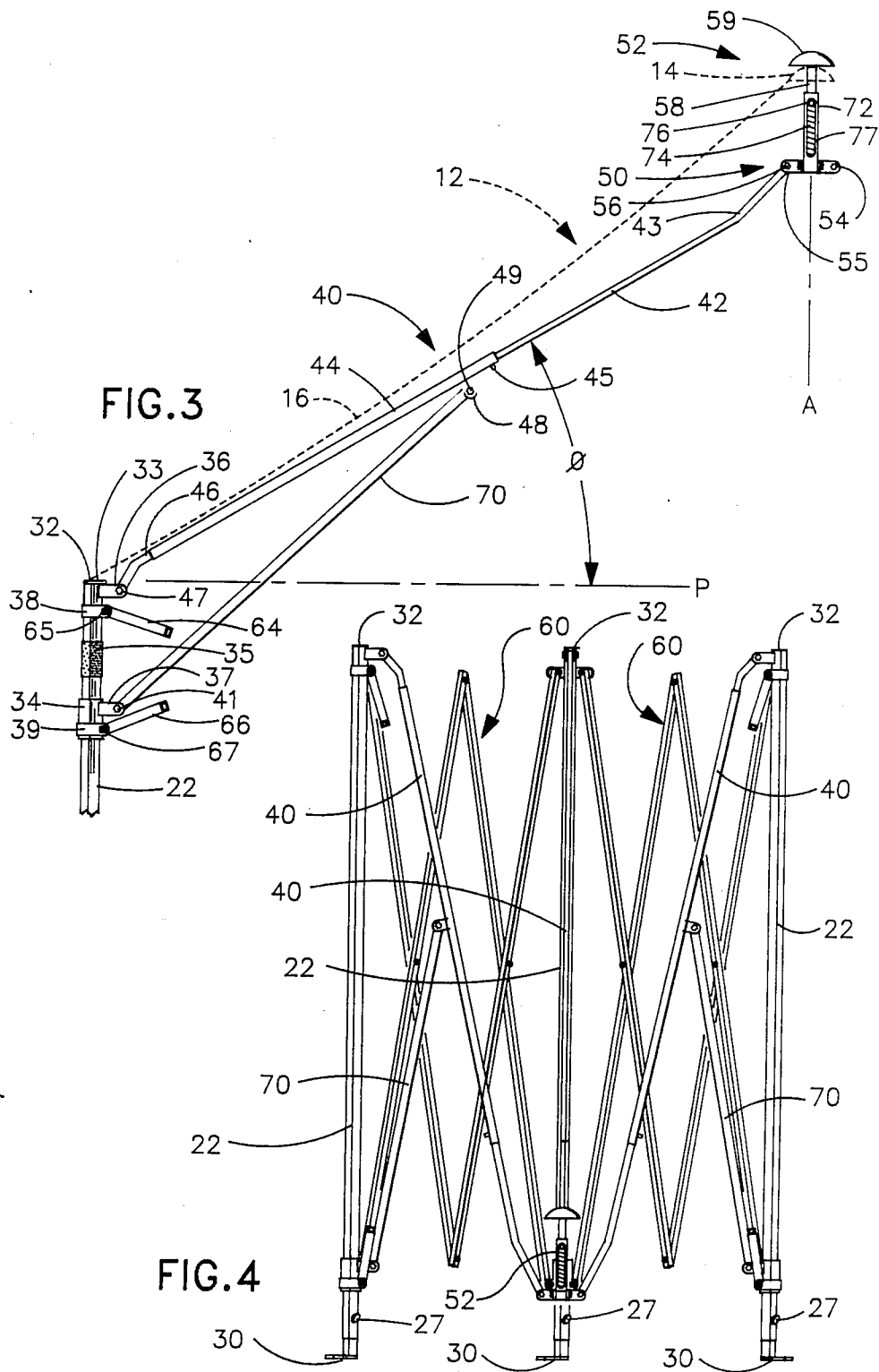

FIG. 2



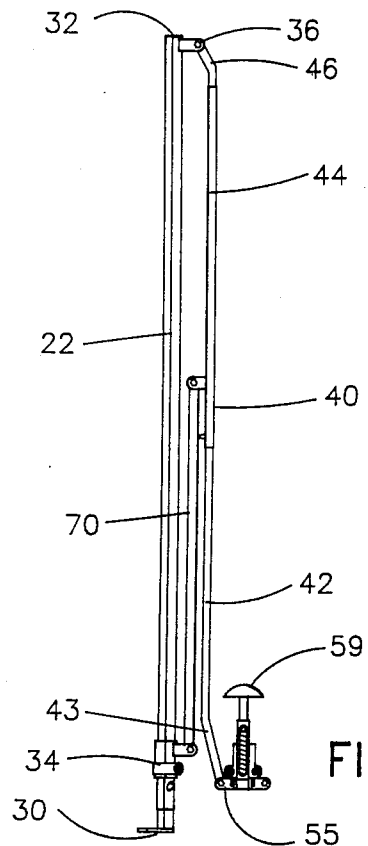

FIG. 5

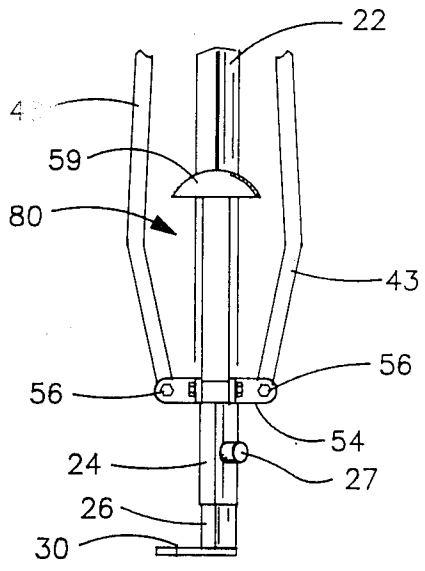

FIG. 6

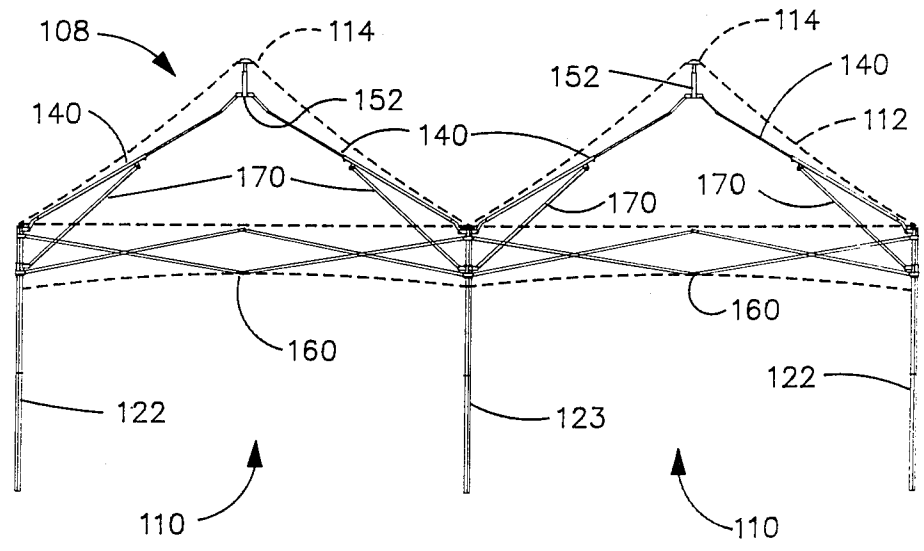
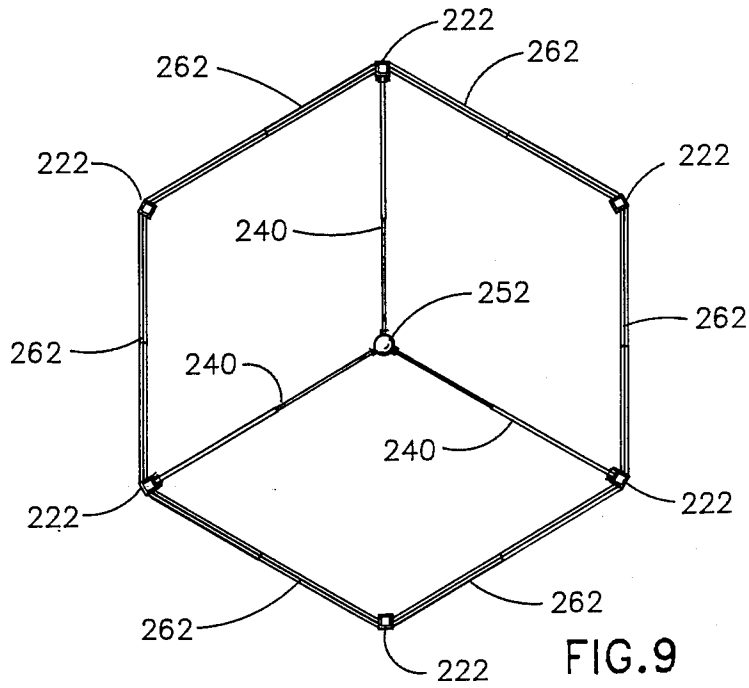
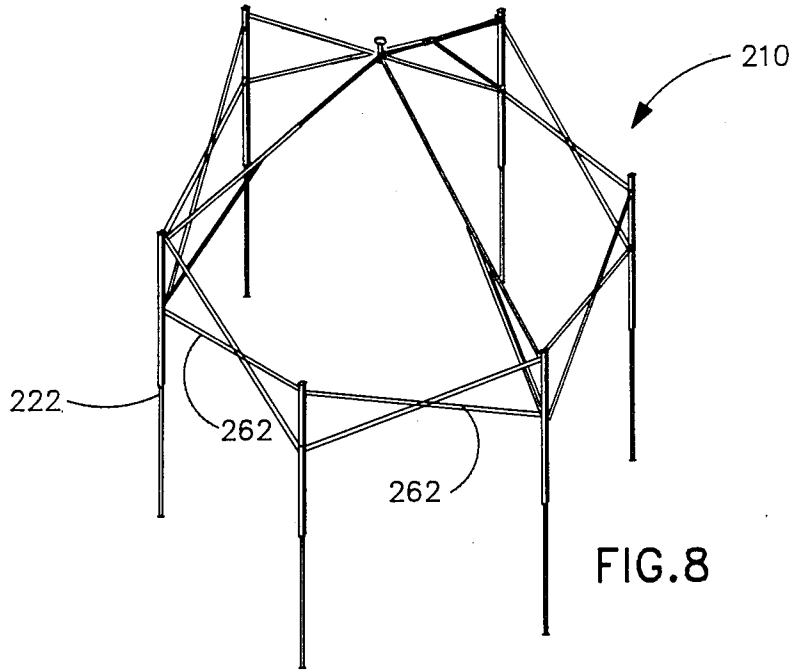

FIG. 7



# Explore Litigation Insights

Docket Alarm provides insights to develop a more informed litigation strategy and the peace of mind of knowing you're on top of things.

## Real-Time Litigation Alerts



Keep your litigation team up-to-date with **real-time alerts** and advanced team management tools built for the enterprise, all while greatly reducing PACER spend.

Our comprehensive service means we can handle Federal, State, and Administrative courts across the country.

## Advanced Docket Research



With over 230 million records, Docket Alarm's cloud-native docket research platform finds what other services can't. Coverage includes Federal, State, plus PTAB, TTAB, ITC and NLRB decisions, all in one place.

Identify arguments that have been successful in the past with full text, pinpoint searching. Link to case law cited within any court document via Fastcase.

## Analytics At Your Fingertips



Learn what happened the last time a particular judge, opposing counsel or company faced cases similar to yours.

Advanced out-of-the-box PTAB and TTAB analytics are always at your fingertips.

## API

Docket Alarm offers a powerful API (application programming interface) to developers that want to integrate case filings into their apps.

## LAW FIRMS

Build custom dashboards for your attorneys and clients with live data direct from the court.

Automate many repetitive legal tasks like conflict checks, document management, and marketing.

## FINANCIAL INSTITUTIONS

Litigation and bankruptcy checks for companies and debtors.

## E-DISCOVERY AND LEGAL VENDORS

Sync your system to PACER to automate legal marketing.