



US005209051A

United States Patent [19]
Langdon

[11] **Patent Number:** **5,209,051**
[45] **Date of Patent:** **May 11, 1993**

[54] **LAWN MOWERS INCLUDING PUSH HANDLES**

[76] **Inventor:** Christopher D. Langdon, P.O. Box 904, Tryon, N.C. 28782

[21] **Appl. No.:** 872,065

[22] **Filed:** Apr. 22, 1992

Related U.S. Application Data

[63] Continuation-in-part of Ser. No. 666,573, Mar. 8, 1991, Pat. No. 5,136,830.

[51] **Int. Cl.⁵** **A01D 34/68**

[52] **U.S. Cl.** **56/16.7; 56/320.1; 56/DIG. 18; 16/111 A**

[58] **Field of Search** **56/16.7, 320.1, 320.2, 56/DIG. 9, DIG. 18, DIG. 20, DIG. 24; 294/15, 26; 16/110 R, 111 A, 111 R; 280/655.1**

[56] **References Cited**

U.S. PATENT DOCUMENTS

3,204,272	9/1965	Greene et al.	16/111 A X
3,423,103	1/1969	Maltarp	16/111 A X
3,462,924	8/1969	Price et al.	56/320.1
3,534,432	10/1970	Davies, III et al.	16/111 A
3,855,763	12/1974	Seifert et al.	280/655.1 X

FOREIGN PATENT DOCUMENTS

2063635 6/1981 United Kingdom 56/DIG. 18

Primary Examiner—Terry Lee Melius
Attorney, Agent, or Firm—John K. Donaghy

[57] **ABSTRACT**

A rotary lawn mower adapted to be moved over a surface to mow vegetation; said lawn mower includes a mower deck, a motor, rotary cutting means and a push handle assembly; said mower deck including a top portion adapted to support said motor and downwardly extending edge portions; said motor being affixed to the central portion of said mower deck and coupled to drive said rotary cutter means positioned underneath said mower deck substantially parallel to said surface, said push handle assembly having telescoping or pivotal members and being pivotally attached to the deck such that the push handles may be folded over said motor and attached to said mower deck forward of the motor thus permitting a user of said mower to selectively grasp said push handle assembly to lift and move said rotary mower from one location to another.

7 Claims, 5 Drawing Sheets

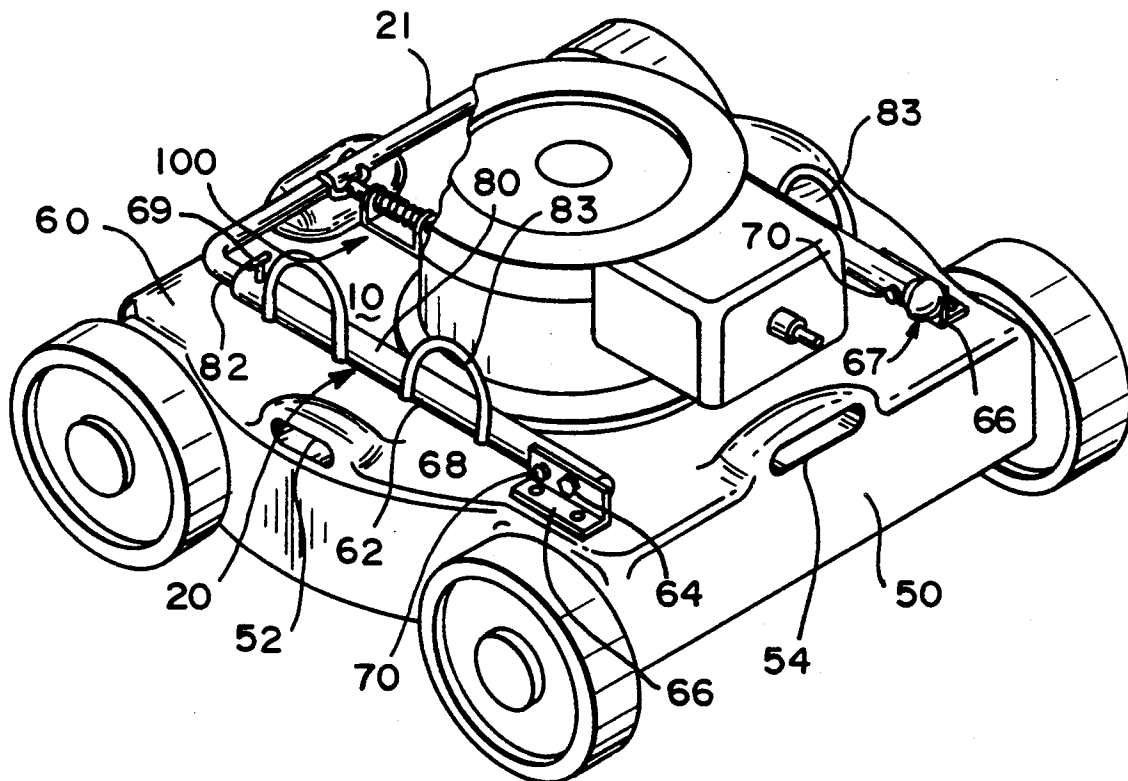

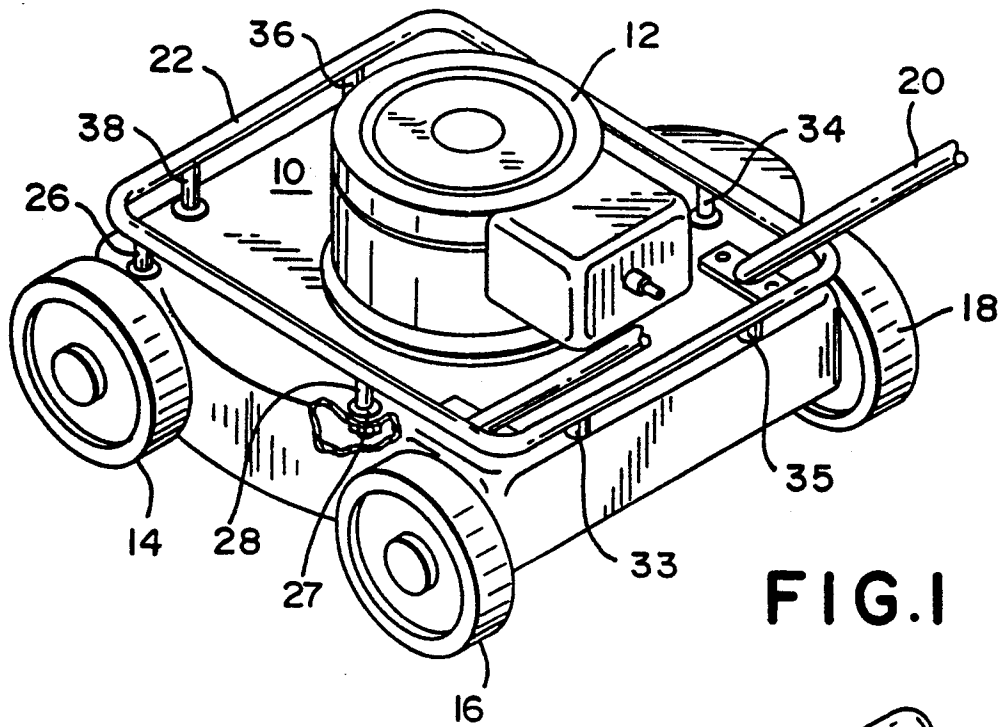

FIG. 1

FIG. 2

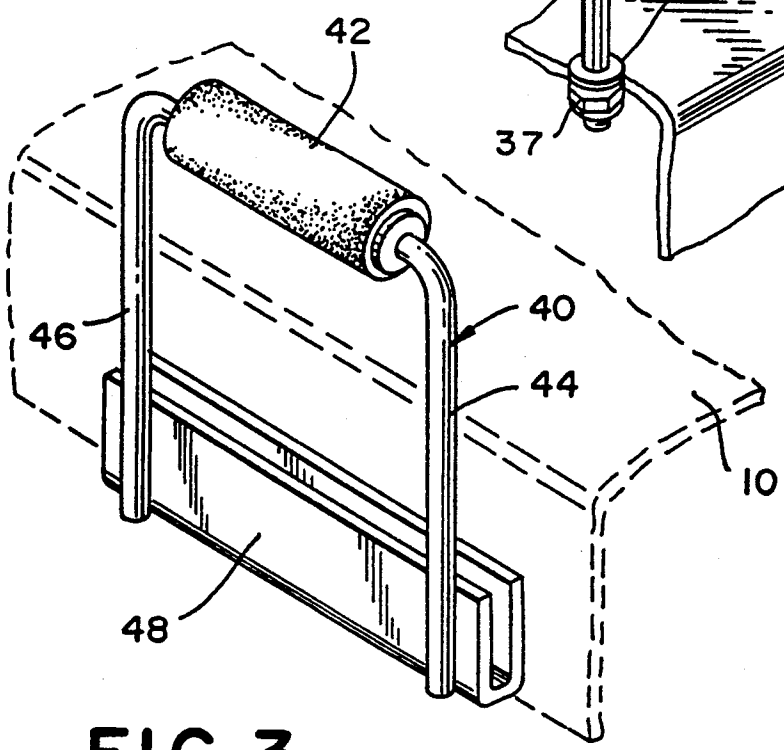
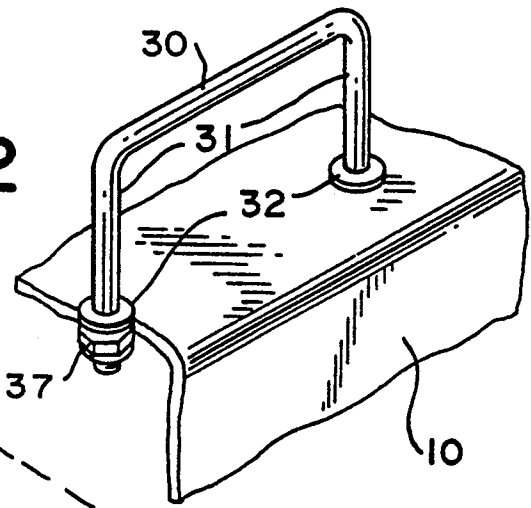

FIG. 3

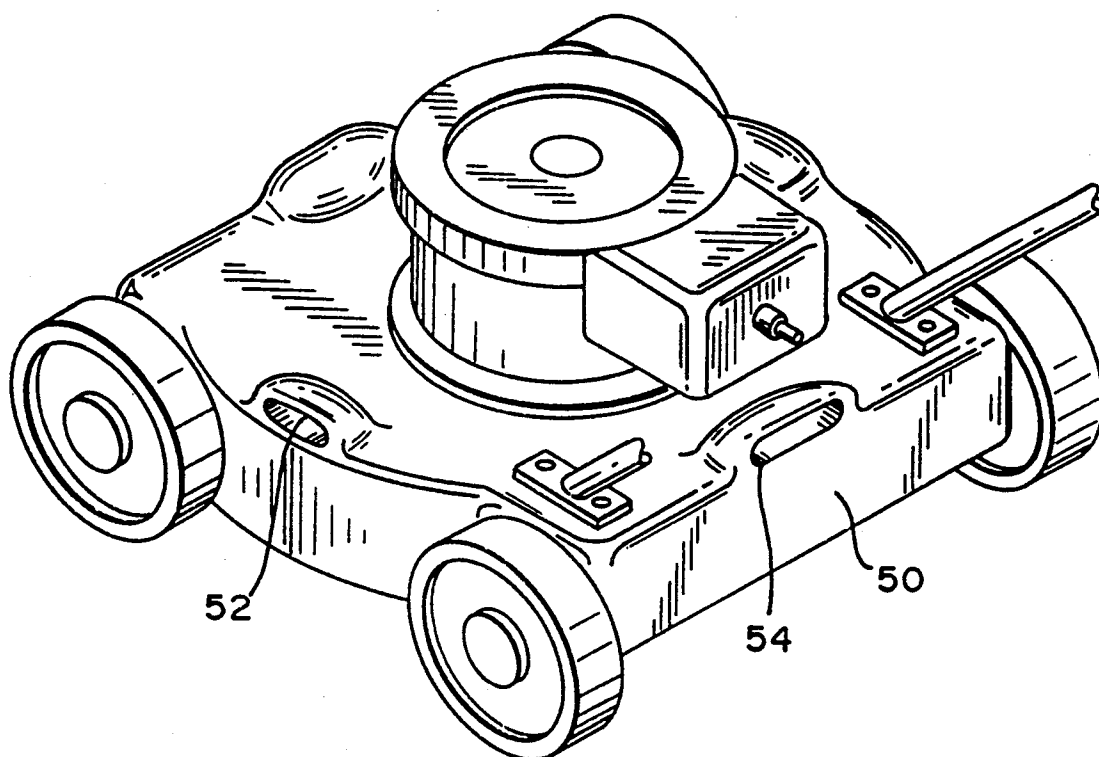

FIG. 4

FIG. 7

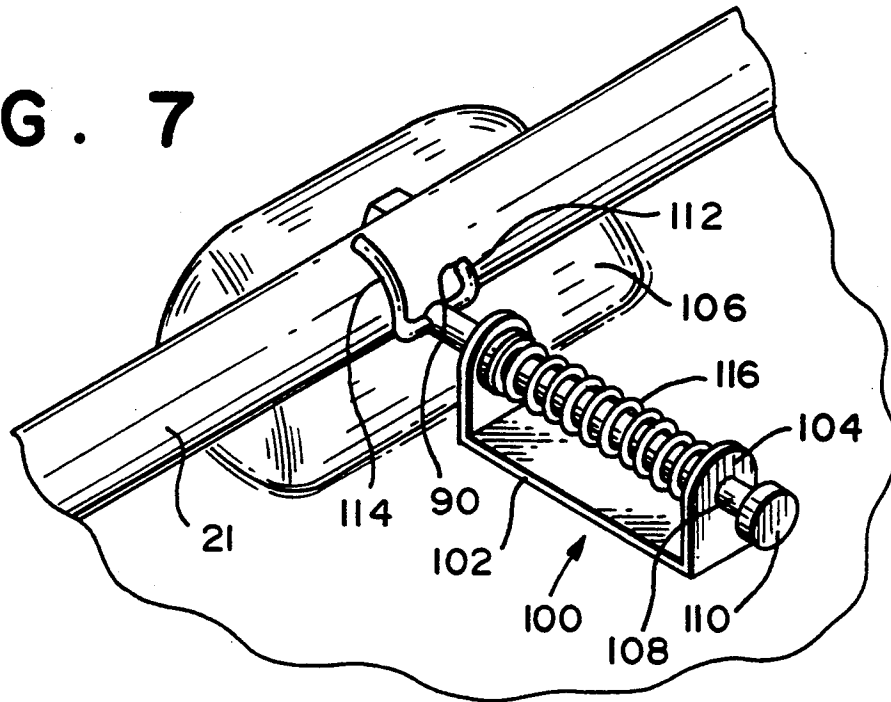
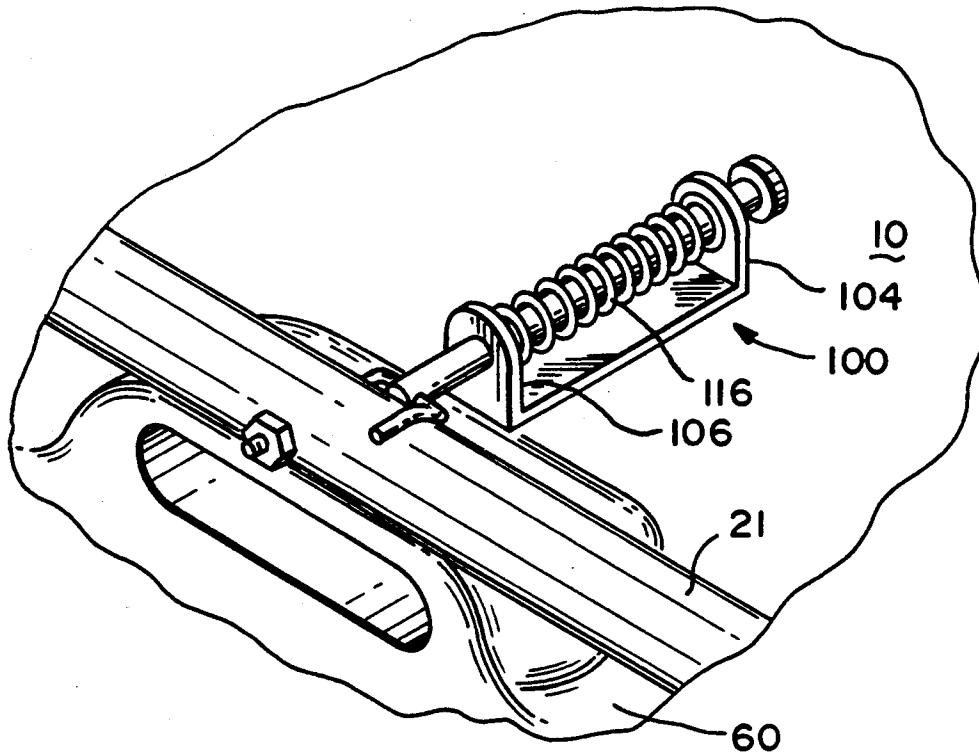

FIG. 6



Explore Litigation Insights

Docket Alarm provides insights to develop a more informed litigation strategy and the peace of mind of knowing you're on top of things.

Real-Time Litigation Alerts



Keep your litigation team up-to-date with **real-time alerts** and advanced team management tools built for the enterprise, all while greatly reducing PACER spend.

Our comprehensive service means we can handle Federal, State, and Administrative courts across the country.

Advanced Docket Research



With over 230 million records, Docket Alarm's cloud-native docket research platform finds what other services can't. Coverage includes Federal, State, plus PTAB, TTAB, ITC and NLRB decisions, all in one place.

Identify arguments that have been successful in the past with full text, pinpoint searching. Link to case law cited within any court document via Fastcase.

Analytics At Your Fingertips



Learn what happened the last time a particular judge, opposing counsel or company faced cases similar to yours.

Advanced out-of-the-box PTAB and TTAB analytics are always at your fingertips.

API

Docket Alarm offers a powerful API (application programming interface) to developers that want to integrate case filings into their apps.

LAW FIRMS

Build custom dashboards for your attorneys and clients with live data direct from the court.

Automate many repetitive legal tasks like conflict checks, document management, and marketing.

FINANCIAL INSTITUTIONS

Litigation and bankruptcy checks for companies and debtors.

E-DISCOVERY AND LEGAL VENDORS

Sync your system to PACER to automate legal marketing.