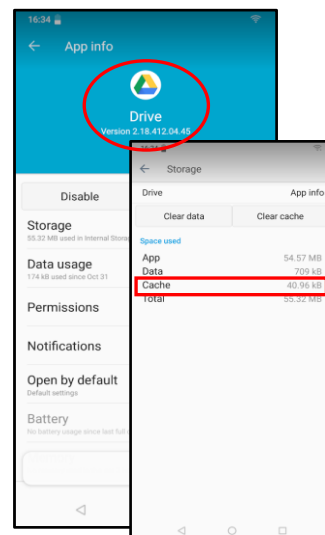
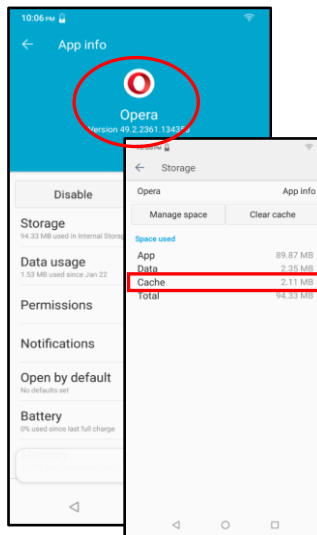

Exhibit 2 – Claim Chart for U.S. Patent No. 9,092,111

Claim of the '526 Patent	BLU Device Access to Remote Storage
<p>1. A wireless device comprising:</p>	<p>A BLU wireless device (e.g., VIVO One and VIVO XI+ smartphones, etc.)</p> 
<p>at least one cache storage, one wireless interface, and program code configured to cause the</p>	<p>The BLU wireless device comprises at least one cache storage (e.g., “Cache”) and program code configured to cause the</p>

Claim of the '526 Patent

BLU Device Access to Remote



The BLU wireless device comprises at least one wireless interface (e.g., a W

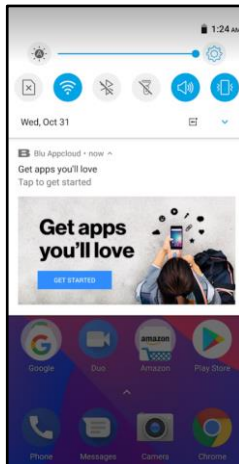

Claim of the '526 Patent

BLU Device Access to Remote

establish a wireless link for the wireless device access to a storage space of a predefined capacity assigned exclusively to a user of the wireless device by a storage server, and

The BLU wireless device establishes a wireless link (e.g., WiFi or cellular) to a storage server, and presents screenshots taken on a BLU wireless device (e.g., VIVO One and VIVOXI+) to a storage server, and provides 15 GB of storage space exclusively to a user of the BLU wireless device.

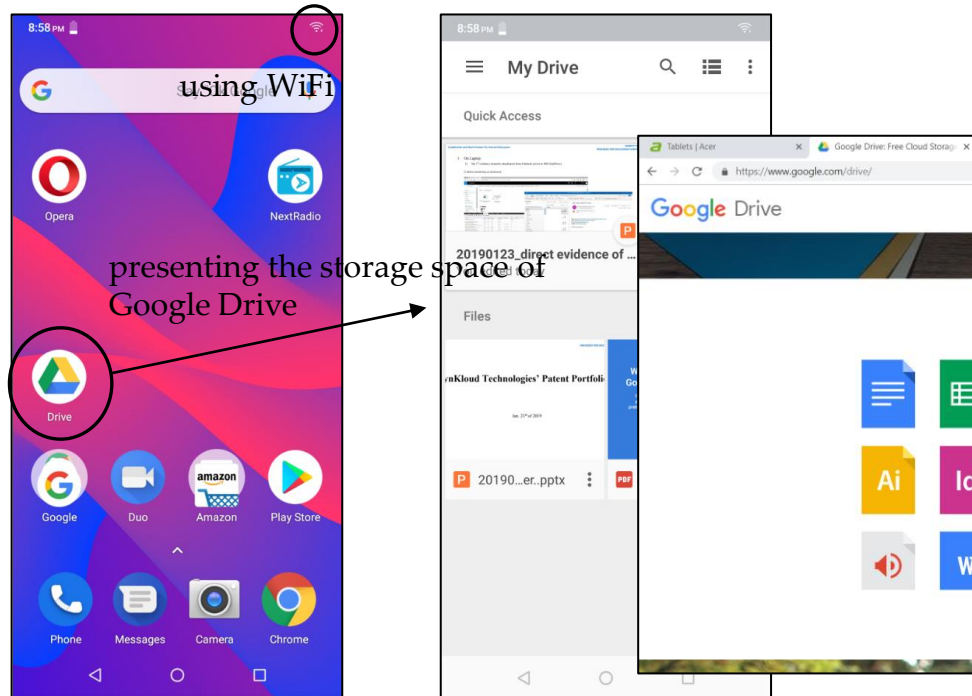

Claim of the '526 Patent

BLU Device Access to Remote

couple with the storage server across the wireless link to carry out a requested operation for remote access to the assigned storage space in response to the user from the wireless device performing the operation,

The BLU wireless device couples with the storage server (e.g., pre-installed wireless link (e.g., WiFi or cellular) to carry out a requested operation for remote access to the assigned storage space on Google Drive) in response to the user from the BLU device.

The operation for remote access to the assigned storage space (e.g., assigning a data object therein (e.g., Upload) or retrieving a data object therefrom (e.g., Download).

wherein the operation for the remote access to the assigned storage space comprises storing a data object therein or retrieving a data object therefrom,

① retrieving data from remote storage space

② st

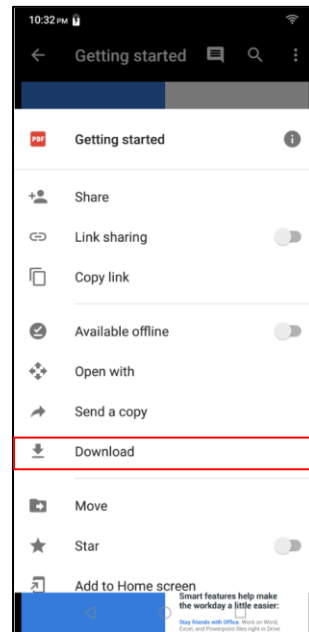

Claim of the '526 Patent

the storing of a data object including to download a file from a remote server across a network into the assigned storage space through utilizing download information for the file stored in said cache storage in response to the user from the wireless device performing the operation for downloading the file from the remote server into the assigned storage space.

BLU Device Access to Remote

The storing of a data object includes downloading a file (e.g., Starbucks logo) from an internet server) into the assigned storage space (e.g., assigned storage space) and the file stored in the cache storage (e.g., "Cache") in response to the user from downloading the file (e.g., Starbucks logo) from the remote server (e.g., remote server) into the assigned storage space on Google Drive).

The next few screenshots illustrate such downloading a file (e.g., downloading a news article) via the Opera browser into the user's assigned storage space on the storage device.

[1st step] access news article via preinstalled Opera app

[2nd step]

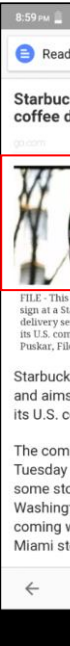
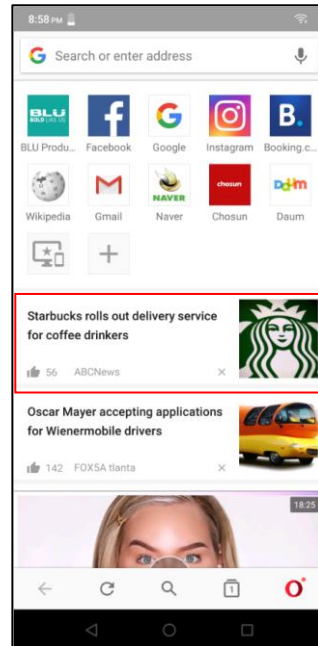

Explore Litigation Insights

Docket Alarm provides insights to develop a more informed litigation strategy and the peace of mind of knowing you're on top of things.

Real-Time Litigation Alerts



Keep your litigation team up-to-date with **real-time alerts** and advanced team management tools built for the enterprise, all while greatly reducing PACER spend.

Our comprehensive service means we can handle Federal, State, and Administrative courts across the country.

Advanced Docket Research



With over 230 million records, Docket Alarm's cloud-native docket research platform finds what other services can't. Coverage includes Federal, State, plus PTAB, TTAB, ITC and NLRB decisions, all in one place.

Identify arguments that have been successful in the past with full text, pinpoint searching. Link to case law cited within any court document via Fastcase.

Analytics At Your Fingertips



Learn what happened the last time a particular judge, opposing counsel or company faced cases similar to yours.

Advanced out-of-the-box PTAB and TTAB analytics are always at your fingertips.

API

Docket Alarm offers a powerful API (application programming interface) to developers that want to integrate case filings into their apps.

LAW FIRMS

Build custom dashboards for your attorneys and clients with live data direct from the court.

Automate many repetitive legal tasks like conflict checks, document management, and marketing.

FINANCIAL INSTITUTIONS

Litigation and bankruptcy checks for companies and debtors.

E-DISCOVERY AND LEGAL VENDORS

Sync your system to PACER to automate legal marketing.