



[54] SACRAL IMPLANT SYSTEM

[75] Inventors: R. Charles Ray, 5425 - 87th Ave. West, Tacoma, Wash. 98467; Richard B. Ashman, Dallas, Tex.

[73] Assignee: R. Charles Ray, Tacoma, Wash.

[21] Appl. No.: 593,196

[22] Filed: Oct. 5, 1990

[51] Int. Cl.<sup>5</sup> ..... A61F 5/01; A61F 2/44; A61F 5/00

[52] U.S. Cl. .... 606/61; 623/17

[58] Field of Search ..... 606/61; 623/17; 128/69

[56] References Cited

U.S. PATENT DOCUMENTS

4,641,636	2/1987	Cotrel	128/69
4,719,905	1/1988	Steffe	128/69
4,743,260	5/1988	Burton	623/17
4,773,402	9/1988	Asher et al.	128/69
4,950,269	8/1990	Gaines, Jr.	606/61

FOREIGN PATENT DOCUMENTS

0301489 7/1988 European Pat. Off.

OTHER PUBLICATIONS

Roy-Camille, Raymond et al., "Internal Fixation of the Lumbar Spine with Pedicle Screw Plating," *Clinical Orthopedics & Related Research*, No. 203 (Feb. 1986), pp. 7-17.

Shipman, Pat et al., "The Human Skeleton," *Harvard University Press*, Cambridge, Massachusetts, and London, England (1985), pp. 81-93.

Asher, Marc A. et al., "Anthropometric Studies of the Human Sacrum Relating to Dorsal Transsacral Implant

Designs," *Clinical Orthopaedics and Related Research*, No. 203 (Feb. 1986), pp. 58-62.

Roy-Camille, Raymond et al., "Internal Fixation of the Lumbar Spine with Pedicle Screw Plating," *Clinical Orthopaedics and Related Research*, No. 203 (Feb. 1986), pp. 7-17.

Louis, Rene, "Fusion of the Lumbar and Sacral Spine by Internal Fixation with Screw Plates," *Clinical Orthopaedics and Related Research*, No. 203 (Feb. 1986), pp. 18-33.

Berry, James L. et al., "A Morphometric Study of Human Lumbar and Selected Thoracic Vertebrae," *Spine*, vol. 12, No. 4 (1987), pp. 362-367.

Roy-Camille, R. et al., "Posterior Spinal Fixation with Transpedicular Screws and Plates," Groupe Hospitalier, Paris, France.

Primary Examiner—David J. Isabella

Assistant Examiner—Elizabeth M. Burke

Attorney, Agent, or Firm—Christensen, O'Connor, Johnson & Kindness

[57] ABSTRACT

A sacral implant system includes first and second sacral plates that are affixed on opposite sides of the sacrum adjacent the lumbosacral junction. Pedicle, lateral and oblique mounting means are provided for rigidly affixing the sacral plates to the sacrum. First and second fixation rods extend in a superior direction along the lumbar portion of the spine. One or more connecting members tie the rods together. The superior most vertebra to be fixed is tied to the implant system with a special offset fixation plate and pedicle screw. Conventional vertebra hooks can also be used as necessary. Intermediate vertebra are tied to the system with a straight fixation plate and pedicle screw.

27 Claims, 5 Drawing Sheets

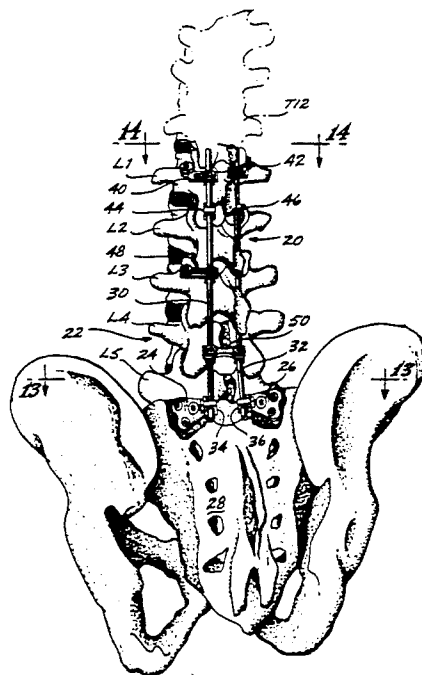

*Fig. 1.*

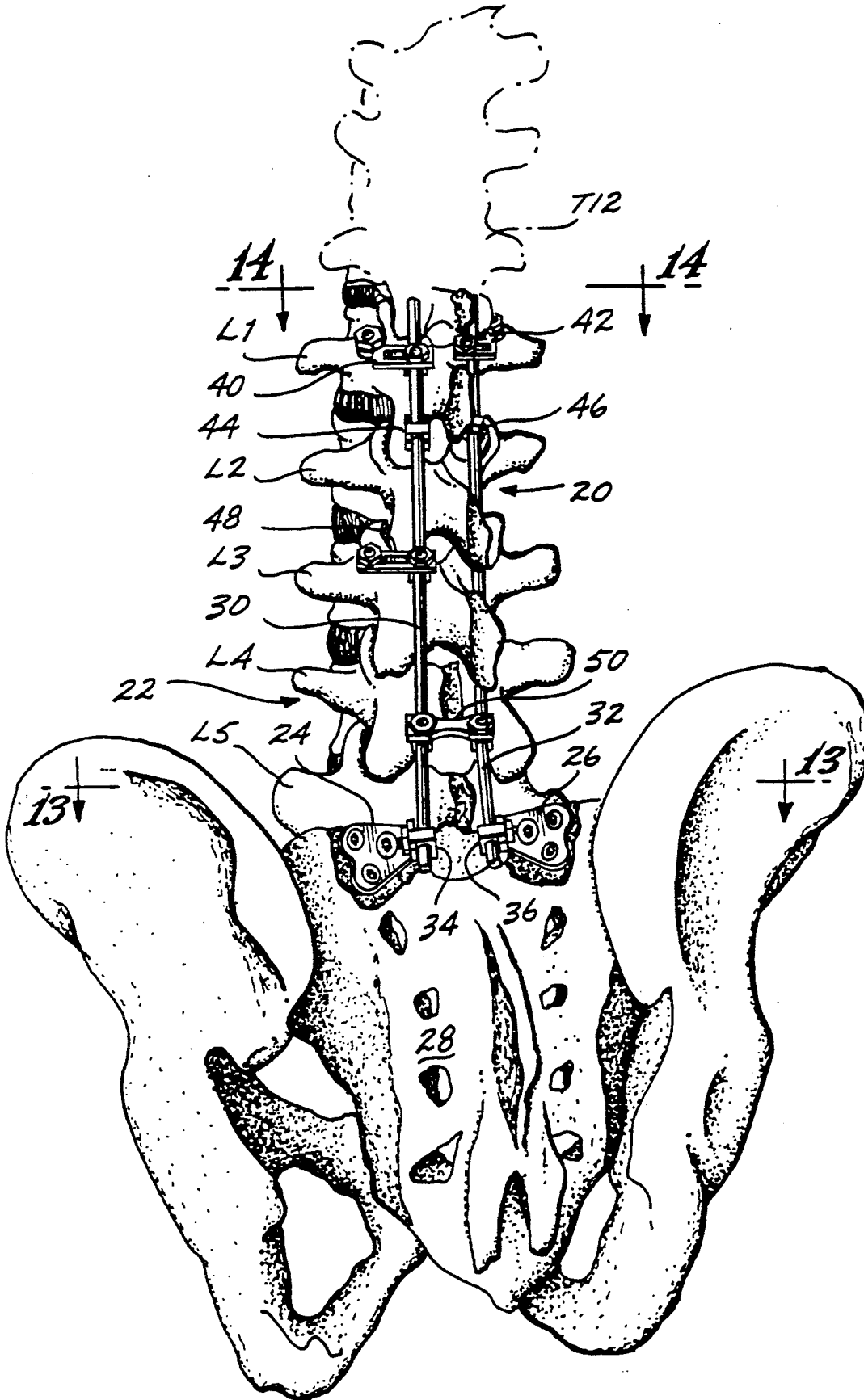

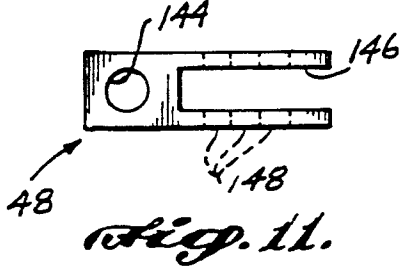
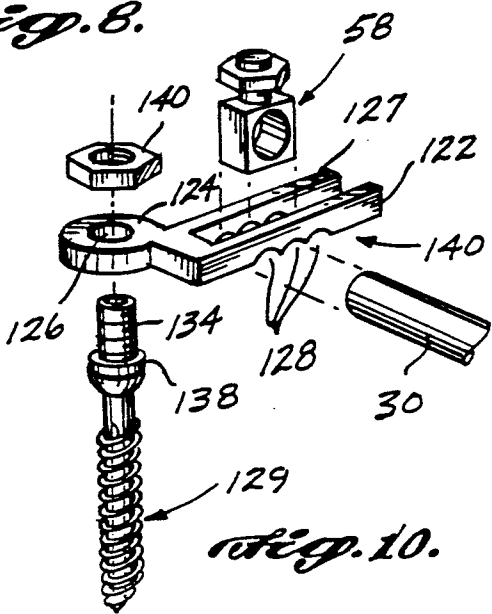
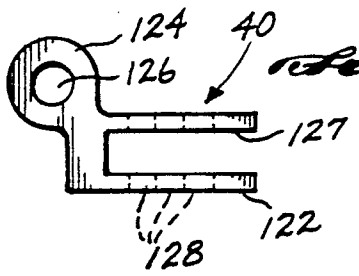
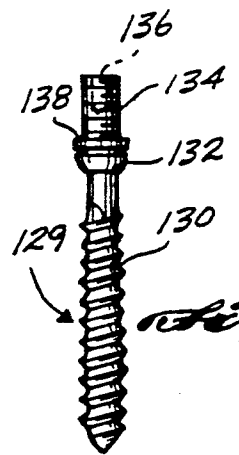
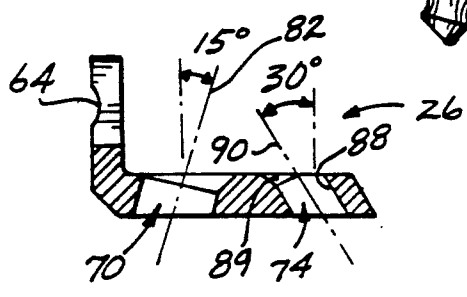
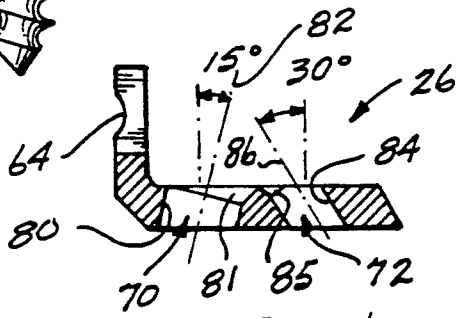
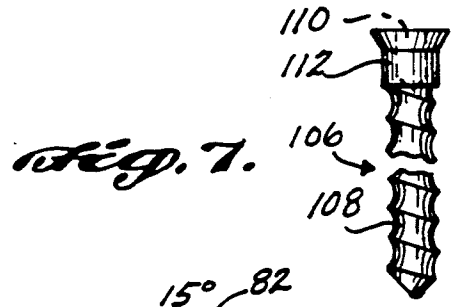
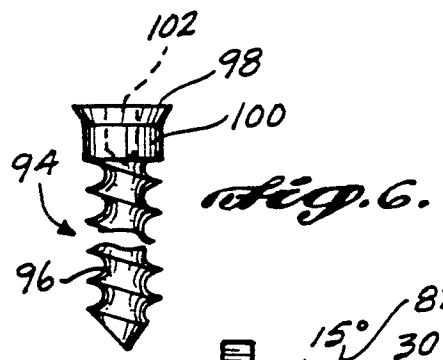
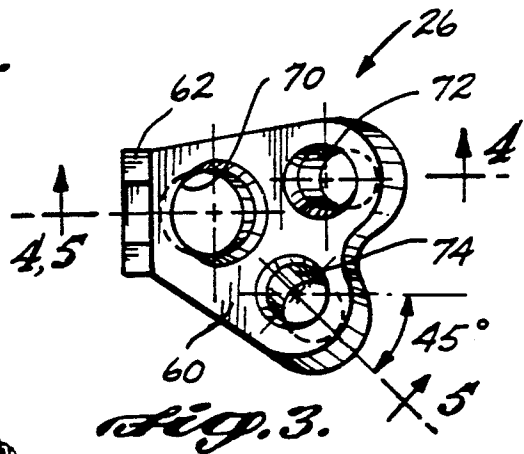
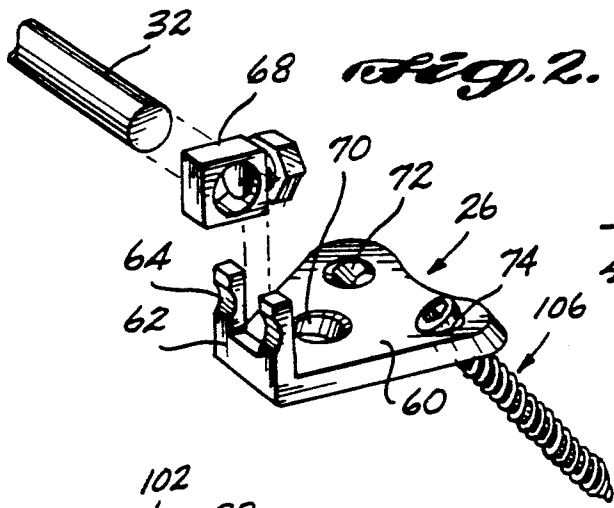

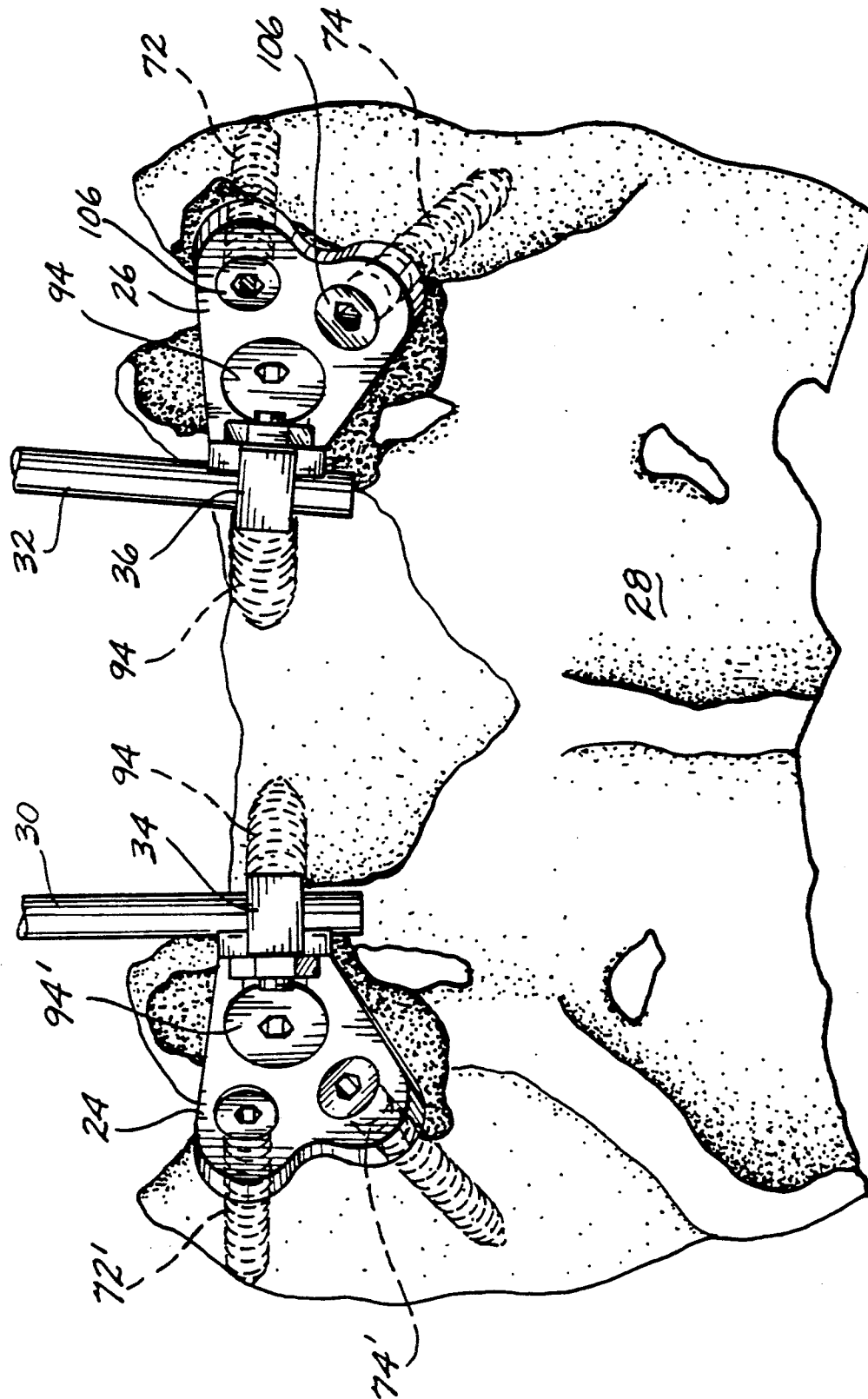

*Fig. 12.*

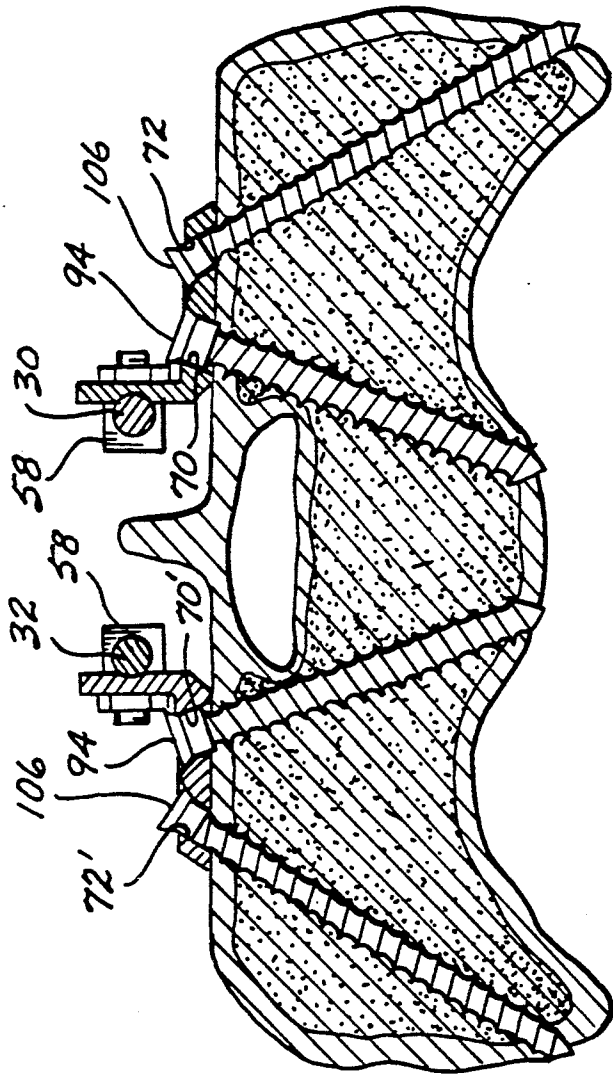

*Fig. 13.*

# Explore Litigation Insights

Docket Alarm provides insights to develop a more informed litigation strategy and the peace of mind of knowing you're on top of things.

## Real-Time Litigation Alerts



Keep your litigation team up-to-date with **real-time alerts** and advanced team management tools built for the enterprise, all while greatly reducing PACER spend.

Our comprehensive service means we can handle Federal, State, and Administrative courts across the country.

## Advanced Docket Research



With over 230 million records, Docket Alarm's cloud-native docket research platform finds what other services can't. Coverage includes Federal, State, plus PTAB, TTAB, ITC and NLRB decisions, all in one place.

Identify arguments that have been successful in the past with full text, pinpoint searching. Link to case law cited within any court document via Fastcase.

## Analytics At Your Fingertips



Learn what happened the last time a particular judge, opposing counsel or company faced cases similar to yours.

Advanced out-of-the-box PTAB and TTAB analytics are always at your fingertips.

## API

Docket Alarm offers a powerful API (application programming interface) to developers that want to integrate case filings into their apps.

## LAW FIRMS

Build custom dashboards for your attorneys and clients with live data direct from the court.

Automate many repetitive legal tasks like conflict checks, document management, and marketing.

## FINANCIAL INSTITUTIONS

Litigation and bankruptcy checks for companies and debtors.

## E-DISCOVERY AND LEGAL VENDORS

Sync your system to PACER to automate legal marketing.