



US005218367A

United States Patent [19]

Sheffer et al.

[11] Patent Number: **5,218,367**

[45] Date of Patent: **Jun. 8, 1993**

- [54] **VEHICLE TRACKING SYSTEM**
- [75] Inventors: **Eliezer A. Sheffer; Marco J. Thompson**, both of San Diego, Calif.
- [73] Assignee: **Trackmobile**, San Diego, Calif.
- [21] Appl. No.: **891,805**
- [22] Filed: **Jun. 1, 1992**
- [51] Int. Cl.⁵ **G01S 3/02; H04M 11/00**
- [52] U.S. Cl. **342/457; 379/59**
- [58] Field of Search **342/457, 463; 455/33.1; 379/58, 59, 63**

| | | | |
|-----------|---------|--------------|----------|
| 4,596,988 | 6/1986 | Wanka | 343/457 |
| 4,651,157 | 3/1987 | Gray et al. | 342/457 |
| 4,740,792 | 4/1988 | Sagey et al. | 342/457 |
| 4,891,650 | 1/1990 | Sheffer | 342/457 |
| 4,907,290 | 3/1990 | Crompton | 455/33.1 |
| 5,055,851 | 10/1991 | Sheffer | 342/457 |
| 5,121,126 | 6/1992 | Clagett | 379/59 X |

FOREIGN PATENT DOCUMENTS

| | | |
|---------|---------|--------------------|
| 0011444 | 5/1980 | European Pat. Off. |
| 0242099 | 10/1987 | European Pat. Off. |
| 2016770 | 9/1979 | United Kingdom |
| 2207787 | 2/1989 | United Kingdom |

[56] References Cited

U.S. PATENT DOCUMENTS

| | | | |
|-----------|---------|------------------|----------|
| 2,204,438 | 6/1940 | Neufeld | 250/2 |
| 2,922,142 | 1/1960 | Lappin | 340/150 |
| 3,018,475 | 1/1962 | Kleist et al. | 343/6.8 |
| 3,058,106 | 10/1962 | Cutler | 343/100 |
| 3,137,854 | 6/1964 | Anderson | 343/112 |
| 3,357,020 | 12/1967 | Slifer, Jr. | 343/100 |
| 3,419,865 | 12/1968 | Chisholm | 343/112 |
| 3,518,674 | 6/1970 | Moorehead et al. | 343/112 |
| 3,531,801 | 9/1970 | Huebscher | 343/15 |
| 3,680,121 | 7/1972 | Anderson et al. | 343/112 |
| 3,694,579 | 9/1972 | McMurray | 179/5 R |
| 3,793,635 | 2/1974 | Potter | 343/112 |
| 3,828,306 | 8/1974 | Angeloni | 340/32 |
| 3,848,254 | 11/1974 | Drebinger et al. | 343/112 |
| 3,886,553 | 5/1975 | Bates | 343/112 |
| 3,922,678 | 11/1975 | Frenkel | 343/112 |
| 3,947,807 | 3/1976 | Tyler et al. | 340/23 |
| 3,997,868 | 12/1976 | Ribnick et al. | 340/33 |
| 4,101,873 | 7/1978 | Anderson et al. | 340/539 |
| 4,112,421 | 9/1978 | Freeny, Jr. | 343/112 |
| 4,139,889 | 2/1979 | Ingels | 364/460 |
| 4,152,693 | 5/1979 | Ashworth, Jr. | 340/24 |
| 4,177,466 | 12/1979 | Reagan | 343/112 |
| 4,187,497 | 2/1980 | Howell et al. | 340/65 |
| 4,209,787 | 6/1980 | Freeny, Jr. | 343/112 |
| 4,247,846 | 1/1981 | Zedler | 340/523 |
| 4,369,426 | 1/1983 | Merkel | 340/32 |
| 4,475,010 | 10/1984 | Huensch et al. | 179/2 EB |
| 4,494,119 | 1/1985 | Wimbush | 33/457 |
| 4,577,182 | 3/1986 | Millsap et al. | 340/539 |

Primary Examiner—Mark Hellner
Attorney, Agent, or Firm—Brown, Martin, Haller & McClain

[57] ABSTRACT

A vehicle tracking system makes use of a conventional cellular telephone network including a plurality of fixed cellular transmitter sites each covering a predetermined area. The system includes a plurality of cellular signal processing units for installation at hidden locations in vehicles to be monitored. Each unit is connected to one or more different sensors in the vehicle, at least one of the sensors being a break-in detector for detecting tampering with the vehicle, and to a cellular antenna, and includes a controller for monitoring the sensor outputs and initiating an emergency message transmission to a remote monitoring station in the event of actuation of a sensor. The car processing unit monitors site identifying signals and signal strengths of transmissions from adjacent cellular transmitter sites in an emergency, and the emergency message includes vehicle identifying information, cell site identifying information, and signal strength information which will be dependent on distance from the cell site. The monitoring station includes a computer for determining and displaying an approximate vehicle location from the incoming cell site identifying and signal strength information.

16 Claims, 7 Drawing Sheets

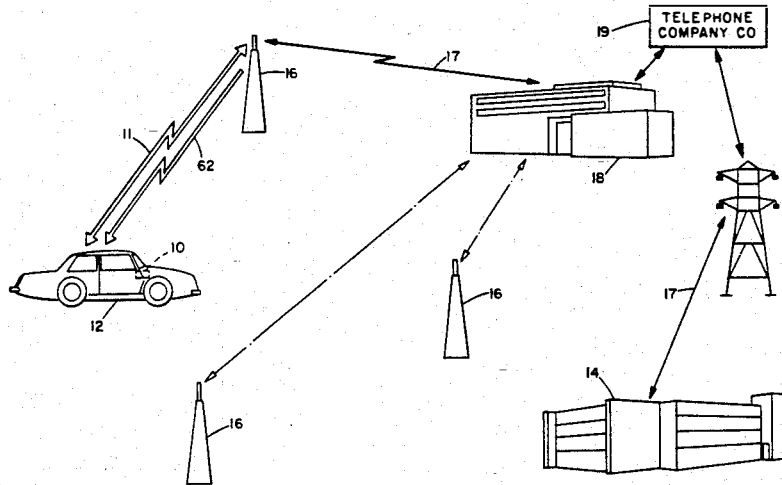

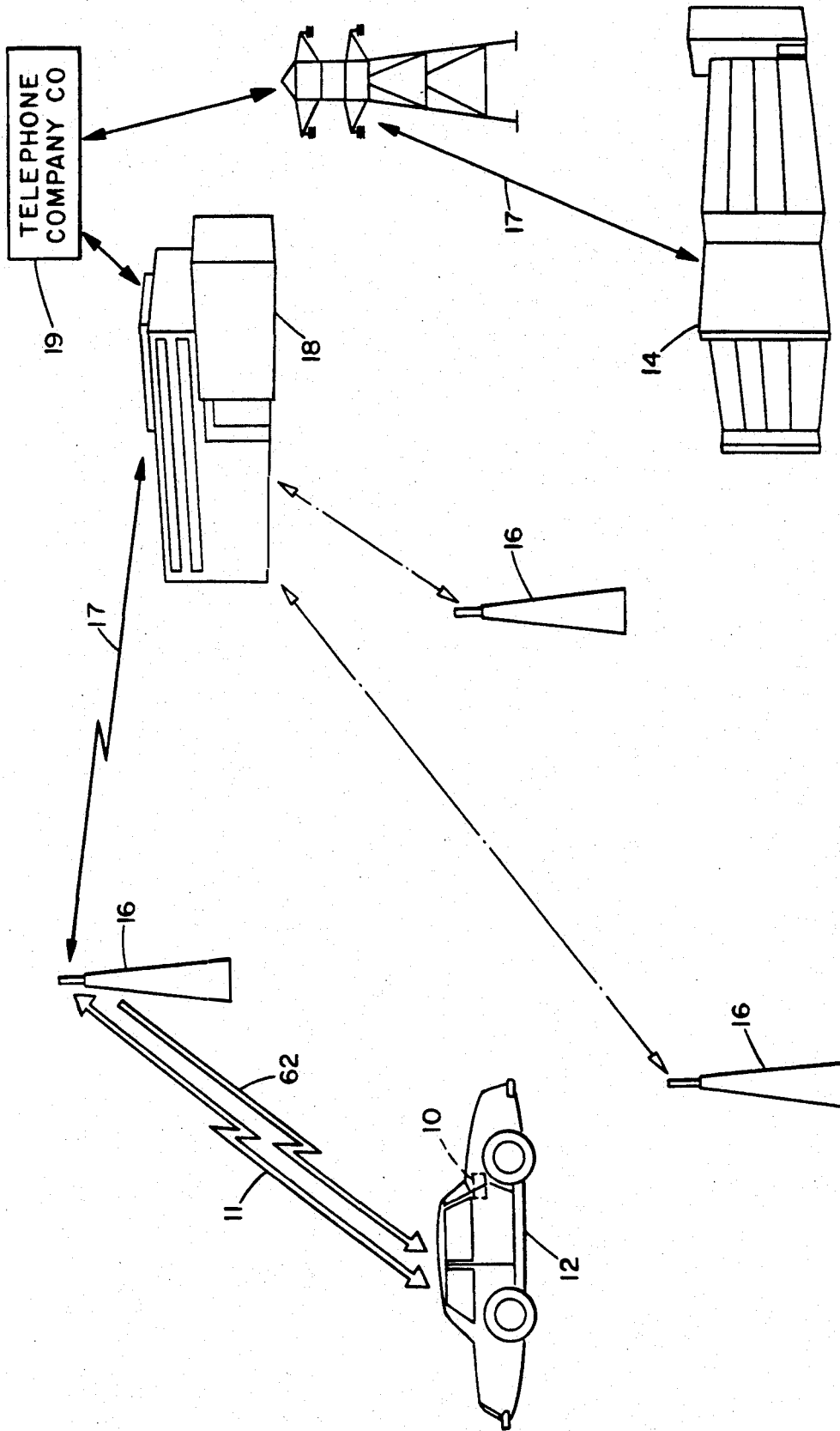
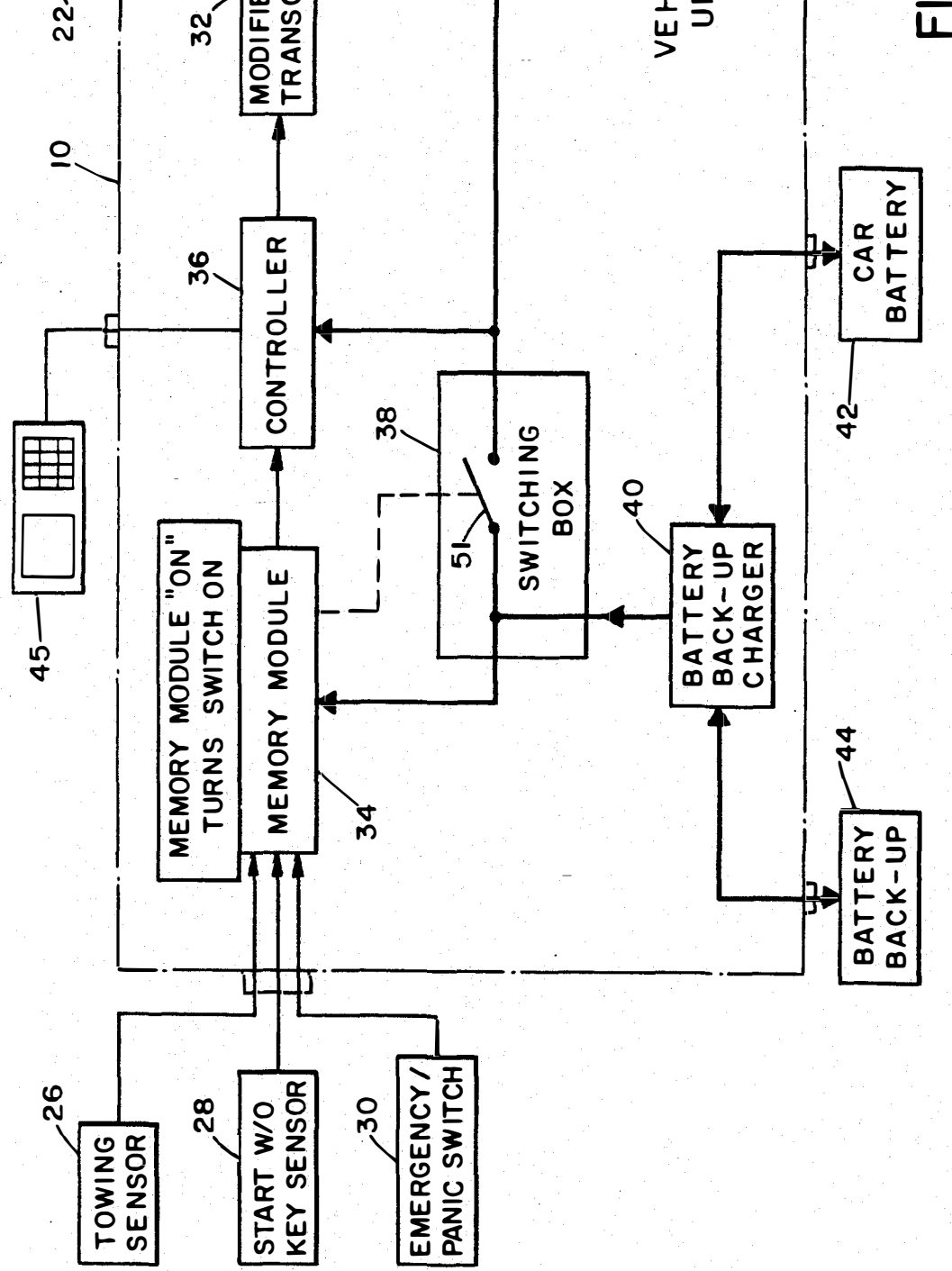

FIG. 1



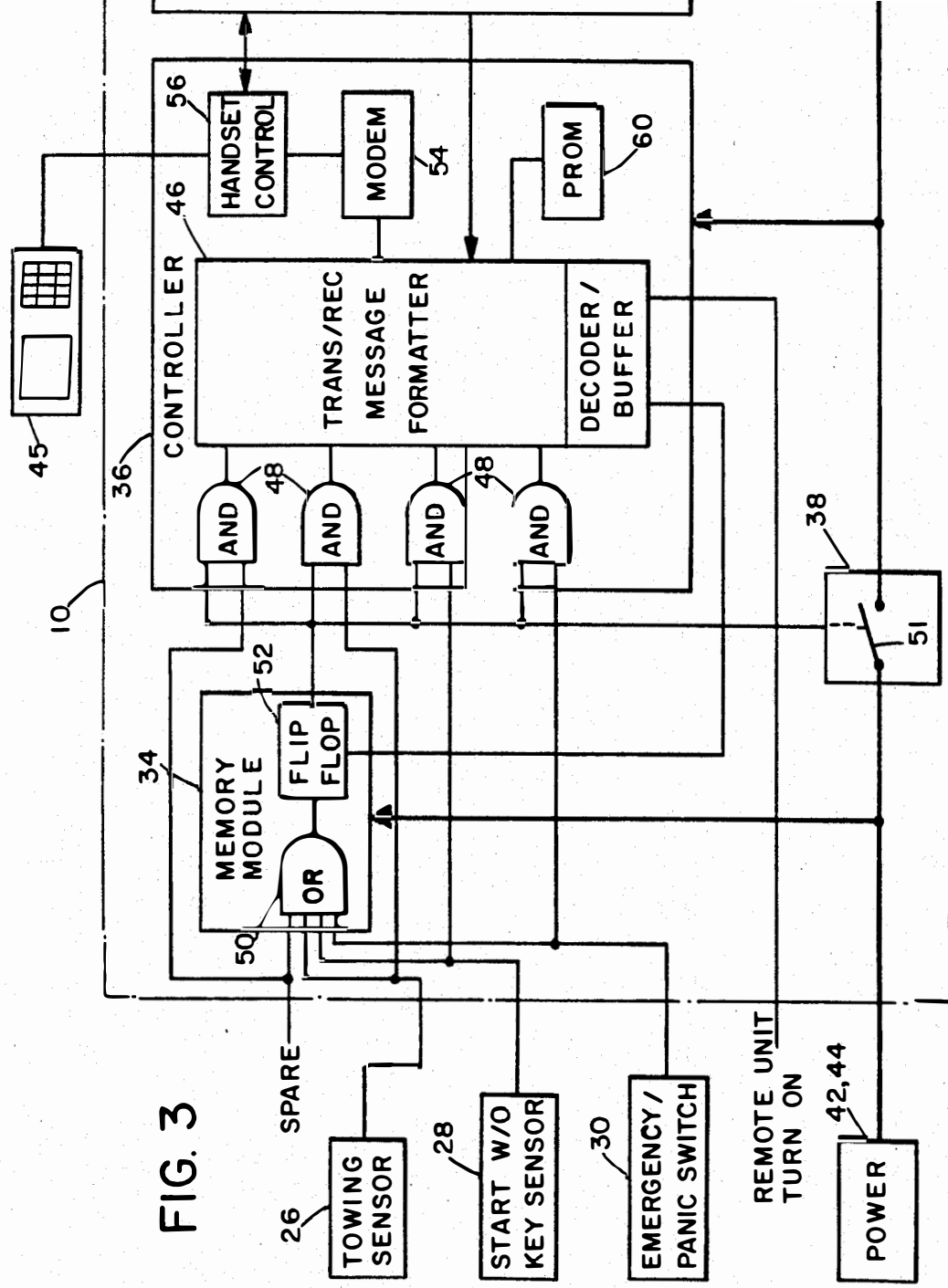

FIG. 3

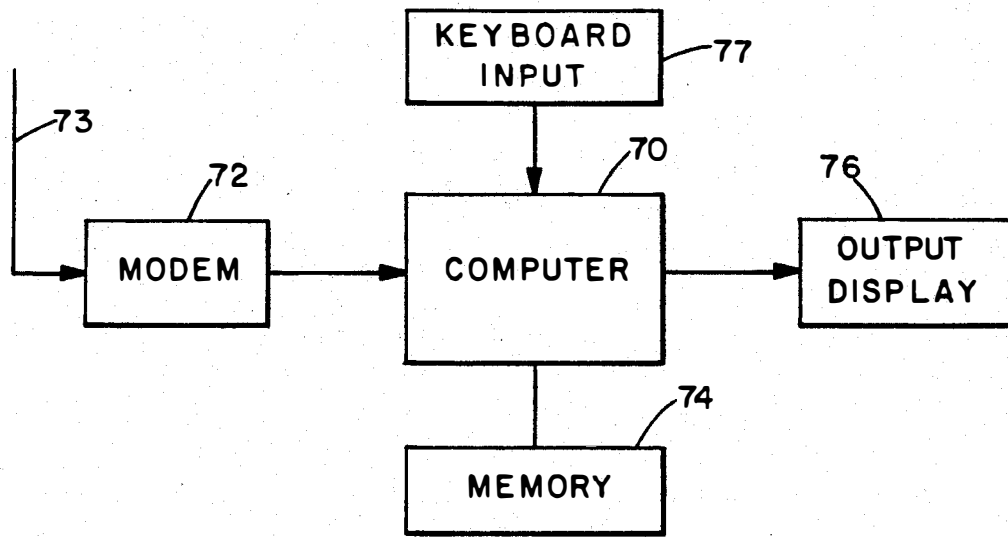

FIG. 4

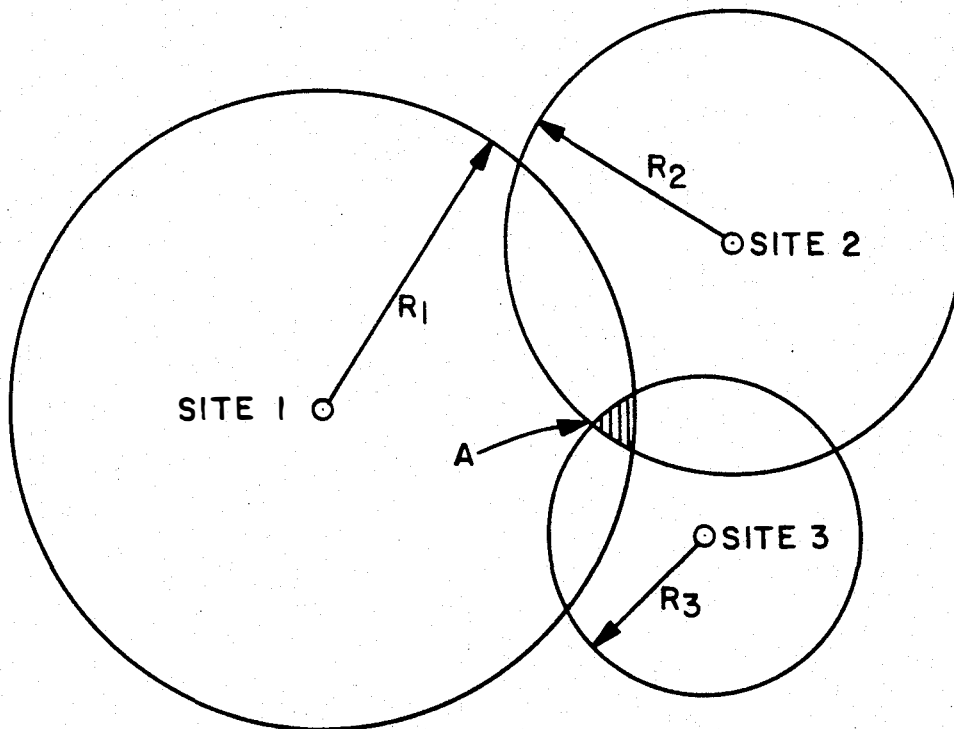

FIG. 6

Explore Litigation Insights

Docket Alarm provides insights to develop a more informed litigation strategy and the peace of mind of knowing you're on top of things.

Real-Time Litigation Alerts



Keep your litigation team up-to-date with **real-time alerts** and advanced team management tools built for the enterprise, all while greatly reducing PACER spend.

Our comprehensive service means we can handle Federal, State, and Administrative courts across the country.

Advanced Docket Research



With over 230 million records, Docket Alarm's cloud-native docket research platform finds what other services can't. Coverage includes Federal, State, plus PTAB, TTAB, ITC and NLRB decisions, all in one place.

Identify arguments that have been successful in the past with full text, pinpoint searching. Link to case law cited within any court document via Fastcase.

Analytics At Your Fingertips



Learn what happened the last time a particular judge, opposing counsel or company faced cases similar to yours.

Advanced out-of-the-box PTAB and TTAB analytics are always at your fingertips.

API

Docket Alarm offers a powerful API (application programming interface) to developers that want to integrate case filings into their apps.

LAW FIRMS

Build custom dashboards for your attorneys and clients with live data direct from the court.

Automate many repetitive legal tasks like conflict checks, document management, and marketing.

FINANCIAL INSTITUTIONS

Litigation and bankruptcy checks for companies and debtors.

E-DISCOVERY AND LEGAL VENDORS

Sync your system to PACER to automate legal marketing.