



(19) **United States**

(12) **Patent Application Publication** (10) **Pub. No.: US 2004/0079957 A1**

**Andrews et al.** (43) **Pub. Date: Apr. 29, 2004**

(54) **POWER SURFACE MOUNT LIGHT  
EMITTING DIE PACKAGE**

(52) **U.S. Cl. .... 257/100**

(76) Inventors: **Peter Scott Andrews**, Durham, NC  
(US); **Ban P. Loh**, Durham, NC (US)

(57) **ABSTRACT**

Correspondence Address:

**D. James Chung**  
**Suite 245**  
**6601 Koll Center Parkway**  
**Pleasanton, CA 94566 (US)**

(21) Appl. No.: **10/692,351**

(22) Filed: **Oct. 22, 2003**

**Related U.S. Application Data**

(63) Continuation-in-part of application No. 10/446,532,  
filed on May 27, 2003.

(60) Provisional application No. 60/408,254, filed on Sep.  
4, 2002.

**Publication Classification**

(51) **Int. Cl.<sup>7</sup> ..... H01L 33/00**

A light emitting die package is disclosed. The die package includes a substrate, a reflector plate, and a lens. The substrate may be made from thermally conductive but electrically insulating material or from a material that is both thermally and electrically conductive. In embodiments wherein the substrate is made from an electrically conductive material, the substrate further includes an electrically insulating, thermally conductive material formed on the electrically conductive material. The substrate has traces for connecting to a light emitting diode (LED) at a mounting pad. The reflector plate is coupled to the substrate and substantially surrounds the mounting pad. The lens substantially covers the mounting pad. Heat generated by the LED during operation is drawn away from the LED by both the substrate (acting as a bottom heat sink) and the reflector plate (acting as a top heat sink). The reflector plate includes a reflective surface to direct light from the LED in a desired direction.

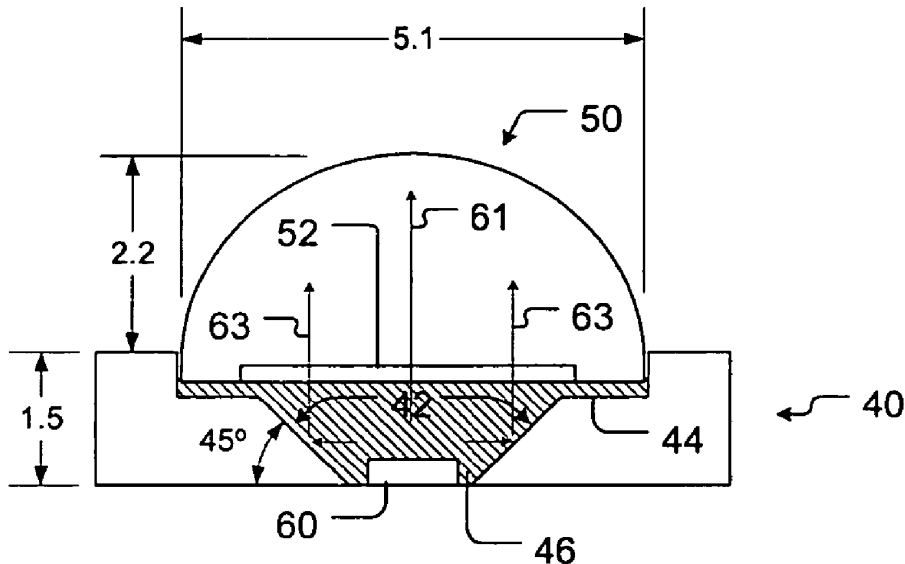

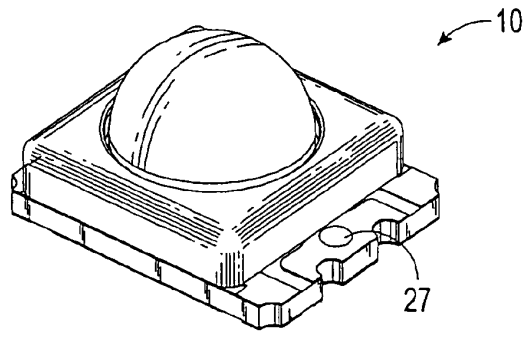

FIG. 1A

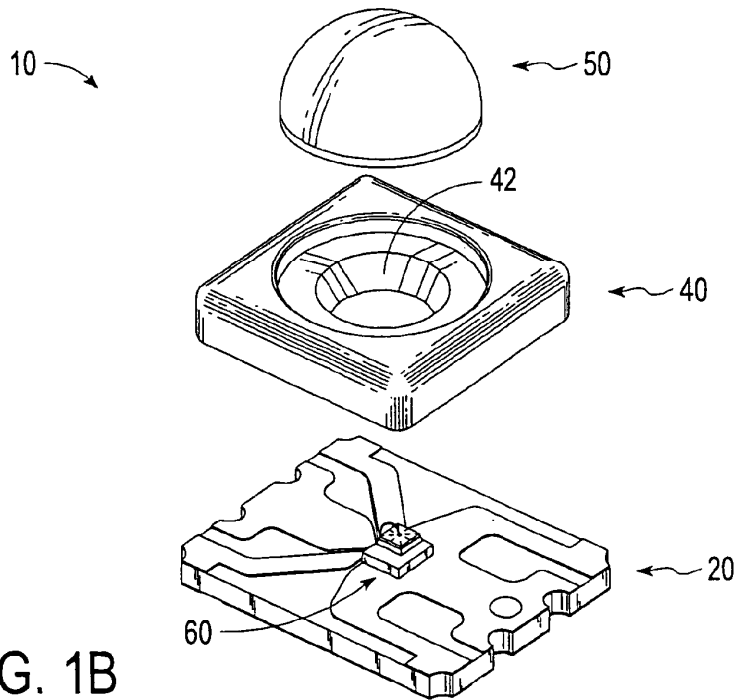

FIG. 1B

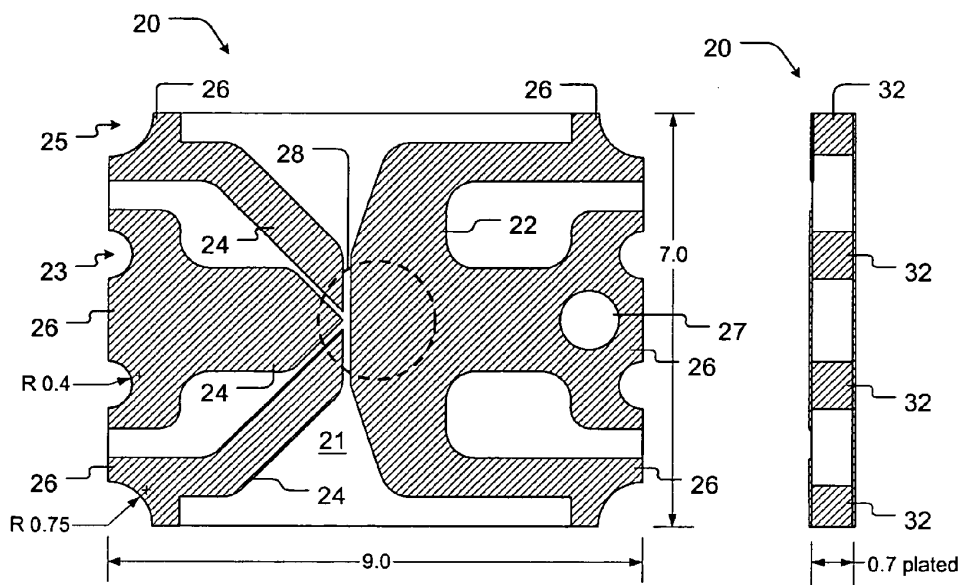

FIG. 2A

FIG. 2B

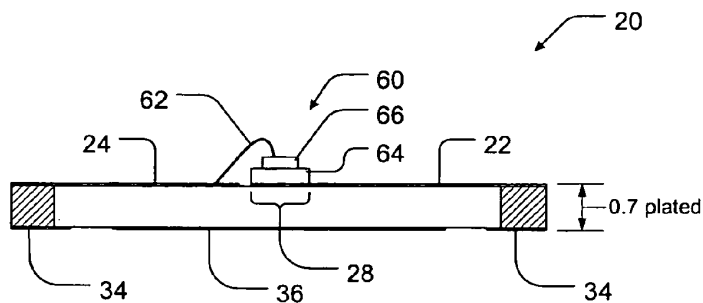

FIG. 2C

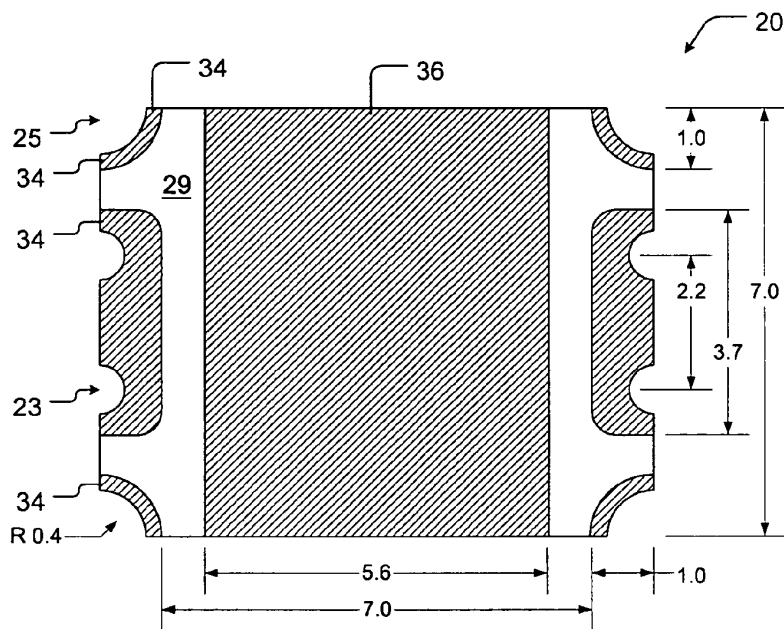

FIG. 2D

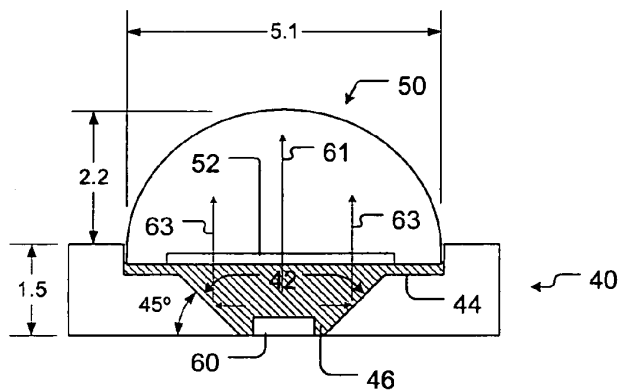

FIG. 3

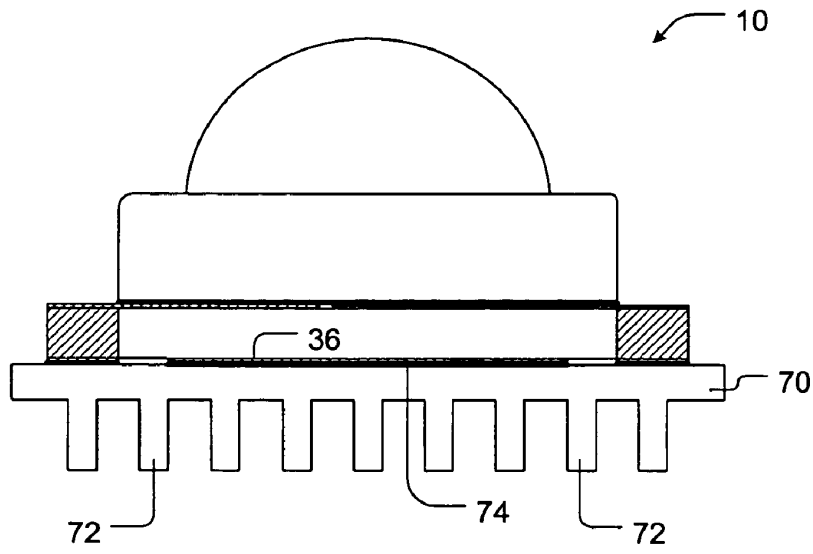

FIG. 4

# Explore Litigation Insights

Docket Alarm provides insights to develop a more informed litigation strategy and the peace of mind of knowing you're on top of things.

## Real-Time Litigation Alerts



Keep your litigation team up-to-date with **real-time alerts** and advanced team management tools built for the enterprise, all while greatly reducing PACER spend.

Our comprehensive service means we can handle Federal, State, and Administrative courts across the country.

## Advanced Docket Research



With over 230 million records, Docket Alarm's cloud-native docket research platform finds what other services can't. Coverage includes Federal, State, plus PTAB, TTAB, ITC and NLRB decisions, all in one place.

Identify arguments that have been successful in the past with full text, pinpoint searching. Link to case law cited within any court document via Fastcase.

## Analytics At Your Fingertips



Learn what happened the last time a particular judge, opposing counsel or company faced cases similar to yours.

Advanced out-of-the-box PTAB and TTAB analytics are always at your fingertips.

## API

Docket Alarm offers a powerful API (application programming interface) to developers that want to integrate case filings into their apps.

## LAW FIRMS

Build custom dashboards for your attorneys and clients with live data direct from the court.

Automate many repetitive legal tasks like conflict checks, document management, and marketing.

## FINANCIAL INSTITUTIONS

Litigation and bankruptcy checks for companies and debtors.

## E-DISCOVERY AND LEGAL VENDORS

Sync your system to PACER to automate legal marketing.