



(12) **United States Patent**  
**Hansen et al.**

(10) **Patent No.:** **US 6,315,230 B1**  
(45) **Date of Patent:** **Nov. 13, 2001**

(54) **TAPE REEL ASSEMBLY WITH WASHER  
GUARD FOR A DATA STORAGE TAPE  
CARTRIDGE**

5,826,811 \* 10/1998 Melbye et al. .... 242/343 X  
5,871,166 \* 2/1999 Doninelli ..... 242/340  
6,043,963 \* 3/2000 Eaton ..... 360/132  
6,264,126 \* 7/2001 Shima et al. .... 242/343

(75) Inventors: **Carter J. Hansen; William D. Lewis,**  
both of Wahpeton, ND (US)

\* cited by examiner

(73) Assignee: **Imation Corp.,** Oakdale, MN (US)

*Primary Examiner*—William A. Rivera  
(74) *Attorney, Agent, or Firm*—Eric D. Levinson

(\* ) Notice: Subject to any disclaimer, the term of this  
patent is extended or adjusted under 35  
U.S.C. 154(b) by 0 days.

(57) **ABSTRACT**

A tape reel assembly for maintaining a data storage tape. The tape reel assembly includes a hub ring, an engagement section, a metallic ring and opposing flanges. The hub ring defines a tape-winding surface and forms a central opening. The engagement section extends substantially radially inwardly relative to the tape-winding surface and includes an inner surface, an outer surface and an annular flange. The annular flange extends substantially axially from the outer surface and defines an axial passage. The metallic ring is secured to the outer surface of the engagement section and has an inner diameter. In this regard, the inner diameter of the metallic ring is greater than a diameter of the axial passage such that the annular flange extends axially within the inner diameter of the metallic ring. Finally, the opposing flanges extend radially from opposite ends of the hub ring, respectively. With this configuration, the annular flange protects the metallic ring from accidental contact with a tape drive post during use. In addition, the annular flange serves to co-axially align a drive assembly with the tape-winding surface, thereby improving cartridge performance.

(21) Appl. No.: **09/542,533**

(22) Filed: **Apr. 4, 2000**

(51) **Int. Cl.<sup>7</sup>** ..... **G03B 23/02**

(52) **U.S. Cl.** ..... **242/348; 242/118.6; 360/132**

(58) **Field of Search** ..... 242/341, 342,  
242/340, 338, 343, 343.1, 343.2, 345.1,  
348, 118.6, 118.61, 608.2, 608.8, 609.4,  
612; 360/132

(56) **References Cited**

**U.S. PATENT DOCUMENTS**

4,775,115 10/1988 Gelardi .  
4,879,614 \* 11/1989 Nakagome ..... 360/132 X  
5,027,249 \* 6/1991 Johnson et al. .... 360/132  
5,323,984 \* 6/1994 Lackowski ..... 242/348  
5,400,981 3/1995 Rambosek et al. .  
5,618,005 \* 4/1997 Todd et al. .... 242/345.1  
5,657,937 8/1997 Todd et al. .

**20 Claims, 7 Drawing Sheets**

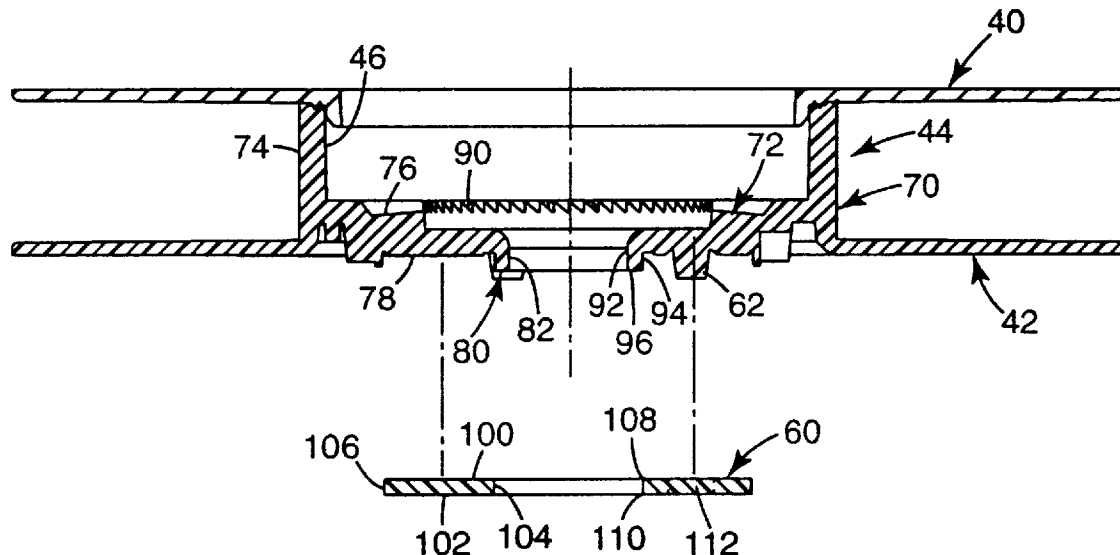

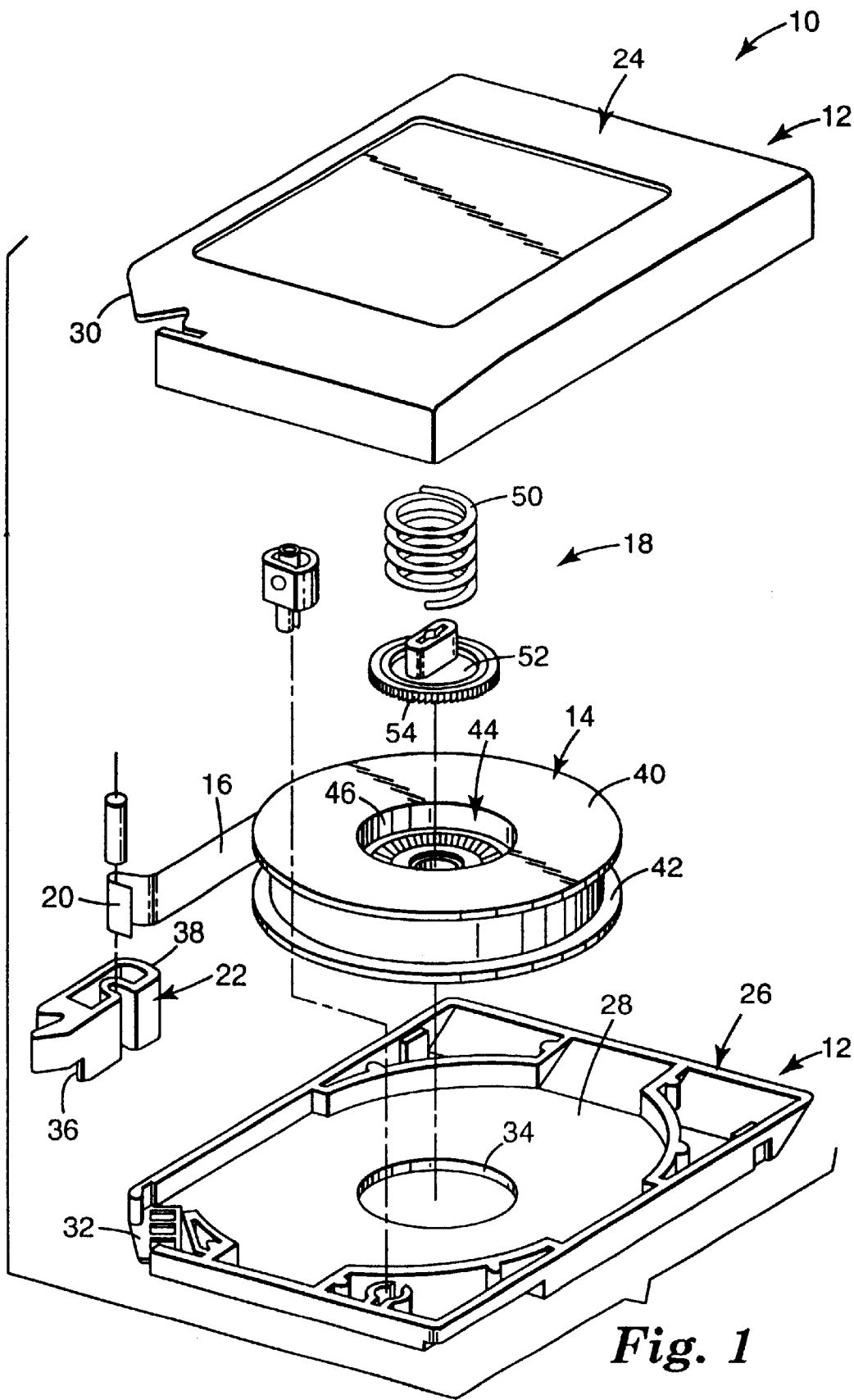
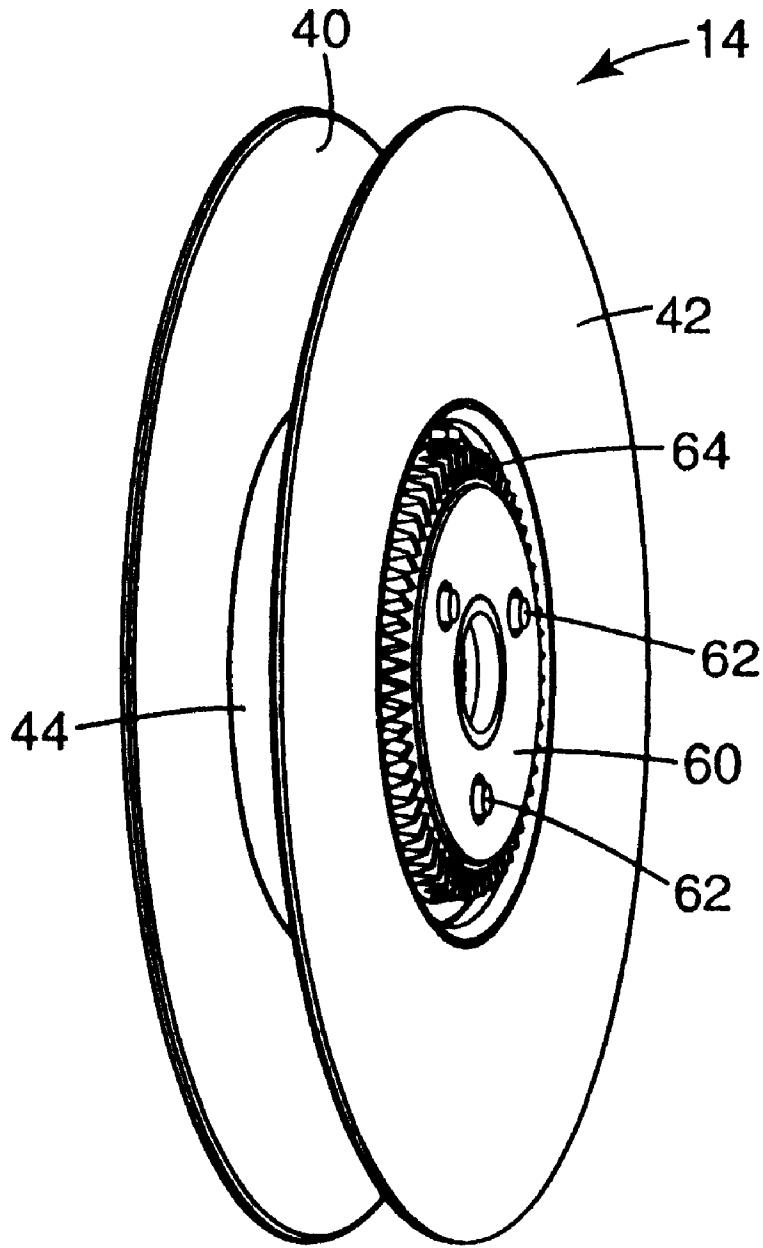
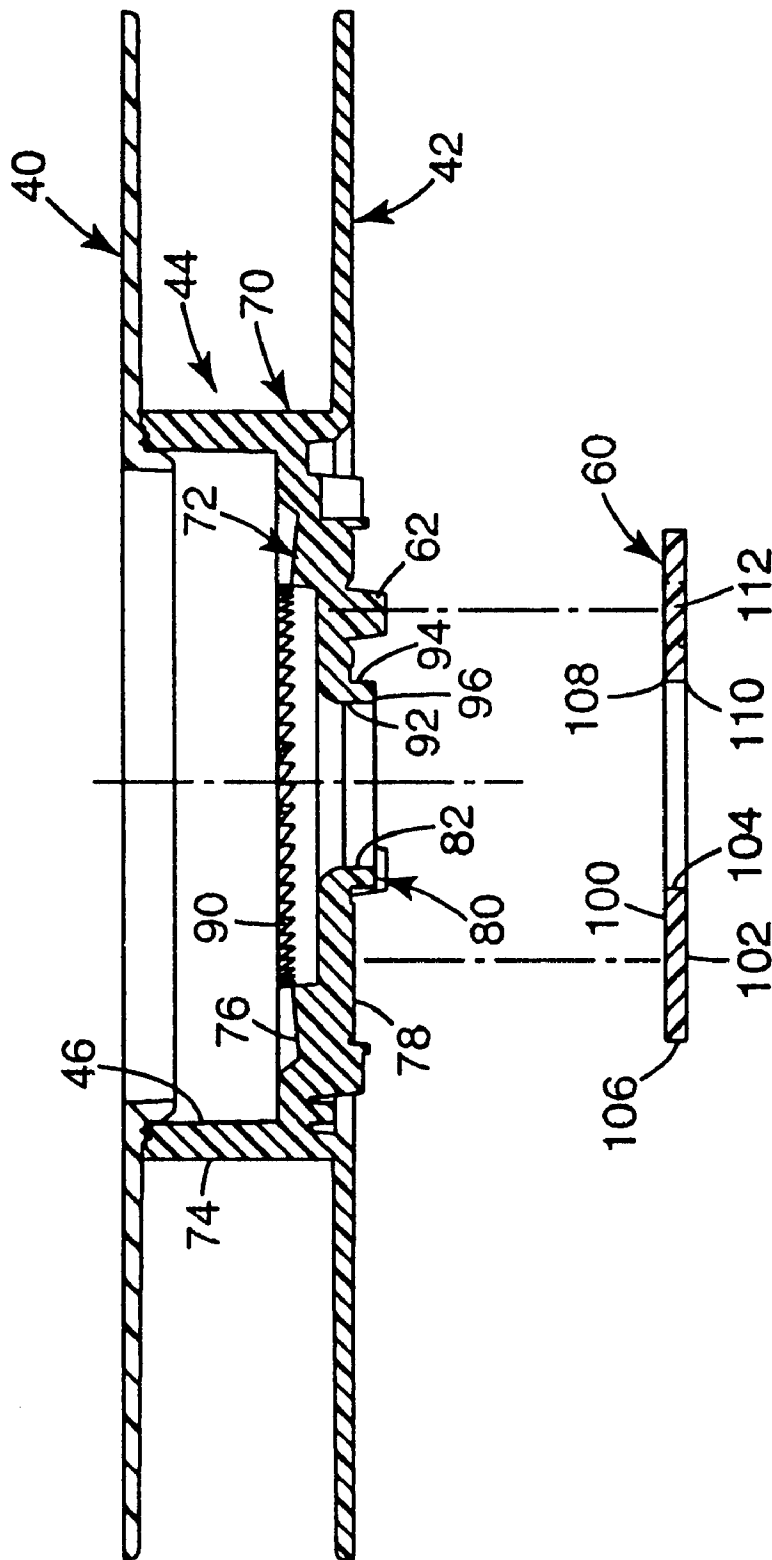

Fig. 1



*Fig. 2*



**Fig. 3A**

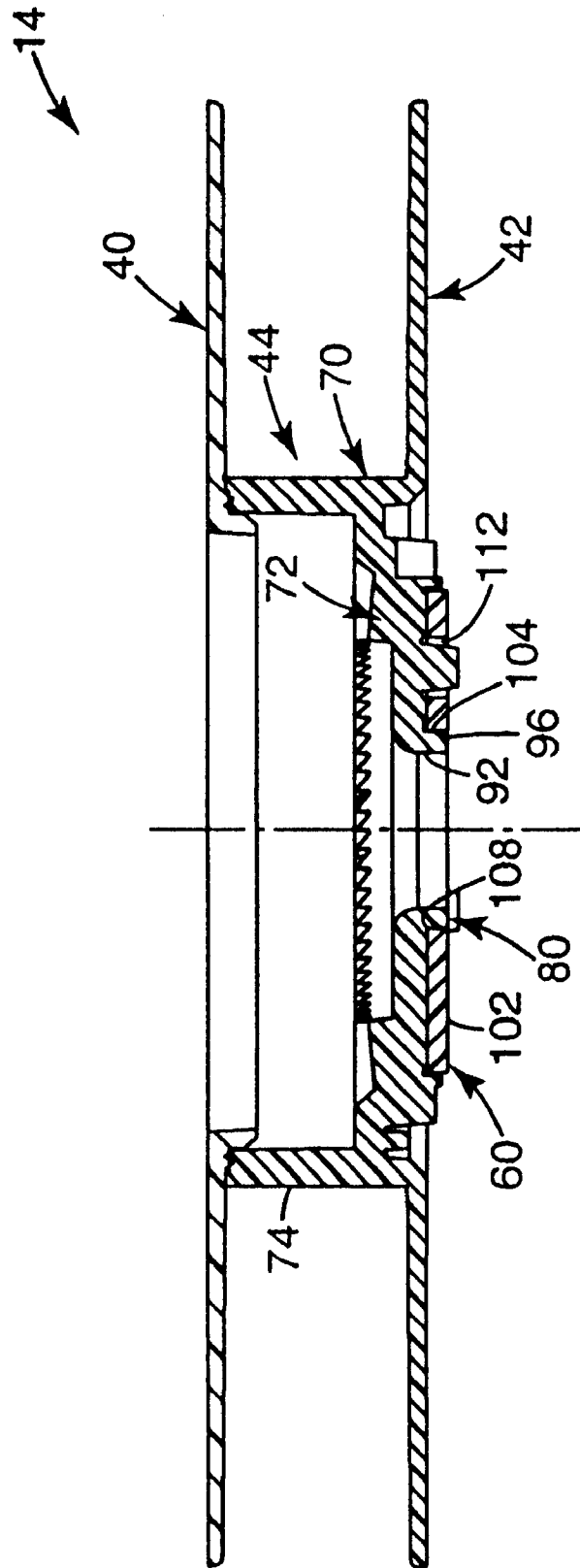

*Fig. 3B*

# Explore Litigation Insights

Docket Alarm provides insights to develop a more informed litigation strategy and the peace of mind of knowing you're on top of things.

## Real-Time Litigation Alerts



Keep your litigation team up-to-date with **real-time alerts** and advanced team management tools built for the enterprise, all while greatly reducing PACER spend.

Our comprehensive service means we can handle Federal, State, and Administrative courts across the country.

## Advanced Docket Research



With over 230 million records, Docket Alarm's cloud-native docket research platform finds what other services can't. Coverage includes Federal, State, plus PTAB, TTAB, ITC and NLRB decisions, all in one place.

Identify arguments that have been successful in the past with full text, pinpoint searching. Link to case law cited within any court document via Fastcase.

## Analytics At Your Fingertips



Learn what happened the last time a particular judge, opposing counsel or company faced cases similar to yours.

Advanced out-of-the-box PTAB and TTAB analytics are always at your fingertips.

## API

Docket Alarm offers a powerful API (application programming interface) to developers that want to integrate case filings into their apps.

## LAW FIRMS

Build custom dashboards for your attorneys and clients with live data direct from the court.

Automate many repetitive legal tasks like conflict checks, document management, and marketing.

## FINANCIAL INSTITUTIONS

Litigation and bankruptcy checks for companies and debtors.

## E-DISCOVERY AND LEGAL VENDORS

Sync your system to PACER to automate legal marketing.