



US007471025B2

(12) **United States Patent**
Sheeran et al.

(10) **Patent No.:** **US 7,471,025 B2**
(45) **Date of Patent:** **Dec. 30, 2008**

(54) **SEGMENTED STATOR WITH IMPROVED HANDLING AND WINDING CHARACTERISTICS**

6,121,711 A 9/2000 Nakahara
6,127,753 A 10/2000 Yamazaki
6,177,751 B1 1/2001 Suzuki
6,226,856 B1 5/2001 Kazama

(75) Inventors: **Kent A. Sheeran**, Festus, MO (US);
Payman Rassoolkhani, Maryland Heights, MO (US); **Paul G. Michaels**, St. Louis, MO (US)

(Continued)

(73) Assignee: **Emerson Electric Co.**, St. Louis, MO (US)

FOREIGN PATENT DOCUMENTS

JP 11-089128 3/1990

(*) Notice: Subject to any disclaimer, the term of this patent is extended or adjusted under 35 U.S.C. 154(b) by 0 days.

(Continued)

(21) Appl. No.: **12/029,998**

OTHER PUBLICATIONS

(22) Filed: **Feb. 12, 2008**

International Search Report, PCT/US03/32557, dated Feb. 27, 2004, 3 pgs.

(65) **Prior Publication Data**

US 2008/0129142 A1 Jun. 5, 2008

Primary Examiner—Dang D Le
(74) *Attorney, Agent, or Firm*—Senniger Powers LLP

Related U.S. Application Data

(57) **ABSTRACT**

(60) Continuation of application No. 11/534,705, filed on Sep. 25, 2006, now Pat. No. 7,345,397, and a division of application No. 10/427,450, filed on Apr. 30, 2003, now Pat. No. 7,111,380.

(60) Provisional application No. 60/422,676, filed on Oct. 31, 2002.

A stator assembly has discrete stacks of laminations. A plurality of nonmagnetic containment structures define pockets. The stacks are at least partially received in the pockets and coupled to one another by the containment structure. The containment structures are moveable between a first configuration in which the stacks are separate from one another and a second configuration in which yokes of adjacent stacks are in physical contact with one another. In a method of making a stator assembly, a plurality of stator segments are positioned so each is received in one of a plurality of pockets in a containment structure. Coils are wound around each stator segment while the containment structure prevents the stator segment from having direct physical contact with another stator segment. The containment structure is reconfigured to bring the wound stator segments into contact with one another, thereby forming a closed magnetic circuit.

(51) **Int. Cl.**
H02K 1/06 (2006.01)

(52) **U.S. Cl.** **310/217; 310/218**

(58) **Field of Classification Search** 310/216–218
See application file for complete search history.

(56) **References Cited**

U.S. PATENT DOCUMENTS

4,350,914 A 9/1982 Searle
5,592,731 A 1/1997 Huang
5,729,072 A 3/1998 Hirano
6,081,059 A 6/2000 Hsu

8 Claims, 9 Drawing Sheets

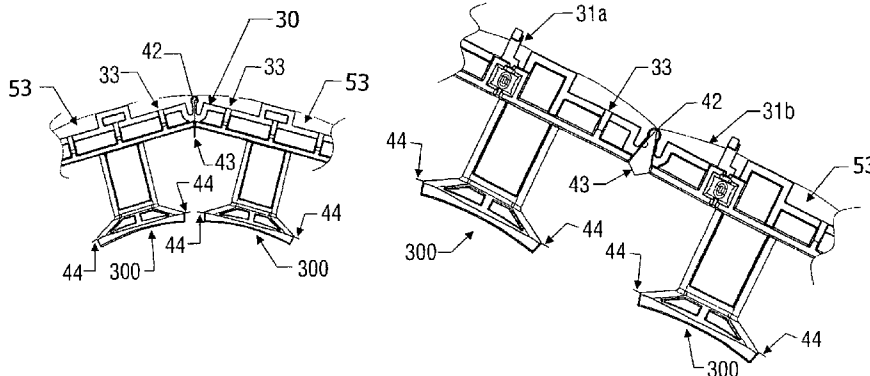

U.S. PATENT DOCUMENTS

6,362,553 B1 3/2002 Nakahara
6,369,687 B1 4/2002 Akita
6,487,769 B2 12/2002 Ketterer
6,504,284 B1 1/2003 Kazama
6,509,665 B1 1/2003 Nishiyama
6,573,632 B2 6/2003 Hsu
6,584,813 B2 7/2003 Peachee
6,659,385 B2 12/2003 Akita
6,700,284 B2 3/2004 Williams
6,737,778 B2 5/2004 Daikoku
6,741,005 B2 5/2004 Vohlgemuth
6,744,166 B2 6/2004 Harter
6,856,064 B2 2/2005 Masumoto
6,897,591 B2 5/2005 Peachee
7,012,350 B2 3/2006 Peachee

7,067,952 B2 * 6/2006 Neal 310/259
7,084,545 B2 * 8/2006 Happel 310/218
2001/0030483 A1 10/2001 Masumoto
2002/0093269 A1 7/2002 Harter
2002/0139606 A1 10/2002 Williams
2004/0051417 A1 3/2004 Yamazaki

FOREIGN PATENT DOCUMENTS

JP 7-245895 9/1995
JP 9-191588 7/1997
JP 11-341717 12/1999
JP 2001-025185 1/2001
JP 2002-218716 2/2002
JP 2002-305848 10/2002
WO 02-47240 A1 6/2002

* cited by examiner

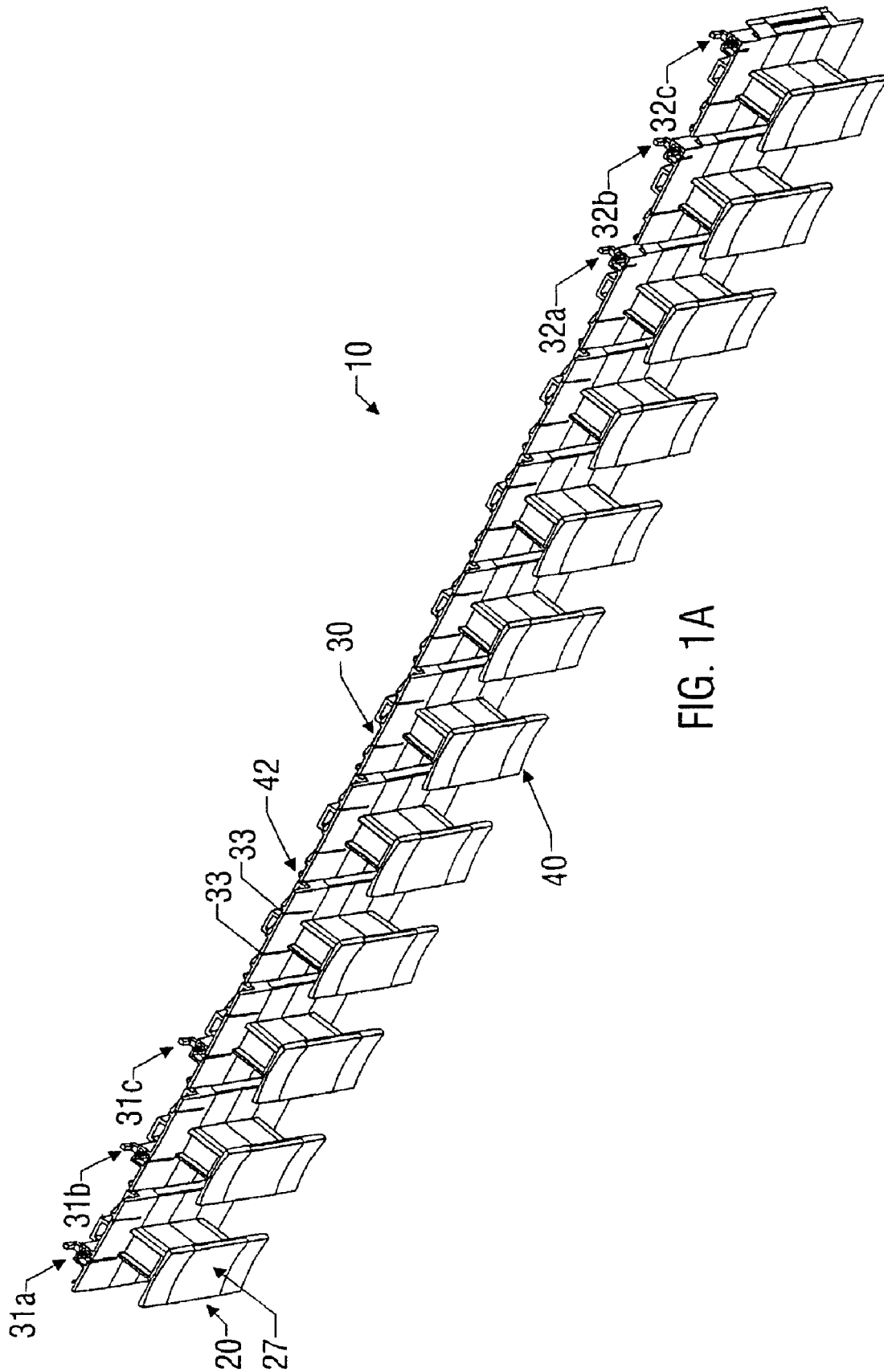

FIG. 1A

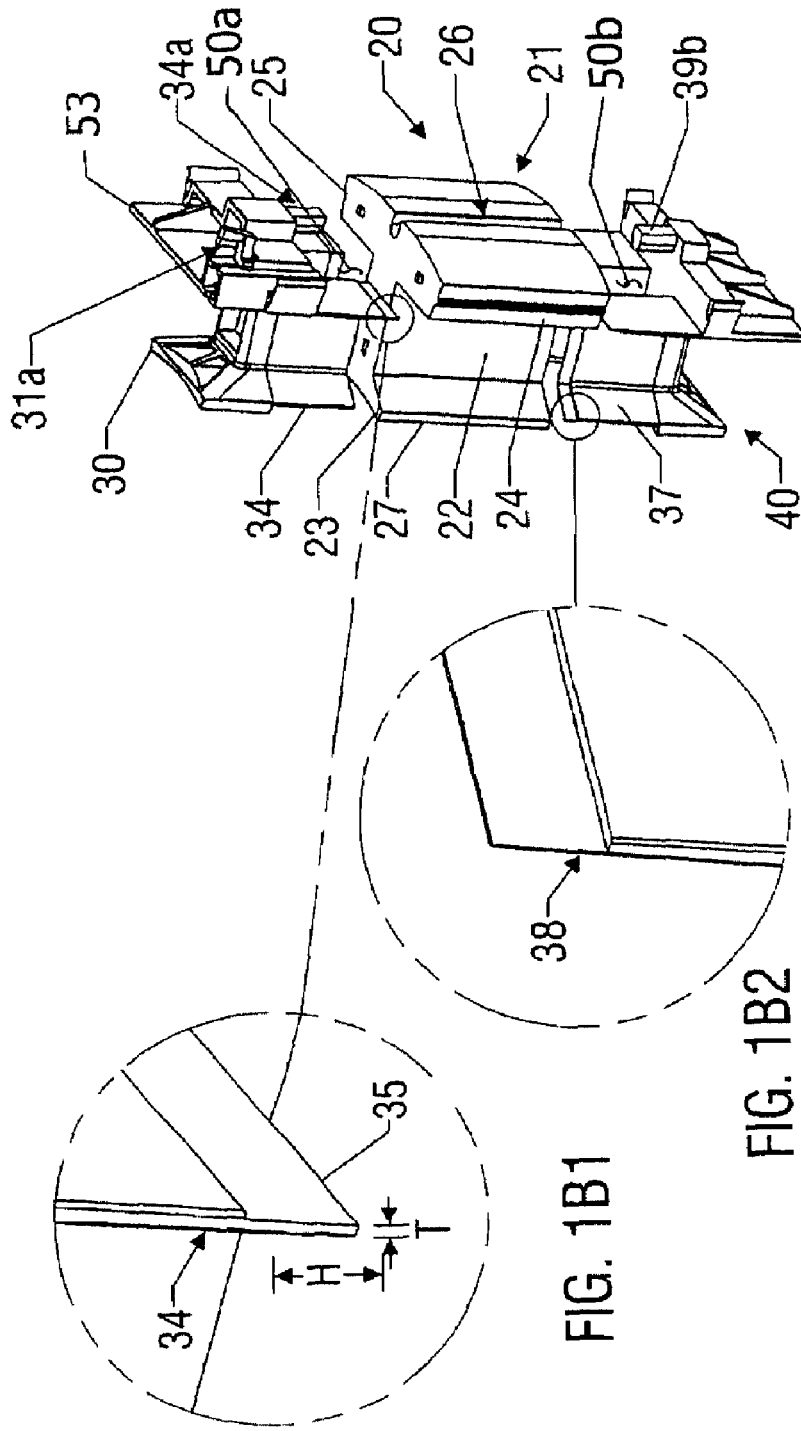

FIG. 1B

FIG. 1B1

FIG. 1B2

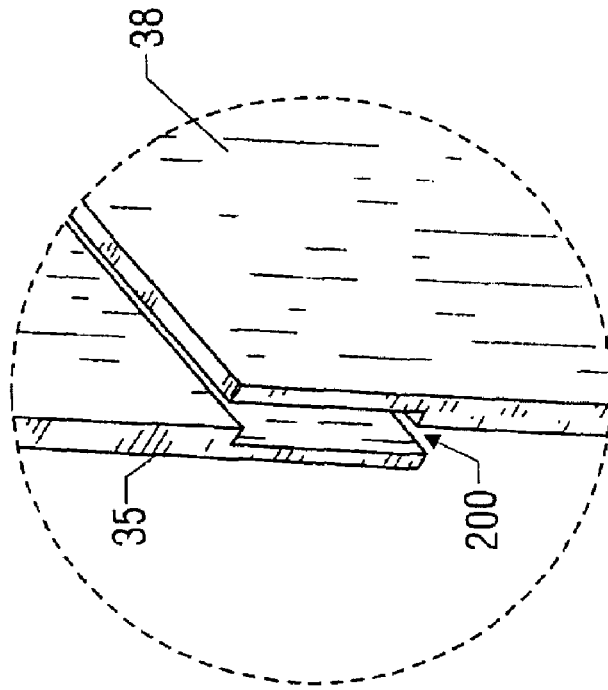

FIG. 1D

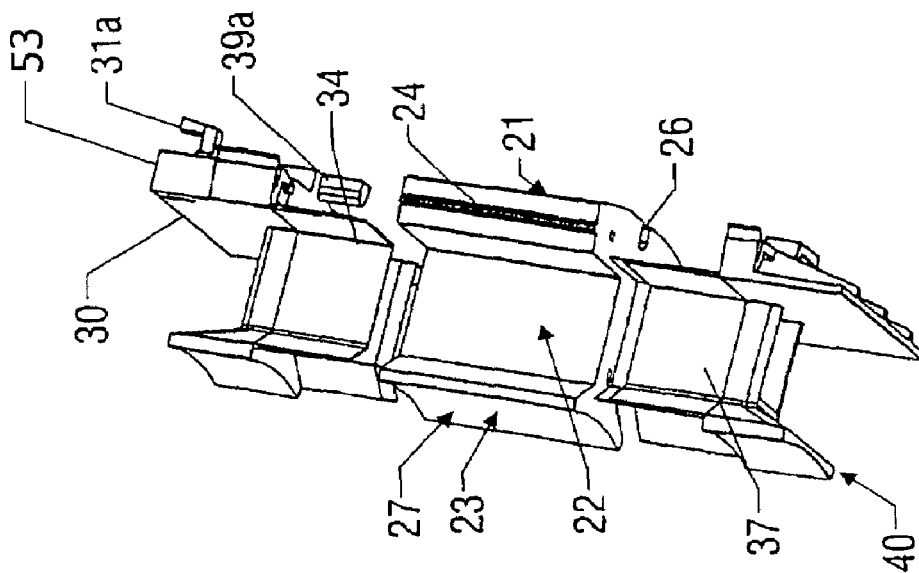

FIG. 1C

Explore Litigation Insights

Docket Alarm provides insights to develop a more informed litigation strategy and the peace of mind of knowing you're on top of things.

Real-Time Litigation Alerts



Keep your litigation team up-to-date with **real-time alerts** and advanced team management tools built for the enterprise, all while greatly reducing PACER spend.

Our comprehensive service means we can handle Federal, State, and Administrative courts across the country.

Advanced Docket Research



With over 230 million records, Docket Alarm's cloud-native docket research platform finds what other services can't. Coverage includes Federal, State, plus PTAB, TTAB, ITC and NLRB decisions, all in one place.

Identify arguments that have been successful in the past with full text, pinpoint searching. Link to case law cited within any court document via Fastcase.

Analytics At Your Fingertips



Learn what happened the last time a particular judge, opposing counsel or company faced cases similar to yours.

Advanced out-of-the-box PTAB and TTAB analytics are always at your fingertips.

API

Docket Alarm offers a powerful API (application programming interface) to developers that want to integrate case filings into their apps.

LAW FIRMS

Build custom dashboards for your attorneys and clients with live data direct from the court.

Automate many repetitive legal tasks like conflict checks, document management, and marketing.

FINANCIAL INSTITUTIONS

Litigation and bankruptcy checks for companies and debtors.

E-DISCOVERY AND LEGAL VENDORS

Sync your system to PACER to automate legal marketing.