

(12) **United States Patent**
Takatsuka et al.

(10) **Patent No.:** **US 6,524,186 B2**
(45) **Date of Patent:** ***Feb. 25, 2003**

(54) **GAME INPUT MEANS TO REPLICATE HOW OBJECT IS HANDLED BY CHARACTER**

5,269,519 A * 12/1993 Malone
5,288,078 A * 2/1994 Capper et al.

(75) Inventors: **Susumu Takatsuka**, Tokyo (JP);
Kenkichi Shimooka, Tokyo (JP); **Yuji Yamada**, Tokyo (JP)

(List continued on next page.)

FOREIGN PATENT DOCUMENTS

(73) Assignee: **Sony Computer Entertainment, Inc.**, Tokyo (JP)

AU	70018/96	4/1997
AU	25220/97	5/1998
CA	2184001	2/1997
JP	4-156875	5/1992
JP	9-24161	1/1997
JP	9-50539	2/1997

(*) Notice: This patent issued on a continued prosecution application filed under 37 CFR 1.53(d), and is subject to the twenty year patent term provisions of 35 U.S.C. 154(a)(2).

OTHER PUBLICATIONS

Subject to any disclaimer, the term of this patent is extended or adjusted under 35 U.S.C. 154(b) by 0 days.

Virtual Pool instruction Manual, 1996.*
Links 386 CD Players Manual, 1995.*
Gamest Mook vol. 112 The Best Game 2 (Japan) K.K. Shinseisha, 17. 01. 98).

Primary Examiner—Michael O’Neill
(74) *Attorney, Agent, or Firm*—Katten Muchin Zavis Rosenman

(21) Appl. No.: **09/322,776**

(22) Filed: **May 28, 1999**

(65) **Prior Publication Data**

US 2002/0068628 A1 Jun. 6, 2002

(30) **Foreign Application Priority Data**

Jun. 1, 1998 (JP) 10-151528

(51) **Int. Cl.**⁷ **A63F 13/00**

(52) **U.S. Cl.** **463/37; 463/31; 463/43**

(58) **Field of Search** 463/1, 2, 4, 5,
463/6, 7, 8, 23, 31, 35, 36, 37, 38, 39,
40, 41, 42, 43, 44, 46, 50, 52; 434/21,
22, 69

(56) **References Cited**

U.S. PATENT DOCUMENTS

- 4,672,541 A * 6/1987 Bromley et al.
- 4,817,950 A * 4/1989 Goo
- 5,080,377 A * 1/1992 Stamper et al.
- 5,229,756 A * 7/1993 Kosugi et al.
- 5,239,463 A * 8/1993 Blair et al.

(57) **ABSTRACT**

An entertainment system and a recording medium on which a system is recorded that makes it possible for a character in a game space to handle an object so that a player can make with respect to an operation device of the entertainment system a movement that is related to the actual way an object is handled. A game is played in the entertainment system in accordance with this program. Commands by a player are input from an input operation system. Mounted in an optical disk device built into an optical disk controller of the entertainment system is a CD-ROM on which is recorded a program by which, using his fingers, the player moves operation parts of the input operation device with movements which are related to the way in which objects are actually handled by characters in a game space, thereby analogously moving the object of the character in the game space in two directions. A control system controls the actions of player characters on a display screen based on the program from the CD-ROM and commands from the input operation system.

19 Claims, 21 Drawing Sheets

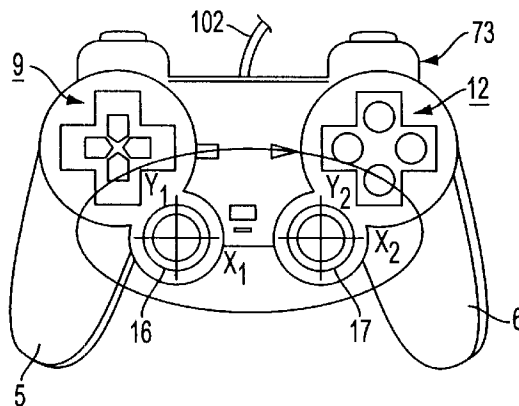

U.S. PATENT DOCUMENTS

5,435,554 A *	7/1995	Lipson		5,971,853 A *	10/1999	Kataoka et al.	463/36
5,442,168 A *	8/1995	Gurner et al.		5,989,123 A *	11/1999	Tosaki et al.	
5,551,693 A *	9/1996	Goto et al.		6,010,405 A *	1/2000	Morawiec	
5,556,107 A *	9/1996	Carter	463/35	6,028,593 A *	2/2000	Rosenberg et al.	
5,616,078 A *	4/1997	Oh		6,030,290 A *	2/2000	Powell	
5,643,087 A *	7/1997	Marcus et al.		6,132,314 A *	10/2000	Aiki	
5,649,861 A *	7/1997	Okano et al.		6,162,123 A *	12/2000	Woolston	
5,692,956 A *	12/1997	Rifkin		6,171,187 B1 *	1/2001	Audebert et al.	
5,704,837 A *	1/1998	Iwasaki et al.	463/38	6,200,219 B1 *	3/2001	Rudell et al.	
5,734,370 A *	3/1998	Skodlar		6,217,444 B1 *	4/2001	Kataoka et al.	
5,833,549 A *	11/1998	Zur et al.		6,220,963 B1 *	4/2001	Meredith	
5,853,327 A *	12/1998	Gilboa		6,227,968 B1 *	5/2001	Suzuki et al.	
5,903,257 A *	5/1999	Nishiumi et al.		6,227,974 B1 *	5/2001	Eilat et al.	
5,913,727 A *	6/1999	Ahdoot		6,251,015 B1 *	6/2001	Caprai	
5,919,092 A *	7/1999	Yokoi et al.	463/37	6,312,335 B1 *	11/2001	Tosalki et al.	
5,931,734 A *	8/1999	Nakatani et al.	463/23	6,368,217 B2 *	4/2002	Kanno et al.	
5,933,152 A *	8/1999	Naruki et al.					

* cited by examiner

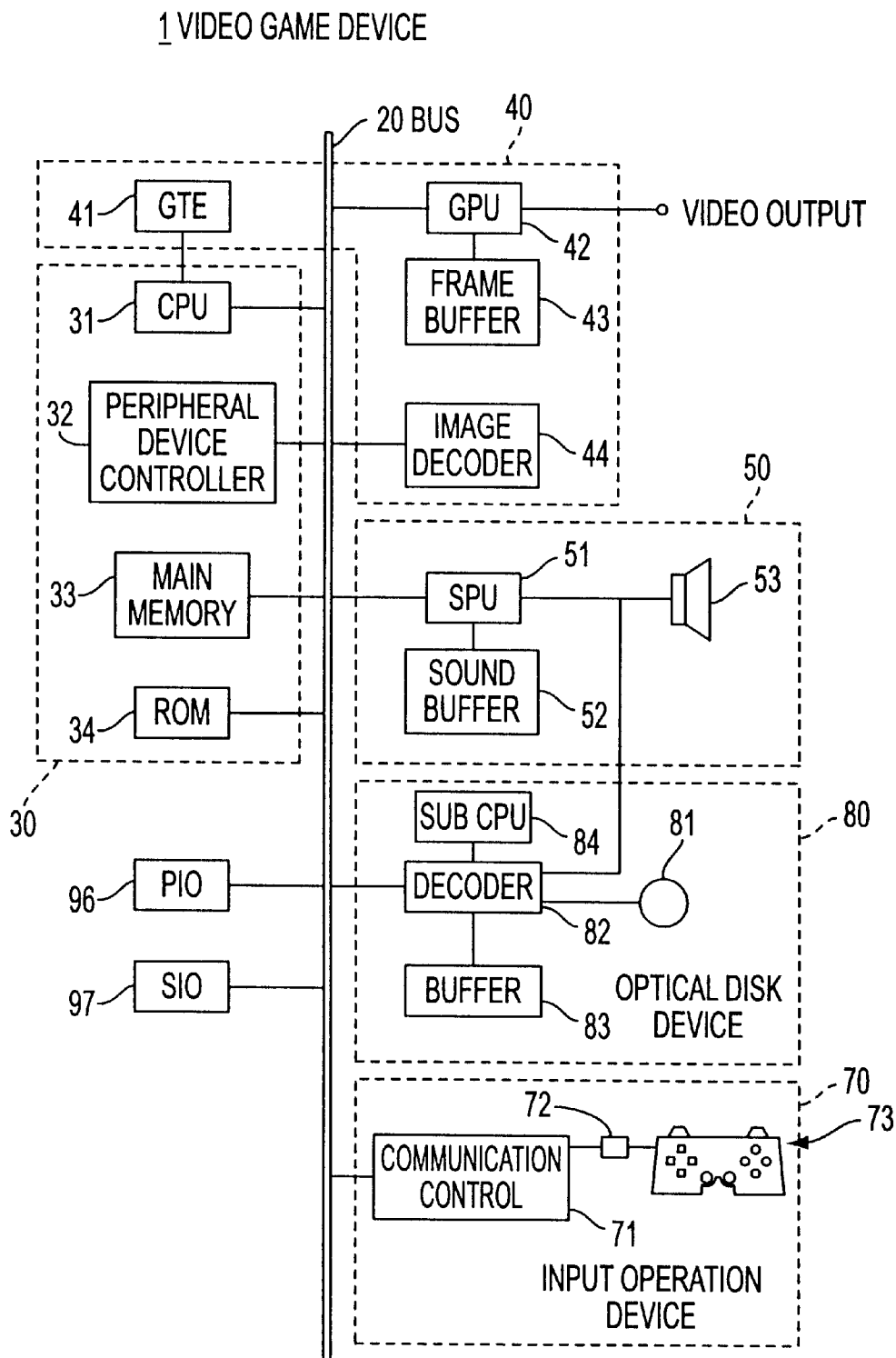

FIG. 1

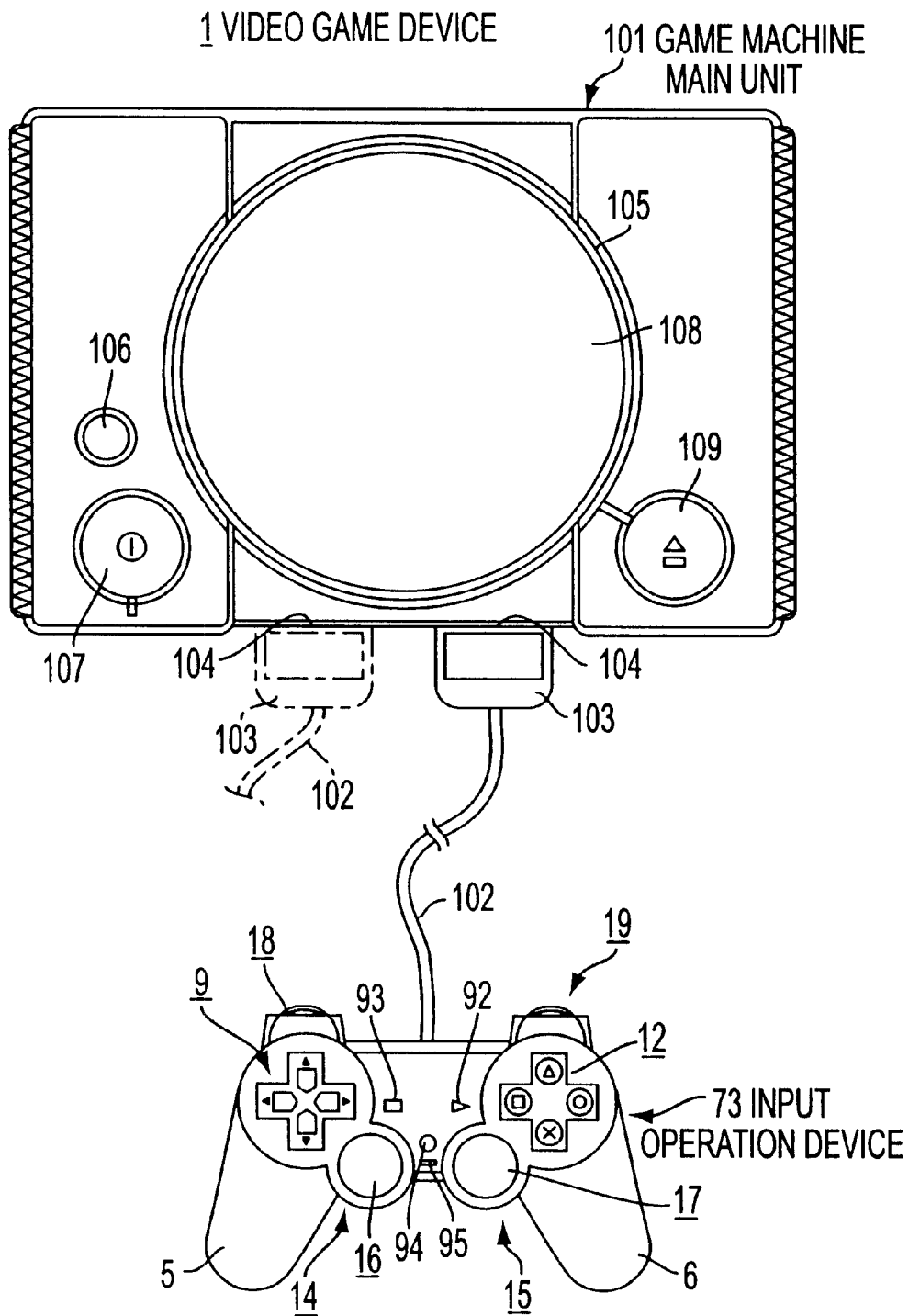

FIG. 2

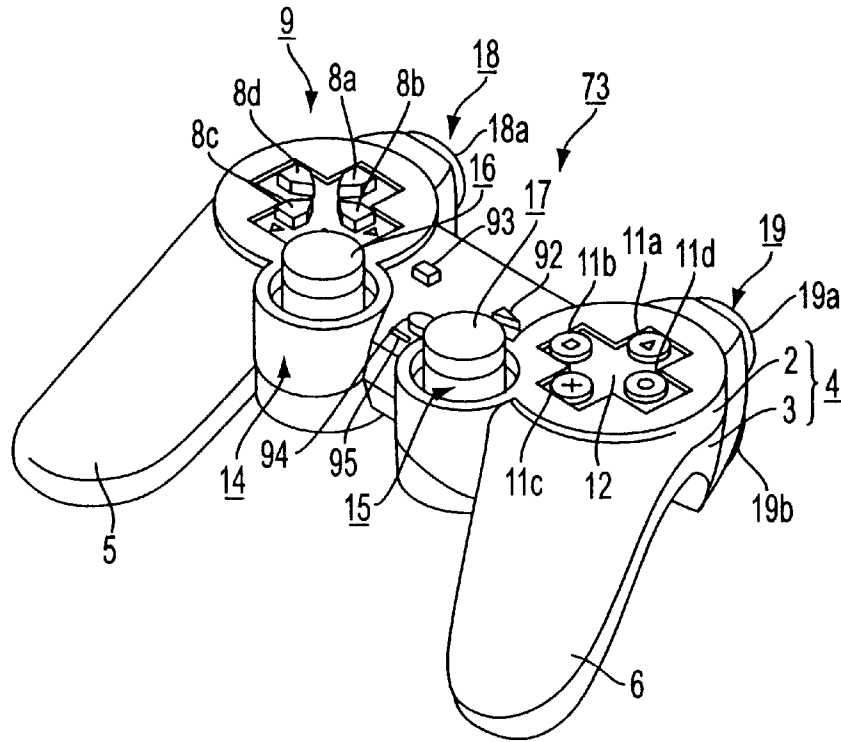

FIG. 3

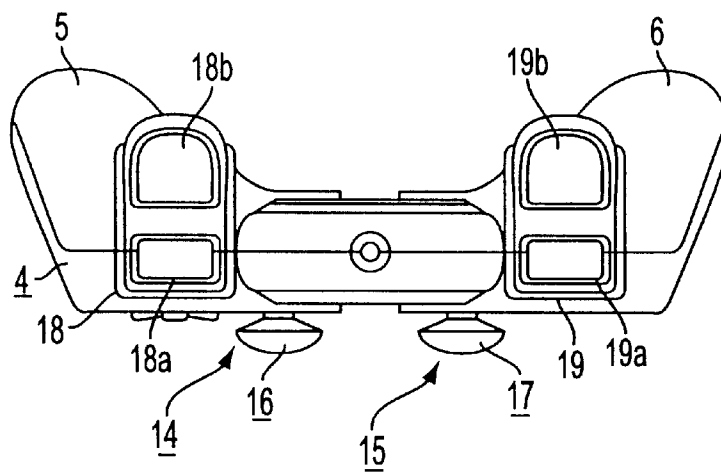

FIG. 4

Explore Litigation Insights

Docket Alarm provides insights to develop a more informed litigation strategy and the peace of mind of knowing you're on top of things.

Real-Time Litigation Alerts



Keep your litigation team up-to-date with **real-time alerts** and advanced team management tools built for the enterprise, all while greatly reducing PACER spend.

Our comprehensive service means we can handle Federal, State, and Administrative courts across the country.

Advanced Docket Research



With over 230 million records, Docket Alarm's cloud-native docket research platform finds what other services can't. Coverage includes Federal, State, plus PTAB, TTAB, ITC and NLRB decisions, all in one place.

Identify arguments that have been successful in the past with full text, pinpoint searching. Link to case law cited within any court document via Fastcase.

Analytics At Your Fingertips



Learn what happened the last time a particular judge, opposing counsel or company faced cases similar to yours.

Advanced out-of-the-box PTAB and TTAB analytics are always at your fingertips.

API

Docket Alarm offers a powerful API (application programming interface) to developers that want to integrate case filings into their apps.

LAW FIRMS

Build custom dashboards for your attorneys and clients with live data direct from the court.

Automate many repetitive legal tasks like conflict checks, document management, and marketing.

FINANCIAL INSTITUTIONS

Litigation and bankruptcy checks for companies and debtors.

E-DISCOVERY AND LEGAL VENDORS

Sync your system to PACER to automate legal marketing.