



US006049192A

# United States Patent [19]

[11] Patent Number: **6,049,192**

**Kfoury et al.**

[45] Date of Patent: **Apr. 11, 2000**

[54] **BATTERY CHARGER HAVING MOVING DOOR HOUSING FOR A BATTERY**

5,347,208 9/1994 Iida .  
5,525,888 6/1996 Toya .  
5,656,914 8/1997 Nagele et al. .

[75] Inventors: **Tony N. Kfoury**, Lisle; **Jon Godston**, Chicago; **Robert Hertlein**, Round Lake Beach; **Andrew A. Powell**, Chicago, all of Ill.

### OTHER PUBLICATIONS

NTT Do Co Mo, Mo Va, 94-4, Japan, pp. 1, 88, 90, year 1994.

[73] Assignee: **Motorola, Inc.**, Schaumburg, Ill.

*Primary Examiner*—Edward H. Tso  
*Attorney, Agent, or Firm*—Michael C. Soldner; Randall S. Vaas

[21] Appl. No.: **09/271,831**

[22] Filed: **Mar. 18, 1999**

### [57] ABSTRACT

[51] **Int. Cl.**<sup>7</sup> ..... **H01M 10/46**  
[52] **U.S. Cl.** ..... **320/113; 320/115**  
[58] **Field of Search** ..... 320/107, 110,  
320/112, 113, 114, 115; D13/103, 107,  
108; 429/99, 100

A battery charger includes a main housing (103). A well (108) in the main housing is for receipt of an electronic device (102) including a battery. A door housing (104) is movably carried on the main housing. At least one contact (422) is carried on the main housing for connection to a battery (200, 300) inserted between the door housing and the main housing, wherein the door housing is movable between an open position for receipt of a battery and a compact closed position. A circuit is positioned in the main housing for electrical connection to the electronic device and the contacts for charging a battery.

### [56] References Cited

#### U.S. PATENT DOCUMENTS

D. 349,883 8/1994 Gallagher et al. .  
D. 353,131 12/1994 Nagele .  
5,059,885 10/1991 Weiss et al. .  
5,327,067 7/1994 Scholder .

**20 Claims, 11 Drawing Sheets**

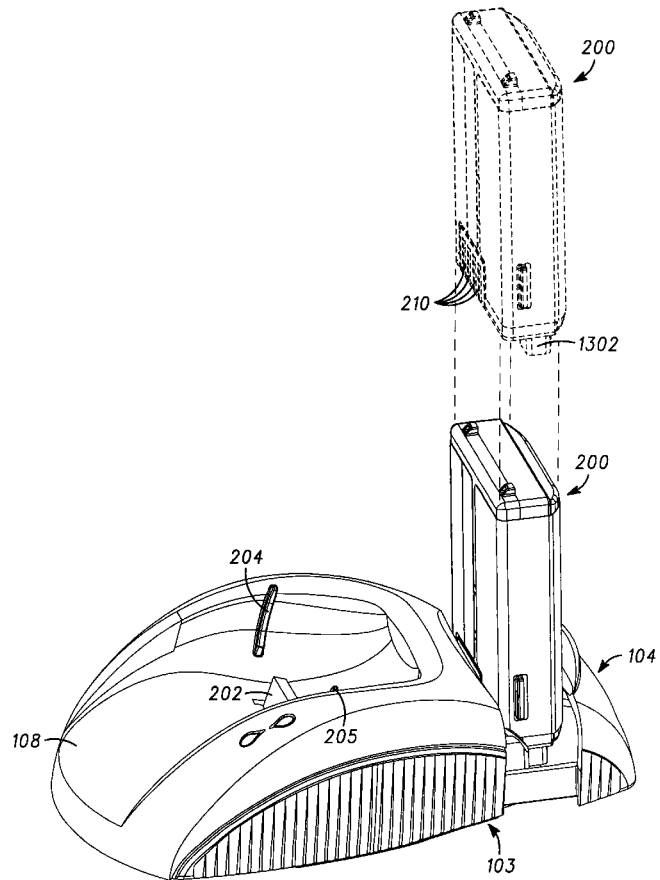
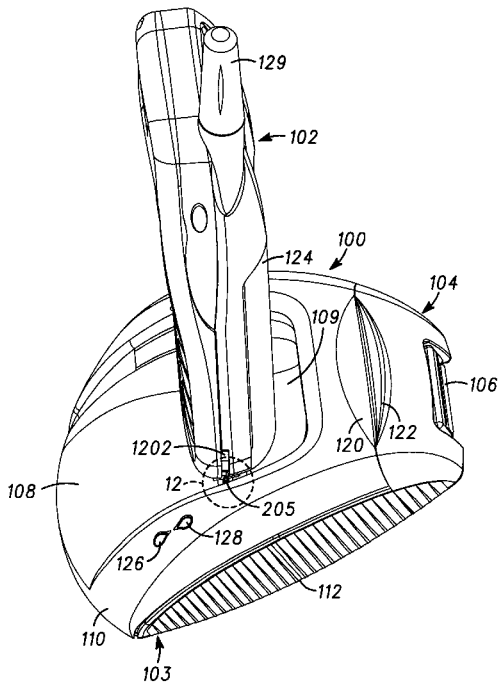

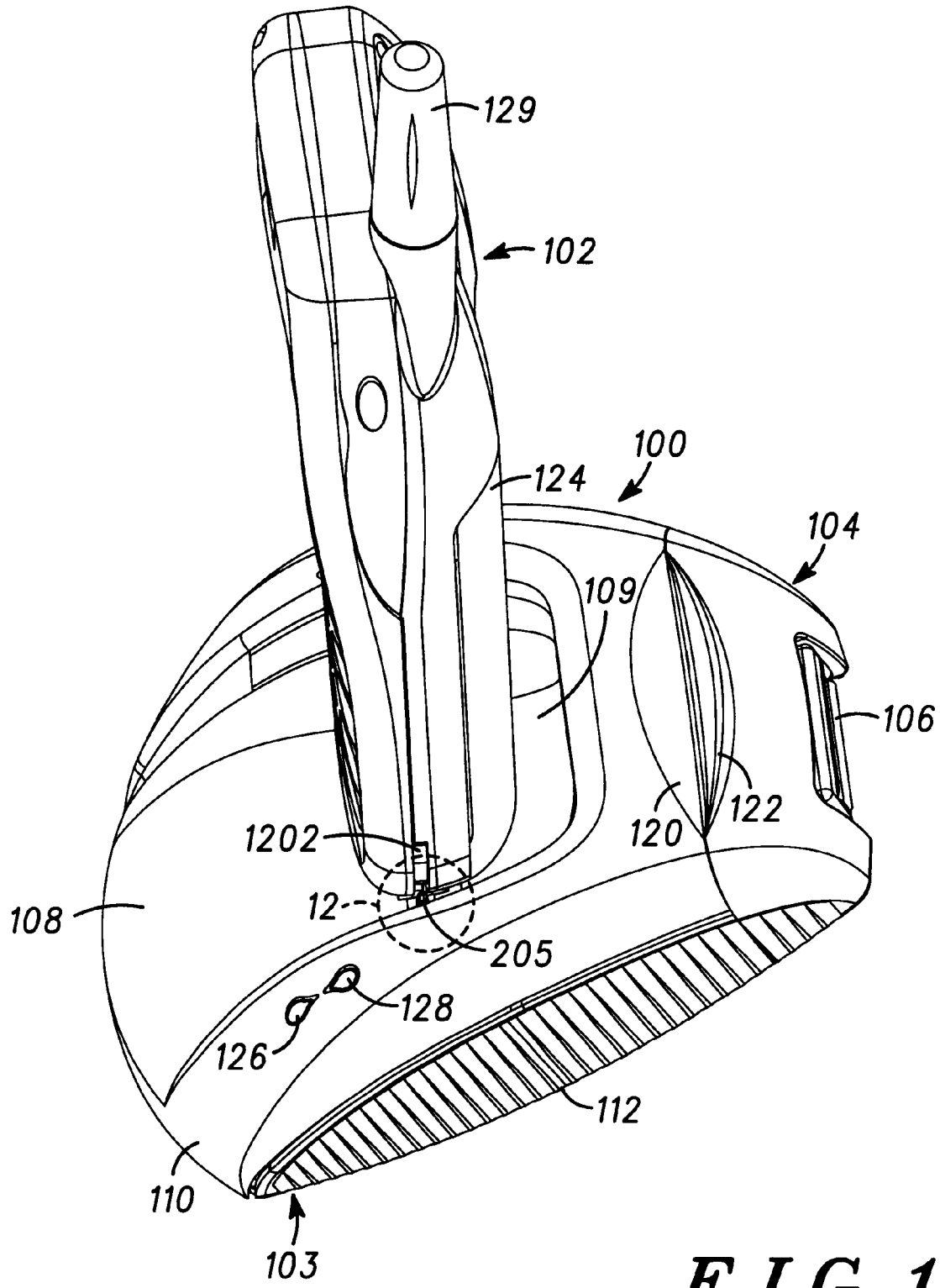

**FIG. 1**

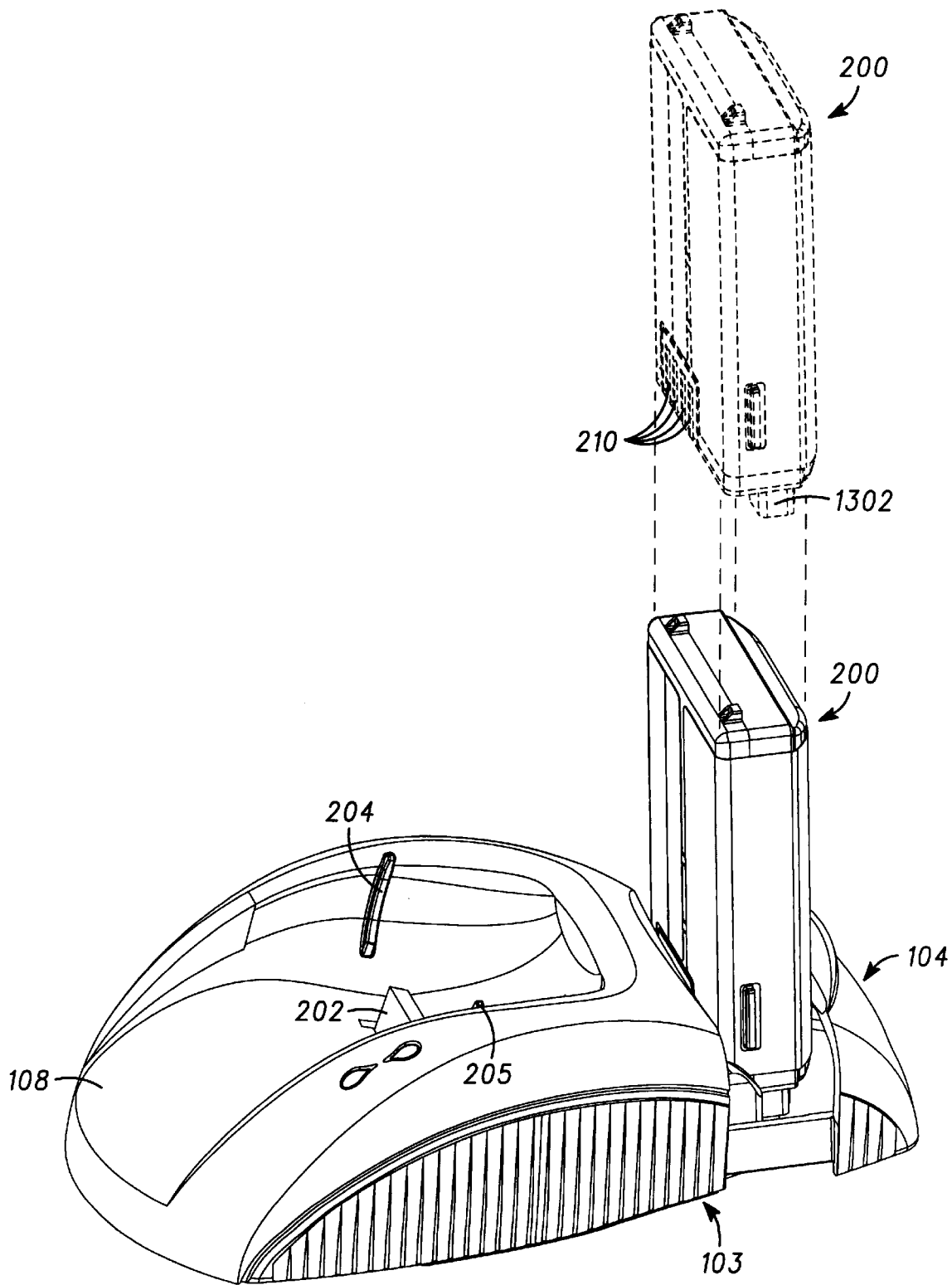
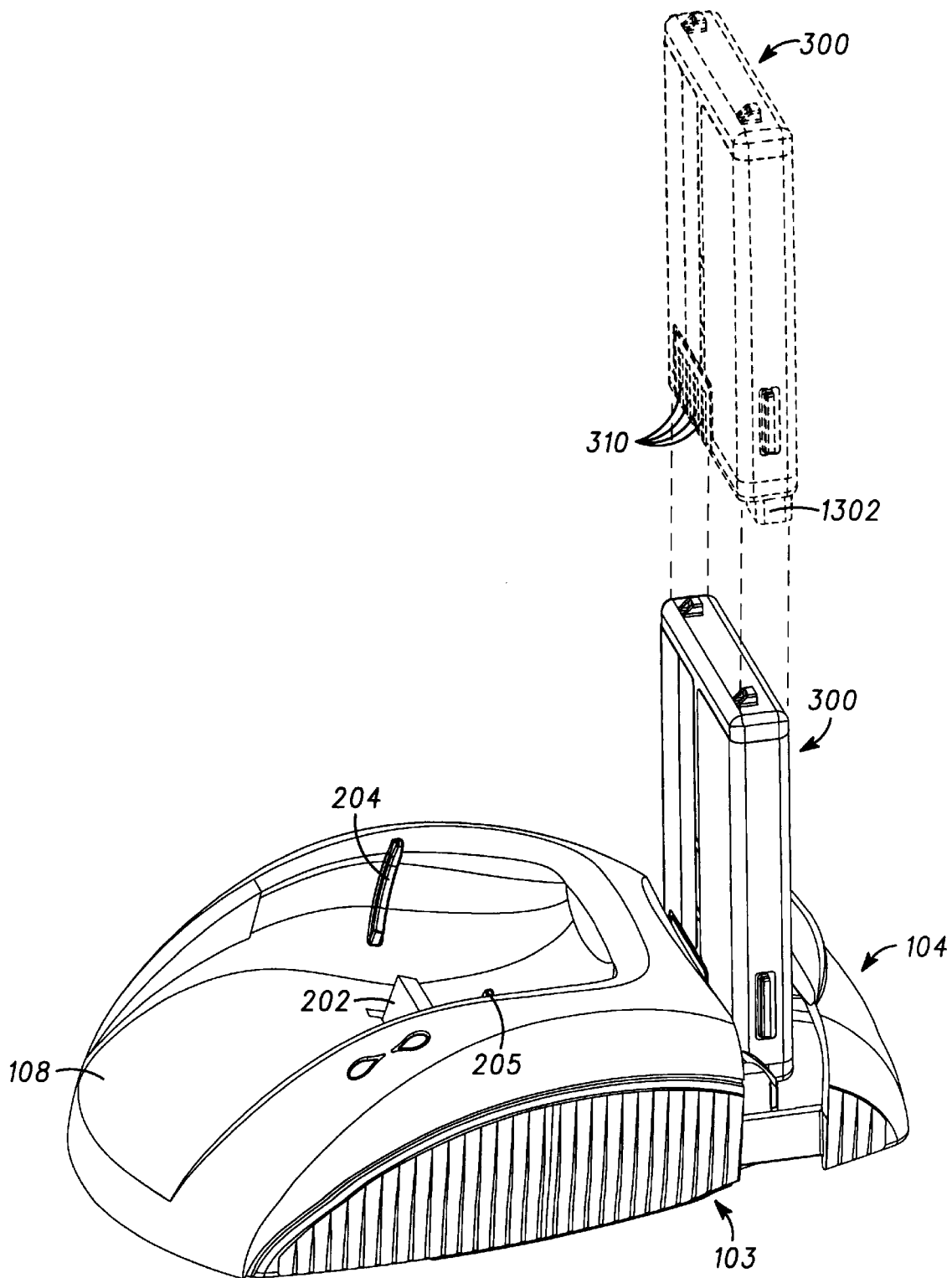
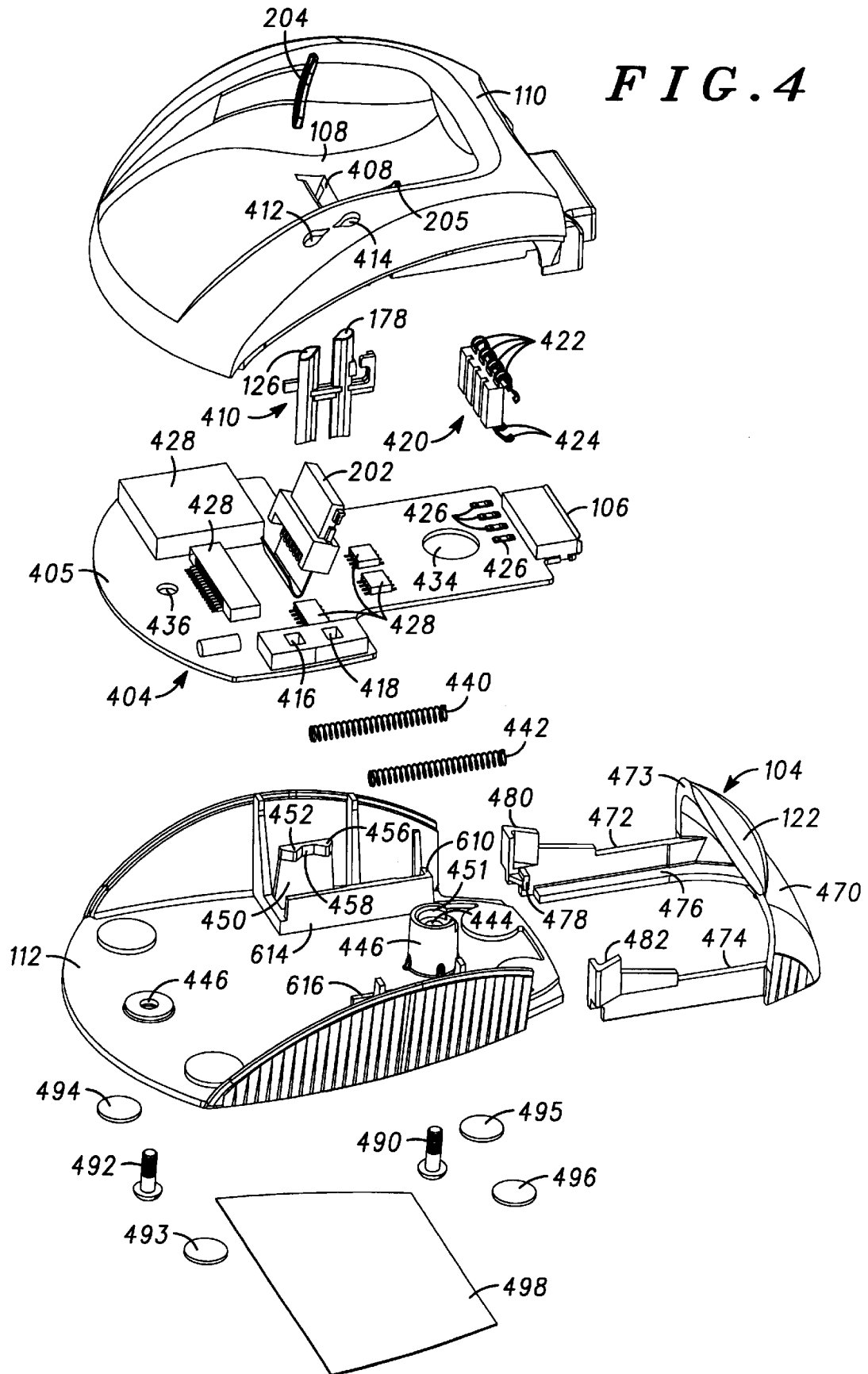

FIG. 2



**FIG. 3**



# Explore Litigation Insights

Docket Alarm provides insights to develop a more informed litigation strategy and the peace of mind of knowing you're on top of things.

## Real-Time Litigation Alerts



Keep your litigation team up-to-date with **real-time alerts** and advanced team management tools built for the enterprise, all while greatly reducing PACER spend.

Our comprehensive service means we can handle Federal, State, and Administrative courts across the country.

## Advanced Docket Research



With over 230 million records, Docket Alarm's cloud-native docket research platform finds what other services can't. Coverage includes Federal, State, plus PTAB, TTAB, ITC and NLRB decisions, all in one place.

Identify arguments that have been successful in the past with full text, pinpoint searching. Link to case law cited within any court document via Fastcase.

## Analytics At Your Fingertips



Learn what happened the last time a particular judge, opposing counsel or company faced cases similar to yours.

Advanced out-of-the-box PTAB and TTAB analytics are always at your fingertips.

## API

Docket Alarm offers a powerful API (application programming interface) to developers that want to integrate case filings into their apps.

## LAW FIRMS

Build custom dashboards for your attorneys and clients with live data direct from the court.

Automate many repetitive legal tasks like conflict checks, document management, and marketing.

## FINANCIAL INSTITUTIONS

Litigation and bankruptcy checks for companies and debtors.

## E-DISCOVERY AND LEGAL VENDORS

Sync your system to PACER to automate legal marketing.