

[54] RIDE-ON TOY VEHICLE WITH FRONT WHEEL DRIVE AND OUTBOARD FRONT WHEELS

[76] Inventors: Robert DeGraaff, 20 Kennedy Dr., Flanders, N.J. 07836; Michael Langeiri, 425 Inverness La., Longmeadow, Mass. 01106

[21] Appl. No.: 491,422

[22] Filed: May 4, 1983

[51] Int. Cl.<sup>3</sup> ..... B62K 9/00

[52] U.S. Cl. .... 280/1.11 R; 296/177; D12/83

[58] Field of Search ..... 280/1.11 R, 1.1 R, 1.21, 280/1.22; 296/177; D12/108, 83

[56] References Cited

U.S. PATENT DOCUMENTS

- D. 213,511 3/1969 Moribe .
- 1,796,339 3/1931 Nicholson ..... 280/1.11 R
- 3,151,872 10/1964 Weber, Sr. .... 280/1.11 R
- 3,416,625 12/1968 Narutani ..... 280/1.11 X
- 3,684,046 8/1972 Begleiter ..... 280/1.11 R

3,842,928 10/1974 Kishi ..... 180/214  
4,361,338 11/1982 Kuchenbecker et al. .... 280/1.11 R

Primary Examiner—John A. Pekar

[57] ABSTRACT

A child's pedal-powered vehicle simulating a four wheel drive vehicle includes a body on which there is rotatably supported a pair of rear wheels. Centrally of its front end portion is a drive and steering assembly which is rotatable within the body to effect rotation of a pedal-powered drive wheel at lower end thereof to effect turning motion of the wheel and thereby the vehicle. Mounted on the front end portion of the body outboard of the drive wheel are a pair of outboard front wheels which will readily move vertically on the body to adjust to differences in ground contour while presenting little resistance to turning of the vehicle. In one embodiment, there is included means for limiting the vertical movement so that these wheels will stop upward movement at a point where overturning might occur.

8 Claims, 9 Drawing Figures

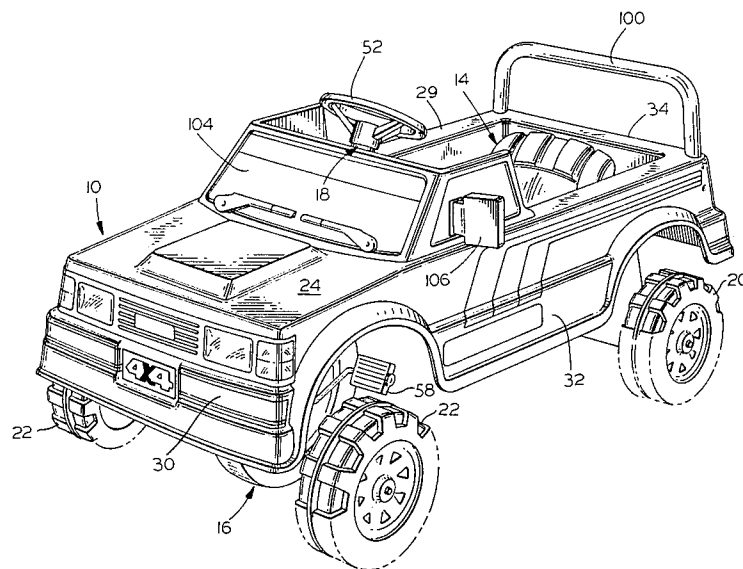

Dynacraft BSC, Inc.  
**Exhibit 1005**  
 Dynacraft v. Mattel  
 IPR2018-00042

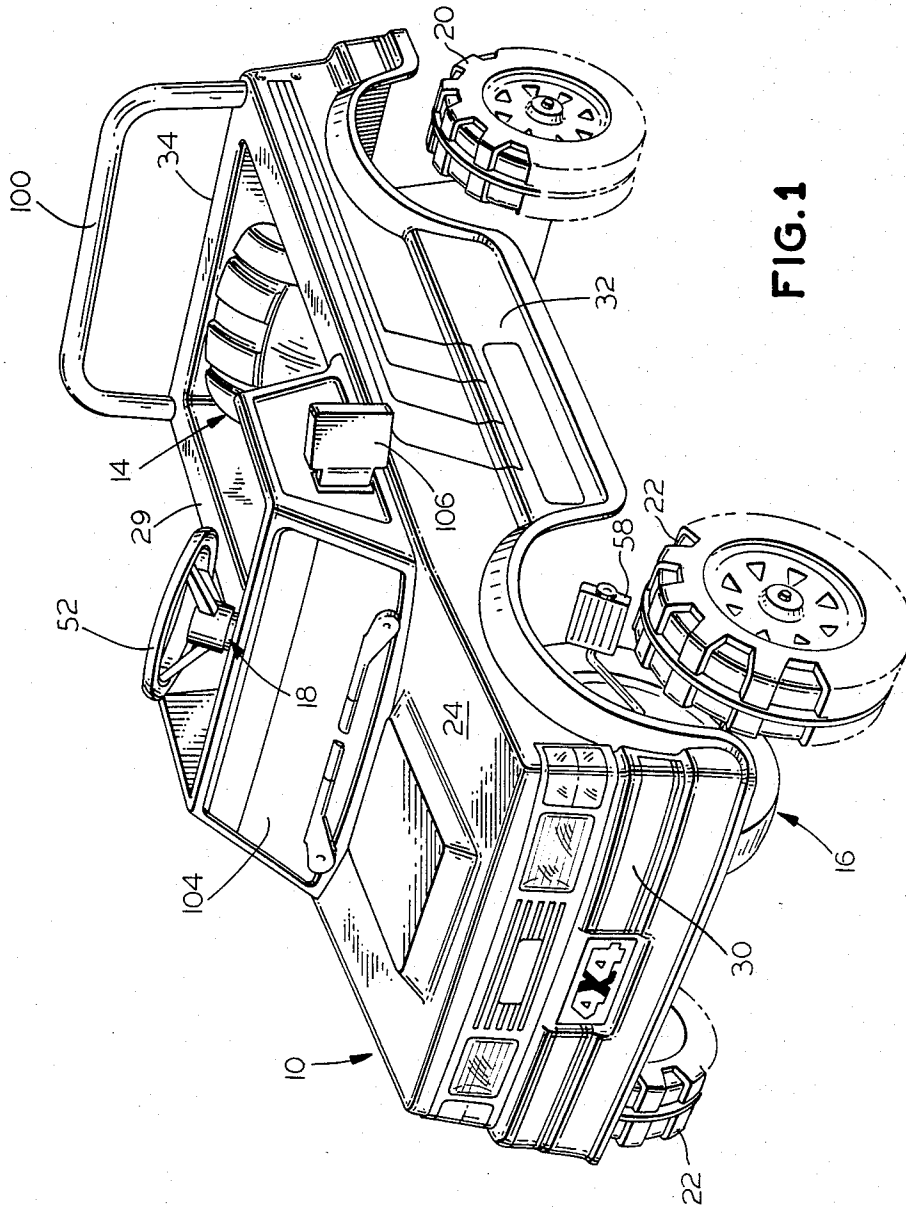

FIG. 1

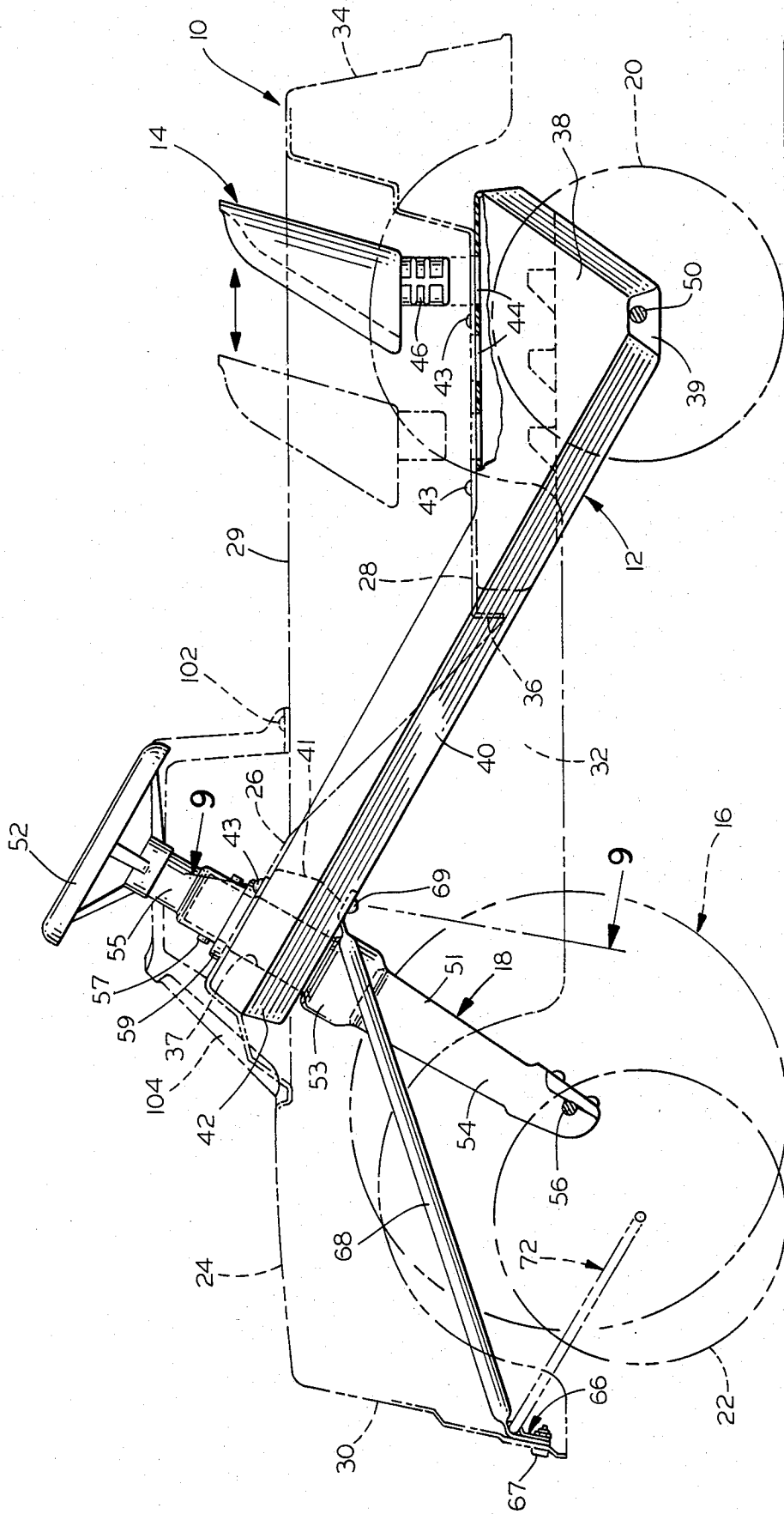

FIG. 2

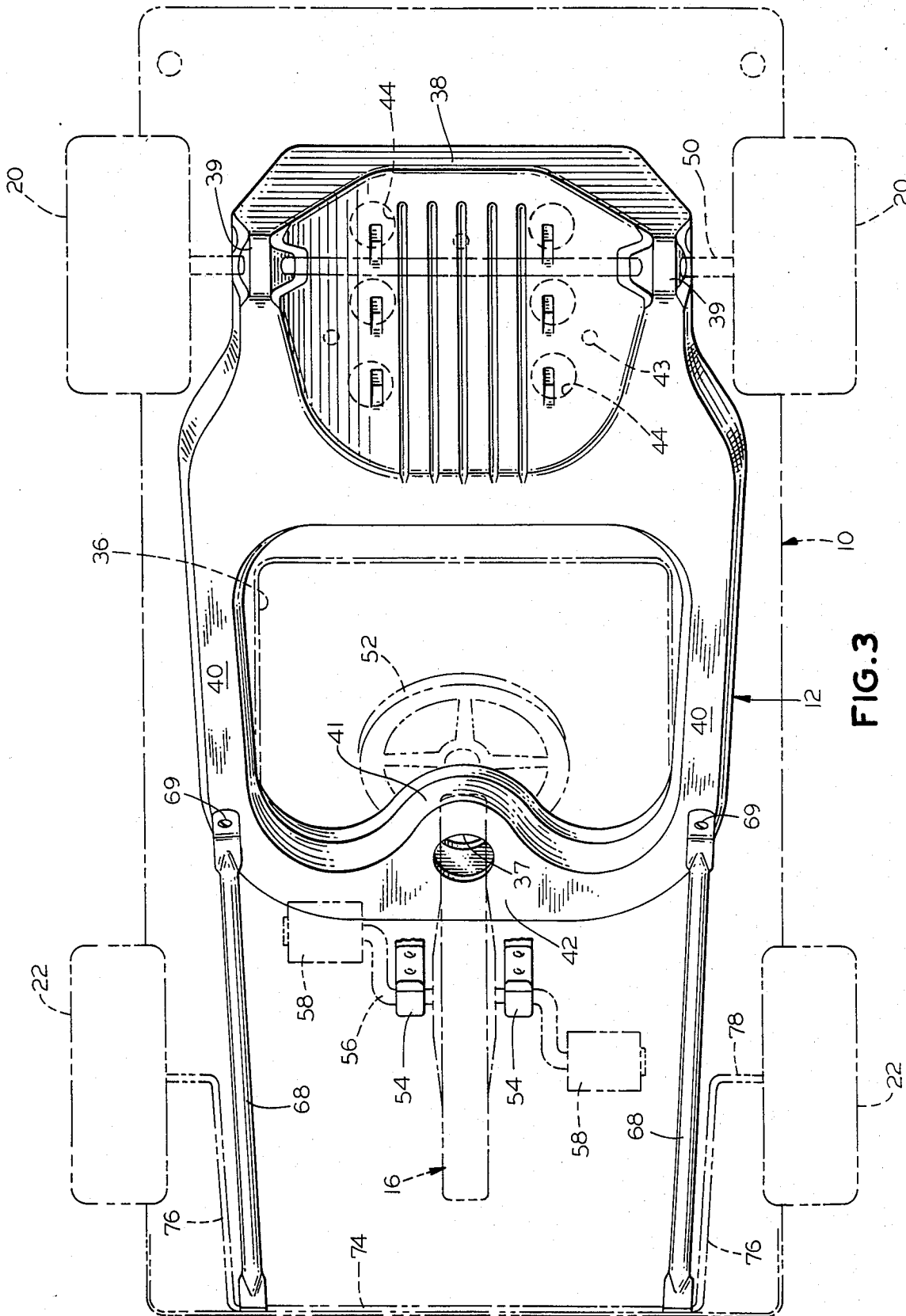

FIG. 3

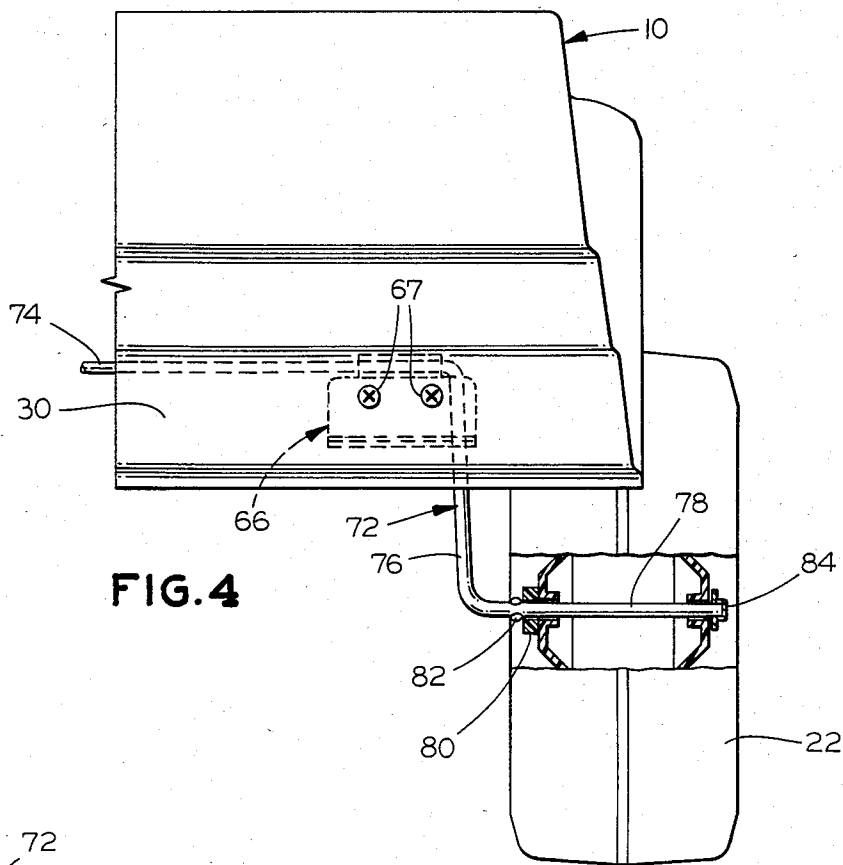

FIG. 4

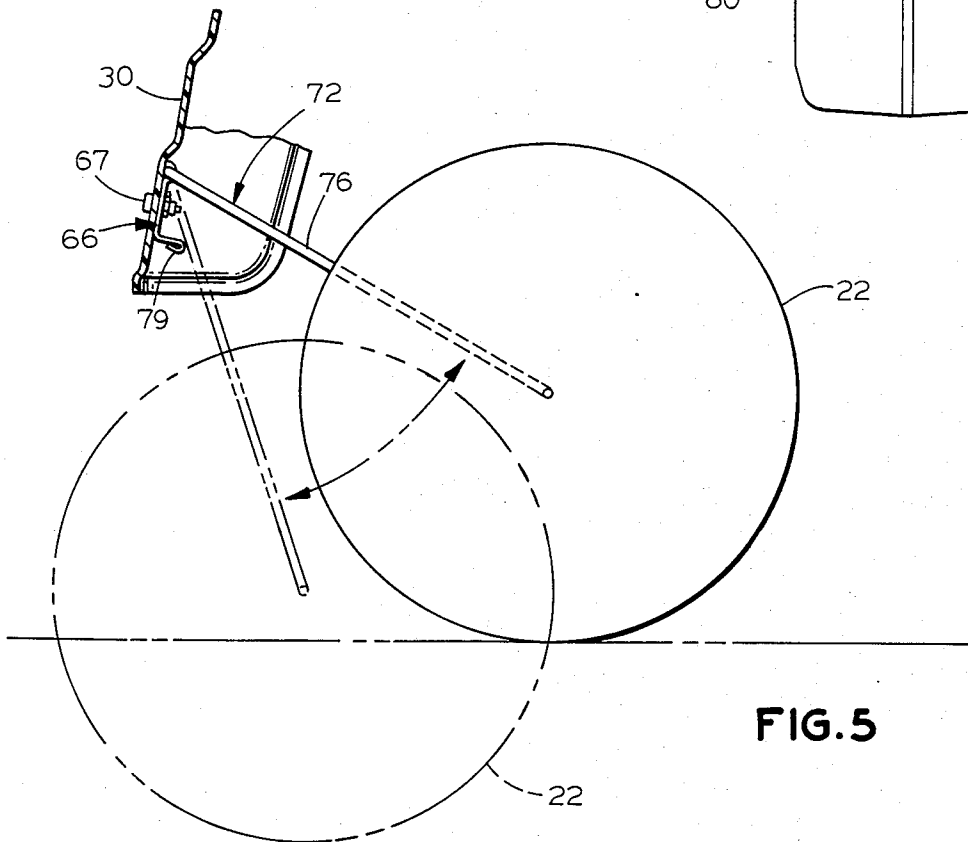

FIG. 5

# Explore Litigation Insights

Docket Alarm provides insights to develop a more informed litigation strategy and the peace of mind of knowing you're on top of things.

## Real-Time Litigation Alerts



Keep your litigation team up-to-date with **real-time alerts** and advanced team management tools built for the enterprise, all while greatly reducing PACER spend.

Our comprehensive service means we can handle Federal, State, and Administrative courts across the country.

## Advanced Docket Research



With over 230 million records, Docket Alarm's cloud-native docket research platform finds what other services can't. Coverage includes Federal, State, plus PTAB, TTAB, ITC and NLRB decisions, all in one place.

Identify arguments that have been successful in the past with full text, pinpoint searching. Link to case law cited within any court document via Fastcase.

## Analytics At Your Fingertips



Learn what happened the last time a particular judge, opposing counsel or company faced cases similar to yours.

Advanced out-of-the-box PTAB and TTAB analytics are always at your fingertips.

## API

Docket Alarm offers a powerful API (application programming interface) to developers that want to integrate case filings into their apps.

## LAW FIRMS

Build custom dashboards for your attorneys and clients with live data direct from the court.

Automate many repetitive legal tasks like conflict checks, document management, and marketing.

## FINANCIAL INSTITUTIONS

Litigation and bankruptcy checks for companies and debtors.

## E-DISCOVERY AND LEGAL VENDORS

Sync your system to PACER to automate legal marketing.