



US007487850B2

(12) **United States Patent**
Lucas et al.

(10) **Patent No.:** **US 7,487,850 B2**
(45) **Date of Patent:** **Feb. 10, 2009**

(54) **CHILDREN'S RIDE-ON VEHICLES HAVING IMPROVED SHIFTER ASSEMBLIES**

(75) Inventors: **Christopher F. Lucas**, Cheektowaga, NY (US); **John Rhein**, Hamburg, NY (US)

4,643,695 A 2/1987 Kennedy et al.
4,716,980 A 1/1988 Butler
4,736,648 A 4/1988 Perego
4,823,632 A 4/1989 Harrod et al.
5,173,591 A 12/1992 Perego
5,175,062 A 12/1992 Faroque et al.

(73) Assignee: **Mattel, Inc.**, El Segundo, CA (US)

(*) Notice: Subject to any disclaimer, the term of this patent is extended or adjusted under 35 U.S.C. 154(b) by 363 days.

(Continued)

OTHER PUBLICATIONS

(21) Appl. No.: **11/410,568**

International Search Report, Sep. 10, 2008, 2 pages, U.S. Patent and Trademark Office.

(22) Filed: **Apr. 24, 2006**

(Continued)

(65) **Prior Publication Data**

US 2007/0246271 A1 Oct. 25, 2007

Primary Examiner—Christopher P Ellis
Assistant Examiner—Vaughn T Coolman
(74) *Attorney, Agent, or Firm*—Kolisich Hartwell, P.C.

(51) **Int. Cl.**
G05G 9/00 (2006.01)

(57) **ABSTRACT**

(52) **U.S. Cl.** **180/65.1; 74/471 R**

(58) **Field of Classification Search** 180/65.1,
180/65.6, 65.8, 167, 169, 908; 74/469, 471 R,
74/473.1, 473.21, 473.28, 471 XY; 200/61.88,
200/61.85

See application file for complete search history.

Children's ride-on vehicles having improved shifter assemblies. The vehicles include a drive assembly comprising a velocity control assembly that selectively configures the drive assembly within a plurality of drive configurations and which includes a switch assembly adapted to be selectively configured between a plurality of velocity settings. Each velocity setting configures the drive assembly to a predetermined drive configuration. The velocity control assembly may include an actuator assembly that receives user inputs via a shifter handle moveable between a plurality of shift positions along a plurality of shift paths. Each shift position configures the switch assembly to a particular velocity setting. At least two of the shift paths have non-linear relative orientations. In some embodiments, the actuator assembly includes a biasing mechanism, which urges the shifter handle towards a selected shift position, and/or a restraining mechanism, which selectively prevents the shifter handle from being moved to a selected shift position.

(56) **References Cited**

U.S. PATENT DOCUMENTS

- 3,030,459 A 4/1962 Elliott et al.
- 3,639,705 A 2/1972 Rayner
- 3,674,046 A 7/1972 Miceli
- 4,052,578 A 10/1977 Hoke
- 4,284,157 A 8/1981 Lay
- 4,378,855 A 4/1983 Haub et al.
- 4,401,866 A 8/1983 Kaminski et al.
- 4,519,266 A * 5/1985 Reinecke 74/471 XY
- 4,531,027 A 7/1985 Vogt et al.
- 4,553,947 A 11/1985 Weiland et al.
- 4,560,022 A 12/1985 Kassai
- 4,562,893 A 1/1986 Cunard
- 4,565,538 A 1/1986 Kennedy et al.

38 Claims, 10 Drawing Sheets

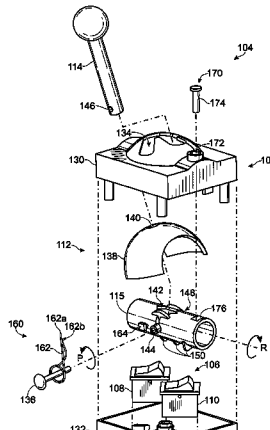

Dynacraft BSC, Inc.
Exhibit 1001
Dynacraft v. Mattel
IPR2018-00040

US 7,487,850 B2

Page 2

U.S. PATENT DOCUMENTS

5,197,344	A	3/1993	Maier et al.				
5,388,477	A	2/1995	Frei et al.				
5,571,999	A *	11/1996	Harris	200/565			
5,644,114	A	7/1997	Neaves				
5,742,014	A	4/1998	Schwartz et al.				
5,934,694	A	8/1999	Schugt et al.				
6,082,213	A *	7/2000	Skogward	74/473.18			
6,422,330	B1	7/2002	Harris				
6,470,982	B2	10/2002	Sitarski et al.				
6,718,842	B1 *	4/2004	Bofias	74/473.33			
6,719,076	B1	4/2004	Tabata et al.				
6,756,750	B2	6/2004	Wakitani et al.				
					6,771,034	B2	8/2004 Reile et al.
					6,789,444	B2 *	9/2004 Fujiwara et al. 74/473.23
					6,921,870	B2	7/2005 Lan et al.
					7,213,483	B2 *	5/2007 Inoguchi et al. 74/473.23
					2002/0121395	A1	9/2002 Norman et al.
					2004/0069557	A1	4/2004 Lan et al.
					2004/0154854	A1	8/2004 Stephens

OTHER PUBLICATIONS

Written Opinion, Sep. 10, 2008, 5 pages, U.S. Patent and Trademark Office.

* cited by examiner

Fig. 1

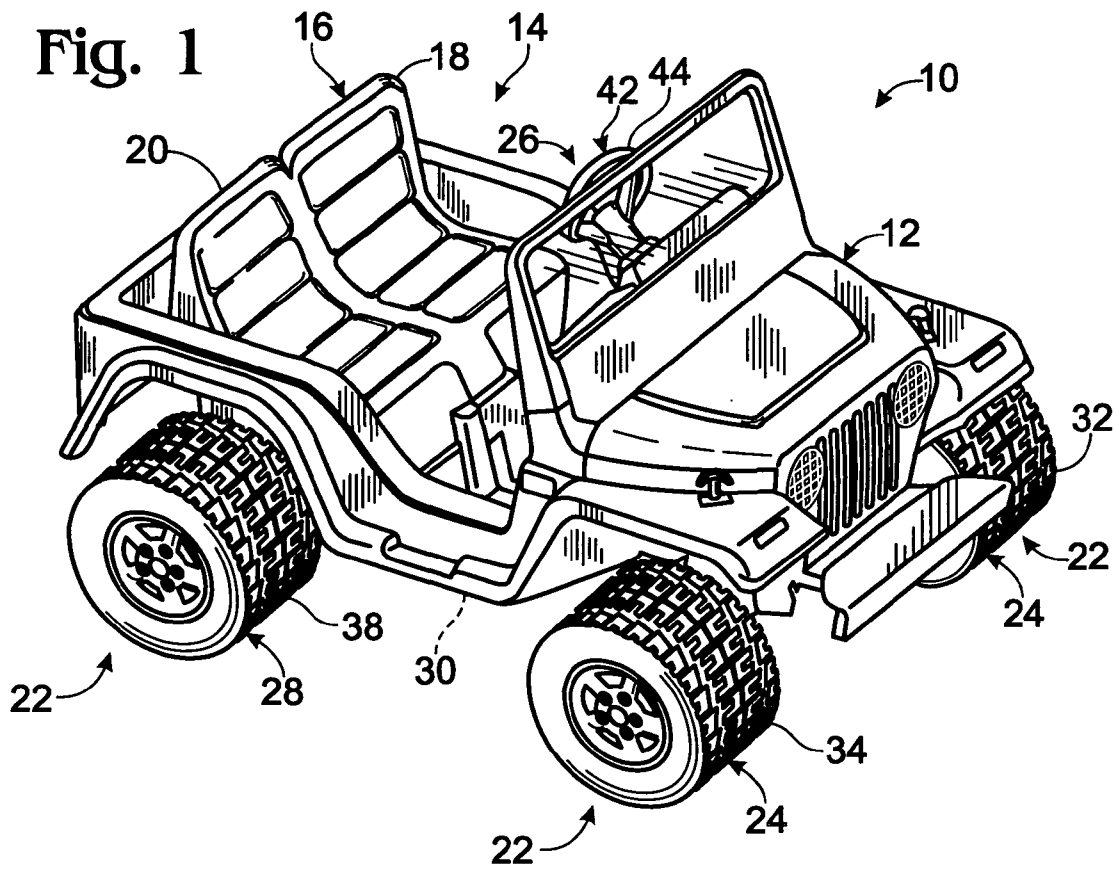

Fig. 2

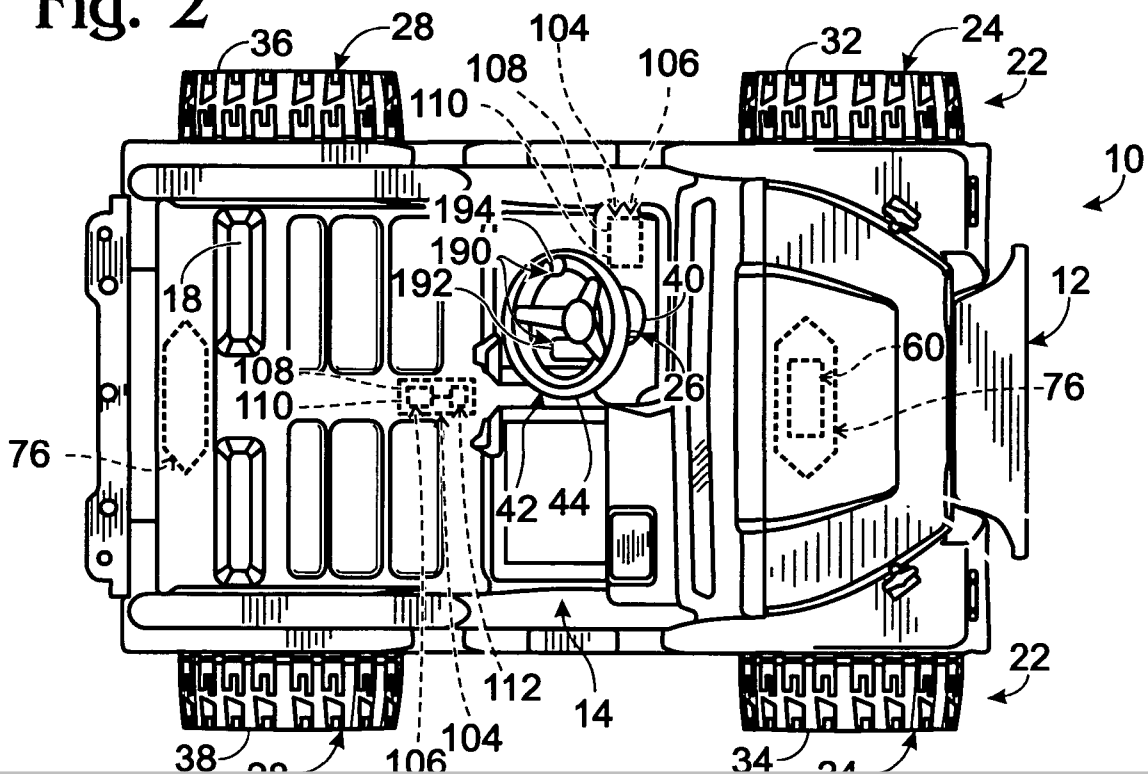

Fig. 3

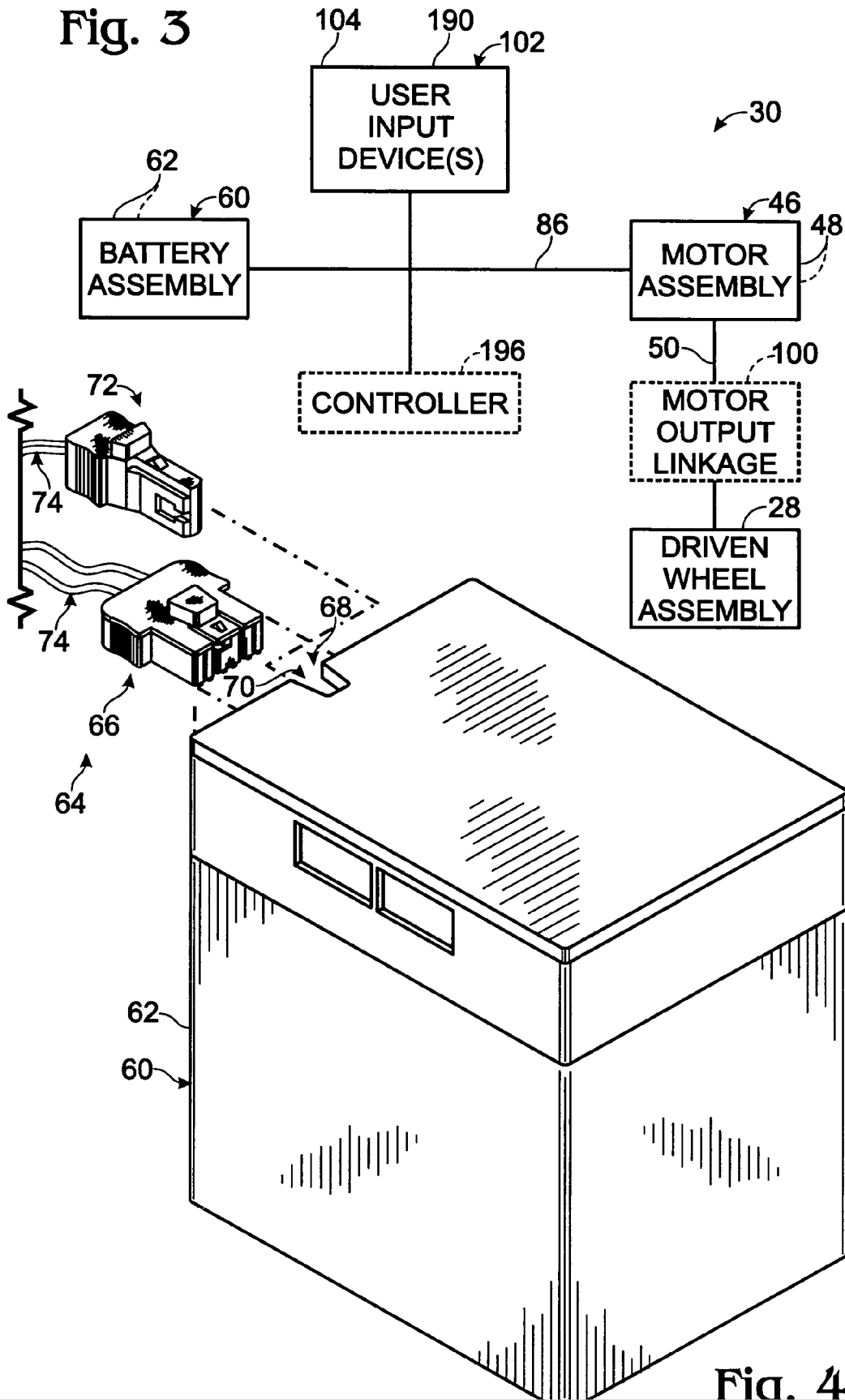

Fig. 4

Fig. 5

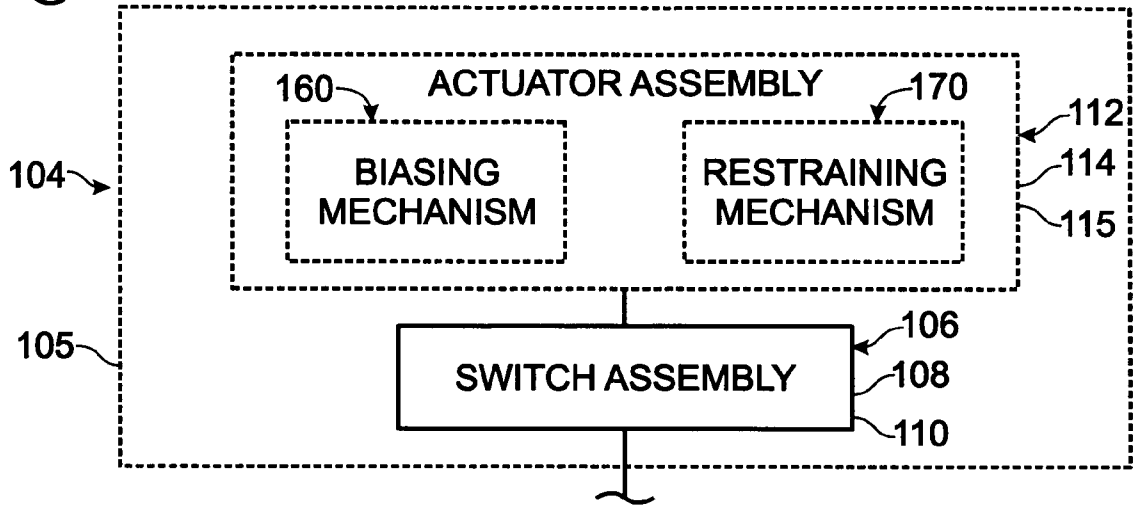

Fig. 6

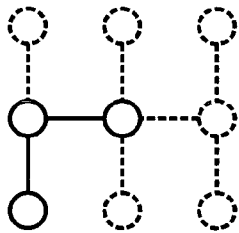

Fig. 7

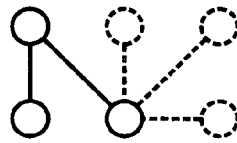

Fig. 8

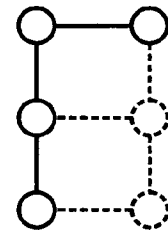
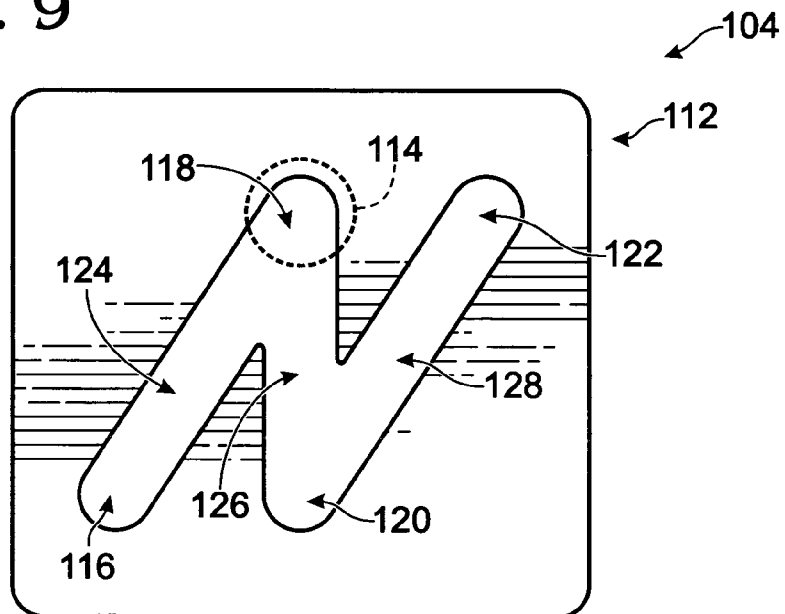

Fig. 9



Explore Litigation Insights

Docket Alarm provides insights to develop a more informed litigation strategy and the peace of mind of knowing you're on top of things.

Real-Time Litigation Alerts



Keep your litigation team up-to-date with **real-time alerts** and advanced team management tools built for the enterprise, all while greatly reducing PACER spend.

Our comprehensive service means we can handle Federal, State, and Administrative courts across the country.

Advanced Docket Research



With over 230 million records, Docket Alarm's cloud-native docket research platform finds what other services can't. Coverage includes Federal, State, plus PTAB, TTAB, ITC and NLRB decisions, all in one place.

Identify arguments that have been successful in the past with full text, pinpoint searching. Link to case law cited within any court document via Fastcase.

Analytics At Your Fingertips



Learn what happened the last time a particular judge, opposing counsel or company faced cases similar to yours.

Advanced out-of-the-box PTAB and TTAB analytics are always at your fingertips.

API

Docket Alarm offers a powerful API (application programming interface) to developers that want to integrate case filings into their apps.

LAW FIRMS

Build custom dashboards for your attorneys and clients with live data direct from the court.

Automate many repetitive legal tasks like conflict checks, document management, and marketing.

FINANCIAL INSTITUTIONS

Litigation and bankruptcy checks for companies and debtors.

E-DISCOVERY AND LEGAL VENDORS

Sync your system to PACER to automate legal marketing.