

Ex. 1010



US 20090086476A1

(19) **United States**

(12) **Patent Application Publication**

Tickner et al.

(10) **Pub. No.: US 2009/0086476 A1**

(43) **Pub. Date: Apr. 2, 2009**

(54) **LIGHT EMITTING DIODE RECESSED LIGHT FIXTURE**

Publication Classification

(75) Inventors: **Jerold Tickner**, Newnan, GA (US); **Scott David Wegner**, Peachtree City, GA (US); **Evans Edward Thompson, III**, Fairburn, GA (US)

(51) **Int. Cl.**
F21V 21/04 (2006.01)
F21V 29/00 (2006.01)
F21V 7/00 (2006.01)
F21K 7/00 (2006.01)

(52) **U.S. Cl.** 362/231; 362/234; 362/364; 362/249.02; 362/235; 362/230

Correspondence Address:
KING & SPALDING LLP
1180 PEACHTREE STREET
ATLANTA, GA 30309-3521 (US)

(57) **ABSTRACT**

(73) Assignee: **Cooper Technologies Company**, Houston, TX (US)

A recessed light fixture includes an LED module, which includes a single LED package that is configured to generate all light emitted by the recessed light fixture. For example, the LED package can include multiple LEDs mounted to a common substrate. The LED package can be coupled to a heat sink for dissipating heat from the LEDs. The heat sink can include a core member from which fins extend. Each fin can include one or more straight and/or curved portions. A reflector housing may be coupled to the heat sink and configured to receive a reflector. The reflector can have any geometry, such as a bell-shaped geometry including two radii of curvature that join together at an inflection point. An optic coupler can be coupled to the reflector housing and configured to cover electrical connections at the substrate and to guide light emitted by the LED package.

(21) Appl. No.: **12/235,116**

(22) Filed: **Sep. 22, 2008**

Related U.S. Application Data

(60) Provisional application No. 60/994,792, filed on Sep. 21, 2007, provisional application No. 61/010,549, filed on Jan. 9, 2008, provisional application No. 61/065,914, filed on Feb. 15, 2008, provisional application No. 61/090,391, filed on Aug. 20, 2008.

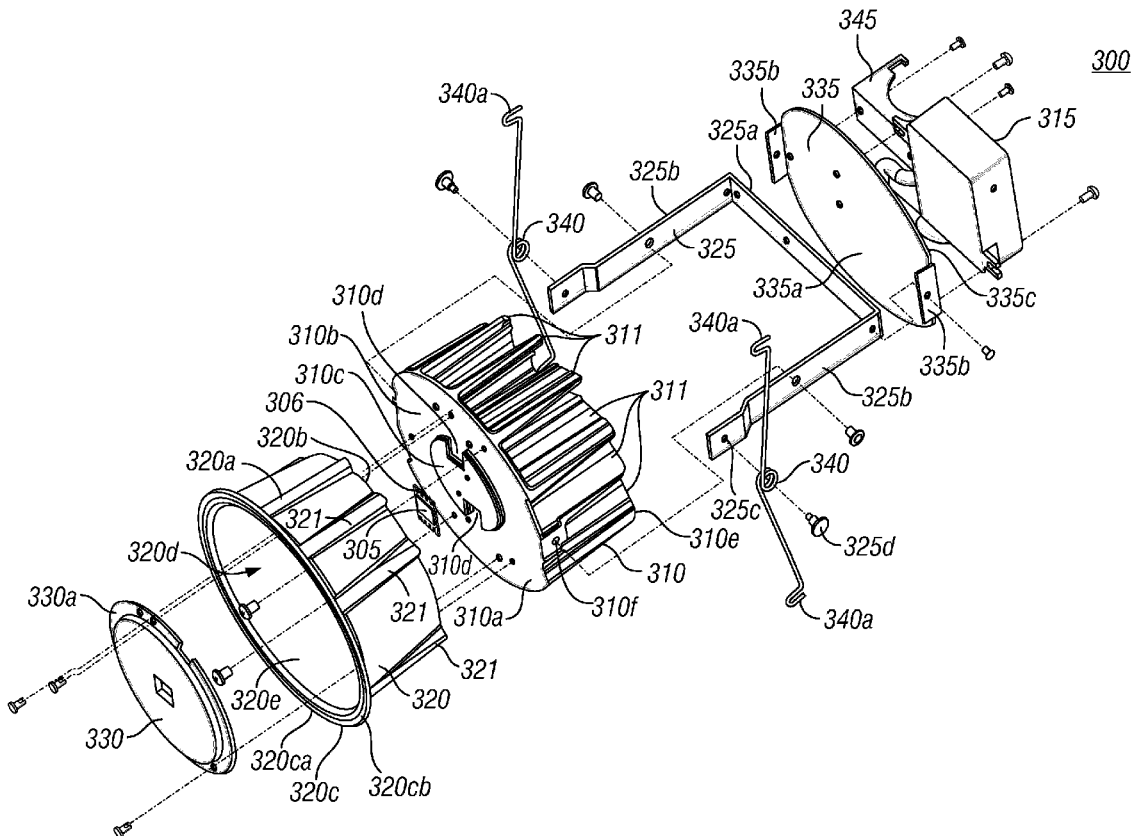

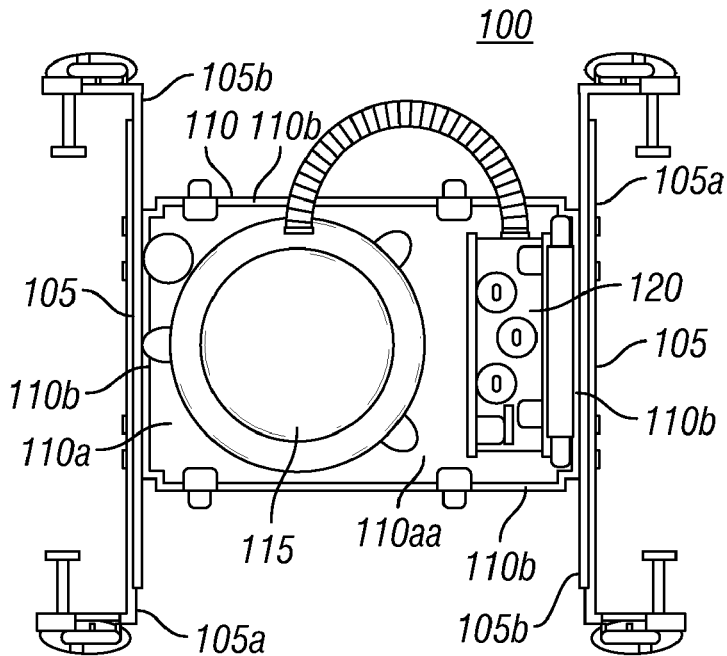

FIG. 1

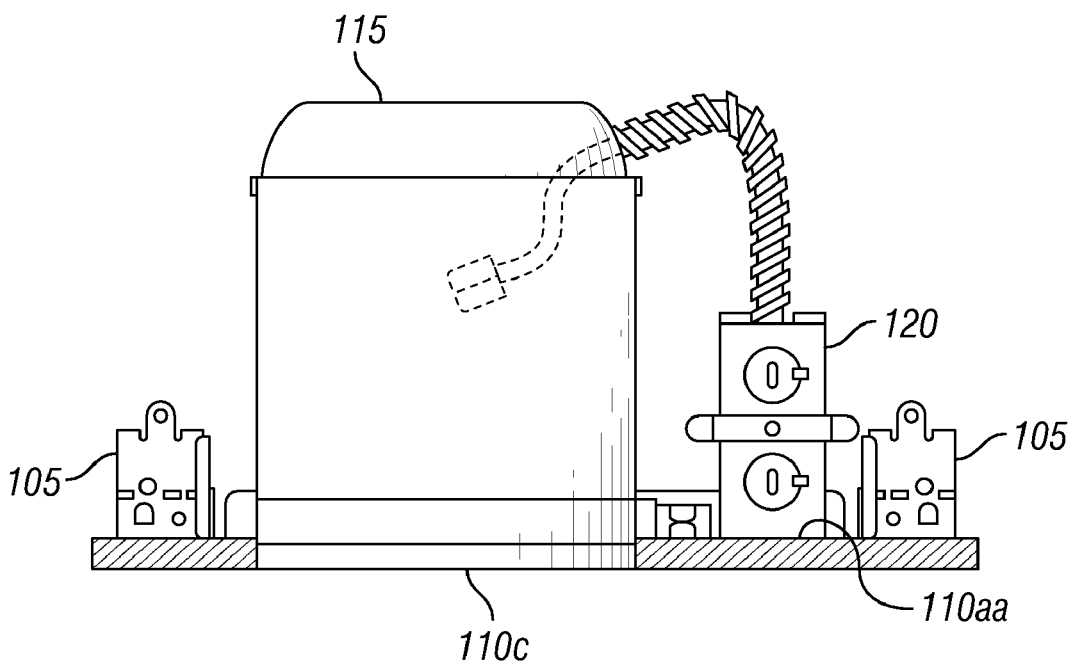

FIG. 2

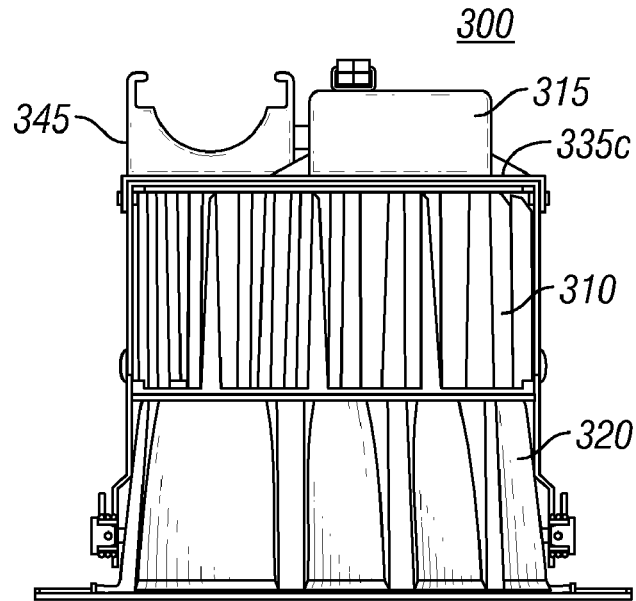

FIG. 3

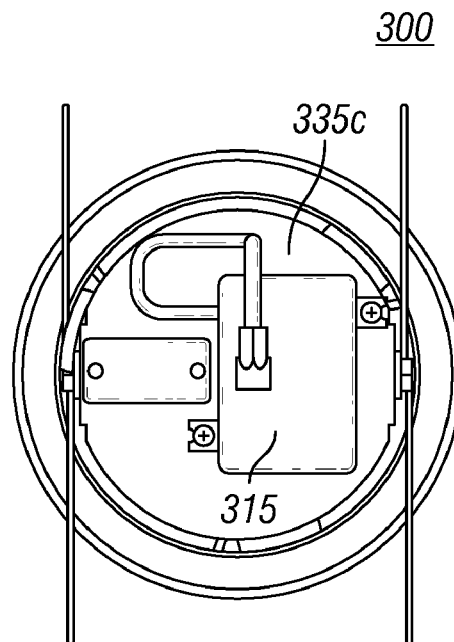

FIG. 4

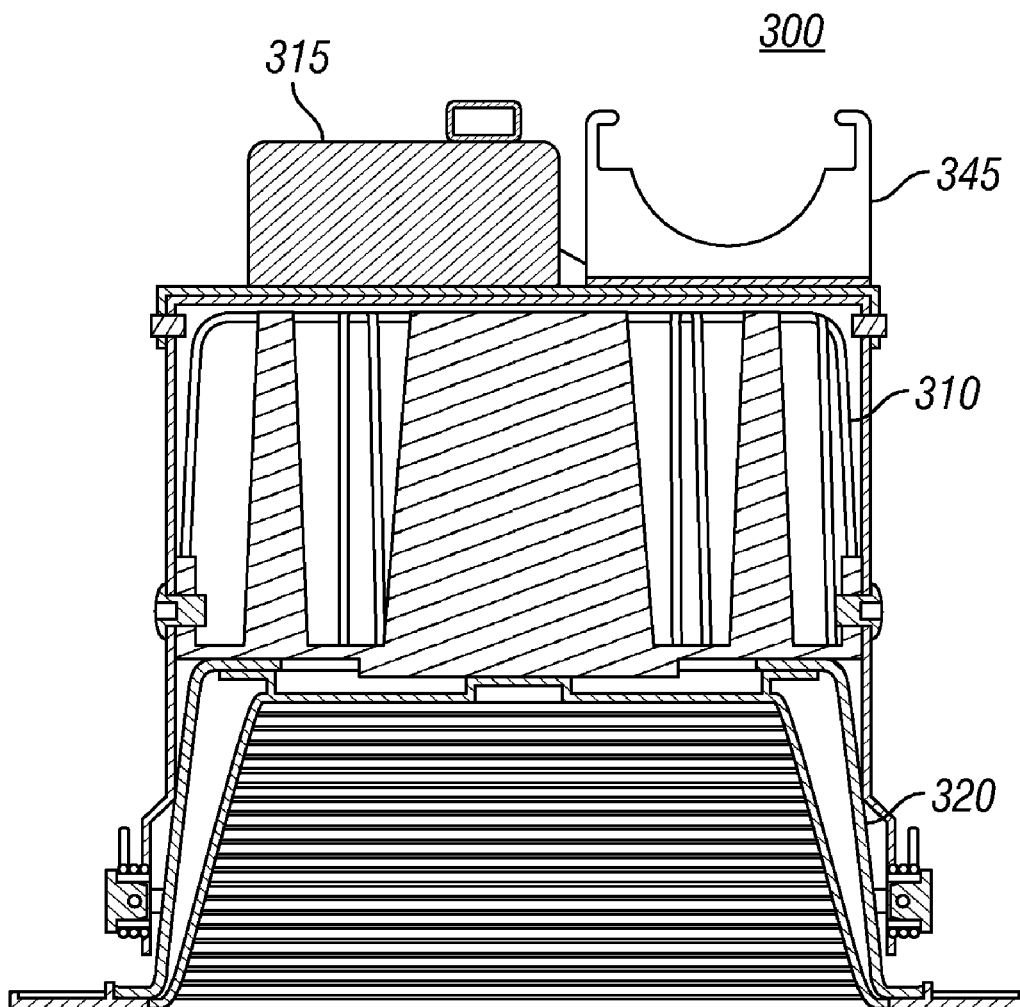

FIG. 5

Explore Litigation Insights

Docket Alarm provides insights to develop a more informed litigation strategy and the peace of mind of knowing you're on top of things.

Real-Time Litigation Alerts



Keep your litigation team up-to-date with **real-time alerts** and advanced team management tools built for the enterprise, all while greatly reducing PACER spend.

Our comprehensive service means we can handle Federal, State, and Administrative courts across the country.

Advanced Docket Research



With over 230 million records, Docket Alarm's cloud-native docket research platform finds what other services can't. Coverage includes Federal, State, plus PTAB, TTAB, ITC and NLRB decisions, all in one place.

Identify arguments that have been successful in the past with full text, pinpoint searching. Link to case law cited within any court document via Fastcase.

Analytics At Your Fingertips



Learn what happened the last time a particular judge, opposing counsel or company faced cases similar to yours.

Advanced out-of-the-box PTAB and TTAB analytics are always at your fingertips.

API

Docket Alarm offers a powerful API (application programming interface) to developers that want to integrate case filings into their apps.

LAW FIRMS

Build custom dashboards for your attorneys and clients with live data direct from the court.

Automate many repetitive legal tasks like conflict checks, document management, and marketing.

FINANCIAL INSTITUTIONS

Litigation and bankruptcy checks for companies and debtors.

E-DISCOVERY AND LEGAL VENDORS

Sync your system to PACER to automate legal marketing.