



US006745061B1

(12) **United States Patent**  
**Hicks et al.**

(10) **Patent No.:** **US 6,745,061 B1**  
(45) **Date of Patent:** **Jun. 1, 2004**

(54) **DISPOSABLE OXIMETRY SENSOR**  
(75) Inventors: **Christopher Hicks**, Boulder, CO (US);  
**Norma M. Prince**, Lyons, CO (US)  
(73) Assignee: **Datex-Ohmeda, Inc.**, Madison, WI  
(US)

5,671,529 A 9/1997 Nelson ..... 29/825  
5,678,544 A 10/1997 DeLonzor et al.  
5,782,757 A \* 7/1998 Diab et al. .... 600/323  
RE36,000 E 12/1998 Swedlow et al.  
5,913,819 A 6/1999 Taylor et al. .... 600/323  
6,014,576 A 1/2000 Raley ..... 600/344  
6,073,038 A 6/2000 Wang et al. .... 600/323

(\* ) Notice: Subject to any disclaimer, the term of this patent is extended or adjusted under 35 U.S.C. 154(b) by 0 days.

\* cited by examiner

*Primary Examiner*—Eric F. Winakur  
(74) *Attorney, Agent, or Firm*—Marsh Fischmann & Breyfogle LLP

(21) Appl. No.: **10/225,940**  
(22) Filed: **Aug. 21, 2002**  
(51) **Int. Cl.**<sup>7</sup> ..... **A61B 5/00**  
(52) **U.S. Cl.** ..... **600/344; 600/323**  
(58) **Field of Search** ..... 600/310, 322,  
600/323, 340, 344

(57) **ABSTRACT**

The invention is directed to a disposable oximetry sensor having an integrally formed connector. In one aspect, the sensor includes a clear flexible substrate on which a light emitter and/or light detector (collectively active component (s)) are mounted to allow those components to emit/detect light through the clear substrate and a second patient-side surface of that substrate. The clear substrate will generally contain one or more electrically conductive traces, preferably formed through a printing process, for interconnection to the active components. In this regard, the clear substrate acts as the electrical connector and lens structure for the active components reducing the overall part count for the sensor's assembly. Additional materials/layers may be added to the sensor including an adhesive layer, a compressible material layer, a light blocking layer, and/or a heat sink for thermal management. Generally, any additional layers/materials applied the patient-side of the clear substrate will be substantially transparent to allow light curing of adhesives utilized to connect components to the sensor through the patient-side surface of the sensor during production.

(56) **References Cited**  
**U.S. PATENT DOCUMENTS**

4,825,872 A 5/1989 Tan et al.  
4,830,014 A 5/1989 Goodman et al.  
4,865,038 A 9/1989 Rich et al.  
4,964,408 A 10/1990 Hink et al.  
5,041,187 A 8/1991 Hink et al.  
5,237,994 A 8/1993 Goldberger  
5,246,003 A 9/1993 DeLonzor  
5,249,576 A 10/1993 Goldberger et al.  
5,263,244 A 11/1993 Centa et al.  
5,425,360 A 6/1995 Nelson  
5,427,093 A \* 6/1995 Ogawa et al. .... 600/323  
5,452,717 A 9/1995 Branigan et al.  
5,469,845 A 11/1995 DeLonzor et al.  
5,520,177 A 5/1996 Ogawa et al.

**34 Claims, 13 Drawing Sheets**

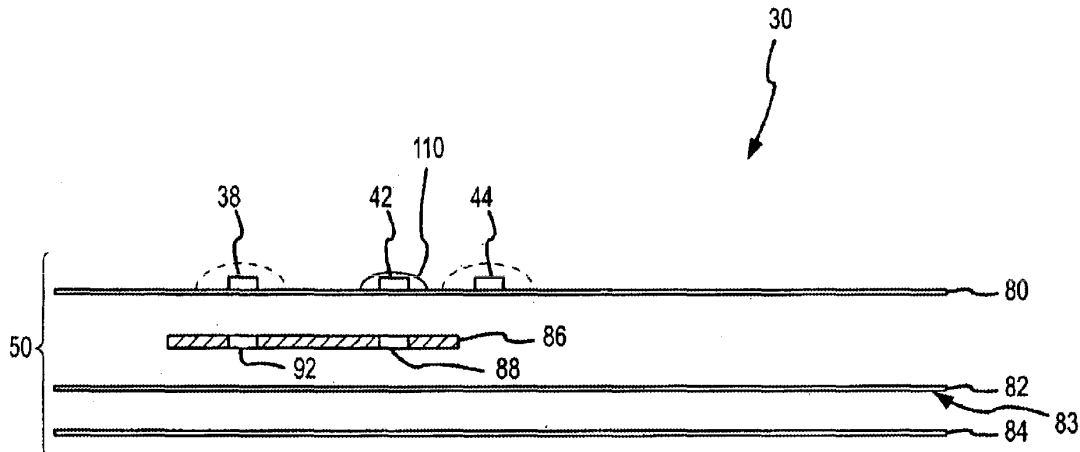

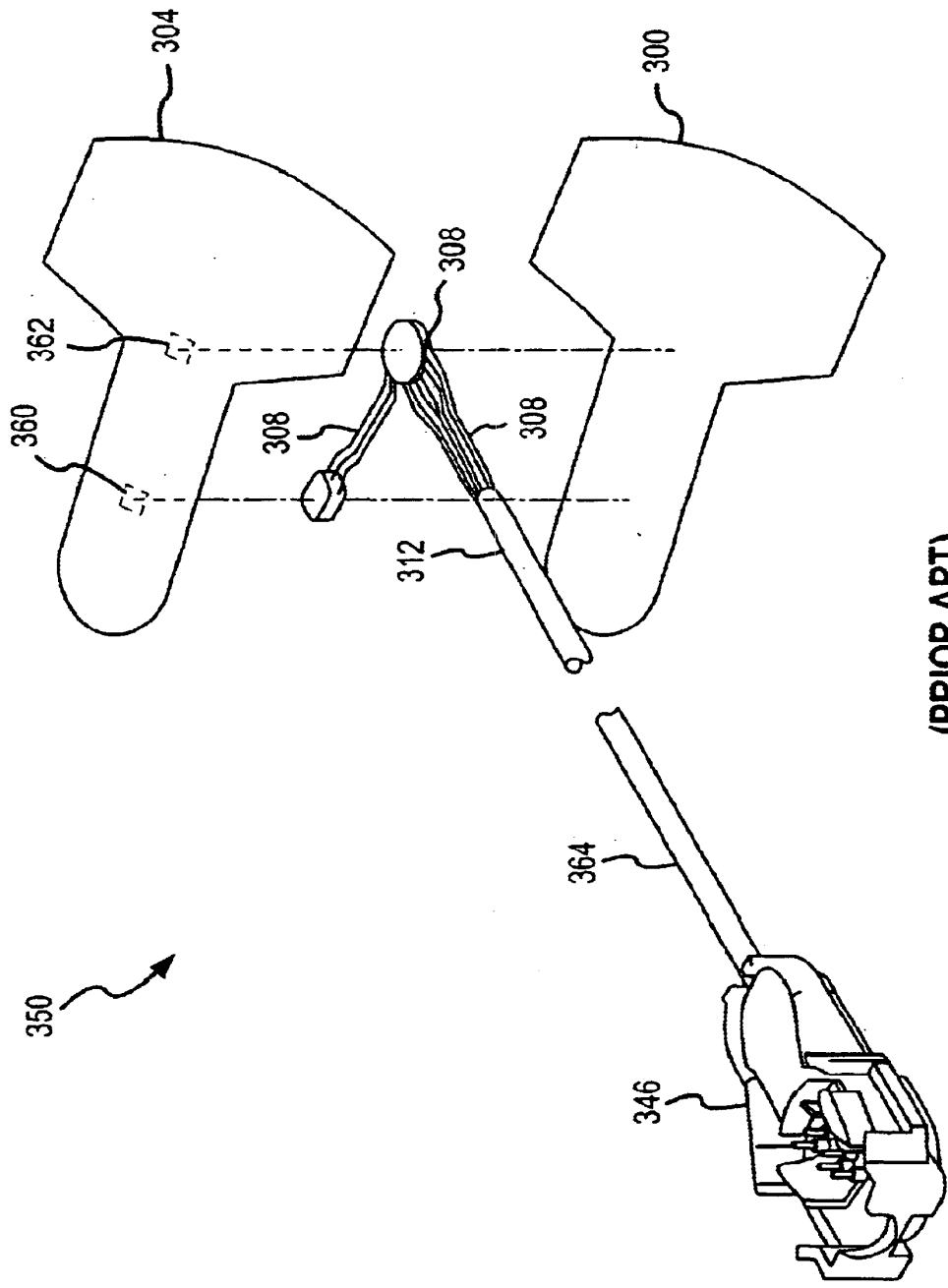

(PRIOR ART)  
FIG. 1

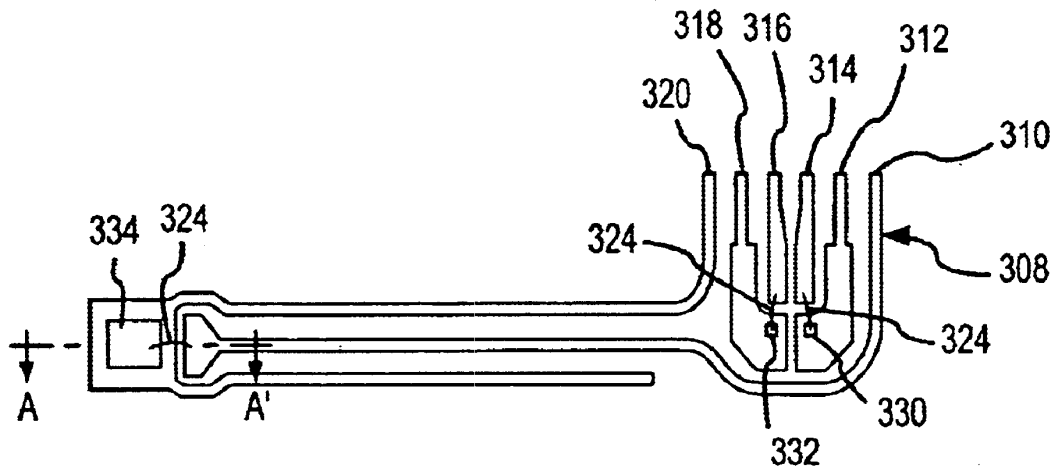

(PRIOR ART)

FIG.2

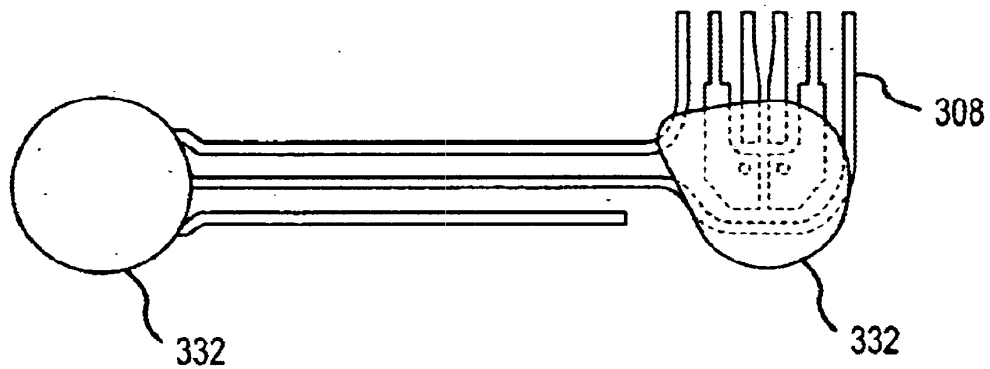

(PRIOR ART)

FIG.4

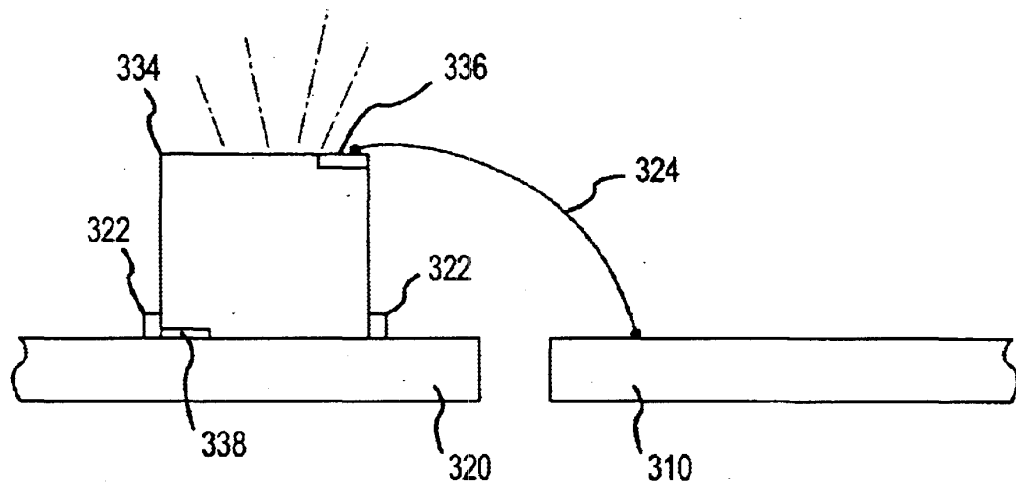

(PRIOR ART)

FIG.3

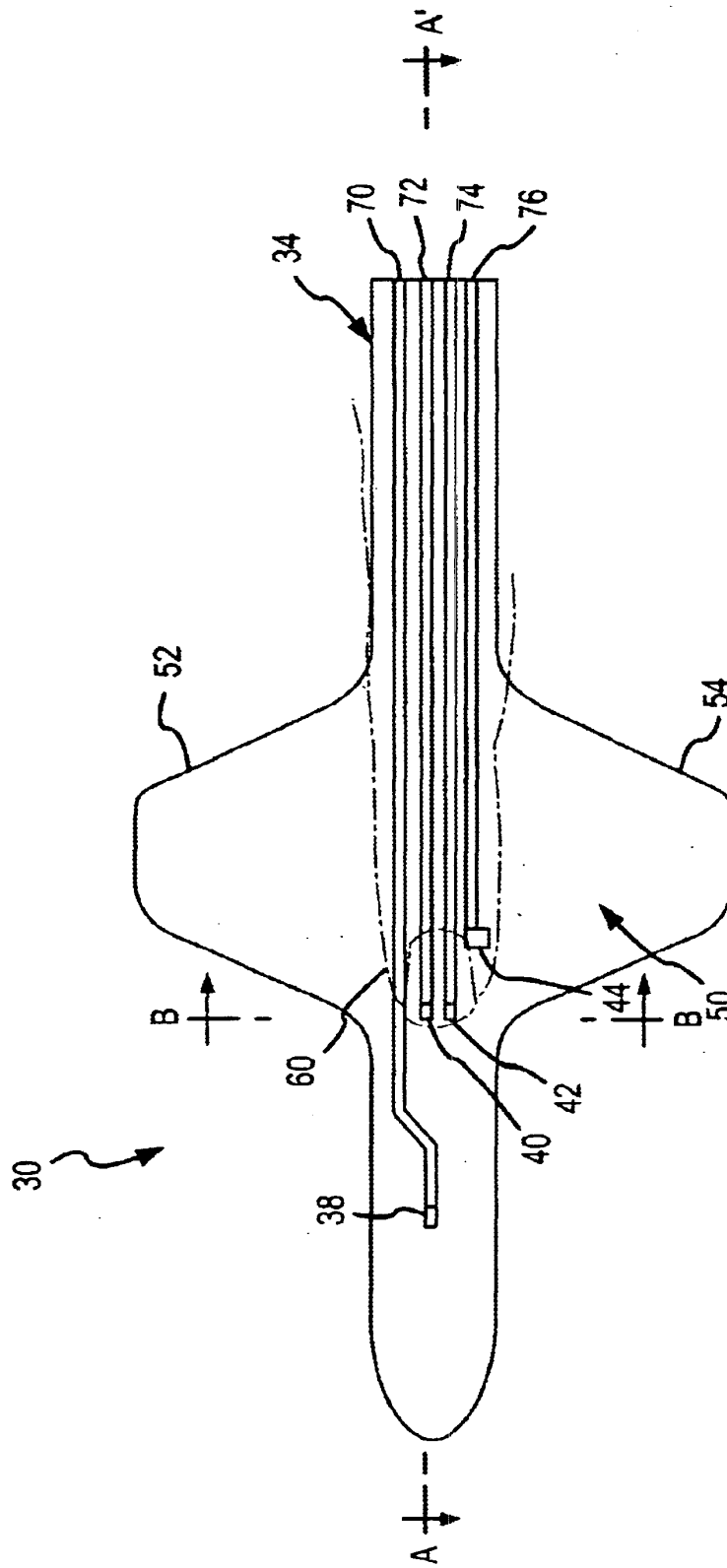

FIG. 5

0005

# Explore Litigation Insights

Docket Alarm provides insights to develop a more informed litigation strategy and the peace of mind of knowing you're on top of things.

## Real-Time Litigation Alerts



Keep your litigation team up-to-date with **real-time alerts** and advanced team management tools built for the enterprise, all while greatly reducing PACER spend.

Our comprehensive service means we can handle Federal, State, and Administrative courts across the country.

## Advanced Docket Research



With over 230 million records, Docket Alarm's cloud-native docket research platform finds what other services can't. Coverage includes Federal, State, plus PTAB, TTAB, ITC and NLRB decisions, all in one place.

Identify arguments that have been successful in the past with full text, pinpoint searching. Link to case law cited within any court document via Fastcase.

## Analytics At Your Fingertips



Learn what happened the last time a particular judge, opposing counsel or company faced cases similar to yours.

Advanced out-of-the-box PTAB and TTAB analytics are always at your fingertips.

## API

Docket Alarm offers a powerful API (application programming interface) to developers that want to integrate case filings into their apps.

## LAW FIRMS

Build custom dashboards for your attorneys and clients with live data direct from the court.

Automate many repetitive legal tasks like conflict checks, document management, and marketing.

## FINANCIAL INSTITUTIONS

Litigation and bankruptcy checks for companies and debtors.

## E-DISCOVERY AND LEGAL VENDORS

Sync your system to PACER to automate legal marketing.