



US006049153A

United States Patent [19]

[11] Patent Number: **6,049,153**

Nishiyama et al.

[45] Date of Patent: ***Apr. 11, 2000**

[54] **MOTOR**

[75] Inventors: **Noriyoshi Nishiyama**, Izumiotsu; **Tomokazu Nakamura**, Katano; **Yasufumi Ikkai**, Kobe; **Yukio Honda**, Katano; **Hiroshi Murakami**, Suita; **Shinichiro Kawano**, Kadoma, all of Japan

[73] Assignee: **Matsushita Electric Industrial Co., Ltd.**, Osaka, Japan

[*] Notice: This patent issued on a continued prosecution application filed under 37 CFR 1.53(d), and is subject to the twenty year patent term provisions of 35 U.S.C. 154(a)(2).

[21] Appl. No.: **08/945,460**

[22] PCT Filed: **Feb. 21, 1997**

[86] PCT No.: **PCT/JP97/00489**

§ 371 Date: **Feb. 2, 1998**

§ 102(e) Date: **Feb. 2, 1998**

[87] PCT Pub. No.: **WO97/31422**

PCT Pub. Date: **Aug. 28, 1997**

[30] **Foreign Application Priority Data**

Feb. 23, 1996 [JP] Japan 8-35988

[51] Int. Cl.⁷ **H02K 1/27**

[52] U.S. Cl. **310/156**; 310/254; 310/259; 310/162; 310/42; 310/179

[58] Field of Search 310/254, 258, 310/259, 216, 217, 218, 156, 162, 166, 168, 179, 42; 29/596

[56] **References Cited**

U.S. PATENT DOCUMENTS

5,097,166	3/1992	Mikulic	310/156
5,583,387	12/1996	Tankeuchi et al.	310/217
5,729,072	3/1998	Hirano et al.	310/258
5,861,693	1/1999	Takahashi et al.	310/113

FOREIGN PATENT DOCUMENTS

62-160048	7/1987	Japan	H02K 3/28
63-242157	10/1988	Japan	310/156
5-284677	10/1993	Japan	H02K 1/16
5-292714	11/1993	Japan	H02K 17/12
6-98514	4/1994	Japan	310/156
6-66277	9/1994	Japan	H02K 21/14
7-20050	4/1995	Japan	H02K 1/27
7-236240	9/1995	Japan	H02K 1/27
7-255138	10/1995	Japan	H02K 1/27
7-303357	11/1995	Japan	H02K 19/10
8-19196	1/1996	Japan	H02K 1/18

OTHER PUBLICATIONS

Japanese language search report for Int'l Appln. No. PCT/JP97/00489.

English translation of Japanese language search report for Int'l Appln. No. PCT/JP97/00489.

Primary Examiner—Nestor Ramirez

Assistant Examiner—Burt Mullins

Attorney, Agent, or Firm—Ratner & Prestia

[57] **ABSTRACT**

A motor comprises a stator core having plural teeth and slots provided among the teeth, a winding applied on the teeth by a turn, and a rotor incorporating plural permanent magnets. The rotor is rotated and driven by utilizing reluctance torque in addition to magnetic torque. Since the winding is not crossed, the size of the coil end is reduced.

21 Claims, 7 Drawing Sheets

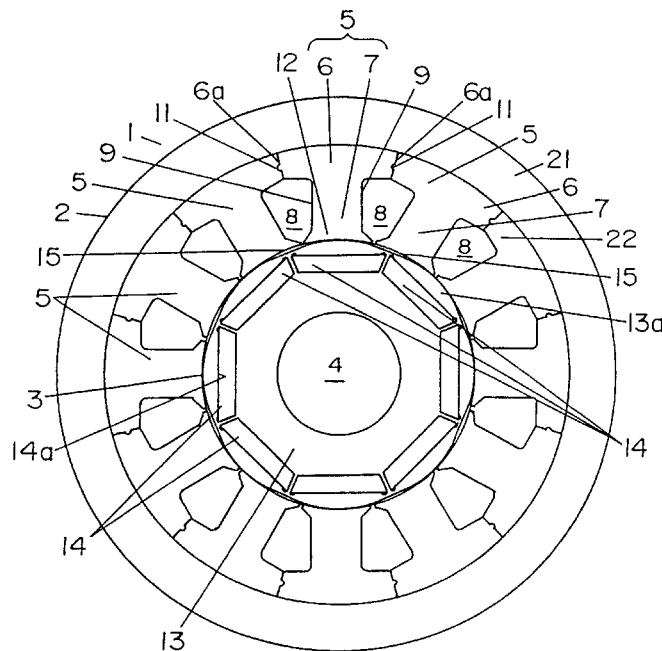

Fig. 1

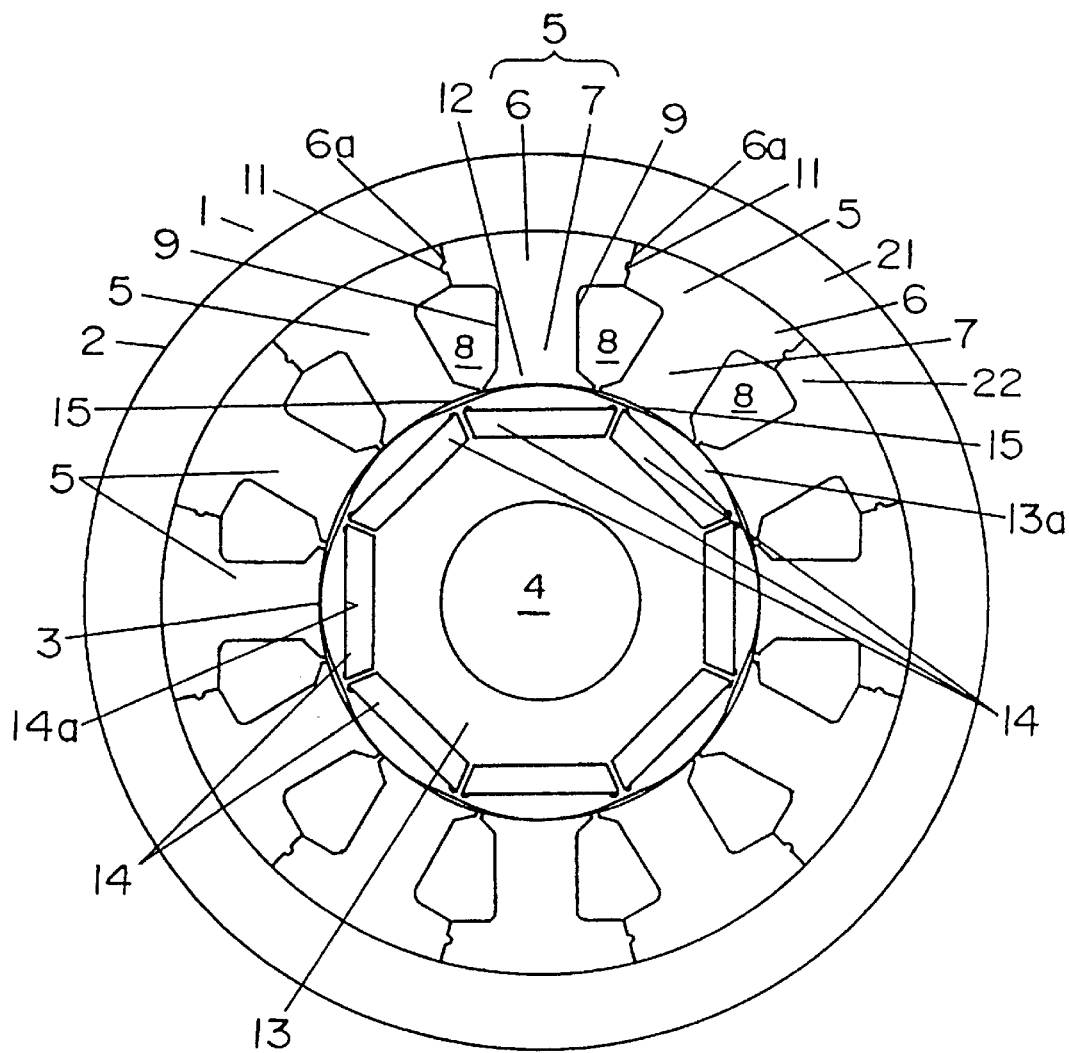

Fig. 2

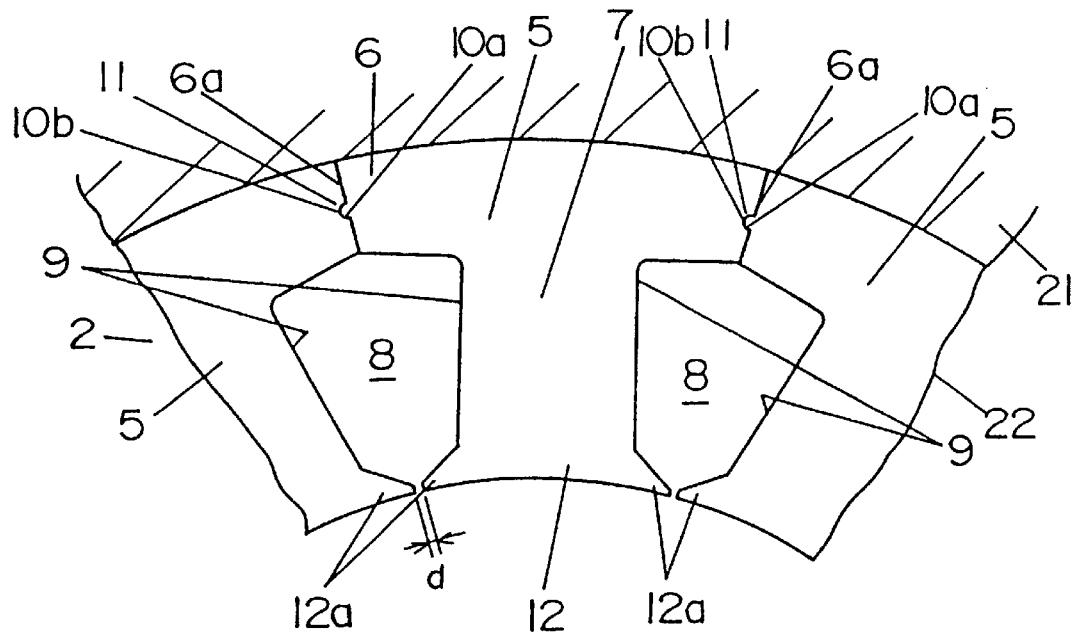

Fig. 3

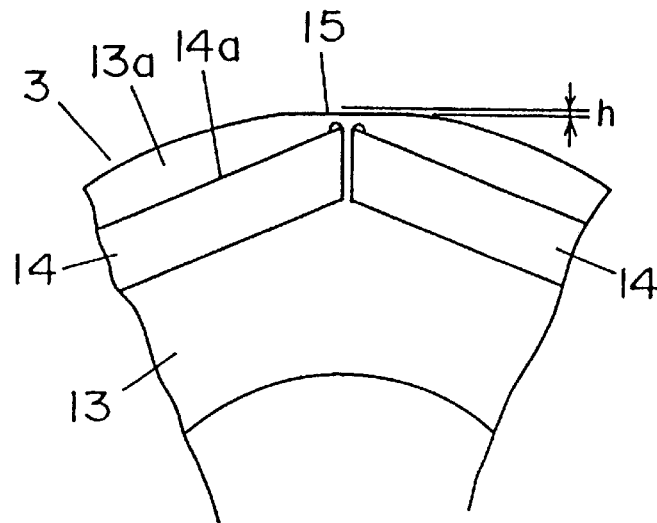

Fig.4

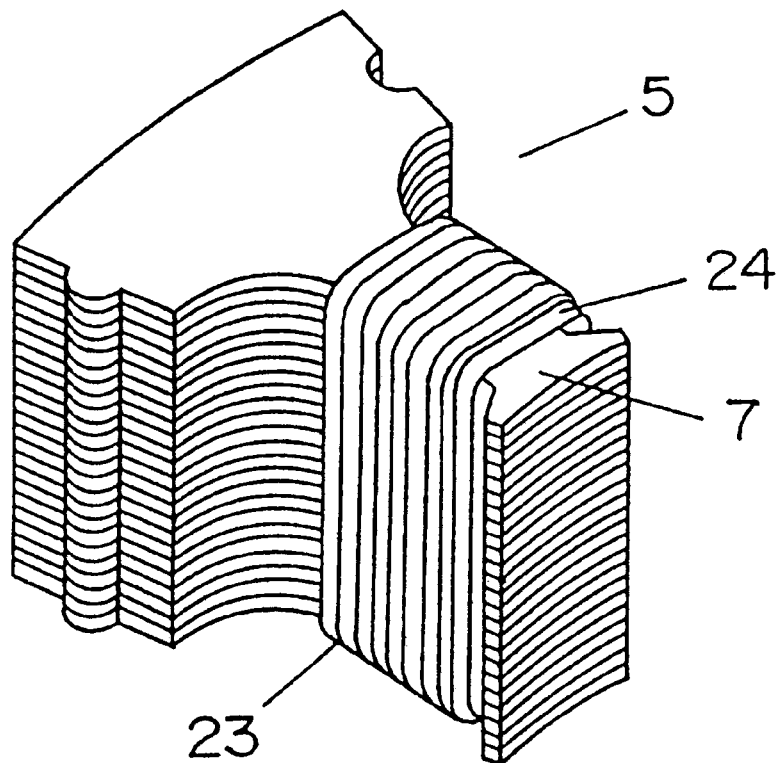
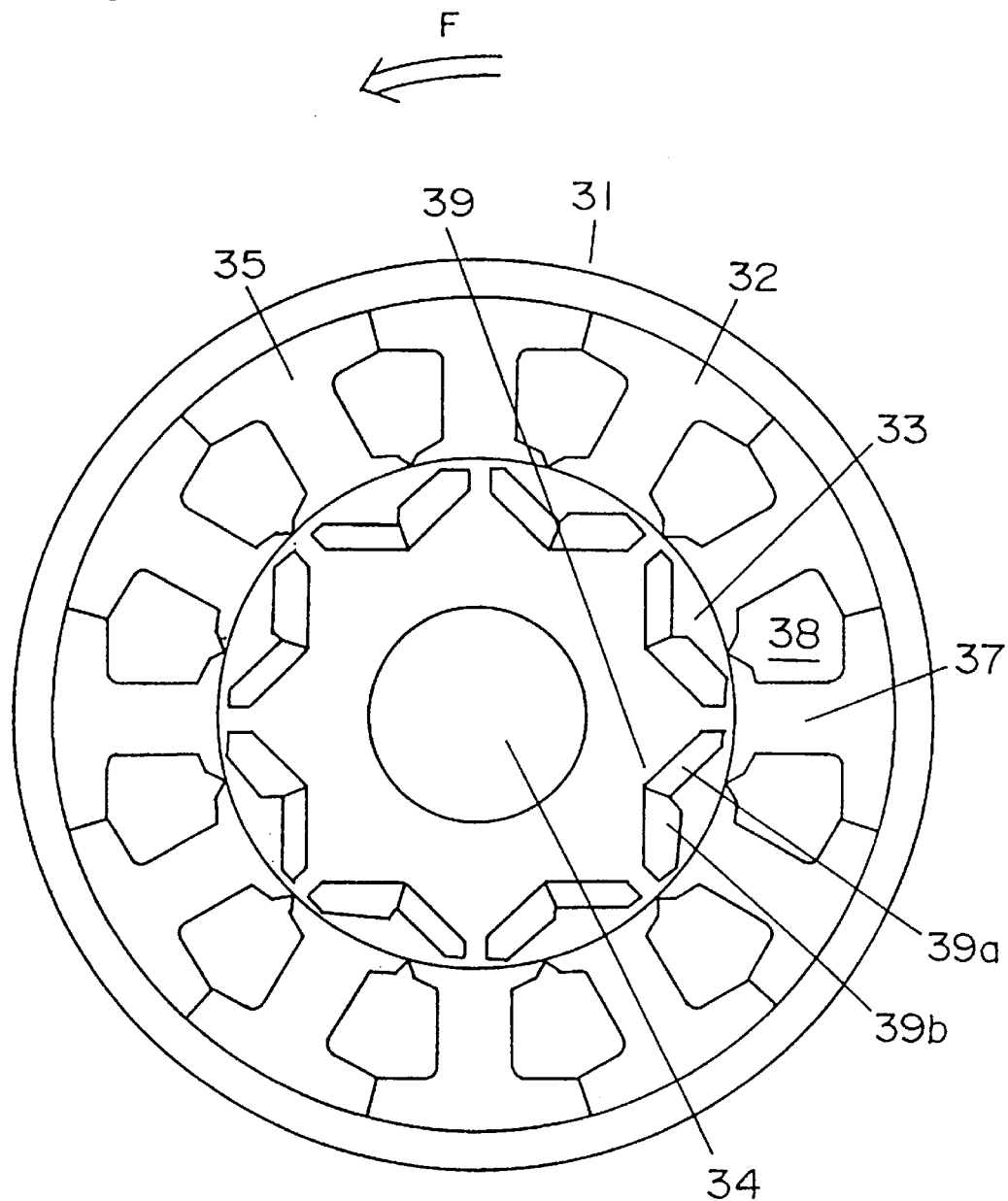

Fig.5



Explore Litigation Insights

Docket Alarm provides insights to develop a more informed litigation strategy and the peace of mind of knowing you're on top of things.

Real-Time Litigation Alerts



Keep your litigation team up-to-date with **real-time alerts** and advanced team management tools built for the enterprise, all while greatly reducing PACER spend.

Our comprehensive service means we can handle Federal, State, and Administrative courts across the country.

Advanced Docket Research



With over 230 million records, Docket Alarm's cloud-native docket research platform finds what other services can't. Coverage includes Federal, State, plus PTAB, TTAB, ITC and NLRB decisions, all in one place.

Identify arguments that have been successful in the past with full text, pinpoint searching. Link to case law cited within any court document via Fastcase.

Analytics At Your Fingertips



Learn what happened the last time a particular judge, opposing counsel or company faced cases similar to yours.

Advanced out-of-the-box PTAB and TTAB analytics are always at your fingertips.

API

Docket Alarm offers a powerful API (application programming interface) to developers that want to integrate case filings into their apps.

LAW FIRMS

Build custom dashboards for your attorneys and clients with live data direct from the court.

Automate many repetitive legal tasks like conflict checks, document management, and marketing.

FINANCIAL INSTITUTIONS

Litigation and bankruptcy checks for companies and debtors.

E-DISCOVERY AND LEGAL VENDORS

Sync your system to PACER to automate legal marketing.