



(19) **United States**

(12) **Patent Application Publication**  
**Wolf et al.**

(10) **Pub. No.: US 2007/0197881 A1**

(43) **Pub. Date: Aug. 23, 2007**

(54) **WIRELESS HEALTH MONITOR DEVICE AND SYSTEM WITH COGNITION**

(76) Inventors: **James L. Wolf**, Conifer, CO (US); **Thomas P. Walker**, Morrison, CO (US); **Franz Huber**, Denver, CO (US); **Robert N. Caruso**, Evergreen, CO (US)

Correspondence Address:  
**KYLE W. ROST**  
5490 AUTUMN CT.  
GREENWOOD VILLAGE, CO 80111

(21) Appl. No.: 11/678,052

(22) Filed: Feb. 22, 2007

**Related U.S. Application Data**

(60) Provisional application No. 60/766,963, filed on Feb. 22, 2006.

**Publication Classification**

(51) **Int. Cl.**  
*A61B 5/00* (2006.01)  
*G06Q 10/00* (2006.01)

(52) **U.S. Cl.** ..... 600/300; 128/920; 705/2

(57) **ABSTRACT**

A home-based remote care solution provides sensors including a basic health monitor (BHM) that is a measurement and feedback system. The BHM operates with low power inte-

grated communications combined with an in-home, low power mesh network or programmable digital assistant (PDA) with cell phone technology. A cognitive system allows remote monitoring of the location and the basic health of an individual. The BHM measures oxygen saturation (SaO2), temperature of the ear canal, and motion, including detection of a fall and location within a facility. Optionally, the BHM measures CO2, respiration, EKG, EEG, and blood glucose. No intervention is required to determine the status of the individual and to convey this information to care providers. The cognitive system provides feedback and assistance to the individual while learning standard behavior patterns. An integrated audio speaker and microphone enable the BHM to deliver audio alerts, current measurements, and voice prompts. A remote care provider can deliver reminders via the BHM. The device may be worn overnight to allow monitoring and intervention. Through the ability to inquire, the cognitive system is able to qualify events such as loss of unconsciousness or falls. Simple voice commands activate the device to report its measurements and to give alerts to care providers. Alerts from care providers can be in a familiar voice to assist with compliance to medication regimens and disease management instructions. Simple switches allow volume control and manual activation. The device communicates with a series of low-power gateways to an in-home cognitive server and point-of-care (POC) appliance (computer). Along the BHM provides basic feedback and monitoring with limited cognitive capabilities such as low oxygen or fall detection. While connected to the cognitive server, full cognitive capabilities are attained. Full alerting capability requires the cognitive server to be connected through an Internet gateway to the remote care provider.

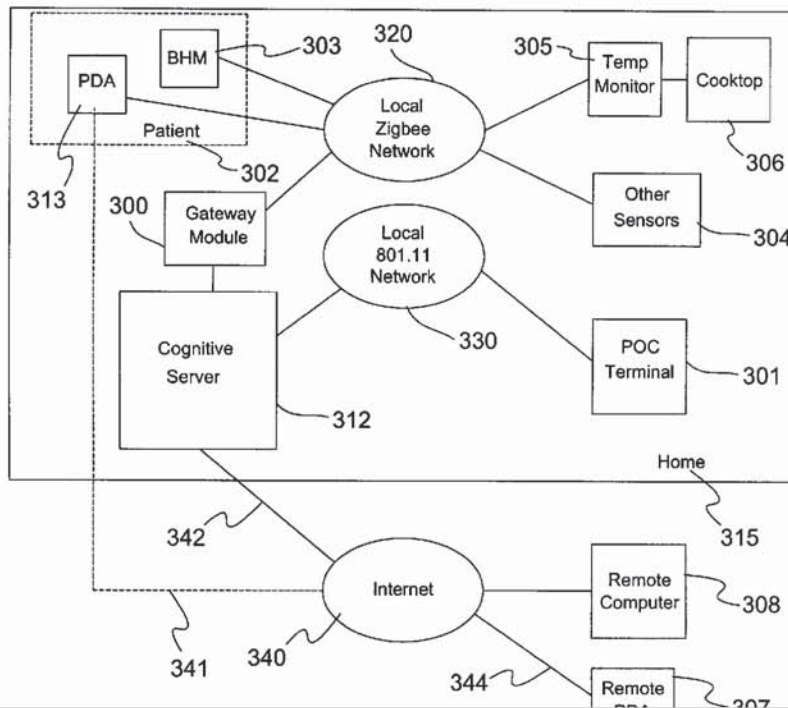

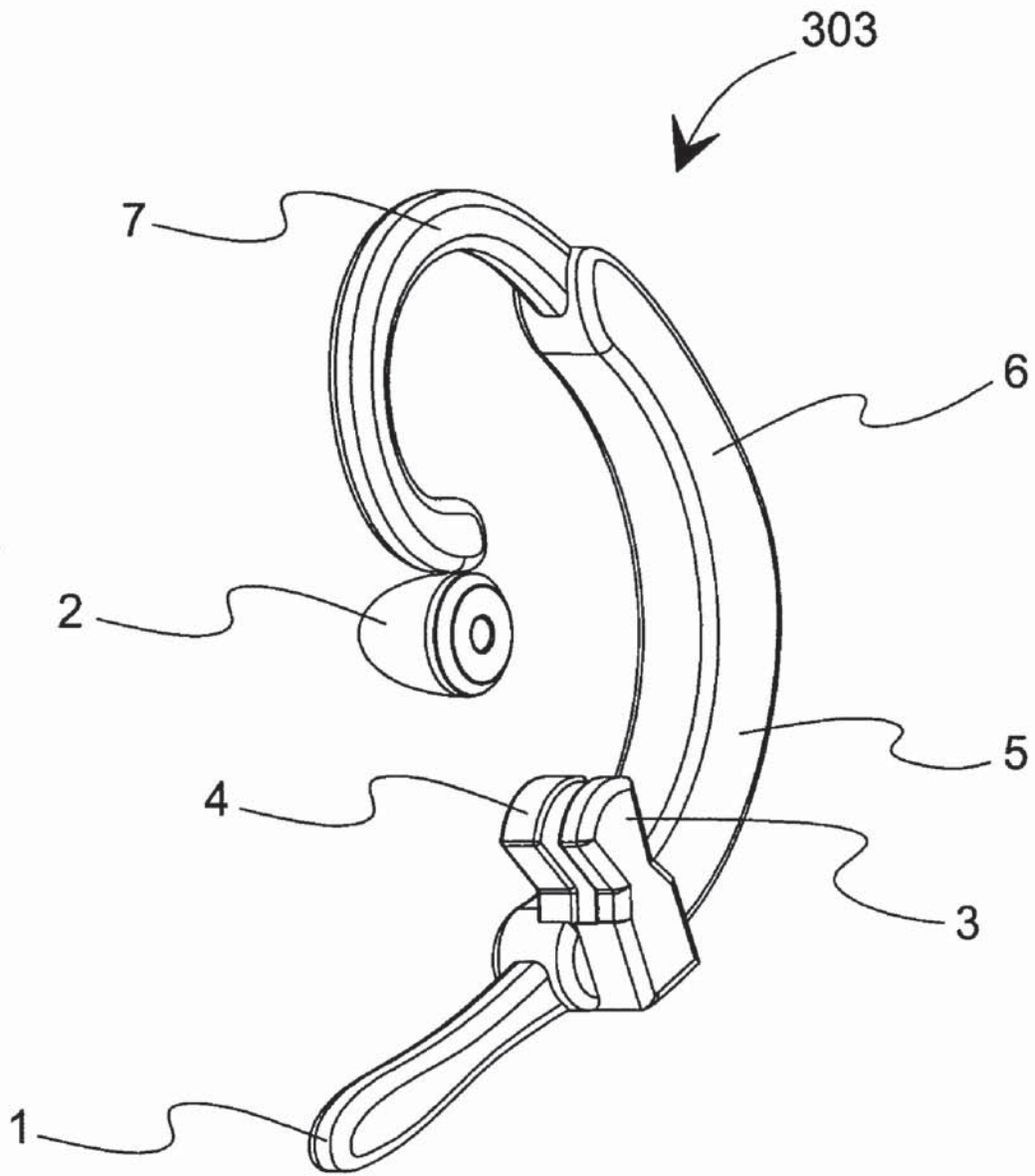

Fig. 1

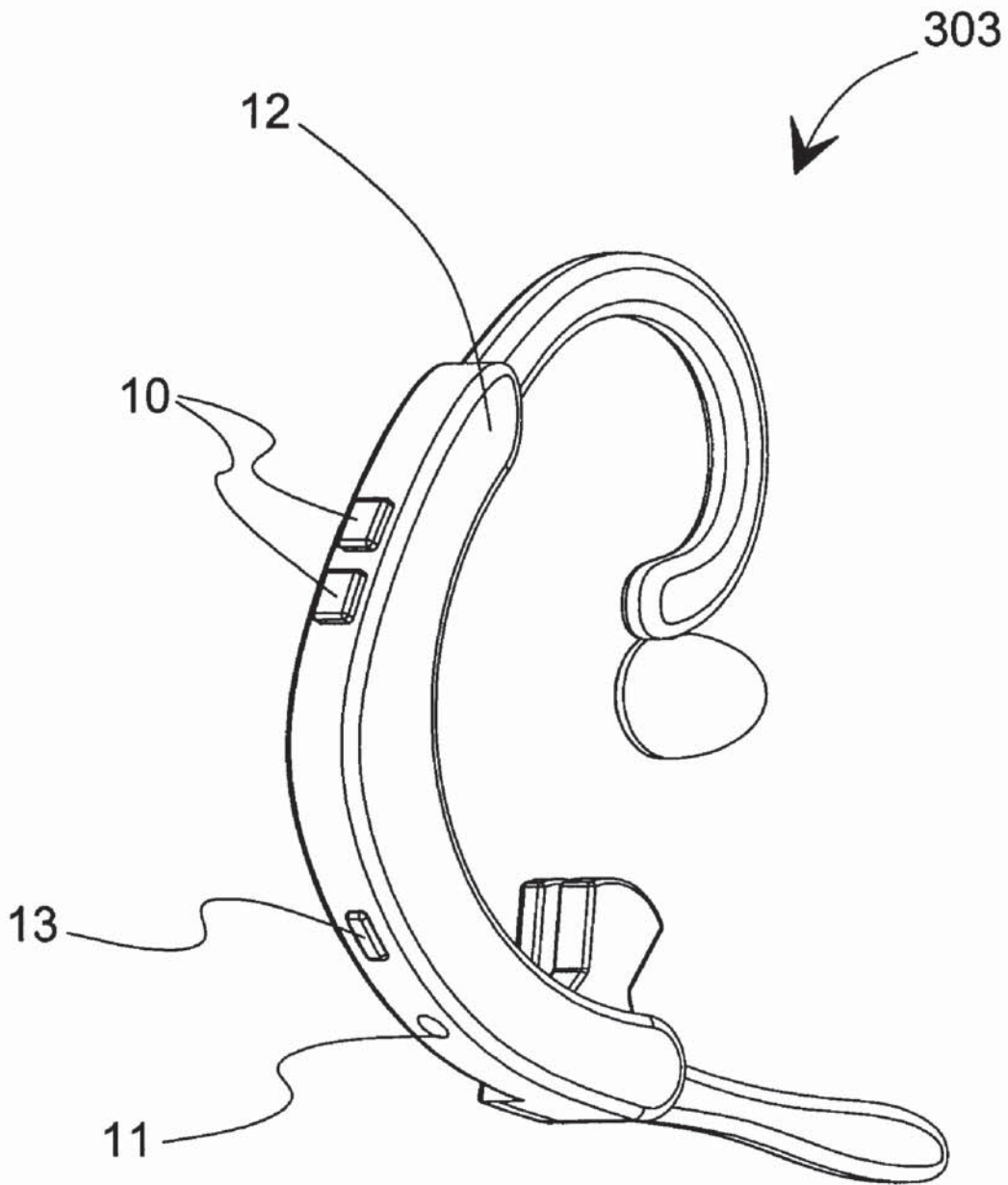

Fig. 2

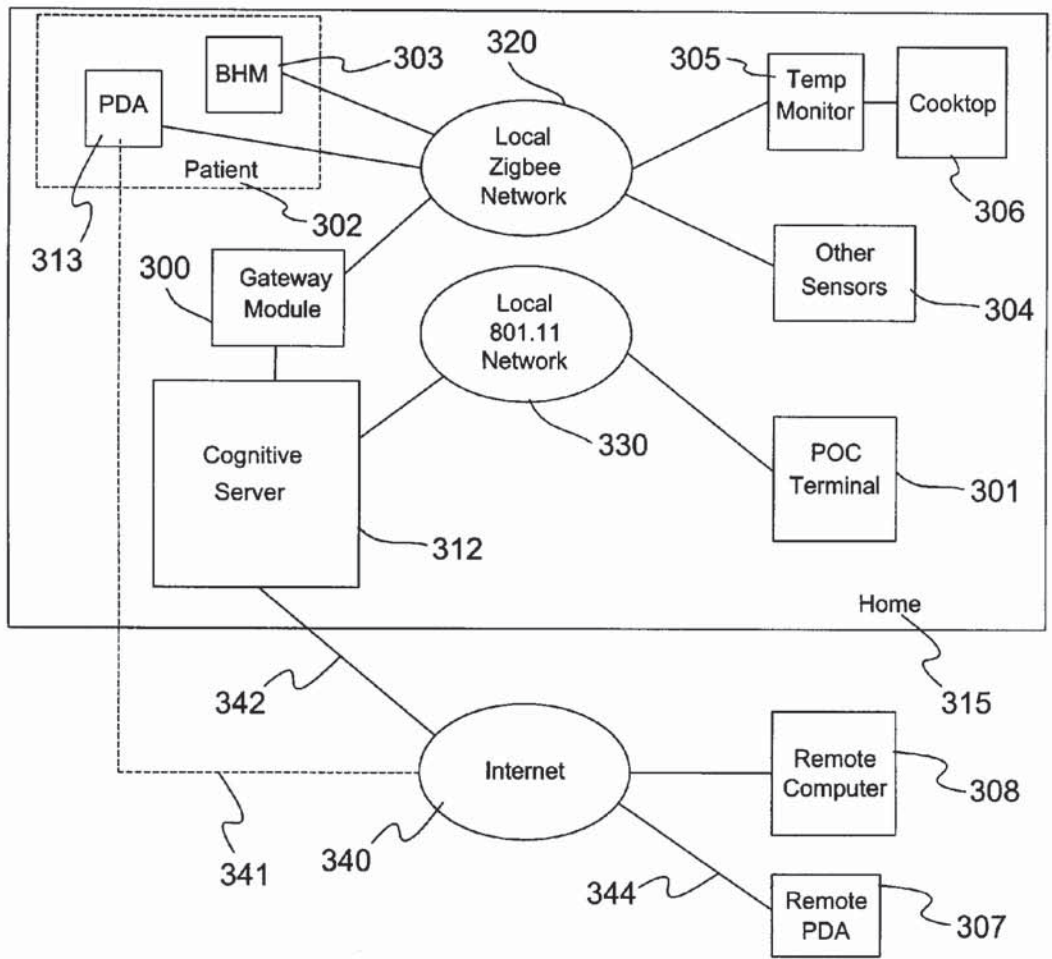

Fig. 3

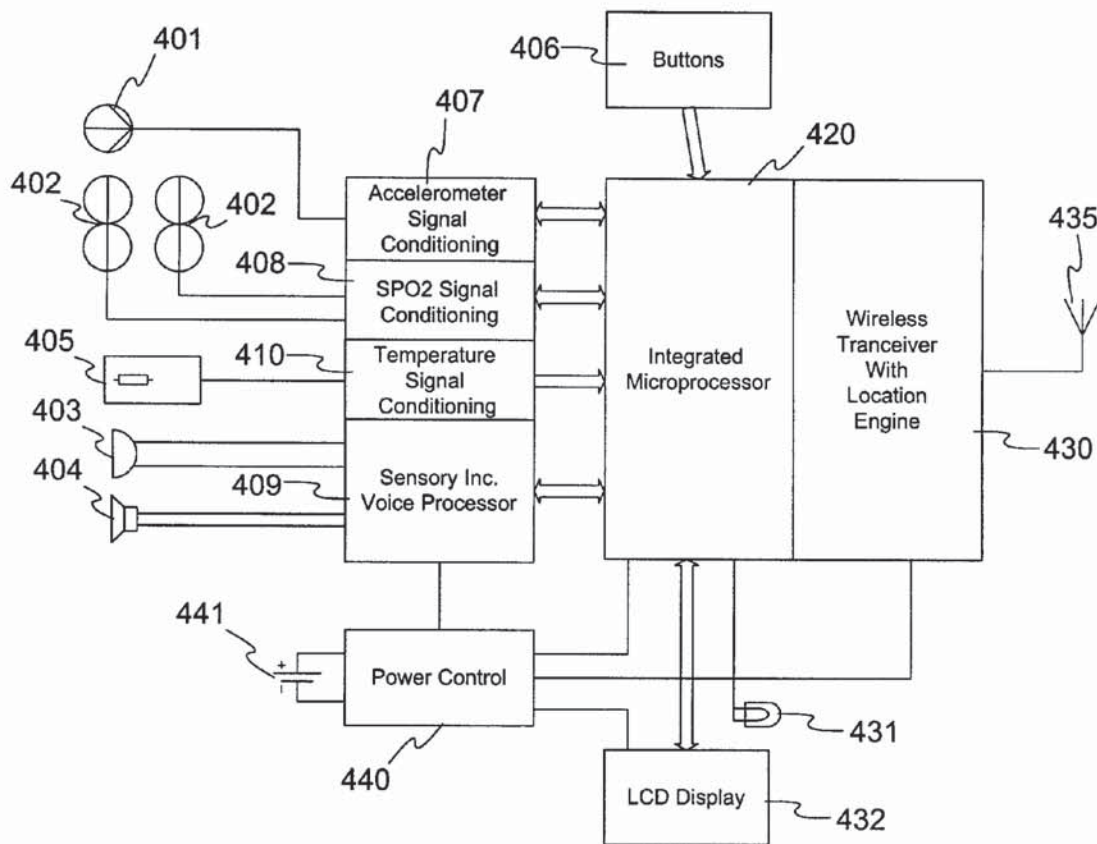

Fig. 4

# Explore Litigation Insights

Docket Alarm provides insights to develop a more informed litigation strategy and the peace of mind of knowing you're on top of things.

## Real-Time Litigation Alerts



Keep your litigation team up-to-date with **real-time alerts** and advanced team management tools built for the enterprise, all while greatly reducing PACER spend.

Our comprehensive service means we can handle Federal, State, and Administrative courts across the country.

## Advanced Docket Research



With over 230 million records, Docket Alarm's cloud-native docket research platform finds what other services can't. Coverage includes Federal, State, plus PTAB, TTAB, ITC and NLRB decisions, all in one place.

Identify arguments that have been successful in the past with full text, pinpoint searching. Link to case law cited within any court document via Fastcase.

## Analytics At Your Fingertips



Learn what happened the last time a particular judge, opposing counsel or company faced cases similar to yours.

Advanced out-of-the-box PTAB and TTAB analytics are always at your fingertips.

## API

Docket Alarm offers a powerful API (application programming interface) to developers that want to integrate case filings into their apps.

## LAW FIRMS

Build custom dashboards for your attorneys and clients with live data direct from the court.

Automate many repetitive legal tasks like conflict checks, document management, and marketing.

## FINANCIAL INSTITUTIONS

Litigation and bankruptcy checks for companies and debtors.

## E-DISCOVERY AND LEGAL VENDORS

Sync your system to PACER to automate legal marketing.