

[54] APPARATUS RESPONSIVE TO MOVEMENT OF A PATIENT DURING TREATMENT/DIAGNOSIS

[75] Inventors: Andre M. Kalend, Monroeville; Joel Greenberger, Sewickley; Karun B. Shimoga, Pittsburgh; Charalambos N. Athanassiou, Pittsburgh; Takeo Kanade, Pittsburgh, all of Pa.

[73] Assignee: University of Pittsburgh of the Commonwealth System of Higher Education, Pittsburgh, Pa.

[21] Appl. No.: 715,834

[22] Filed: Sep. 19, 1996

[51] Int. Cl.⁶ A61B 6/00

[52] U.S. Cl. 128/653.1

[58] Field of Search 128/630, 653.1, 128/660.03; 364/413.02, 413.13, 413.25, 413.26; 356/375; 378/69, 205

[56] References Cited

U.S. PATENT DOCUMENTS

4,466,075	8/1984	Groch et al.	364/413.26 X
5,080,100	1/1992	Trotel	128/653.1
5,103,823	4/1992	Acharya et al.	128/653.1
5,214,711	5/1993	Neely et al.	364/413.27 X
5,295,483	3/1994	Nowacki et al.	128/660.03
5,389,101	2/1995	Heilbrun et al.	128/653.1 X
5,398,684	3/1995	Hardy	128/653.1
5,446,548	8/1995	Geig et al.	128/653.1 X
5,482,042	1/1996	Fujita	128/653.1
5,558,430	9/1996	Bova et al.	128/653.1

OTHER PUBLICATIONS

Active Shape Models—'Smart Snakes', T.F. Cootes and C.J. Taylor, pp. 267–275, Proceedings of European Conference on Computer Vision, Genoa, Italy, 1992.

Training Models of Shape from Sets of Examples, T.F. Cootes, C.J. Taylor, D.H. Cooper, and J. Graham, pp. 8–18, Proceedings of European Conference on Computer Vision, Genoa, Italy, 1992.

A Computational Framework and an Algorithm for the Measurement of Visual Motion, P. Anandan, pp. 283–310, International Journal of Computer Vision, 2, 1989.

Feature Extraction from Faces Using Deformable Templates, A.L. Yuille, P.W. Hallinan, and D.S. Cohen, pp. 99–111, International Journal of Computer Vision, 8:2, 1992.

Computer and Robot Vision, vol. I, R. M. Haralick and L. G. Shapiro, pp. 328–353, Library of Congress Cataloging-in-Publication Data, 1992.

Motion Tracking with an Active Camera, D. Murray and A. Basu, pp. 449–459, IEEE Transactions on Pattern Analysis and Machine Intelligence, vol. 16, No. 5, May 1994.

Primary Examiner—Francis Jaworski
Attorney, Agent, or Firm—Richard V. Westerhoff; Eckert Seamans Cherin & Mellott, LLC

[57] ABSTRACT

A camera generates digital image signals representing an image of one or more natural or artificial fiducials on a patient positioned on treatment or diagnosis equipment. A processor applies multiple levels of filtering at multiple levels of resolution to repetitively determine successive fiducial positions. A warning signal is generated if movement exceeds certain limits but is still acceptable for treatment. Unacceptable displacement results in termination of the treatment beam. Tracking templates can be generated interactively from a display of the digital image signals or through automatic selection of an image having the median correlation to an initial template. A gating signal synchronized to patient breathing can be extracted from the digital image signals for controlling the radiation beam generator.

22 Claims, 12 Drawing Sheets

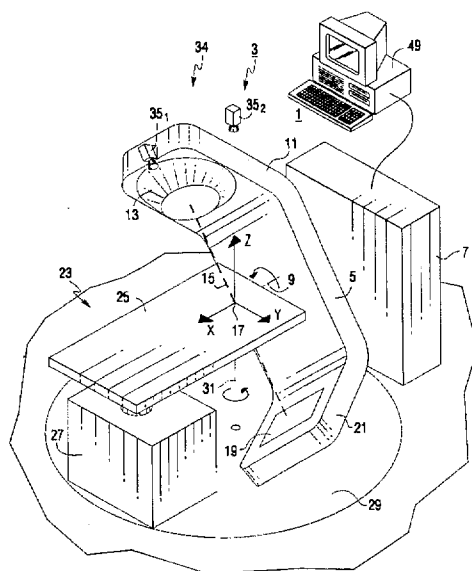

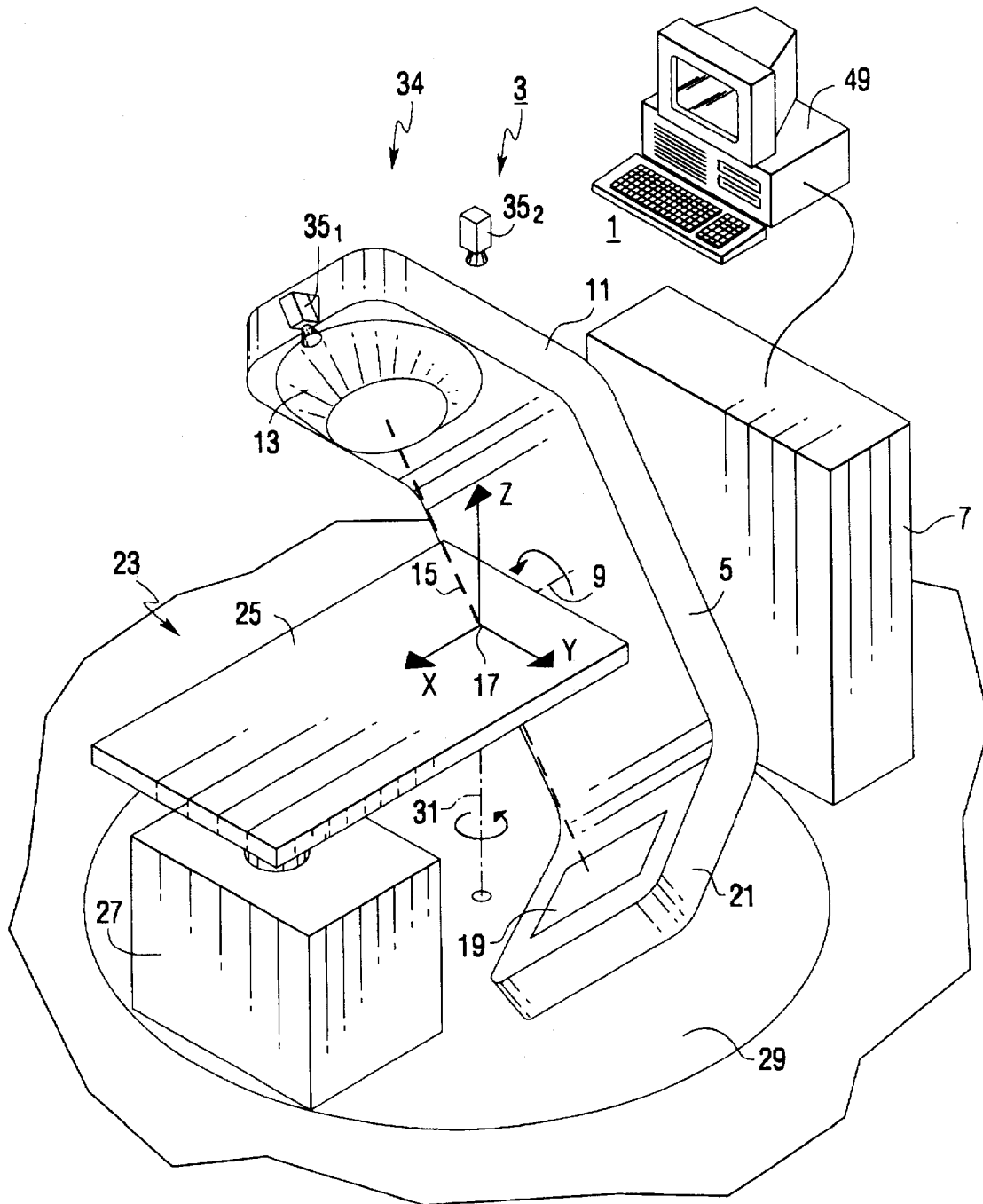

FIG. 1

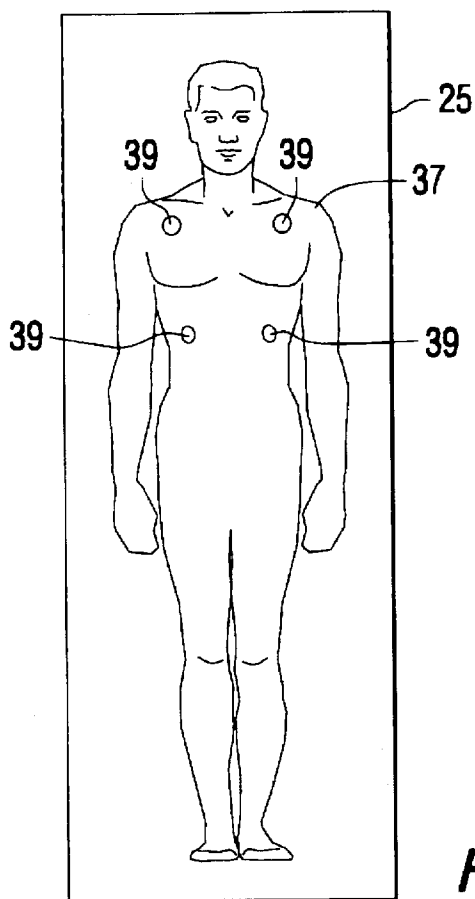

FIG. 2

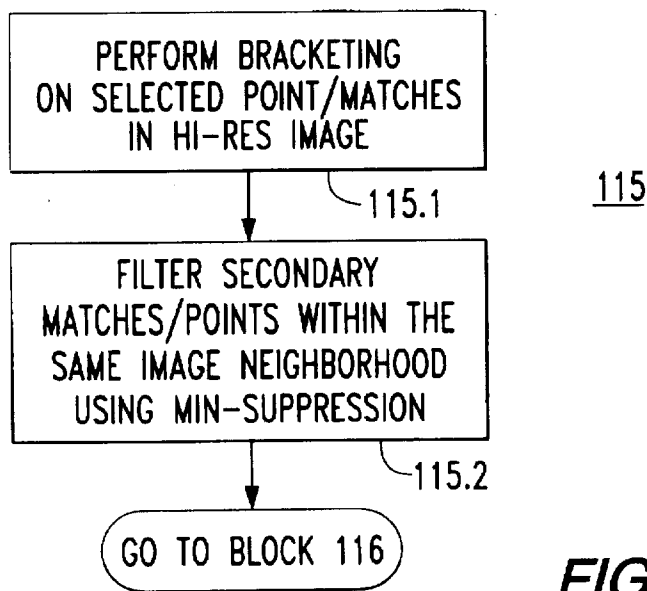

FIG. 9

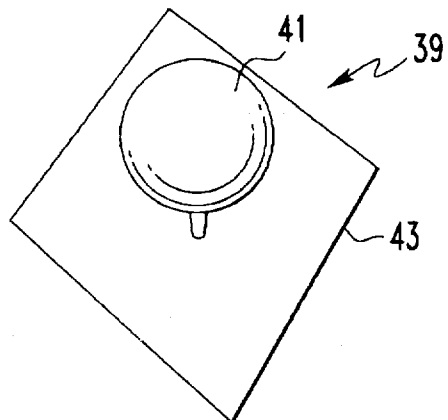

FIG. 3

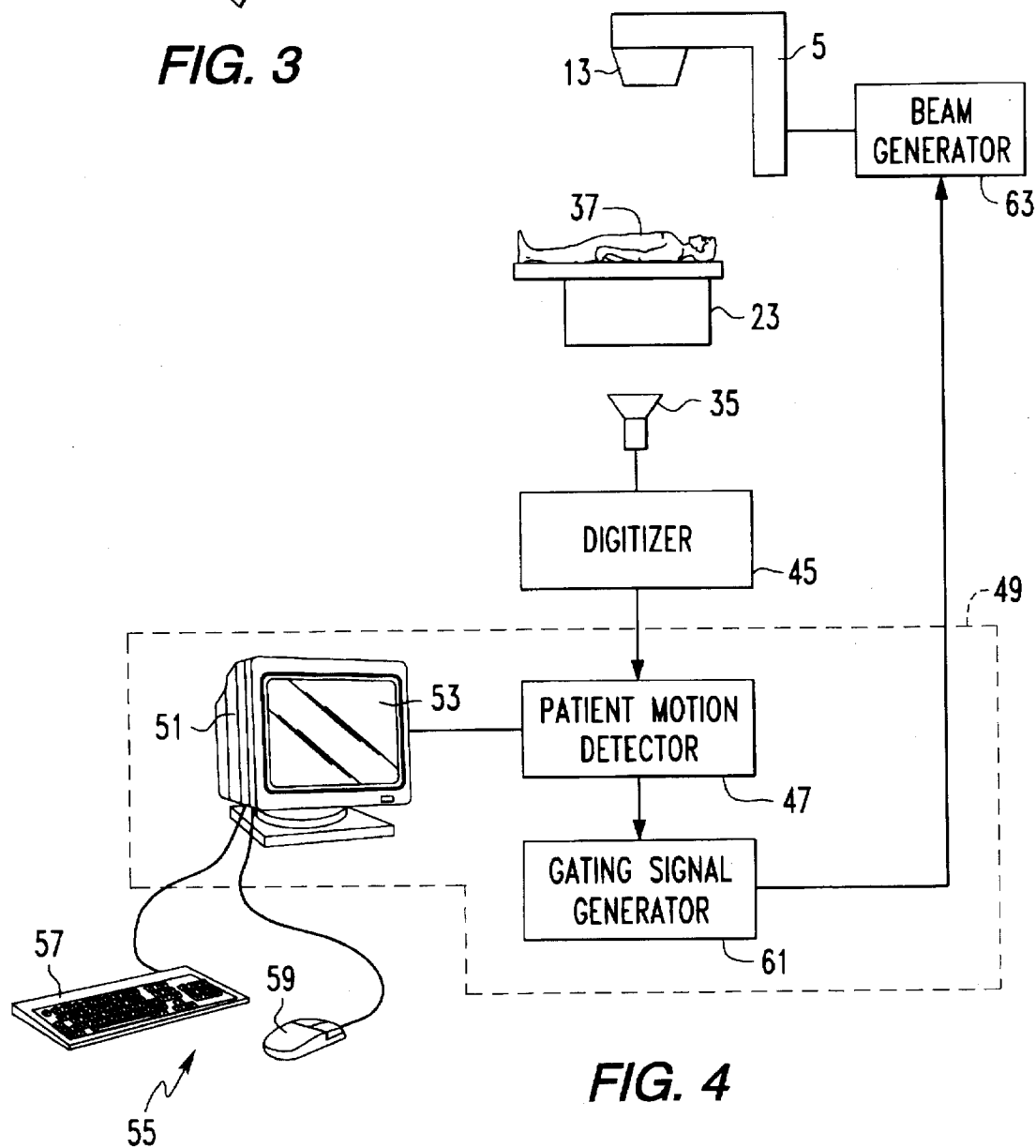

FIG. 4

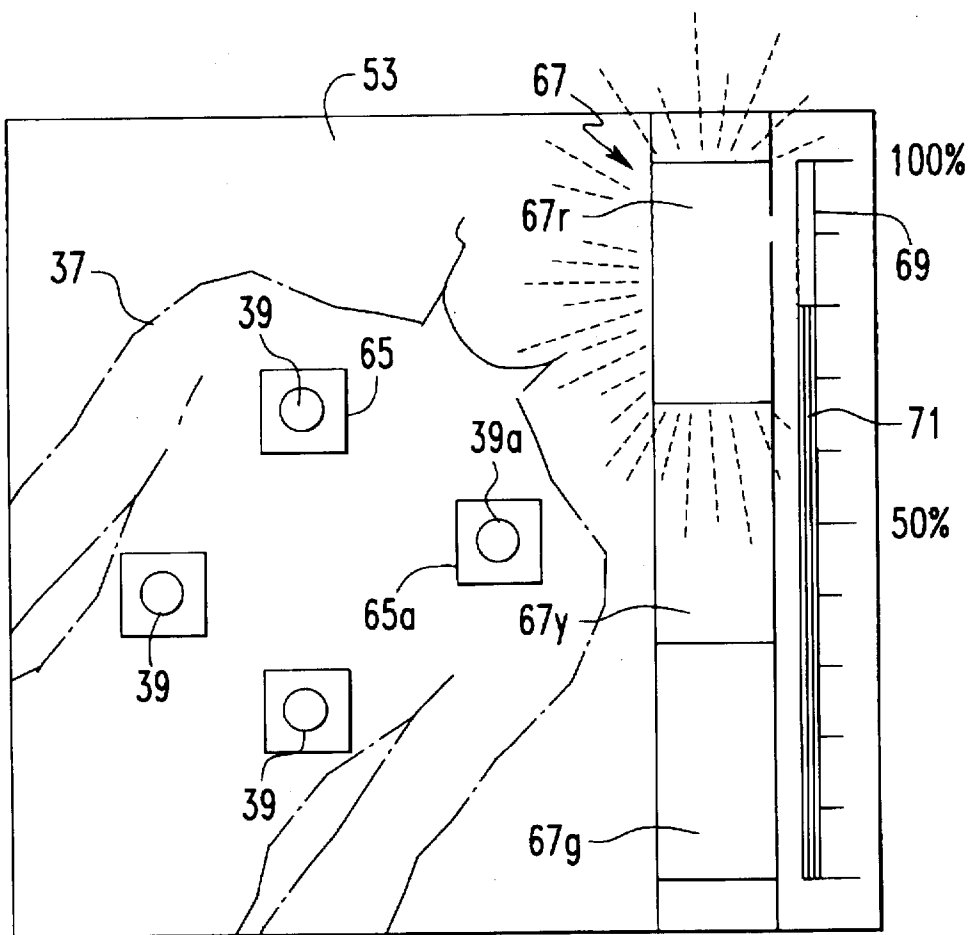

FIG. 5

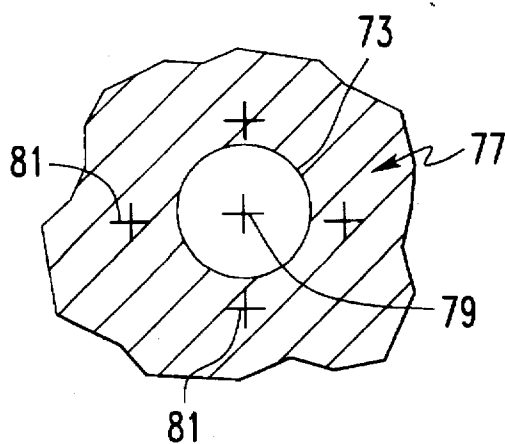

FIG. 17

Explore Litigation Insights

Docket Alarm provides insights to develop a more informed litigation strategy and the peace of mind of knowing you're on top of things.

Real-Time Litigation Alerts



Keep your litigation team up-to-date with **real-time alerts** and advanced team management tools built for the enterprise, all while greatly reducing PACER spend.

Our comprehensive service means we can handle Federal, State, and Administrative courts across the country.

Advanced Docket Research



With over 230 million records, Docket Alarm's cloud-native docket research platform finds what other services can't. Coverage includes Federal, State, plus PTAB, TTAB, ITC and NLRB decisions, all in one place.

Identify arguments that have been successful in the past with full text, pinpoint searching. Link to case law cited within any court document via Fastcase.

Analytics At Your Fingertips



Learn what happened the last time a particular judge, opposing counsel or company faced cases similar to yours.

Advanced out-of-the-box PTAB and TTAB analytics are always at your fingertips.

API

Docket Alarm offers a powerful API (application programming interface) to developers that want to integrate case filings into their apps.

LAW FIRMS

Build custom dashboards for your attorneys and clients with live data direct from the court.

Automate many repetitive legal tasks like conflict checks, document management, and marketing.

FINANCIAL INSTITUTIONS

Litigation and bankruptcy checks for companies and debtors.

E-DISCOVERY AND LEGAL VENDORS

Sync your system to PACER to automate legal marketing.