



US006581594B1

(12) **United States Patent**
Drew et al.

(10) **Patent No.:** **US 6,581,594 B1**
(45) **Date of Patent:** **Jun. 24, 2003**

(54) **RESPIRATORY MASK HAVING GAS WASHOUT VENT AND GAS WASHOUT VENT FOR RESPIRATORY MASK**

5,937,851 A * 8/1999 Serowski et al. 128/205.11
6,112,746 A * 9/2000 Kwok et al. 128/207.13
6,119,693 A * 9/2000 Kwok et al. 128/207.13
6,192,886 B1 * 2/2001 Rudolph 128/207.13

(75) Inventors: **Joanne Drew**, Balgowlah (AU);
Alexander Virr, Balmain (AU);
Geoffrey Crumblin, Baulkham Hills (AU)

FOREIGN PATENT DOCUMENTS

AU 712236 4/1999
EP 0697225 A2 2/1996

(73) Assignee: **ResMed Limited**, North Ryde (AU)

OTHER PUBLICATIONS

(*) Notice: Subject to any disclaimer, the term of this patent is extended or adjusted under 35 U.S.C. 154(b) by 0 days.

Instruction Brochure for "E-Vent-N" ©Aug. 1997 Dräger Medizintechnik GmbH, 2 pages.

* cited by examiner

(21) Appl. No.: **09/570,907**

Primary Examiner—Aaron J. Lewis

(22) Filed: **May 15, 2000**

(74) *Attorney, Agent, or Firm*—Pillsbury Winthrop LLP

(51) **Int. Cl.**⁷ **A61M 16/00**

(57) **ABSTRACT**

(52) **U.S. Cl.** **128/204.18; 128/207.12; 128/207.13**

(58) **Field of Search** 128/200.29, 201.29, 128/204.18, 205.11, 207.12, 207.13

The present invention provides a vent assembly suitable for use with a respiratory mask of the type used in CPAP treatment. In one embodiment the vent is made of a thin air permeable membrane. Generally, the membrane is thinner than 0.5 mm. The membrane can be made of a hydrophobic material such as polytetrafluoroethylene (PTFE). The membrane can also be fabricated from expanded PTFE. The expanded PTFE membrane is mounted on a polypropylene scrim. The pores of the membrane have a reference pore size of 10 to 15 microns. In an alternative embodiment, the vent assembly includes a vent constructed from stainless steel. In another embodiment the membrane has a superficial cross-sectional area of approximately 500 mm². In another embodiment the vent assembly comprises a membrane attached to a vent frame, the vent assembly forming an insert which can be removeably attached to a mask frame.

(56) **References Cited**

U.S. PATENT DOCUMENTS

3,291,127 A * 12/1966 Eimer et al. 128/207.15
3,850,171 A * 11/1974 Ball et al. 128/205.11
4,258,710 A * 3/1981 Reber 128/204.18
4,266,540 A * 5/1981 Panzik et al. 128/207.12
5,065,756 A * 11/1991 Rapoport 128/204.18
5,148,802 A * 9/1992 Sanders et al. 128/204.18
5,477,852 A * 12/1995 Landis et al. 128/204.18
5,560,354 A * 10/1996 Berthon-Jones et al. 128/204.18
5,657,752 A * 8/1997 Landis et al. 128/204.18

8 Claims, 4 Drawing Sheets

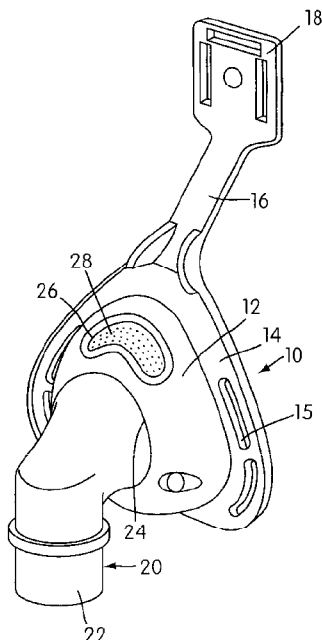

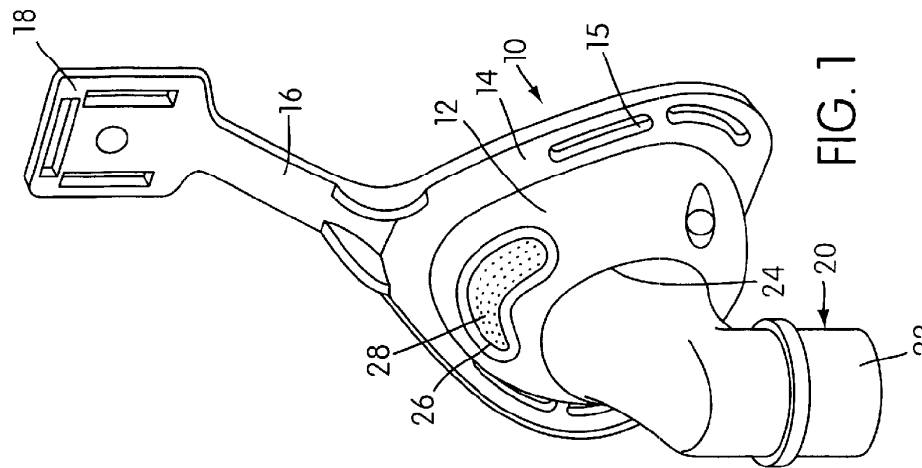
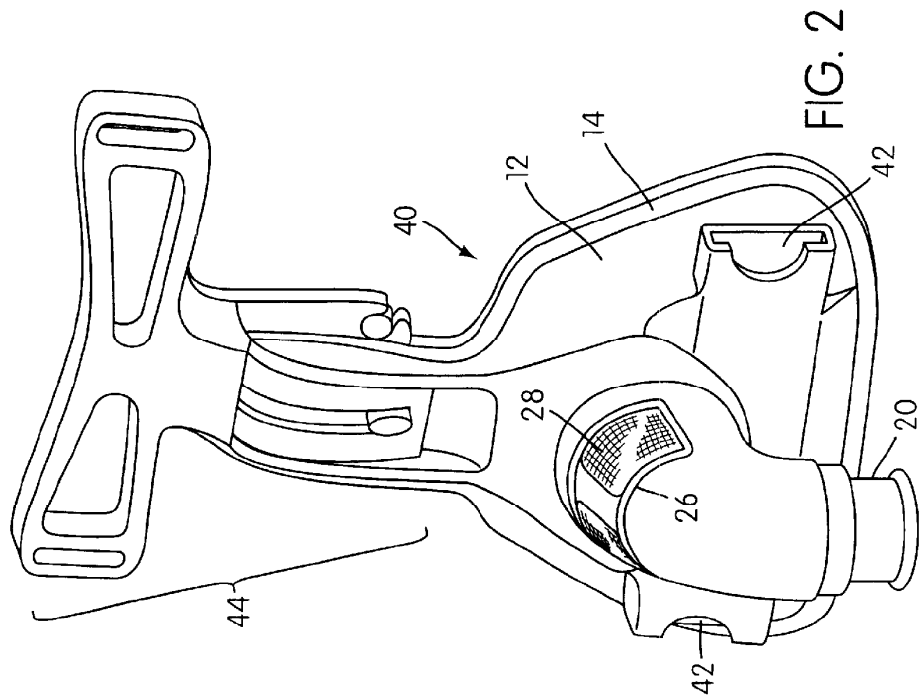

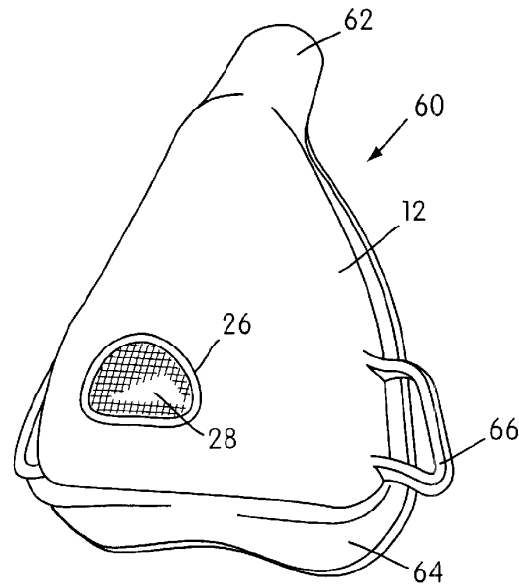

FIG. 3

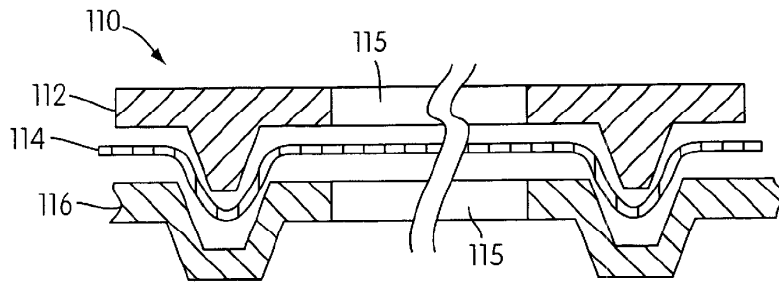

FIG. 4

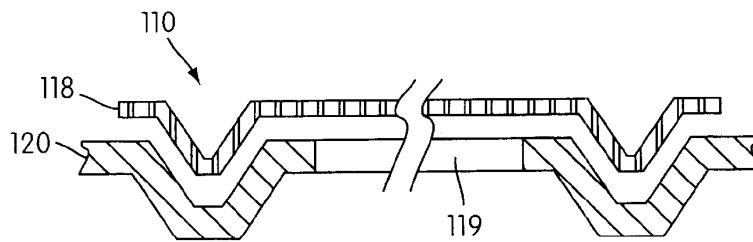

FIG. 5

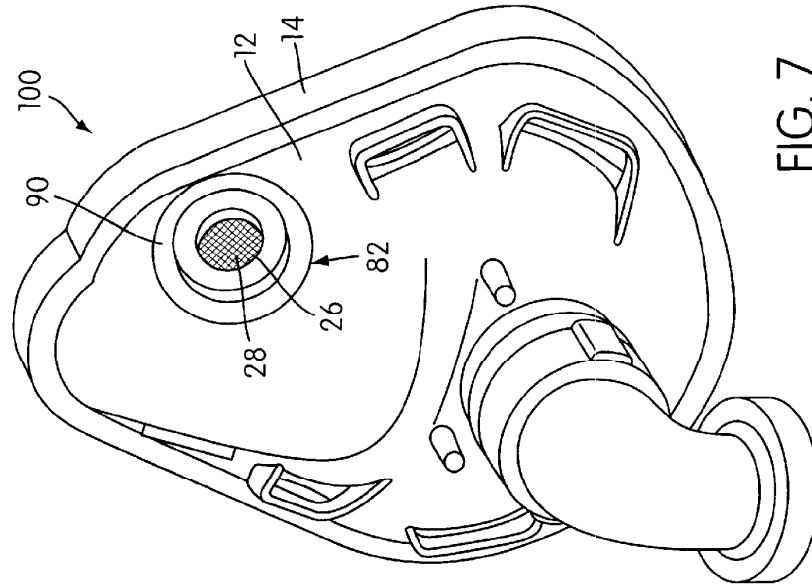

FIG. 7

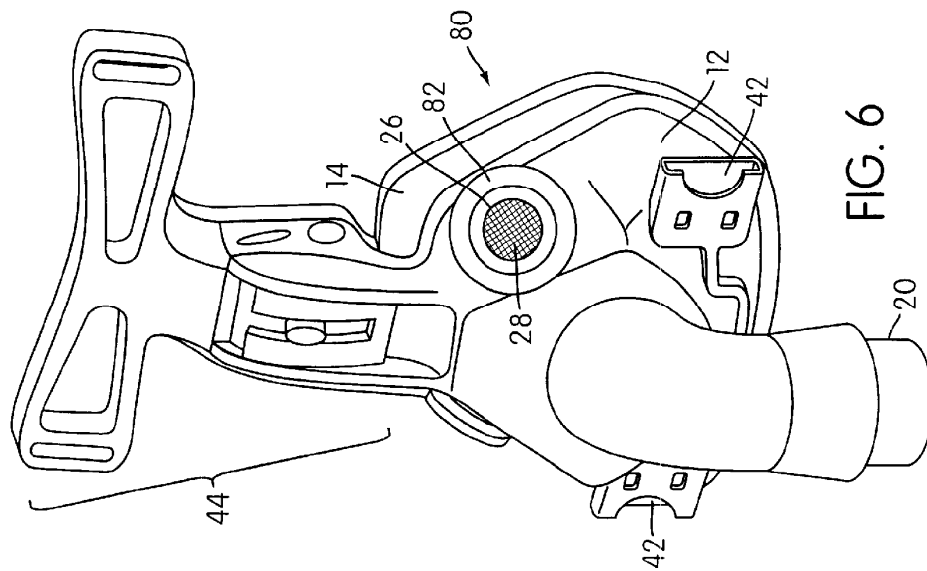
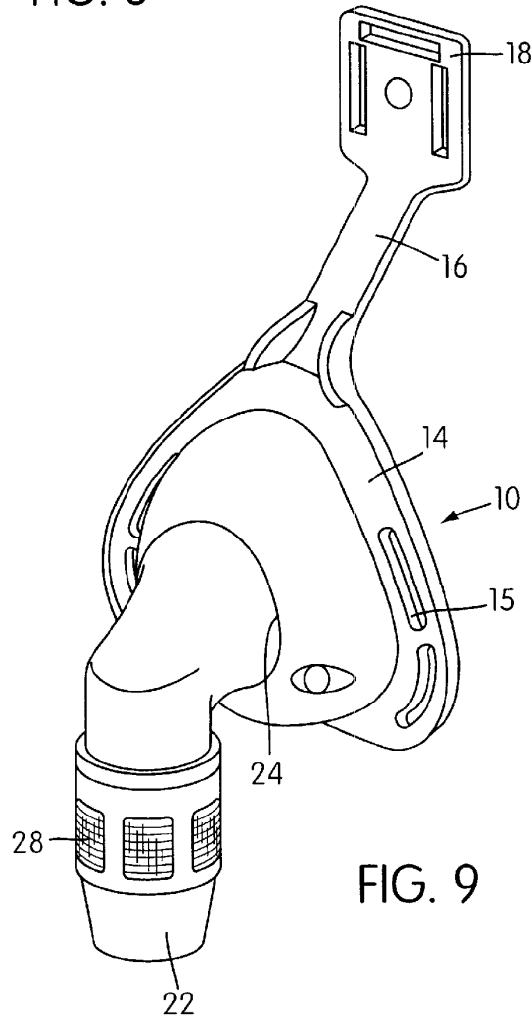
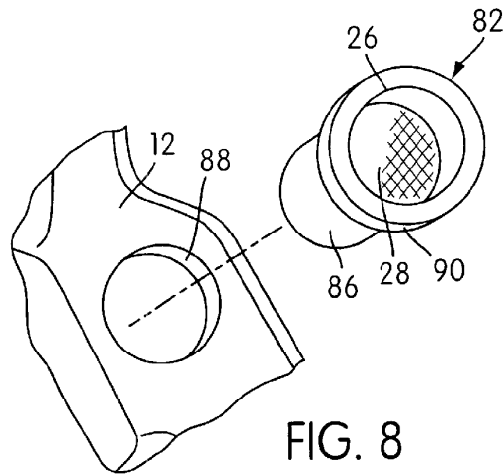

FIG. 6



Explore Litigation Insights

Docket Alarm provides insights to develop a more informed litigation strategy and the peace of mind of knowing you're on top of things.

Real-Time Litigation Alerts



Keep your litigation team up-to-date with **real-time alerts** and advanced team management tools built for the enterprise, all while greatly reducing PACER spend.

Our comprehensive service means we can handle Federal, State, and Administrative courts across the country.

Advanced Docket Research



With over 230 million records, Docket Alarm's cloud-native docket research platform finds what other services can't. Coverage includes Federal, State, plus PTAB, TTAB, ITC and NLRB decisions, all in one place.

Identify arguments that have been successful in the past with full text, pinpoint searching. Link to case law cited within any court document via Fastcase.

Analytics At Your Fingertips



Learn what happened the last time a particular judge, opposing counsel or company faced cases similar to yours.

Advanced out-of-the-box PTAB and TTAB analytics are always at your fingertips.

API

Docket Alarm offers a powerful API (application programming interface) to developers that want to integrate case filings into their apps.

LAW FIRMS

Build custom dashboards for your attorneys and clients with live data direct from the court.

Automate many repetitive legal tasks like conflict checks, document management, and marketing.

FINANCIAL INSTITUTIONS

Litigation and bankruptcy checks for companies and debtors.

E-DISCOVERY AND LEGAL VENDORS

Sync your system to PACER to automate legal marketing.