



US006691707B1

(12) **United States Patent**
Gunaratnam et al.

(10) **Patent No.:** **US 6,691,707 B1**
(45) **Date of Patent:** **Feb. 17, 2004**

(54) **CONNECTOR FOR A RESPIRATORY MASK AND A RESPIRATORY MASK**

(75) **Inventors:** **Michael K. Gunaratnam**, Marsfield (AU); **Joanne E. Drew**, Balgowlah (AU); **Geoffrey Crumblin**, Baulkham Hills (AU); **Phillip Jenkinson**, Epping (AU); **Susan R. Lynch**, Rodd Point (AU)

(73) **Assignee:** **ResMed Limited**, North Ryde (AU)

(*) **Notice:** Subject to any disclaimer, the term of this patent is extended or adjusted under 35 U.S.C. 154(b) by 0 days.

(21) **Appl. No.:** **09/594,775**

(22) **Filed:** **Jun. 16, 2000**

(30) **Foreign Application Priority Data**

Jun. 18, 1999 (AU) PQ 1029

(51) **Int. Cl.⁷** **A62B 18/02**

(52) **U.S. Cl.** **128/206.21; 128/207.13**

(58) **Field of Search** 128/206.21, 207.13, 128/207.18, 206.28, 205.27, 205.28, 204.18, 202.27, 912, 207.12, 206.12, 206.15, 206.18

(56) **References Cited**

U.S. PATENT DOCUMENTS

- 4,015,598 A * 4/1977 Brown 128/203.23
- 4,463,755 A 8/1984 Suzuki
- 4,794,921 A * 1/1989 Lindkvist 128/203.29
- 5,018,519 A * 5/1991 Brown 128/203.29

- 5,560,354 A * 10/1996 Berthon-Jones et al. 128/205.25
- 5,694,922 A * 12/1997 Palmer 128/202.27
- 5,871,011 A * 2/1999 Howell et al. 128/206.22
- 5,921,239 A * 7/1999 McCall et al. 128/205.25
- 5,937,851 A * 8/1999 Scrowski et al. 128/202.27
- 5,975,077 A * 11/1999 Hofstetter et al. 128/204.24
- 6,196,223 B1 * 3/2001 Belfer et al. 128/206.25

FOREIGN PATENT DOCUMENTS

- CA 1039144 9/1978
- DE 197 57 703 C1 10/1999
- WO WO 98/34665 8/1998

* cited by examiner

Primary Examiner—Weilun Lo

Assistant Examiner—Tenna Mitchell

(74) *Attorney, Agent, or Firm*—Nixon & Vanderhye, P.C.

(57) **ABSTRACT**

A connector includes a mask end for connecting with the interior of a respiratory mask, a supply conduit end, and a gas washout vent passage having an inlet adjacent to, or forming part of, the mask end in fluid communication with the interior of the respiratory mask and an outlet in fluid communication with atmosphere. The vent outlet of the vent passage is disposed on the side of the connector remote from the mask end. A respiratory mask includes a mask shell, a mask inlet for connecting with the outlet of a breathable gas supply conduit, and a gas washout vent passage. A vent outlet is disposed on the side of the mask remote from the mask interior and is adapted to direct the washout gas in a direction substantially parallel to the longitudinal axis of the mask inlet and away from the mask inlet.

14 Claims, 9 Drawing Sheets

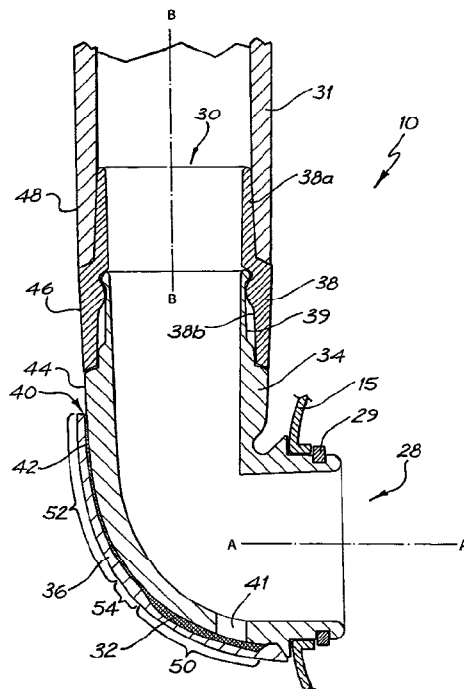

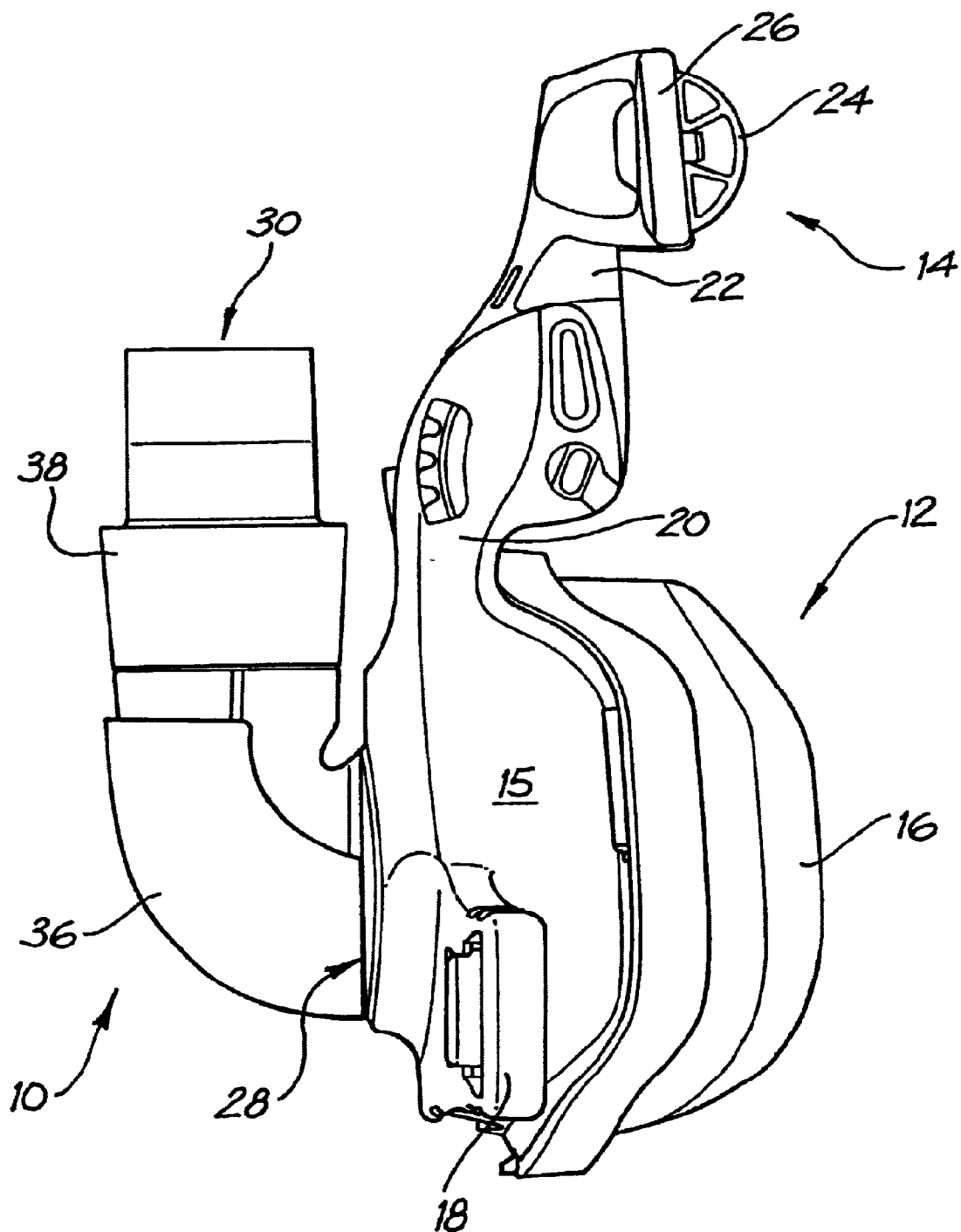

FIG. 1

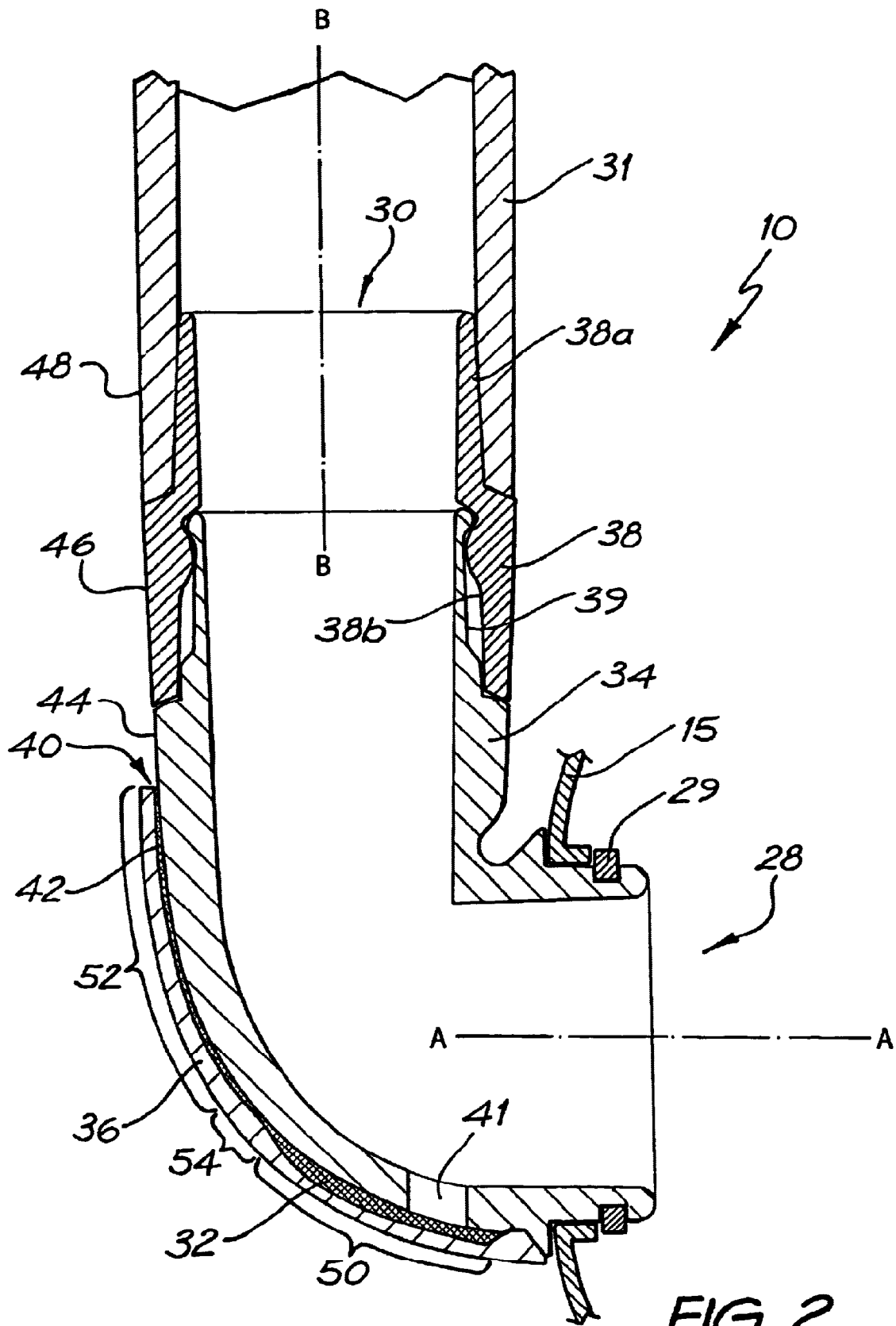

FIG. 2

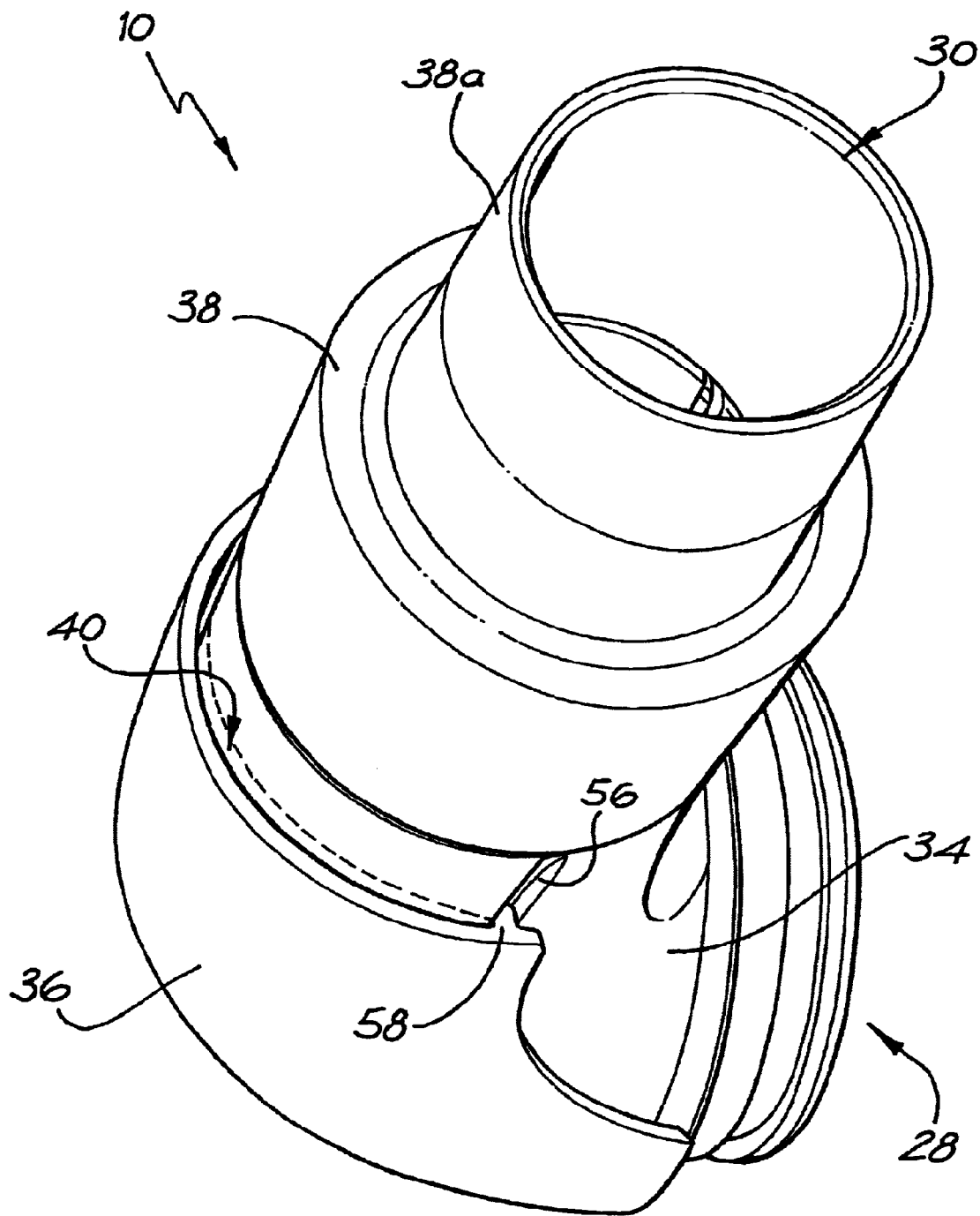

FIG. 3

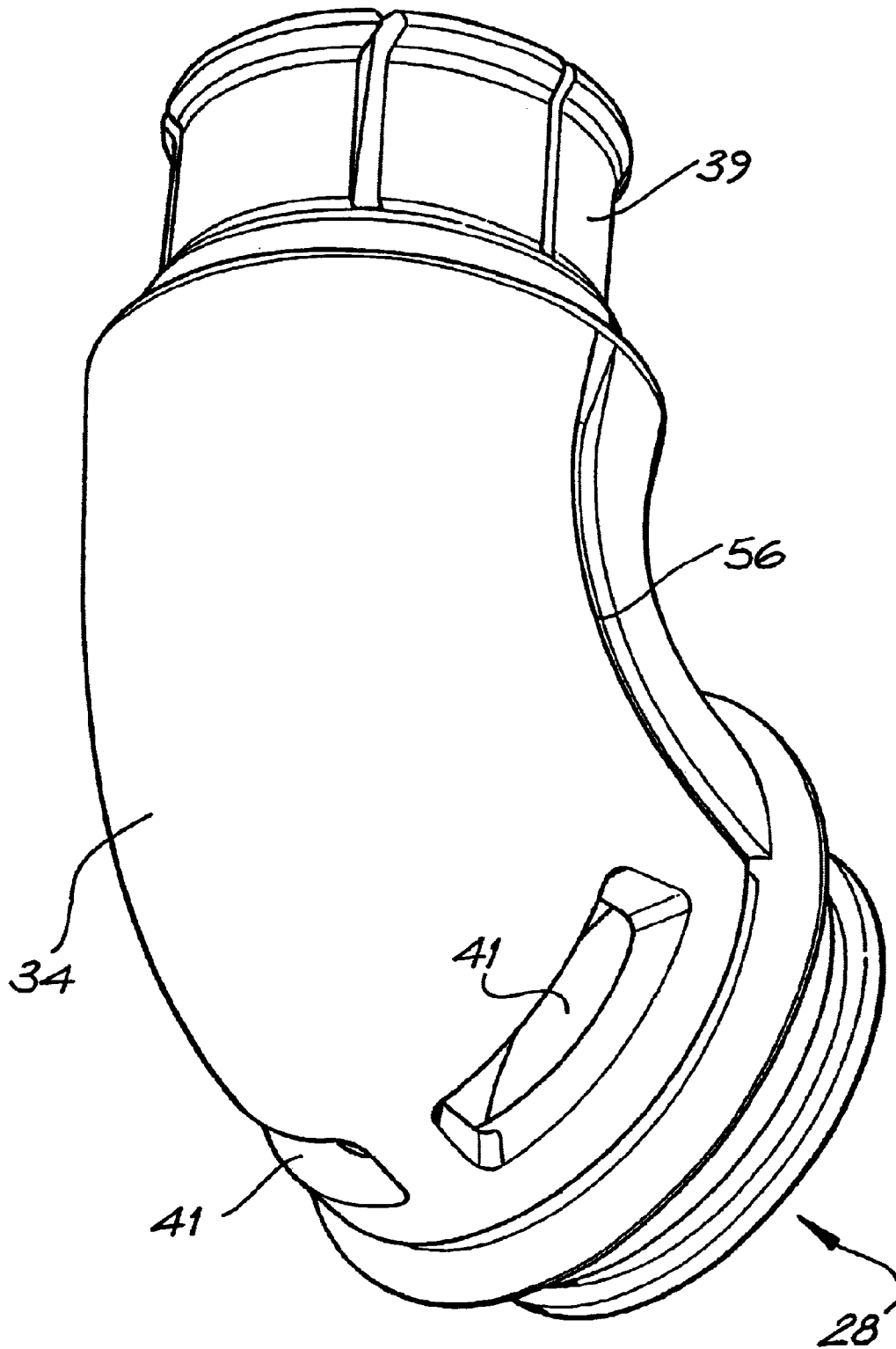

FIG. 4

Explore Litigation Insights

Docket Alarm provides insights to develop a more informed litigation strategy and the peace of mind of knowing you're on top of things.

Real-Time Litigation Alerts



Keep your litigation team up-to-date with **real-time alerts** and advanced team management tools built for the enterprise, all while greatly reducing PACER spend.

Our comprehensive service means we can handle Federal, State, and Administrative courts across the country.

Advanced Docket Research



With over 230 million records, Docket Alarm's cloud-native docket research platform finds what other services can't. Coverage includes Federal, State, plus PTAB, TTAB, ITC and NLRB decisions, all in one place.

Identify arguments that have been successful in the past with full text, pinpoint searching. Link to case law cited within any court document via Fastcase.

Analytics At Your Fingertips



Learn what happened the last time a particular judge, opposing counsel or company faced cases similar to yours.

Advanced out-of-the-box PTAB and TTAB analytics are always at your fingertips.

API

Docket Alarm offers a powerful API (application programming interface) to developers that want to integrate case filings into their apps.

LAW FIRMS

Build custom dashboards for your attorneys and clients with live data direct from the court.

Automate many repetitive legal tasks like conflict checks, document management, and marketing.

FINANCIAL INSTITUTIONS

Litigation and bankruptcy checks for companies and debtors.

E-DISCOVERY AND LEGAL VENDORS

Sync your system to PACER to automate legal marketing.