



(12) **United States Patent**  
**Bence et al.**

(10) **Patent No.:** **US 7,479,035 B2**  
(45) **Date of Patent:** **Jan. 20, 2009**

(54) **ELECTRICAL CONNECTOR WITH  
GROUNDING MEMBER**

(75) Inventors: **Bruce D. Bence**, Glendale, AZ (US);  
**Donald A. Burris**, Peoria, AZ (US);  
**Brian L. Kisling**, Phoenix, AZ (US);  
**John A. Kooiman**, Peoria, AZ (US);  
**William B. Lutz**, Glendale, AZ (US);  
**William F. McDade**, Glendale, AZ (US);  
**Thomas D. Miller**, Peoria, AZ (US);  
**Lee Yung Chuan**, Sanchong (TW)

3,686,623 A 8/1972 Nijman ..... 339/177 E  
3,778,535 A \* 12/1973 Forney, Jr. .... 174/88 C  
3,793,610 A 2/1974 Brishka ..... 339/74 R  
3,835,443 A \* 9/1974 Arnold et al. .... 439/319  
3,879,102 A 4/1975 Horak ..... 339/143 R  
4,079,343 A 3/1978 Nijman ..... 333/79  
4,082,404 A 4/1978 Flatt ..... 339/111

(Continued)

(73) Assignee: **Corning Gilbert Inc.**, Glendale, AZ  
(US)

**FOREIGN PATENT DOCUMENTS**

(\* ) Notice: Subject to any disclaimer, the term of this  
patent is extended or adjusted under 35  
U.S.C. 154(b) by 32 days.

GB 1 401 373 7/1975

(21) Appl. No.: **11/541,903**

**OTHER PUBLICATIONS**

(22) Filed: **Oct. 2, 2006**  
(Under 37 CFR 1.47)

US Office Action, U.S. Appl. No. 10/997,218; filed Jul. 31, 2006, pp.  
1-10.

(65) **Prior Publication Data**  
US 2007/0026734 A1 Feb. 1, 2007

*Primary Examiner*—T C Patel  
*Assistant Examiner*—Vladimir Imas  
(74) *Attorney, Agent, or Firm*—Joseph M. Homa; Matthew J.  
Mason

**Related U.S. Application Data**

(63) Continuation of application No. 11/043,844, filed on  
Jan. 25, 2005, now Pat. No. 7,114,990.

(57) **ABSTRACT**

(51) **Int. Cl.**  
**H01R 9/05** (2006.01)  
(52) **U.S. Cl.** ..... **439/583**  
(58) **Field of Classification Search** ..... 439/578,  
439/583, 584, 320, 322, 314  
See application file for complete search history.

A coaxial cable connector includes tubular post, a coupler  
secured over an end of the tubular post for securing the con-  
nector to an appliance, and an outer body secured to the  
tubular post. An electrical grounding path is maintained  
between the coupler and the tubular post whether or not the  
coupler is tightly fastened to the appliance. The electrical  
grounding path is provided by a resilient, electrically-conduc-  
tive grounding member disposed between the tubular post  
and the coupler. Alternatively, the connector includes conduc-  
tive grease at a point where mating portions of the tubular post  
and coupler have closely matching dimensions.

(56) **References Cited**  
U.S. PATENT DOCUMENTS

3,665,371 A 5/1972 Cripps ..... 339/90 C  
3,669,472 A \* 6/1972 Nadsady ..... 285/87  
3,678,445 A 7/1972 Brancaleone ..... 339/143 R

**17 Claims, 8 Drawing Sheets**

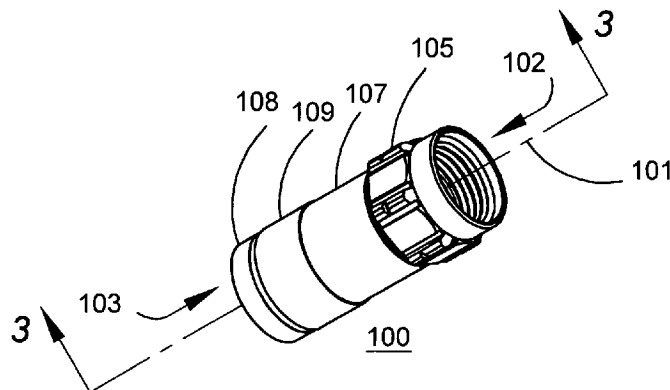

**PPC Exhibit 2012**  
**Corning v. PPC**  
**IPR2016-01573**

U.S. PATENT DOCUMENTS

4,106,839	A	8/1978	Cooper	339/143	R	5,882,226	A	*	3/1999	Bell et al.	439/582
4,153,320	A	5/1979	Townshend	339/91	B	5,938,465	A		8/1999	Fox, Sr.	439/350
4,296,986	A	* 10/1981	Herrmann, Jr.	439/322		5,957,716	A		9/1999	Buckley et al.	439/321
4,389,081	A	* 6/1983	Gallusser et al.	439/320		5,975,951	A	*	11/1999	Burris et al.	439/585
4,408,822	A	* 10/1983	Nikitas	439/583		6,019,635	A		2/2000	Nelson	439/583
4,506,943	A	* 3/1985	Drogo	439/314		6,022,237	A		2/2000	Esh	439/348
4,525,017	A	* 6/1985	Schildkraut et al.	439/320		6,217,383	B1	*	4/2001	Holland et al.	439/578
4,531,805	A	* 7/1985	Werth	439/607		6,331,123	B1	*	12/2001	Rodrigues	439/584
4,545,637	A	10/1985	Bosshard et al.	339/177		6,332,815	B1	*	12/2001	Bruce	439/862
4,580,865	A	4/1986	Fryberger	339/103	M	6,425,782	B1		7/2002	Holland	439/585
4,634,213	A	1/1987	Larsson et al.	339/275	T	6,506,083	B1	*	1/2003	Bickford et al.	439/736
4,734,666	A	3/1988	Ohya et al.	333/230		6,540,531	B2		4/2003	Syed et al.	439/98
4,749,821	A	6/1988	Linton et al.	174/35	R	6,558,194	B2	*	5/2003	Montena	439/585
4,808,128	A	2/1989	Werth	439/610		6,572,419	B2		6/2003	Feye-Homann	439/839
4,867,706	A	9/1989	Tang	439/620		6,576,833	B2		6/2003	Covaro et al.	174/35
4,902,246	A	2/1990	Samchisen	439/578		6,683,253	B1	*	1/2004	Lee	174/75
4,938,718	A	* 7/1990	Guendel	439/680		6,712,631	B1		3/2004	Youtsey	439/322
5,002,503	A	3/1991	Campbell et al.	439/578		6,716,062	B1		4/2004	Palinkas et al.	439/578
5,030,126	A	* 7/1991	Hanlon	439/320		6,848,939	B2	*	2/2005	Stirling	439/578
5,080,600	A	1/1992	Baker et al.	439/258		6,884,115	B2	*	4/2005	Malloy	439/584
5,137,471	A	* 8/1992	Verespej et al.	439/585		2002/0038720	A1	*	4/2002	Kai et al.	174/125.1
5,215,477	A	6/1993	Weber et al.	439/581		2004/0209516	A1	*	10/2004	Burris et al.	439/587
5,362,250	A	* 11/1994	McMills et al.	439/387		2004/0219833	A1	*	11/2004	Burris et al.	439/578
5,380,211	A	1/1995	Kawagauchi et al.	439/74		2005/0042919	A1	*	2/2005	Montena	439/578
5,413,504	A	5/1995	Kloecker et al.	439/620		2005/0181652	A1		8/2005	Montena et al.	439/271
5,444,810	A	8/1995	Szegda	385/139		2005/0181668	A1		8/2005	Montena et al.	439/578
5,683,263	A	11/1997	Hsu	439/319		2006/0110977	A1		5/2006	Matthews	439/578

\* cited by examiner

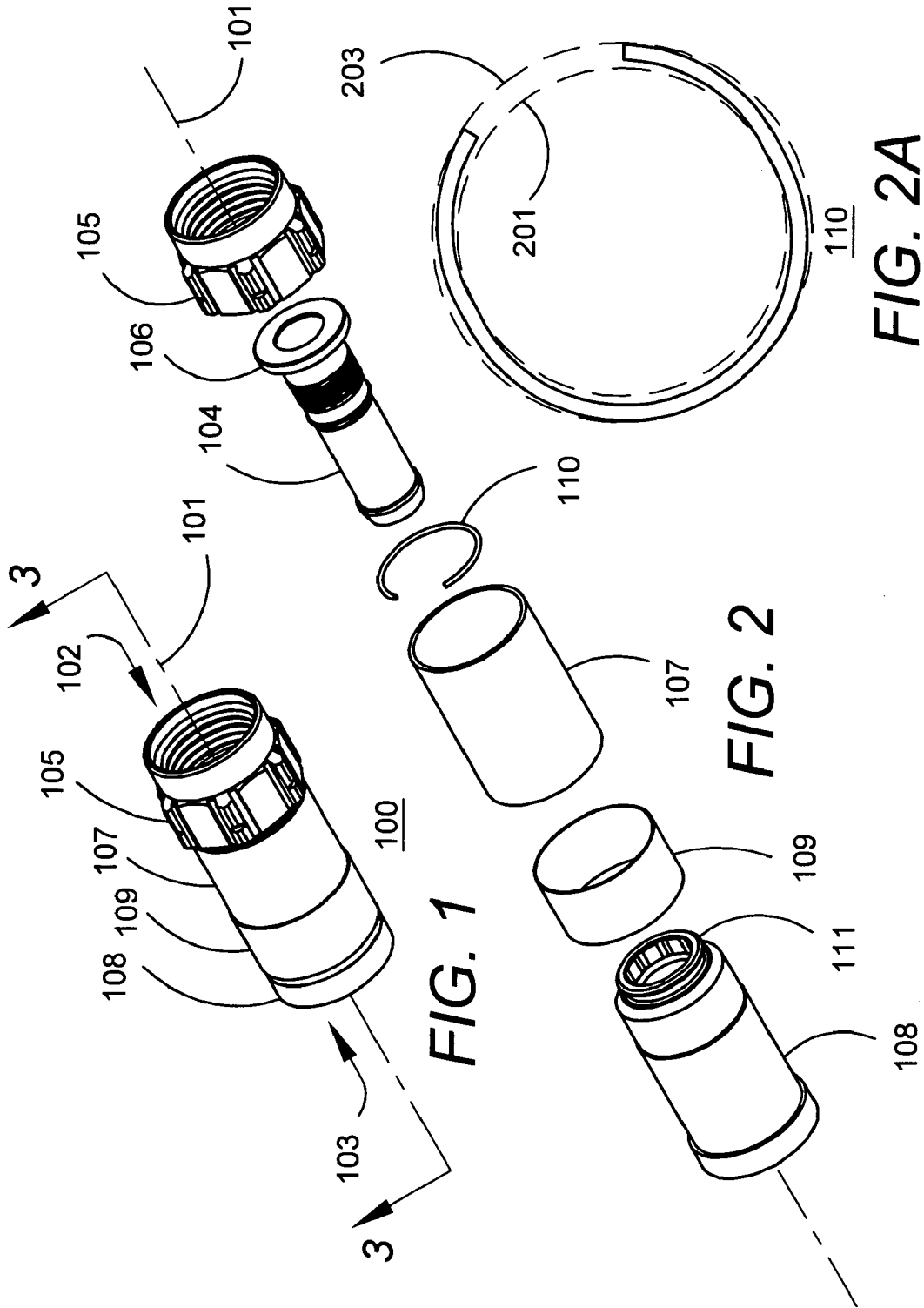

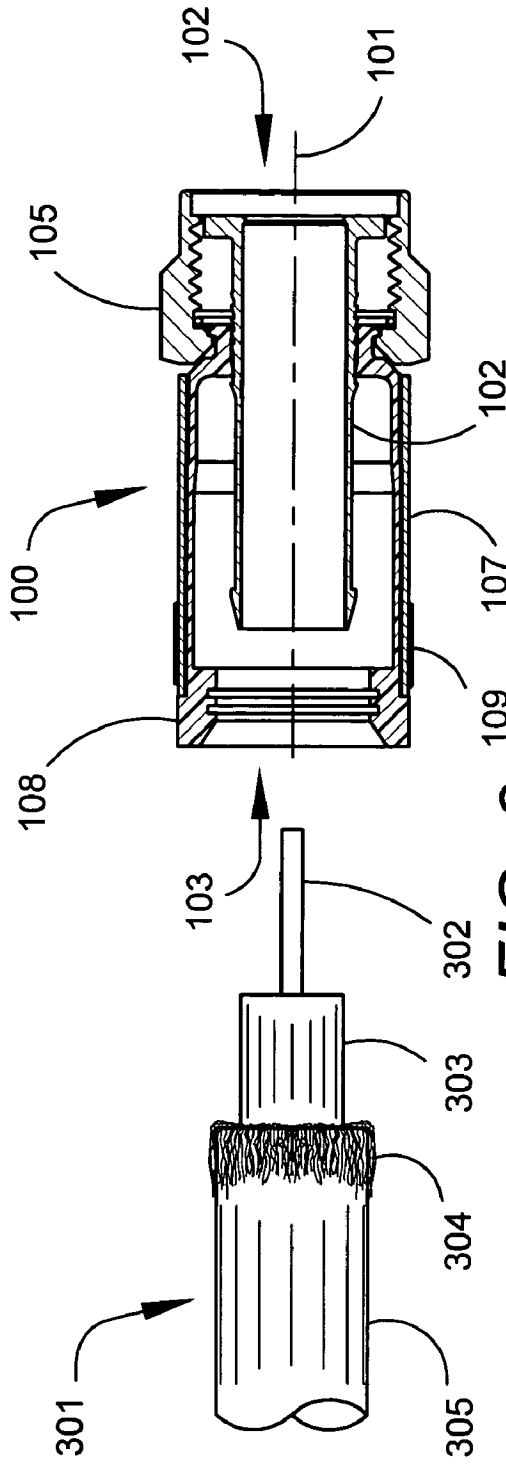

FIG. 3

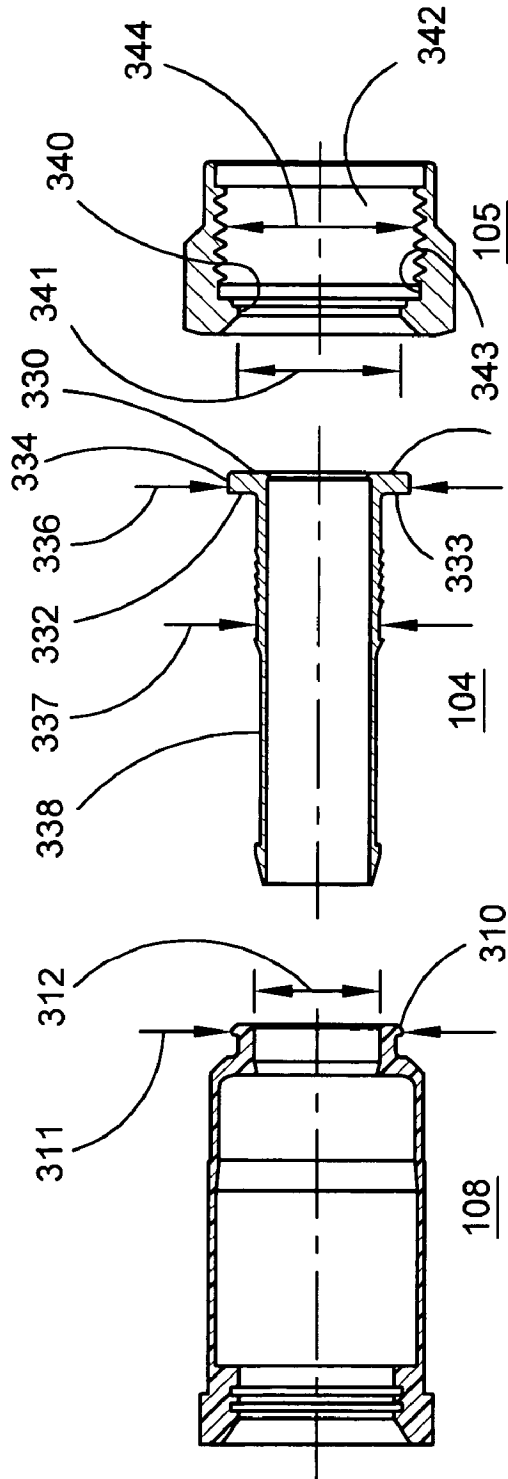

FIG. 3A

FIG. 3B

FIG. 3C

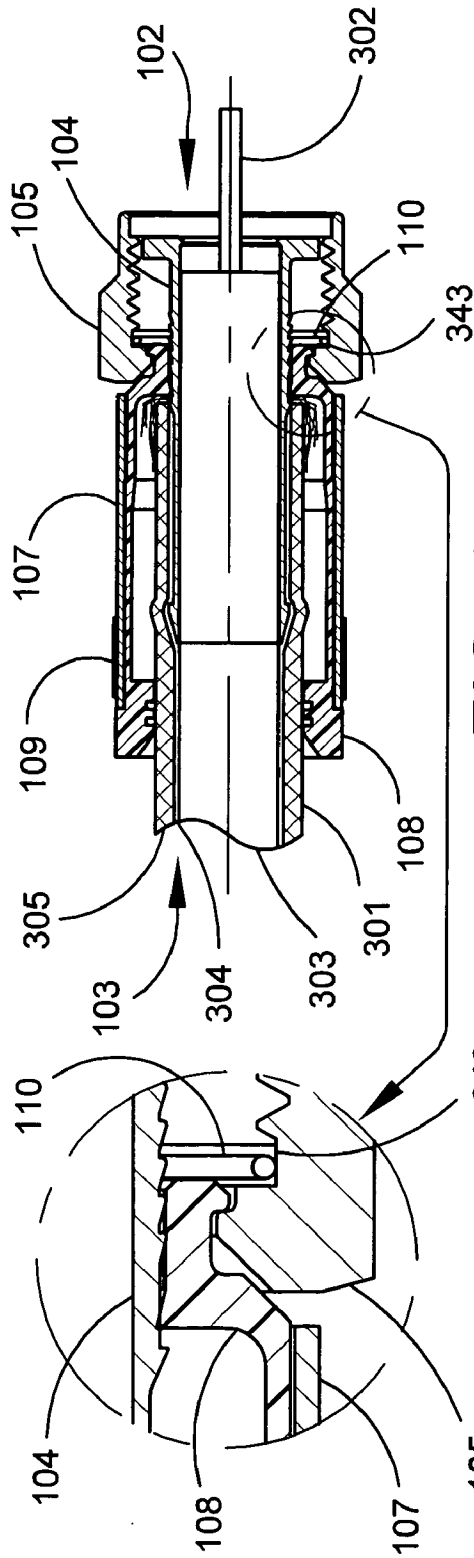

FIG. 4

FIG. 4A

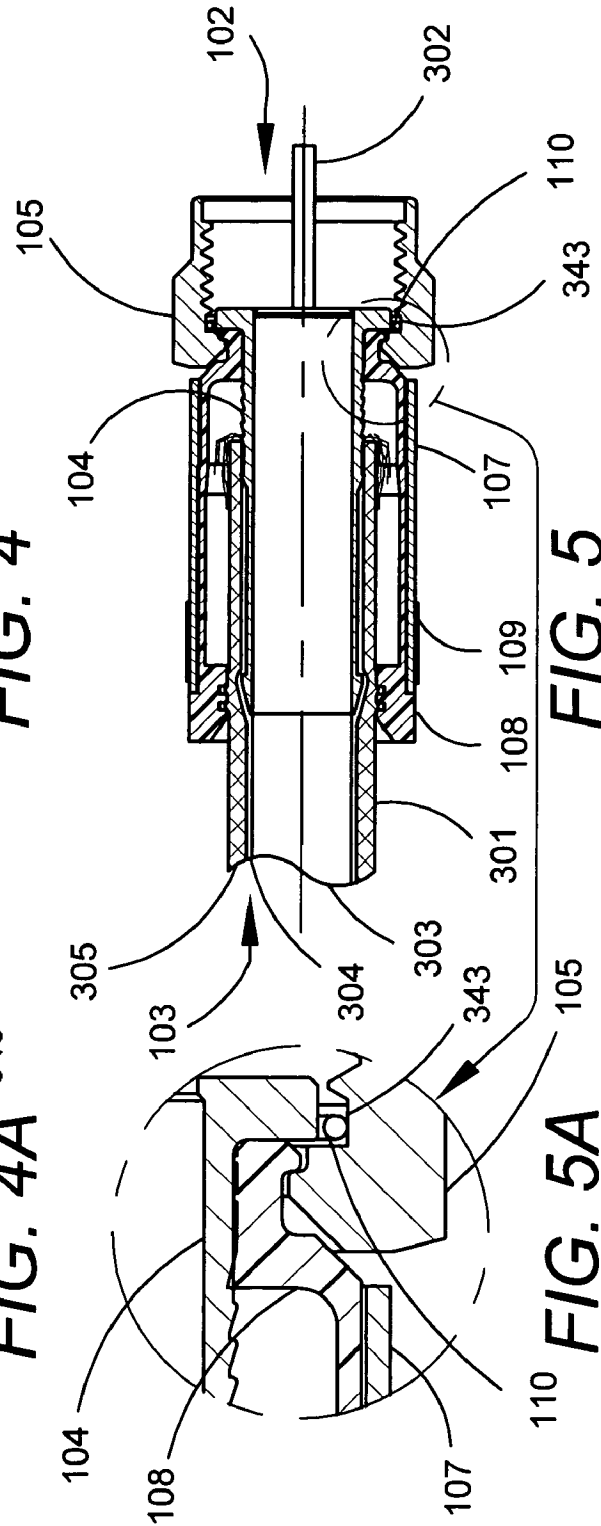

FIG. 5

FIG. 5A

# Explore Litigation Insights

Docket Alarm provides insights to develop a more informed litigation strategy and the peace of mind of knowing you're on top of things.

## Real-Time Litigation Alerts



Keep your litigation team up-to-date with **real-time alerts** and advanced team management tools built for the enterprise, all while greatly reducing PACER spend.

Our comprehensive service means we can handle Federal, State, and Administrative courts across the country.

## Advanced Docket Research



With over 230 million records, Docket Alarm's cloud-native docket research platform finds what other services can't. Coverage includes Federal, State, plus PTAB, TTAB, ITC and NLRB decisions, all in one place.

Identify arguments that have been successful in the past with full text, pinpoint searching. Link to case law cited within any court document via Fastcase.

## Analytics At Your Fingertips



Learn what happened the last time a particular judge, opposing counsel or company faced cases similar to yours.

Advanced out-of-the-box PTAB and TTAB analytics are always at your fingertips.

## API

Docket Alarm offers a powerful API (application programming interface) to developers that want to integrate case filings into their apps.

## LAW FIRMS

Build custom dashboards for your attorneys and clients with live data direct from the court.

Automate many repetitive legal tasks like conflict checks, document management, and marketing.

## FINANCIAL INSTITUTIONS

Litigation and bankruptcy checks for companies and debtors.

## E-DISCOVERY AND LEGAL VENDORS

Sync your system to PACER to automate legal marketing.