



(12) **United States Patent**
Bence et al.

(10) **Patent No.:** **US 7,114,990 B2**
(45) **Date of Patent:** **Oct. 3, 2006**

(54) **COAXIAL CABLE CONNECTOR WITH GROUNDING MEMBER**

(75) Inventors: **Bruce D. Bence**, Glendale, AZ (US);
Donald A. Burris, Peoria, AZ (US);
Brian L. Kisling, Phoenix, AZ (US);
John A. Kooiman, Mesa, AZ (US);
William B. Lutz, Glendale, AZ (US);
William F. McDade, Glendale, AZ (US);
Thomas D. Miller, Peoria, AZ (US);
Lee Yung Chuan, Sanchong (TW)

(73) Assignee: **Corning Gilbert Incorporated**,
Glendale, AZ (US)

(*) Notice: Subject to any disclaimer, the term of this patent is extended or adjusted under 35 U.S.C. 154(b) by 0 days.

(21) Appl. No.: **11/043,844**

(22) Filed: **Jan. 25, 2005**
(Under 37 CFR 1.47)

(65) **Prior Publication Data**
US 2006/0166552 A1 Jul. 27, 2006

(51) **Int. Cl.**
H01R 9/05 (2006.01)

(52) **U.S. Cl.** **439/583; 439/322**

(58) **Field of Classification Search** **439/578, 439/583, 584, 320, 322, 314**
See application file for complete search history.

(56) **References Cited**

U.S. PATENT DOCUMENTS

3,665,371 A	5/1972	Cripps	339/90 C
3,669,472 A *	6/1972	Nadsady	285/87
3,678,445 A	7/1972	Brancaleone	339/143 R
3,686,623 A	8/1972	Nijman	339/177 E
3,778,535 A *	12/1973	Forney, Jr.	174/88 C
3,793,610 A	2/1974	Brishka	339/74 R
3,835,443 A *	9/1974	Arnold et al.	439/319

4,106,839 A	8/1978	Cooper	339/143 R
4,153,320 A	5/1979	Townshend	339/91 B
4,389,081 A *	6/1983	Gallusser et al.	439/320
4,506,943 A *	3/1985	Drogo	439/314
4,525,017 A *	6/1985	Schildkraut et al.	439/320
4,531,805 A *	7/1985	Werth	439/607
4,545,637 A	10/1985	Bosshard et al.	339/177
4,580,865 A	4/1986	Fryberger	339/103 M
4,634,213 A	1/1987	Larsson et al.	339/275 T
4,902,246 A	2/1990	Samchisen	439/578
4,938,718 A *	7/1990	Guendel	439/680
5,030,126 A *	7/1991	Hanlon	439/320
5,137,471 A *	8/1992	Verespej et al.	439/585
5,380,211 A	1/1995	Kawagauchi et al.	439/74
5,413,504 A	5/1995	Kloecker et al.	439/620
5,683,263 A	11/1997	Hsu	439/319
5,938,465 A	8/1999	Fox, Sr.	439/350
5,957,716 A	9/1999	Buckley et al.	439/321
5,975,951 A *	11/1999	Burris et al.	439/585
6,019,635 A	2/2000	Nelson	439/583

(Continued)

Primary Examiner—Tulsidas C. Patel
Assistant Examiner—Vladimir Imas
(74) *Attorney, Agent, or Firm*—Joseph M. Homa; Marvin A. Glazer

(57) **ABSTRACT**

A coaxial cable connector includes tubular post, a coupler secured over an end of the tubular post for securing the connector to an appliance, and an outer body secured to the tubular post. An electrical grounding path is maintained between the coupler and the tubular post whether or not the coupler is tightly fastened to the appliance. The electrical grounding path is provided by a resilient, electrically-conductive grounding member disposed between the tubular post and the coupler. Alternatively, the connector includes conductive grease at a point where mating portions of the tubular post and coupler have closely matching dimensions.

34 Claims, 8 Drawing Sheets

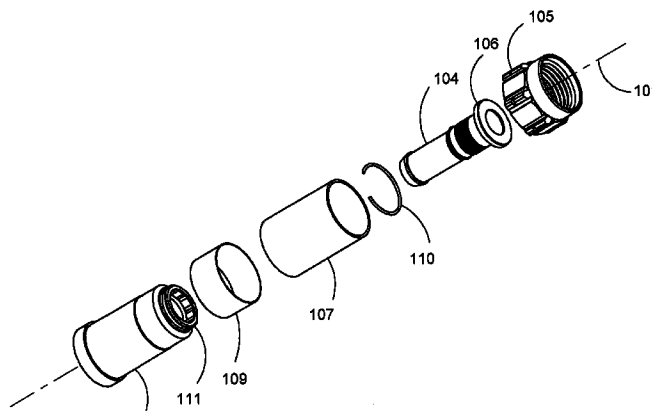

US 7,114,990 B2

Page 2

U.S. PATENT DOCUMENTS

6,332,815 B1 *	12/2001	Bruce	439/862	6,683,253 B1	1/2004	Lee	174/75
6,558,194 B1 *	5/2003	Montena	439/585	6,712,631 B1	3/2004	Youtsey	439/322
6,572,419 B1	6/2003	Feye-Homann	439/839	6,716,062 B1	4/2004	Palinkas et al.	439/578

* cited by examiner

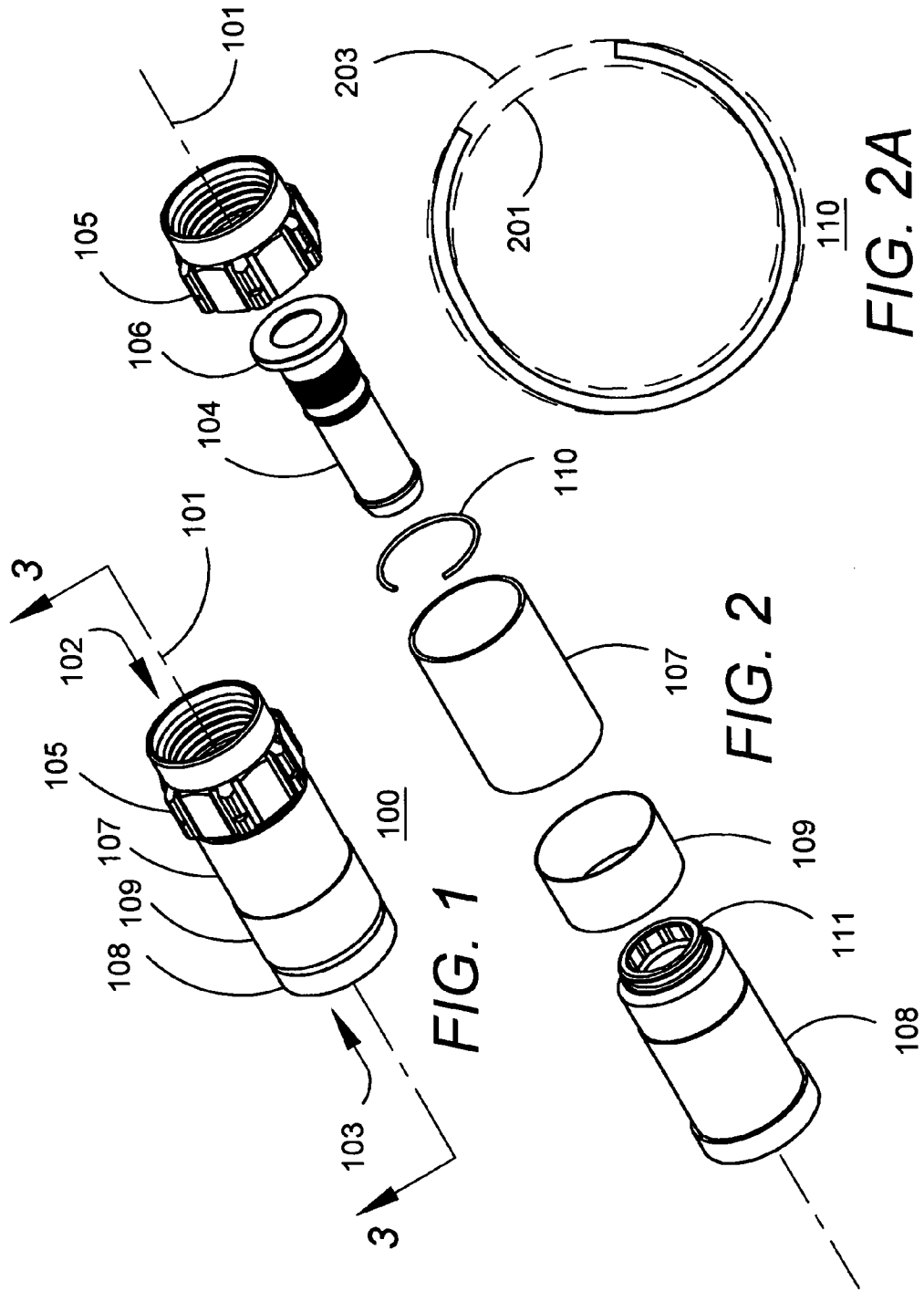

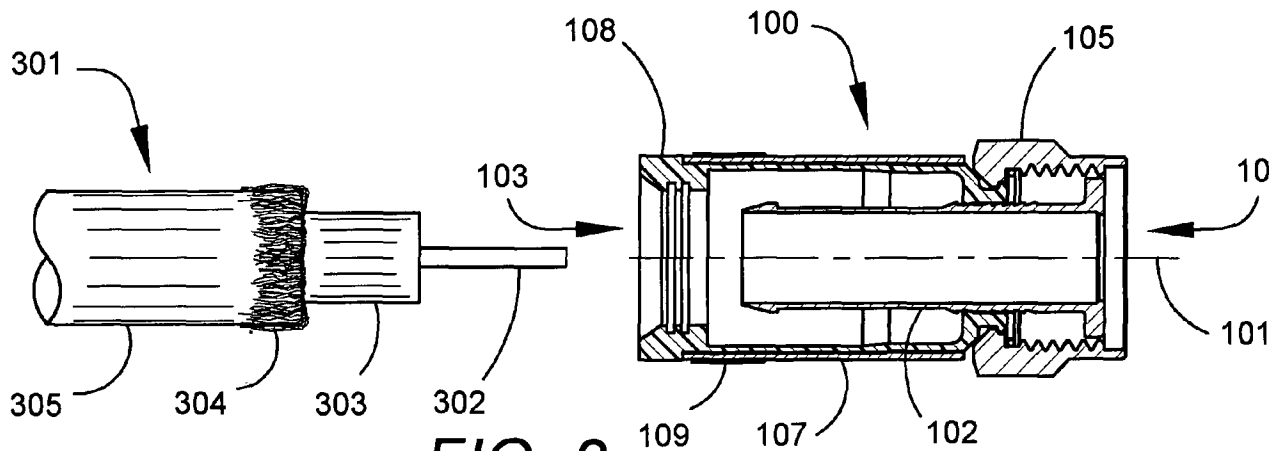

FIG. 3

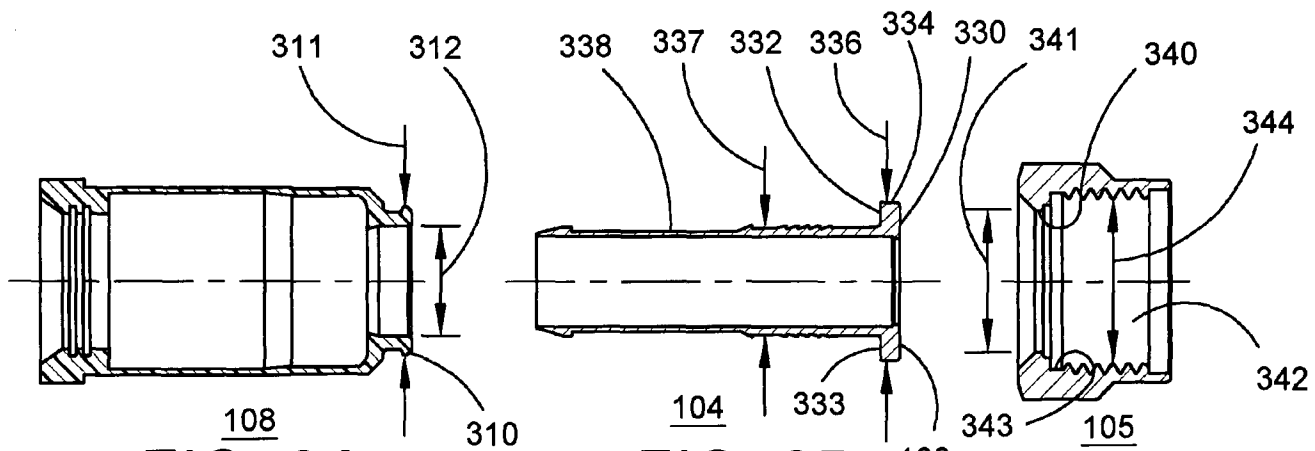
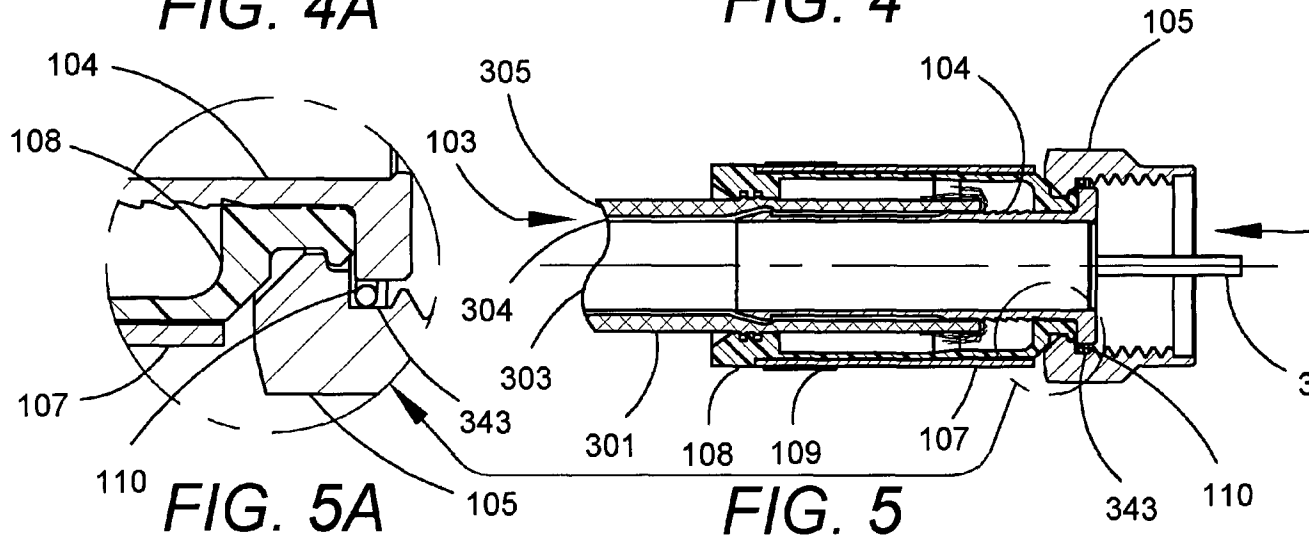
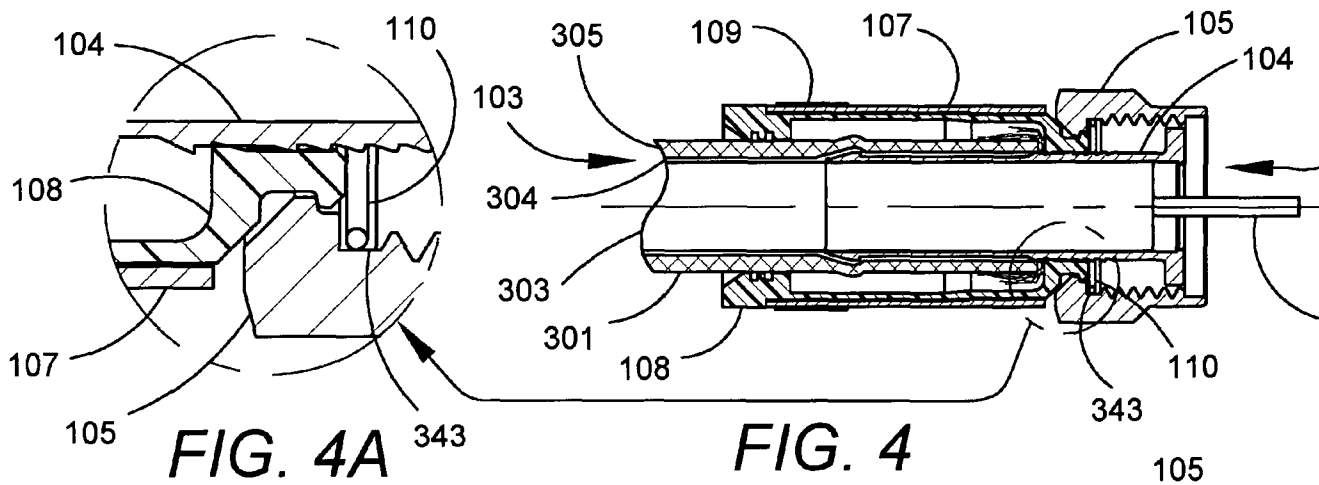

FIG. 3A

FIG. 3B

FIG. 3C



Explore Litigation Insights

Docket Alarm provides insights to develop a more informed litigation strategy and the peace of mind of knowing you're on top of things.

Real-Time Litigation Alerts



Keep your litigation team up-to-date with **real-time alerts** and advanced team management tools built for the enterprise, all while greatly reducing PACER spend.

Our comprehensive service means we can handle Federal, State, and Administrative courts across the country.

Advanced Docket Research



With over 230 million records, Docket Alarm's cloud-native docket research platform finds what other services can't. Coverage includes Federal, State, plus PTAB, TTAB, ITC and NLRB decisions, all in one place.

Identify arguments that have been successful in the past with full text, pinpoint searching. Link to case law cited within any court document via Fastcase.

Analytics At Your Fingertips



Learn what happened the last time a particular judge, opposing counsel or company faced cases similar to yours.

Advanced out-of-the-box PTAB and TTAB analytics are always at your fingertips.

API

Docket Alarm offers a powerful API (application programming interface) to developers that want to integrate case filings into their apps.

LAW FIRMS

Build custom dashboards for your attorneys and clients with live data direct from the court.

Automate many repetitive legal tasks like conflict checks, document management, and marketing.

FINANCIAL INSTITUTIONS

Litigation and bankruptcy checks for companies and debtors.

E-DISCOVERY AND LEGAL VENDORS

Sync your system to PACER to automate legal marketing.