



US006088532A

United States Patent [19]
Yamamoto et al.

[11] Patent Number: 6,088,532
[45] Date of Patent: *Jul. 11, 2000

- [54] **IMAGE SIGNAL READING OPERATION CONTROL DEVICE**
- [75] Inventors: **Yasuhiro Yamamoto; Tahei Morisawa,**
both of Tokyo, Japan
- [73] Assignee: **Asahi Kogaku Kogyo Kabushiki Kaisha,** Tokyo, Japan
- [*] Notice: This patent issued on a continued prosecution application filed under 37 CFR 1.53(d), and is subject to the twenty year patent term provisions of 35 U.S.C. 154(a)(2).

| | | | |
|-----------|---------|-------------------------|---------|
| 5,521,748 | 5/1996 | Sarraf | 359/521 |
| 5,539,532 | 7/1996 | Watanabe | 358/443 |
| 5,631,700 | 5/1997 | Aoki | 348/222 |
| 5,646,746 | 7/1997 | Tazawa et al. | 358/471 |
| 5,652,618 | 7/1997 | Nanba | 348/96 |
| 5,684,601 | 11/1997 | Endo | 358/298 |
| 5,691,824 | 11/1997 | Haded et al. | 358/487 |
| 5,708,472 | 1/1998 | Morisawa et al. | 348/373 |
| 5,724,160 | 3/1998 | Brandestini et al. | 358/475 |
| 5,739,849 | 4/1998 | Aoki et al. | 348/207 |
| 5,760,924 | 6/1998 | Takahara et al. | 358/474 |
| 5,805,945 | 9/1998 | Aoki | 396/429 |
| 5,808,675 | 9/1998 | Yamamoto | 348/294 |
| 5,842,050 | 11/1998 | Aoki | 396/30 |
| 5,857,125 | 1/1999 | Morisawa | 396/429 |
| 5,905,526 | 5/1999 | Sato | 348/96 |

[21] Appl. No.: **08/580,684**

[22] Filed: **Dec. 29, 1995**

[30] **Foreign Application Priority Data**

| | | | |
|--------------|------|-------------|----------|
| Jan. 6, 1995 | [JP] | Japan | 7-016551 |
| Jan. 6, 1995 | [JP] | Japan | 7-016552 |
| Jan. 6, 1995 | [JP] | Japan | 7-016553 |
| Jan. 6, 1995 | [JP] | Japan | 7-016554 |
| Jan. 6, 1995 | [JP] | Japan | 7-016555 |
| Jan. 6, 1995 | [JP] | Japan | 7-016556 |

[51] **Int. Cl.**⁷ **G03B 17/50; G03B 17/48; G03B 19/00**

[52] **U.S. Cl.** **396/30; 396/429**

[58] **Field of Search** **396/30, 429, 430; 348/202, 297, 96-100, 102-103, 110; 358/506, 487, 497, 486, 474, 509, 510, 475, 480**

[56] **References Cited**

U.S. PATENT DOCUMENTS

| | | | |
|-----------|--------|------------------------|----------|
| 4,689,691 | 8/1987 | Isogai et al. | 358/280 |
| 4,804,975 | 2/1989 | Yip | 346/76 L |
| 4,893,196 | 1/1990 | Koshiyouji et al. | 358/474 |
| 4,945,423 | 7/1990 | Takanashi et al. | 358/300 |
| 5,283,668 | 2/1994 | Hiramatsu | 358/474 |
| 5,424,156 | 6/1995 | Aoki et al. . | |
| 5,516,607 | 5/1996 | Iijima et al. | 430/20 |

FOREIGN PATENT DOCUMENTS

| | | |
|---------|---------|----------------------|
| 0327236 | 8/1989 | European Pat. Off. . |
| 2-29081 | 1/1990 | Japan . |
| 5-2280 | 1/1993 | Japan . |
| 5-24706 | 4/1993 | Japan . |
| 5150251 | 6/1993 | Japan . |
| 6313894 | 11/1994 | Japan . |

Primary Examiner—Safet Metjahic
Assistant Examiner—Christopher Mahoney
Attorney, Agent, or Firm—Greenblum & Bernstein, P.L.C.

[57] **ABSTRACT**

An image signal reading operation control device has an electro-developing recording medium to electronically develop an image formed by a photographing optical system. The image is read out by a line sensor with the electro-developing recording medium being illuminated by a light source. Namely, pixel signals arranged along a horizontal scanning line are read by the line sensor while the line sensor is set at a predetermined position, and then the line sensor is moved in a direction perpendicular to the horizontal scanning line by a predetermined amount. When the image is read out by the line sensor, the light source is displaced along the longitudinal direction of the line sensor.

26 Claims, 26 Drawing Sheets

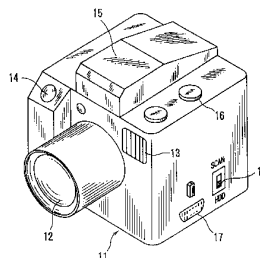
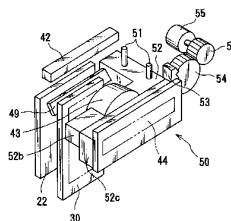

Fig. 1

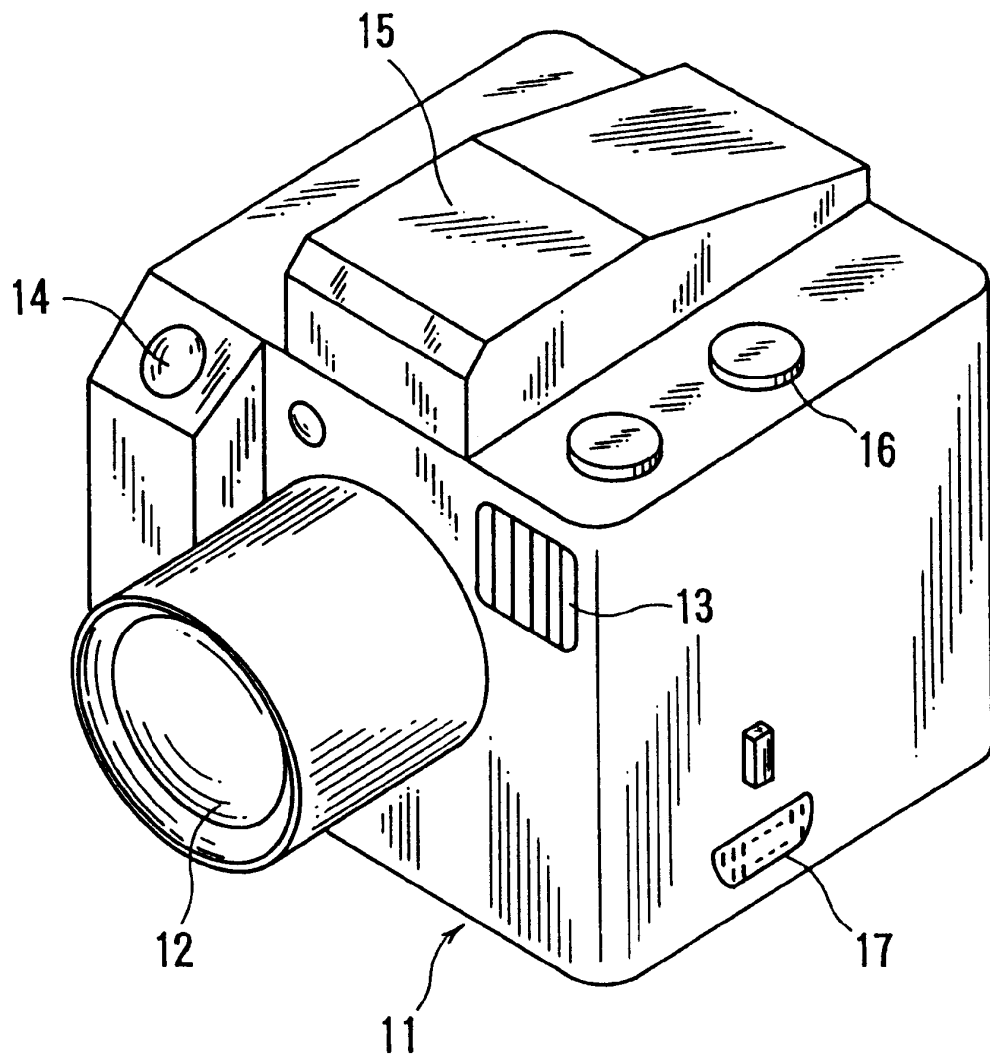

Fig. 2

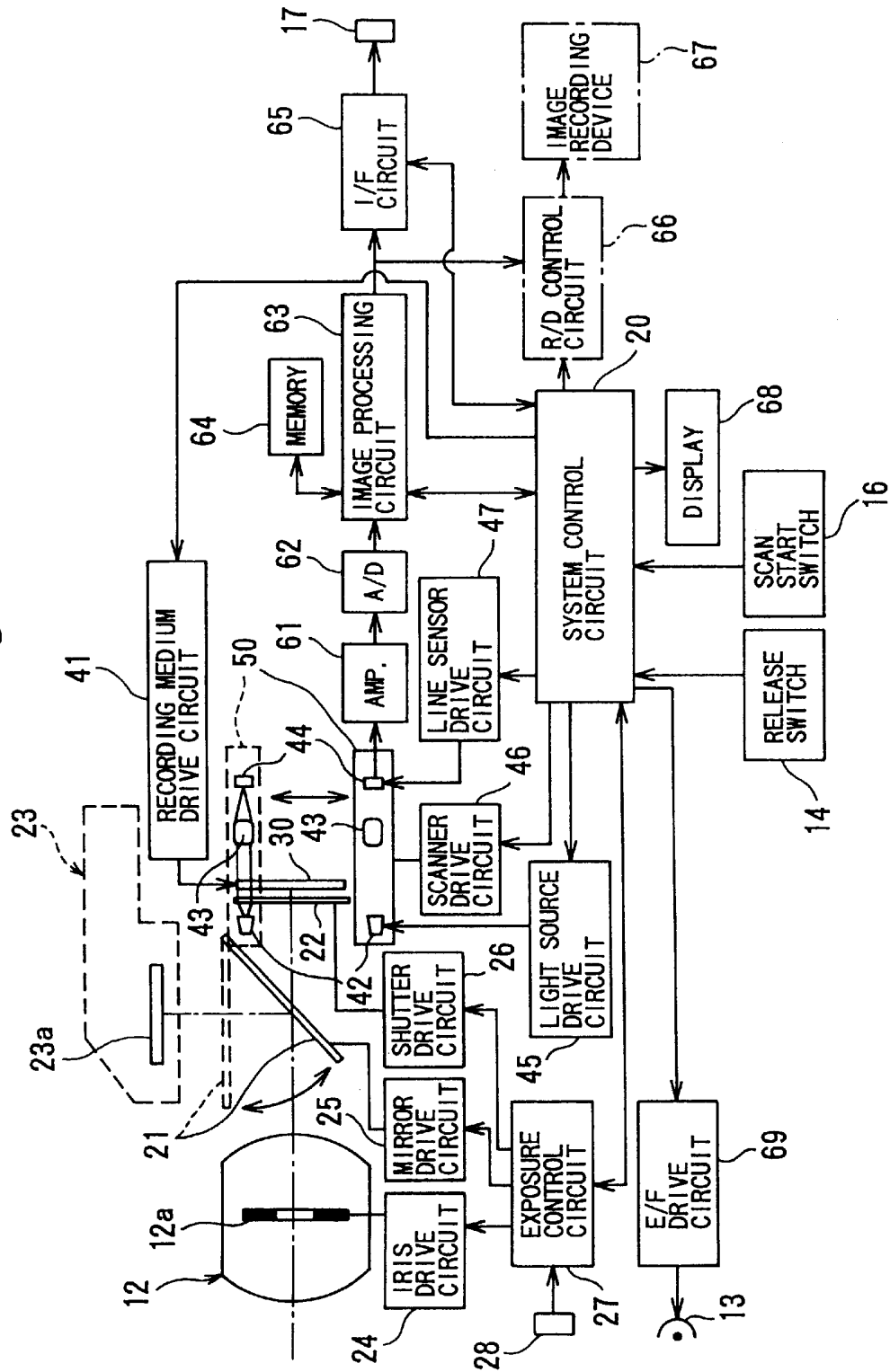

Fig. 3

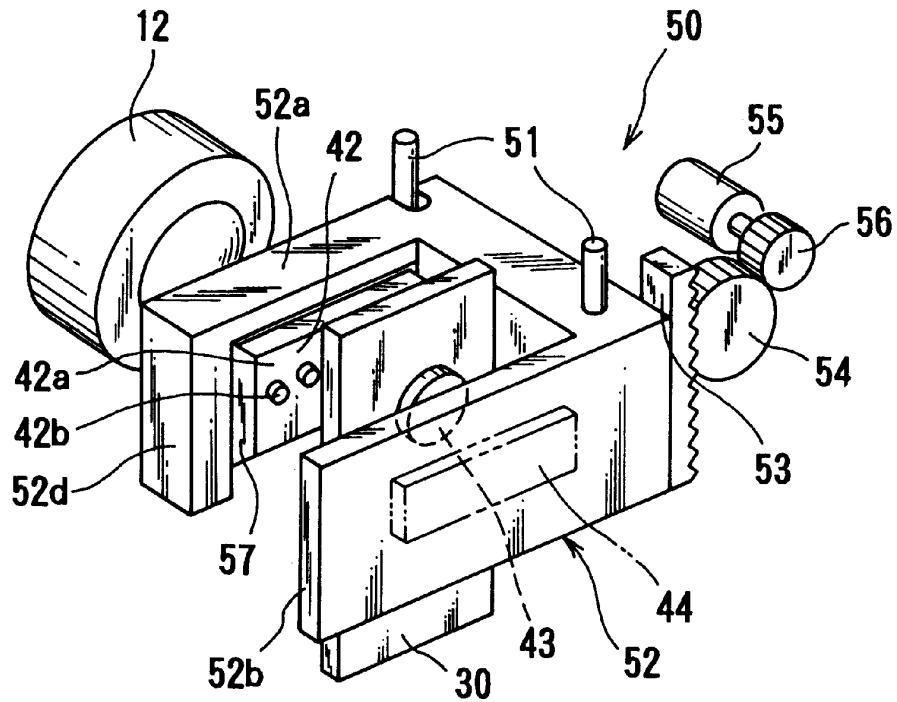

Fig. 5

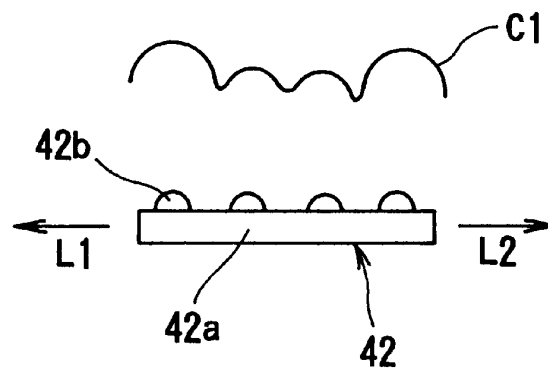
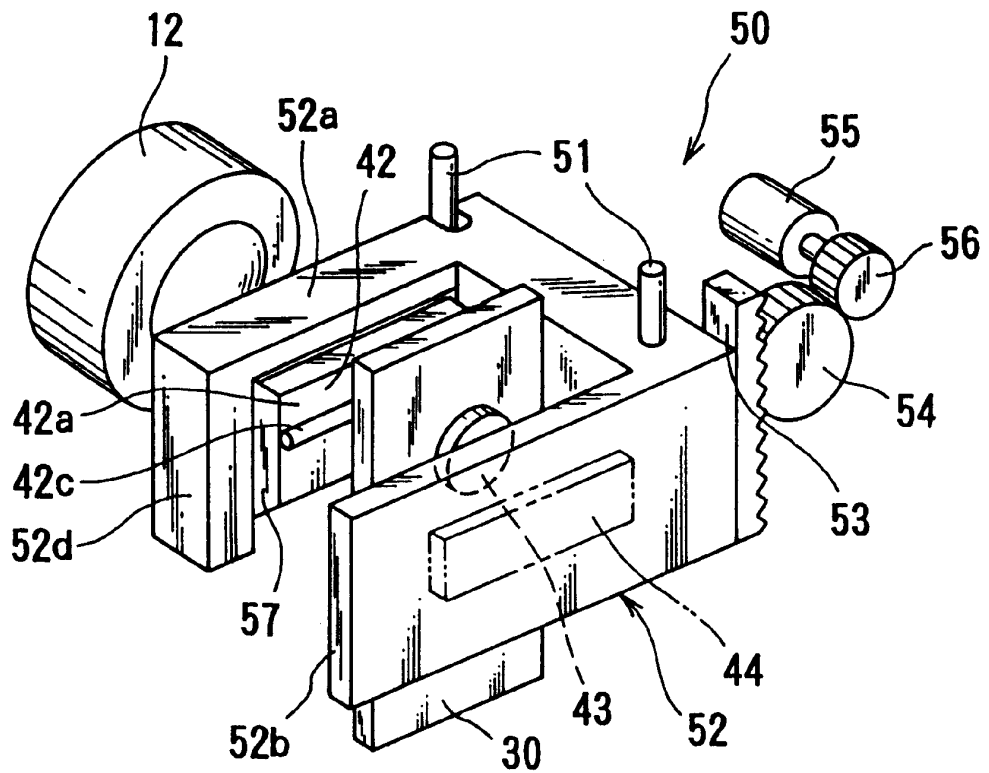

Fig. 4



Explore Litigation Insights

Docket Alarm provides insights to develop a more informed litigation strategy and the peace of mind of knowing you're on top of things.

Real-Time Litigation Alerts



Keep your litigation team up-to-date with **real-time alerts** and advanced team management tools built for the enterprise, all while greatly reducing PACER spend.

Our comprehensive service means we can handle Federal, State, and Administrative courts across the country.

Advanced Docket Research



With over 230 million records, Docket Alarm's cloud-native docket research platform finds what other services can't. Coverage includes Federal, State, plus PTAB, TTAB, ITC and NLRB decisions, all in one place.

Identify arguments that have been successful in the past with full text, pinpoint searching. Link to case law cited within any court document via Fastcase.

Analytics At Your Fingertips



Learn what happened the last time a particular judge, opposing counsel or company faced cases similar to yours.

Advanced out-of-the-box PTAB and TTAB analytics are always at your fingertips.

API

Docket Alarm offers a powerful API (application programming interface) to developers that want to integrate case filings into their apps.

LAW FIRMS

Build custom dashboards for your attorneys and clients with live data direct from the court.

Automate many repetitive legal tasks like conflict checks, document management, and marketing.

FINANCIAL INSTITUTIONS

Litigation and bankruptcy checks for companies and debtors.

E-DISCOVERY AND LEGAL VENDORS

Sync your system to PACER to automate legal marketing.