



## **Hardware Guide**

### **Compaq Tablet PC TC1000 Series**

Document Part Number: 280133-001

**November 2002**

This guide explains how to identify, use, modify, and maintain the hardware features on the tablet PC and an optional tablet PC keyboard. It also includes power and environmental specifications, which may be helpful when traveling with the tablet PC.

© 2002 Compaq Information Technologies Group, L.P.

Compaq and the Compaq logo are trademarks of Compaq Information Technologies Group, L.P. in the U.S. and/or other countries. Microsoft and Windows are trademarks of Microsoft Corporation in the U.S. and/or other countries. All other product names mentioned herein may be trademarks of their respective companies.

Compaq shall not be liable for technical or editorial errors or omissions contained herein. The information is provided "as is" without warranty of any kind and is subject to change without notice. The warranties for Compaq products are set forth in the express limited warranty statements accompanying such products. Nothing herein should be construed as constituting an additional warranty.

Hardware Guide

First Edition November 2002

Document Part Number: 280133-001

---

# Contents

## 1 External Components

Pen Components . . . . .	1-1
Tablet PC Components . . . . .	1-2
Front: Lights . . . . .	1-2
Front: Pen-Activated Buttons . . . . .	1-3
Right Side: Power Switch and Power/Standby Light . . . . .	1-4
Right Side: Email Launch and Windows Security Buttons . . . . .	1-5
Right Side: Esc, Tab and Q Menu Buttons . . . . .	1-6
Right Side: Jog Dial and Antenna . . . . .	1-7
Lower Side . . . . .	1-8
Left Side: Attachment Slots and Keyboard Connector . . . . .	1-9
Left Side: Security Cable Slot, Vent and Antenna . . . . .	1-10
Top: Connectors and Jacks . . . . .	1-11
Top: Pen Holder and LAN Connection Lights . . . . .	1-12
Top: Card Slots, Buttons and Tether Eyelet . . . . .	1-13
Back: Attachment Features and Hard Drive Bay . . . . .	1-14
Back: Battery Bay . . . . .	1-15
Back: Memory and Mini PCI Compartment . . . . .	1-16
Back: Labels . . . . .	1-17
Back: Tilt Feet and Pad Feet . . . . .	1-18
Additional Tablet PC Standard Components . . . . .	1-19
Documentation and QuickRestore CDs . . . . .	1-19
Cord, Cables and Pen Battery . . . . .	1-20
Adapters and Accessories . . . . .	1-21

Tablet PC Keyboard Components . . . . . 1–22  
    Front: Lights and Pointing Device. . . . . 1–22  
    Front: Keys . . . . . 1–23  
    Front: Positioning and Security Features. . . . . 1–24  
    Top. . . . . 1–25  
    Back. . . . . 1–26  
    Additional Keyboard Standard Component . . . . . 1–27

**2 Pen, Command Controls and Keyboards**

Pen . . . . . 2–1  
    Entering Information with the Pen . . . . . 2–2  
    Maintaining and Protecting the Pen. . . . . 2–4  
    Setting Pen Preferences . . . . . 2–6  
Command Controls . . . . . 2–7  
    Identifying Command Controls. . . . . 2–7  
    Command Controls Quick Reference . . . . . 2–8  
    Using Command Controls . . . . . 2–9  
    Setting Command Control Preferences . . . . . 2–14  
On-Screen Keyboard . . . . . 2–17  
Tablet PC Keyboard. . . . . 2–18  
    Using the Pointing Device. . . . . 2–19  
    Using the Keypad . . . . . 2–20  
    Using F11/F12 . . . . . 2–23

**3 Battery Packs**

Running the Tablet PC on Battery Power . . . . . 3–1  
Replacing a Battery Pack . . . . . 3–2  
    Removing a Battery Pack . . . . . 3–2  
    Inserting a Battery Pack. . . . . 3–3  
Securing a Battery Pack. . . . . 3–5  
    Accessing the Battery Pack Security Screws . . . . . 3–5  
    Inserting a Battery Pack Security Screw . . . . . 3–6  
Charging a Battery Pack. . . . . 3–7  
    Charging a New Battery Pack . . . . . 3–8  
    Charging an In-Use Battery Pack . . . . . 3–8

Monitoring the Charge in a Battery Pack . . . . . 3–8  
 Obtaining Accurate Charge Information . . . . . 3–8  
 Displaying Charge Information on the Screen . . . . . 3–9  
 Displaying Charge Information on a  
 Battery Pack . . . . . 3–10  
 Managing Low-Battery Conditions . . . . . 3–11  
 Identifying Low-Battery Conditions . . . . . 3–11  
 Resolving Low-Battery Conditions . . . . . 3–12  
 Initiating and Resuming from Standby  
 or Hibernation . . . . . 3–13  
 Calibrating a Battery Pack . . . . . 3–14  
 When to Calibrate . . . . . 3–14  
 How to Calibrate . . . . . 3–14  
 Battery Conservation Procedures and Settings . . . . . 3–17  
 Conserving Power as You Work . . . . . 3–17  
 Selecting Power Conservation Settings . . . . . 3–17  
 Storing a Battery Pack . . . . . 3–18  
 Disposing of a Used Battery Pack . . . . . 3–19  
 Finding More Power Information . . . . . 3–19

**4 Drives**

Adding a Drive to the System . . . . . 4–1  
 Understanding Drive Terms . . . . . 4–2  
 Terms for Types of Drives . . . . . 4–2  
 Terms for Drive Media . . . . . 4–2  
 Caring for Drives . . . . . 4–3  
 Inserting or Removing Drive Media . . . . . 4–3  
 Inserting a CD or DVD . . . . . 4–4  
 Removing a CD or DVD (With Power) . . . . . 4–5  
 Removing a CD or DVD (Without Power) . . . . . 4–6  
 Inserting a Diskette . . . . . 4–7  
 Removing a Diskette . . . . . 4–7

- Using Drive Media . . . . . 4-8
  - Avoiding Standby and Hibernation . . . . . 4-8
  - Displaying Media Contents . . . . . 4-8
  - Caring for Drive Media . . . . . 4-9
- Finding More Drive Software Information . . . . . 4-10

**5 Audio**

- Adjusting Volume . . . . . 5-1
  - Using the Volume Control Icon . . . . . 5-1
  - Using the Q Menu . . . . . 5-2
- Using the Internal Speakers . . . . . 5-3
- Using the Internal Microphone . . . . . 5-4
- Connecting an Audio Device . . . . . 5-5
  - Identifying Audio Jacks . . . . . 5-5
  - Using the Audio-Out Jack . . . . . 5-6
  - Using the Headset Jack . . . . . 5-6
  - Using the Microphone Jack . . . . . 5-6
- Finding Audio and Video Software Information . . . . . 5-7

**6 Internal Modem**

- Connecting the Modem . . . . . 6-2
  - Selecting Connectors . . . . . 6-2
  - Connecting the Modem to an RJ-11 Jack . . . . . 6-3
  - Connecting the Modem with an Adapter . . . . . 6-4
- Setting Country Preferences . . . . . 6-5
  - Displaying the Current Country Configuration . . . . . 6-5
  - Adding a Country Configuration . . . . . 6-5
  - Solving Travel Connection Problems . . . . . 6-6
- Accessing Communication Software . . . . . 6-8
- Finding AT Command Information . . . . . 6-8

**7 Network Connections**

Connecting the Network Cable . . . . . 7-2  
 Turning a Network Connection Off and On . . . . . 7-3  
 Using the LAN Connection Lights . . . . . 7-3  
 Accessing the Network at Startup . . . . . 7-4  
     Enabling a NIC for Startup . . . . . 7-4  
     Responding to a Network Service Boot Prompt . . . . . 7-5  
 Finding Wireless LAN Information . . . . . 7-5

**8 External Device Connections**

Standard Device . . . . . 8-1  
 USB Device . . . . . 8-2  
 Tablet PC Keyboard . . . . . 8-3  
     Attaching the Tablet PC to the Keyboard . . . . . 8-3  
     Adjusting the Tablet PC and Keyboard . . . . . 8-5  
     Closing the Tablet PC and Keyboard . . . . . 8-6  
     Transporting the Tablet PC and Keyboard . . . . . 8-7  
     Detaching the Tablet PC from the Keyboard . . . . . 8-8  
 Cable Lock . . . . . 8-10

**9 Hardware Upgrades**

Obtaining Upgrades . . . . . 9-1  
 Using a PC Card . . . . . 9-1  
     Selecting a PC Card . . . . . 9-1  
     Configuring a PC Card . . . . . 9-2  
     Inserting a PC Card . . . . . 9-2  
     Stopping and Removing a PC Card . . . . . 9-3  
 Using a CompactFlash Card . . . . . 9-4  
     Selecting a CompactFlash Card . . . . . 9-4  
     Configuring a CompactFlash Card . . . . . 9-4  
     Inserting a CompactFlash Card . . . . . 9-5  
     Stopping and Removing a CompactFlash Card . . . . . 9-6

Increasing Memory . . . . . 9-7  
    Displaying Memory Information. . . . . 9-7  
    Removing or Inserting a Memory Module . . . . . 9-8  
Finding Mini PCI Information . . . . . 9-12

**10 Maintenance, Shipping and Travel**

Maintaining Software. . . . . 10-1  
Protecting Hardware. . . . . 10-2  
    Using Portfolios. . . . . 10-2  
    Attaching a Portfolio . . . . . 10-3  
    Detaching a Portfolio. . . . . 10-4  
Cleaning Hardware. . . . . 10-5  
    Cleaning the Screen. . . . . 10-5  
    Cleaning a Tablet PC Keyboard . . . . . 10-6  
Replacing Hardware. . . . . 10-7  
    Replacing a Pen Battery . . . . . 10-7  
    Replacing the System Hard Drive. . . . . 10-8  
    Replacing a Pointing Stick Cap. . . . . 10-12  
Preparing the Tablet PC for Shipping or Travel . . . . . 10-13  
Traveling with the Tablet PC . . . . . 10-13  
    Checklist for Travelers . . . . . 10-13  
    Contacting Compaq. . . . . 10-15

**11 Specifications**

Tablet PC and Tablet PC Keyboard Dimensions. . . . . 11-1  
Tablet PC Operating Environment. . . . . 11-1  
Tablet PC Rated Input Power. . . . . 11-2  
Modem Specifications . . . . . 11-2  
Finding More Environmental Information. . . . . 11-3

**Index**



---

## External Components

### Pen Components

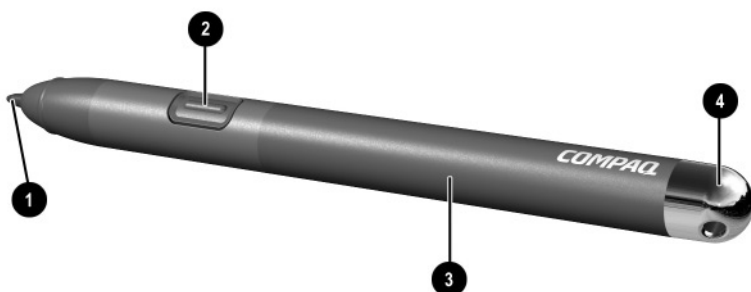

---

#### Pen Components

---

① Pen tip	Interacts with the tablet PC whenever the tip is touching the screen or within 0.5 inch (1.27 cm) of the screen. When tapped on or held over a pen-activated button, activates the button.
② Pen button	Functions like the right button on an external mouse.
③ Pen barrel	Holds a standard AAAA battery.
④ Pen tether eyelet	Used with the tether eyelet on the tablet PC, enables you to tether the pen to the tablet PC.

---

## Tablet PC Components

### Front: Lights

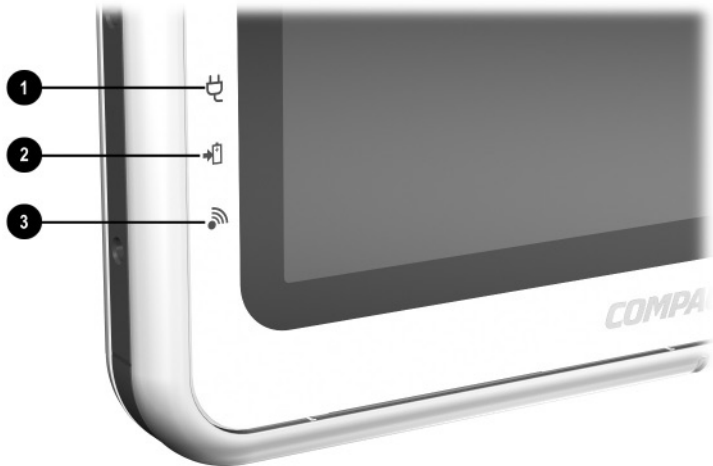

---

#### Tablet PC Front Components: Lights

---

❶ AC adapter light	On: AC power is being supplied through the AC adapter.
❷ Battery light	On: A battery pack is charging. Flashing: A battery pack that is the only available power source has reached a low-battery condition.
❸ Wireless LAN activity light	Off: The internal wireless LAN is off or not installed. On: The internal wireless LAN is on and connected to a network. Flashing: The internal wireless LAN is on, but is not connected to a network or properly configured.

---

## Front: Pen-Activated Buttons

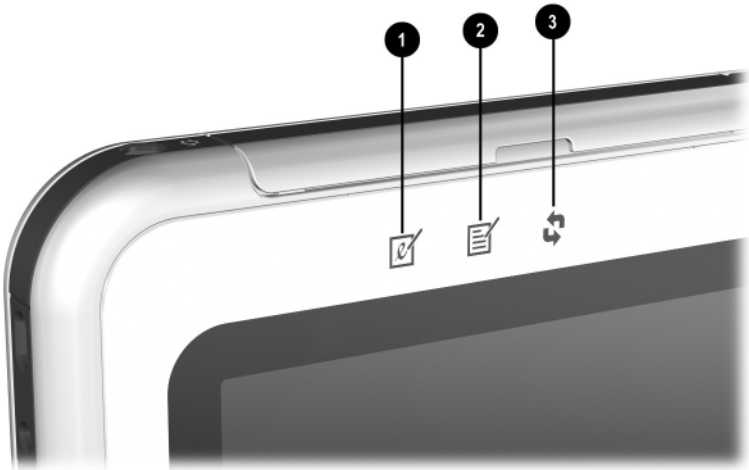

### Tablet PC Front Components: Pen-Activated Buttons

- |   |  |
|---|--|
| <p>❶ Tablet PC Input Panel launch button*</p> | <p>When the tablet PC is in Windows, opens the Microsoft Tablet PC Input Panel application, which includes a handwriting pad and an on-screen keyboard. While using the on-screen keyboard:</p> <ul style="list-style-type: none"> <li>■ To enter the ctrl+alt+delete command, press the Windows Security button on the tablet PC with the pen tip or a small object like the end of a paper clip.</li> <li>■ To switch the top row of keys between number keys and function keys, tap <b>Func</b> on the on-screen keyboard.</li> </ul> |
| <p>❷ Journal launch button*</p>               | <p>When the tablet PC is in Windows, opens and closes the Microsoft Journal application, which supports handwriting.</p>   |
| <p>❸ Rotate button*</p>                       | <p>Switches the image between landscape and portrait orientation.</p>  |

\*This table describes default settings. For information about changing the functions of the Tablet PC Input Panel launch, Journal launch, and rotate buttons, see the “Pen, Command Controls and Keyboards” chapter.

## Right Side: Power Switch and Power/Standby Light



---

### Tablet PC Right Side Components: Power Switch and Power/Standby Light

---

❶ Power switch\*

When the tablet PC is:

- Off, turns on the tablet PC.
- On, initiates Standby.\*
- In Standby, resumes tablet PC from Standby.
- In Hibernation, resumes tablet PC from Hibernation.\*

If the system has stopped responding and Windows shut down procedures cannot be used, slide and hold for 4 seconds to turn off the tablet PC.

---

❷ Power/standby light

On: Tablet PC is on.

Flashing: Tablet PC is in Standby.

Off: Tablet PC is off or in Hibernation.

---

\*This table describes default settings. For information about changing the functions of the power switch and about using Standby and Hibernation, refer on this CD to the *Software Guide*, "Power" chapter.

---

## Right Side: Email Launch and Windows Security Buttons



### Tablet PC Right Side Components: Email Launch and Windows Security Buttons

- |                            |  |
|----------------------------|--|
| ❶ Windows Security button* | <p>When pressed with the pen tip or a small object like the end of a paper clip while:</p> <ul style="list-style-type: none"> <li>■ Windows is open, enters the ctrl+alt+delete command.<sup>†</sup></li> <li>■ The Setup utility is open, enters the reset command.</li> </ul>                          |
| ❷ Email launch button      | <p>When the tablet PC is in Windows:</p> <ul style="list-style-type: none"> <li>■ Until your Internet or network service is set up, opens the operating system Internet connection wizard.</li> <li>■ After your Internet or network service is set up, opens your default email application.</li> </ul> |

\*This table describes default settings. For information about changing the functions of the Windows Security button, see the “Pen, Command Controls and Keyboards” chapter.

<sup>†</sup>To protect your work and the system, the ctrl+alt+delete command cannot be entered using the **Ctrl**, **Alt**, and **Del** keys on the on-screen keyboard.

## Right Side: Esc, Tab and Q Menu Buttons

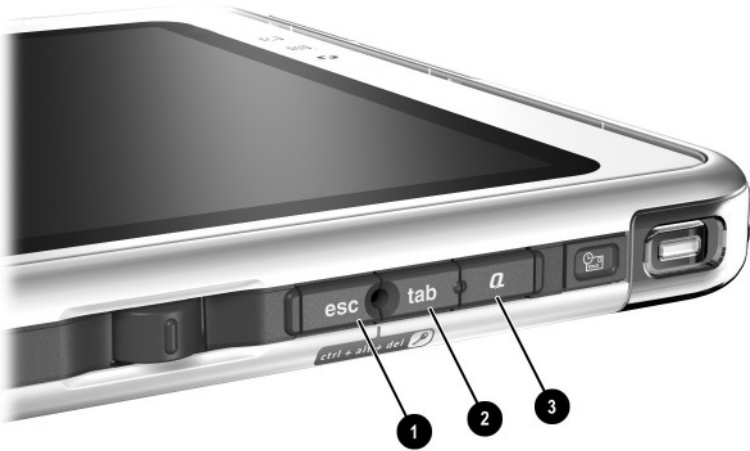

---

### Tablet PC Right Side Components: Esc, Tab, and Q Menu Buttons

---

❶ Esc button\*

While the tablet PC is:

- Starting up and a flashing pointer is displayed on the screen, opens the Setup utility.
- In Windows, functions like **esc** on a standard keyboard.

---

❷ Tab button\*

When the tablet PC is in Windows, functions like **tab** on a standard keyboard.<sup>†</sup>

---

❸ Q menu button\*

When the tablet PC is in Windows, opens or closes the Q Menu.

---

\*This table describes default settings. For information about changing the functions of the esc, tab, and Q menu buttons, see the “Pen, Command Controls and Keyboards” chapter.

<sup>†</sup>The tab button can also be used, instead of an F12 command, to respond to a Network Service Boot prompt during startup.

---

## Right Side: Jog Dial and Antenna

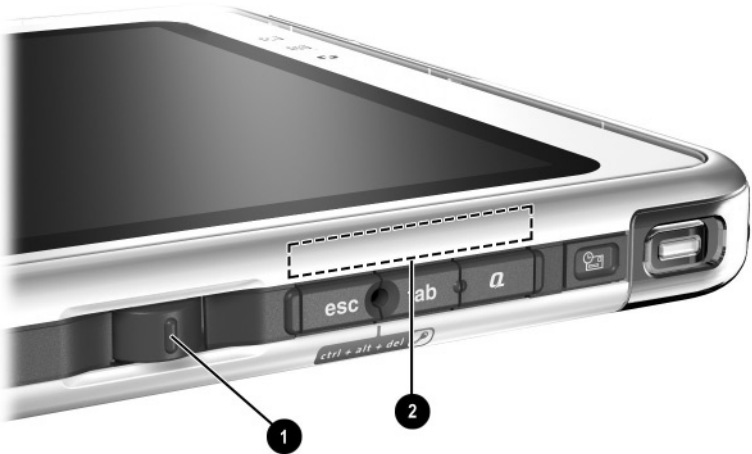

### Tablet PC Right Side Components: Jog Dial and Antenna

<p>❶ Jog dial*</p>	<p>Functions like <b>enter</b> and the up and down arrow keys on a standard keyboard.</p> <ul style="list-style-type: none"> <li>■ Press inward to enter a command.</li> <li>■ Rotate upward to scroll upward.</li> <li>■ Rotate downward to scroll downward.</li> </ul>
<p>❷ Antenna,<sup>†</sup> not visible from the outside of the tablet PC</p>	<p>Sends and receives internal wireless LAN signals.<sup>‡</sup></p>

\*This table describes default settings. For information about changing the rotation functions of the jog dial, see the “Pen, Command Controls and Keyboards” chapter.

<sup>†</sup>The tablet PC has 2 antennas. The other antenna is found on the left side of the tablet PC.

<sup>‡</sup>For optimal transmissions, keep the antennas free from obstructions and facing away from you while you are using an internal wireless LAN.

## Lower Side

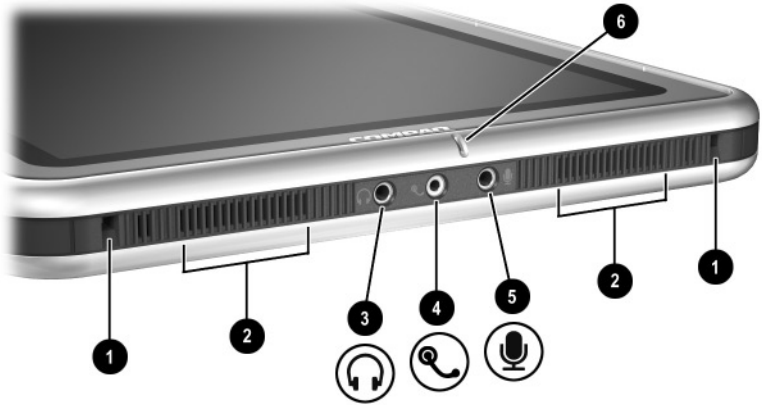

---

### Tablet PC Lower Side Components

---

❶	Docking alignment slots (2)	Secure the tablet PC to an optional Tablet PC Docking Station.
❷	Speakers (2)	Produce stereo sound.
❸	Audio-out jack	Connects optional stereo headphones or powered stereo speakers.
❹	Headset jack	Connects an optional headset, such as a mobile telephone headset with a microphone and a monaural ear piece.
❺	Microphone jack	Connects an optional monaural microphone.
❻	Microphone	Inputs monaural sound.*

---

\*If you are using voice recognition or other software that requires optimal sound quality, Compaq recommends that you use an optional external microphone or a headset.

---



## Left Side: Attachment Slots and Keyboard Connector

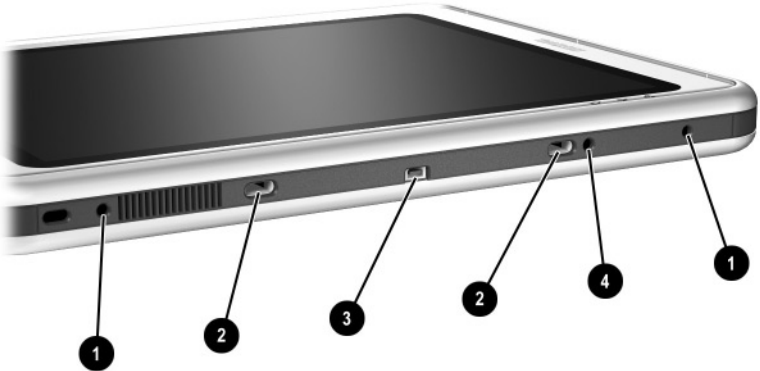

### Tablet PC Left Side Components: Attachment Slots and Keyboard Connector

<p>❶ Screen protector slots (2)</p>	<p>Secure the screen protector* when it is attached to the tablet PC.</p>
<p>❷ Universal attachment slots (2)</p>	<p>Secure the portfolio, a screen protector,* or an optional attachment, such as a tablet PC keyboard, to the tablet PC.</p>
<p>❸ Keyboard connector</p>	<p>Connects an optional tablet PC keyboard to the tablet PC.</p>
<p>❹ Alignment key slot</p>	<p>Accepts an alignment key to safeguard attachment procedures. For example, matching the alignment key on an optional tablet PC keyboard to the alignment key slot helps you correctly orient the tablet PC to the keyboard as you attach the tablet PC to the keyboard.</p>

\*A screen protector is included with an optional Tablet PC Docking Station.

## Left Side: Security Cable Slot, Vent and Antenna

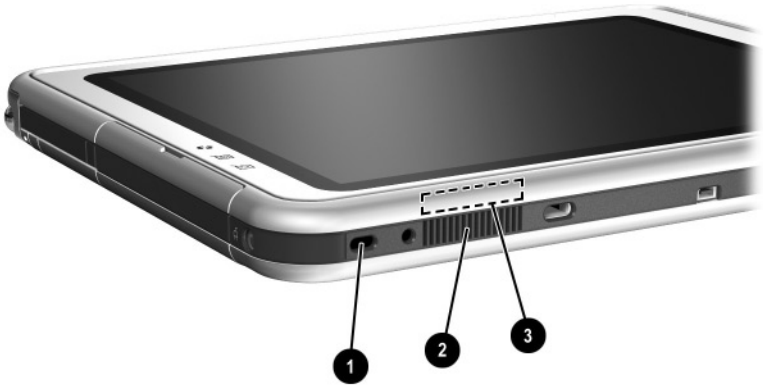

---

### Tablet PC Left Side Components: Security Cable Slot, Vent, and Antenna

---

- |   |   |  |
|---|---|--|
| ① | Security cable slot                                     | Attaches an optional security cable to the tablet PC.  |
| ② | Vent  | Allows airflow to cool internal components.<br><br>△ To prevent overheating, do not obstruct the vent. Do not allow a hard surface, such as an adjoining optional printer, or a fabric, such as bedding or clothing, to block airflow. |
| ③ | Antenna,* not visible from the outside of the tablet PC | Receives internal wireless LAN signals.†   |
- 

\*The tablet PC has 2 antennas. The other antenna is found on the right side of the tablet PC.

†For optimal transmissions, keep the antennas free from obstructions and facing away from you while you are using an internal wireless LAN.

---

## Top: Connectors and Jacks

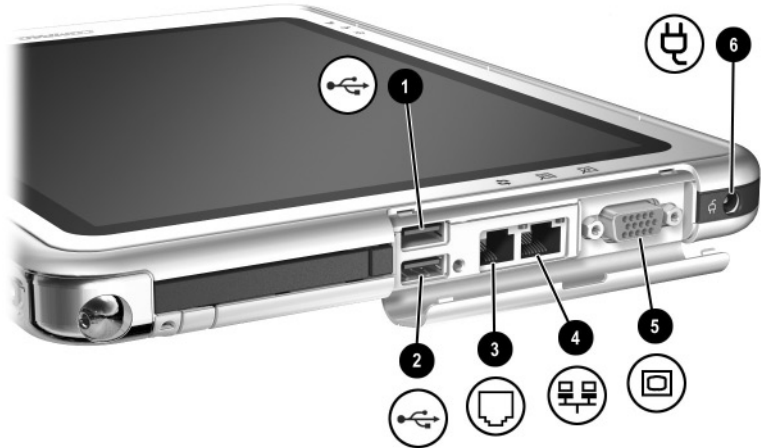

### Tablet PC Top Components: Connectors and Jacks

①	USB connector	Connects an optional USB 2.0- or 1.1-compliant device.*
②	External MultiBay connector	Connects an optional USB 2.0- or 1.1-compliant device.*
③	RJ-11 telephone jack	Connects a modem cable. (A modem cable is included with internal modem models.)
④	RJ-45 network jack	Connects an Ethernet network cable. (An Ethernet network cable is included with network models.)
⑤	External monitor connector	Connects an optional VGA external monitor or projector.
⑥	AC power connector	Connects an AC adapter or an optional DC cable, Auto/Air Cable, or Automobile Power Adapter/Charger.

\*If an optional External MultiBay is connected to the USB connector, the External MultiBay must also be connected to external power. If an External MultiBay is connected to the External MultiBay connector, it is not necessary to connect the External MultiBay to external power.

## Top: Pen Holder and LAN Connection Lights

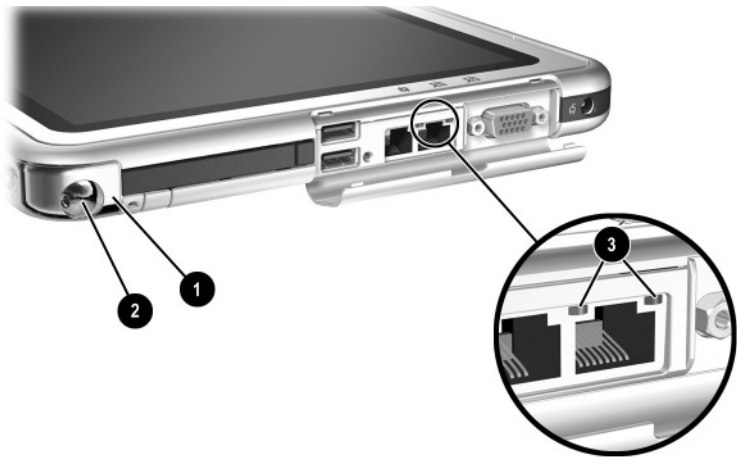

---

### Tablet PC Top Components: Pen Holder and LAN Connection Lights

---

❶ Pen holder (shown with pen ❷ inserted)	Secures the pen to the tablet PC.
❸ LAN connection lights (2)	Both lights off: The tablet PC is not connected to a LAN. Both lights on: The tablet PC is connected to a LAN with a 100 Mbps link. Green light on and yellow light off: The tablet PC is connected to a LAN with a 10 Mbps link. Green light flashing: Information is transmitting through the LAN.

---

## Top: Card Slots, Buttons and Tether Eyelet

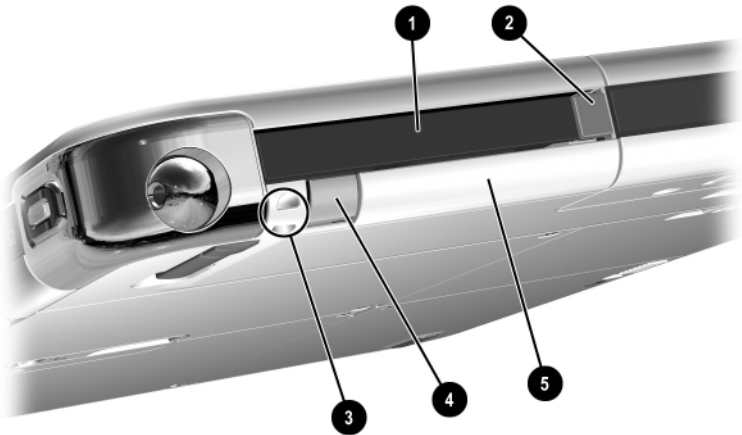

### Tablet PC Top Components: Card Slots, Buttons, and Tether Eyelet

❶	PC Card slot	Supports an optional Type I or Type II 32-bit (CardBus) or 16-bit PC Card.
❷	PC Card eject button	Ejects an optional PC Card from the PC Card slot.
❸	Tablet PC tether eyelet	Used with the tether eyelet on the pen, enables you to tether the pen to the tablet PC.
❹	CompactFlash card eject button	Ejects an optional CompactFlash card from the CompactFlash card slot.
❺	CompactFlash card slot	Supports an optional Type I or Type II CompactFlash card.

## Back: Attachment Features and Hard Drive Bay

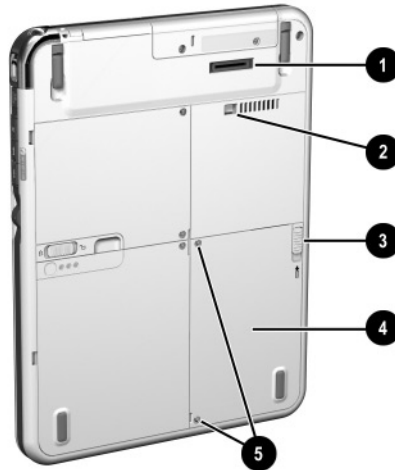

---

### Tablet PC Back Components: Attachment Features and Hard Drive Bay

---

❶	Docking connector	Connects the tablet PC to an optional docking station.
❷	Docking restraint latch recess	Accepts the docking restraint latch on an optional docking station to secure the tablet PC to the docking station.
❸	Attachment release switch	Releases an attachment, such as the portfolio, a screen protector,* or an optional tablet PC keyboard, from the universal attachment slots on the tablet PC.
❹	Hard drive bay	Holds the system hard drive.
❺	Hard drive bay retaining screws (2)	Secure the hard drive bay cover to the tablet PC.

---

\*A screen protector is included with an optional Tablet PC Docking Station.

---

## Back: Battery Bay

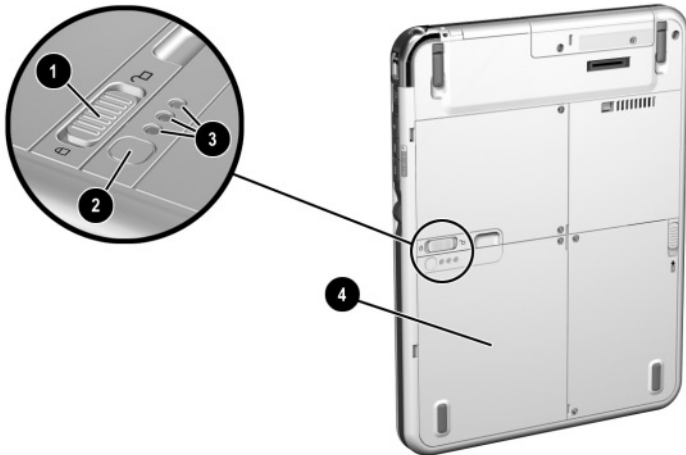

### Tablet PC Back Components: Battery Bay

① Battery pack release latch	Releases the battery pack from the battery bay.
② Battery quick check button on battery pack*	Activates the battery quick check lights, see below, which display how much charge remains in the battery pack.
③ Battery quick check lights (3) on battery pack*	<p>On: Each light represents a percent of a full charge. For example, when all 3 lights are on, the battery pack is fully charged.</p> <p>Flashing: When one light is flashing, less than 10 percent of a full charge remains in the battery pack.</p>
④ Battery bay	Holds the battery pack. Also, contains one battery pack security screw.*

\*This illustration shows the battery pack inserted in the battery bay. The battery pack is included with the tablet PC, but is not inserted. For insertion instructions and information about using a battery pack security screw for anti-theft protection, see the “Battery Packs” chapter.

## Back: Memory and Mini PCI Compartment



---

### Tablet PC Back Components: Memory and Mini PCI Compartment

---

- |  |  |
|--|--|
| ① Memory and Mini PCI (Peripheral Component Interconnect) compartment, not visible from the outside of the tablet PC | Contains one memory slot for a PC133-compliant memory module. Also, holds an optional Mini PCI board such as a modem board or a combination modem and wireless board. (A Mini PCI board is included with some tablet PC models.) |
| ② Memory and Mini PCI compartment retaining screws (2)   | Secure the memory and Mini PCI compartment cover to the tablet PC.   |
-



## Back: Labels

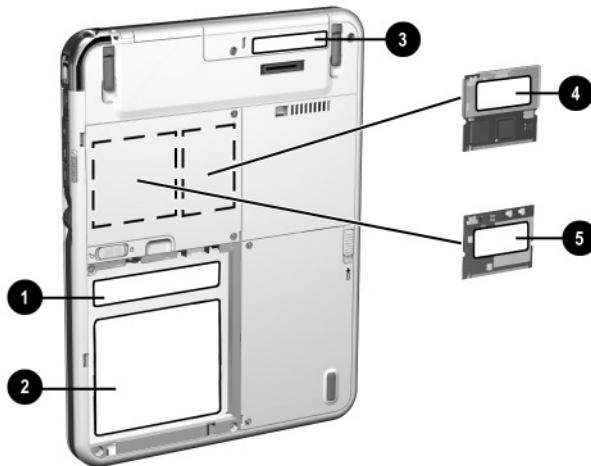

### Tablet PC Back Components: Labels

<b>1</b> Microsoft Certificate of Authenticity label ( <i>inside the battery bay</i> )	Contains the Product Key number. You may need this number to update or troubleshoot the operating system.
<b>2</b> System label	Provides regulatory information about the tablet PC.
<b>3</b> Product identification label	Contains the serial number of the tablet PC and a code describing the original configuration of the tablet PC. You will need the serial number if you call Compaq customer support.
<b>4</b> Modem approvals label (on Mini PCI modem*)	Lists the countries in which the modem has been approved for use. <sup>†</sup>
<b>5</b> Wireless certification label (on Mini PCI wireless device*)	Lists the countries in which the wireless device has been approved for use. <sup>†</sup>

\*A modem or combination modem and wireless device Mini PCI board ships inside the memory and Mini PCI compartment of some tablet PC models.

<sup>†</sup>You may need this information when traveling.

## Back: Tilt Feet and Pad Feet

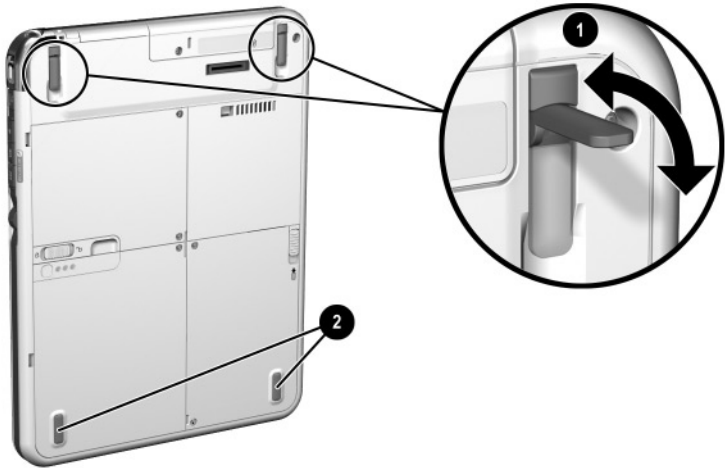

---

### Tablet PC Back Components: Tilt Feet and Pad Feet

---

**1** Tilt feet (2)

While the tablet PC is being used in portrait orientation as a free-standing tablet, can elevate the top of the tablet PC to provide a comfortable writing and viewing angle.

**2** Pad feet (2)

Stabilize the tablet PC when the tablet PC is placed as a free-standing tablet on a flat surface.

---

## Additional Tablet PC Standard Components

The components included with the tablet PC vary by geographical region and the tablet PC hardware ordered. The following illustrations and tables identify the standard external components included with most tablet PC models.

These illustrations do not include supplementary documentation, supplementary CDs, the portfolio that shipped attached to the tablet PC or an optional keyboard, or optional devices such as PC Cards or drives. The system hard drive ships inside the hard drive bay.

## Documentation and QuickRestore CDs

Among the CDs included are:

- *Compaq QuickRestore* CDs, which contain preinstalled and supplementary software.

For information about using the QuickRestore CDs, refer on this CD to the *Software Guide*, “Software Updates and Restorations” chapter.



- *Documentation Library* CD, which includes the following guides:
  - ❑ *Hardware Guide*
  - ❑ *Software Guide*
  - ❑ *Modem Command Guidelines*
  - ❑ *Lucent/Agere Command Set* (English only)
  - ❑ *Compaq WLAN Mini PCI User Guide*
  - ❑ *Troubleshooting*
  - ❑ *Regulatory and Safety Notices*
  - ❑ *Safety & Comfort Guide*

For information about using the *Documentation Library* CD, refer to the printed *Getting Started* guide included with the tablet PC.

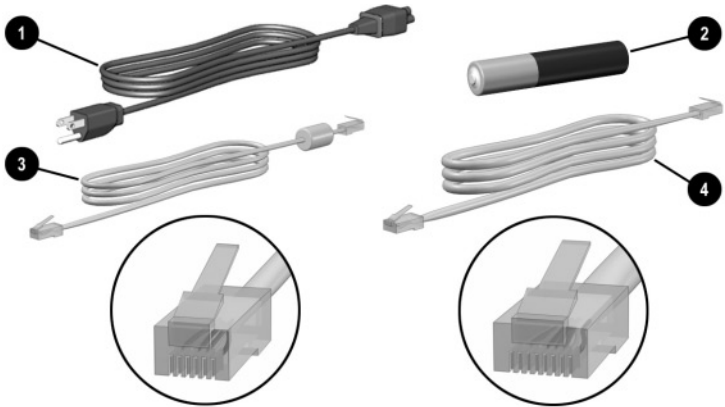
## Cord, Cables and Pen Battery



### Additional Standard Components: Cord, Cables, and Pen Battery

❶	Power cord*	Connects the AC adapter to an AC electrical outlet.
❷	Pen AAAA battery	Standard alkaline battery that powers the pen. <sup>†</sup>
❸	Modem cable	<p>Connects the modem to an RJ-11 telephone jack or to a country-specific modem adapter. (A modem cable is included with internal modem models only.)</p> <p> The modem cable has a 6-pin RJ-11 telephone connector at each end.</p>
❹	Network cable	<p>Connects the tablet PC to an RJ-45 (Ethernet network) jack. (A network cable is included with network models only.)</p> <p> The network cable has an 8-pin RJ-45 network connector at each end.</p>

\*Power cords vary in appearance by region.

<sup>†</sup>For pen battery insertion instructions, see the “Maintenance, Shipping and Travel” chapter.

## Adapters and Accessories

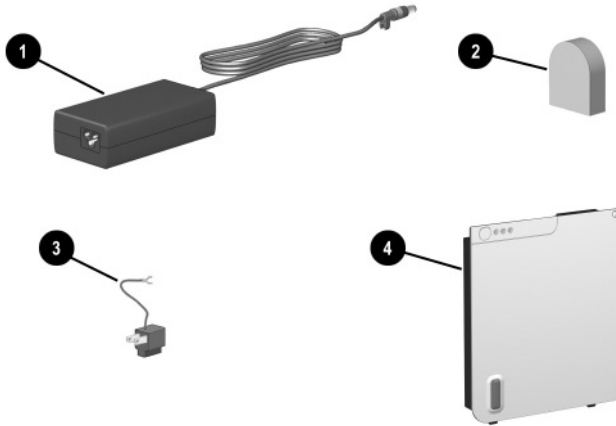

### Additional Standard Components: Adapters and Accessories

❶	AC adapter*	Converts AC power to DC power.
❷	Country-specific modem adapter (included by region as required with modem models only)	Adapts the modem cable to a non-RJ-11 telephone jack.
❸	Japan-specific outlet adapter (Japan only)	Connects the AC adapter to a 2-prong electrical outlet.
❹	Battery pack	Runs the tablet PC when the tablet PC is not connected to external power.

\*AC adapters vary in appearance by region. The only AC adapter that should be used with the tablet PC is the AC adapter included with the tablet PC or a replacement AC adapter provided by Compaq.

## Tablet PC Keyboard Components

This section identifies the hardware components of an optional tablet PC keyboard.

- For information about detaching, attaching, and adjusting the keyboard, see the “External Device Connections” chapter.
- For information about using the keyboard, see the “Pen, Command Controls and Keyboards” chapter.

### Front: Lights and Pointing Device



---

#### Keyboard Front Components: Lights and Pointing Device

---

①	Caps lock light	On: Caps lock is on.
②	Num lock light	On: The keypad is on.
③	Pointing stick	Moves the pointer and selects and activates items on the screen.
④	Left and right pointing stick buttons	Function like the left and right buttons on an external mouse.

---

## Front: Keys



### Keyboard Front Components: Keys

- |                      |   |
|----------------------|---|
| ❶ Function keys (11) | <p>Perform system and application tasks. For example, in Windows and many applications, pressing <b>F1</b> opens a Help file.</p> <ul style="list-style-type: none"> <li>■ To enter an F11 function, press <b>F11/F12</b>.</li> <li>■ To enter an F12 function, press <b>Fn+F11/F12</b>.</li> </ul> |
| ❷ <b>Fn</b>          | <p>Combines with other keys to perform system tasks. For example, pressing <b>Fn+num lk</b> turns on the keypad.</p>  |
| ❸ Keypad keys (15)*  | <p>Can be used like the keys on an external numeric keypad.</p>   |
| ❹ Microsoft logo key | <p>Displays the Windows Start menu.</p>   |
| ❺ Applications key   | <p>Displays a shortcut menu for an item beneath the pointer.</p>  |

\*For more information about using keypad keys, see the “Pen, Command Controls and Keyboards” chapter.

## Front: Positioning and Security Features



---

### Keyboard Front Components: Positioning and Security Features

---

❶	Rotation disk	Rotates the tablet PC while it is attached to the keyboard.
❷	Docking alignment notches (4)	Help guide the tablet PC and keyboard into an optional docking station.
❸	Keyboard latch	When the tablet PC and keyboard are closed, locks the tablet PC to the keyboard: <ul style="list-style-type: none"><li>■ Slide to the right to lock the tablet PC to the keyboard.</li><li>■ Slide to the left to unlock the tablet PC from the keyboard.</li></ul>

---



## Top



### Keyboard Top Components

<p>❶ Alignment key</p>	<p>Inserts into the alignment key slot on the tablet PC to safeguard attachment procedures. For example, matching the alignment key to the alignment key slot on the tablet PC helps you correctly orient the tablet PC to the keyboard as you attach the tablet PC to the keyboard.</p>
<p>❷ Keyboard hooks (2)</p>	<p>Secure the tablet PC to the keyboard.</p>
<p>❸ Keyboard connector</p>	<p>Connects the tablet PC to the keyboard.</p>
<p>❹ Tilt adjustment</p>	<p>Tilts the tablet PC upward or downward while it is connected to the keyboard.</p>

## Back

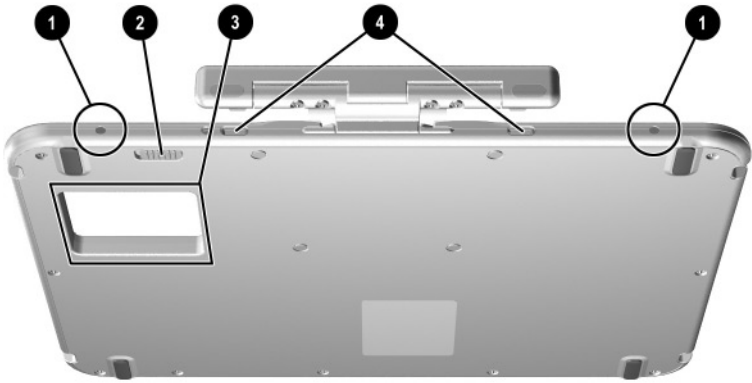

---

### Keyboard Back Components

---

❶	Screen protector slots (2)	Secure a screen protector* to the keyboard.
❷	Attachment release switch	Releases attachments, such as the portfolio, a screen protector* or the tablet PC, from the keyboard.
❸	Docking connector pass-through	Allows the tablet PC to be connected to an optional docking station while the tablet PC is attached to the keyboard.
❹	Universal attachment slots (2)	Secure the portfolio, a screen protector,* or the tablet PC to the keyboard.

---

\*A screen protector is included with an optional Tablet PC Docking Station.

---

## Additional Keyboard Standard Component

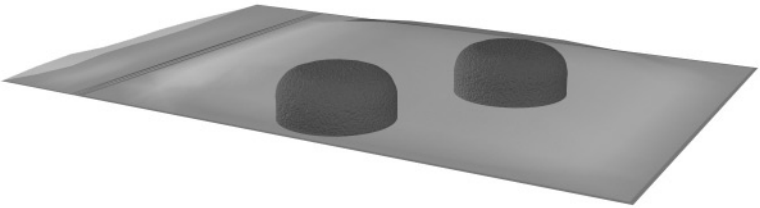

---

### Additional Keyboard Standard Component

---

- ① Spare pointing stick caps (2)    Replace a worn pointing stick cap.
-

---

## Pen, Command Controls and Keyboards

You can enter and access information on the tablet PC by voice, pen, command controls, the on-screen keyboard, or an optional tablet PC keyboard or external USB keyboard. An optional external mouse can be connected to a USB connector on the tablet PC, an optional docking station, or some external USB keyboards.

This chapter provides information about using the pen, command controls, the on-screen keyboard, and a tablet PC keyboard.

### Pen

You can write with the pen in pen-specific applications such as Journal and Tablet PC Input Panel, in all Microsoft Office applications, and in most other Windows applications and utilities. The information you write on the screen with the pen can be filed, searched, and shared among most Windows applications.

- To access basic information about using the pen within the operating system, refer to the printed *Windows XP Tablet PC Edition Start Here* guide included with the tablet PC.
- To access on-screen tutorials which include more detailed information about using the pen in the tablet PC system:
  1. Open Windows Explorer. To open Windows Explorer from the Start button, select Start > All Programs > Accessories > Windows Explorer.
  2. In Windows Explorer, select My Computer > Local Disk (C:) > WINDOWS > Help > latute.hta.

## Entering Information with the Pen

### Identifying the Pen Tip and Pen Button

The pen interacts with the tablet PC whenever the tip of the pen **1** is within 0.5 inch (1.27 cm) from the screen. The pen button **2** emulates the functions of the buttons on an external mouse.

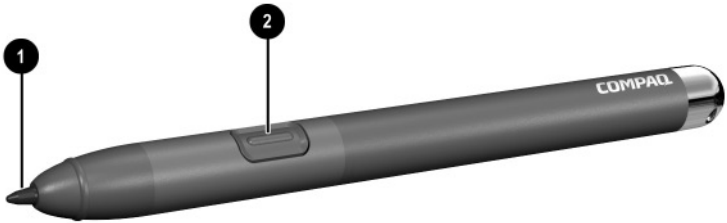

*Identifying the pen tip and pen button*

### Holding the Pen

Hold the pen as if you were handwriting with a standard pen or pencil. Position your hand on the pen so that you will not accidentally press the pen button.

As you monitor the movements of the pen, focus on the pointer, not on the tip of the pen.

## **Performing Mouse Clicks with the Pen**

To select an item on the screen as you would with the left button of an external mouse, tap the item with the tip of the pen.

To double-click an item on the screen as you would with the left button of an external mouse, tap the item twice with the tip of the pen.

To select an item as you would with the right button of an external mouse, press and hold down the pen button, then tap the item with the tip of the pen.

## **Performing Other Procedures with the Pen**

In addition to emulating mouse clicks, the pen can be used for the following tasks:

- To display the pointer location, hold the pen tip immediately over any location on the tablet PC screen without touching the screen with the pen tip.
- To display the menu options related to an item on the screen, hold the pen tip immediately over the item without touching the screen with the pen tip.
- To write with the pen, write on the screen with the tip of the pen.
- To press a pen-activated button, tap the button with the tip of the pen.
- To reactivate the pen, tap the pen tip anywhere on the tablet PC screen. To extend the life of the pen battery, the pen becomes inactive if it does not interact with the tablet PC for approximately 14 minutes.

## Maintaining and Protecting the Pen

The pen contains a standard AAAA battery that should be replaced yearly or whenever the tablet PC stops responding to the pen. For battery replacement instructions, see the “Maintenance, Shipping and Travel” chapter.

## Calibrating the Pen

The pen can function at the default calibration or at a calibration set by another user. However, Compaq highly recommends that you use the pen only while it is calibrated to your personal handwriting and mouse action motions. Calibration optimizes pen performance for all users and particularly for left-handed users.

To calibrate the pen, select Start > Control Panel > Printers and Other Hardware icon > Tablet and Pen Settings window > Pen Options tab, then follow the instructions on the screen.

As you perform the calibration:

- Tap the pen in the exact center of each of the calibration markers. The calibration markers are displayed on the screen as plus signs (+).
- Be sure to calibrate the pen for use in both portrait and landscape orientations.
- You can display information about any setting in the Tablet and Pen Settings window by selecting the question mark button in the upper right corner of the window, then selecting a setting. A definition, explanation, or procedure is displayed.

## **Using the Pen Holder**

To protect the pen when you are not using it, insert the pen, tip first, into the pen holder on the tablet PC.

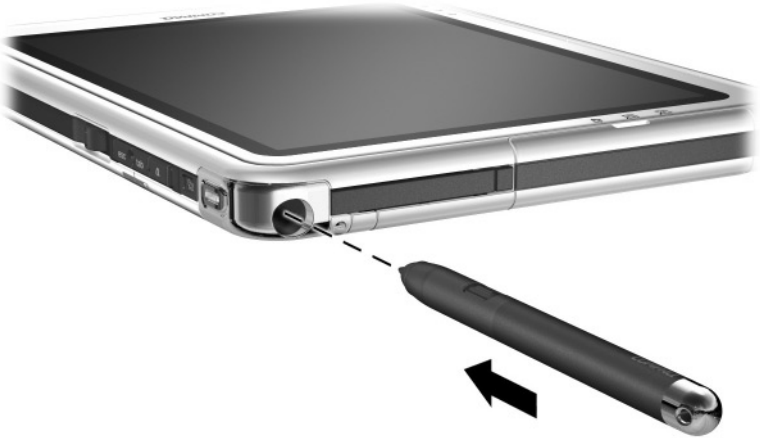

***Inserting the pen into the pen holder***



## Using the Tether Eyelets

For additional protection against loss or theft, loop one end of a tether through the tether eyelet on the pen barrel ❶ and loop the other end of the tether through the tether eyelet on the tablet PC ❷.



*Identifying the tether eyelets*

## Setting Pen Preferences

Pen preferences are set in the Tablet and Pen Settings window of the operating system. The preferences include settings that optimize handwriting recognition and the location of on-screen menus for either right-handed or left-handed users. To access the pen settings, select Start > Control Panel > Printers and Other Hardware icon > Tablet and Pen Settings window > Pen Options tab.

The preferences you set in the Tablet and Pen Settings window are specific to the pen and the tablet PC.

Pointing device preferences, such as pointer speed, click speed, and mouse trails, that apply to any pointing device in the system, are set in the Mouse Properties window. For instructions, see “Setting Pointing Device Preferences” in the “Tablet PC Keyboard” section later in this chapter.

## Command Controls

The 9 command controls enable you to enter commands usually entered with keyboard keys while you are using the tablet PC without an optional keyboard. The command controls can also be used while you are using the on-screen keyboard or an optional keyboard.

### Identifying Command Controls

- ❶ Tablet PC Input Panel launch button
- ❷ Journal launch button
- ❸ Rotate button
- ❹ Email launch button
- ❺ Q menu button
- ❻ Tab button
- ❼ Windows Security button
- ❽ Esc button
- ❾ Jog dial

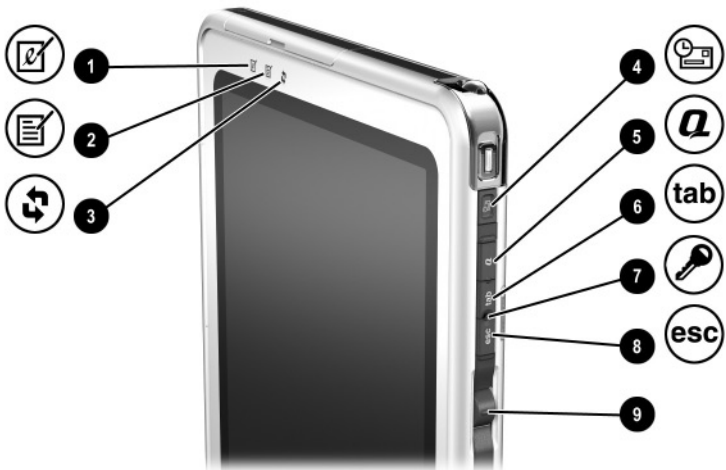

*Identifying the command controls*

## Command Controls Quick Reference

The following table identifies the default setting and activation procedure for each command control.

- To activate a pen-activated button, tap the button with the tip of the pen.
- To activate a manually activated button, press and release the button.

Button	Default Function	Activation
Journal launch button*	Opens and closes the Journal application.	Pen
Tablet PC Input Panel launch button*	Opens and closes the Tablet PC Input Panel application, which includes a writing pad and the on-screen keyboard.	Pen
Rotate button*	Switches the image between landscape and portrait orientation.	Pen
Windows Security button*	In Windows, functions like the ctrl+alt+delete command on a standard keyboard. In the Setup utility, functions like the reset button on some computers.	Manual
Email launch button	Launches the default email application.	Manual
Q menu button*	Opens and closes the Q Menu.	Manual
Tab button*	Functions like <b>tab</b> on a standard keyboard.	Manual
Esc button*	During startup, opens the Setup utility. In Windows, functions like <b>esc</b> on a standard keyboard.	Manual
Jog dial*	Enters commands or scrolls the image upward or downward.	Manual

\*These controls are programmable. For instructions, see "Setting Command Control Preferences," later in this chapter.

## Using Command Controls

### Journal Launch Button

Tap the Journal launch button with the pen tip to open the Journal application. The Journal application is a handwriting program unrelated to the Journal feature in Microsoft Outlook.

For more information about using the Journal application, refer to the Help file within the application or to an on-screen tutorial. To access the tutorials:

1. Open Windows Explorer. To open Windows Explorer from the Start button, select Start > All Programs > Accessories > Windows Explorer.
2. In Windows Explorer, select My Computer > Local Disk (C:) WINDOWS > Help > latute.hta.

### Tablet PC Input Panel Launch Button

Tap the Tablet PC Input Panel launch button with the pen tip when the tablet PC is in Windows to open the Tablet PC Input Panel application. The Tablet PC Input Panel application displays a keyboard on the screen and can also display a writing pad, which supports handwriting.

To protect your work and the system, the ctrl+alt+delete command cannot be entered using the **Ctrl**, **Alt**, and **Del** keys on the on-screen keyboard. To enter the ctrl+alt+delete command, press the Windows Security button on the tablet PC with the pen tip or a small object like the end of a paper clip.

For more information about using the Tablet PC Input Panel application, refer to the Help file within the application, the “On-Screen Keyboard” section later in this chapter, or to an on-screen tutorial. To access the tutorials:

1. Open Windows Explorer. To open Windows Explorer from the Start button, select Start > All Programs > Accessories > Windows Explorer.
2. In Windows Explorer, select My Computer > Local Disk (C:) WINDOWS > Help > latute.hta.

## Rotate Button

Tap the rotate button with the pen tip when the tablet PC is in Windows to rotate the image on the screen 90 degrees. For example, if the image is in landscape orientation, tap the rotate button to rotate the image to portrait orientation.

## Windows Security Button

Press the Windows Security button with the pen tip or a small object like the end of a paper clip to enter the **ctrl+alt+delete** command while you are in Windows or the reset command while you are in the Setup utility. The **ctrl+alt+delete** command cannot be entered using the **Ctrl**, **Alt**, and **Del** keys on the on-screen keyboard.

### Ctrl+Alt+Delete Command

When the tablet PC is in Windows, the Windows Security button clears your work from the screen and displays the Windows Security window in which you can lock, log off, or shut down the tablet PC, initiate Standby or Hibernation, or open Task Manager.

- The Shut Down option in the **ctrl+alt+delete** window enables you to safely shut down the tablet PC if the system has become unresponsive.
- Task Manager displays the status of all open applications and enables you to close an application that has become unresponsive.

If the system remains unresponsive after selecting Shut Down in the Windows Security window, slide and hold the power switch for 4 seconds. For additional shut down procedures, refer on this CD to the *Software Guide*, “Power” chapter. For information about using the **ctrl+alt+delete** command in non-Windows applications, refer to the application documentation.

## Reset Command

When the Setup utility is open, the Windows Security button simulates the reset button found on some computers. When the tablet PC is reset, the tablet PC restarts and all unsaved information is lost.

The reset function can be used to restore functionality when the system has become unresponsive. For information about the Setup utility, which is a non-Windows utility, refer on this CD to the *Software Guide*, “Setup, Diagnostic and Support Utilities” chapter.

## Email Launch Button

Press the email launch button manually to open an Internet connection wizard or your default email application.

- Until your Internet or network service is set up, the email launch button opens an Internet connection wizard.
- After your Internet or network service is set up, the email launch button opens the default email application.

The default email application is Microsoft Outlook Express. If the Outlook application is installed, the default email application is Outlook, but Outlook Express remains available. The default Web browser is Microsoft Internet Explorer.

After your Internet or network service is set up, you can change the default email application. To change the default application:

1. Select Start > Internet Explorer icon.
2. In Internet Explorer, select Tools > Internet Options > Programs tab, then follow the instructions on the screen.

## Q Menu Button

Press the Q menu button manually when the tablet PC is in Windows to open or close the Q Menu. The Q Menu provides quick access to programmable tasks and destinations including:

- System controls, such as volume and screen brightness.
- Key simulations such as Capture Screen, which functions like the **print screen** key on a standard keyboard.
- Applications, files, or folders on a drive, a network, or the Internet.

To select an item from the Q Menu without using the pen or a keyboard, press the Q menu button to display the Q Menu, rotate the jog dial upward or downward until your selection is highlighted, then press the jog dial inward.

For more information about using the Q Menu, refer on this CD to the *Software Guide*, “Q Menu and Desktop Profile Manager Utility” chapter.

## Tab Button

Press the tab button manually to enter the tab command as you would by pressing the **tab** key on a standard keyboard. The tab button can be used with or without the on-screen keyboard or an optional keyboard.

The function of the tab command varies by application. For example, in Microsoft Word the tab command indents and in Microsoft Excel the tab command moves the pointer to an adjoining cell.

The tab button can be combined with keystrokes on the on-screen keyboard or an optional keyboard. For example, press the **alt** key on either keyboard, then the tab button, to display and select from among all open applications.

## Esc Button

Press the esc button manually to open the Setup utility or to use the esc button like the **esc** key on a standard keyboard.

### Setup Utility Function

While the tablet PC is starting up, the Compaq logo is displayed and the cursor flashes in the upper right hand corner of the screen. During this time, press the esc button to open the Setup utility. For information about the Setup utility, refer on this CD to the *Software Guide*, “Setup, Diagnostic and Support Utilities” chapter.

### Esc Key Function

When the tablet PC is on, press the esc button to enter the esc command as you would by pressing the **esc** key on a standard keyboard. The esc button can be used with or without the on-screen keyboard or an optional keyboard.

The function of the esc command varies among applications. Esc is usually used to exit a mode or routine or to cancel a function.

The esc button can be combined with keystrokes on the on-screen keyboard or an optional keyboard. For example, press the **ctrl** key on either keyboard, then the esc button, to display the Windows Start menu.



## Jog Dial

Press or rotate the jog dial manually to enter commands or scroll vertically:

- Press inward to simulate the function of the **enter** key on a standard keyboard.
- Rotate upward or downward to scroll toward the top or bottom of an image.

At the default setting, the jog dial scrolls line by line like the up and down arrow keys on a standard keyboard. The jog dial can be set to scroll page by page like the page up and page down keys on a standard keyboard or 3 lines at a time like a mouse wheel. Other settings, in addition to scroll functions, are also available. For instructions, see “Setting Command Control Preferences,” next in this chapter.

## Setting Command Control Preferences

All command controls except the email launch button and the enter function of the jog dial can be set to launch applications, simulate key combinations, or perform preset system functions.

Each programmable command control can be assigned to 4 settings. Each setting applies only to one of 4 views:

- Portrait-Primary
- Portrait-Secondary
- Landscape-Primary
- Landscape-Secondary

Command control preferences are set in the Tablet and Pen Settings window. You must select a view before setting a preference. Each view is illustrated in the Button Location pane of the Tablet and Pen Settings window as you select it.

If you are unfamiliar with the 4 views, you may want to read “Selecting a View,” next in this section, before setting a command control preference.

## Selecting a View

In the Portrait-Primary and Portrait-Secondary views, the image is displayed vertically, in portrait orientation. In the Landscape-Primary and Landscape-Secondary views, the image is displayed horizontally, in landscape orientation.

- A portrait view is often optimal when you are using the tablet PC as a handheld.
- A landscape view is often optimal when you are displaying the image on an optional external monitor or projector.

In the primary views (Portrait-Primary and Landscape-Primary), the image switches clockwise between vertical and horizontal. In the secondary views (Portrait-Secondary and Landscape-Secondary), the image switches counterclockwise between vertical and horizontal.

- Left-handed users may find the secondary views more convenient.
- Compaq recommends that you not use a secondary view while using the internal wireless. The positions commonly occupied by the tablet PC, external devices, and users while the tablet PC is in a secondary view may obstruct the antennas.

When you are facing the tablet PC screen with the tablet PC in portrait orientation, the antennas, not visible from the outside of the tablet PC, are on the right and left sides of the tablet PC, near the upper corners.

To switch the system among the Portrait-Primary, Landscape-Primary, Portrait-Secondary, and Landscape-Secondary views:

1. Press the Q menu button.
2. Select a view from the Q Menu. (The system switches to the view you select.)

For more information about using the Q Menu, including instructions for adding or removing items from the Q Menu, refer on this CD to the *Software Guide*, “Q Menu and Desktop Profile Manager Utility,” “Q Menu” section.

## Assigning or Changing a Preference

To assign or change the function of a programmable command control:

1. Select Start > Control Panel > Printers and Other Hardware icon > Tablet and Pen Settings window > Tablet Buttons tab.
2. In the Button Settings For field, select the view in which you want to use your preference. (The view is illustrated in the Button Location panel.)
3. In the Tablet Button drop-down list, select the button you plan to assign.
  - To assign or change the function of rotating the jog dial upward, select Up.
  - To assign or change the function of rotating the jog dial downward, select Down.
4. Select the Change button. (The Button Action dialog box opens.)
5. Select your preference in the Button Action dialog box. To save your preference, select the OK or Apply button.

## Returning All Command Controls to Default Settings

To return the settings on *all* command controls to their default settings:

1. Select Start > Control Panel > Printers and Other Hardware icon > Tablet and Pen Settings window > Tablet Buttons tab.
2. In the Button Settings For field, select the view in which you want to change all command controls to their default settings.
3. Select the Reset button. (All command controls are returned to their default settings only in the orientation currently selected.)
4. Select the OK or Apply button.

## On-Screen Keyboard

The Tablet PC Input Panel application displays a keyboard on the screen. This on-screen keyboard simulates the functions of an optional keyboard.

To open the Tablet PC Input Panel application, tap the Tablet PC Input Panel launch button ❶ with the pen.

- To type, tap a key.
- To switch the keys displayed in the top row between number keys and function keys, tap **Func.**
- To enter the ctrl+alt+delete command, press the Windows Security button ❷ on the tablet PC with the pen tip or a small object like the end of a paper clip. To protect your work and the system, the ctrl+alt+delete command cannot be entered using the **Ctrl**, **Alt**, and **Del** keys on the on-screen keyboard.

For more information about using the Tablet PC Input Panel application, see the “Using Command Controls” section, “Tablet PC Input Launch Button” earlier in this chapter.

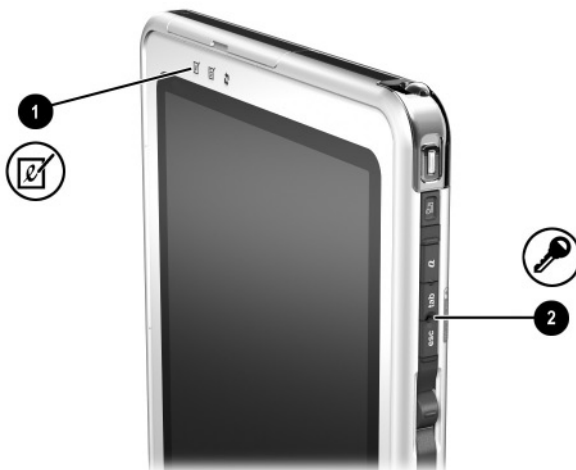

*Identifying the Tablet PC Input Panel launch and Windows Security buttons*

## Tablet PC Keyboard

An optional tablet PC keyboard that is thinner than the tablet PC but the same length and width is available from your Compaq authorized dealer, reseller, or service provider.

When the tablet PC is attached to the keyboard, the tablet PC can be folded down flush with the keyboard for transport or tilted upward and used like a notebook display.

This chapter provides information about using the keyboard pointing device and keypad.

- For information about identifying other keyboard components, see the “External Components” chapter.
- For information about attaching, detaching, and positioning the keyboard, see the “External Device Connections” chapter.



***Using the tablet PC and tablet PC keyboard like a notebook***

## Using the Pointing Device

### Navigating and Selecting

To move the pointer, press the pointing stick **1** in the direction you want to move the pointer. To increase or decrease pointer speed, increase or decrease the directional (not downward) pressure on the pointing stick. If the pointer continues to move after you release the pointing stick, wait a few seconds and the pointer will stop moving.

Use the left **2** and right **3** pointing stick buttons as you would the left and right buttons on an external mouse.

For information about replacing the pointing stick cap with one of the 2 spare pointing stick caps included with the keyboard, see the “Maintenance, Shipping and Travel” chapter.



**Identifying pointing device components**

## Setting Pointing Device Preferences

Pointer speed, click speed, mouse trails, and other pointing device preferences can be set in the Mouse Properties window of the operating system. To access Mouse Properties, select Start > Control Panel > Printers and Other Hardware icon > Mouse icon.

To learn more about a setting, select the question mark icon in the upper right corner of the window, then select the setting. To select a setting, follow the instructions on the screen, then select the OK button.

Mouse Properties settings apply to any pointing device in the system, including the pen, an optional mouse, and the pointing device on an optional tablet PC keyboard.

## Using the Keypad

The tablet PC keyboard includes 15 keys that can be used like the keys on an external numeric keypad. When the keypad is turned on, each of these 15 keys performs the functions indicated by the icon in the upper right corner of the key. The standard functions of the keypad keys can still be accessed while the keypad is turned on.



**Identifying the keypad keys**

## Turning the Keypad On and Off

When the keypad is off, press **Fn+num lk** ❶ on the keyboard to turn the keypad on.

When the keypad is on, press **Fn+num lk** on the keyboard to turn the keypad off.

When the keypad is on, the num lock light ❷ on the keyboard is on. When the keypad is off, the num lock light on the keyboard is off.



**Identifying the Fn and num lk keys and the num lock light**



## Switching Keypad Keys Between Standard and Keypad Functions

You can temporarily switch the functions of keypad keys between their standard keyboard functions and their keypad functions by using **Fn** ❶ and **shift** ❷.

- To use a key on the keypad temporarily as a keypad key while the keypad is off, press and hold **Fn** as you press the key.
- To use a keypad key temporarily as a standard key while the keypad is on:
  - ❑ Press and hold **Fn** to type in lowercase.
  - ❑ Press and hold **Fn+shift** to type in uppercase.

When **Fn** is released, the keypad keys return to their standard functions if the keypad is off or to their keypad functions if the keypad is on.



**Identifying the Fn and shift keys**

## Using F11/F12

F11/F12 provides both F11 and F12 functions.

- To enter an F11 function, press **F11/F12** ❶.
- To enter an F12 function, press **Fn+F11/F12** ❷.

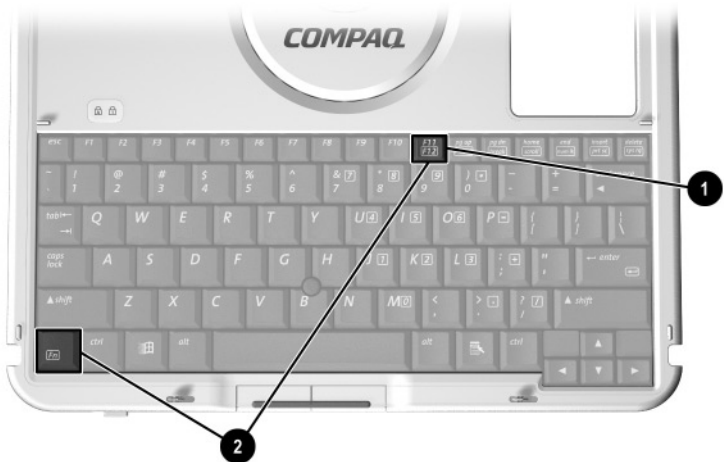

*Identifying the F11/F12 and Fn keys*

---

## Battery Packs

### Running the Tablet PC on Battery Power

When the tablet PC is connected to external power, the tablet PC runs on external power.

When a charged battery pack is in the tablet PC and the tablet PC is not connected to external power, the tablet PC runs on battery power.

The tablet PC switches between external power and battery power according to the availability of an external power source. For example, if the tablet PC contains a charged battery pack and is running on external power supplied through the AC adapter, the tablet PC will switch to battery power if the AC adapter is disconnected from the tablet PC.

Whether to leave a battery pack in the tablet PC or in storage depends on how you work. Keeping a battery pack in the tablet PC enables the battery pack to charge whenever the tablet PC is connected to external power and also protects your work in case of a power outage.

On the other hand, a battery pack in the tablet PC slowly discharges even while the tablet PC is turned off.

If you will not be using the tablet PC for one month or more, removing the battery pack and storing it as described in “Storing a Battery Pack,” later in this chapter, will prolong its life. For more information about leaving your work, refer on this CD to the *Software Guide*, “Power” chapter.

# Replacing a Battery Pack

## Removing a Battery Pack

 **CAUTION:** To prevent loss of work when removing a battery pack that is running the tablet PC, initiate Hibernation or turn off the tablet PC before removing the battery pack.

- If you remove a battery pack that is running the tablet PC while the tablet PC is in Standby, your work is saved in Standby for up to one minute, then the tablet PC shuts down and your unsaved work is lost.
- If you remove a battery pack that is running the tablet PC while the tablet PC is on, the tablet PC shuts down immediately and your unsaved work is lost.

---

To remove a battery pack from the tablet PC:

1. Turn the tablet PC front side down. (If a battery pack security screw is in place, remove the screw.)
2. To unlock the battery pack release latch, press the latch firmly toward the unlock icon **1**. Then slide and hold the latch as you disengage the 2 tabs on the battery pack from the 2 slots on the battery bay **2** and lift the battery pack out of the battery bay **3**.

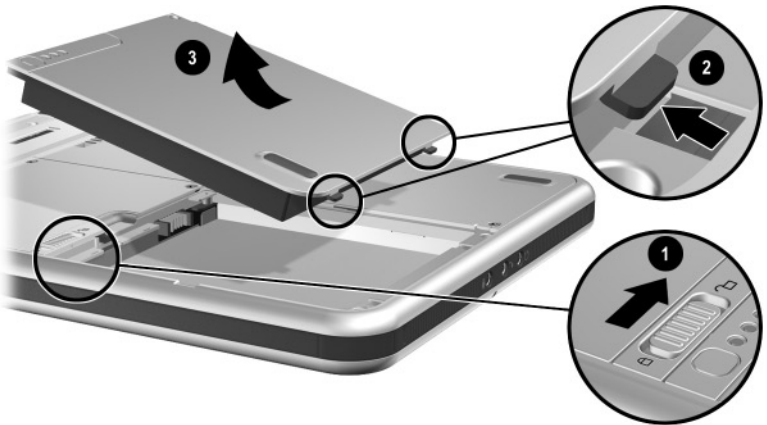

**Removing a battery pack**

## Inserting a Battery Pack

To insert a battery pack into the tablet PC:

1. Turn the tablet PC front side down.
2. Align the 2 rectangular tabs **1** on the battery pack with the 2 rectangular alignment slots **2** in the battery bay.

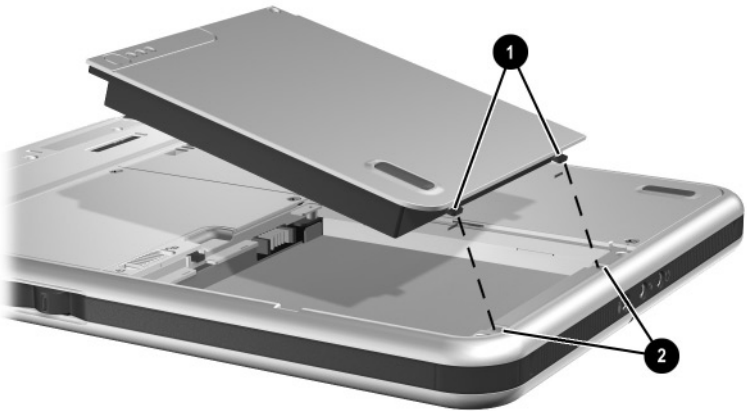

***Aligning the battery pack tabs with the battery bay alignment slots***

3. Angle the battery pack toward the alignment slots ❶ until the 2 tabs are inserted into the 2 alignment slots ❷.
4. Tilt the battery pack downward until it snaps into place ❸.

If you initiated Standby or Hibernation before replacing the battery pack, slide and release the power switch to resume from Standby or Hibernation.

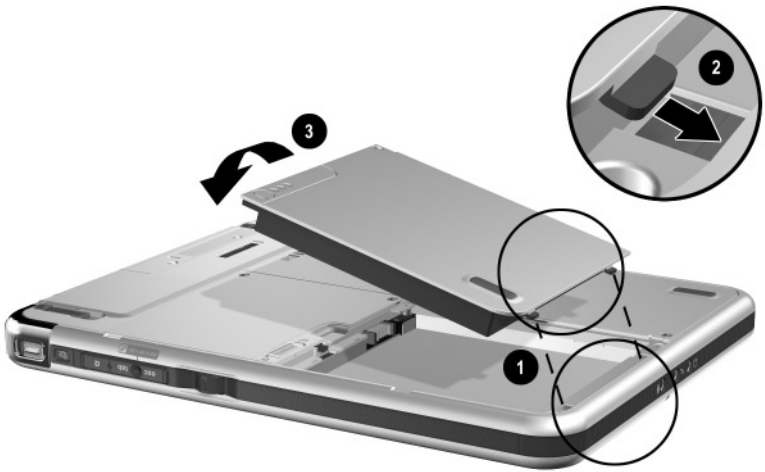

***Inserting a battery pack***

## Securing a Battery Pack

You can provide anti-theft protection for the battery pack in the battery bay by using a battery pack security screw.

### Accessing the Battery Pack Security Screws

One battery pack security screw ships inside the package containing the pen battery. A second battery pack security screw ships inside the battery bay.

To access the battery pack security screw which ships inside the battery bay:

1. Remove the battery pack as instructed in “Replacing a Battery Pack,” earlier in this section.
2. Remove the battery pack security screw.

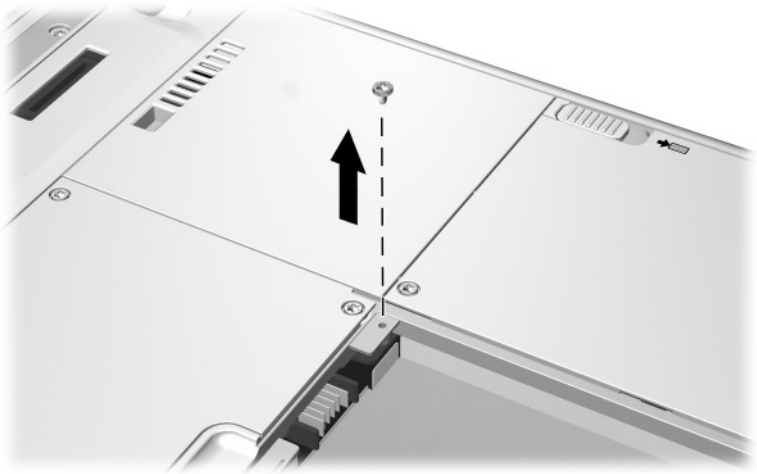

***Removing the battery pack security screw***

## Inserting a Battery Pack Security Screw

To secure the battery pack in the battery bay with a battery pack security screw:

1. Insert the battery pack into the battery bay as instructed in “Replacing a Battery Pack,” earlier in this section.
2. Insert a battery pack security screw through the battery pack case and into the tablet PC.



*Inserting a battery pack security screw*



## Charging a Battery Pack

The battery pack in the tablet PC charges whenever the tablet PC is connected to external power.

The battery pack charges whether or not the tablet PC is in use, but charges faster when the tablet PC is off.

Charging may be delayed if a battery pack is new, has not been used for 2 weeks or more, or is much warmer or cooler than room temperature. A new battery pack charges in the tablet PC as shipped in about 2 hours. Other charging times vary.

The battery light displays charge status:

- On: the battery pack is charging.
- Off: the battery pack is fully charged.
- Flashing: the battery pack has 10 percent or less of a full charge.

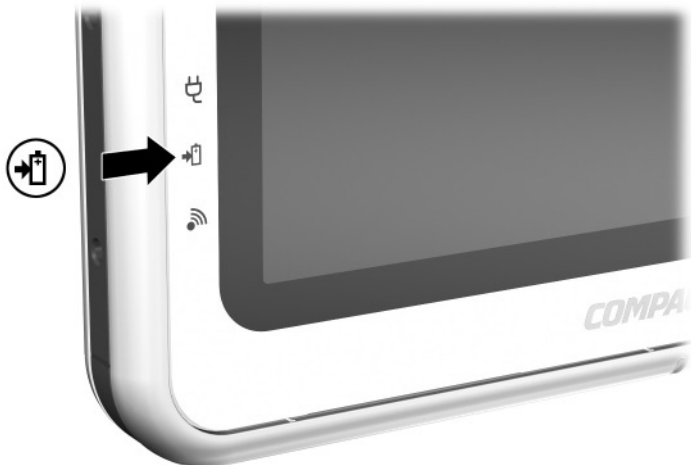

***Identifying the battery light***

## Charging a New Battery Pack

Fully charge the battery pack while the tablet PC is connected to external power through the AC adapter or an optional DC cable.

A new battery pack that has been partially charged, but not fully charged, can run the tablet PC, but battery charge displays may be inaccurate.

## Charging an In-Use Battery Pack

To prolong battery life and increase the accuracy of battery charge displays:

- Allow the battery pack to discharge to less than 10 percent of a full charge through normal use before charging it.
- When you charge the battery pack, charge it fully. An in-use battery pack can be charged while the tablet PC is connected to external power through the AC adapter or an optional Automobile Power Adapter Charger, docking station, or DC cable.

An optional Auto/Air Cable can be used to run the tablet PC, but cannot be used to charge a battery pack.

## Monitoring the Charge in a Battery Pack

### Obtaining Accurate Charge Information

To increase the accuracy of all battery charge displays:

- Allow a battery pack to discharge to less than 10 percent of a full charge through normal use before charging it.
- When you charge a battery pack, charge it fully.
- If a battery pack has not been used for one month or more, calibrate the battery pack instead of simply charging it. For calibration instructions, see “Calibrating a Battery Pack,” later in this chapter.

---

## Displaying Charge Information on the Screen

### Accessing Charge Displays

To display battery charge information on the screen, use the operating system Power Meter feature.

To access Power Meter displays, use either of the following methods:

- Select Start > Control Panel > Performance and Maintenance icon > Power Options icon > Power Meter tab.
- Select the Power Meter icon in the system tray.

To display the Power Meter icon in the system tray:

1. Select Start > Control Panel > Performance and Maintenance icon > Power Options icon > Advanced tab.
2. Select the Always Show Icon On The Taskbar check box.
3. Select the OK button.
4. If the icon is not displayed, select in the system tray the icon for Show Hidden Icons.

### Interpreting Charge Displays

Power Meter displays battery status in both percent and time:

- The percent indicates the amount of charge remaining in the battery pack.
- The time indicates the approximate running time remaining on the battery pack *if the battery pack continues to provide power at the current level*. For example, the time remaining will decrease if you start backing up to a CompactFlash card and will increase when the backup is complete.

A lightning bolt icon indicates that the battery pack is charging.

## Displaying Charge Information on a Battery Pack

Charge information about a battery pack can be displayed on the battery pack with the Quick Check feature, which can be used whether or not the battery pack is inserted in the battery bay.

To display the percent of a full charge remaining in a battery pack, press the battery quick check button ❶ on the battery pack. The 3 battery quick check lights ❷ on the battery pack indicate the charge remaining in the battery pack.

Indication	Percent of a Full Charge Remaining
3 lights on	67 to 100%
2 lights on	34 to 66%
1 light on	11 to 33%
1 light flashing*	0 to 10%

\*When the battery pack reaches 10% of a full charge, the battery light on the tablet PC also flashes.

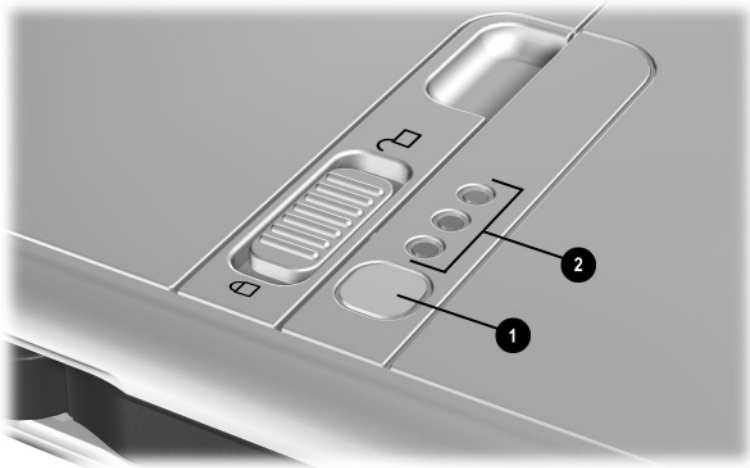

**Identifying the quick check button and lights on a battery pack inserted in the battery bay**

## Managing Low-Battery Conditions

The information in this section describes default alerts and system responses.

Some low-battery condition alerts and system responses can be changed in the Power Options Properties window of the operating system. Preferences set in the Power Options Properties window do not affect lights.

For information about setting preferences in the Power Options Properties window, refer on this CD to the *Software Guide*, “Power” chapter, “Setting Power Preferences” section.

## Identifying Low-Battery Conditions

### Low-Battery Condition

When a battery pack that is the sole power source available to the tablet PC reaches a low-battery condition (10 percent of a full charge), the battery light flashes.

### Critical Low-Battery Condition

If a low-battery condition is not resolved, the tablet PC enters a critical low-battery condition (1 percent of a full charge).

In a critical low-battery condition:

- If Hibernation is enabled and the tablet PC is on or in Standby, the tablet PC initiates Hibernation.
- If Hibernation is disabled and the tablet PC is on or in Standby, the tablet PC remains briefly in Standby, then shuts down and loses your unsaved work.

Hibernation is enabled by default. To verify that Hibernation is enabled, select Start > Control Panel > Performance and Maintenance icon > Power Options icon > Hibernate tab. If Hibernation is enabled, the Enable Hibernation check box is selected.

## Resolving Low-Battery Conditions

**CAUTION:** If the tablet PC has reached a critical low-battery condition (1 percent of a full charge) and has initiated Hibernation, do not slide the power switch until Hibernation is complete. Hibernation is complete when the power/standby light turns off.

---

## When a Charged Battery Pack Is Available

Select one of the following options:

- Turn off the tablet PC or initiate Hibernation, insert a charged battery pack while the tablet PC is off or in Hibernation, then turn on the tablet PC.
- To replace the battery with minimal disruption to your work, slide and release the power switch ❶ to initiate Standby, confirm that Standby has been initiated by making sure the power/standby light is flashing ❷, then replace the battery pack *within one minute*.

**CAUTION:** To prevent loss of work, do not immediately repeat the Standby procedure for replacing a battery pack. The bridge battery, which runs the tablet PC in Standby for up to one minute, requires time to recharge.

---

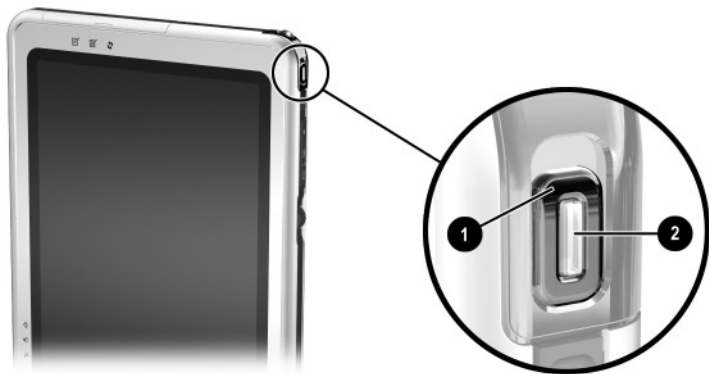

**Identifying the power switch and the power/standby light**

## When External Power Is Available

Select one of the following options:

- Plug the AC adapter cable into the tablet PC, then plug the power cord into the AC adapter and into an AC electrical outlet.
- Plug an optional Automobile Power Adapter/Charger into the tablet PC and into a vehicle cigarette lighter receptacle.
- Plug an optional Auto/Air Cable into the tablet PC and into the in-seat power supply available on some commercial aircraft. (An optional Auto/Air Cable can run the tablet PC but cannot charge a battery pack.)
- Plug an optional DC cable into the tablet PC and a DC electrical outlet.

## When No Power Source Is Available

Initiate Hibernation. Or, save your work, then shut down the tablet PC.

## Initiating and Resuming from Standby or Hibernation

For more information about Standby and Hibernation, refer on this CD to the *Software Guide*, “Power” chapter.

- To initiate Standby, slide and release the power switch. To resume from Standby, slide and release the power switch, press any key or activate the pointing device on an optional tablet PC keyboard, or activate an optional USB mouse.
- To initiate Hibernation, select Start > Shut Down > Hibernate. If the Hibernate option is not displayed and an optional keyboard is in the system, press and hold **shift**. (When you press and hold **shift**, the Hibernate option replaces the Stand by option in the Shut Down window.) To resume from Hibernation, slide and release the power switch.

For information about initiating Standby or Hibernation from the Q Menu, refer on this CD to the *Software Guide*, “Q Menu and Desktop Profile Manager Utility” chapter.

# Calibrating a Battery Pack

## When to Calibrate

Calibrate an in-use battery pack whenever battery charge displays seem inaccurate or whenever the battery pack has not been used for one month or more. It should not be necessary to calibrate any battery pack, even if it is heavily used, more than once a month. It is not necessary to calibrate a new battery pack before first use.

## How to Calibrate

Calibration requires 3 steps:

1. Fully charge the battery pack.
2. Fully discharge the battery pack.
3. Fully recharge the battery pack.

To initiate an unattended calibration in an optional Battery Charger or Multibattery Charger, follow the instructions included with the charger.

To calibrate a battery pack manually, follow the instructions in the following sections.

## Charging the Battery Pack

You can charge the battery pack while the tablet PC is on or off, but the battery pack will charge faster while the tablet PC is off.

To charge the battery pack:

1. Insert the battery pack into the tablet PC.



2. Connect the tablet PC to external power. (The battery light turns on.) To connect the tablet PC to external power, use any of the following methods:
  - ❑ Plug the AC adapter cable into the tablet PC, then plug the power cord into the AC adapter and into an AC electrical outlet.
  - ❑ Plug an optional Automobile Power Adapter/Charger into the tablet PC and into a vehicle cigarette lighter receptacle.
  - ❑ Plug an optional DC cable into the tablet PC and into a DC electrical outlet.
3. Leave the tablet PC connected to external power until the battery pack is fully charged. (The battery light turns off.)

## Discharging the Battery Pack

The tablet PC must remain on while the battery pack is being discharged. The battery pack can discharge whether or not you are using the tablet PC, but will discharge faster while the tablet PC is in use.

- If you plan to leave the tablet PC untended during the discharge, save your work before beginning the discharge procedure.
- If you use the tablet PC occasionally during the discharge procedure and have set energy-saving timeouts, expect the following performance from your system during the discharge process:
  - ❑ The monitor will not turn off automatically.
  - ❑ Hard drive speed will not decrease automatically while the tablet PC is idle.
  - ❑ System-initiated Standby will not occur.
  - ❑ System-initiated Hibernation will not occur until the battery has discharged to a critical low-battery condition.

To fully discharge a battery pack:

1. When the battery light turns off indicating that the battery pack is fully charged, select Start > Control Panel > Performance and Maintenance icon > Power Options icon > Power Schemes tab.
2. Record the 2 settings in the Plugged In column and the 2 settings in the Running On Batteries column so that you can reset them after the calibration.
3. Change the settings in both columns to Never.
4. Select the OK button.
5. Disconnect the tablet PC from the external power source, but do *not* turn off the tablet PC.
6. Run the tablet PC on battery power until the battery pack is fully discharged. (The battery light begins to flash when the battery pack has discharged to a low-battery condition. When the battery pack is fully discharged, the tablet PC initiates Hibernation and the power/standby light turns off.)

## Recharging the Battery Pack

1. Connect the tablet PC to external power, then leave the tablet PC connected to external power until the battery pack is fully recharged. (The battery light turns off.)  
You can use the tablet PC while the battery pack is recharging but the battery pack will charge faster if the tablet PC is off.
2. If the tablet PC is off, turn it on when the battery pack is fully charged and the battery light turns off.
3. Select Start > Control Panel > Performance and Maintenance icon > Power Options icon > Power Schemes tab.
4. Referring to the settings you recorded earlier, reenter your settings for the 2 options in the Plugged In column and the 2 options in the Running On Batteries column.
5. Select the OK button.

## Battery Conservation Procedures and Settings

Using the battery conservation procedures and settings described in the following sections extends the time that a battery pack can run the tablet PC from a single charge.

### Conserving Power as You Work

To conserve power as you use the tablet PC:

- Turn off wireless and local area network (LAN) connections and exit modem applications when you are not using them.
- Detach, disconnect, stop, or remove unpowered external devices that you are not using. Such devices include a PC Card, a CompactFlash Card, or a tablet PC keyboard.
- Use the Brightness item on the Q Menu to quickly lower and raise screen brightness as you need it.
- Use optional powered speakers instead of the internal speakers, or use volume controls to quickly mute, restore, raise, and lower system volume as you need it.
- If you leave your work, initiate Standby or Hibernation or shut down the tablet PC.

### Selecting Power Conservation Settings

To set the tablet PC to conserve power:

- Select a short wait for the screen saver and select a screen saver with minimal graphics and motion. To access screen saver settings, select Start > Control Panel > Appearance and Themes icon > Display icon > Screen Saver tab.
- Follow the instructions on this CD in the *Software Guide*, “Power” chapter, to select a power scheme with low power-use settings.

## Storing a Battery Pack

If the tablet PC will be unused and unplugged for more than 1 month, remove and store the battery pack.



**CAUTION:** To prevent damage to a battery pack, do not expose it to high temperatures for extended periods of time.

---

High temperatures, which may be present in parked cars or some workplaces, accelerate the self-discharge rate of a stored battery pack. To prolong the charge of a stored battery pack, place it in a cool, dry place.

Use the following table to estimate how long you can safely store a battery pack. The storage times provided are based on a battery pack that contains 50 percent of a full charge. A fully charged battery pack can be safely stored for longer times; a battery pack containing a low charge can be safely stored for less time.

Calibrate a battery pack that has been stored for one month or more before using it.

At These Temperatures		You Can Safely Store a Battery Pack for This Amount of Time
Temperature Range °F	Temperature Range °C	Storage Time
115°–140°	46°–60°	Less than 1 month
79°–113°	26°–45°	No more than 3 months
32°–77°	0°–25°	1 year

---

## Disposing of a Used Battery Pack

---



**WARNING:** There is a risk of fire and chemical burn if a battery pack is handled improperly. Do not disassemble, crush, or puncture a battery pack or short the contacts on a battery pack. Do not expose a battery pack to temperatures higher than 60° C (140° F), or dispose of a battery pack in water or fire.

---

When a battery pack has reached the end of its useful life, do not dispose of it in general household waste.

- In North America, you can dispose of battery packs by using the Compaq battery recycling program. This program provides you with a postage-paid battery pack mailer preaddressed to a reclamation facility where the metals are recycled. For more information, call the telephone number listed for your location in the *Worldwide Telephone Numbers* booklet, included in English only with the tablet PC.
- In Europe, dispose of or recycle battery packs by using the public collection system or by returning them to Compaq, your authorized Compaq partners, or their agents.
- In other regions, refer to the *Worldwide Telephone Numbers* booklet, included in English only with the tablet PC, to contact a Compaq authorized dealer, reseller, or service provider and request information about battery pack disposal.

For more information about battery pack precautions and disposal and the complete text of governmental agency notices, refer on this CD to the *Regulatory and Safety Notices* guide.

## Finding More Power Information

For more information about using Standby and Hibernation, conserving power, setting power preferences, and using other power management features, refer on this CD to the *Software Guide*, “Power” chapter. For information about initiating Standby or Hibernation from the Q Menu, refer in the *Software Guide* to the “Q Menu and Desktop Profile Manager Utility” chapter.

## Adding a Drive to the System

Drives enable you to store and access data.

A standard removable drive can be added to the system by inserting the drive into the MultiBay of an optional External MultiBay or docking station. A USB drive can be added by connecting the drive to a USB connector on the tablet PC or on the docking station. Hard drive functions can also be added with a microdrive PC Card.

For information about connecting a USB drive, see the “External Device Connections” chapter. For information about PC Cards, see the “Hardware Upgrades” chapter. For general information about inserting and removing drives from an External MultiBay or docking station, refer to the documentation included with the device.

This chapter provides specific information about using drives in the tablet PC system.

The tablet PC hard drive bay supports only a 9.5-mm system hard drive. A MultiBay in an External MultiBay or docking station supports an additional 9.5-mm optional hard drive (inserted in a MultiBay Hard Drive Adapter) and the following 12.7-mm standard removable drives:

- CD-ROM drive
- CD-RW drive
- DVD-ROM drive
- DVD/CD-RW drive
- Diskette drive

# Understanding Drive Terms

## Terms for Types of Drives

A *hard drive* is usually used for the permanent storage of data files and of software such as system files, applications, and drivers. The hard drive in the hard drive bay is the *system* hard drive, sometimes called the *local disk*. The system hard drive can be replaced, but cannot be used in a MultiBay. A hard drive is sometimes called a *hard disk drive* or *HDD*.

*Diskette drives* are often used to store or transport data. The tablet PC can read or write to any MultiBay diskette drive. A diskette drive is sometimes called a *floppy disk drive*, *floppy drive*, or *FDD*.

*Optical drives* include CD and DVD drives. Optical drives are used to store or transport data and to play music and movies. DVD media have higher capacities than CD media. The tablet PC can read or write to optical drives as described in the following table.

Optical Drive	Read	Write
CD-ROM drive	Yes	No
CD-RW drive	Yes	Yes
DVD-ROM drive	Yes	No
DVD/CD-RW drive	Yes	Yes

## Terms for Drive Media

A *diskette* or *disc* that can be inserted or removed from a drive is referred to as a *drive medium*. In this guide a *diskette* is used in a diskette drive, and a *disc* is used in an optical drive.

---

## Caring for Drives

Drives are fragile system components that must be handled with care. Observe the following cautions when handling any drive.



**CAUTION:** To prevent damage to the tablet PC or a drive and loss of work:

- Do not remove the system hard drive except for repair or replacement. For instructions, see the “Maintenance, Shipping and Travel” chapter.
- Electrostatic discharge can damage electronic components. To prevent electrostatic damage to the tablet PC or a drive, follow these 2 precautions: (1) Discharge yourself from static electricity before handling a drive by touching a grounded metal object and (2) Avoid touching the connectors on a drive. For more information about preventing electrostatic damage, refer on this CD to the *Regulatory and Safety Notices* guide.
- Excessive force can damage drive connectors. When you insert a drive, use only enough force to seat the drive.
- Handle a drive carefully. Do not drop it.
- Avoid exposing a hard drive or a diskette to devices with magnetic fields. Products with magnetic fields include video and audio tape erasure products, monitors, and speakers. Security devices with magnetic fields include airport walk-through devices and security wands. The airport security devices that check carry-on luggage, usually while it is placed on a conveyor belt, use x-rays instead of magnetism and will not damage a hard drive or a diskette.
- Do not spray a drive with cleaners.
- Avoid exposing a drive to liquids or temperature extremes.
- If you mail a drive, ship it in packaging that protects it from shock, vibration, temperature, and humidity. Label the package “FRAGILE.”

---

## Inserting or Removing Drive Media

For general information about inserting or removing a drive from a MultiBay, refer to the documentation included with an optional External MultiBay or docking station. This section provides information that is not provided with optional drives or MultiBays and that may be helpful to users unfamiliar with standard removable drives.



## Inserting a CD or DVD

1. Be sure the tablet PC is turned on.
2. Press the media release button ❶ on the drive bezel to release the media tray, then pull the tray outward until it is fully extended ❷.
3. Position a CD or one-sided DVD over the tray label side up.
4. Gently press the disc onto the tray spindle ❸ until the disc snaps into place. Handle the disc by the edges, not the flat surfaces. (If the media tray is not fully extended, tilt the disc to position it over the tray spindle, then press it downward into position.)
5. Close the media tray ❹.

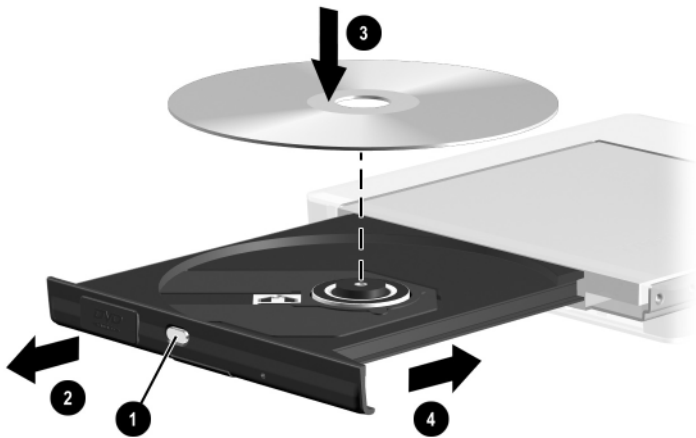

*Inserting a CD or DVD into an optical drive*

## Removing a CD or DVD (With Power)

If power is available:

1. Be sure the tablet PC is on.
2. Press the media release button ❶ on the drive bezel to release the media tray, then pull the tray outward until it is fully extended ❷.
3. Remove the disc from the tray ❸ by gently pushing down on the spindle while pulling up on the outer edges of the disc. If the media tray is not fully extended, tilt the disc as you remove it. Handle the disc by the edges, not the flat surfaces.
4. Close the media tray ❹.
5. Place the disc in a protective case.

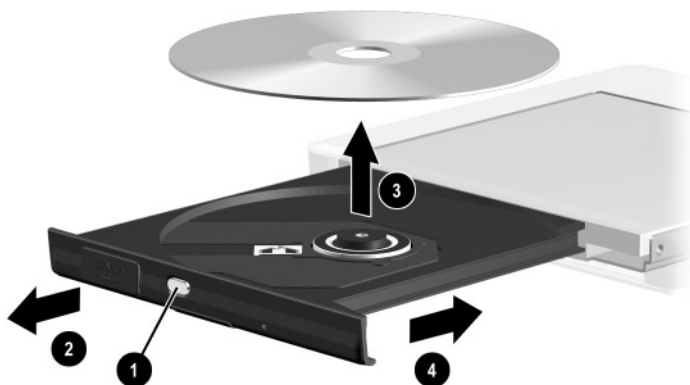

***Removing a CD or DVD from an optical drive when power is available***

## Removing a CD or DVD (Without Power)

 **CAUTION:** To prevent damage to the pen tip, do not insert the pen tip into the release access.

---

If the notebook is turned off or if no power is available, the media release button on the drive will not work. To remove a disc from an optical drive without using the media release button:

1. Insert the end of a small object like a paper clip into the release access **1** in the front bezel of the drive.
2. Press gently on the paper clip until the media tray is released, then pull the tray outward until it is fully extended **2**.
3. Remove the disc from the tray **3**. If the media tray is not fully extended, tilt the disc as you remove it. Handle the disc by the edges, not the flat surfaces.
4. Close the media tray **4**.
5. Place the disc in a protective case.

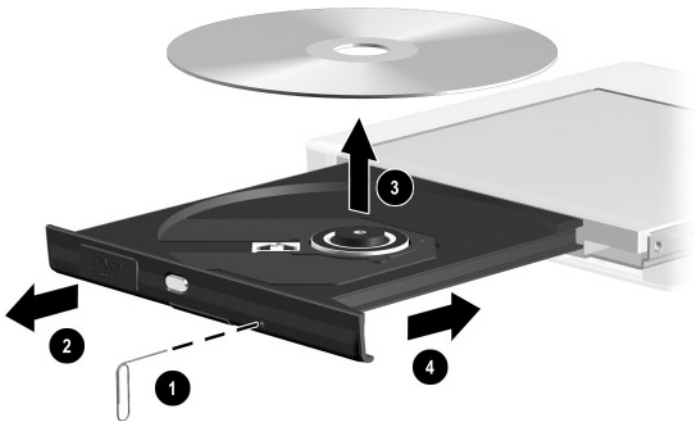

***Removing a CD or DVD from an optical drive when power is not available***

## Inserting a Diskette

To insert a diskette into a diskette drive, gently push the diskette, label side up, into the drive until it clicks into place.

The media eject button extends when the diskette is correctly inserted.

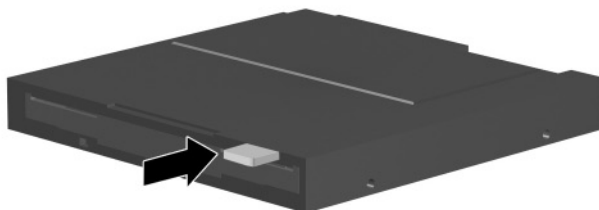

*Identifying the media eject button on a diskette drive*

## Removing a Diskette

To remove a diskette from a diskette drive:

1. Press the media eject button on the drive to eject the diskette.
2. Pull the diskette from the drive.
3. Place the diskette in a protective case.

## Using Drive Media

### Avoiding Standby and Hibernation



**CAUTION:** Initiating Standby or Hibernation while playing audio or video drive media may stop the play or diminish the quality of the play.

---

If Standby or Hibernation is accidentally initiated while a medium is in use, slide and release the power switch to resume from Standby or Hibernation, then restart the tablet PC.

You can also resume from Standby by pressing any key or activating the pointing device on an optional tablet PC keyboard or by activating an optional USB mouse.

For more information about Standby and Hibernation, refer on this CD to the *Software Guide*, “Power” chapter.

### Displaying Media Contents

When you insert a diskette, CD, or DVD into the system, the tablet PC can play the medium, display its contents, take no action, or display a response prompt on the screen. You can set the responses of the tablet PC to the insertion of various types of media by using the operating system AutoPlay feature.

### Setting AutoPlay Preferences

To set AutoPlay preferences:

1. Select Start > My Computer.
2. Right-click a drive.
3. Select Properties > AutoPlay tab, then follow the instructions on the screen.
4. To save your settings, select the OK button.

## Displaying Media Contents Without Using AutoPlay

To display the contents of a drive medium when the contents are not displayed by AutoPlay:

1. Insert the medium into the drive.
2. Select Start > Run, then type:  
explorer x:  
(where X = the drive designation of the drive containing the medium).
3. Select the OK button.



A drive designation is a letter of the alphabet that the tablet PC uses to identify the drive. To display the drive designation of every drive in the system, select Start > My Computer.

---

## Caring for Drive Media



**CAUTION:** To prevent damage to drive media:

- Do not open the metal shutter of a diskette or touch the disk within the diskette case.
  - Do not expose a diskette to a strong magnetic field, such as the security field used by a walk-through security device or a handheld security wand.
  - Clean a CD or DVD only with a disc cleaning kit. Disc cleaning kits are available from most electronics retailers.
-

## Finding More Drive Software Information

All the software you need to play the types of CDs and DVDs supported by the tablet PC is included with the tablet PC. For information about this software, refer on this CD to the *Software Guide*, “CD and DVD Software” chapter.

In addition, a feature in the Setup utility enables you to set the tablet PC to start from a specified medium or device. For instructions, refer on this CD to the *Software Guide*, “Boot Order” chapter.

## Adjusting Volume

Volume can be adjusted by using the Windows volume control icon, the Q Menu, or the volume adjustment available within some applications. Volume can be adjusted on the Q Menu without using a keyboard or the pen. For information about application volume features, refer to the application documentation.

## Using the Volume Control Icon

To display the Windows volume control icon in the system tray:

1. Select Start > Control Panel > Sounds, Speech, and Audio Devices icon > Sounds and Audio Devices icon.
2. Select the Volume tab.
3. Select the check box for Place Volume Icon In The Taskbar.
4. Select the OK button.
5. If the icon is not displayed, select in the system tray the icon for Show Hidden Icons.

To adjust, mute, or restore volume using the volume control icon, select the icon in the system tray. Then:

- To increase or decrease volume, select the slide bar, then drag it upward or downward.
- To mute or restore volume, select or clear the Mute check box.

To close the volume control pop-up window, click anywhere outside the window.



## Using the Q Menu

To adjust, mute, or restore volume using the Q Menu:

1. To open the Q Menu, press the Q menu button ❶.
  - ❑ To display the Windows volume control window, select the Volume tab.
  - ❑ To mute or restore system volume, select the Mute On/Off tab. (Selecting the On/Off tab mutes system volume if it is on or restores system volume if it is muted.)
2. To close the Q Menu, press the Q menu button, tap anywhere outside the Q Menu with the pen tip, or click an optional pointing device.

To select an item on the Q Menu without using a keyboard or the pen, press the Q menu button to open the Q Menu, rotate the jog dial ❷ upward or downward to scroll vertically through the items, then press the jog dial inward to select an item.

For more information about using the Q Menu, refer on this CD to the *Software Guide*, “Q Menu and Desktop Profile Manager Utility” chapter.

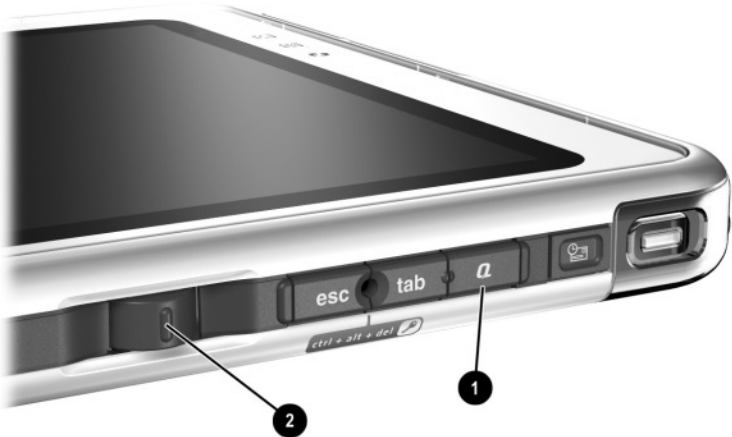

**Identifying the Q menu button and the jog dial**

## Using the Internal Speakers

The internal speakers play sound in stereo from applications, the operating system, games, drive media, the Internet, and other sources.

The internal speakers are disabled if:

- Optional powered speakers or a headphone is connected to the audio-out jack on the tablet PC or an optional docking station.
- An optional mobile telephone headset is connected to the headset jack.

Attaching an optional tablet PC keyboard to the tablet PC or connecting a line-in device, such as a clock radio or MP3 player, to the tablet PC or to an optional docking station does not affect the performance of the internal speakers.

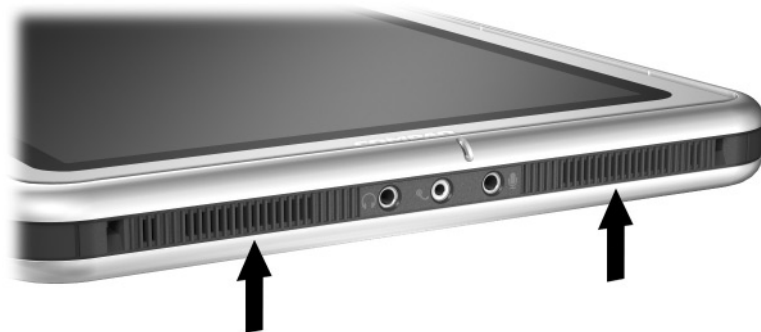

***Identifying the internal speakers***

## Using the Internal Microphone

The internal microphone:

- Has a standard sensitivity of -45 decibels.
- Can be used while a screen protector or an optional tablet PC keyboard is attached. A screen protector is provided with an optional docking station.
- Is disabled if:
  - An optional external microphone is connected to the microphone jack.
  - An optional headset is connected to the headset jack.

If you are using voice recognition or other software that requires optimal sound quality, Compaq recommends that you use an optional external microphone or headset. To access on-screen tutorials that include operating system speech features:

1. Open Windows Explorer. To open Windows Explorer from the Start button, select Start > All Programs > Accessories > Windows Explorer.
2. In Windows Explorer, select My Computer > Local Disk (C:) > WINDOWS > Help > latute.hta.



**Identifying the internal microphone**

## Connecting an Audio Device

### Identifying Audio Jacks

The tablet PC has 3 audio jacks:

- The audio-out jack ❶ connects stereo headphones or powered stereo speakers.
- The headset jack ❷ can support a headset, such as a mobile telephone headset with a microphone and a monaural ear piece.
- The microphone jack ❸ supports a monaural external microphone.



*Identifying the audio jacks*

## Using the Audio-Out Jack



**WARNING:** To reduce the risk of personal injury, adjust the volume before putting on headphones.

---



**CAUTION:** To prevent possible damage to an external device, do not plug a monaural plug into the audio-out jack.

---

When connecting a device to the audio-out jack:

- Use only a 3.5-mm stereo plug.
- For best sound quality, use 24-ohm to 32-ohm headphones.

When optional powered speakers or a headphone is connected to the audio-out jack on the tablet PC or an optional docking station, the internal speakers are disabled.

## Using the Headset Jack

The headset jack can support a headset, such as a mobile telephone headset, that has a microphone, a monaural ear piece, and a 2.5-mm plug.

When a headset is connected to the headset jack, the internal microphone and speakers are disabled.

## Using the Microphone Jack

The microphone jack supports a monaural microphone with a 3.5-mm plug.

A monaural electret condenser microphone is recommended. If you connect a stereo microphone, left channel sound will record on both channels.

When an optional headset or external microphone is connected to the tablet PC, the internal microphone is disabled.

## **Finding Audio and Video Software Information**

For information about using audio and video software, refer on this CD to the *Software Guide*, “CD and DVD Software” chapter.

---

## Internal Modem

The tablet PC has an RJ-11 telephone jack and preinstalled modem drivers.

A modem cable with RJ-11 connectors at each end is included with models that ship with an internal modem. If you purchased the tablet PC in a country where RJ-11 telephone jacks are not standard, a country-specific modem adapter is also included.

The internal modem supports:

- All applications supported by the operating system.
- V.34 ITU (International Telecommunications Union) analog modem recommendations for speeds up to 33.6 Kbps.
- V.44 data compression algorithm.
- V.90/V.92 ITU digital/analog modem pair recommendations for speeds up to 56 Kbps.

The digital/analog modem pair rates allow faster downloads only from compliant digital sources. Maximum achievable download rates are currently unknown, may not reach 56 Kbps, and will vary with line conditions. Maximum achievable upload rates are limited to 48 Kbps, may not reach 48 Kbps, and will vary with line conditions.

# Connecting the Modem

## Selecting Connectors

The modem must be connected to an analog telephone line.



**WARNING:** To reduce the risk of electric shock, fire, or damage to the equipment, do not plug a telephone cable into the RJ-45 network jack.

---



**CAUTION:** Jacks for digital PBX systems may resemble RJ-11 telephone jacks, but are not compatible with the modem.

---

Jacks for analog telephone lines and procedures for connecting the modem vary by country:

- If you are connecting the modem in a country where RJ-11 telephone jacks are standard, follow the instructions in “Connecting the Modem to an RJ-11 Jack,” next in this chapter.
- If you are connecting the modem in a country where RJ-11 telephone jacks are not standard, a modem adapter specific to the country in which you purchased the tablet PC is included with the tablet PC. Follow the instructions in “Connecting the Modem with an Adapter,” later in this chapter.
- If you plan to use the modem outside the country in which you purchased the tablet PC, you can purchase adapters specific for the countries on your itinerary from most computer or electronics retailers. For information about using country-specific software configurations, see “Setting Country Preferences,” later in this chapter.



## Connecting the Modem to an RJ-11 Jack

To connect the modem to an analog telephone line that has an RJ-11 telephone jack:

1. To access the RJ-11 jack ❶ on the tablet PC, open the upper panel of the tablet PC.
2. If the modem cable has noise suppression circuitry ❷, which prevents interference with TV and radio reception, orient the circuitry end of the cable toward the tablet PC.
3. Plug the cable into the RJ-11 telephone jack ❸ (not the RJ-45 network jack) on the tablet PC.
4. Plug the modem cable into an RJ-11 telephone jack ❹ (not into an RJ-45 network jack or a PBX jack).

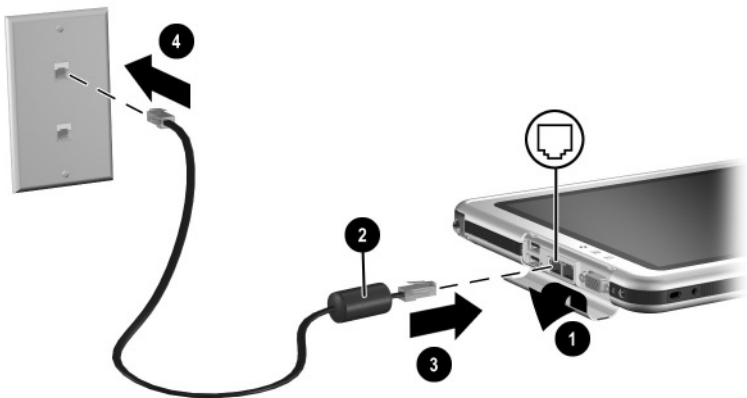

**Connecting the modem to an RJ-11 telephone wall jack (Telephone wall jacks vary in appearance by region.)**



**WARNING:** To reduce the risk of electric shock, disconnect the modem from the telephone network before accessing an internal compartment of the tablet PC. Internal compartments include the memory and Mini PCI compartment and the hard drive bay.

## Connecting the Modem with an Adapter

To connect the modem to an analog telephone line that does not have an RJ-11 telephone jack:

1. To access the RJ-11 jack ❶, open the upper panel of the tablet PC.
2. If the modem cable has noise suppression circuitry ❷, which prevents interference with TV and radio reception, orient the circuitry end of the cable toward the tablet PC.
3. Plug the modem cable into the RJ-11 telephone jack ❸ (not the RJ-45 network jack) on the tablet PC.
4. Plug the country-specific modem adapter ❹ into the telephone jack.
5. Plug the modem cable ❺ into the country-specific modem adapter.

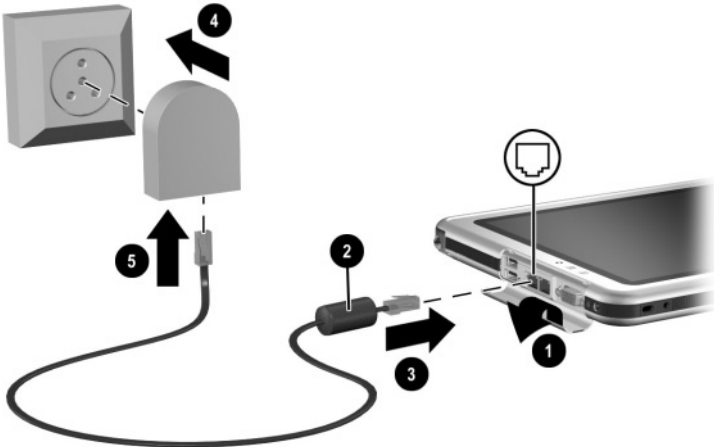

**Connecting the modem with a modem adapter  
(Telephone wall jacks vary in appearance by region.)**



**WARNING:** To reduce the risk of electric shock, disconnect the modem from the telephone network before accessing an internal compartment of the tablet PC. Internal compartments include the memory and Mini PCI compartment and the hard drive bay.

---

## Setting Country Preferences

The internal modem is configured to function in and meet the operating standards of the country in which you purchased the tablet PC. To use the internal modem in other countries, you must add country-specific modem configurations.

## Displaying the Current Country Configuration

To display the current country configuration, select Start > Control Panel > Date, Time, Language, and Regional Options category > Regional and Language Options icon > Regional Options tab. The current country configuration of the modem is displayed in the Location panel.

## Adding a Country Configuration



**CAUTION:** To prevent loss of your current country configuration, do not delete or replace your current country configuration. Additional country configurations can be added without deleting the current configuration.

---



**CAUTION:** To prevent modem malfunction and violation of telecommunications regulations and laws, use the modem only with the country configuration for the country in which you are using the modem.

---

To add a country configuration:

1. Select Start > Control Panel > Network and Internet Connections category.
2. From the See Also menu in the left column of the window, select Phone and Modem Options > Dialing Rules tab.
3. Select the New button, then type a name for the new location in the Location Name field.
4. Select a country or region for the new location from the Country/Region list.

If you select a country or region that is not supported by the modem, the country configuration defaults to USA or UK.

5. Select the OK button > OK button.

## **Solving Travel Connection Problems**

If you experience connection problems while using the modem outside the country in which you purchased the tablet PC, the following suggestions may be helpful.

Before changing any settings, you may want to write down your current settings so you can quickly replace those settings when you return home.

### **Check the Line**

The modem requires an analog, not a digital, telephone line. A line described as a PBX line is usually a digital line. A telephone line described as a data line, fax machine line, modem line, or standard telephone line is probably an analog line.

### **Check the Dialing Mode**

Dial a few digits on the telephone, then listen for clicks or tones. Clicks indicate that the telephone line supports pulse dialing; tones indicate that the telephone line supports tone dialing. To set the internal modem to support either pulse or tone dialing:

1. Select Start > Control Panel > Network and Internet Connections category.
2. From the See Also menu in the left column of the window, select Phone and Modem Options > Dialing Rules tab.
3. Select your location, then select the Edit button.
4. Select the Tone or Pulse radio button.
5. Select the OK button > OK button.

## Check the Telephone Number

Dial the telephone number on the telephone, verify that the remote modem is answering, then hang up.

## Check the Dial Tone

If the modem receives a dial tone it does not recognize, it will not dial and will display a No Dial Tone error message.

- To set the modem to ignore all dial tones before dialing:
  1. Select Start > Control Panel > Network and Internet Connections category.
  2. From the See Also menu in the left column of the window, select Phone and Modem Options > Modems tab.
  3. Select your modem > Properties button > Modem tab.
  4. Clear the Wait For Dial Tone Before Dialing check box.
  5. Select the OK button > OK button.
- If you continue to receive the No Dial Tone error message after clearing the check box:
  1. Select Start > Control Panel > Network and Internet Connections category.
  2. From the See Also menu in the left column of the Network and Internet Connections window, select Phone and Modem Options > Dialing Rules tab.
  3. Select your location, then select the Edit button.
  4. Select your location from the Country/Region list.

If you select a country or region that is not supported by the modem, the country configuration defaults to USA or UK.
  5. Select the OK button.

6. In the Phone and Modem Options window, select the Modems tab.
7. Select your modem > Properties button > Modem tab.
8. Clear the Wait For Dial Tone Before Dialing check box.
9. Select the OK button > OK button.

## Accessing Communication Software

To access preinstalled modem software, including software for terminal emulation and data transfer, select Start > All Programs > Accessories > Communications, then select an application, wizard, or utility.

## Finding AT Command Information

It is not necessary to use AT commands with most modem software. If you prefer to use AT commands, refer on this CD to:

- *Modem Commands Guidelines* for information about accessing Hyperterminal, identifying the modem in your tablet PC, and using AT commands.
- The *Lucent/Agere Command Set* guide for the AT commands supported by your modem. This guide is provided in English only.

---

## Network Connections

The tablet PC has an RJ-45 network jack. Network tablet PC models also have an internal NIC (network interface card), preinstalled network drivers, and a network cable.

The tablet PC can be connected to a network whether or not the internal modem is connected to a telephone line.

If your tablet PC is connected to a network, you may want to confer with your network administrator before changing network settings.

The tablet PC supports:

- Network speeds up to 10 Mbps when connected to a 10BaseT network and 100 Mbps when connected to a 100BaseTX network.
- 56bitDES or 3DES or “null” encryption with MD5 or SHA-1 integrity.
- IPSec Authentication Header (AH) transform algorithms MD5 and SHA-1.

## Connecting the Network Cable

A network cable has an 8-pin RJ-45 network connector at each end and may contain noise suppression circuitry, which prevents interference with TV and radio reception.

1. To access the tablet PC RJ-45 network jack ❶, open the upper panel of the tablet PC.
2. Orient the end of a network cable with noise suppression circuitry ❷ toward the tablet PC.
3. Plug the network cable into the tablet PC RJ-45 network jack ❸.
4. Plug the other end of the cable into the network RJ-45 jack ❹.

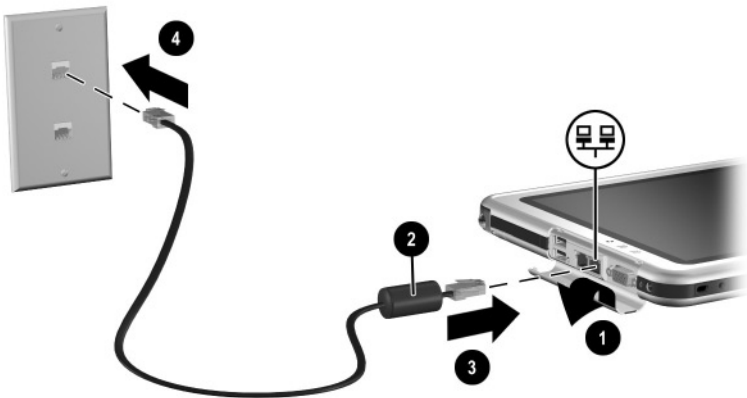

### Connecting a network cable

---



**WARNING:** To reduce the risk of electric shock, disconnect the network cable before accessing an internal compartment of the tablet PC. Internal compartments include the memory and Mini PCI compartment and the hard drive bay.

---



## Turning a Network Connection Off and On

To conserve power, turn off a network connection you are not using.

- To turn off a network connection, log off the network, then disconnect the network cable.
- To turn on a network connection, connect the network cable, then log on to the network.

## Using the LAN Connection Lights

The 2 LAN connection lights indicate the status of a network connection:

- Both lights off: The tablet PC is not connected to a LAN.
- Both lights on: The tablet PC is connected to a LAN with a 100 Mbps link.
- Green light on and yellow light off: The tablet PC is connected to a LAN with a 10 Mbps link.
- Green light flashing: Information is transmitting through the LAN.

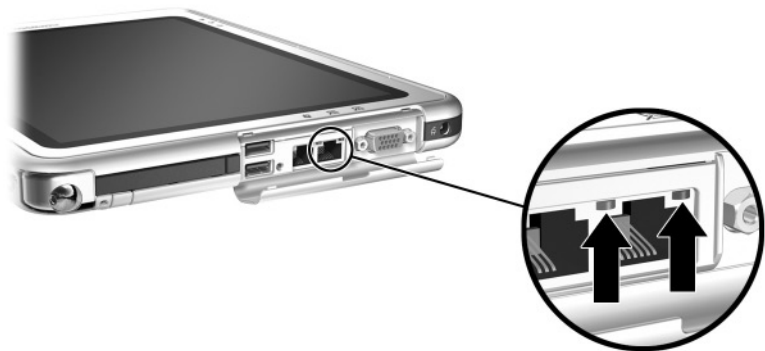

***Identifying the LAN connection lights***

## Accessing the Network at Startup

To connect to a PXE (Preboot eXecution Environment) or RPL (Remote Program Load) server during startup, you must respond to the Network Service Boot prompt each time you want to connect to the server as the tablet PC starts or restarts.

To set the tablet PC to display the Network Service Boot prompt each time it is started or restarted, you must enable the internal NIC for startup.

## Enabling a NIC for Startup

An internal NIC is enabled for startup in the Setup utility.

1. To open the Setup utility, turn on or restart the tablet PC. While the Compaq logo is displayed and a cursor is flashing in the upper right corner of the screen, press the esc button on the tablet PC or press **F10** on an optional keyboard.

To change the language, select **Advanced > Languages**. To navigate and select without using an optional keyboard, rotate the jog dial to scroll and press the jog dial inward to select. To navigate and select using an optional keyboard, use the arrow and **enter** keys.

2. Select **Advanced menu > I/O Device Configuration**, then enable **PXE/Remote Boot**.
3. To save your preference and exit the Setup utility, select **File > Save Changes and Exit**, then follow the instructions on the screen.

Your preference is set as you exit the Setup utility and is in effect when the tablet PC restarts.

## Responding to a Network Service Boot Prompt

After the internal NIC has been enabled for startup, the Network Service Boot prompt is displayed very briefly in the lower right corner of the screen each time the tablet PC is started or restarted.

To connect to a network by responding to the prompt, use either of the following procedures:

- Press the tab button on the tablet PC.
- Press **F12** on an optional keyboard. To press F12 on the tablet PC keyboard, press **Fn+F11/F12**.

## Finding Wireless LAN Information

The tablet PC supports wireless LAN provided through a Mini PCI board, a PC Card, or a CompactFlash card. A wireless LAN PC Card or CompactFlash card is optional. A wireless Mini PCI board may be preinstalled or purchased as an option.

Information about using a preinstalled wireless LAN board is provided on this CD in the *Compaq WLAN Mini PCI User Guide*. If you purchase a wireless device as an option, documentation about the device is included with the option.

---

# External Device Connections

## Standard Device

The jacks and connectors described in this guide support standard external devices.

- For information about which jack or connector to use, refer to the documentation included with the device.
- For information about installing or loading any software required by the device, refer to the device documentation, the operating system Help files, or the device manufacturer's Web site.

To connect a standard external device to the tablet PC:

1. If you are connecting a powered device, be sure the device is turned off.
2. Connect the device to a jack or connector on the tablet PC.
3. If you are connecting a powered device, plug the device power cord into a grounded electrical outlet.
4. Turn on the device.



---

If a properly connected display device does not display an image, try pressing the Q menu button > Internal and External item or External Only item to switch the image to the new device. If the tablet PC is docked, also refer on this CD to the *Software Guide*, “Q Menu and Desktop Profile Manager Utility” chapter, “Desktop Profile Manager Utility” section.

---

To disconnect a standard external device from the tablet PC, turn off the device (if it is powered), then disconnect the device from the tablet PC.

## USB Device

USB is a hardware interface that can be used to connect external devices such as a USB keyboard, mouse, drive, printer, scanner, or hub to the tablet PC or an optional docking station.

A USB device functions in the system in the same way as a comparable non-USB device. The USB connectors support USB 2.0- or 1.1-compliant devices.

A USB hub is a connecting device that can be powered or unpowered. USB hubs can be connected to a USB connector on the tablet PC or on an optional docking station or to other USB devices. Hubs support varying numbers of USB devices and are used to increase the number of USB devices in the system.

- Powered hubs must be connected to external power.
- Unpowered hubs must be connected either to a USB connector on the tablet PC or to a port on a powered hub.

Some USB devices may require additional support software, which is usually included with the device. For software information about a specific device, refer to the documentation included with the device.

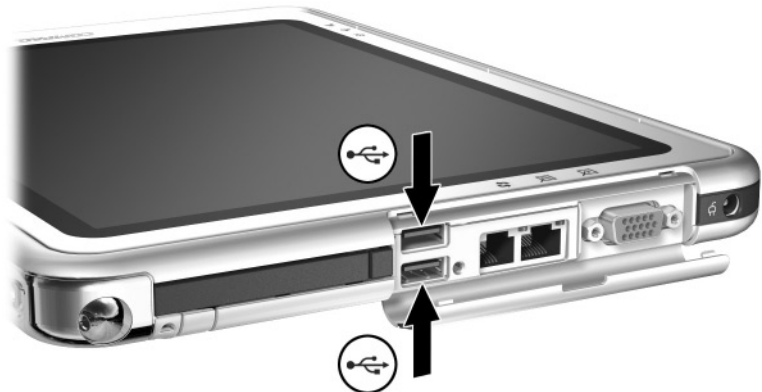

***Identifying the 2 USB connectors on the tablet PC***

## Tablet PC Keyboard

An optional tablet PC keyboard, which includes a numeric keypad, can be used with the tablet PC and with the tablet PC and an optional docking station.

For information about using the tablet PC keyboard pointing device, keypad, and **F11/F12** key, see the “Pen, Command Controls and Keyboards” chapter, “Tablet PC Keyboard” section.

The tablet PC can be attached or detached from the keyboard while it is on, off, in Standby, or in Hibernation.

## Attaching the Tablet PC to the Keyboard

To attach the tablet PC to the keyboard:

1. Place the keyboard on a flat surface with the keyboard keys facing you.
2. Rotate the attachment features on the rotation disk toward the keyboard.

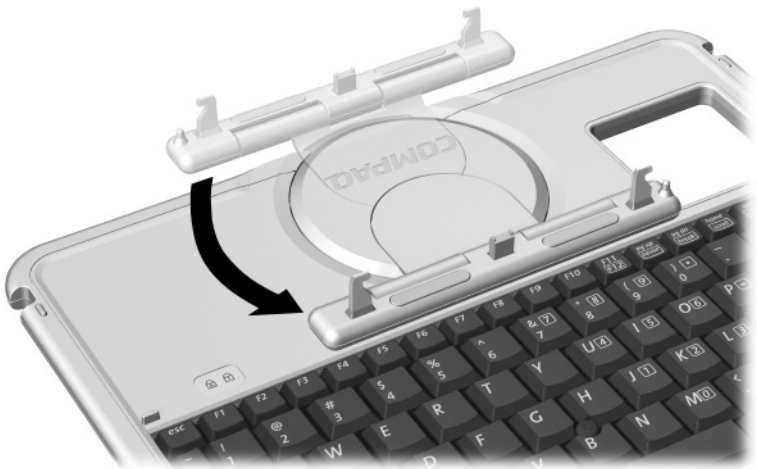

***Rotating the attachment features toward the keyboard***

3. Position the tablet PC horizontally above the keyboard, with the front of the tablet PC facing the keyboard.



***Positioning the tablet PC above the keyboard***

4. Align the 4 slots on the tablet PC with the keyboard connector, alignment key, and 2 keyboard hooks on the keyboard ❶, then press the tablet PC downward until it snaps into place ❷.

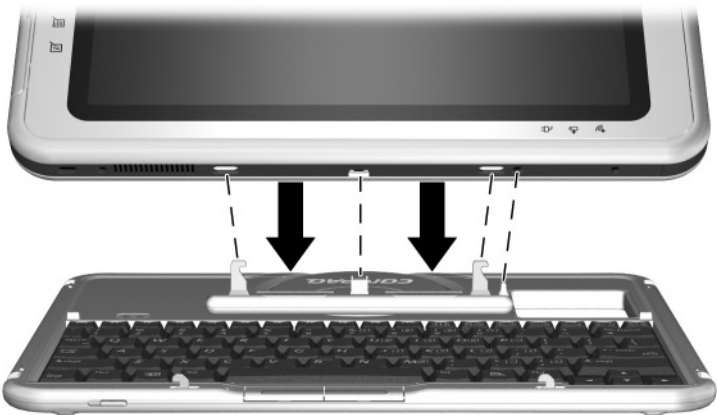

***Attaching the keyboard to the tablet PC***

## Adjusting the Tablet PC and Keyboard

To tilt the tablet PC screen to a comfortable viewing angle, push gently on the top of the tablet PC.

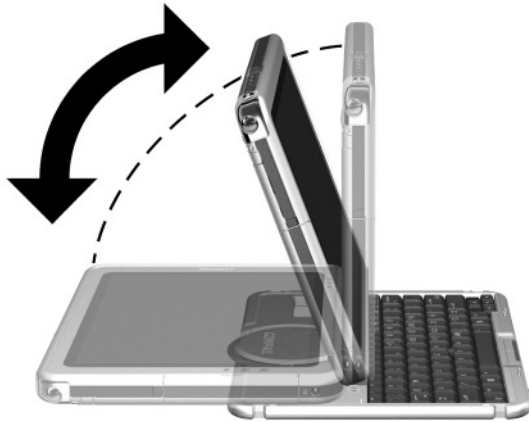

*Tilting the tablet PC on the keyboard*



## Closing the Tablet PC and Keyboard

To close the tablet PC and keyboard as you would close the display on a standard notebook:

1. Rotate the tablet PC clockwise until it snaps into place facing away from the keyboard.



***Rotating the tablet PC toward the back of the keyboard***

2. Tilt the tablet PC downward onto the keyboard.



***Closing the tablet PC and keyboard***

## Transporting the Tablet PC and Keyboard

If you are transporting the tablet PC and keyboard while they are not attached, be sure the rotation disk is in the default position. (The attachment features are at the rear of the tablet PC and the Compaq logo is right side up when you are facing the keyboard.)

If you are transporting the tablet PC and keyboard while they are attached, you may want to use the keyboard latch. The keyboard latch locks the tablet PC to the keyboard while the tablet PC and keyboard are closed.

- To lock the tablet PC to the keyboard while the tablet PC is closed, slide the keyboard latch to the right ❶.
- To release the tablet PC from the closed position, push the keyboard latch to the left, then slide and hold the latch toward the left as you open the tablet PC ❷.

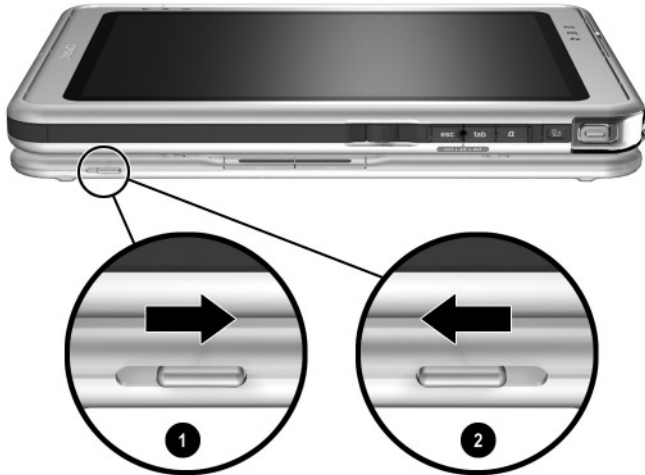

**Using the keyboard latch**

## Detaching the Tablet PC from the Keyboard

To detach the tablet PC from the keyboard:

1. If the tablet PC is closed, open the tablet PC, then rotate the tablet PC so the screen is facing the keyboard in the notebook position.

If the tablet PC does not open easily from the keyboard, it may be secured to the keyboard with the keyboard latch. For release instructions, see “Transporting the Tablet PC and Keyboard,” earlier in this chapter.

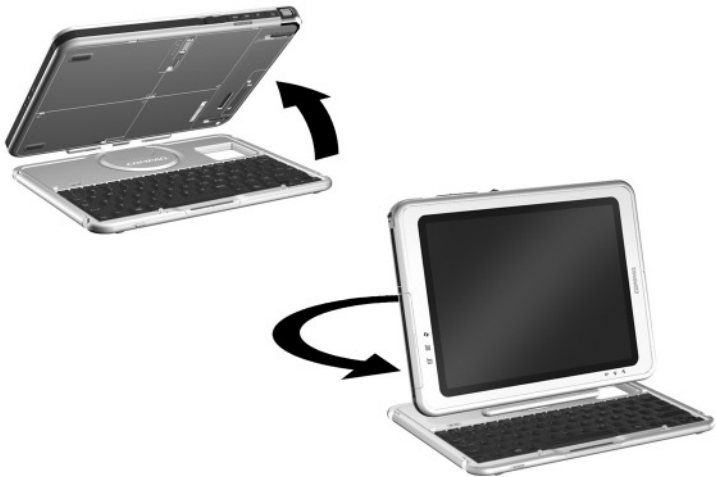

***Opening the tablet PC to the notebook position***

2. Rotate the tablet PC and keyboard so the back of the tablet PC and the keyboard are facing you.



***Positioning the tablet PC and keyboard to detach the tablet PC***

3. To detach the keyboard, slide and hold the attachment release switch ❶ on the tablet PC as you lift the tablet PC away from the keyboard ❷.

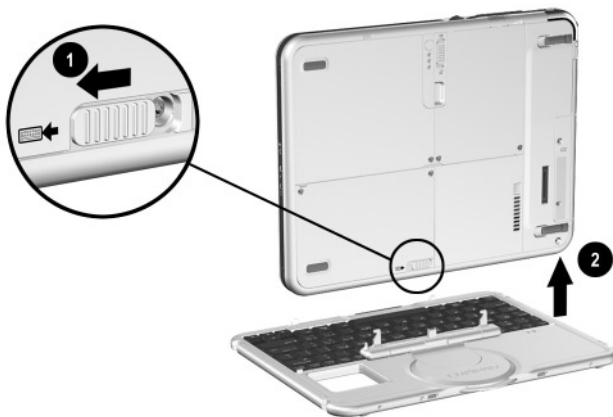

***Detaching the tablet PC from the tablet PC keyboard***

## Cable Lock

Loop the cable around a secure object, then insert the security cable lock ❶ into the security cable slot ❷ and lock it with the cable lock key ❸.

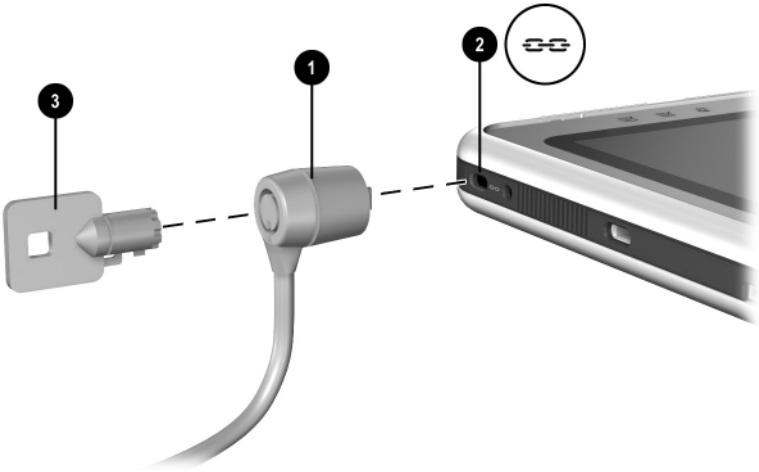

***Connecting an optional cable lock***

---

## Hardware Upgrades

### Obtaining Upgrades

To order or learn more about optional hardware upgrades and accessories, visit the Compaq Web site at <http://www.compaq.com>. The hardware upgrade area is English-only. Or, refer to the *Worldwide Telephone Numbers* booklet, included in English only with the tablet PC, to contact a Compaq authorized dealer, reseller, or service provider.

For information about obtaining and installing software updates and upgrades, refer on this CD to the *Software Guide*.

### Using a PC Card

A PC Card is a credit card–sized accessory designed to conform to the standard specifications of the Personal Computer Memory Card International Association (PCMCIA). The tablet PC supports both 32-bit CardBus and 16-bit PC Cards.

A PC Card can be used to add modem, sound card, memory, storage, wireless communication, or digital camera functions to the tablet PC. A PC Smart Card Reader or a biometric identification PC Card can add security.

### Selecting a PC Card

A Type I or Type II PC Card can be used. A Type III PC Card will not fit into the PC Card slot of the tablet PC. (Type I, II, and III PC Cards vary by thickness, with Type III being the thickest.)

Zoomed video cards are not supported.

## Configuring a PC Card

 **CAUTION:** If you install all of the software or any of the enablers provided by a PC Card manufacturer, you may not be able to use other PC Cards. If you are instructed by the documentation included with a PC Card to install device drivers:

- Install only the device drivers for the Microsoft Windows XP Tablet PC Edition operating system.
  - Do not install other software, such as card services, socket services, or enablers, that may also be supplied by the PC Card manufacturer.
- 

## Inserting a PC Card

 **CAUTION:** To prevent damage to the PC Card connectors, use minimal force when inserting a PC Card into the PC Card slot.

---

1. Hold the PC Card label-side up with the connector facing the tablet PC.
2. Gently push the card into the PC Card slot until the card is seated.

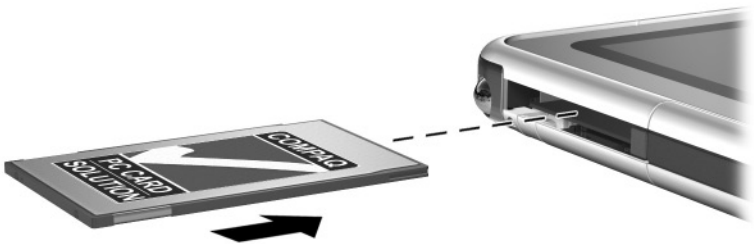

***Inserting a PC Card***

## Stopping and Removing a PC Card

 **CAUTION:** To prevent loss of work or an unresponsive system, stop a PC Card before removing it.



An inserted PC Card uses power even when it is not in use. To conserve power, stop a PC Card when you are not using it.

1. Close all applications and complete all activities that are supported by the PC Card.
2. To stop a PC Card, select the Safely Remove Hardware icon in the system tray, then follow the instructions on the screen. (To display the Safely Remove Hardware icon, select in the system tray the icon for Show Hidden Icons.)
3. To release the PC Card, press the PC Card eject button ❶.
4. Gently pull out the PC Card ❷.

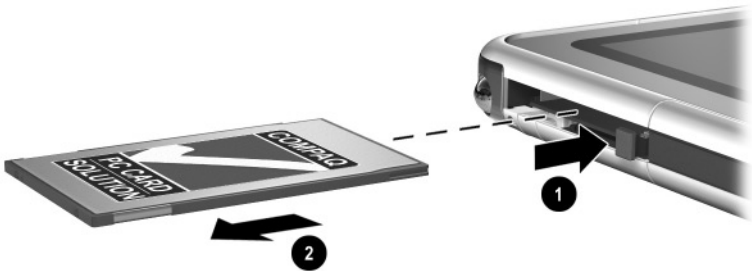

**Removing a PC Card**



## Using a CompactFlash Card

A CompactFlash card is smaller than a PC Card, but can add similar functions to the tablet PC system. Most commonly, a CompactFlash card is used to add backup, storage, wireless network, fax/modem, or cellular telephone functions.

When using a CompactFlash card, Compaq recommends that you connect the system to external power whenever possible. Some CompactFlash cards use large amounts of power and can quickly drain a battery pack.



**CAUTION:** To prevent loss of work or damage to a CompactFlash card:

- Do not save your work to a CompactFlash card unless the tablet PC is connected to external power or you are certain that the battery pack has enough charge remaining to complete the operation.
  - Do not shut down the tablet PC or remove the CompactFlash card until all activities supported by the card are complete.
- 

## Selecting a CompactFlash Card

The tablet PC supports both Type I and Type II CompactFlash cards.

## Configuring a CompactFlash Card

If a CompactFlash card manufacturer instructs you to install card-specific drivers, be sure to install only the drivers supported by the Windows XP Tablet PC Edition operating system. If you are unsure of driver compatibility, contact the CompactFlash card manufacturer.

## Inserting a CompactFlash Card

 **CAUTION:** To prevent damage to the CompactFlash card connectors, use minimal force when inserting a CompactFlash card into the CompactFlash card slot.

---

1. Hold the CompactFlash card label-side up with the connector facing the tablet PC.
2. Gently push the card into the CompactFlash card slot until the card is seated.

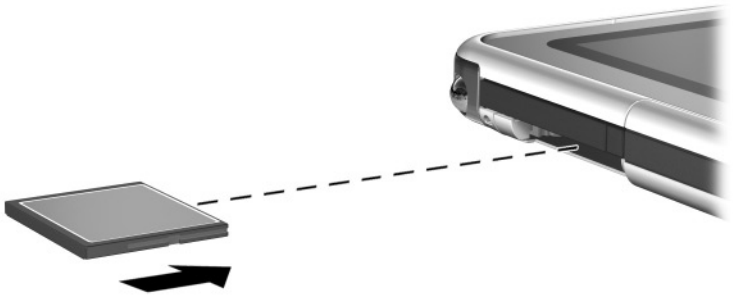

***Inserting a CompactFlash Card***

## Stopping and Removing a CompactFlash Card



**CAUTION:** To prevent loss of work or an unresponsive system, stop a CompactFlash card before removing it.

---



An inserted CompactFlash card uses power even when it is not in use. To conserve power, stop a CompactFlash card when you are not using it.

---

1. Close all applications and complete all activities that are supported by the CompactFlash card.
2. To stop a CompactFlash Card, select the Safely Remove Hardware icon in the system tray, then follow the instructions on the screen. (To display the Safely Remove Hardware icon, select in the system tray the icon for Show Hidden Icons.)
3. To release the CompactFlash card, press the CompactFlash card eject button ❶.
4. Gently pull out the CompactFlash card ❷.

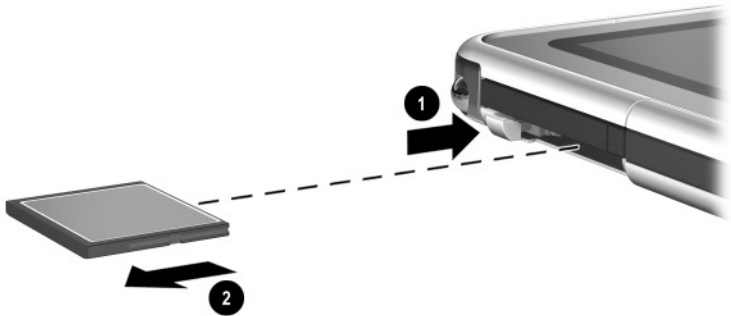

**Removing a CompactFlash card**

## Increasing Memory

You can increase the amount of RAM (random access memory) in the tablet PC with an optional PC Card or with an optional memory module.

The tablet PC has one user-accessible memory slot. The slot supports a PC133-compliant 128-megabyte, 256-megabyte, or 512-megabyte memory module.

## Displaying Memory Information

When the amount of RAM in the system increases, the operating system increases the hard drive space reserved for the hibernation file.

If you experience problems with Hibernation after increasing RAM, verify that your hard drive has enough free space for the larger hibernation file.

- To display the amount of RAM in the system:

Select Start > Control Panel > Performance and Maintenance icon > System icon > General tab.

- To display both the amount of free space on your hard drive and the amount of space required by the hibernation file:

Select Start > Control Panel > Performance and Maintenance icon > Power Options icon > Hibernate tab.

## Removing or Inserting a Memory Module



**WARNING:** To prevent exposure to electric shock, work only in the memory and Mini PCI compartment during this procedure. The hard drive bay and the memory and Mini PCI compartment are the only user-accessible internal compartments on the tablet PC. All other areas that require a tool to access should be opened only by a Compaq authorized service provider.

---



**WARNING:** To prevent exposure to electric shock and damage to the tablet PC, shut down the tablet PC, unplug the power cord, and remove the battery pack before installing a memory module.

---



**CAUTION:** To prevent electrostatic discharge from damaging electronic components: Discharge static electricity from yourself by touching a grounded metal object before beginning this procedure. For more information about preventing electrostatic damage, refer on this CD to the *Regulatory and Safety Notices* guide.

---

1. Be sure that you have followed the instructions in the preceding warnings and caution.

If you are not sure whether the tablet PC is off or in Hibernation, slide and release the power switch. If your work returns to the screen, save your work, exit all applications, then shut down the tablet PC.

2. Disconnect all external devices connected to the tablet PC.
3. Disconnect the power cord.
4. Remove the battery pack.
5. If an optional tablet PC keyboard is attached to the tablet PC, detach the keyboard.

6. Turn the tablet PC front side down.
7. Remove the 2 memory and Mini PCI compartment retaining screws ❶.
8. Slide, lift, then remove the memory and Mini PCI compartment cover ❷.

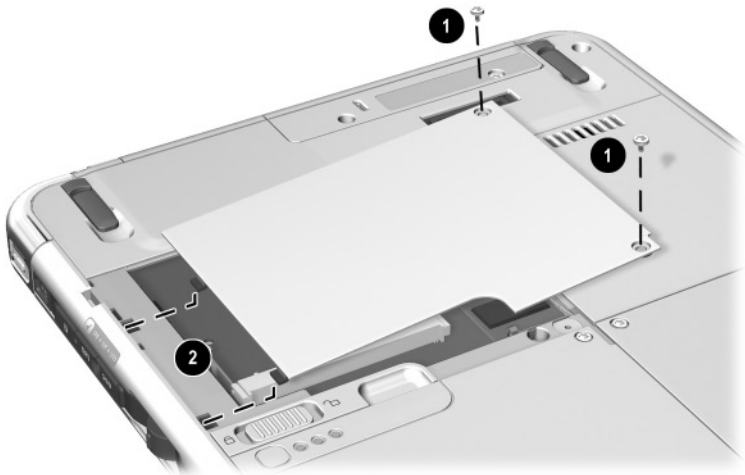

***Opening the memory compartment***

9. Remove or insert the memory module.

To remove a memory module:

- a. Pull away the retention clips on each side of the memory module ❶. (The memory module tilts upward.)
- b. Grasp the edges of the memory module, then gently pull it out of the memory slot ❷.
- c. To protect a removed memory module, place it in an electrostatic-safe container.

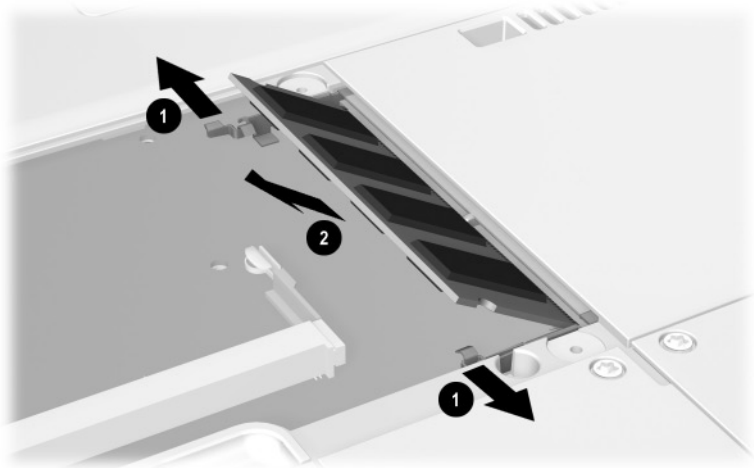

***Removing a memory module***

To insert a memory module:

- a. Align the keyed (notched) edge of the memory module with the keyed area in the memory slot ❶.
- b. Press the memory module into the slot from a 45-degree angle until it is seated ❷.
- c. Push the memory module downward until the retention clips snap into place ❸.

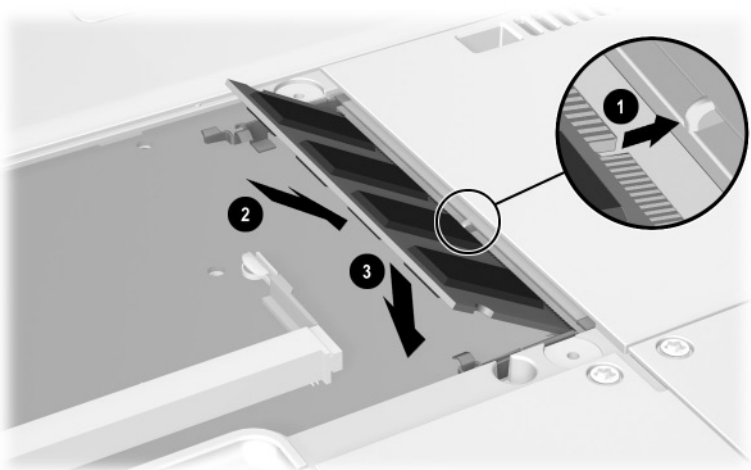

***Inserting a memory module***



10. Align the tabs on the memory compartment cover with the cover slots on the tablet PC ❶, then press downward on the cover until it is seated.
11. Reinsert the 2 retaining screws that secure the memory and Mini PCI compartment cover to the tablet PC ❷.

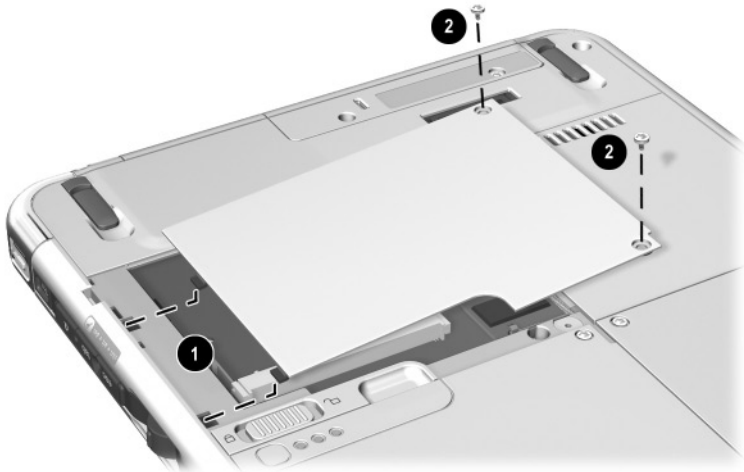

***Replacing the memory compartment cover***

## **Finding Mini PCI Information**

Information about using a preinstalled wireless LAN Mini PCI board is provided on this CD in the *Compaq WLAN Mini PCI User Guide*. If you purchase a different Mini PCI device as an option, documentation about the device is included with the option.

---

# Maintenance, Shipping and Travel

## Maintaining Software

Compaq recommends that you:

- Install all software updates as they become available. For instructions, refer on this CD to the *Software Guide*, “Software Updates and Restorations” chapter.
- Install and use virus protection software. Antivirus software can be purchased from most computer or electronics retailers.
- Back up your work and system software frequently.
  - For information about using the operating system backup utility, select Start > Help and Support > Performance and Maintenance topic. In the upper left pane of the Performance and Maintenance window, select the Backing Up Your Data check box.
  - For information about selecting optional backup software or hardware, consult with your authorized Compaq dealer, reseller, or service provider.

## Protecting Hardware

To protect and prolong the performance of your hardware, observe the following cautions.



---

**CAUTION:** To prevent damage to your hardware or loss of work:

- Carry and store the tablet PC in the portfolio or an optional Deluxe Portfolio.
  - Do not place anything on top of the tablet PC, even when it is in a portfolio.
  - Use the tablet PC only on solid surfaces and in open areas. Do not allow a hard surface, such as an adjoining optional printer, or a soft surface, such as carpet, clothing, or bedding, to block the vent.
  - Protect the tablet PC from liquids and excessive moisture.
  - Do not expose the tablet PC to direct sunlight, extreme temperatures, or ultraviolet light for extended periods of time.
  - Keep all hard drives and diskettes away from magnetic fields. Magnetic fields can corrupt data stored on hard drives and diskettes.
  - If the tablet PC will be unused for one week or more, shut it down.
  - If the tablet PC will be disconnected from external power for more than one month, shut down the tablet PC and remove the battery pack. For information about storing the battery pack, see the “Battery Packs” chapter.
- 

## Using Portfolios

To protect the tablet PC screen, Compaq recommends that you use or transport the tablet PC with a portfolio attached. A slim portfolio that protects the tablet PC or the tablet PC attached to an optional keyboard is included with the tablet PC.

An optional leather Deluxe Portfolio that provides additional protection, has slots for business cards, and accommodates additional items is available in most regions.

To obtain the Deluxe Portfolio, refer to the *Worldwide Telephone Numbers* booklet included in English only with the tablet PC to contact your authorized Compaq dealer, reseller, or service provider.

## Attaching a Portfolio

When you are using only the tablet PC, press the 2 tabs on the portfolio into the 2 universal attachment slots on the tablet PC.

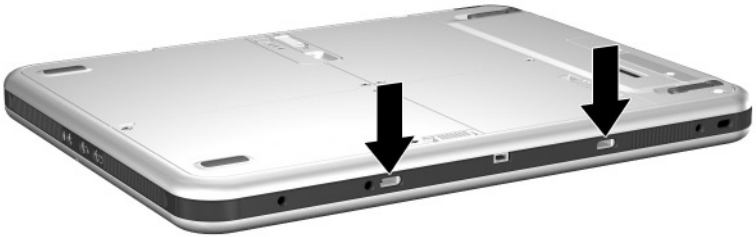

### ***Identifying the universal attachment slots on the tablet PC***

When you are using the tablet PC attached to an optional tablet PC keyboard, press the 2 tabs on the portfolio into the 2 universal attachment slots on the keyboard.

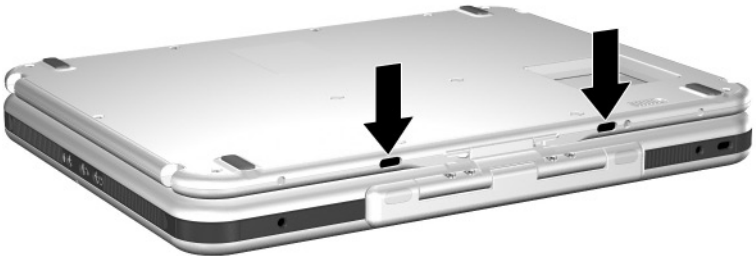

### ***Identifying the universal attachment slots on a tablet PC keyboard***

## Detaching a Portfolio

To release a portfolio from the tablet PC, slide and hold the attachment release switch on the tablet PC.

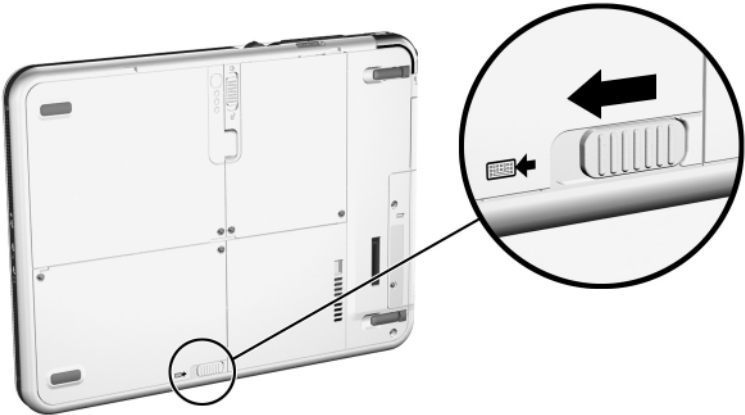

### ***Sliding the attachment release switch on the tablet PC***

To release a portfolio from the tablet PC keyboard, slide and hold the attachment release switch on the tablet PC keyboard.

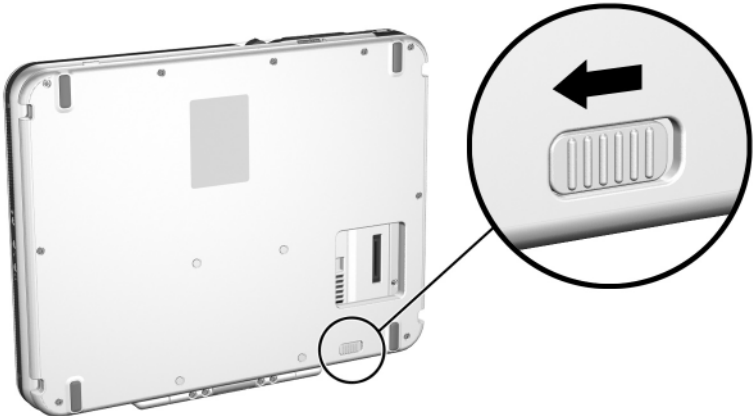

### ***Sliding the attachment release switch on the tablet PC keyboard***

## Cleaning Hardware



**WARNING:** To prevent electric shock or damage to components, do not attempt to clean the tablet PC until you:

- Shut down the tablet PC.
  - Disconnect the tablet PC from external power.
  - Disconnect all powered external devices from the tablet PC.
- 



**CAUTION:** Do not spray liquids on the tablet PC. Household solvents can permanently damage tablet PC surfaces, and any liquid can damage the internal components of the tablet PC or an optional keyboard.

---

## Cleaning the Screen

To remove smudges and lint, clean the screen with a soft, lint-free cloth dampened with water or a glass cleaning liquid. Antistatic screen cleaner or premoistened antistatic wipes may also be used.

## Cleaning a Tablet PC Keyboard

Dust, lint, and other debris can affect the performance of an optional tablet PC keyboard. To prevent sticking or nonfunctioning keys, clean the keyboard frequently using a can of compressed air with a straw extension. Blow the compressed air around the base of each key.

To clean the key surfaces, use a soft, damp, lint-free cloth.



Using a household vacuum cleaner to clean the keyboard may deposit, rather than remove, debris.

---



***Cleaning a tablet PC keyboard with a can of compressed air***

## Replacing Hardware

### Replacing a Pen Battery

Replace the pen AAAA battery once a year or when the pen stops functioning. A standard AAAA battery can be purchased from most electronics retailers or from your Compaq authorized dealer, reseller, or service provider.

The time the pen can operate on a new battery varies with use. In most cases, a new AAAA battery can run a pen that is used approximately 8 hours a day for 6 months.

To replace the pen battery:

1. Remove the pen from the pen holder ❶.
2. Unscrew the pen tip end of the pen barrel from the pen tether eyelet end of the pen barrel ❷.
3. Remove the used pen battery.
4. Insert the AAAA battery included with the tablet PC into the pen with the positive pole (+) facing the pen tip ❸. (The positive end of the battery ❹ touches the circuit board in the pen tip end of the pen.)
5. Screw the pen tether eyelet end of the pen barrel onto the pen tip end of the pen barrel ❺.

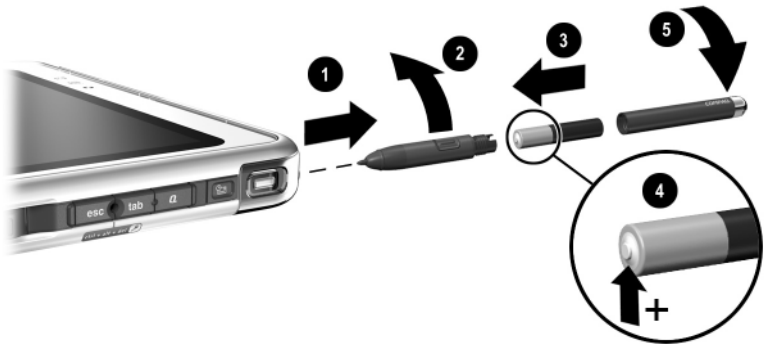

**Replacing the pen battery**



## Replacing the System Hard Drive

The system hard drive is the hard drive in the hard drive bay. Remove the system hard drive only for repair or replacement.



**CAUTION:** To prevent an unresponsive system and loss of work:

- Shut down the tablet PC before removing the system hard drive. Do not remove the system hard drive while the tablet PC is on, in Standby, or in Hibernation.
- To verify that the tablet PC is off and not in Hibernation, slide and release the power switch. If your work returns to the screen, save your work, exit all applications, then shut down the tablet PC.

1. Save your work.
2. Shut down the tablet PC.
3. Turn the tablet PC front side down.
4. Remove the 2 hard drive bay cover retaining screws ①.
5. Slide, lift, then remove the hard drive bay cover ②.

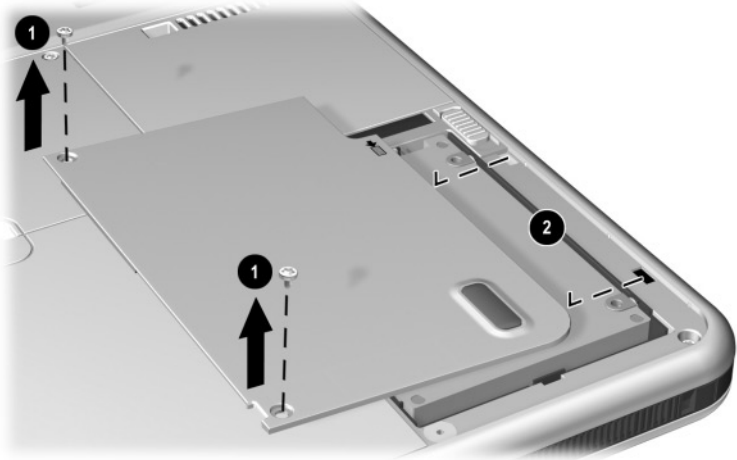

**Removing the hard drive bay cover**

**CAUTION:** The connector pins on the hard drive are designed to support only the minimal insertions or removals that may be required for repair or replacement. To prevent damage to the hard drive connectors, be careful not to bend them while removing the hard drive.

6. To remove the hard drive, gently disengage the drive connectors ❶ by sliding the hard drive toward the lower edge of the tablet PC.
7. Remove the drive from the bay ❷.

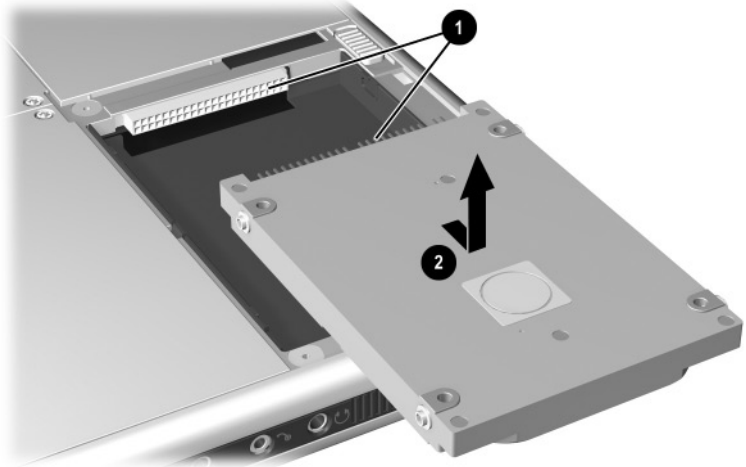

**Removing a system hard drive from the hard drive bay**

8. To insert the replacement hard drive, lower the drive into the hard drive bay ❶, then slide the connectors on the hard drive toward the connectors in the bay ❷ until the connectors engage and the drive is seated.

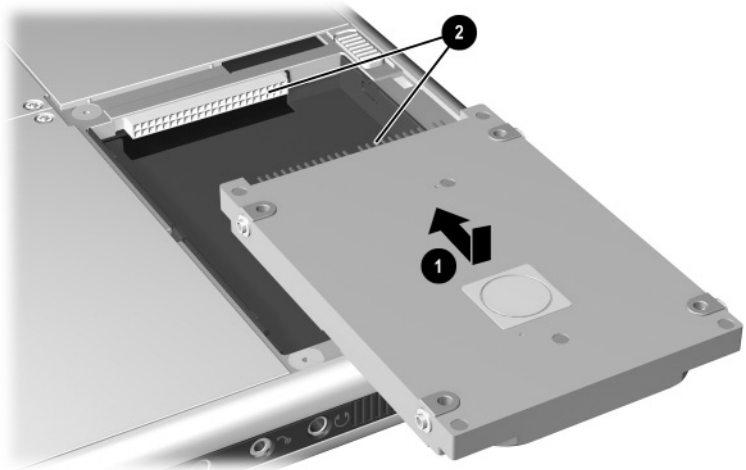

***Inserting a system hard drive into the hard drive bay***

9. Align the tabs on the hard drive bay cover with the cover slots on the tablet PC ❶, then press downward on the cover until it is seated.
10. Reinsert the 2 retaining screws that secure the cover to the tablet PC ❷.

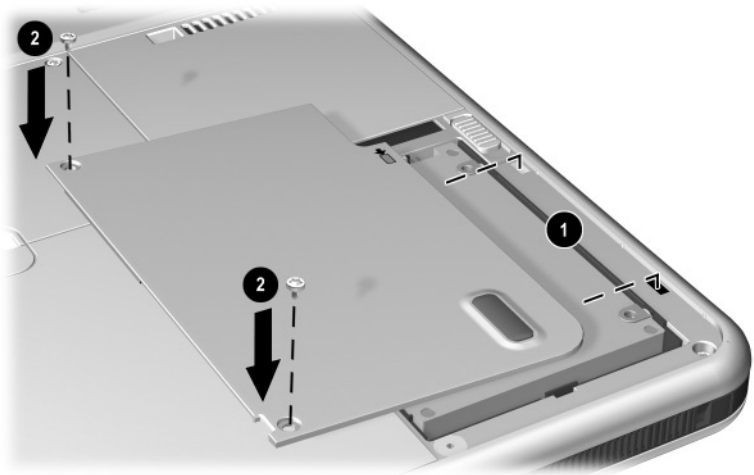

***Replacing the hard drive bay cover***

## Replacing a Pointing Stick Cap

Two pointing stick replacement caps are included with an optional tablet PC keyboard. To replace a worn pointing stick cap:

1. If the keyboard is attached to the tablet PC, shut down the tablet PC.
2. Gently pull off the used pointing stick cap.
3. Push a replacement cap into place.



***Replacing the pointing stick cap***

## Preparing the Tablet PC for Shipping or Travel

1. Back up your work.
2. Remove a PC Card or CompactFlash card.
3. Undock the tablet PC from an optional docking station and turn off, then disconnect all optional external devices such as headphones or an External MultiBay. (It is not necessary to detach the tablet PC from an optional tablet PC keyboard.)
4. Shut down the tablet PC.
5. If the tablet PC will be disconnected from an external power source for more than one month, shut down the tablet PC, remove the battery pack, and store the battery pack in a cool, dry place.
6. If you are shipping the tablet PC, insert it into a portfolio, place it in the original packing box or similar protective packaging, and label the package “FRAGILE.”

## Traveling with the Tablet PC

### Checklist for Travelers

- Take along a backup of your work. Do not pack the backup with the tablet PC.
- Carry the tablet PC with you. Do not check it with your luggage.
- If you are traveling to an area where battery packs or AAAA batteries for the pen may be unavailable, you may want to take along a spare battery pack and AAAA battery.
- If you will have access to an optical drive, you may want to take along the *Documentation Library* CD. If not, Compaq suggests that you print and take with you the “Contacting Compaq” section later in this chapter.

- Do not expose the tablet PC, a hard drive, or a diskette to a magnetic security detector.
  - ❑ The security device that examines carry-on items placed on a conveyer belt uses x-rays and is safe for the tablet PC and all drive media.
  - ❑ The walk-through security device and handheld security wands are magnetic and may damage the tablet PC, a hard drive, or a diskette.
- If you plan to use the tablet PC during a flight, check with the airline in advance. In-flight tablet PC use is at the discretion of the airline.
- If you expect to encounter climatic extremes, see the “Specifications” chapter, “Tablet PC Operating Environment” section.
- If you are traveling internationally:
  - ❑ If you plan to use an internal modem, review in this guide the “Internal Modem” chapter for information about using adapters and country configurations. You may want to print and take with you the “Solving Travel Connection Problems” section if you are not bringing the *Documentation Library* CD.
  - ❑ Check the computer-related customs regulations for each country on your itinerary.
  - ❑ Consult with an electronics retailer or a Compaq authorized dealer, reseller, or service provider about power cord and adapter requirements for each location in which you plan to use the tablet PC. (Voltage, frequency, and plug configurations vary.) To contact a Compaq authorized dealer, reseller, or service provider near you, refer to the *Worldwide Telephone Numbers* booklet included in English only with the tablet PC.



**WARNING:** To reduce the risk of electric shock, fire, or damage to the equipment, do not attempt to run the tablet PC with a voltage converter kit sold for appliances.

---

## Contacting Compaq

### Getting Help from the Internet

If you have Internet access, you can resolve most problems that may arise while traveling with the tablet PC by using Compaq Help and Support.

Compaq Help and Support provides links to specific areas of the Compaq Web site where you can:

- Obtain all documentation included with your tablet PC as well as other information about your tablet PC such as specifications, white papers, and customer advisories.
- Initiate an online service event with a Compaq support specialist.
- Download the latest drivers, utilities, and other software updates for your tablet PC.
- Subscribe to the *Compaq Support Software CD*.

To access these links and descriptions of the options they provide, select Start > Compaq Information Center. The Compaq Help and Support menu is displayed in the left panel.

Not all links are available worldwide, and most sites are available in limited languages.



## Getting Help Without Using the Internet

If you need help and cannot access the Internet:

- To obtain troubleshooting information:
  - Refer on this CD to the *Troubleshooting* guide.
  - Refer to the “Solving Problems” chapter in the printed *Getting Started* guide included with the tablet PC.
- To obtain a list of worldwide Technical Support telephone numbers:
  - Select Start > Control Panel > Performance and Maintenance icon > System icon. Then, near the lower edge of the System Properties window, select the Support Information button.
  - Refer to the printed *Worldwide Telephone Numbers* booklet included in English only with the tablet PC.

---

## Specifications

The information in this chapter may be helpful if you plan to use or transport the tablet PC internationally or in extreme environments.

### Tablet PC and Tablet PC Keyboard Dimensions

<b>Dimension</b>	<b>U.S.</b>	<b>Metric</b>
Height	0.8 in.	2.1 cm
Width	8.3 in.	21.0 cm
Depth	10.8 in.	27.1 cm

### Tablet PC Operating Environment

<b>Factor</b>	<b>U.S.</b>	<b>Metric</b>
<b>Temperature</b>		
Operating	50° to 95° F	10° to 35° C
Nonoperating	14° to 140° F	-10° to 60° C
<b>Relative humidity (noncondensing)</b>		
Operating	10 to 90%	10 to 90%
Nonoperating	5 to 90%	5 to 90%
<b>Maximum altitude (unpressurized)</b>		
Operating	10,000 ft	3,048 m
Nonoperating	30,000 ft	9,144 m

## Tablet PC Rated Input Power

The tablet PC operates on DC power, which can be supplied by an AC or DC power source.

Input Power	Rating
Operating voltage	100–120/220–240 Vrms
Operating current	1.7/0.85 A RMS
Operating frequency range	50 to 60 Hz AC
When powered by a DC source	18.5 V MAX

 This product is designed for IT power systems in Norway with phase-to-phase voltage not exceeding 240 Vrms.

## Modem Specifications

This tablet PC has been tested and found to comply with the limits for a Class B digital device. For additional governmental agency information, refer on this CD to the *Regulatory and Safety Notices* guide.

Factor	Specification	
<b>Temperatures</b>		
Operating	50° to 104° F (10° to 40° C)	
Nonoperating	–4° to 140° F (–20° to 60° C)	
<b>Relative Humidity (noncondensing)</b>		
Operating	10 to 90%	
Nonoperating	5 to 90%	
<b>Interfaces</b>	Communications connector	Standard RJ-11 connector
	Host Connector	Mini PCI Type III
<b>Power Requirements</b>	+3.3 volts ±5%, +3.3 vaux ±5%	

## **Finding More Environmental Information**

The specifications in this chapter contain information about exposing the tablet PC to environmental extremes.

For similar information about storing battery packs, see the “Battery Packs” chapter, “Storing a Battery Pack” section.

For information about exposing the tablet PC to sunlight, ultraviolet light, x-rays, or magnetic fields, see the “Maintenance, Shipping and Travel” chapter, “Protecting Hardware” section.

---

# Index

## A

- AAAA battery
  - included 1–20
  - replacing in pen 10–7
- AC adapter
  - AC power connector 1–11
  - connecting 3–13
  - disconnecting 3–1
  - identifying 1–21
  - light 1–2
- AC power connector 1–11
- AC power, switching to and from 3–1
- adapter
  - for AC power cord. *See* AC adapter
  - for connecting AC adapter to electrical outlet (Japan only) 1–21
  - for modem. *See* modem adapter
- adjustment, tilt 1–25
- Agere modem commands 6–8
- airport security devices 10–14
- alignment
  - key 1–25, 8–4
  - key slot 1–9, 8–4
  - notches, docking 1–24
  - slots, battery bay 3–3
  - slots, docking 1–8
  - tabs, battery pack 3–3
- altitude specifications 11–1
- analog telephone lines 6–6
- antennas 1–7, 1–10
- antivirus software 10–1
- applications key 1–23
- applications. *See* software
- AT commands 6–8
- attachment release switch
  - on tablet PC 1–14, 8–9
  - on tablet PC keyboard 1–26
- audio devices, external
  - connecting 8–1
  - jacks for 5–5
- audio-out jack 5–5
- Auto/Air Cable
  - AC power connector 1–11
  - connecting 3–13
  - tasks supported by 3–8
- Automobile Power Adapter/Charger
  - AC power connector 1–11
  - connecting 3–13
  - tasks supported by 3–7

**B**

- backup software 10-1
- battery bay
  - alignment slots 3-3
  - inserting battery pack into 3-3
  - Microsoft Certificate of Authenticity label, inside 1-17
  - release latch 1-15
  - removing a battery pack
    - security screw from 3-5
  - removing battery pack from 3-2
- battery light 1-2
- battery pack
  - button and lights on 3-10
  - calibrating 3-14
  - charging 3-7
  - disposing of 3-19
  - inserting 3-3
  - monitoring charge in 3-8
  - Quick Check feature 3-10
  - recycling 3-19
  - release latch 1-15
  - security screws 3-5
  - storing 3-1, 3-18
  - tabs 3-3
- battery power
  - conserving 3-17
  - low-battery conditions, identifying 3-11
  - low-battery conditions, resolving 3-12
  - running tablet PC on 3-1
  - switching to and from 3-1
- battery, bridge 3-12
- battery, pen
  - included 1-20
  - replacing 10-7
  - running time 10-7
- biometric identification PC Cards 9-1
- board
  - Mini PCI 1-16, 7-5
  - modem 6-1
- bridge battery 3-12
- button(s)
  - battery quick check 3-10
  - CompactFlash card eject 9-6
  - email launch 1-5, 2-11
  - esc 1-6, 2-13
  - Journal launch 1-3, 2-9
  - media eject, on diskette drive 4-7
  - media release, on optical drive 4-5
  - PC Card eject 9-3
  - pen 2-2
  - pointing stick 2-19
  - Q menu 1-6, 2-12
  - reset 2-11
  - rotate 1-3, 2-10
  - tab 1-6, 2-12
  - Tablet PC Input Panel
    - launch 1-3, 2-9
  - Windows Security 1-5, 2-10
  - See also* jog dial; latch; switch; *specific buttons*

**C**

## cable

- DC 1–11
- modem 1–20, 6–3
- modem vs. network 1–20
- network 1–20, 7–2
- security 8–10

## cable lock, security 8–10

## calibration

- battery pack 3–14
- pen 2–4

cap, replacing pointing stick  
10–12

## caps lock light 1–22

## card and socket services, PC

## Card 9–2

card. *See* board; CompactFlash  
card; module, memory; PC  
CardCD-ROM, CD-RW drives. *See*  
drivesCDs included with tablet PC  
1–19CDs, CD-RWs. *See* drive  
media

## circuitry, noise suppression

- on modem cable 6–3
- on network cable 7–2

## command controls

- identified 2–7
- procedures 2–9
- Quick Reference 2–8
- setting preferences for  
2–14

## commands, AT 6–8

## CompactFlash card

- drivers 9–4
- eject button 9–6
- functions 9–4
- inserting 9–5
- power considerations 9–4,  
9–6
- removing 9–6
- stopping 9–6
- Type I and Type II 9–4

Compaq Help and Support  
10–15Compaq Information Center  
10–15*Compaq Support Software* CD  
10–15Compaq utilities. *See* software  
compartment

- memory 1–16, 9–9

## connector(s)

- AC power 1–11
- connection procedures 8–1
- docking 1–14
- drive 4–3
- external monitor 1–11
- External MultiBay 1–11
- keyboard 1–9
- modem 6–2
- network 1–20
- telephone 1–20
- USB 8–2

*See also* fasteners; jack

## conservation, power 3–17

## controls, command 2–7

- cord, power 1–20
  - See also* cable
- country-specific modem adapter
  - configuring software for use with 6–5
  - connecting 6–4
  - included with tablet PC 1–21
  - when required 6–2
- critical low-battery condition
  - identifying 3–11
  - restoring from 3–13
- ctrl+alt+delete command 2–10
- customer support 10–15
- D**
- DC cable 1–11
- device drivers
  - CompactFlash card 9–4
  - for external devices 8–1
  - modem 6–1
  - network 7–1
  - PC Card 9–2
  - updating 10–15
  - USB 8–2
- dial, jog
  - described 2–14
  - identified 2–7
- dialing modes (pulse vs. tone) 6–6
- digital telephone lines 6–6
- dimensions, tablet PC 11–1
- disc drive, diskette drive. *See* drives
- disc, diskette *See* drive media
- disk, rotation 1–24
- display device images, managing 8–1
- docking
  - alignment notches 1–24
  - alignment slots 1–8
  - connector 1–14
  - connector pass-through 1–26
  - restraint latch recess 1–14
- docking station
  - audio-out jack on 5–3
  - docking alignment notches 1–24
  - docking alignment slots 1–8
  - docking connector 1–14
  - drives supported by 4–1
- Documentation Library CD* 1–19
- drive media
  - affected by airport security 4–3
  - affected by Standby and Hibernation 4–8
  - caring for 4–9
  - displaying contents of 4–8
  - inserting a CD or DVD 4–4
  - inserting a diskette 4–7
  - playing 4–10
  - removing a CD or DVD (power available) 4–5
  - removing a CD or DVD (power unavailable) 4–6
  - removing a diskette 4–7
  - types and terms 4–2



- drivers. *See* device drivers
- drives
  - adding to system 4–1
  - affected by airport security 4–3
  - caring for 4–3
  - shipping 4–3
  - supported 4–1
  - types and terms 4–2
  - USB 8–2
  - See also* hard drive, system
- DVD, DVD/CD-RW drive.  
*See* drives
- DVDs, CD-RWs. *See* drive media
- E**
- eject button
  - CompactFlash card 9–6
  - diskette drive 4–7
  - optical drive 4–5
  - PC Card 9–3
- electrostatic discharge (ESD) 9–8
- email applications 2–11
- email launch button
  - identified 1–5
  - procedures 2–11
  - setting preferences for 2–14
- enablers, PC Card 9–2
- encryption, data 7–1
- enter command 2–14
- environmental specifications 11–1
- esc button
  - identified 1–6
  - procedures 2–13
  - setting preferences for 2–14
- ESD (electrostatic discharge) 9–8
- external devices
  - connecting, disconnecting 8–1
  - USB 8–2
  - See also* connector(s); fasteners; jack; *specific types of devices*
- external monitor connector 1–11
- External MultiBay
  - connectors for 1–11
  - drives supported 4–1
- External MultiBay connector 1–11
- eyelets, tether 2–6
- F**
- F11/F12 key
  - procedures 2–23
  - responding to Network Service Boot prompt with 7–5
- fasteners
  - for pen tether 2–6
  - for tablet PC keyboard 8–4
- FDD (floppy disk drive). *See* drives
- feet, tilt and stationary 1–18

- Fn, specific functions of
  - on on-screen keyboard 2–17
  - on tablet PC keyboard 2–21, 2–23
- freeze, system 2–10
- function keys (F1, F2, etc.)
  - accessing F12 on tablet PC keyboard 2–23
  - accessing, on on-screen keyboard 2–17
  - standard functions of 1–23
- H**
- hard drive bay
  - cover 10–8
  - cover retaining screws 10–8
  - replacing system hard drive in 10–8
- hard drive, system
  - defined 4–2
  - displaying amount of free space on 9–7
  - replacing 10–8
  - retaining screw 10–8
  - space on, required for Hibernation file 9–7
  - See also* drives
- HDD (hard disk drive). *See* hard drive, system
- headphones
  - audio-out jack 5–5
  - connecting 5–6, 8–1
- headset
  - connecting 5–6, 8–1
  - headset jack 5–5
- help line 10–15
- Hibernation
  - avoiding while playing media 4–8
  - identifying 10–8
  - initiated during critical low-battery condition 3–11
  - initiating 3–13
  - resuming from 3–13
- holder, pen 2–5
- hooks, keyboard 1–25, 8–4
- hub, USB 8–2
- humidity specifications 11–1
- I**
- identifying pen components 1–1
- identifying tablet PC components
  - additional 1–19
  - back 1–14
  - front 1–2
  - left side 1–9, 1–10
  - lower side 1–8
  - right side 1–4
  - top 1–10, 1–11
- identifying tablet PC keyboard components
  - additional 1–27
  - back 1–26
  - front 1–22
  - top 1–25

internal wireless LAN  
  antennas 1–7, 1–10  
  documentation 7–5  
  optimizing transmissions  
    1–7  
  wireless LAN activity light  
    1–2  
Internet Explorer 2–11  
IPSec Authentication Header  
  (AH) 7–1

## J

jack  
  audio-out 5–5  
  connection procedures 8–1  
  headset 5–5  
  microphone 5–5  
  PBX 6–6  
  RJ-11 telephone 6–2  
  RJ-45 network 7–2  
  *See also* connector(s)  
Japan-specific outlet adapter  
  1–21  
jog dial  
  identified 1–7  
  procedures 2–14  
  setting preferences for  
    2–14  
Journal application 2–9  
Journal launch button  
  identified 1–3  
  procedures 2–9  
  setting preferences for  
    2–14

## K

key(s)  
  F11/F12 2–23  
  function (F1, F2, etc.) 1–23  
  Microsoft logo 1–23  
  numeric keypad 2–20  
  Windows application 1–23  
keyboard, external USB  
  connecting 8–2  
  supported 2–1  
keyboard, on-screen 2–17  
keyboard, tablet PC  
  alignment key 1–25, 8–4  
  attaching 8–3  
  cleaning 10–6  
  closing 8–6  
  components identified  
    1–22  
  connector 1–25, 8–4  
  detaching 8–7, 8–8  
  F11/F12 key 2–23  
  hooks 1–25, 8–4  
  latch 8–7  
  locking to tablet PC 8–7  
  numeric keypad 2–20  
  obtaining 2–18  
  opening 8–5, 8–7  
  pointing device 2–19  
  releasing 8–7, 8–8  
  replacing pointing stick cap  
    10–12  
  rotating 8–5

- securing 8–6
  - setting pointing device
    - preferences for 2–20
  - shipping 10–13
  - tilting 8–5
  - unlocking 8–7
- L**
- label
- Microsoft Certificate of Authenticity 1–17
  - modem approvals 1–17
  - product identification 1–17
  - system 1–17
  - wireless certification 1–17
- LAN. *See* internal wireless LAN; network
- LAN connection lights 7–3
- landscape orientation
  - defined 2–15
  - rotate button 1–3
- Landscape View, Primary and Secondary 2–15
- latch
  - battery pack release 1–15, 3–2
  - docking restraint, recess 1–14
  - keyboard 8–7
  - See also* button(s); switch
- light(s)
  - AC adapter 1–2
  - battery 1–2
  - battery quick check 3–10
  - caps lock 1–22
  - LAN connection 7–3
  - num lock 2–21
  - power/standby 1–4
  - wireless LAN activity 1–2
- local area network. *See* network
- lock, security cable 8–10
- lockup, system 1–4
- low-battery conditions
  - identifying 3–11
  - resolving 3–13
- Lucent/Agere Command Set* 6–8
- M**
- magnetic fields, affecting hardware 10–14
- media eject button 4–7
- media, drive
  - avoiding Standby and Hibernation while using 4–8
  - caring for 4–9
  - displaying contents of 4–8
  - software 4–10
  - types and terms 4–2
- memory
  - displaying amount of 9–7
  - module, inserting or removing 9–8
  - modules supported 9–7
  - slots available 9–7
- microdrive PC Card 9–1
- microphone, external
  - connecting 5–6, 8–1
  - microphone jack 5–5

- microphone, internal 5–4
  - Microsoft logo key 1–23
  - Mini PCI (Peripheral Component Interface)
    - documentation 9–12
  - modem adapter
    - configuring software for use with 6–5
    - connecting 6–4
    - included 1–21
    - when required 6–2
  - modem cable
    - connecting 6–2
    - included 1–20
    - noise suppression circuitry on 6–3
    - RJ-11 telephone jack 1–11
    - vs. network cable 1–20
  - modem, internal
    - board 6–1
    - Modem Command Guidelines* 1–19
    - setting country preferences for 6–5
    - specifications 6–1, 11–2
    - travel connection
      - troubleshooting 6–6
    - using while connected to a network 7–1
  - modes, dialing (pulse vs. tone) 6–6
  - module, memory 9–7
  - monitor, external
    - connecting 8–1
    - displaying image on 8–1
    - external monitor connector 1–11
  - mouse, external
    - setting preferences for 2–1
    - supported 2–1
    - USB connectors 8–2
- N**
- network
    - accessing at startup 7–4
    - connection specifications 7–1
    - hardware and software included 7–1
    - LAN lights 7–3
    - Service Boot prompt 7–5
    - turning connection on and off 7–3
    - using internal modem while connected to 7–1
  - network cable
    - connecting 7–2
    - included 1–20
    - noise suppression circuitry on 7–2
    - RJ-45 network jack 1–11
    - vs. modem cable 1–20
  - No Dial Tone error message 6–7
  - noise suppression circuitry
    - on modem cable 6–3
    - on network cable 7–2

- num lock light 2–21
- number
  - keys, on keypad 2–20
  - keys, on on-screen keyboard 2–17
  - Product Key 1–17
  - serial 1–17
- numeric keypad 2–20

**O**

- operating environment
  - specifications 11–1
- operating system Product Key
  - number 1–17
- optical disc. *See* drive media
- optical drive. *See* drives
- Outlook 2–9, 2–11
- Outlook Express 2–11

**P**

- PBX jack 6–2, 6–6
- PC Card
  - eject button 9–3
  - enablers and card and socket services 9–2
  - functions 9–1
  - inserting 9–2
  - microdrive 4–1
  - removing 9–3
  - stopping 9–3
  - Types I, II, III 9–1
  - zoomed video 9–1

pen

- attaching 2–5
- battery, included 10–7
- battery, replacing 10–7
- battery, running time 10–7
- button 2–2
- calibration 2–4
- components 1–1, 1–20
- entering information with 2–2
- Help and tutorials 2–1
- Journal application 2–1, 2–8
- pen-activated buttons 2–7
- reactivating 2–3
- setting preferences for 2–6, 2–20

peripherals

- connecting, disconnecting 8–1
- USB 8–2
- See also* connector(s); fasteners; jack; *specific types of devices*

pointing device(s)

- command controls 2–7
- on tablet PC keyboard 2–18
- pen 2–1
- setting preferences for 2–6, 2–20
- using in Setup utility 7–4

pointing stick cap

- replacing 10–12
- spares included 1–27

- portfolio(s)
  - attaching 10–3
  - Deluxe 10–2
  - detaching 10–4
  - included with tablet PC 10–2
  - when to use 10–2
- portrait orientation
  - defined 2–15
  - rotate button 1–3
- Portrait View, Primary and Secondary 2–15
- power
  - connector, AC 1–11
  - conservation 3–17
  - cord 1–20
  - rated input 11–2
  - switch 1–4
  - switching between external and battery 3–1
  - See also* battery power
- Power Meter 3–9
- power/standby light 1–4
- Product Key number 1–17
- projector
  - connecting 8–1
  - displaying image on 8–1
  - external monitor connector 1–11
- pulse dialing mode 6–6
- PXE (Preboot eXecution Environment) server 7–4
- Q**
- Q Menu
  - Brightness tab 3–17
  - described 2–12
  - Internal and External item 8–1
  - Internal Only item 8–1
  - menu 1–6
  - volume controls 5–2
- Q menu button
  - identified 1–6
  - procedures 2–12
  - setting preferences for 2–14
- Quick Check feature, battery 3–10
- R**
- RAM (random access memory) 9–7
- recycling a battery pack 3–19
- regulatory information
  - Class B designation (FCC) 11–2
  - Regulatory and Safety Notices* 1–19
- release latch, battery pack 3–2
- release switch, attachment
  - on tablet PC 1–14, 8–9
  - on tablet PC keyboard 1–26
- reset (emergency shut down) 2–10
- RJ-11 telephone jack
  - connecting 6–2
  - modem cable 1–20

- RJ-45 network jack
  - connecting 7-2
  - network cable 1-20
- rotate button
  - identified 1-3
  - procedures 2-10
  - setting preferences for 2-14
- rotation disk 1-24
- RPL (Remote Program Load) server 7-4
- S**
- screen protector
  - included with docking station 1-9
  - slots, on tablet PC 1-9
  - slots, on tablet PC keyboard 1-26
  - universal attachment slots 1-9, 1-26
- screen, cleaning 10-5
- security
  - biometric identification PC Card 9-1
  - cable lock 8-10
  - PC Smart Card Reader 9-1
  - screws, battery pack 3-5
- security devices, affecting hardware 10-14
- serial number 1-17
- servers, network 7-4
- service, Compaq customer 10-15
- Setup utility
  - accessing 7-4
  - network settings 7-4
  - resetting the tablet PC 2-11
- shipping the tablet PC 10-13
- shutting down the tablet PC 2-10
- Sleep. *See* Standby
- slipcase 10-3
- slot(s)
  - alignment key 1-9
  - battery bay 3-3
  - CompactFlash card 9-5
  - docking alignment 1-8
  - memory 9-7
  - PC Card 9-2
  - screen protector, on keyboard 1-26
  - screen protector, on tablet PC 1-9
  - security cable 8-10
  - universal attachment, on tablet PC 1-9
  - universal attachment, on tablet PC keyboard 1-26
- socket services, PC Card 9-2



- software
    - AT command 6–8
    - AutoPlay 4–8
    - backup 10–1
    - Internet connection wizard 2–11
    - Internet Explorer 2–11
    - Journal 2–9
    - modem 3–17, 6–1, 6–8
    - Outlook 2–9, 2–11
    - Outlook Express 2–11
    - Power Meter 3–9
    - setting up 2–2
    - Setup utility 2–11
    - Software Guide* 1–19
    - Tablet PC Input Panel 2–17
    - Task Manager 2–10
    - Windows Security window 2–10
  - speakers, external
    - audio-out jack 5–5
    - connecting 5–6, 8–1
  - speakers, internal 5–3
  - specifications
    - modem 6–1, 11–2
    - network 7–1
    - tablet PC 11–1
  - Standby
    - avoiding while playing media 4–8
    - initiated during critical low-battery condition 3–11
    - initiating 3–13
    - power/standby light 1–4
    - resuming from 3–13
  - sunlight, affecting tablet PC 10–2
  - support, customer 10–15
  - Suspend. *See* Standby
  - switch
    - attachment release, on keyboard 1–26
    - attachment release, on tablet PC 1–14
    - power 1–4
    - See also* button(s); latch
  - system hard drive. *See* hard drive, system
  - system lockup 2–10
- T**
- tab button
    - identified 1–6
    - procedures 2–12
    - responding to Network Service Boot prompt with 7–5
    - setting preferences for 2–14
  - Tablet PC Input Panel application 2–17
  - Tablet PC Input Panel launch button
    - identified 1–3
    - procedures 2–9
    - setting preferences for 2–14
  - tablet PC keyboard. *See* keyboard, tablet PC
  - technical support 10–15

- telephone jack (RJ-11)
    - connecting 6–3
    - modem cable 1–20
  - telephone line(s)
    - analog vs. digital 6–6
    - connecting modem to 6–2
  - telephone numbers, Compaq
    - worldwide 10–16
  - temperature(s)
    - operating 11–1
    - overheating 1–10
    - storage, for battery packs 3–18
  - tether eyelets 2–6
  - thermal vent 1–10
  - tilt
    - adjustment 1–25
    - feet 1–18
  - tone dialing mode 6–6
  - traveling with the tablet PC
    - Auto/Air Cable 3–13
    - Automobile Power Adapter/Charger 3–13
    - battery pack temperature considerations 3–18
    - connecting the modem 6–2, 6–5
    - contacting Compaq 10–15
    - modem approvals label 1–17
    - operating environment specifications 11–1
    - wireless certification label 1–17
  - troubleshooting
    - modem problems, while traveling 6–6
    - resources 10–16
    - Troubleshooting* 1–19
  - turning off the tablet PC 2–10
  - tutorials
    - Journal 2–9
    - Tablet PC Input Panel 2–9
  - Type I and Type II
    - CompactFlash cards 9–4
  - Type I, II, and III PC Cards 9–1
- U**
- ultraviolet light, affecting tablet PC 10–2
  - universal attachment slots
    - on tablet PC 1–9
    - on tablet PC keyboard 1–26
- USB**
- connector 1–11
  - devices, connecting 8–2
  - External MultiBay connector 1–11
  - hub 8–2
- utilities. *See* software
- V**
- vent 1–10
  - virus protection software 10–1
  - volume controls
    - adjusting volume with 5–1
    - conserving power with 3–17

**W**

- Web browser 2–11
- Windows applications key  
1–23
- Windows Security button
  - identified 1–5
  - procedures 2–10
  - setting preferences for  
2–14
- wireless LAN, internal
  - antennas 1–7, 1–10
  - documentation 7–5
  - optimizing transmissions  
1–7
  - wireless LAN activity light  
1–2

- worldwide telephone numbers,  
Compaq 10–16

**X**

- x-rays, affecting hardware  
10–14

**Z**

- zoomed video 9–1