

(12) **United States Patent**
Soussan et al.

(10) **Patent No.:** **US 6,526,357 B1**
(45) **Date of Patent:** **Feb. 25, 2003**

(54) **ASSOCIATED PARAMETER MEASURING AND/OR MONITORING SUCH AS IN THE EVALUATION OF PRESSURE DIFFERENCES**

5,069,792 A 12/1991 Prince et al.
5,174,894 A 12/1992 Ohsawa et al.
5,200,090 A 4/1993 Ford et al.
5,211,849 A 5/1993 Kitaevich et al.
5,234,608 A 8/1993 Duff

(75) Inventors: **Daniel A. Soussan**, Lakewood, CO (US); **Douglas P. Miller**, Lakewood, CO (US)

(List continued on next page.)

(73) Assignee: **Gambro, Inc.**, Lakewood, CO (US)

FOREIGN PATENT DOCUMENTS

(*) Notice: Subject to any disclaimer, the term of this patent is extended or adjusted under 35 U.S.C. 154(b) by 105 days.

EP 0967554 A1 12/1999
EP 0990417 A1 4/2000
EP 0990418 A1 4/2000
EP 0992215 A1 4/2000
EP 0993803 A1 4/2000
EP 0997102 A1 5/2000
EP 0997103 A1 5/2000

(21) Appl. No.: **09/631,204**

(22) Filed: **Aug. 1, 2000**

Related U.S. Application Data

(60) Provisional application No. 60/147,958, filed on Aug. 9, 1999.

Primary Examiner—John S. Hilten

Assistant Examiner—Xiuqin Sun

(74) *Attorney, Agent, or Firm*—Peter H. Scull; Edna M. O'Connor; Laura M. Butterfield

(51) **Int. Cl.⁷** **G06F 19/00**
(52) **U.S. Cl.** **702/45; 702/100**
(58) **Field of Search** 604/65; 364/509; 702/45; 73/304; 222/15

(57) **ABSTRACT**

Correction quantities are generated for yielding closer approximations of actual parameters. These are obtained by preliminarily subjecting parametric transducers to pre-selected parametric values and recording the measured values for each transducer in a data table for later use as or in correction quantities. An embodiment includes interpolation relative to data table values closest to the operationally measured parametric value and using the resulting interpolated value as a corrected parametric value. Such interpolations may be performed for two parametric transducers relative to two substances. The resulting corrected parametric values may then be subtracted to obtain a parametric difference. A further embodiment may include using correction quantities of a reference parametric transducer in interpolation calculations for the actual parametric transducers. Similarly, other data table correction recordings such as differences between two measured parameters can be used to modify an operationally measured parametric differential. Reference transducer corrections can be used here as well.

(56) **References Cited**

U.S. PATENT DOCUMENTS

3,946,731 A 3/1976 Lichtenstein
4,083,777 A 4/1978 Hutchisson
4,161,880 A 7/1979 Prosky
4,168,517 A 9/1979 Lee
4,227,420 A 10/1980 Lamadrid
4,315,309 A 2/1982 Coli
4,370,983 A 2/1983 Lichtenstein
4,403,296 A 9/1983 Prosky
4,600,401 A 7/1986 Kamen
4,661,246 A 4/1987 Ash
4,710,164 A 12/1987 Levin et al.
4,718,891 A 1/1988 Lipps
4,739,492 A 4/1988 Cochran
4,828,543 A 5/1989 Weiss et al.
4,879,040 A 11/1989 Prince et al.
4,954,128 A 9/1990 Ford

22 Claims, 7 Drawing Sheets

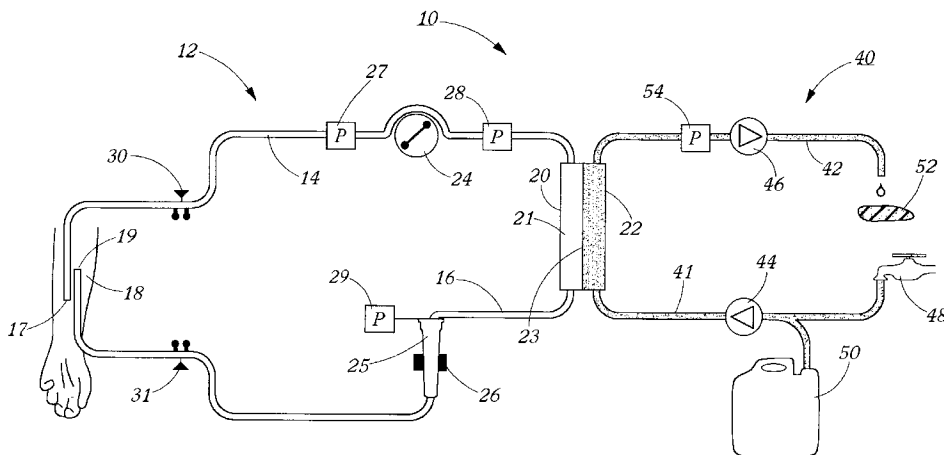

U.S. PATENT DOCUMENTS

5,263,924 A	11/1993	Mathewson	5,618,441 A	4/1997	Rosa et al.	
5,277,188 A	1/1994	Selker	5,645,642 A	7/1997	Nishizato et al.	
5,326,476 A	7/1994	Grogan et al.	5,650,071 A	7/1997	Brugger et al.	
5,344,568 A	9/1994	Kitaevich et al.	5,690,831 A	11/1997	Kenley et al.	
5,370,123 A	12/1994	Shinzato	5,706,661 A	1/1998	Frank	
5,372,709 A	12/1994	Hood	5,711,302 A	1/1998	Lampropoulos et al.	
5,431,811 A	7/1995	Tusini et al.	5,711,883 A	1/1998	Folden et al.	
5,441,636 A	8/1995	Chevallet et al.	5,725,776 A	3/1998	Kenley et al.	
5,473,537 A	12/1995	Glazer et al.	5,745,377 A *	4/1998	Power et al.	364/509
5,482,049 A	1/1996	Addiss et al.	5,749,364 A	5/1998	Sliwa, Jr. et al.	
5,487,827 A	1/1996	Peterson et al.	5,776,091 A	7/1998	Brugger et al.	
5,497,665 A	3/1996	Cage et al.	5,788,851 A	8/1998	Kenley et al.	
5,510,716 A	4/1996	Buffaloe, IV et al.	5,910,252 A	6/1999	Truitt et al.	
5,510,717 A	4/1996	Buffaloe, IV et al.	6,045,510 A	4/2000	Ogura et al.	
5,536,237 A	7/1996	Prince et al.	6,280,408 B1 *	8/2001	Sipin	604/65
5,551,440 A	9/1996	Miyawaki				

* cited by examiner

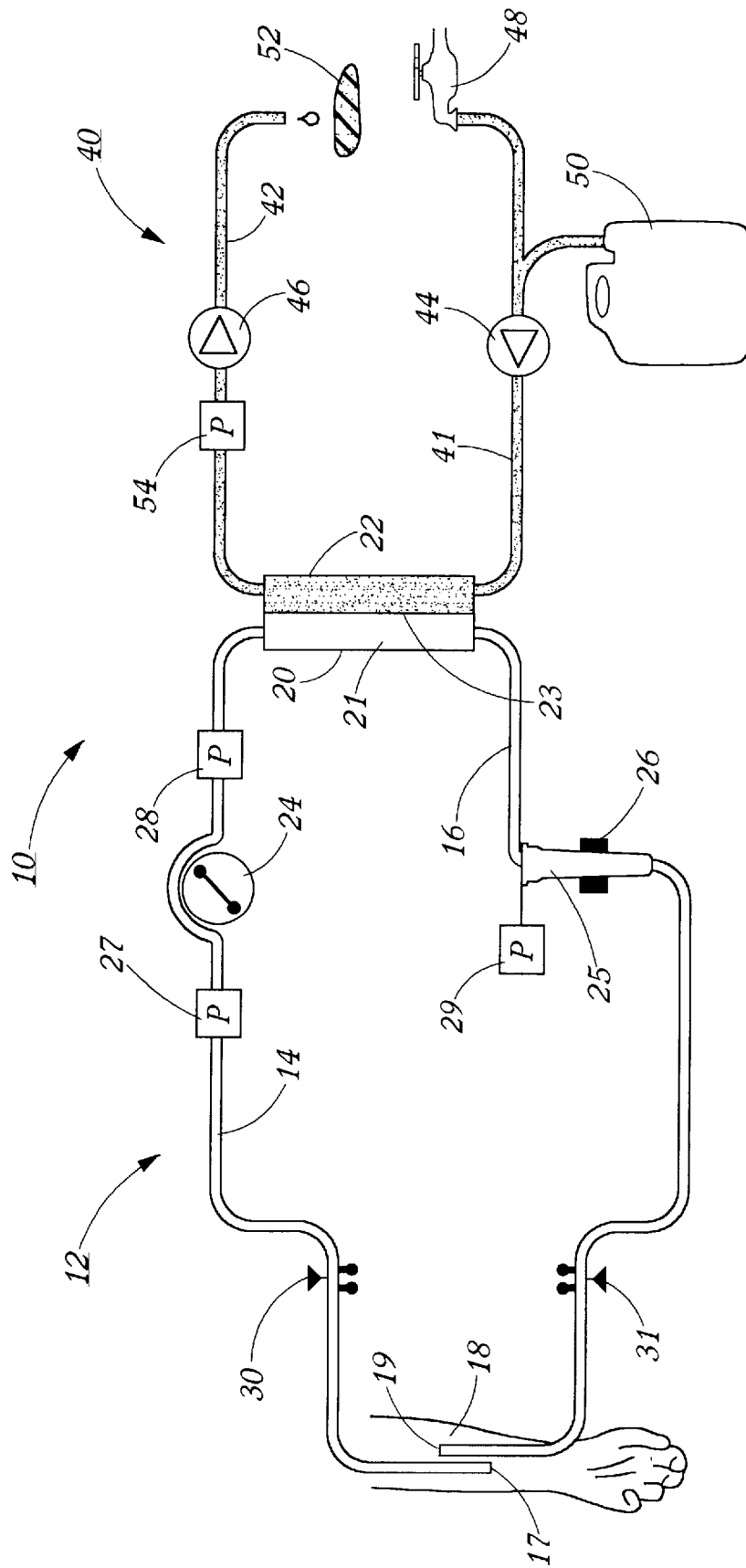

Figure 1

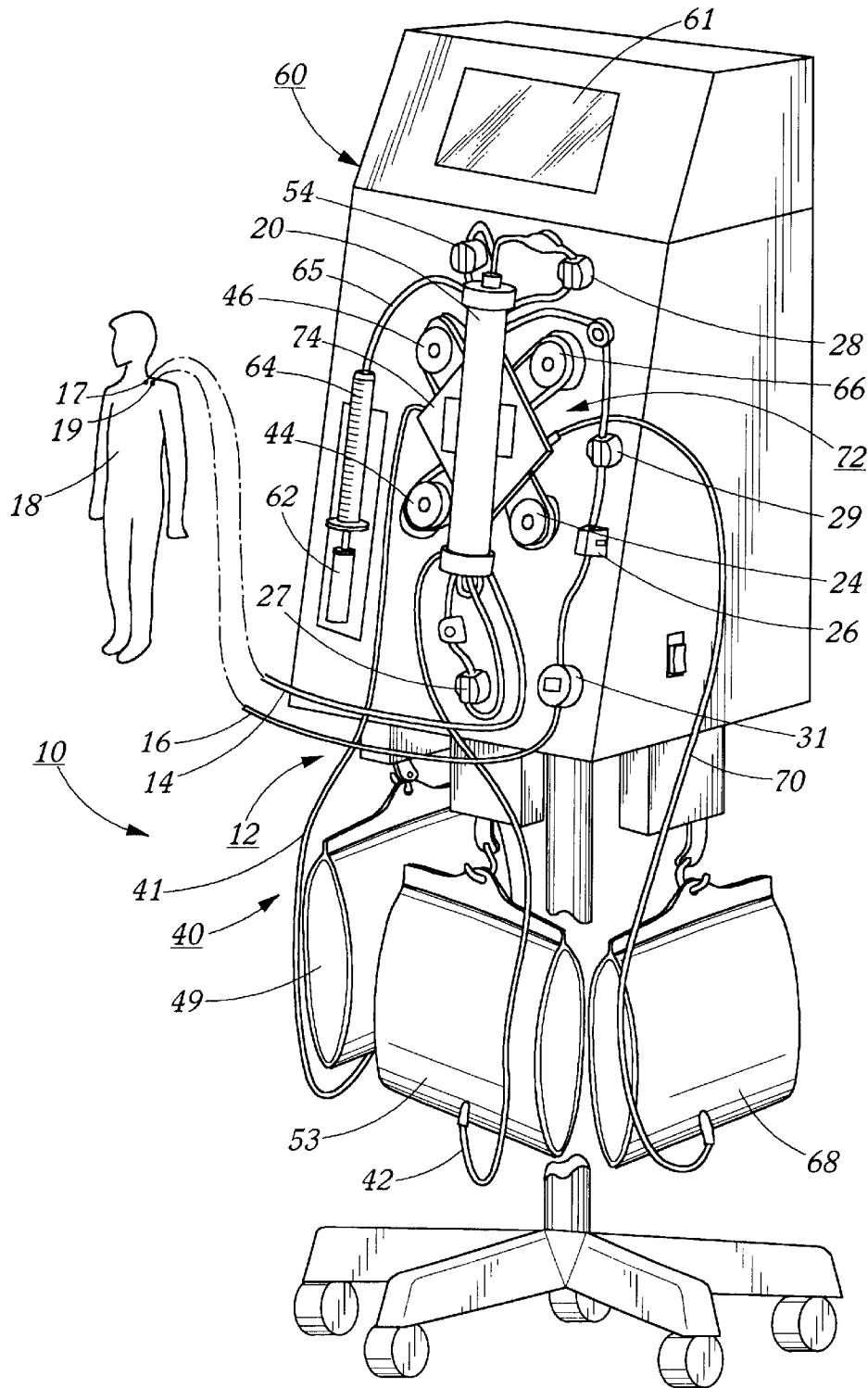

Figure 2

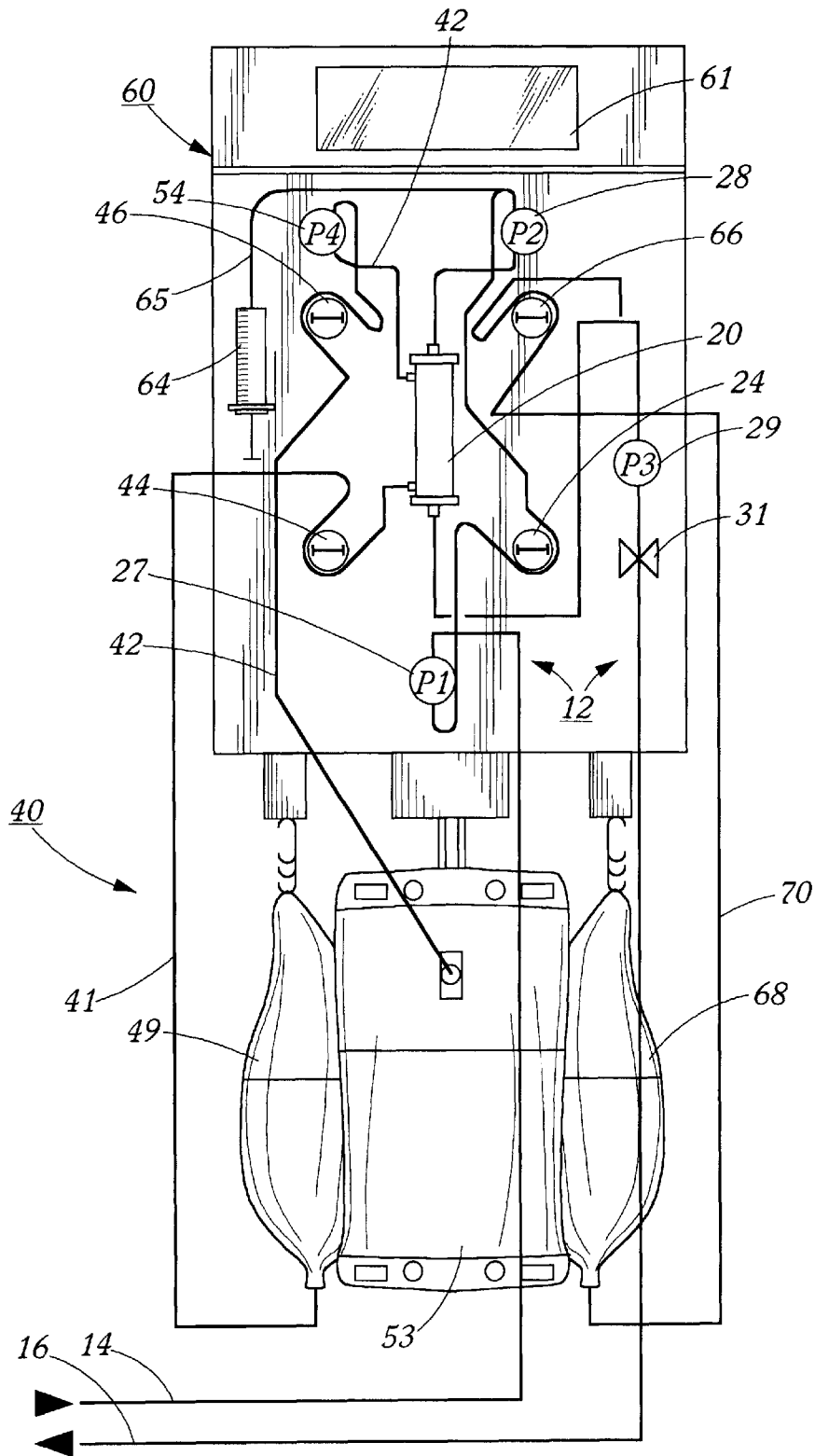

Figure 3

Explore Litigation Insights

Docket Alarm provides insights to develop a more informed litigation strategy and the peace of mind of knowing you're on top of things.

Real-Time Litigation Alerts



Keep your litigation team up-to-date with **real-time alerts** and advanced team management tools built for the enterprise, all while greatly reducing PACER spend.

Our comprehensive service means we can handle Federal, State, and Administrative courts across the country.

Advanced Docket Research



With over 230 million records, Docket Alarm's cloud-native docket research platform finds what other services can't. Coverage includes Federal, State, plus PTAB, TTAB, ITC and NLRB decisions, all in one place.

Identify arguments that have been successful in the past with full text, pinpoint searching. Link to case law cited within any court document via Fastcase.

Analytics At Your Fingertips



Learn what happened the last time a particular judge, opposing counsel or company faced cases similar to yours.

Advanced out-of-the-box PTAB and TTAB analytics are always at your fingertips.

API

Docket Alarm offers a powerful API (application programming interface) to developers that want to integrate case filings into their apps.

LAW FIRMS

Build custom dashboards for your attorneys and clients with live data direct from the court.

Automate many repetitive legal tasks like conflict checks, document management, and marketing.

FINANCIAL INSTITUTIONS

Litigation and bankruptcy checks for companies and debtors.

E-DISCOVERY AND LEGAL VENDORS

Sync your system to PACER to automate legal marketing.