



US005625673A

**United States Patent** [19]  
**Grewe et al.**

[11] **Patent Number:** **5,625,673**  
[45] **Date of Patent:** **Apr. 29, 1997**

[54] **MODULAR COMMUNICATION APPARATUS** 5,127,050 6/1992 Takahashi et al. .... 379/428

[75] Inventors: **Anthony J. Grewe**, Holmdel; **Michael Kerwin**, West Orange; **Carl S. Ledbetter, Jr.**, Summit; **B. Waring Partridge, III**, Far Hills, all of N.J.

[73] Assignee: **Lucent Technologies Inc.**, Murray Hill, N.J.

[21] Appl. No.: **310,297**

[22] Filed: **Sep. 22, 1994**

[51] **Int. Cl.**<sup>6</sup> ..... **H04Q 7/32**; H04M 1/00

[52] **U.S. Cl.** ..... **379/61**; 379/428; 379/58; 455/90

[58] **Field of Search** ..... 379/58, 59, 57, 379/428, 420; 340/825.44; 455/89, 90

[56] **References Cited**

**U.S. PATENT DOCUMENTS**

4,748,574 5/1988 Tucht ..... 379/428  
4,991,197 2/1991 Morris ..... 379/58  
5,020,090 5/1991 Morris ..... 379/58  
5,127,041 6/1992 O'Sullivan ..... 379/59

**OTHER PUBLICATIONS**

"Gizmo—A Chronicle of Consumer Electronics", *Popular Electronics*; pp. 51–62, 92–93, Mar. 1994.

*Primary Examiner*—Dwayne D. Bost  
*Assistant Examiner*—Michael B. Chernoff

[57] **ABSTRACT**

A versatile device is obtained with a PDA that includes means for cordless connecting to specialized accessories. The PDA can operate in its conventional mode, or it can be enhanced by interconnecting it with some or all of its accessories. In one embodiment, the PDA is combined with a cellular telephone that is adapted to physically mate with the PDA and form thereby a single integrated apparatus. In another embodiment, the PDA is combined with a landline telephone that is adapted to mate with the PDA and form thereby another single integrated apparatus. In a still another embodiment, the PDA (whether or not mated with a telecommunication device) is combined with a keyboard to form a laptop computer.

**23 Claims, 5 Drawing Sheets**

FIG. 1

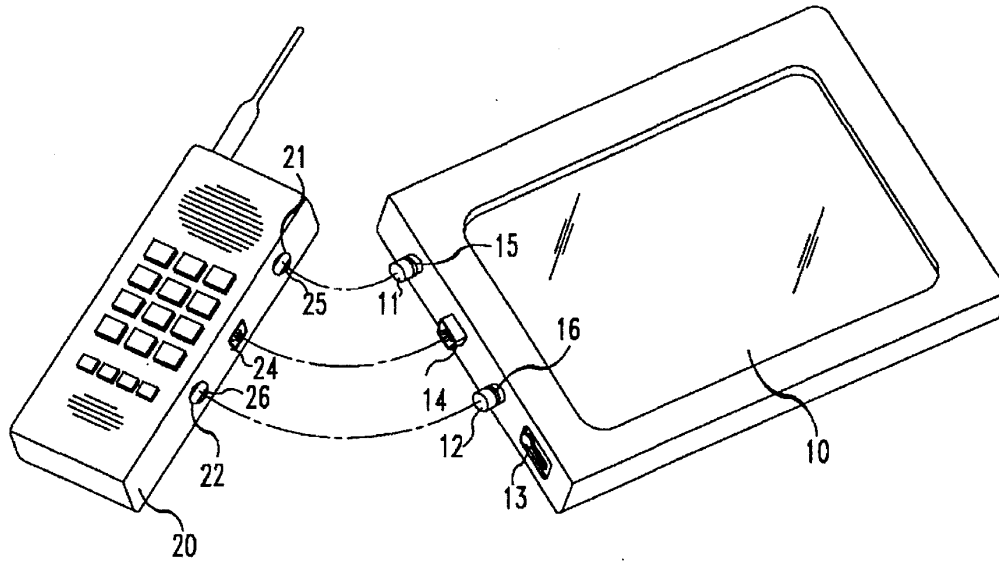

FIG. 2

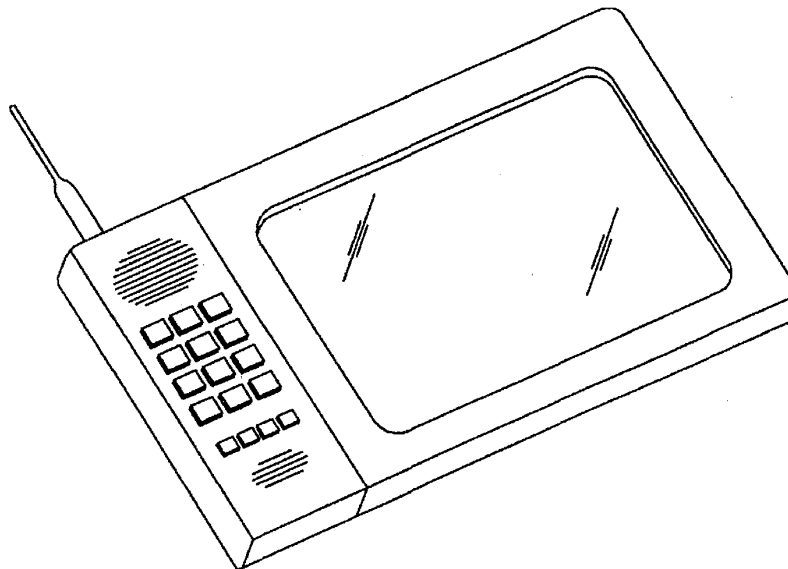

FIG. 3

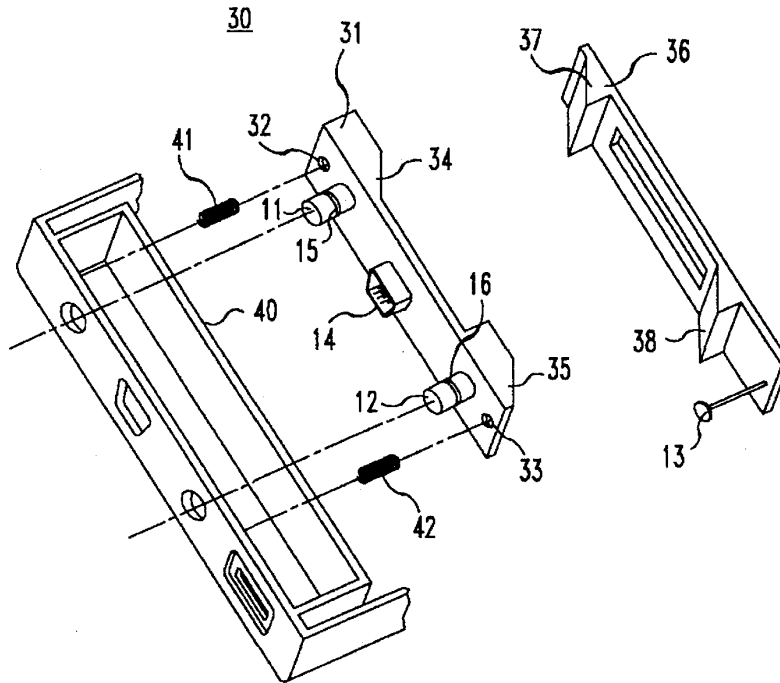
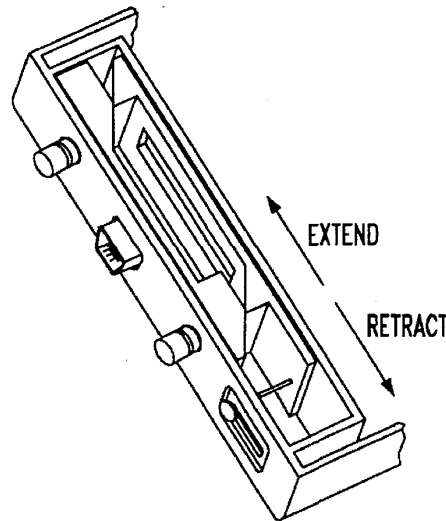
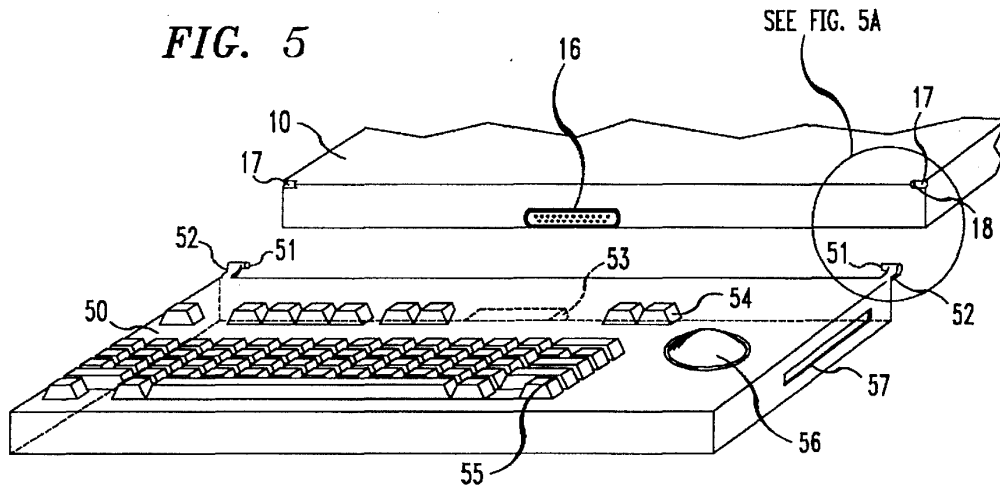

FIG. 4

30





**FIG. 5A**

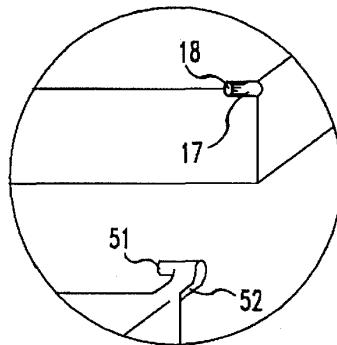

**FIG. 6**

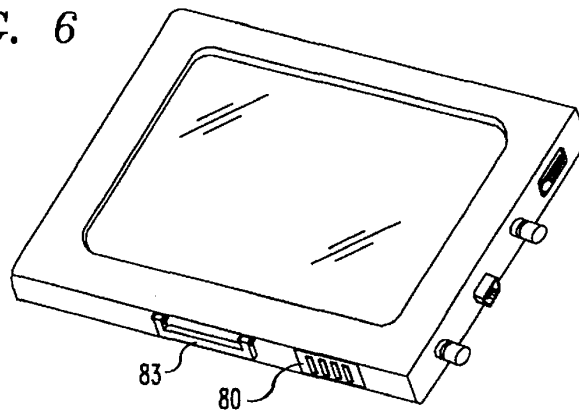

FIG. 7

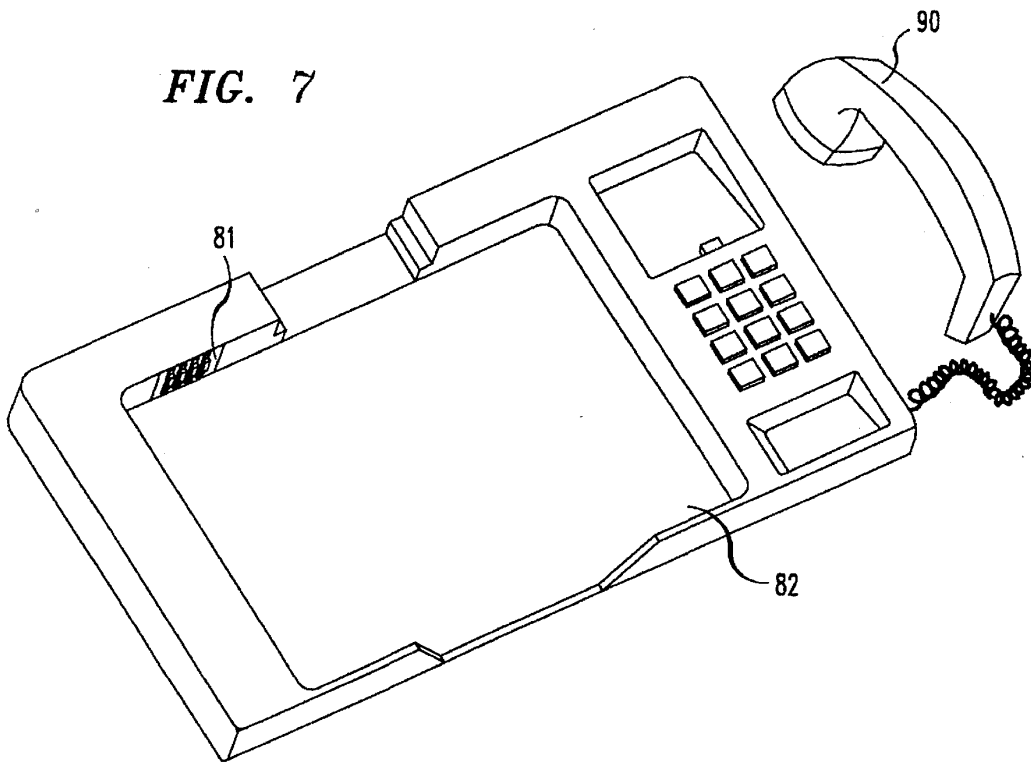
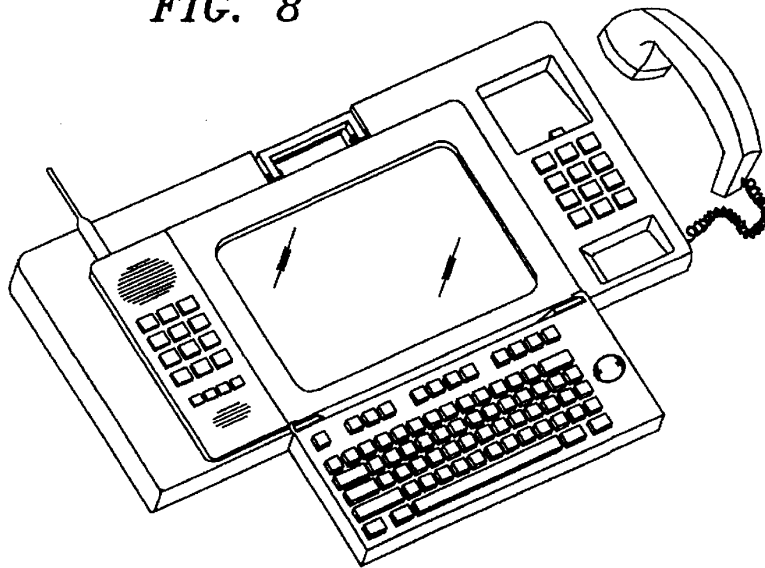

FIG. 8



# Explore Litigation Insights

Docket Alarm provides insights to develop a more informed litigation strategy and the peace of mind of knowing you're on top of things.

## Real-Time Litigation Alerts



Keep your litigation team up-to-date with **real-time alerts** and advanced team management tools built for the enterprise, all while greatly reducing PACER spend.

Our comprehensive service means we can handle Federal, State, and Administrative courts across the country.

## Advanced Docket Research



With over 230 million records, Docket Alarm's cloud-native docket research platform finds what other services can't. Coverage includes Federal, State, plus PTAB, TTAB, ITC and NLRB decisions, all in one place.

Identify arguments that have been successful in the past with full text, pinpoint searching. Link to case law cited within any court document via Fastcase.

## Analytics At Your Fingertips



Learn what happened the last time a particular judge, opposing counsel or company faced cases similar to yours.

Advanced out-of-the-box PTAB and TTAB analytics are always at your fingertips.

## API

Docket Alarm offers a powerful API (application programming interface) to developers that want to integrate case filings into their apps.

## LAW FIRMS

Build custom dashboards for your attorneys and clients with live data direct from the court.

Automate many repetitive legal tasks like conflict checks, document management, and marketing.

## FINANCIAL INSTITUTIONS

Litigation and bankruptcy checks for companies and debtors.

## E-DISCOVERY AND LEGAL VENDORS

Sync your system to PACER to automate legal marketing.