



US005580148A

United States Patent [19]

[11] Patent Number: **5,580,148**

Liao

[45] Date of Patent: **Dec. 3, 1996**

[54] **AUTOMATICALLY SLAVED MOTOR VEHICLE LIGHT**

[76] Inventor: **Yu-Ken Liao**, Suite 1, 11F, 95-8 Chang Ping Rd. Sec. 1, Taichung, Taiwan, Taiwan

4,930,057 5/1990 Williams 362/272
 4,973,155 11/1990 Masuda 362/71
 5,099,400 3/1992 Lee 362/71 X
 5,404,278 4/1995 Shibata et al. 362/37 X

Primary Examiner—Denise L. Gromada
 Assistant Examiner—Thomas M. Sember

[21] Appl. No.: **436,151**
 [22] Filed: **May 8, 1995**

[57] ABSTRACT

[51] Int. Cl.⁶ **B60Q 1/24**
 [52] U.S. Cl. **362/35; 362/37; 362/71; 362/74; 362/66; 362/423; 362/40**
 [58] Field of Search 362/71, 35, 37, 362/40, 66, 74, 69, 233, 271, 269, 272, 275, 287, 419, 420, 422, 423, 424, 427, 428; 74/42, 53, 54

An automatically slaved light for a motor vehicle comprises a roof mounted lamp steerable about a horizontal and vertical axis, and an internal control unit within the coach of the vehicle. The control unit rotates the lamp unit about the vertical axis via a first motor in the lamp housing when the vehicle is engaging a turn, wherein the lamp is rotated in the direction of turn of the vehicle to an angle proportional to the steering angle thereof as determined by a steering angle sensor coupled to the vehicle's steering wheel. The lamp is rotated upward about the horizontal axis by the control unit via a second motor in the lamp housing when the vehicle is traversing a declinate section of road, wherein the lamp unit is rotated upward relative the longitudinal axis of the motor vehicle to an angle proportional to the angle defined between the longitudinal axis of the vehicle and the gravitational horizon which is determined by a level sensor in the control unit.

[56] References Cited

U.S. PATENT DOCUMENTS

1,491,377 4/1924 Calhoun 362/422
 4,204,270 5/1980 Poirier d'Ange d'Orsay 362/71
 4,353,110 10/1982 Ellis 362/233 X
 4,722,030 1/1988 Bowden 362/423 X
 4,833,573 5/1989 Miyauchi et al. 362/71
 4,890,207 12/1989 Jones 362/233

1 Claim, 4 Drawing Sheets

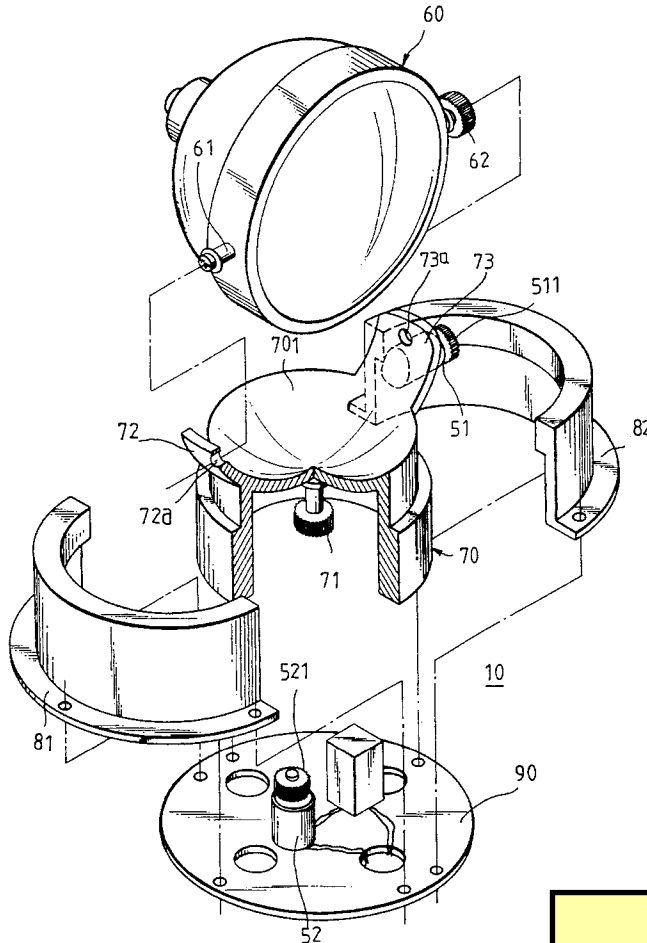

MBUSA LLC
 EXHIBIT 1014

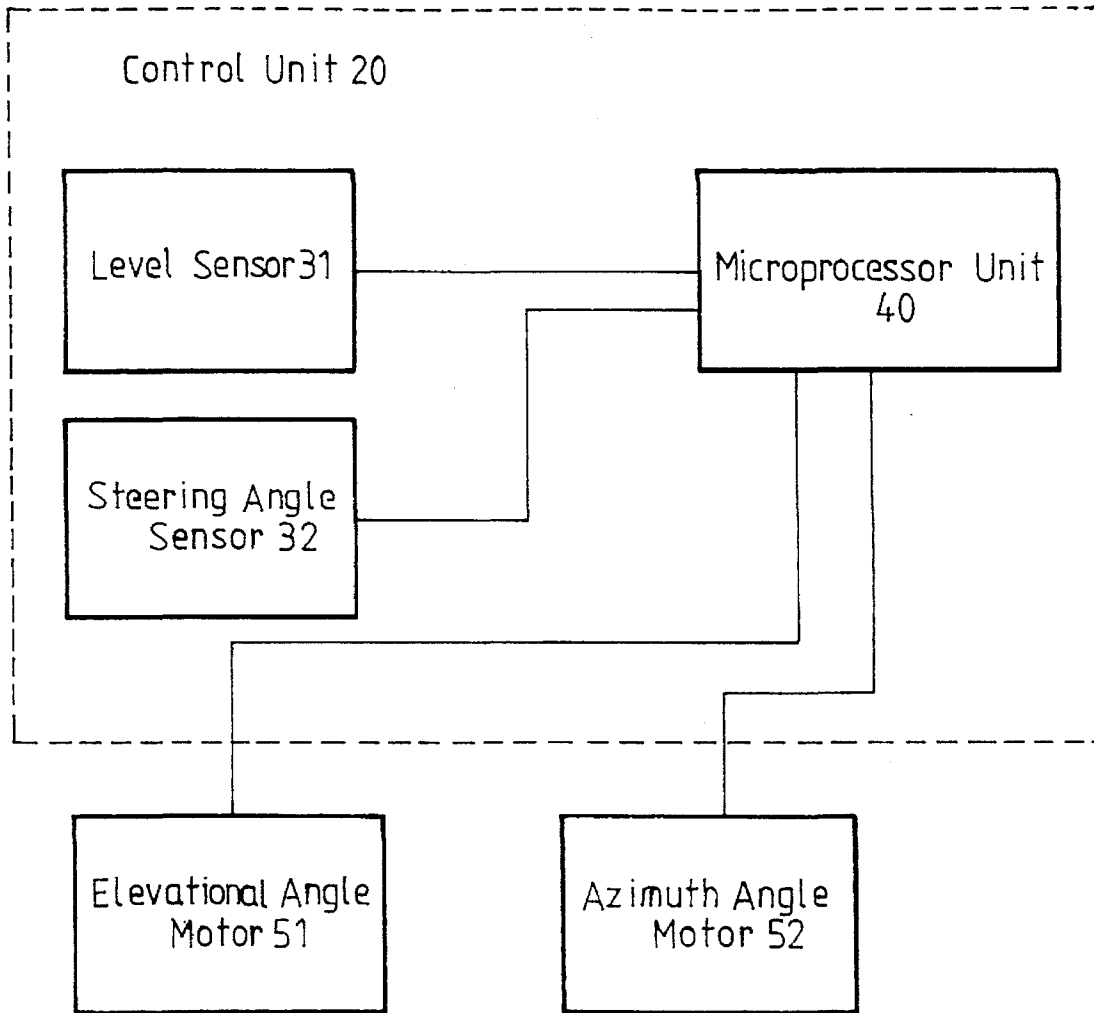
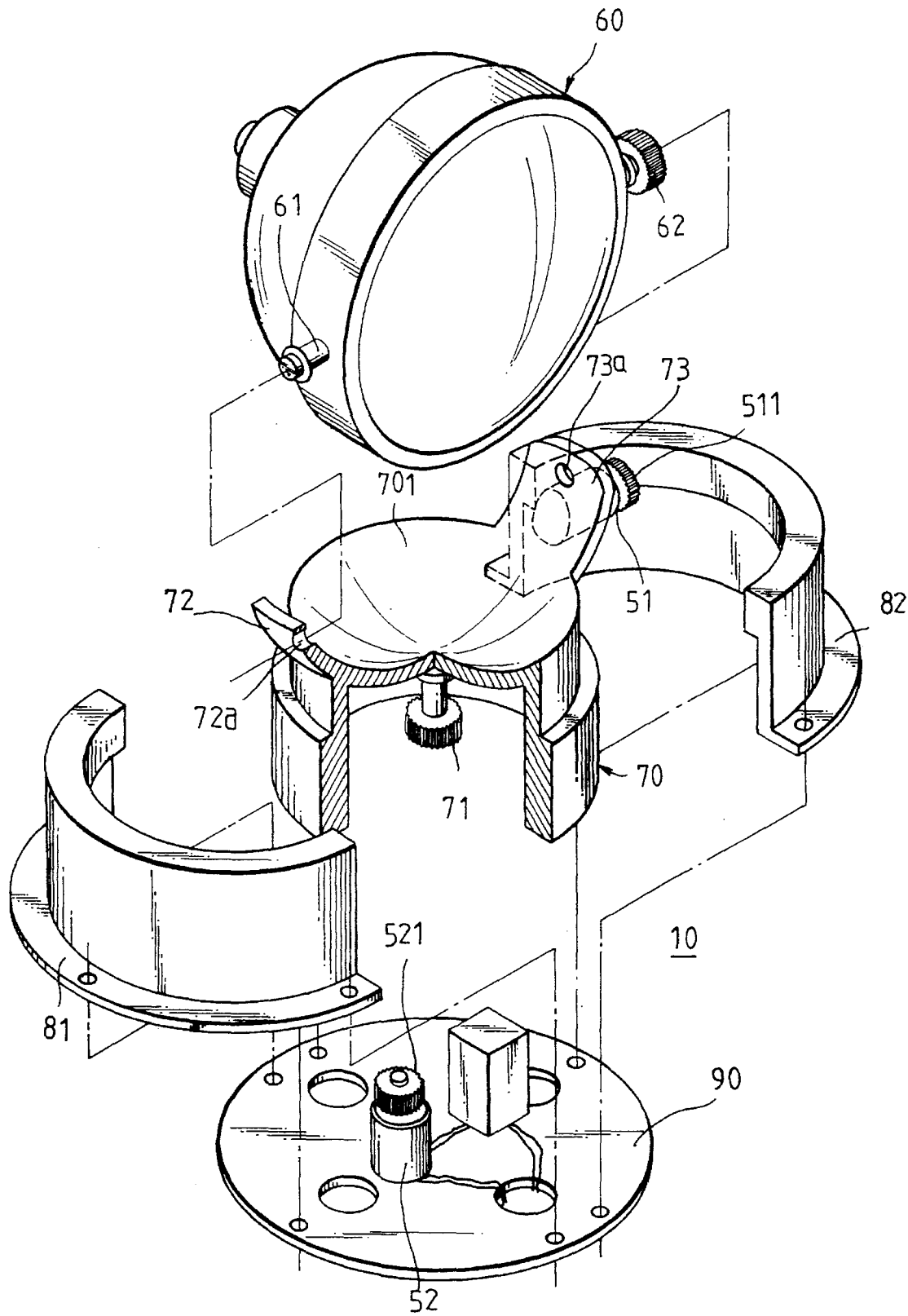

FIG. 1



F I G. 2

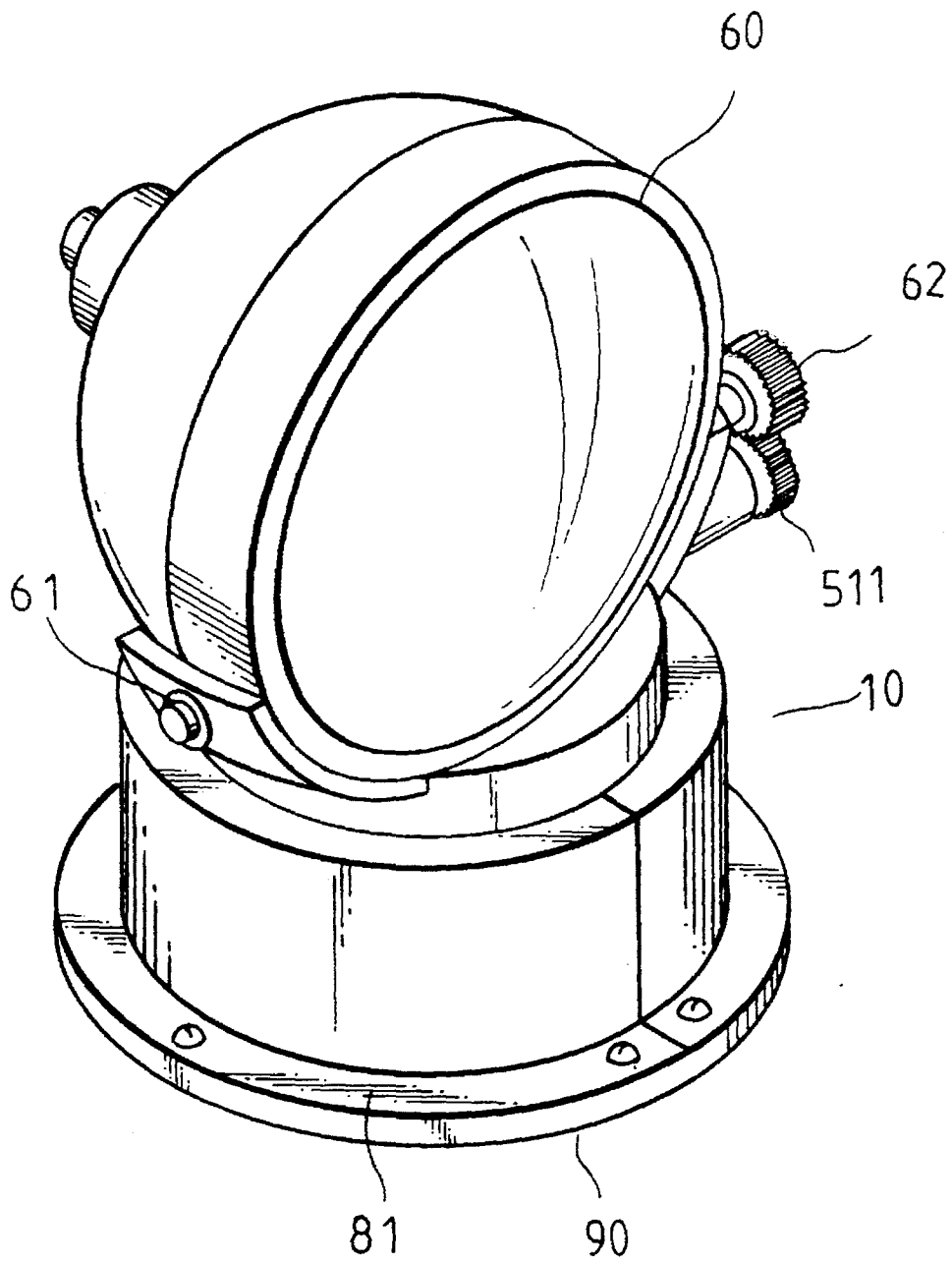

FIG. 3

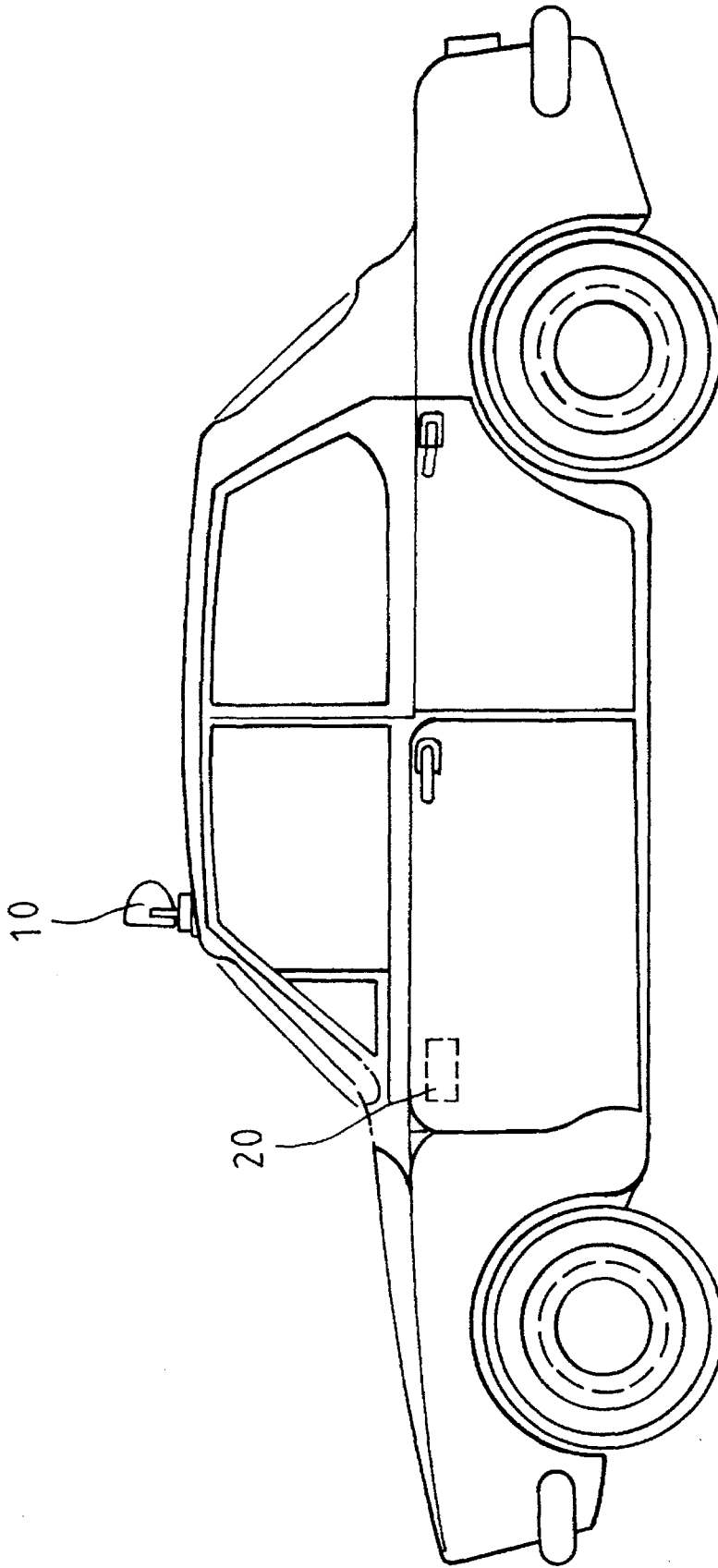

FIG. 4

Explore Litigation Insights

Docket Alarm provides insights to develop a more informed litigation strategy and the peace of mind of knowing you're on top of things.

Real-Time Litigation Alerts



Keep your litigation team up-to-date with **real-time alerts** and advanced team management tools built for the enterprise, all while greatly reducing PACER spend.

Our comprehensive service means we can handle Federal, State, and Administrative courts across the country.

Advanced Docket Research



With over 230 million records, Docket Alarm's cloud-native docket research platform finds what other services can't. Coverage includes Federal, State, plus PTAB, TTAB, ITC and NLRB decisions, all in one place.

Identify arguments that have been successful in the past with full text, pinpoint searching. Link to case law cited within any court document via Fastcase.

Analytics At Your Fingertips



Learn what happened the last time a particular judge, opposing counsel or company faced cases similar to yours.

Advanced out-of-the-box PTAB and TTAB analytics are always at your fingertips.

API

Docket Alarm offers a powerful API (application programming interface) to developers that want to integrate case filings into their apps.

LAW FIRMS

Build custom dashboards for your attorneys and clients with live data direct from the court.

Automate many repetitive legal tasks like conflict checks, document management, and marketing.

FINANCIAL INSTITUTIONS

Litigation and bankruptcy checks for companies and debtors.

E-DISCOVERY AND LEGAL VENDORS

Sync your system to PACER to automate legal marketing.