

SONY[®]

3-865-814-11(1)

FM/AM Cassette Car Stereo

Operating Instructions _____ **US**

Owner's Record

The model and serial numbers are located on the bottom of the unit.
Record the serial number in the space provided below.
Refer to these numbers whenever you call upon your Sony dealer regarding this product.

Model No. XR-C5120/4890 Serial No. _____

For installation and connections, see the supplied installation/connections manual.

***XR-C5120
XR-4890***

Warning

This equipment has been tested and found to comply with the limits for a Class B digital device, pursuant to Part 15 of the FCC Rules. These limits are designed to provide reasonable protection against harmful interference in a residential installation. This equipment generates, uses, and can radiate radio frequency energy and, if not installed and used in accordance with the instructions, may cause harmful interference to radio communications. However, there is no guarantee that interference will not occur in a particular installation. If this equipment does cause harmful interference to radio or television reception, which can be determined by turning the equipment off and on, the user is encouraged to try to correct the interference by one or more of the following measures:

- Reorient or relocate the receiving antenna.
- Increase the separation between the equipment and receiver.
- Connect the equipment into an outlet on a circuit different from that to which the receiver is connected.
- Consult the dealer or an experienced radio/TV technician for help.

You are cautioned that any changes or modifications not expressly approved in this manual could void your authority to operate this equipment.

Welcome !

Thank you for purchasing this Sony Cassette Player. This unit lets you enjoy a variety of features as well as an optional rotary commander.

In addition to the cassette playback and radio operations, you can expand your system by connecting an optional CD/MD unit*.

** You can connect a CD changer, an MD changer, a CD player, or an MD player (XR-C5120 only).*

Table of Contents

This Unit Only

Location of controls 4

Getting Started

Resetting the unit 5

Detaching the front panel 5

Setting the clock 6

Cassette Player

Listening to a tape 7

Playing a tape in various modes 8

Radio

Memorizing stations automatically
— Best Tuning Memory (BTM) 8

Memorizing only the desired stations 9

Receiving the memorized stations 9

Other Functions

Labeling the rotary commander 10

Using the rotary commander 10

Adjusting the sound characteristics 12

Attenuating the sound 12

Changing the sound and display settings 12

Boosting the bass sound
— D-bass 13

With Optional Equipment

CD/MD Unit (XR-C5120 only)

Playing a CD or MD 13

Playing tracks repeatedly

— Repeat Play 15

Playing tracks in random order

— Shuffle Play 15

Additional Information

Precautions 15

Maintenance 16

Dismounting the unit 17

Specifications 18

Troubleshooting guide 19

Location of controls

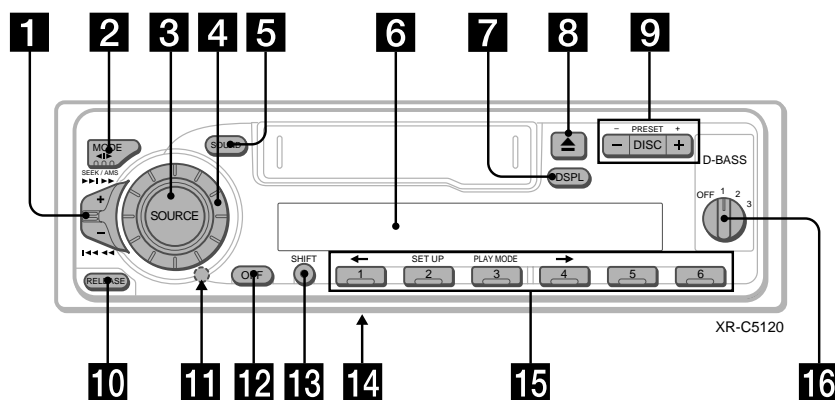

Refer to the pages listed for details.

- 1** SEEK/AMS (seek/Automatic Music Sensor/manual search) control 7, 9, 14
- 2** MODE (◀▶) button
During tape playback: Playback direction change 7
During radio reception: BAND select 8, 9
During CD or MD playback*: CD/MD Unit select 13
- 3** SOURCE (TAPE/TUNER/CD*/MD*) button 7, 8, 9, 13
- 4** Dial (volume/bass/treble/left-right/rear-front control) 6, 12
- 5** SOUND button 12
- 6** Display window
- 7** DSPL (display mode change) button 7, 9, 13, 14
- 8** ▲ (eject) button 7
- 9** XR-C5120: PRESET/DISC button
XR-4890: PRST button
During radio reception: Preset stations select 9
During CD/MD playback*: Disc change 14
- 10** RELEASE (front panel release) button 5, 17
- 11** Reset button (located on the front side of the unit behind the front panel) 5
- 12** OFF button 5, 7
- 13** SHIFT button
PLAY MODE 8, 9, 15
SET UP 6, 12, 14
- 14** POWER SELECT switch (located on the bottom of the unit)
See "POWER SELECT switch" in the Installation/Connections manual.
- 15** Number buttons 9
- 16** D-BASS control 13

* XR-C5120 only

Getting Started

Resetting the unit

Before operating the unit for the first time or after replacing the car battery, you must reset the unit.

Remove the front panel and press the reset button with a pointed object, such as a ball-point pen.

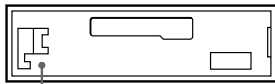

Reset button

Note

Pressing the reset button will erase the clock setting and some memorized functions.

Detaching the front panel

You can detach the front panel of this unit to protect the unit from being stolen.

- 1 Press **OFF**.
- 2 Press **RELEASE**, then slide the front panel a little to the left, and pull it off towards you.

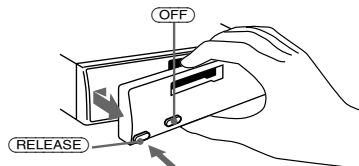

Notes

- Be sure not to drop the panel when detaching it from the unit.
- If you detach the panel while the unit is still turned on, the power will turn off automatically to prevent the speakers from being damaged.
- When carrying the front panel with you, use the supplied front panel case.

Attaching the front panel

Attach part **(a)** of the front panel to part **(b)** of the unit as illustrated and push the left side into position until it clicks.

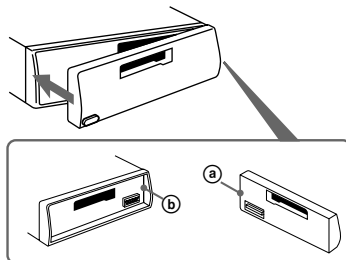

Notes

- Be sure not to attach the front panel upside down.
- Do not press the front panel too hard against the unit when attaching it.
- Do not press too hard or put excessive pressure on the display window of the front panel.
- Do not expose the front panel to direct sunlight or heat sources such as hot air ducts, and do not leave it in a humid place. Never leave it on the dashboard of a car parked in direct sunlight or where there may be a considerable rise in temperature.

Caution alarm

If you turn the ignition key switch to the OFF position without removing the front panel, the caution alarm will beep for a few seconds (only when the POWER SELECT switch on the bottom of the unit is set to the **(A)** position). If you connect an optional power amplifier and do not use the built-in amplifier, the beep sound will be deactivated.

Explore Litigation Insights

Docket Alarm provides insights to develop a more informed litigation strategy and the peace of mind of knowing you're on top of things.

Real-Time Litigation Alerts



Keep your litigation team up-to-date with **real-time alerts** and advanced team management tools built for the enterprise, all while greatly reducing PACER spend.

Our comprehensive service means we can handle Federal, State, and Administrative courts across the country.

Advanced Docket Research



With over 230 million records, Docket Alarm's cloud-native docket research platform finds what other services can't. Coverage includes Federal, State, plus PTAB, TTAB, ITC and NLRB decisions, all in one place.

Identify arguments that have been successful in the past with full text, pinpoint searching. Link to case law cited within any court document via Fastcase.

Analytics At Your Fingertips



Learn what happened the last time a particular judge, opposing counsel or company faced cases similar to yours.

Advanced out-of-the-box PTAB and TTAB analytics are always at your fingertips.

API

Docket Alarm offers a powerful API (application programming interface) to developers that want to integrate case filings into their apps.

LAW FIRMS

Build custom dashboards for your attorneys and clients with live data direct from the court.

Automate many repetitive legal tasks like conflict checks, document management, and marketing.

FINANCIAL INSTITUTIONS

Litigation and bankruptcy checks for companies and debtors.

E-DISCOVERY AND LEGAL VENDORS

Sync your system to PACER to automate legal marketing.