



(12) **United States Patent**
Hayami et al.

(10) **Patent No.:** **US 6,293,686 B1**
(45) **Date of Patent:** **Sep. 25, 2001**

- (54) **LIGHTING DEVICE FOR VEHICLES**
- (75) Inventors: **Toshihisa Hayami; Hiroyuki Ishida; Hideki Uchida; Atsushi Sugimoto**, all of Shizuoka (JP)
- (73) Assignee: **Koito Manufacturing Co., Ltd.**, Tokyo (JP)
- (*) Notice: Subject to any disclaimer, the term of this patent is extended or adjusted under 35 U.S.C. 154(b) by 0 days.

5,343,371	8/1994	Kobayahi et al. .	
5,373,424	12/1994	Ishikawa .	
5,379,196	1/1995	Kobayahi et al. .	
5,404,278	4/1995	Shibata et al. .	
5,488,546	1/1996	Sato et al. .	
5,614,788	3/1997	Mullins et al. .	
5,645,338 *	7/1997	Kobayashi	362/61
5,660,454 *	8/1997	Mori et al.	362/61
5,707,129	1/1998	Kobayashi .	
6,049,749 *	4/2000	Kobayashi	701/49
6,176,590 *	1/2001	Prevost et al.	362/37

- (21) Appl. No.: **09/507,896**
- (22) Filed: **Feb. 22, 2000**
- (30) **Foreign Application Priority Data**
Feb. 22, 1999 (JP) 11-43343
- (51) **Int. Cl.⁷** **B60Q 1/00; F21V 21/28**
- (52) **U.S. Cl.** **362/465; 362/464; 362/466; 362/276; 362/36; 362/37; 362/802; 315/81; 315/82; 307/10.8; 340/468**
- (58) **Field of Search** **362/36, 37, 43, 362/465, 464, 276, 49, 802; 315/81, 82; 307/10.8; 340/468**

FOREIGN PATENT DOCUMENTS

0 761 497 A2	3/1997	(EP) .
0 864 462 A1	9/1998	(EP) .

* cited by examiner

Primary Examiner—Thomas M. Sember
Assistant Examiner—Ali Alavi

(74) *Attorney, Agent, or Firm*—Sughrue, Mion, Zinn, Macpeak & Seas, PLLC

(57) **ABSTRACT**

The lighting device for a vehicle includes running direction detect means **3** for detecting the vehicle running direction or the vehicle steering angle and vehicle speed detect means **4** for detecting the vehicle speed. An illumination control means **5** specifies the turn-on and turn-off of a plurality of lamps in accordance with detect signals output from the means **3** and **4**, thereby changing the combinations of the illumination ranges of the lamps.

(56) **References Cited**
U.S. PATENT DOCUMENTS

3,855,462	12/1974	Kondo .
4,951,178	8/1990	Shirai et al. .
5,339,226	8/1994	Ishikawa .

26 Claims, 8 Drawing Sheets

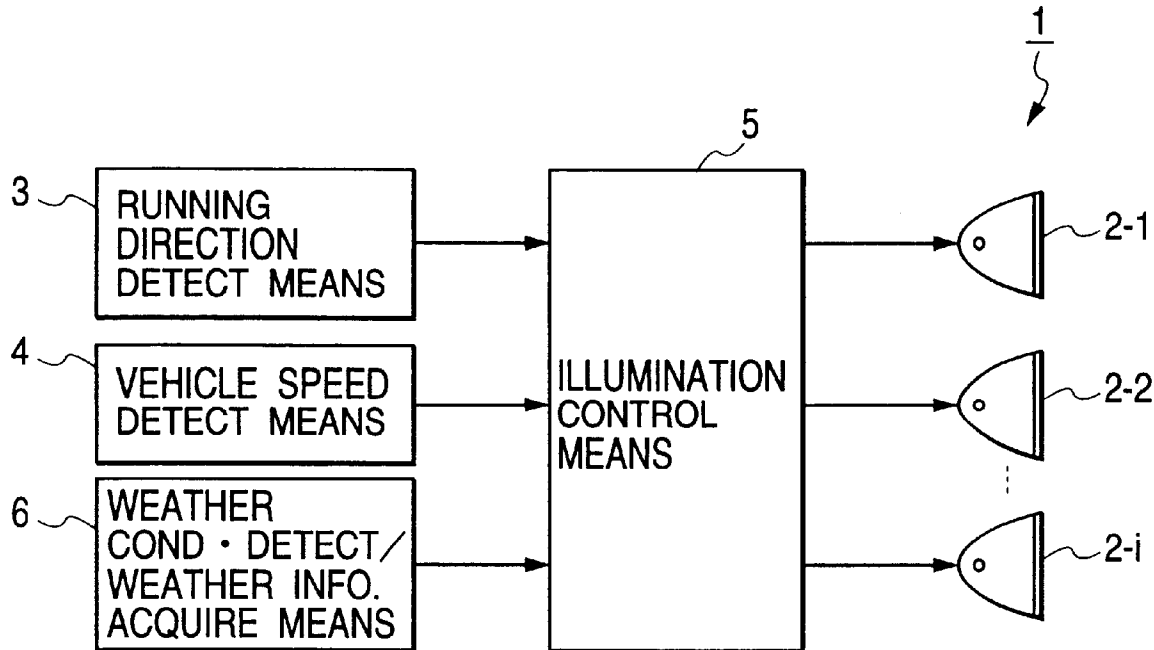

FIG. 1

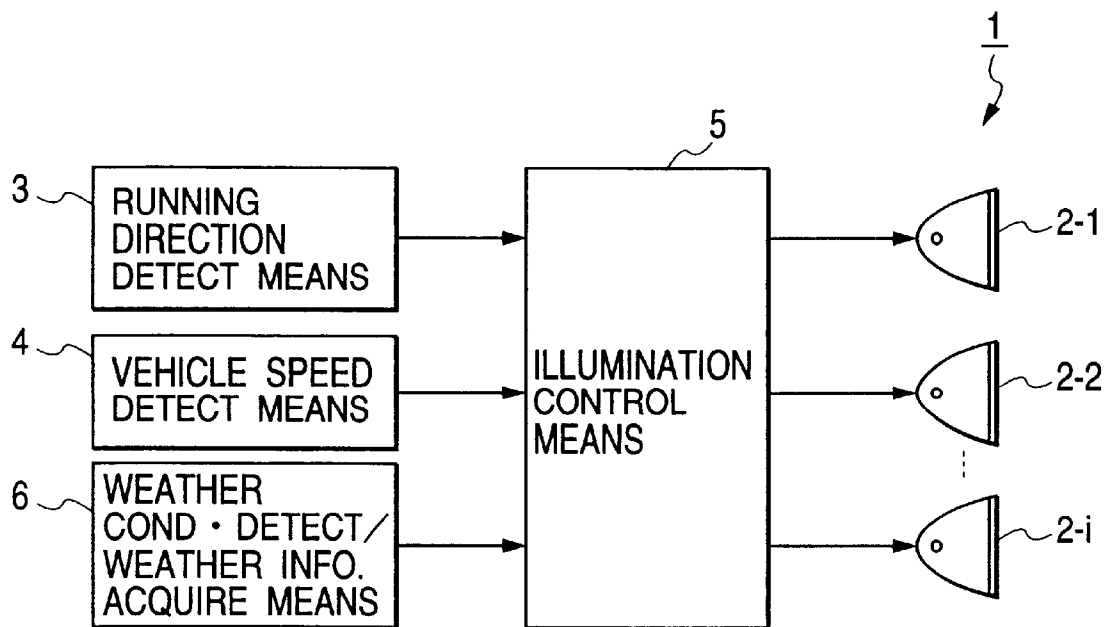

FIG. 2

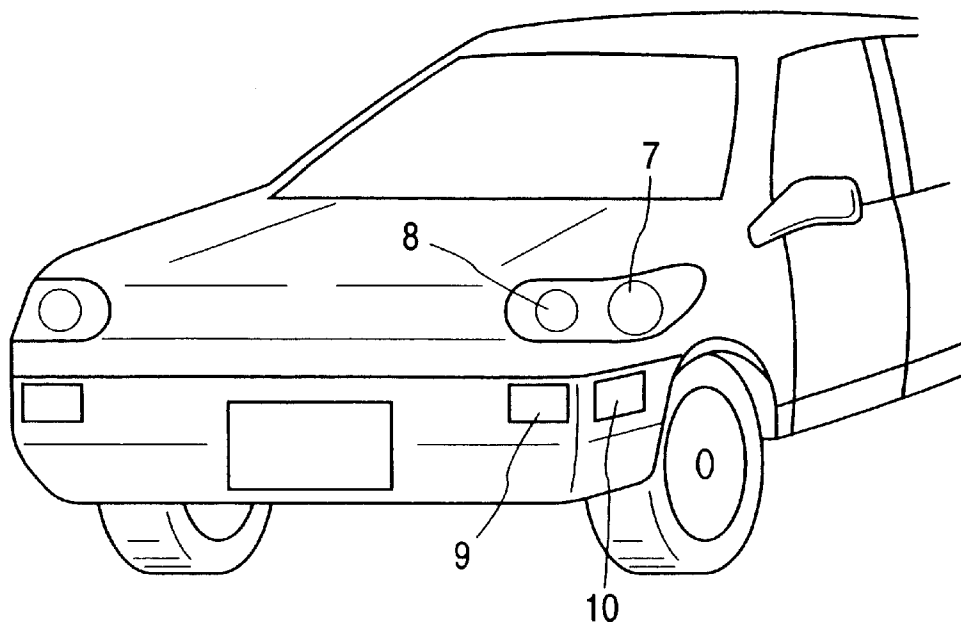

FIG. 3

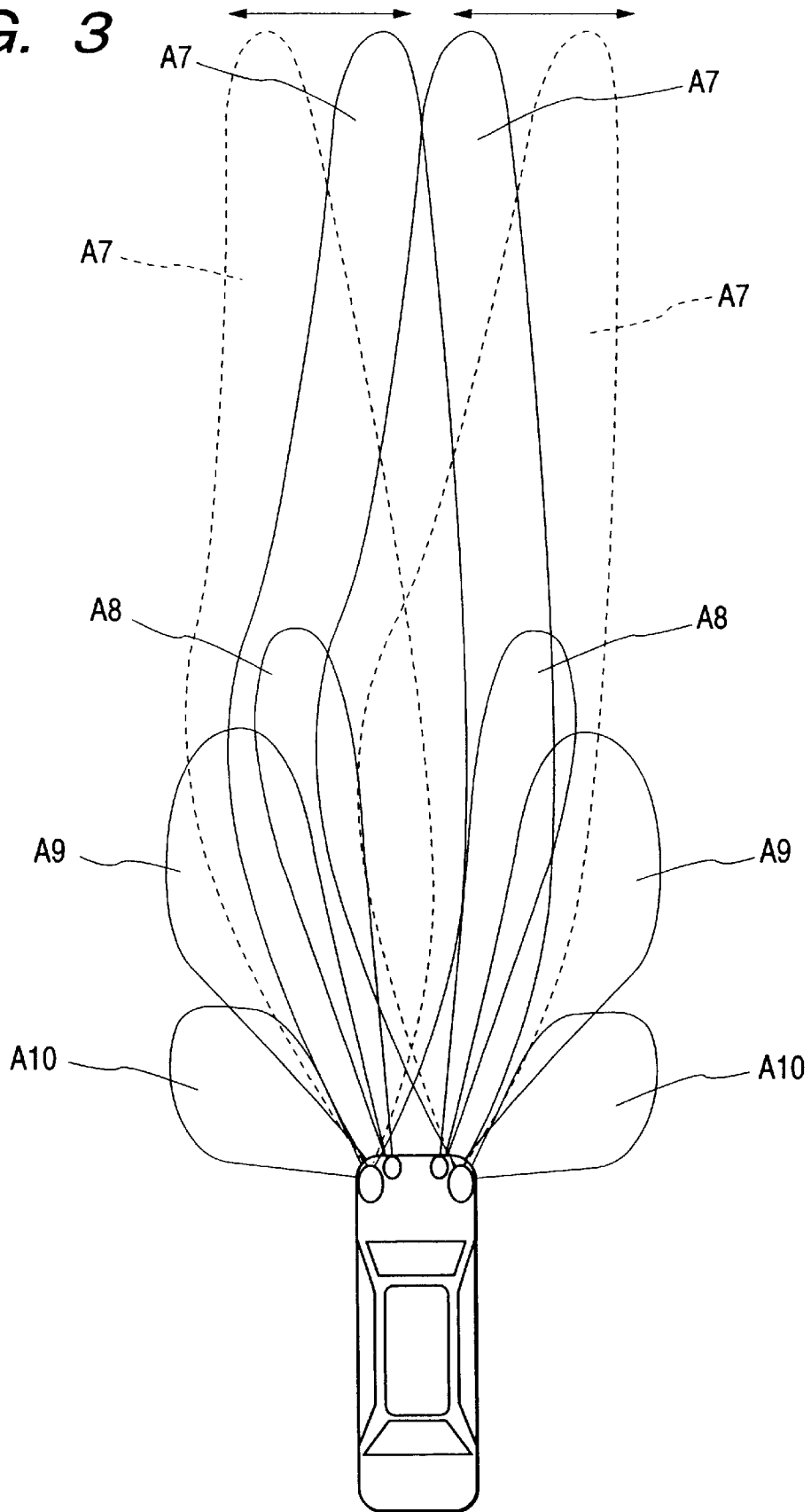

FIG. 4

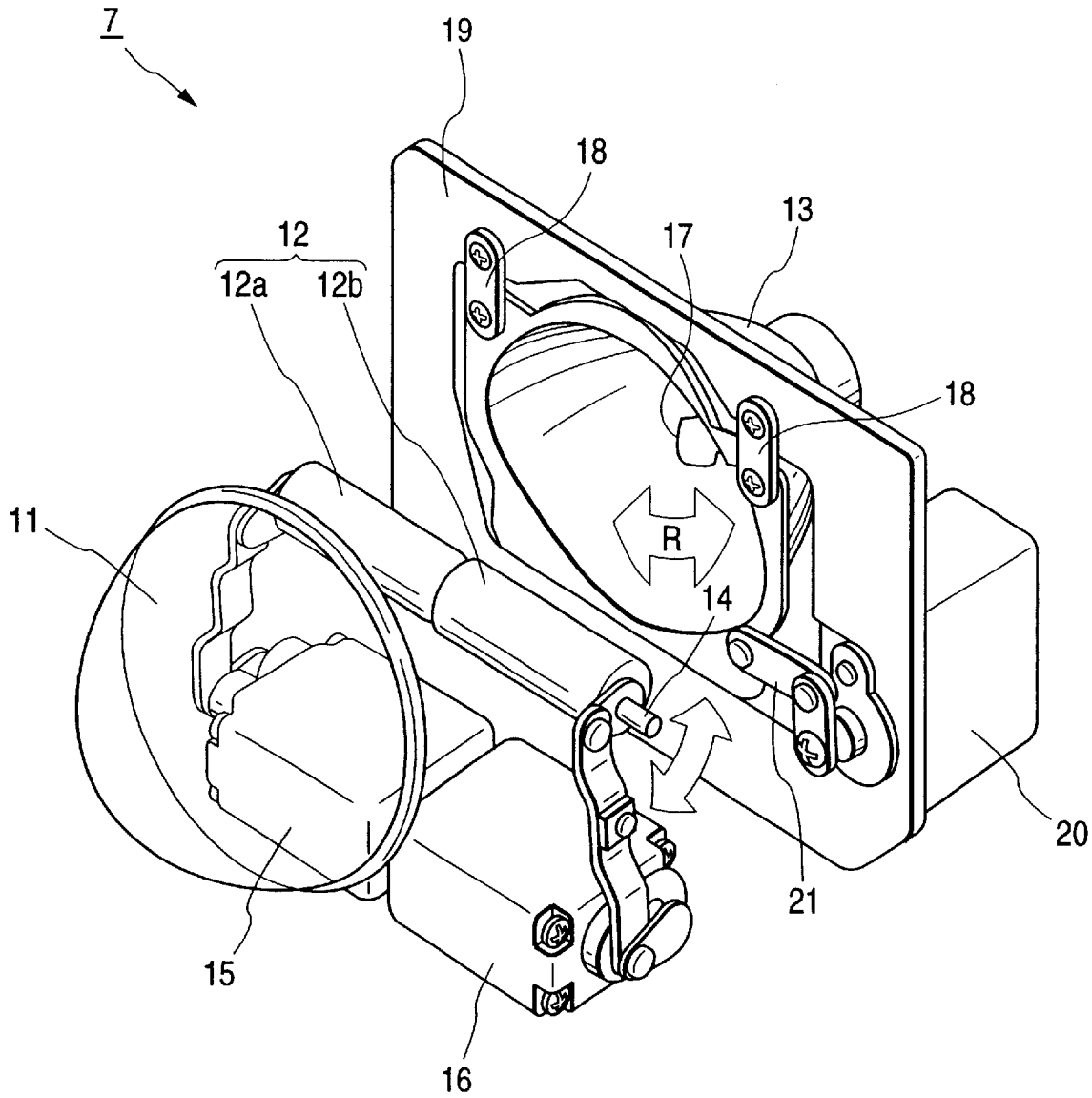

FIG. 5

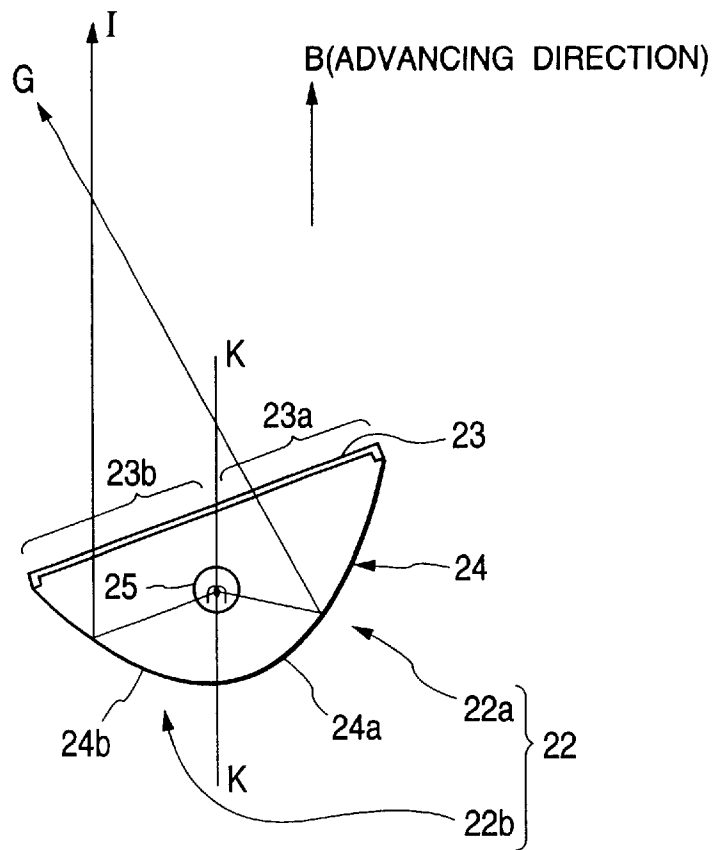
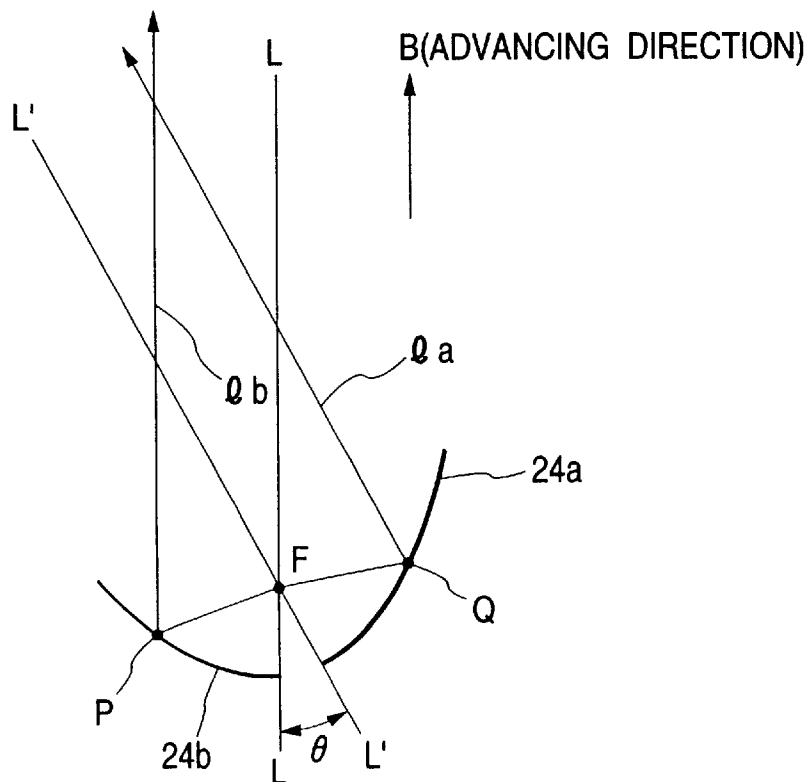

FIG. 6



Explore Litigation Insights

Docket Alarm provides insights to develop a more informed litigation strategy and the peace of mind of knowing you're on top of things.

Real-Time Litigation Alerts



Keep your litigation team up-to-date with **real-time alerts** and advanced team management tools built for the enterprise, all while greatly reducing PACER spend.

Our comprehensive service means we can handle Federal, State, and Administrative courts across the country.

Advanced Docket Research



With over 230 million records, Docket Alarm's cloud-native docket research platform finds what other services can't. Coverage includes Federal, State, plus PTAB, TTAB, ITC and NLRB decisions, all in one place.

Identify arguments that have been successful in the past with full text, pinpoint searching. Link to case law cited within any court document via Fastcase.

Analytics At Your Fingertips



Learn what happened the last time a particular judge, opposing counsel or company faced cases similar to yours.

Advanced out-of-the-box PTAB and TTAB analytics are always at your fingertips.

API

Docket Alarm offers a powerful API (application programming interface) to developers that want to integrate case filings into their apps.

LAW FIRMS

Build custom dashboards for your attorneys and clients with live data direct from the court.

Automate many repetitive legal tasks like conflict checks, document management, and marketing.

FINANCIAL INSTITUTIONS

Litigation and bankruptcy checks for companies and debtors.

E-DISCOVERY AND LEGAL VENDORS

Sync your system to PACER to automate legal marketing.