

## Kraemer et al. '823 Claim 10

10. A **wiper blade** according to claim 1, wherein the claw shaped extensions fittingly engage the upper belt surface (24) and the lower belt surface (22).

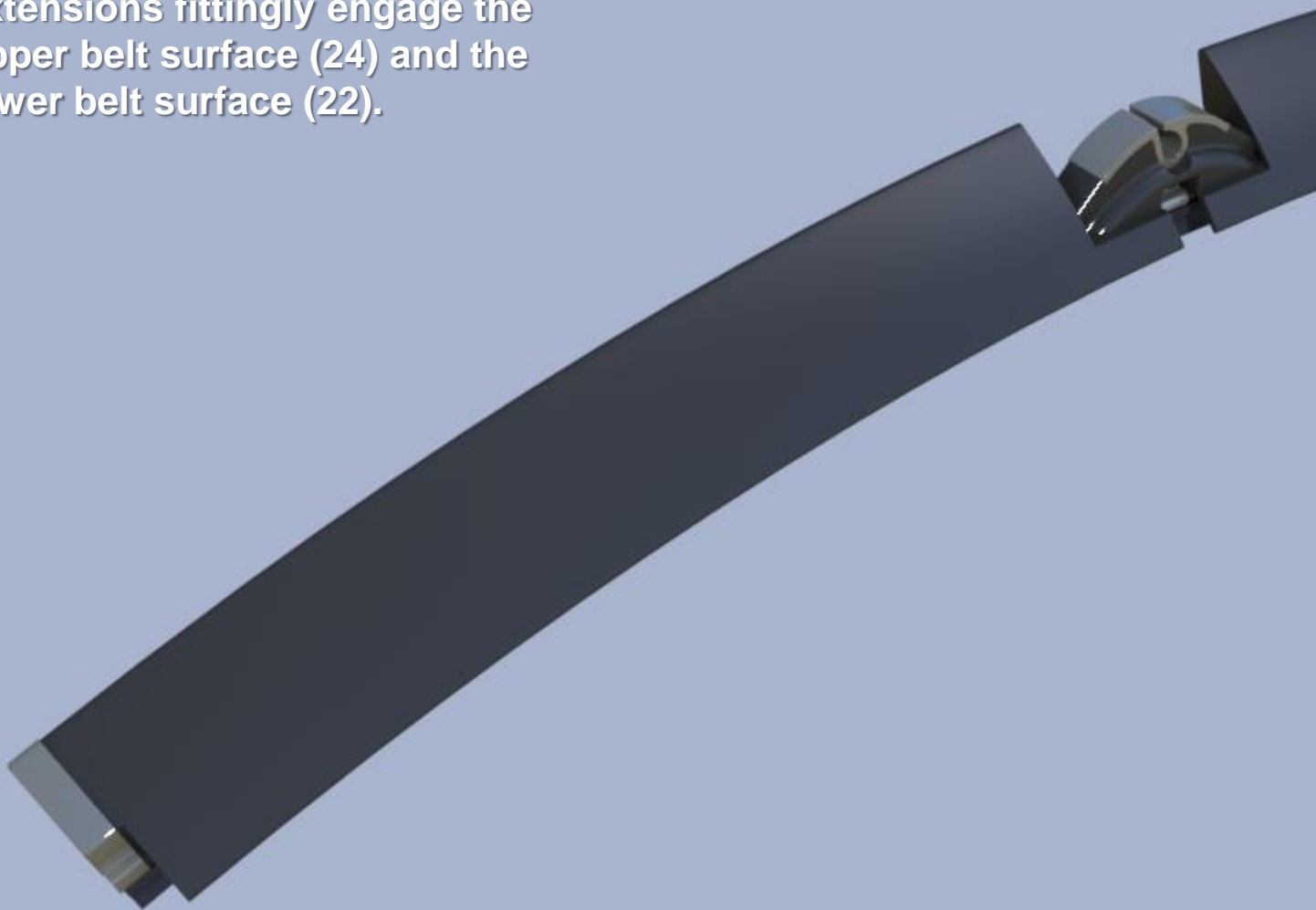

## Kraemer et al. '823 Claim 10

10. A wiper blade according to claim 1, wherein the **claw shaped extensions** fittingly engage the upper belt surface (24) and the lower belt surface (22).



## Kraemer et al. '823 Claim 10

10. A wiper blade according to claim 1, wherein the **claw shaped extensions fittingly engage the upper belt surface (24) and the lower belt surface (22).**

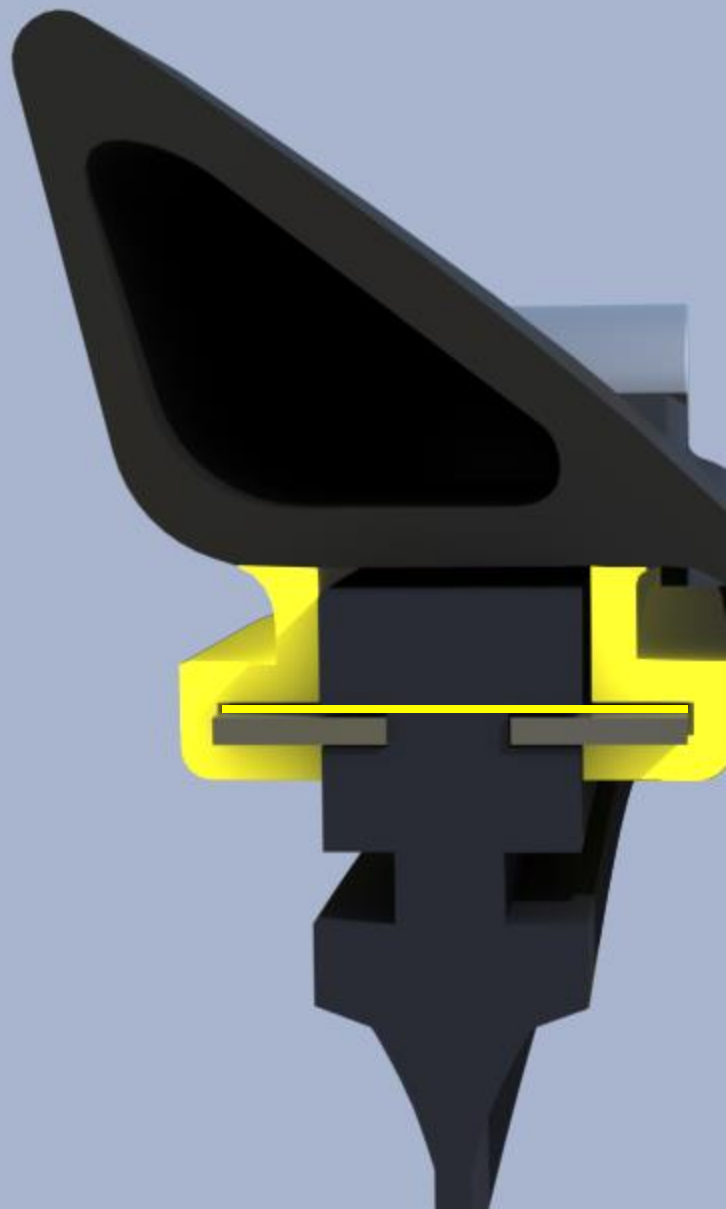

## Kraemer et al. '823 Claim 10

10. A wiper blade according to claim 1, wherein the **claw shaped extensions fittingly engage the upper belt surface (24) and the lower belt surface (22).**

