

Kraemer et al. '823 Claim 6

6. A wiper blade according to claim 5, characterized in that a transition from the harder longitudinal area to the softer longitudinal area occurs near the wall.

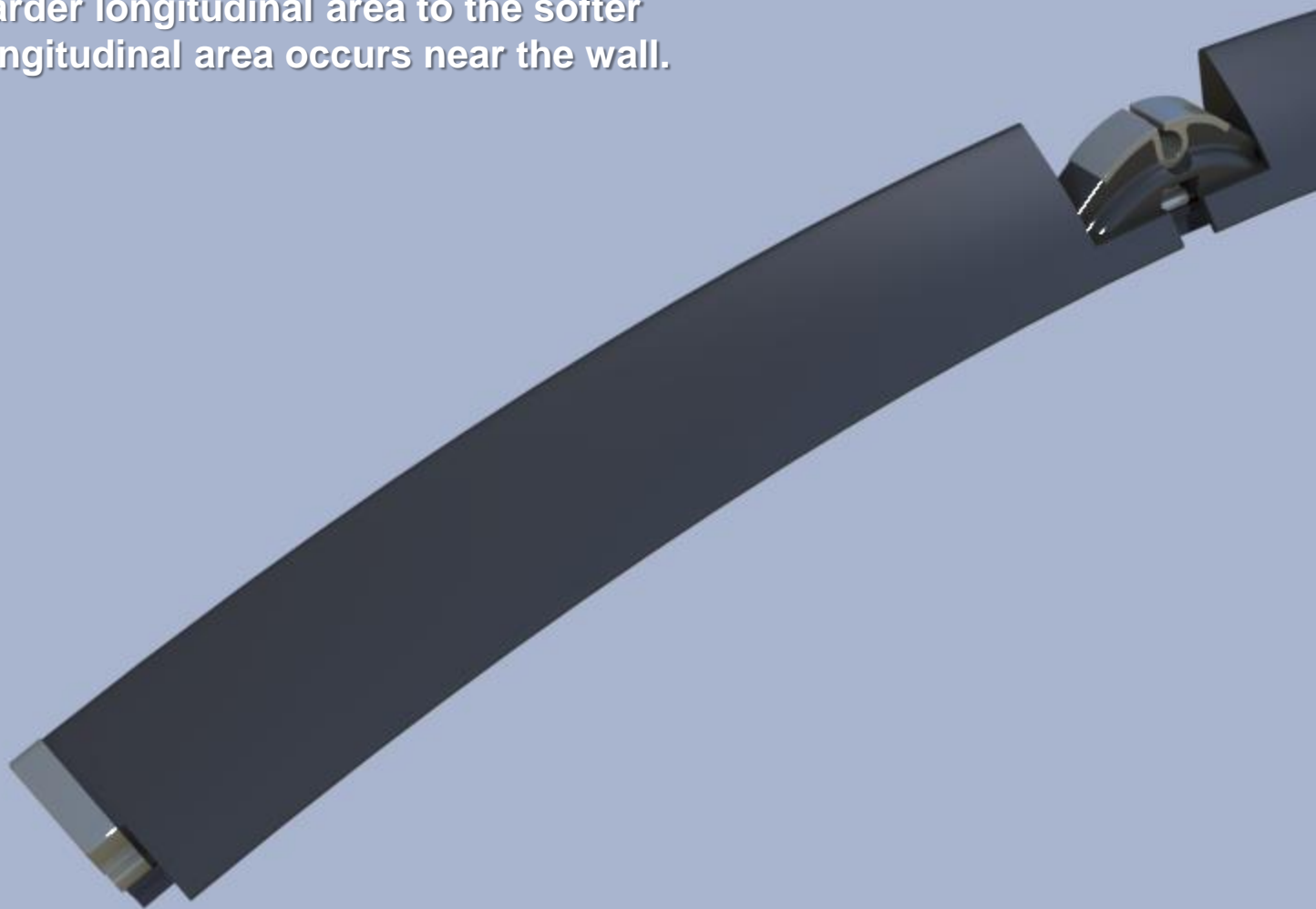

Kraemer et al. '823 Claim 6

6. A wiper blade according to claim 5, characterized in that a transition from the **harder longitudinal area** to the softer longitudinal area occurs near the wall.



Kraemer et al. '823 Claim 6

6. A wiper blade according to claim 5, characterized in that a transition from the harder longitudinal area to the **softer longitudinal area** occurs near the wall.



Kraemer et al. '823 Claim 6

6. A wiper blade according to claim 5, characterized in that a transition from the harder longitudinal area to the softer longitudinal area **occurs near the wall.**

