

The enclosed file history file is stored in electronic form as an Image File Wrapper (IFW). Files that have been converted to the IFW format are only available from the USPTO in electronic form.

This electronic file is in chronological order. Patent references will have been removed if you requested your order with “no references”. Please contact Reed Tech with any questions about your order.



US007434973B2

(12) **United States Patent**
Parker et al.

(10) **Patent No.:** **US 7,434,973 B2**
(45) **Date of Patent:** ***Oct. 14, 2008**

- (54) **LIGHT EMITTING PANEL ASSEMBLIES**
- (75) Inventors: **Jeffery R. Parker**, Strongsville, OH (US); **Gregory A. Coghlan**, Olmsted Falls, OH (US); **Robert M. Ezell**, Copley, OH (US)
- (73) Assignee: **Solid State Opto Limited (VG)**
- (*) Notice: Subject to any disclaimer, the term of this patent is extended or adjusted under 35 U.S.C. 154(b) by 0 days.

This patent is subject to a terminal disclaimer.

(21) Appl. No.: **11/673,302**
(22) Filed: **Feb. 9, 2007**

(65) **Prior Publication Data**
US 2007/0147087 A1 Jun. 28, 2007

Related U.S. Application Data
(60) Continuation of application No. 10/619,815, filed on Jul. 15, 2003, now Pat. No. 7,195,389, which is a continuation of application No. 09/256,275, filed on Feb. 23, 1999, now Pat. No. 6,712,481, which is a continuation-in-part of application No. 08/778,089, filed on Jan. 2, 1997, now Pat. No. 6,079,838, which is a division of application No. 08/495,176, filed on Jun. 27, 1995, now Pat. No. 5,613,751.

- (51) **Int. Cl.**
F21V 7/00 (2006.01)
- (52) **U.S. Cl.** **362/606**; 362/613; 362/618; 362/619
- (58) **Field of Classification Search** 362/800, 362/606-610, 612-613, 617-620, 615, 623-629; 349/65, 63, 62

See application file for complete search history.

(56) **References Cited**

U.S. PATENT DOCUMENTS

3,043,947 A	7/1962	Albinger, Jr.
3,070,913 A	1/1963	Miller
3,328,570 A	6/1967	Balchunas
3,543,014 A	11/1970	Bustad
3,571,585 A	3/1971	Schermerhorn
3,752,974 A	8/1973	Baker et al.
3,761,703 A	9/1973	Mund et al.
3,892,959 A	7/1975	Pulles
3,958,113 A	5/1976	Termohlen
4,043,636 A	8/1977	Eberhardt et al.
4,118,111 A	10/1978	Laesser
4,177,501 A	12/1979	Karlin
4,183,628 A	1/1980	Laesser
4,257,084 A	3/1981	Reynolds

(Continued)

Primary Examiner—Sandra O'Shea
Assistant Examiner—Bao Q Truong
(74) *Attorney, Agent, or Firm*—Renner, Otto, Boisselle & Sklar, LLP

(57) **ABSTRACT**

Light emitting panel assemblies include a light emitting panel member having at least one light source optically coupled to a portion of an input edge of the panel member. A plurality of individual light extracting deformities on or in at least one panel surface of the panel member are of well defined shape and have a length and width substantially smaller than the length and width of the panel surface. At least some of the deformities have at least one surface that is angled at different orientations relative to the input edge depending on the location of the deformities on the panel surface to face a portion of the input edge to which a light source is optically coupled.

14 Claims, 14 Drawing Sheets

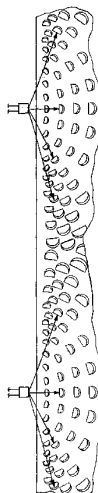

U.S. PATENT DOCUMENTS

4,282,560 A	8/1981	Kringel et al.	5,467,208 A	11/1995	Kokawa et al.
4,290,093 A	9/1981	Thompson et al.	5,467,417 A	11/1995	Nakamura et al.
4,446,508 A	5/1984	Kinzie	5,485,291 A	1/1996	Qiao et al.
4,460,940 A *	7/1984	Mori 362/558	5,506,929 A	4/1996	Tai et al.
4,542,449 A	9/1985	Whitehead	5,521,342 A	5/1996	Barley et al.
4,573,766 A	3/1986	Bournay, Jr. et al.	5,576,078 A	11/1996	Schatz
4,630,895 A	12/1986	Abdala, Jr. et al.	5,579,134 A	11/1996	Lengyel
4,714,983 A	12/1987	Lang	5,590,945 A	1/1997	Simms
4,729,185 A	3/1988	Baba	5,598,281 A	1/1997	Zimmerman et al.
4,751,615 A	6/1988	Abrams	5,600,462 A	2/1997	Suzuki et al.
4,763,984 A	8/1988	Awai et al.	5,618,095 A	4/1997	Kashima et al.
4,765,701 A	8/1988	Cheslak	5,649,754 A	7/1997	Matsumoto
4,906,070 A	3/1990	Cobb, Jr.	5,664,862 A	9/1997	Redmond et al.
4,974,122 A	11/1990	Shaw	5,671,994 A	9/1997	Tai et al.
4,975,808 A	12/1990	Bond et al.	5,711,592 A	1/1998	Hotta
4,978,952 A	12/1990	Irwin	5,719,649 A *	2/1998	Shono et al. 349/65
5,005,108 A	4/1991	Pristash et al.	5,771,328 A	6/1998	Wortman et al.
5,027,258 A	6/1991	Schoniger et al.	5,775,791 A	7/1998	Yoshikawa et al.
5,056,892 A	10/1991	Cobb, Jr.	5,779,337 A	7/1998	Saito et al.
5,070,431 A	12/1991	Kitazawa et al.	5,779,338 A	7/1998	Ishikawa et al.
5,093,765 A	3/1992	Kashima et al.	5,808,784 A	9/1998	Ando et al.
5,134,549 A	7/1992	Yokoyama	5,844,720 A	12/1998	Ohara et al.
5,136,483 A	8/1992	Schoniger et al.	5,890,791 A	4/1999	Saito
5,178,447 A	1/1993	Murase et al.	5,917,664 A	6/1999	O'Neill et al.
5,207,493 A	5/1993	Murase et al.	5,919,551 A	7/1999	Cobb, Jr. et al.
5,262,928 A	11/1993	Kashima et al.	5,931,555 A	8/1999	Akahane et al.
5,283,673 A	2/1994	Murase et al.	5,961,198 A	10/1999	Hira et al.
5,303,322 A	4/1994	Winston et al.	5,971,559 A	10/1999	Ishikawa et al.
5,307,244 A	4/1994	Gaudette	6,011,602 A	1/2000	Miyashita et al.
5,339,179 A	8/1994	Rudisill et al.	6,036,329 A	3/2000	Iimura
5,349,503 A	9/1994	Blonder et al.	6,091,547 A	7/2000	Gardiner et al.
5,375,043 A *	12/1994	Tokunaga 362/601	6,120,280 A	9/2000	Mimura et al.
5,377,084 A	12/1994	Kojima et al.	6,130,730 A	10/2000	Jansson et al.
5,390,085 A	2/1995	Mari-Roca et al.	6,151,169 A	11/2000	Kim
5,394,308 A	2/1995	Watanabe et al.	6,172,809 B1	1/2001	Koike et al.
5,396,350 A *	3/1995	Beeson et al. 349/62	7,195,389 B2 *	3/2007	Parker et al. 362/606
5,442,523 A	8/1995	Kashima et al.			

* cited by examiner

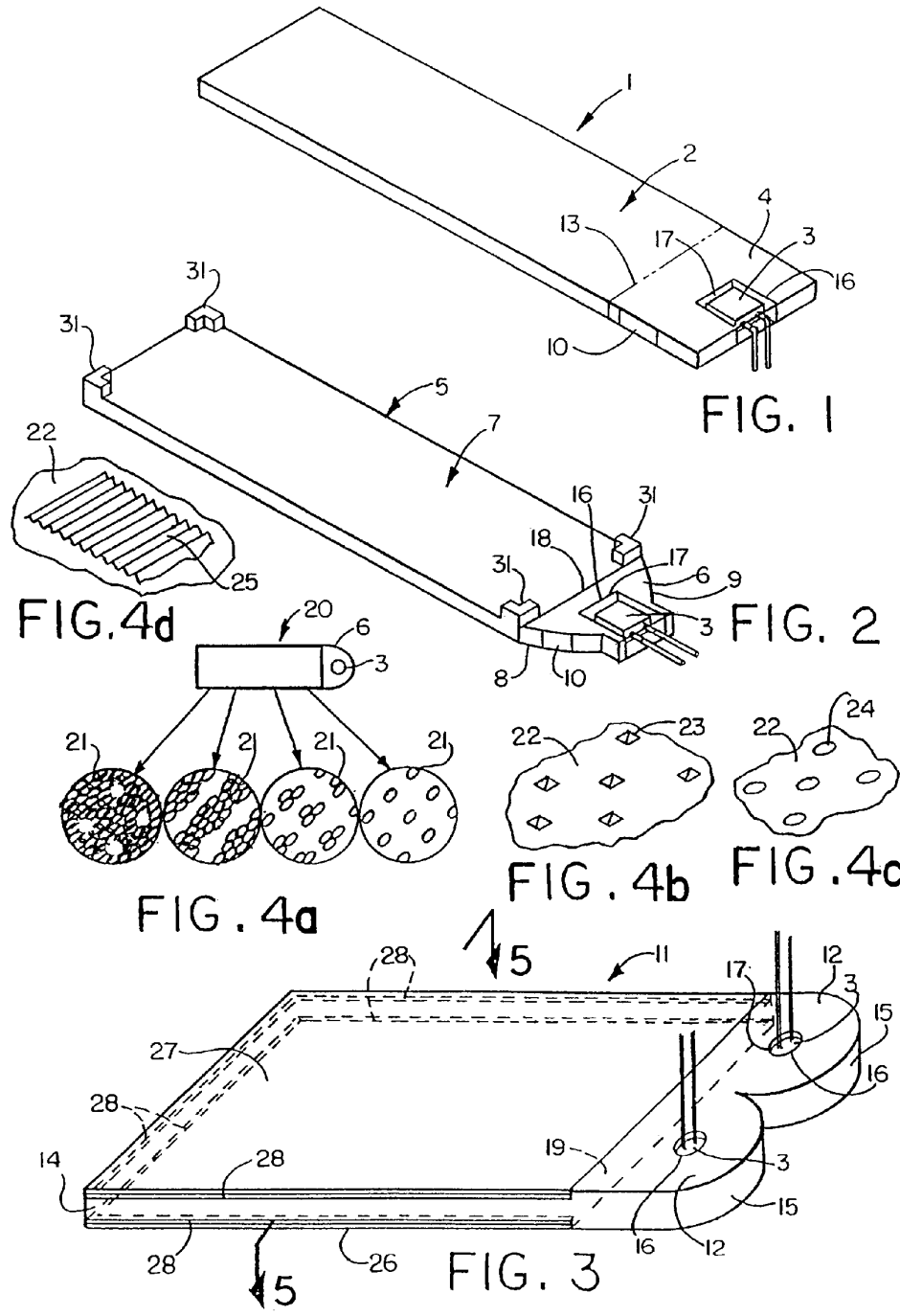

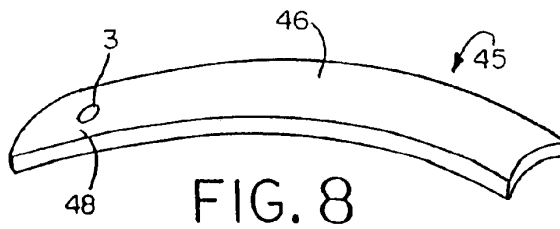
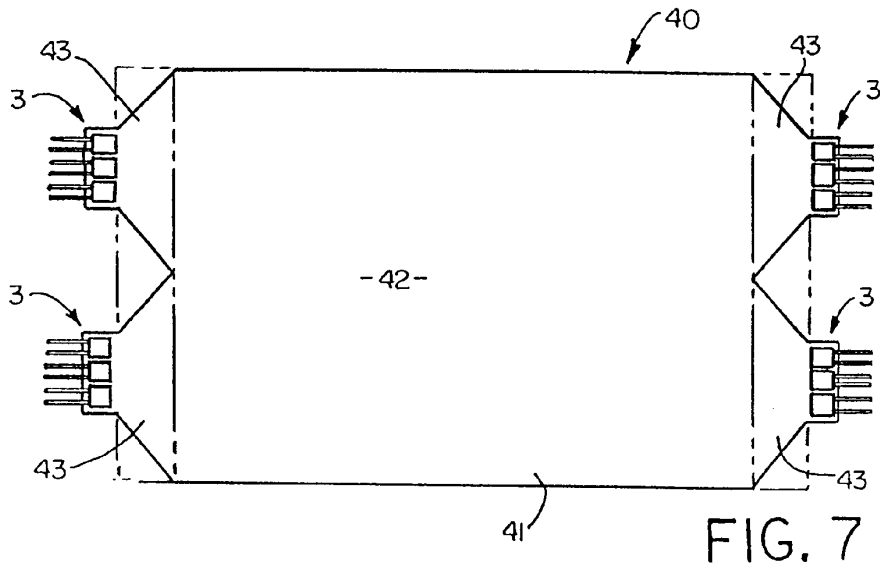
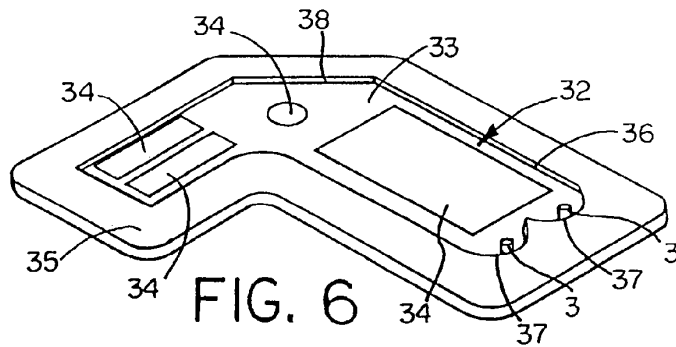
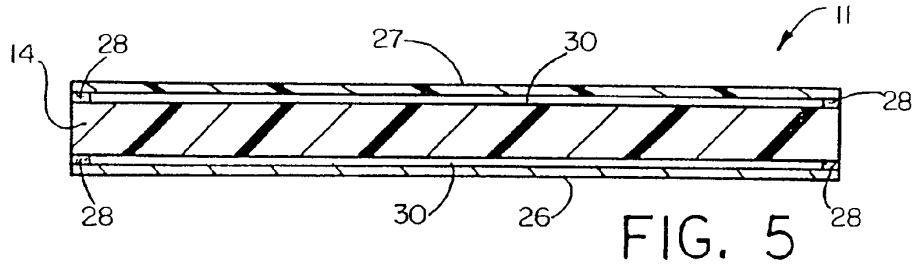

Explore Litigation Insights

Docket Alarm provides insights to develop a more informed litigation strategy and the peace of mind of knowing you're on top of things.

Real-Time Litigation Alerts



Keep your litigation team up-to-date with **real-time alerts** and advanced team management tools built for the enterprise, all while greatly reducing PACER spend.

Our comprehensive service means we can handle Federal, State, and Administrative courts across the country.

Advanced Docket Research



With over 230 million records, Docket Alarm's cloud-native docket research platform finds what other services can't. Coverage includes Federal, State, plus PTAB, TTAB, ITC and NLRB decisions, all in one place.

Identify arguments that have been successful in the past with full text, pinpoint searching. Link to case law cited within any court document via Fastcase.

Analytics At Your Fingertips



Learn what happened the last time a particular judge, opposing counsel or company faced cases similar to yours.

Advanced out-of-the-box PTAB and TTAB analytics are always at your fingertips.

API

Docket Alarm offers a powerful API (application programming interface) to developers that want to integrate case filings into their apps.

LAW FIRMS

Build custom dashboards for your attorneys and clients with live data direct from the court.

Automate many repetitive legal tasks like conflict checks, document management, and marketing.

FINANCIAL INSTITUTIONS

Litigation and bankruptcy checks for companies and debtors.

E-DISCOVERY AND LEGAL VENDORS

Sync your system to PACER to automate legal marketing.