



[54] PROGRAMMABLE VEHICLE MONITORING AND SECURITY SYSTEM HAVING MULTIPLE ACCESS VERIFICATION DEVICES

[75] Inventors: Sam Johnson, Sugarhill; Cecil W. Ashe, Eatontoh; Jesse B. Yates, Atlanta, all of Ga.

[73] Assignee: Mobile Security Communications, Inc., Norcross, Ga.

[21] Appl. No.: 153,140

[22] Filed: Nov. 16, 1993

[51] Int. Cl.⁶ B60R 25/10

[52] U.S. Cl. 340/426; 340/825.34; 340/825.36; 340/825.49; 342/450; 342/386

[58] Field of Search 340/457, 426, 340/430, 425.5, 825.36, 825.34, 825.49, 825.31, 427, 428, 429; 342/450, 388, 386

[56] References Cited

U.S. PATENT DOCUMENTS

3,665,312	5/1972	Jarvis	325/54
4,067,411	1/1978	Conley et al.	180/114
4,177,466	12/1979	Reagan	343/112 TC
4,651,157	3/1987	Gray et al.	340/426
4,688,026	8/1987	Scribner et al.	340/572
4,754,255	6/1988	Sanders et al.	340/430
4,811,013	3/1989	Akutsu	340/825.31
4,845,464	7/1989	Drori et al.	340/429
4,887,064	12/1989	Drori et al.	340/426
4,891,650	1/1990	Sheffer	342/457
4,901,650	2/1990	Mitchell	340/426
4,922,224	5/1990	Drori et al.	340/428
4,924,699	5/1990	Kuroda et al.	73/178 R
4,933,664	6/1990	Igawa et al.	340/426
5,014,206	5/1991	Scribner et al.	364/449
5,023,901	6/1991	Sloan et al.	340/539
5,032,845	7/1991	Velasco	342/357
5,043,736	8/1991	Darnell et al.	342/347
5,081,667	1/1992	Drori et al.	379/59

5,103,459	4/1992	Gilhousen et al.	371/1
5,131,019	7/1992	Sheffer et al.	379/39
5,134,644	7/1992	Garton et al.	379/39
5,140,308	8/1992	Tanaka	340/539
5,146,215	9/1992	Drori	340/825.32
5,155,689	10/1992	Wortham	364/460
5,157,375	10/1992	Drori	340/429
5,181,010	1/1993	Chick	340/426
5,223,844	6/1993	Mansell et al.	342/457
5,259,025	11/1993	Monroe et al.	340/825.31
5,334,974	8/1994	Simms et al.	340/426
5,432,495	7/1995	Tompkins	340/429

Primary Examiner—John K. Peng
Assistant Examiner—Benjamin C. Lee
Attorney, Agent, or Firm—Jones & Askew

[57] ABSTRACT

A security system having two-way communication with a central monitoring station. The security system is equipped with a computerized control and communications unit. The control and communications unit is connected to a position determination device and to a calling unit. The control and communications unit is also connected to several intrusion detection devices. Upon direction of the control and communications unit, for example, in response to the detection of a violation of an intrusion detection device, the calling unit establishes a communications link with the central monitoring station and communicates thereto the status and location of the vehicle in which the security system is located. The control and communication device is operable to receive commands from a handset electrically connected thereto. The central monitoring station, by communicating with the control and communications unit, is operable to control functional units of the vehicle. The central monitoring station includes a display on which maps showing the location of vehicles in communication with the monitoring station and information about such vehicles. An operator at the monitoring station may direct equipment in the monitoring station to initiate calls to law enforcement organizations and emergency response vehicles. Other systems and methods are disclosed.

10 Claims, 36 Drawing Sheets

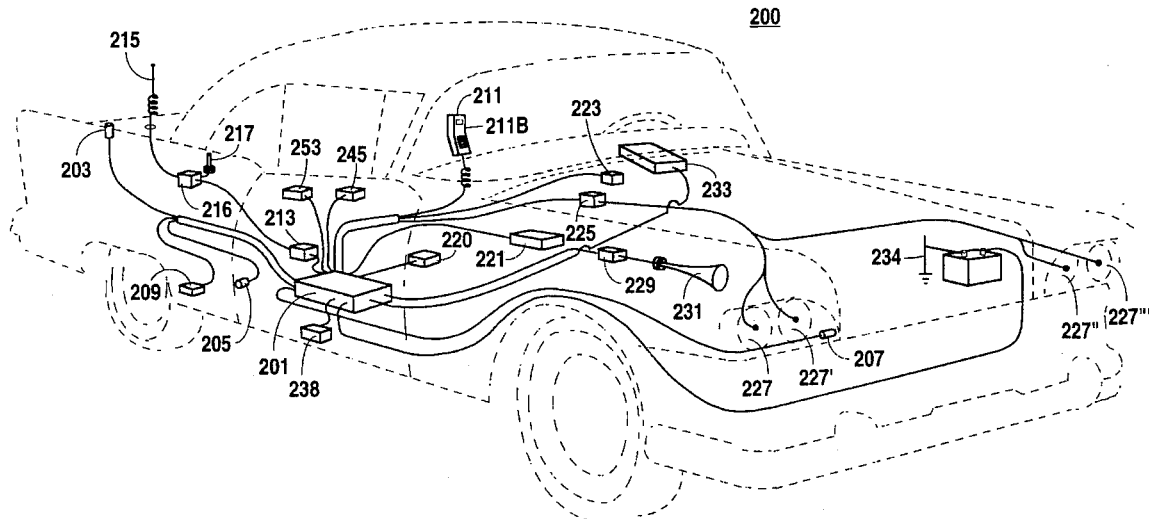

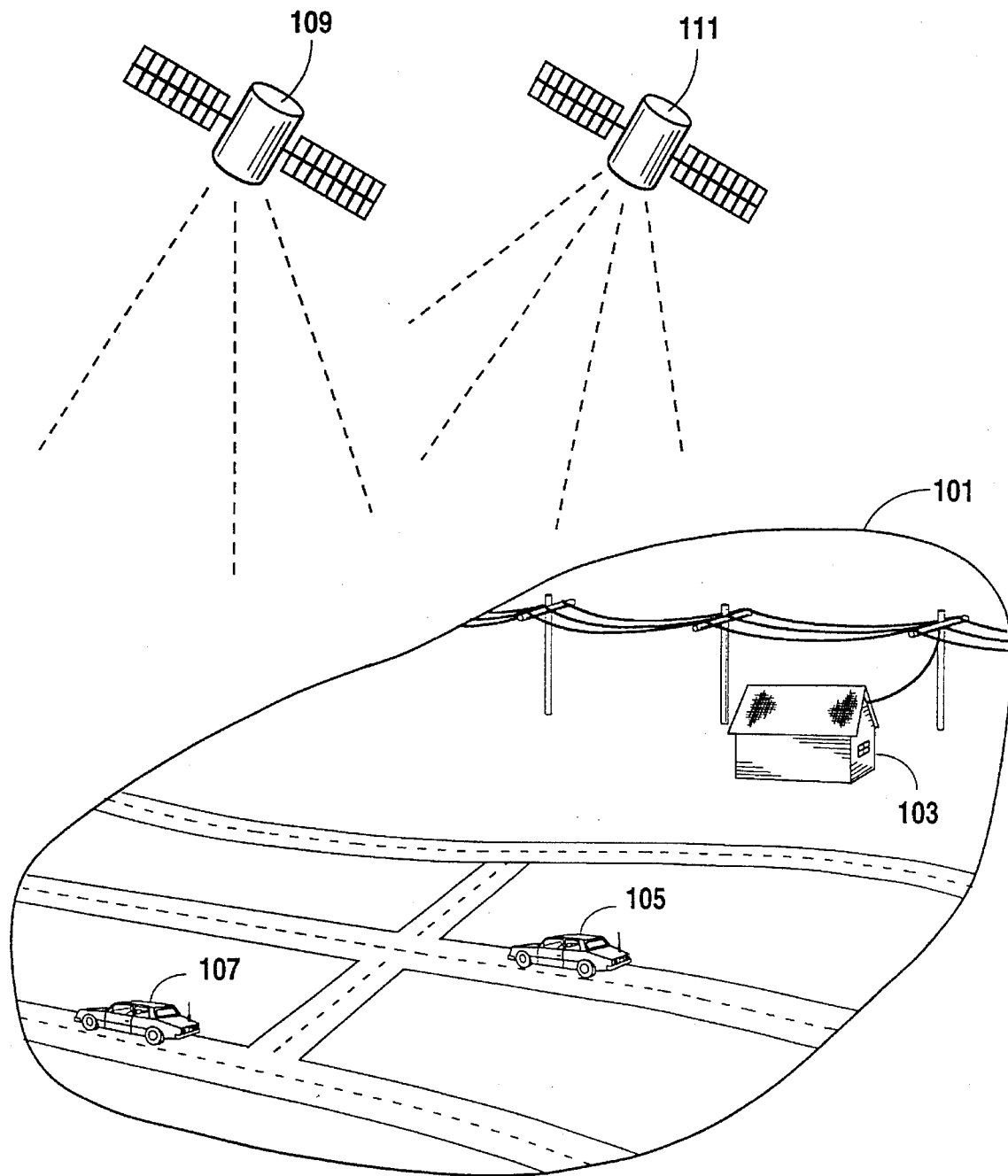

Fig. 1

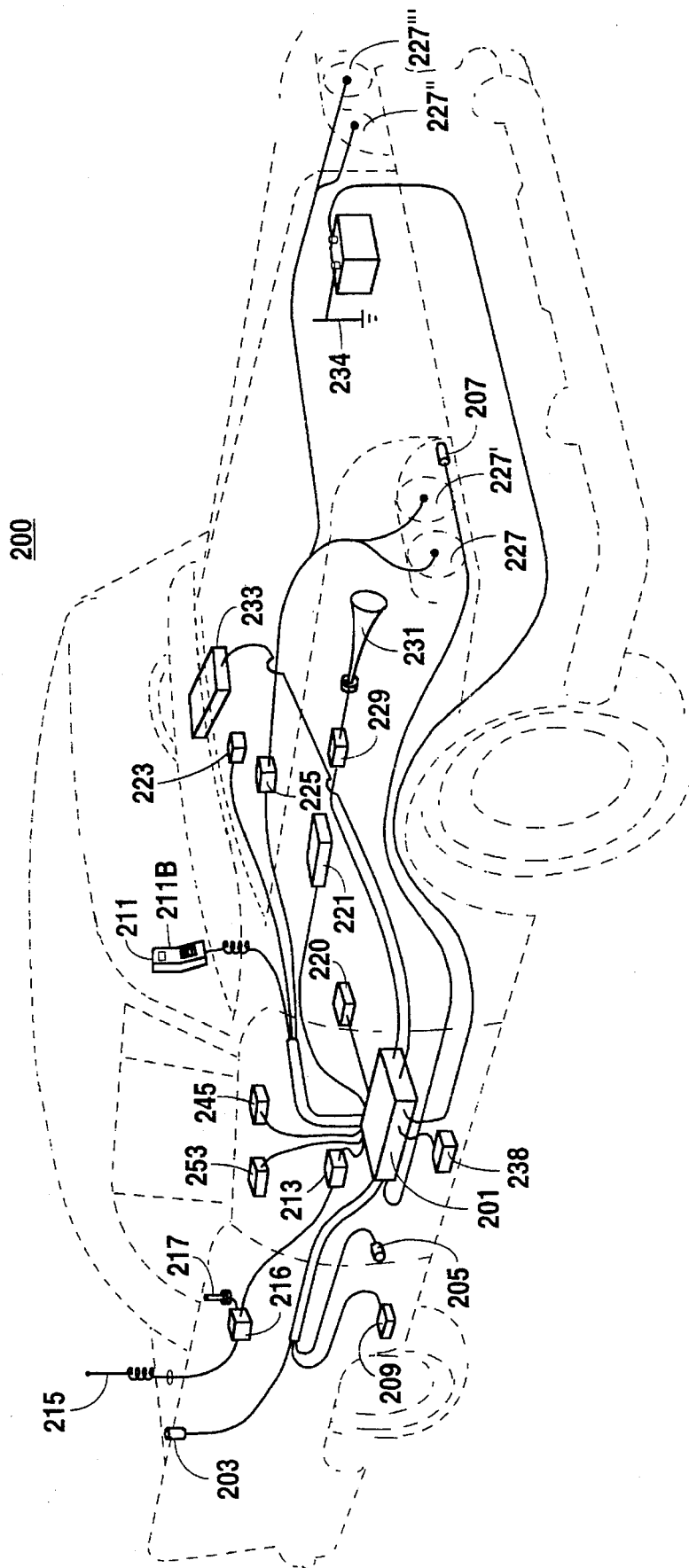

FIG. 2

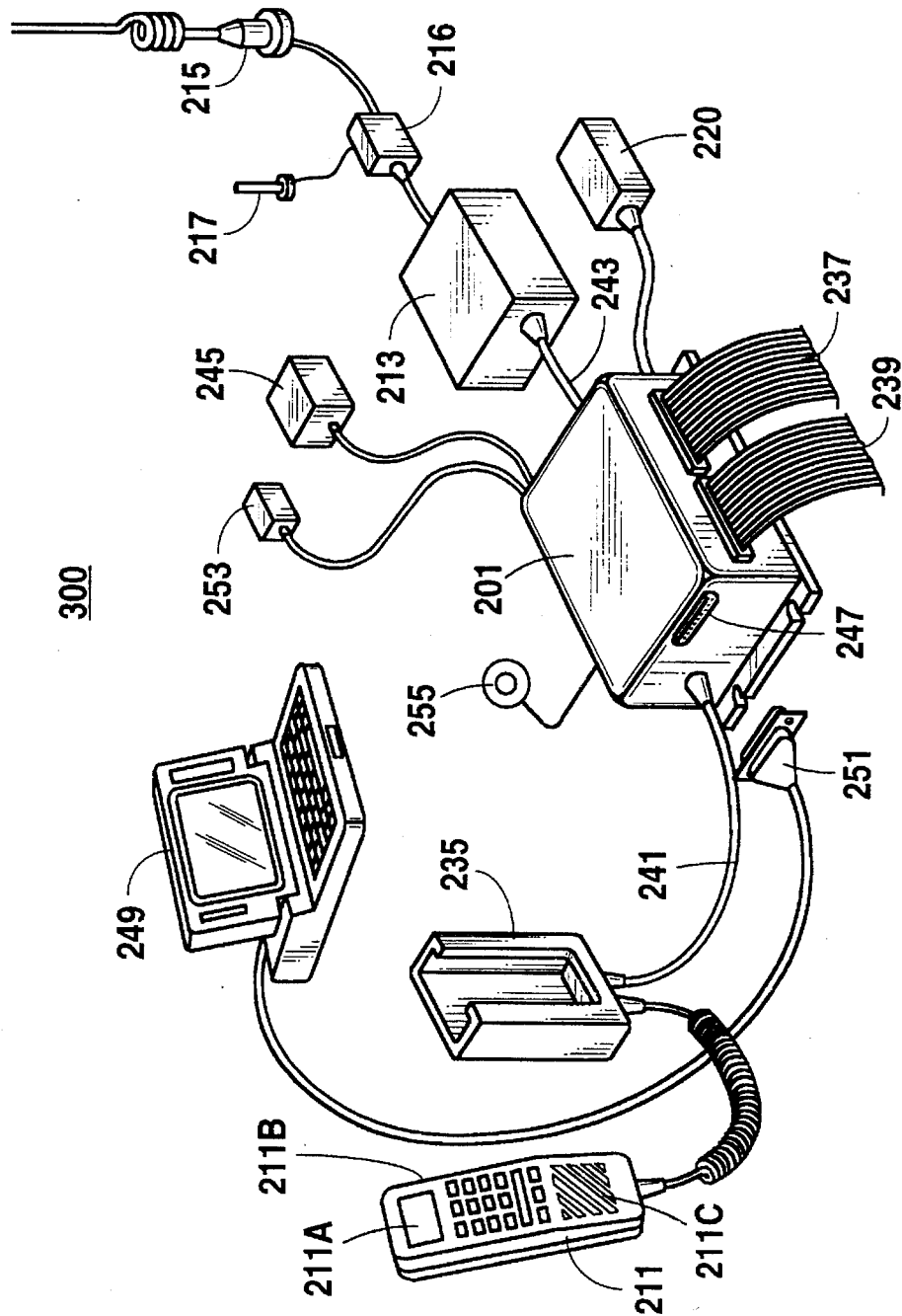

Fig. 3

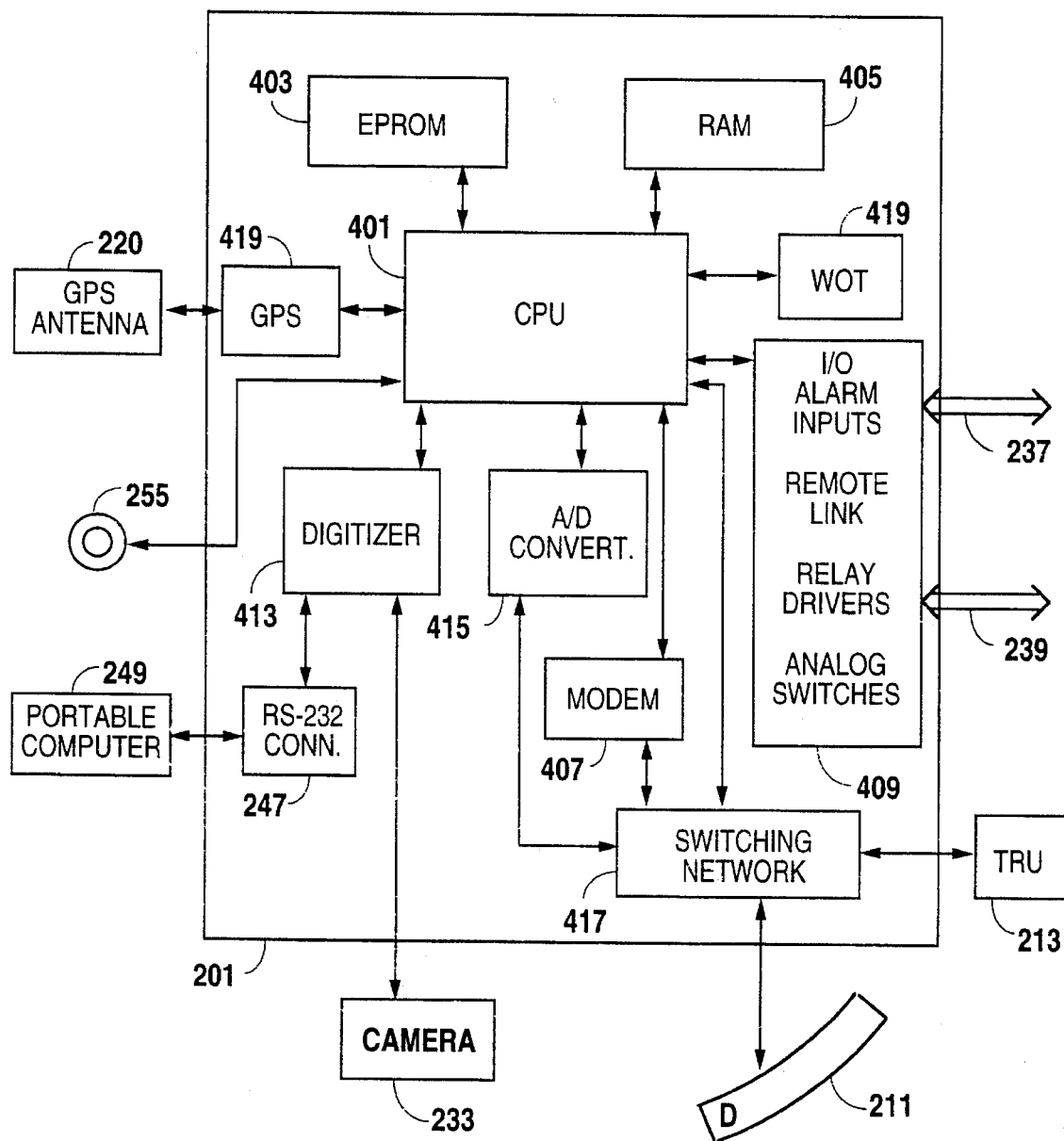

Fig. 4A

Explore Litigation Insights

Docket Alarm provides insights to develop a more informed litigation strategy and the peace of mind of knowing you're on top of things.

Real-Time Litigation Alerts



Keep your litigation team up-to-date with **real-time alerts** and advanced team management tools built for the enterprise, all while greatly reducing PACER spend.

Our comprehensive service means we can handle Federal, State, and Administrative courts across the country.

Advanced Docket Research



With over 230 million records, Docket Alarm's cloud-native docket research platform finds what other services can't. Coverage includes Federal, State, plus PTAB, TTAB, ITC and NLRB decisions, all in one place.

Identify arguments that have been successful in the past with full text, pinpoint searching. Link to case law cited within any court document via Fastcase.

Analytics At Your Fingertips



Learn what happened the last time a particular judge, opposing counsel or company faced cases similar to yours.

Advanced out-of-the-box PTAB and TTAB analytics are always at your fingertips.

API

Docket Alarm offers a powerful API (application programming interface) to developers that want to integrate case filings into their apps.

LAW FIRMS

Build custom dashboards for your attorneys and clients with live data direct from the court.

Automate many repetitive legal tasks like conflict checks, document management, and marketing.

FINANCIAL INSTITUTIONS

Litigation and bankruptcy checks for companies and debtors.

E-DISCOVERY AND LEGAL VENDORS

Sync your system to PACER to automate legal marketing.