



(12) **United States Patent**
Peters et al.

(10) **Patent No.:** **US 7,114,510 B2**
(45) **Date of Patent:** **Oct. 3, 2006**

(54) **VALVE WITH SMART HANDLE**
(75) Inventors: **Mark E. Peters**, Hamilton, OH (US);
Gregory W. Popp, Lebanon, OH (US)
(73) Assignees: **INO Therapeutics, Inc.**, Clinton, NJ
(US); **Ventek LLC**, West Chester, OH
(US)
(*) Notice: Subject to any disclaimer, the term of this
patent is extended or adjusted under 35
U.S.C. 154(b) by 237 days.

(56) **References Cited**
U.S. PATENT DOCUMENTS
5,202,666 A * 4/1993 Knippscheer 340/573.1
5,409,037 A 4/1995 Wheeler et al.
5,441,070 A * 8/1995 Thompson 137/1
5,680,329 A 10/1997 Lloyd et al.
5,945,910 A * 8/1999 Gorra 340/573.1
6,003,170 A * 12/1999 Humpert et al. 4/623
6,236,317 B1 * 5/2001 Cohen et al. 340/573.1

FOREIGN PATENT DOCUMENTS
EP 0961065 12/1991
WO WO 9836245 8/1998

(21) Appl. No.: **10/416,870**
(22) PCT Filed: **Nov. 15, 2001**
(86) PCT No.: **PCT/US01/45519**
§ 371 (c)(1),
(2), (4) Date: **May 15, 2003**
(87) PCT Pub. No.: **WO02/40914**
PCT Pub. Date: **May 23, 2002**

* cited by examiner
Primary Examiner—A. Michael Chambers
(74) *Attorney, Agent, or Firm*—Gibbons, Del Deo, Dolan,
Griffinger and Vecchione

(65) **Prior Publication Data**
US 2004/0045608 A1 Mar. 11, 2004

(57) **ABSTRACT**

A valve with a smart handle including a memory module to log relevant data. A sensor on the handle determines when the valve is open, and this triggers the start of timers and recording of the “open” event in a log in the memory module. When the valve is closed, the sensor triggers stopping of the timers and recording of the “closed” event in the log. The timer information is used to calculate the duration of the time “open” event, and this, together with the actual date and time of the opening and closing of the valve are recorded in the log. Other relevant information, such as cylinder fill date, cylinder I.D. number, batch number, and patient name or account number may also be logged in the memory module. The log of the events and the corresponding dates and times may be used to prepare invoices for billing gas treatments, for inventory control, and for other record-keeping and control functions.

Related U.S. Application Data
(60) Provisional application No. 60/249,765, filed on Nov. 17, 2000.
(51) **Int. Cl.**
F16K 37/00 (2006.01)
(52) **U.S. Cl.** **137/1; 137/552.7; 251/129.04;**
4/623
(58) **Field of Classification Search** **137/552.7;**
137/1; 4/623; 251/129.04
See application file for complete search history.

18 Claims, 12 Drawing Sheets

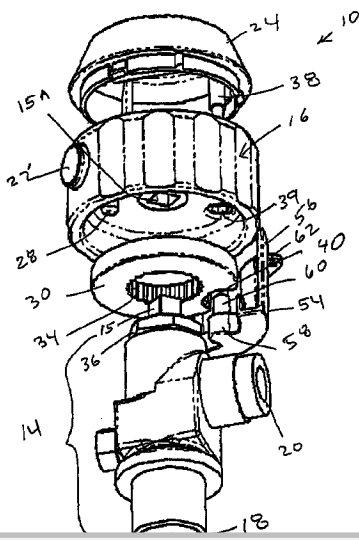

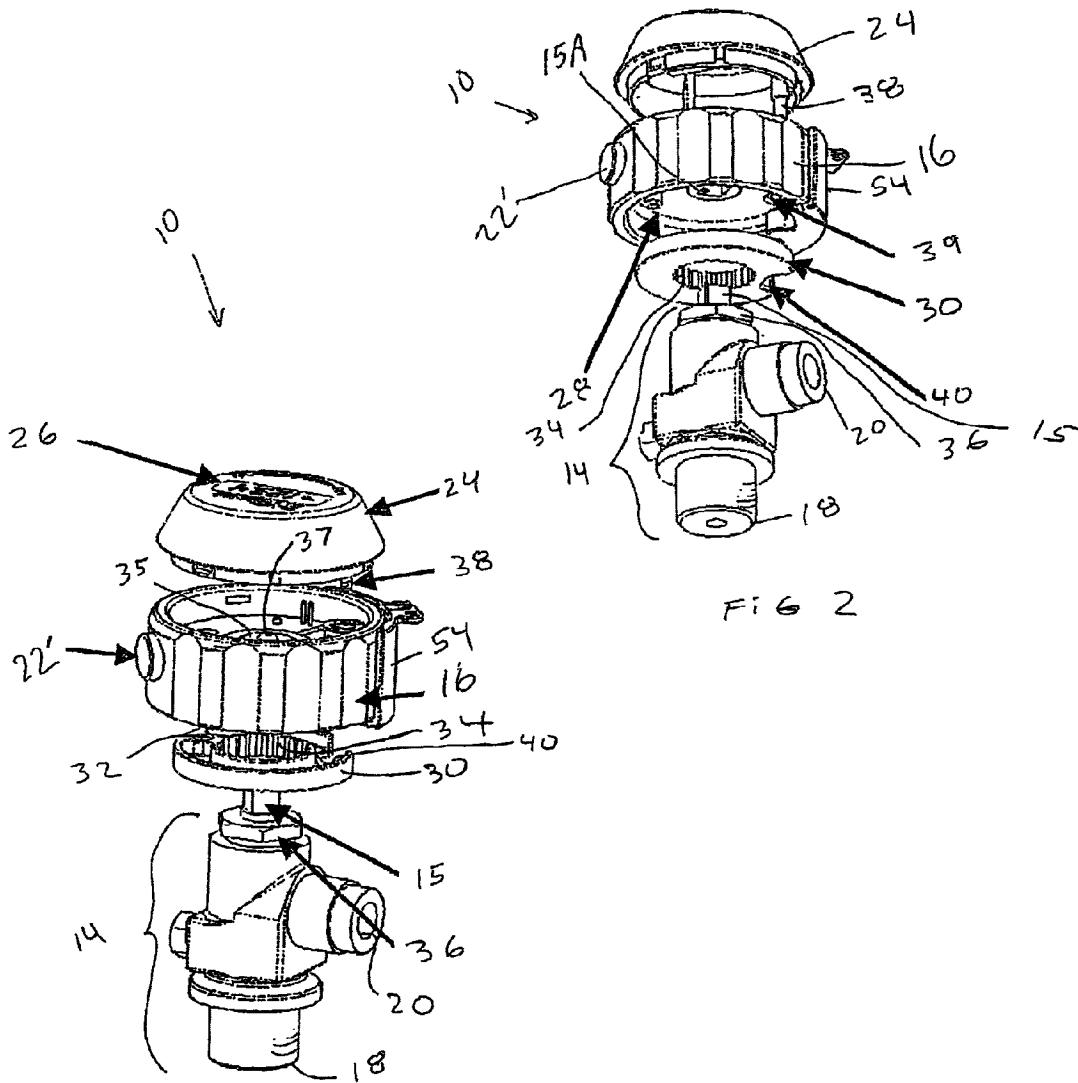

FIG 1

FIG 2

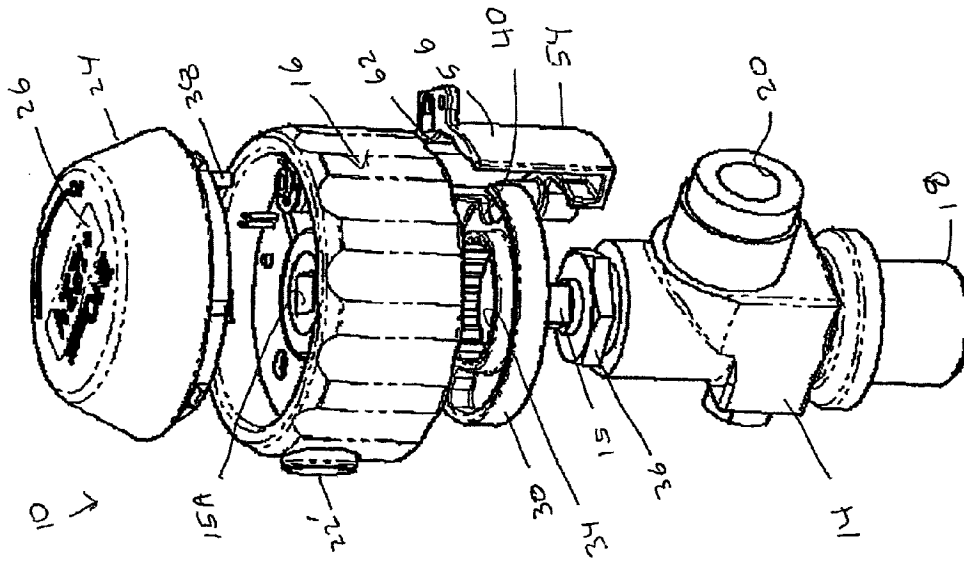

FIG 2A

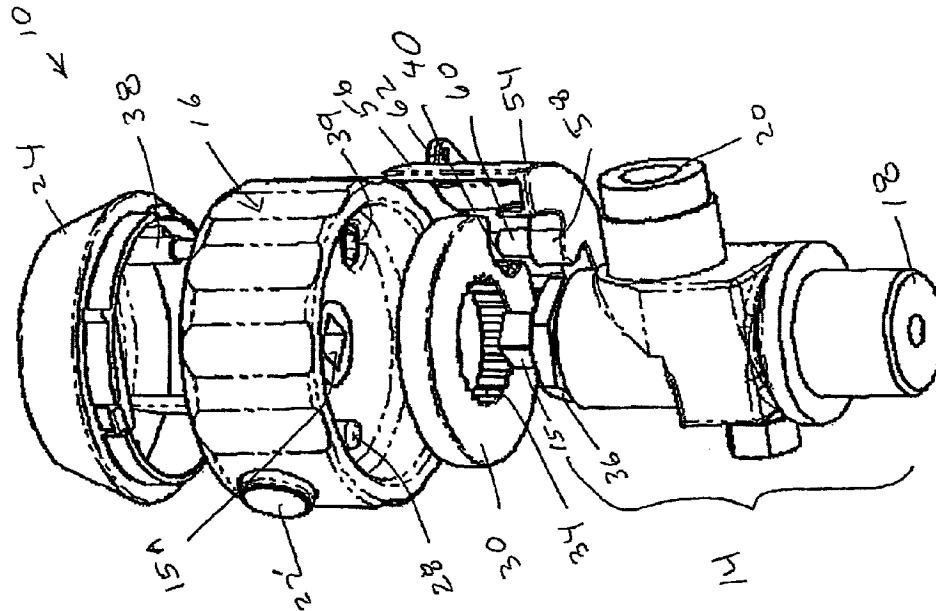

FIG 1A

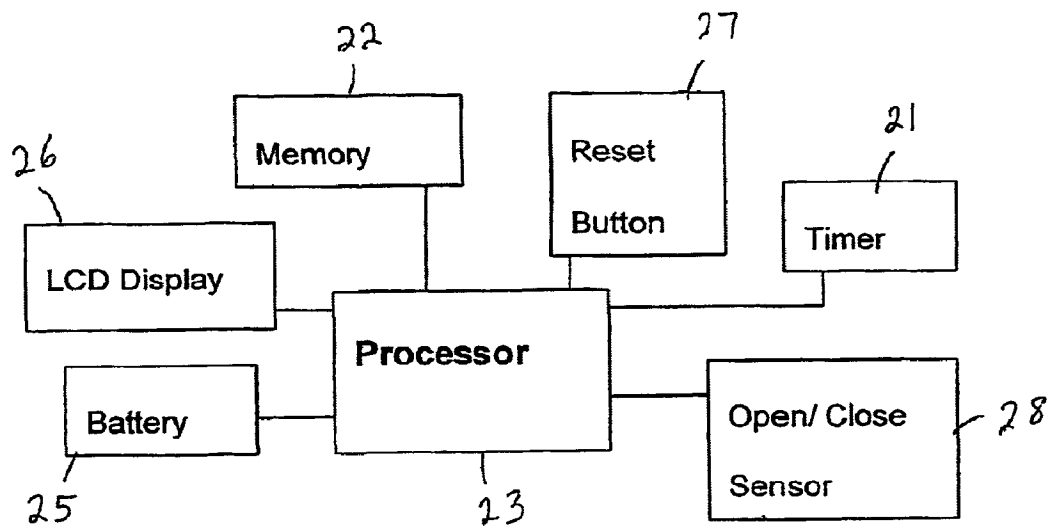

FIG 2B

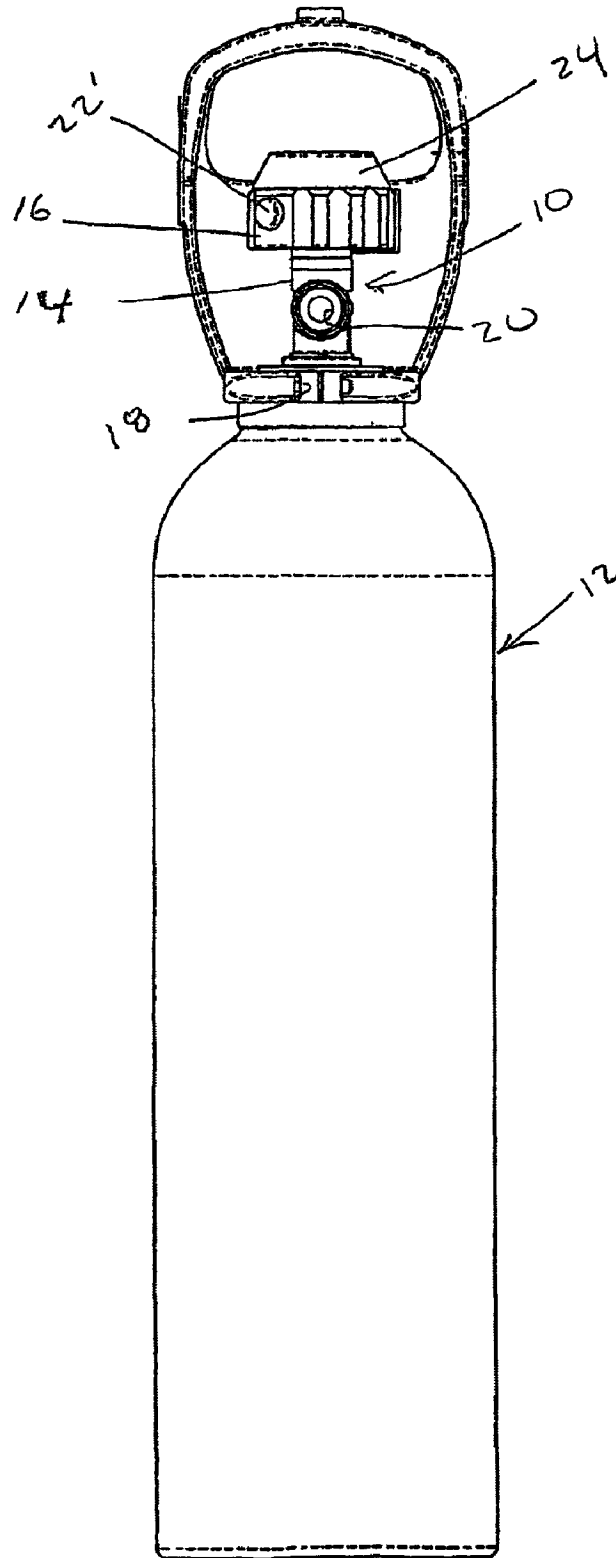

FIG. 3

Explore Litigation Insights

Docket Alarm provides insights to develop a more informed litigation strategy and the peace of mind of knowing you're on top of things.

Real-Time Litigation Alerts



Keep your litigation team up-to-date with **real-time alerts** and advanced team management tools built for the enterprise, all while greatly reducing PACER spend.

Our comprehensive service means we can handle Federal, State, and Administrative courts across the country.

Advanced Docket Research



With over 230 million records, Docket Alarm's cloud-native docket research platform finds what other services can't. Coverage includes Federal, State, plus PTAB, TTAB, ITC and NLRB decisions, all in one place.

Identify arguments that have been successful in the past with full text, pinpoint searching. Link to case law cited within any court document via Fastcase.

Analytics At Your Fingertips



Learn what happened the last time a particular judge, opposing counsel or company faced cases similar to yours.

Advanced out-of-the-box PTAB and TTAB analytics are always at your fingertips.

API

Docket Alarm offers a powerful API (application programming interface) to developers that want to integrate case filings into their apps.

LAW FIRMS

Build custom dashboards for your attorneys and clients with live data direct from the court.

Automate many repetitive legal tasks like conflict checks, document management, and marketing.

FINANCIAL INSTITUTIONS

Litigation and bankruptcy checks for companies and debtors.

E-DISCOVERY AND LEGAL VENDORS

Sync your system to PACER to automate legal marketing.