



US005506617A

United States Patent [19]

[11] Patent Number: **5,506,617**

Parulski et al.

[45] Date of Patent: **Apr. 9, 1996**

[54] **ELECTRONIC CAMERA INCORPORATING A COMPUTER-COMPATIBLE BUS INTERFACE**

[75] Inventors: **Kenneth Parulski; Raymond J. Bouvy; David A. Smith**, all of Rochester; **John J. Acello**, East Rochester, all of N.Y.

[73] Assignee: **Eastman Kodak Company**, Rochester, N.Y.

[21] Appl. No.: **988,560**

[22] Filed: **Dec. 10, 1992**

[51] Int. Cl.⁶ **H04N 5/225**

[52] U.S. Cl. **348/207; 348/552**

[58] Field of Search **354/75, 76; 358/209, 358/903, 906, 909; 364/513, 514; 348/552, 207, 373, 375**

4,545,068	10/1985	Tabata et al.	382/41
4,587,633	5/1986	Wang	364/900
4,589,020	5/1986	Akatsuka	358/160
5,138,459	8/1992	Roberts et al.	358/209
5,182,647	1/1993	Chang	358/213.11
5,231,501	7/1993	Sakai	358/209
5,258,859	11/1993	Wada et al.	358/487

Primary Examiner—Wendy R. Greening
Attorney, Agent, or Firm—David M. Woods

[57] ABSTRACT

An electronic camera is provided as a module that attaches to the signal bus of a PC-compatible computer. The camera includes a minimum of components, particularly an image sensor and an A/D converter, and a PC-compatible interface connector for mating with a bus extension connector on the computer. By directly presenting digitized data from the camera to the signal bus of the computer through the bus connector, the camera can be kept relatively simple and the computer can be relied upon to perform image processing, storage, and display.

[56] References Cited

U.S. PATENT DOCUMENTS

4,425,586 1/1984 Miller 358/335

26 Claims, 10 Drawing Sheets

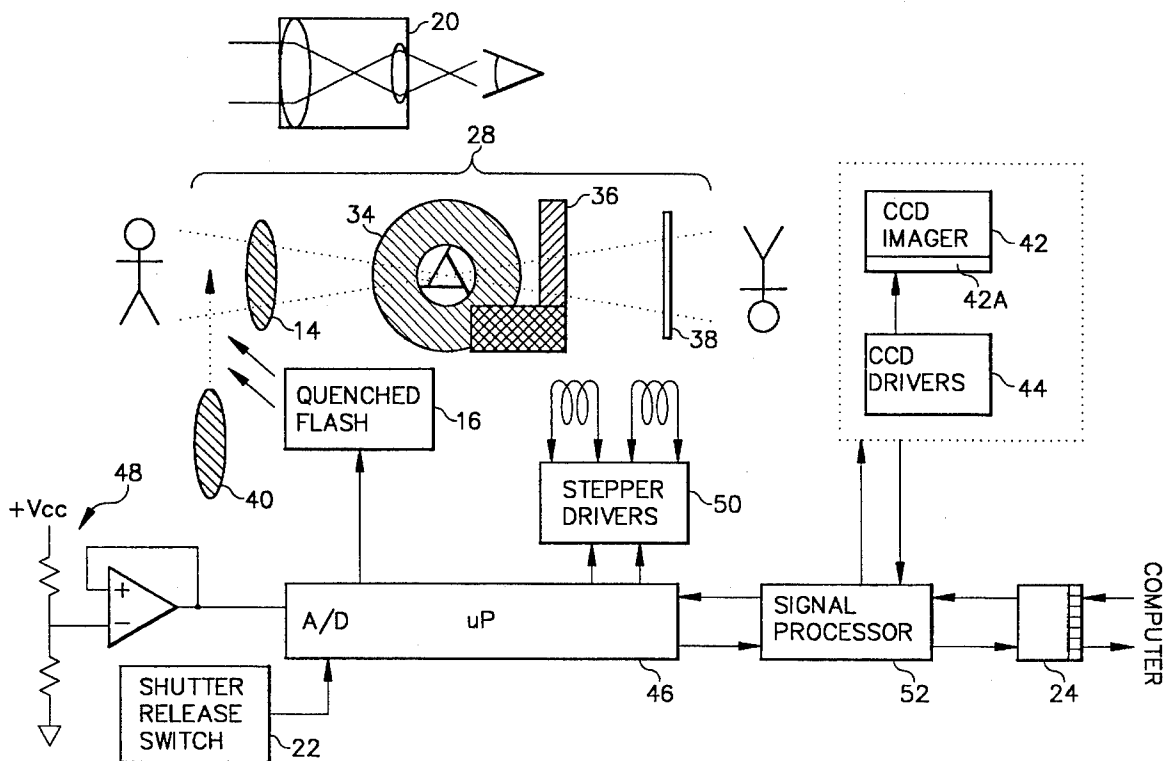

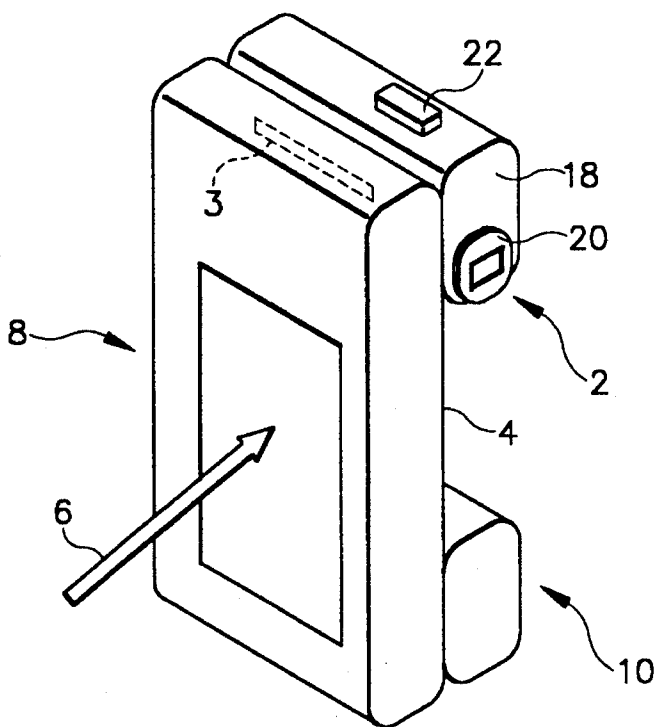

FIG. 1

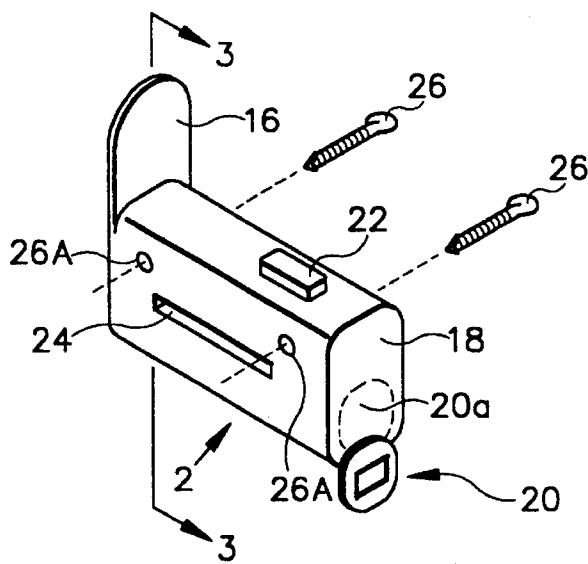

FIG. 2

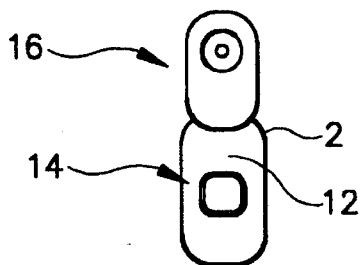

FIG. 3

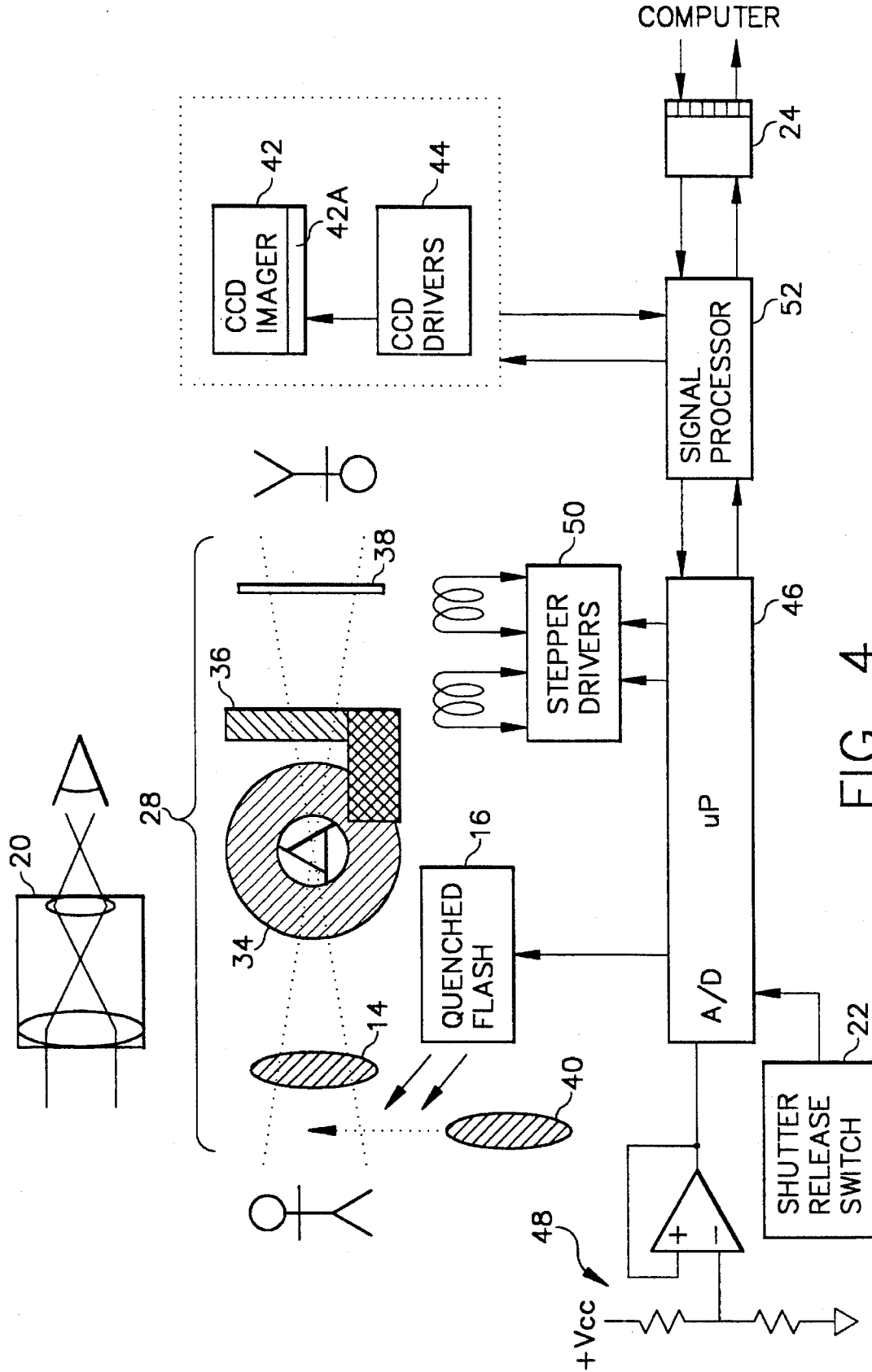

FIG. 4

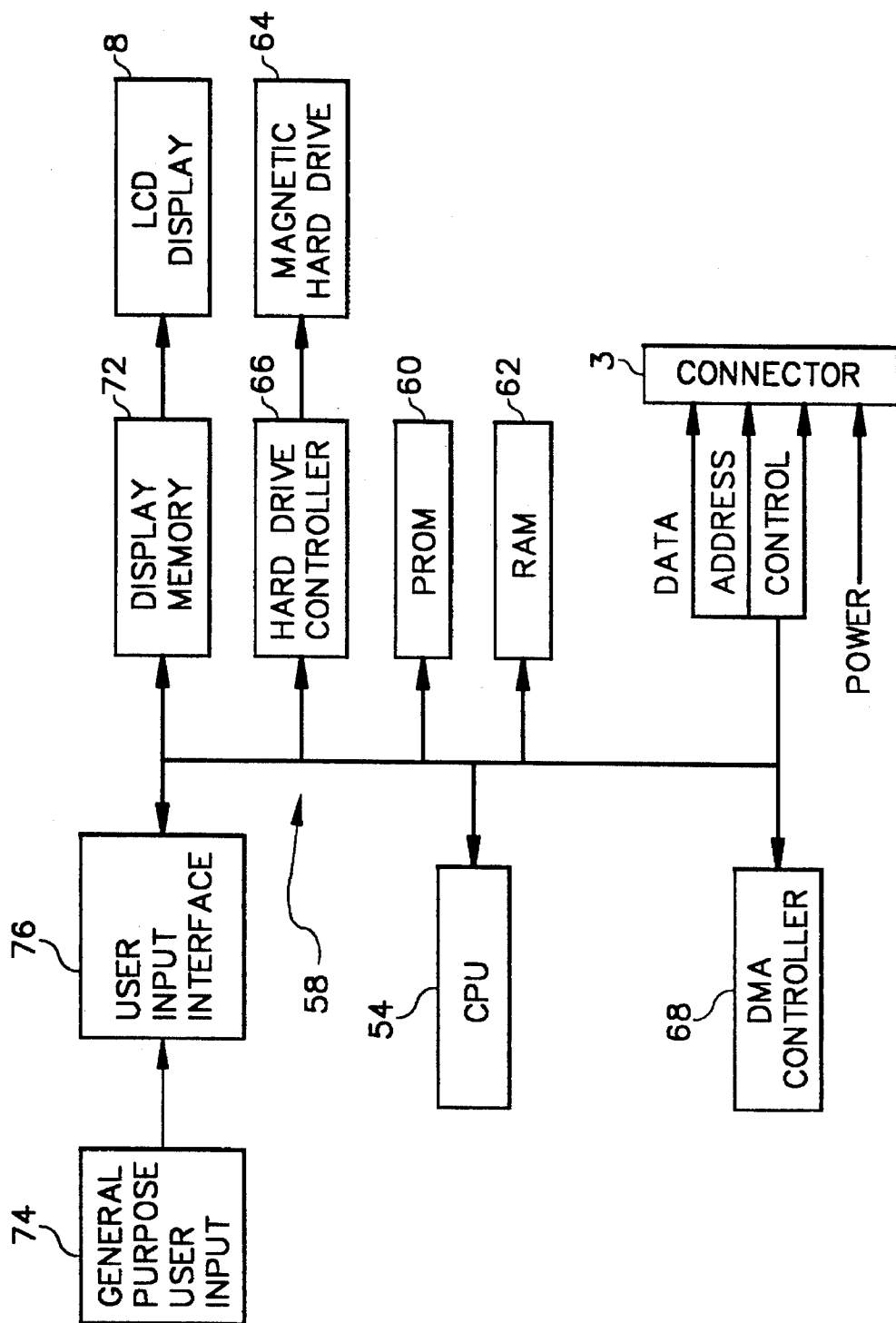

FIG. 5

GROUND		B1	A1	<	-I/O CH CK
RESET	<	B2	A2	< >	SD7
+5 VOLTS		B3	A3	< >	SD6
IRQ2	>	B4	A4	< >	SD5
-5 VOLTS		B5	A5	< >	SD4
DRQ1	>	B6	A6	< >	SD3
-12 VOLTS		B7	A7	< >	SD2
-OWS	>	B8	A8	< >	SD1
+12 VOLTS		B9	A9	< >	SD0
GROUND		B10	A10	<	I/O CH RDY
-SMEMW	<	B11	A11	<	AEN
-SMEMR	<	B12	A12	< >	SA19
-IOW	<	B13	A13	< >	SA18
-IOR	<	B14	A14	< >	SA17
-DACK3	<	B15	A15	< >	SA16
DRQ3	>	B16	A16	< >	SA15
-DACK1	<	B17	A17	< >	SA14
DRQ1	>	B18	A18	< >	SA13
-DACK0	<	B19	A19	< >	SA12
CLK	<	B20	A20	< >	SA11
IRQ7	>	B21	A21	< >	SA10
IRQ6	>	B22	A22	< >	SA9
IRQ5	>	B23	A23	< >	SA8
IRQ4	>	B24	A24	< >	SA7
IRQ3	>	B25	A25	< >	SA6
-DACK2	<	B26	A26	< >	SA5
T/C	<	B27	A27	< >	SA4
BALE	<	B28	A28	< >	SA3
+5 VOLTS		B29	A29	< >	SA2
OSC	<	B30	A30	< >	SA1
GROUND		B31	A31	< >	SA0

FIG. 6

Explore Litigation Insights

Docket Alarm provides insights to develop a more informed litigation strategy and the peace of mind of knowing you're on top of things.

Real-Time Litigation Alerts



Keep your litigation team up-to-date with **real-time alerts** and advanced team management tools built for the enterprise, all while greatly reducing PACER spend.

Our comprehensive service means we can handle Federal, State, and Administrative courts across the country.

Advanced Docket Research



With over 230 million records, Docket Alarm's cloud-native docket research platform finds what other services can't. Coverage includes Federal, State, plus PTAB, TTAB, ITC and NLRB decisions, all in one place.

Identify arguments that have been successful in the past with full text, pinpoint searching. Link to case law cited within any court document via Fastcase.

Analytics At Your Fingertips



Learn what happened the last time a particular judge, opposing counsel or company faced cases similar to yours.

Advanced out-of-the-box PTAB and TTAB analytics are always at your fingertips.

API

Docket Alarm offers a powerful API (application programming interface) to developers that want to integrate case filings into their apps.

LAW FIRMS

Build custom dashboards for your attorneys and clients with live data direct from the court.

Automate many repetitive legal tasks like conflict checks, document management, and marketing.

FINANCIAL INSTITUTIONS

Litigation and bankruptcy checks for companies and debtors.

E-DISCOVERY AND LEGAL VENDORS

Sync your system to PACER to automate legal marketing.