

[54] FELT TAB FEEDER FOR NAILING GUN

Attorney, Agent, or Firm—Siemens Patent Services

[76] Inventor: **Shane Haugen**, P.O. Box 4044, Gulf Shores, Ala. 36547

[57] **ABSTRACT**

[21] Appl. No.: **09/184,943**

Automatic feeding apparatus for feeding a coil of felt tabs connected in head to tail relation to a nailing or stapling gun. The feeder places one tab beneath the gun in the path of the next nail or staple to be driven by the gun such that operating the gun causes a felt tab to be installed simultaneously with the driven nail or staple. The feeding apparatus includes a clip for storing a coil of tabs, a tractor drive for advancing the coil one tab at a time when the gun is operated, and a motor for operating the tractor drive. The clip has a removable cover and an axle about which the coil of tabs rotates as it is paid out. The tractor drive has an endless belt from which fingers project to engage the tabs. Power is the same as that employed by the gun. The feeding apparatus may be integral with the gun or may have structure enabling ready attachment to the gun.

[22] Filed: **Nov. 3, 1998**

[51] **Int. Cl.**⁷ **B65H 5/28**

[52] **U.S. Cl.** **221/71; 221/77; 411/162**

[58] **Field of Search** 221/25, 26-69, 221/71, 73, 77, 79, 30, 106, 253, 277; 411/162, 147, 149; 227/107

[56] **References Cited**

U.S. PATENT DOCUMENTS

4,410,103	10/1983	Fuhrmeister	221/25
5,067,865	11/1991	Zylka et al.	411/531
5,184,752	2/1993	Zylka et al.	221/1

Primary Examiner—Kenneth W. Noland

17 Claims, 7 Drawing Sheets

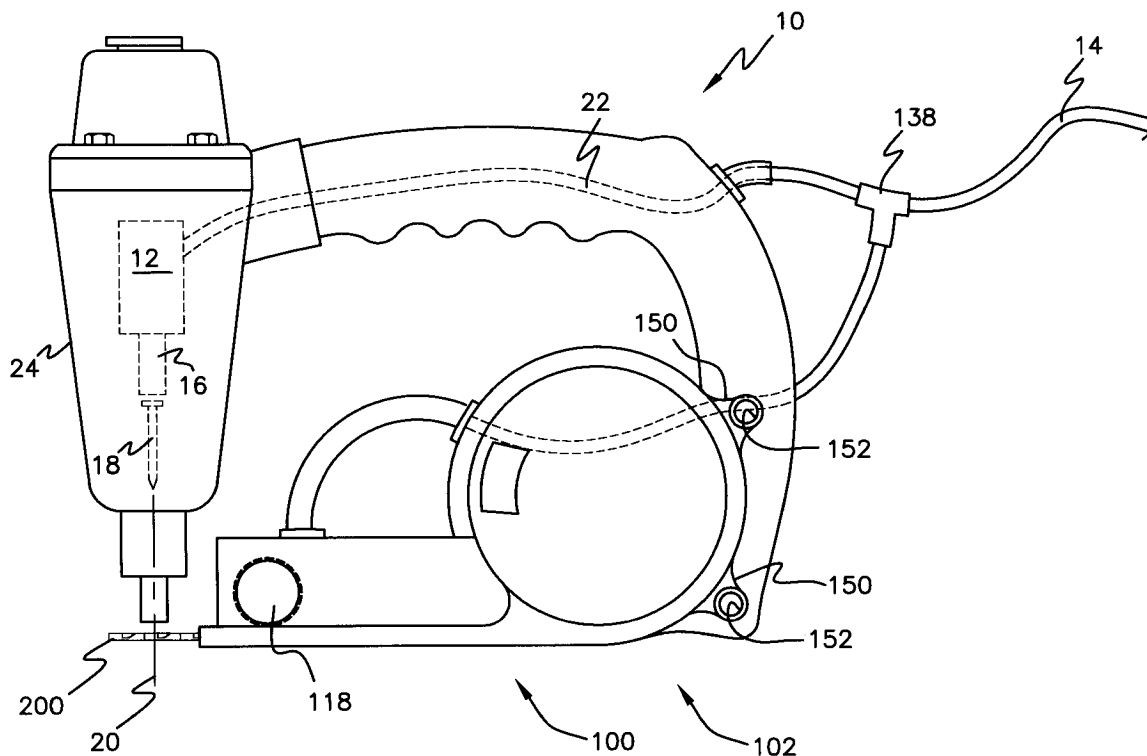

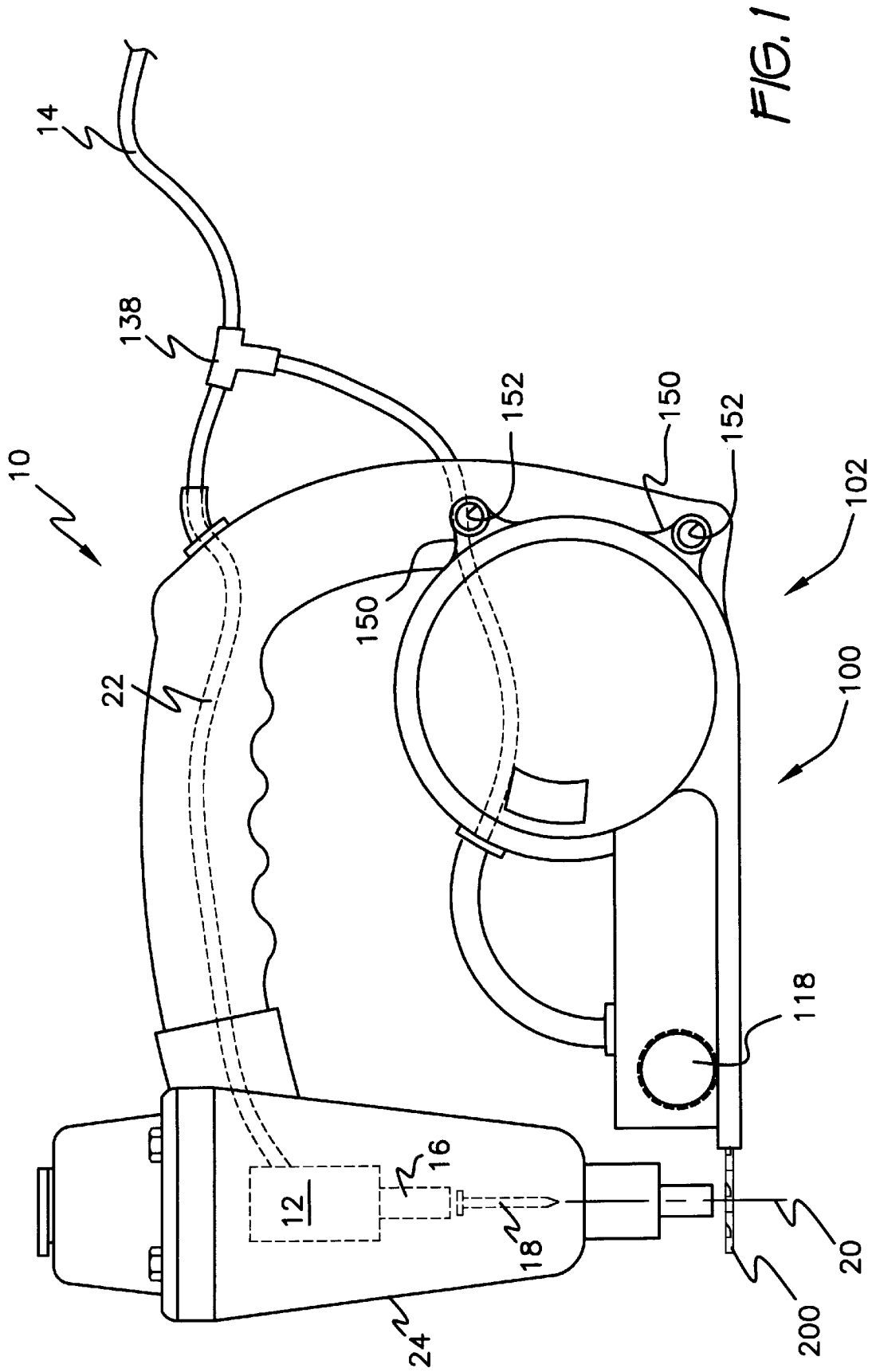

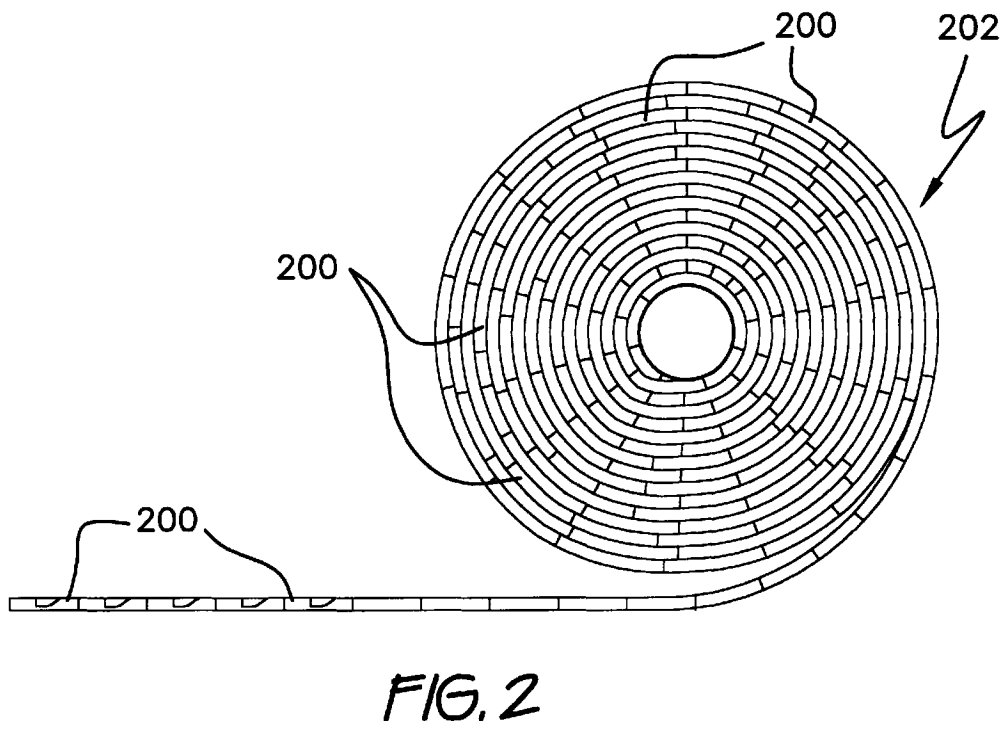
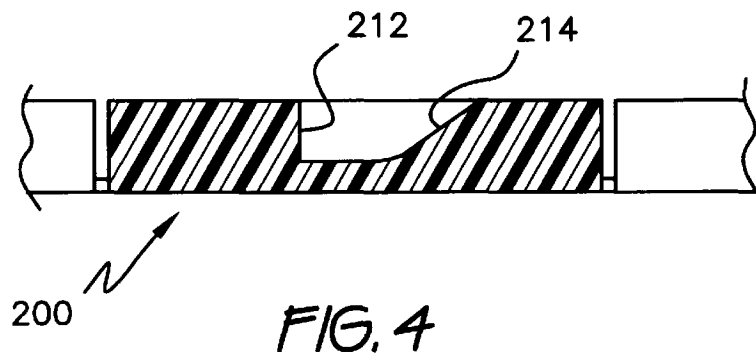
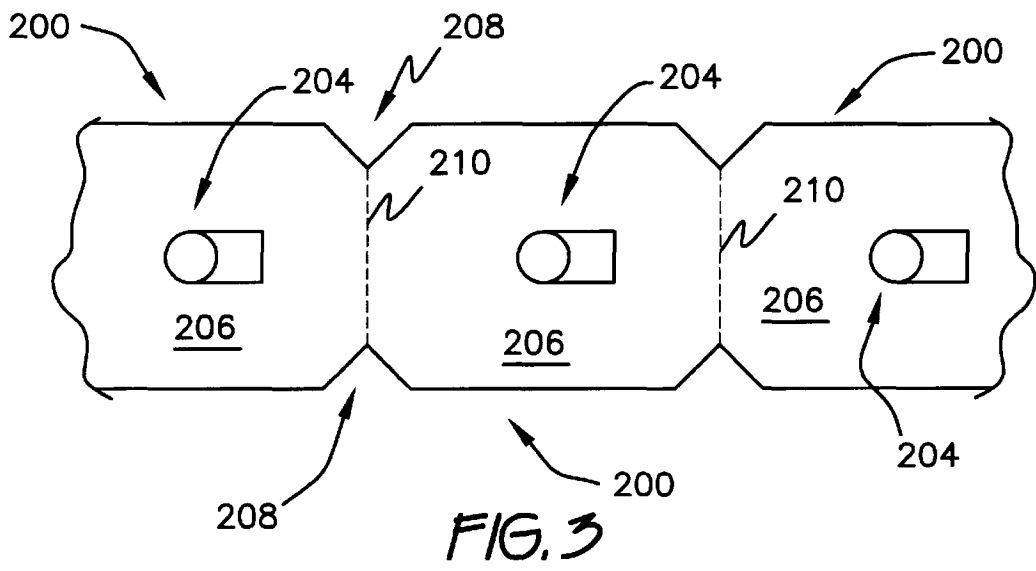

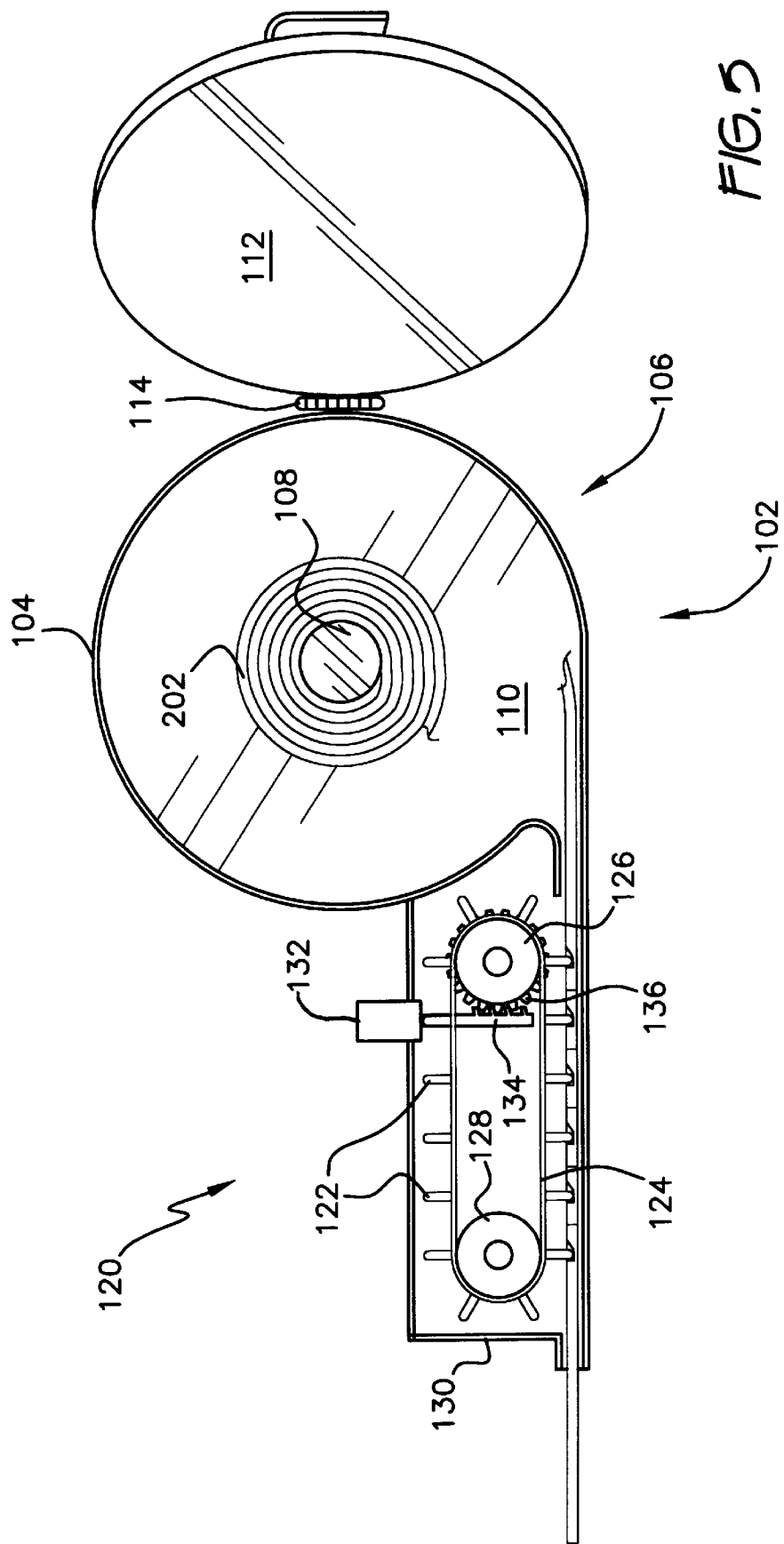

FIG. 5

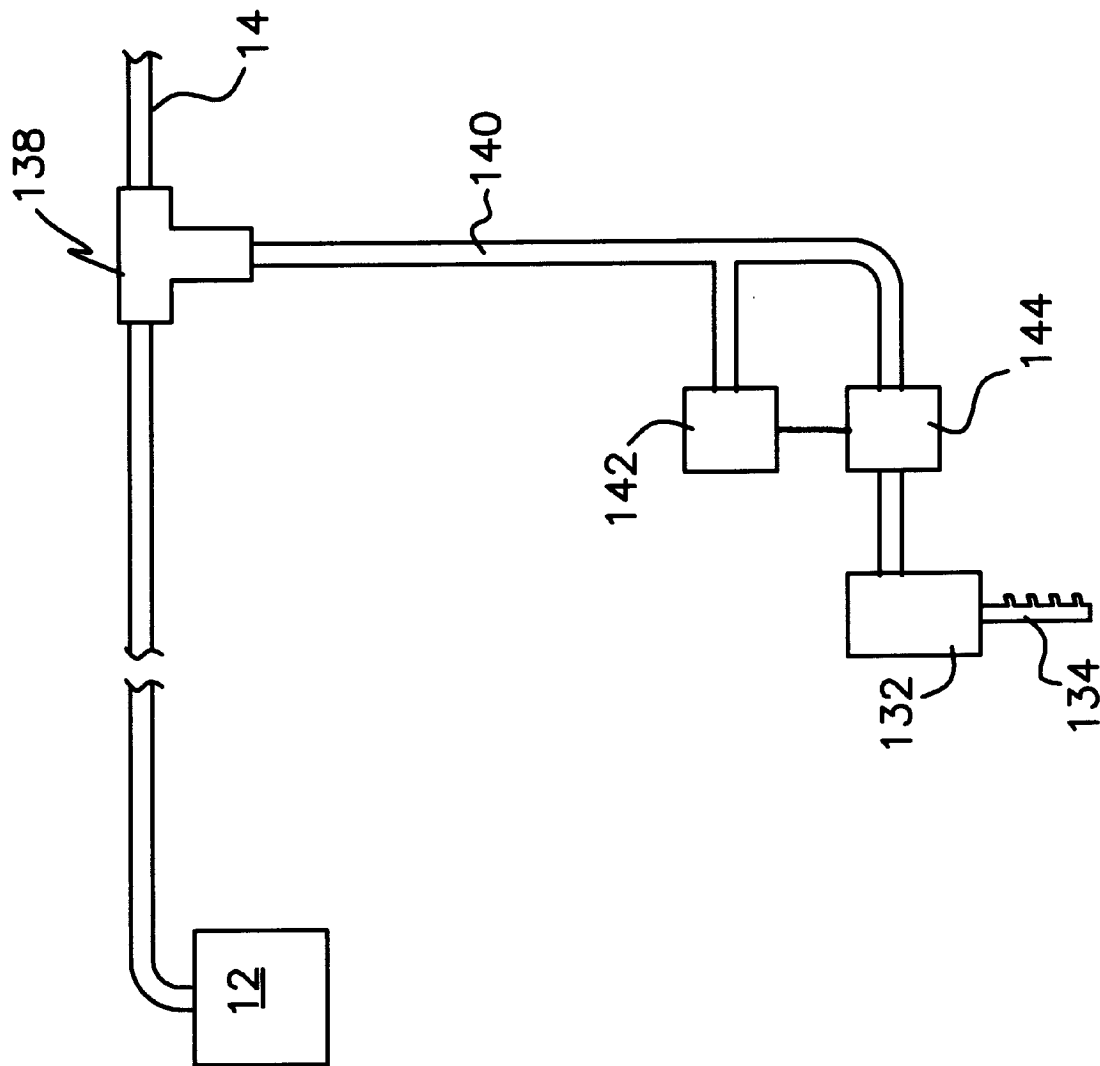

FIG. 6

Explore Litigation Insights

Docket Alarm provides insights to develop a more informed litigation strategy and the peace of mind of knowing you're on top of things.

Real-Time Litigation Alerts



Keep your litigation team up-to-date with **real-time alerts** and advanced team management tools built for the enterprise, all while greatly reducing PACER spend.

Our comprehensive service means we can handle Federal, State, and Administrative courts across the country.

Advanced Docket Research



With over 230 million records, Docket Alarm's cloud-native docket research platform finds what other services can't. Coverage includes Federal, State, plus PTAB, TTAB, ITC and NLRB decisions, all in one place.

Identify arguments that have been successful in the past with full text, pinpoint searching. Link to case law cited within any court document via Fastcase.

Analytics At Your Fingertips



Learn what happened the last time a particular judge, opposing counsel or company faced cases similar to yours.

Advanced out-of-the-box PTAB and TTAB analytics are always at your fingertips.

API

Docket Alarm offers a powerful API (application programming interface) to developers that want to integrate case filings into their apps.

LAW FIRMS

Build custom dashboards for your attorneys and clients with live data direct from the court.

Automate many repetitive legal tasks like conflict checks, document management, and marketing.

FINANCIAL INSTITUTIONS

Litigation and bankruptcy checks for companies and debtors.

E-DISCOVERY AND LEGAL VENDORS

Sync your system to PACER to automate legal marketing.