

United States Patent [19]

[11] **Patent Number:** 5,734,112

Bose et al.

[45] **Date of Patent:** Mar. 31, 1998

[54] **METHOD AND APPARATUS FOR MEASURING PRESSURE IN A CORIOLIS MASS FLOWMETER**

63-191024 8/1988 Japan 73/861.357

[75] **Inventors:** Tamal Bose, Denver; Howard Vincent Derby, Boulder, both of Colo.; Andrew Keith Levien, Cranberry Township, Pa.; Anthony William Pankratz, Westminster, Colo.

Primary Examiner—George M. Dombroske

Assistant Examiner—Paul D. Amrozowicz

Attorney, Agent, or Firm—Duft, Graziano & Forest, P.C.

[73] **Assignee:** Micro Motion, Inc., Boulder, Colo.

[57] **ABSTRACT**

[21] **Appl. No.:** 689,839

A method for determining pressure in an operating Coriolis effect mass flowmeter. The Coriolis flowmeter flow tubes are vibrated in both a bending mode (as is normal for measuring mass flow rate) and in a twisting mode. The ratio of the fundamental frequencies at which the flow tubes vibrate in each of the two vibration modes is proportional to the pressure within the flow tubes. In the preferred embodiment, a sum/difference method initially isolates the superposed sinusoids representing the fundamental frequencies of the two vibrational modes. Fast conjugate gradient (FCG) digital filters are then used to rapidly estimate the fundamental frequencies in each of the two vibration modes. The estimated frequencies are then used by filter chains including digital notch and band pass filters as well as recursive maximum likelihood (RML) digital filter techniques to enhance the bending mode and twisting mode fundamental frequency estimates. The enhanced bending mode and twisting mode frequency estimates are used to determine the pressure within the flow tubes as a function of the ratio of the two frequencies as well as to center the notch and band pass filter chains used to enhance the bending mode frequency of the two vibration sensor channels for mass flow rate computations. The pressure so determined may then be used to correct mass flow rate computations or for other pressure measurement purposes per se.

[22] **Filed:** Aug. 14, 1996

[51] **Int. Cl.⁶** G01F 1/84

[52] **U.S. Cl.** 73/861.56

[58] **Field of Search** 73/861.355, 861.356, 73/861.357, 861.354

[56] **References Cited**

U.S. PATENT DOCUMENTS

4,823,613	4/1989	Cage et al.	73/861.38
4,934,196	6/1990	Romano	73/861.38
5,054,326	10/1991	Mattar	73/861.355
5,301,557	4/1994	Cage et al.	73/861.355
5,347,874	9/1994	Kalotay et al.	73/861.857
5,373,745	12/1994	Cage	73/861.37
5,423,225	6/1995	Cage	73/861.37
5,448,921	9/1995	Cage et al.	73/861.38
5,473,949	12/1995	Cage et al.	73/861.38
5,555,190	9/1996	Derby et al.	73/861.356 X
5,576,500	11/1996	Cage et al.	73/861.357

FOREIGN PATENT DOCUMENTS

WO 92/14123 8/1992 European Pat. Off.

27 Claims, 11 Drawing Sheets

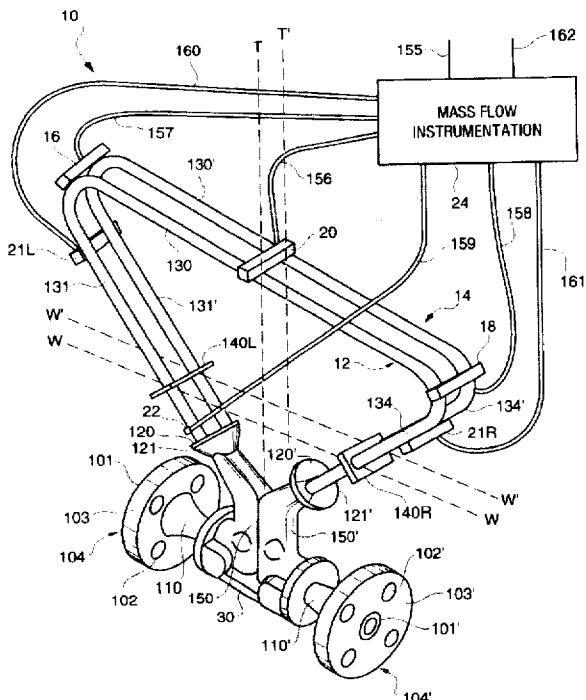

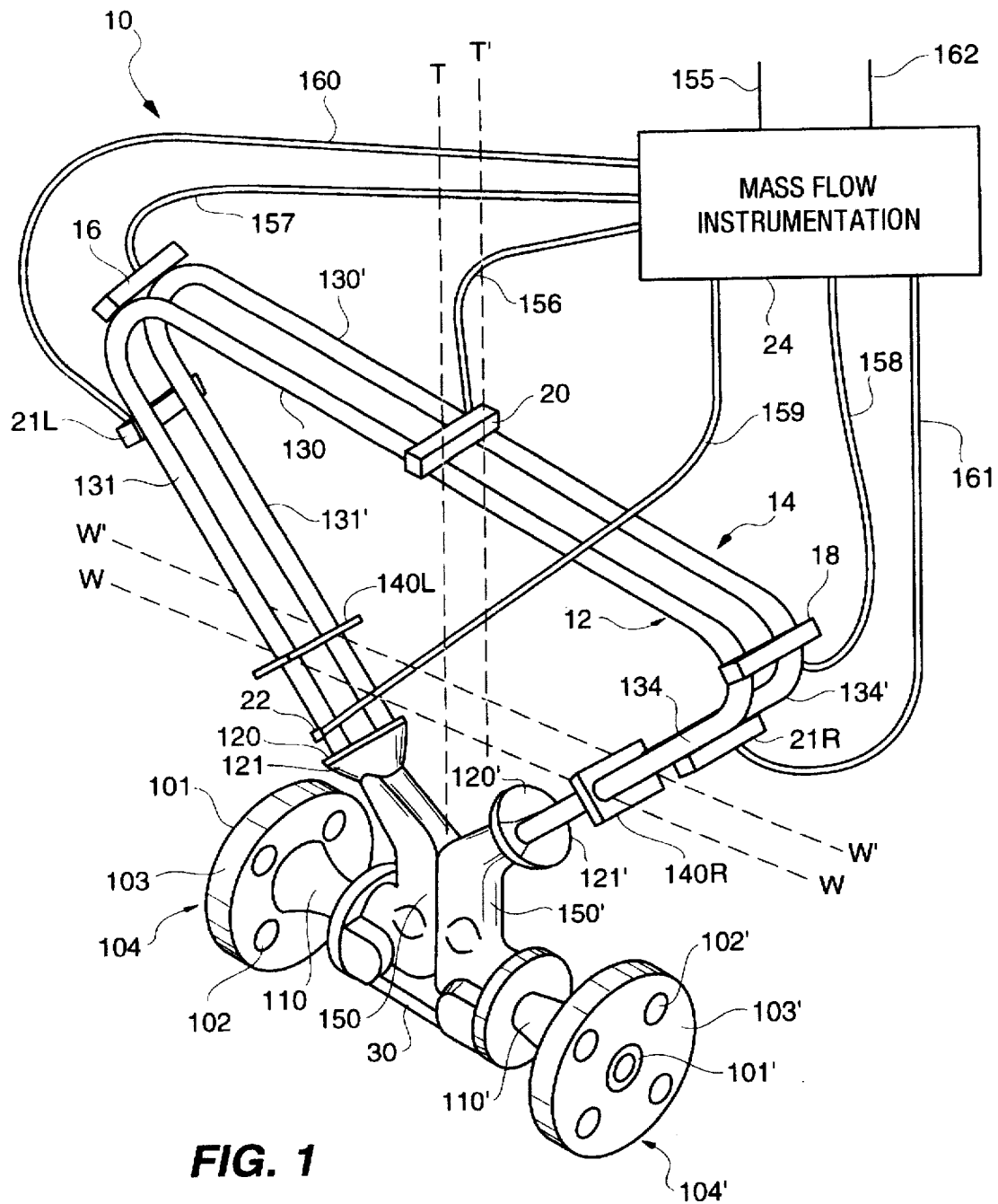

FIG. 1

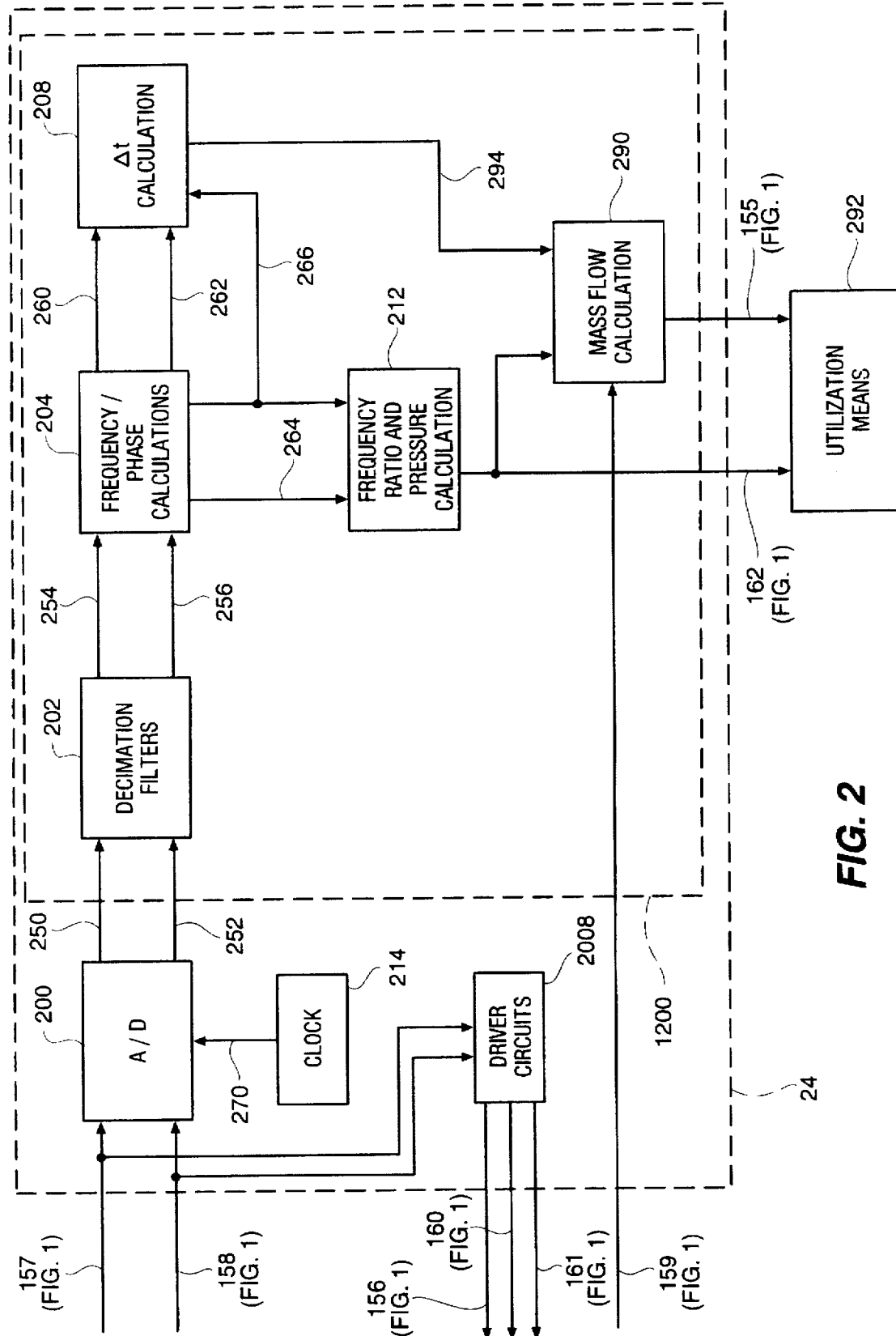

FIG. 2

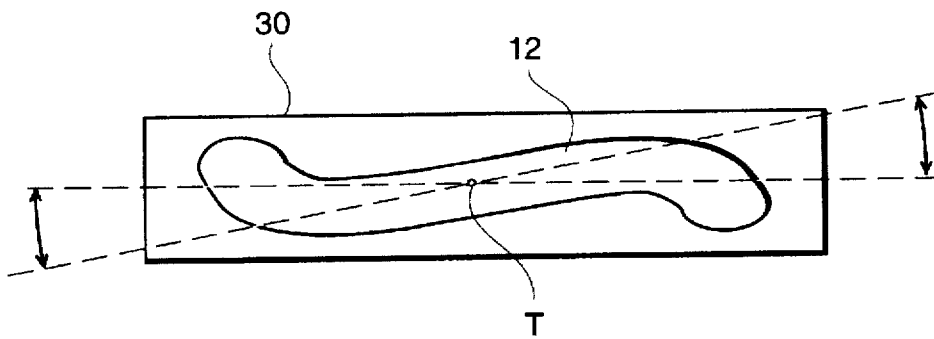
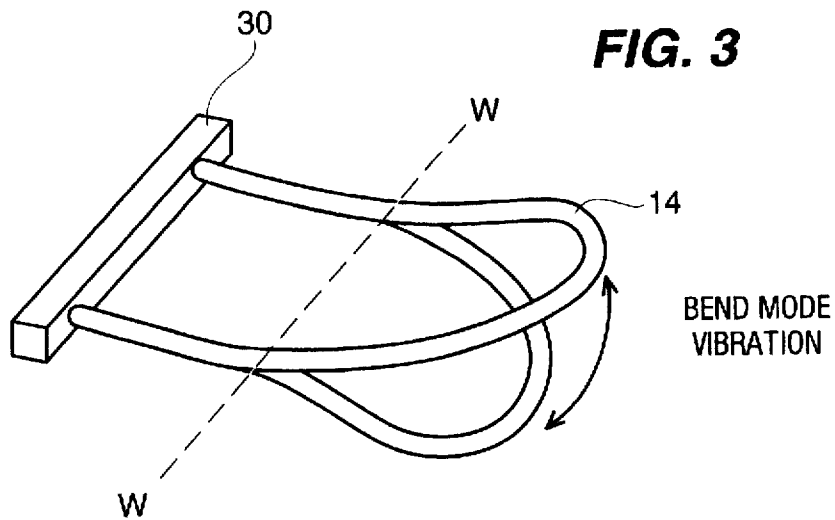
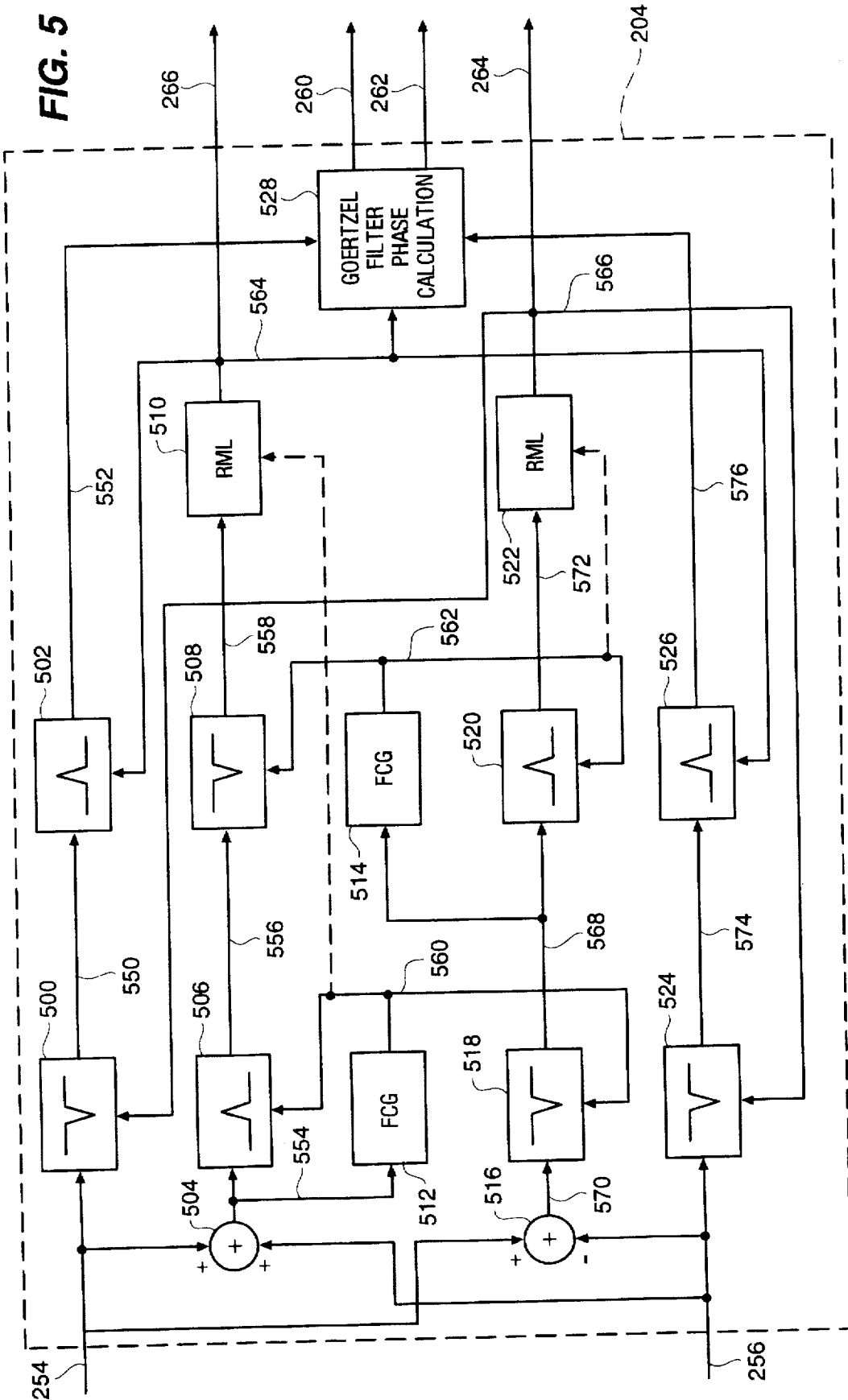

FIG. 4 TWIST MODE VIBRATION



Explore Litigation Insights

Docket Alarm provides insights to develop a more informed litigation strategy and the peace of mind of knowing you're on top of things.

Real-Time Litigation Alerts



Keep your litigation team up-to-date with **real-time alerts** and advanced team management tools built for the enterprise, all while greatly reducing PACER spend.

Our comprehensive service means we can handle Federal, State, and Administrative courts across the country.

Advanced Docket Research



With over 230 million records, Docket Alarm's cloud-native docket research platform finds what other services can't. Coverage includes Federal, State, plus PTAB, TTAB, ITC and NLRB decisions, all in one place.

Identify arguments that have been successful in the past with full text, pinpoint searching. Link to case law cited within any court document via Fastcase.

Analytics At Your Fingertips



Learn what happened the last time a particular judge, opposing counsel or company faced cases similar to yours.

Advanced out-of-the-box PTAB and TTAB analytics are always at your fingertips.

API

Docket Alarm offers a powerful API (application programming interface) to developers that want to integrate case filings into their apps.

LAW FIRMS

Build custom dashboards for your attorneys and clients with live data direct from the court.

Automate many repetitive legal tasks like conflict checks, document management, and marketing.

FINANCIAL INSTITUTIONS

Litigation and bankruptcy checks for companies and debtors.

E-DISCOVERY AND LEGAL VENDORS

Sync your system to PACER to automate legal marketing.