

[54] **REPERFORABLE BRIDGE PLUG**

[75] Inventor: Juan C. Kristiansen, Chubut, Argentina

[73] Assignee: Metalurgica Industrial Mecanica S.A., Buenos Aires, Argentina

[21] Appl. No.: 589,029

[22] Filed: Mar. 13, 1984

[30] **Foreign Application Priority Data**

Mar. 15, 1983 [AR] Argentina 292396

[51] Int. Cl.⁴ E21B 33/129

[52] U.S. Cl. 166/123; 166/135; 166/181; 166/192

[58] Field of Search 166/118, 123, 131, 135, 166/140, 179, 181, 184, 188, 192, 196

[56] **References Cited**

U.S. PATENT DOCUMENTS

2,928,469	3/1960	Crowe	166/135
3,000,443	9/1961	Thompson	166/192
3,054,453	9/1962	Bonner	166/135
3,100,533	8/1963	Fredd	166/181
4,432,418	2/1984	Mayland	166/135

Primary Examiner—Stephen J. Novosad
 Assistant Examiner—William B. Neuder
 Attorney, Agent, or Firm—Holman & Stern

[57] **ABSTRACT**

A reperforable bridge plug fastenable to a tool through a weak point and integrated by an elastic gasket between support and compression pieces has a dentated fastener for fastening to a tube line, a bridge plug having

a tubular body with upper and lower ends, an enlarged diameter hollow portion on the lower end portion of the bridge plug forming a chamber, a plurality of slots through the wall of the chamber so that it communicates with the exterior of the bridge plug body, a plurality of calibrated rings formed by enlargements of the exterior surface of the wall calibrated to fit the well diameter in which the bridge plug is to be applied, an interchangeable converter plug mounted in the end of the tubular body adjacent the enlarged portion between the chamber and tubular body, a lower compression piece located below the elastic gasket and fastened to the tubular body by a fuse pin and having an external frusto conical surface thereon, a frusto conical surface on the exterior of the enlarged diameter portion spaced below the lower compression piece, and wherein the dentated fastener comprises a cylindrical jaw member mounted on the tubular body between the lower compression piece and the enlarged diameter portion, two oppositely directed diverging frusto conical surfaces on the interior surface of the jaw member at least partially operatively engaging respectively in superposition the frusto conical surfaces on the lower compression piece and enlarged diameter portion, substantially circumferential saw teeth on the exterior surface of the jaw member, and a plurality of circumferentially spaced axially directed slots in the exterior surface of the jaw member to produce weak fracture areas which fracture in response to predetermined relative movement of the lower compression piece and enlarged diameter portion of the bridge plug toward each other.

19 Claims, 32 Drawing Figures

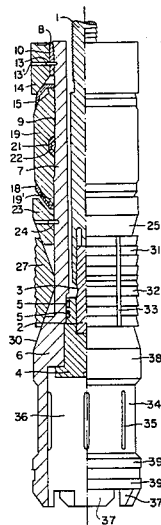

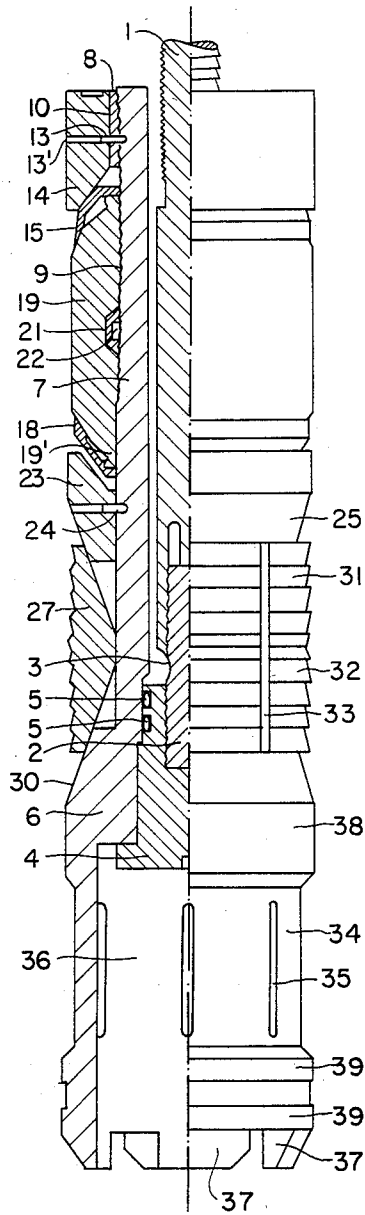

FIG. 1

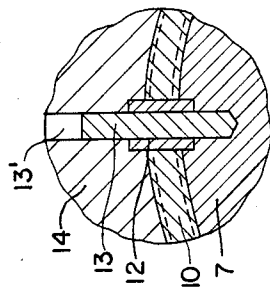
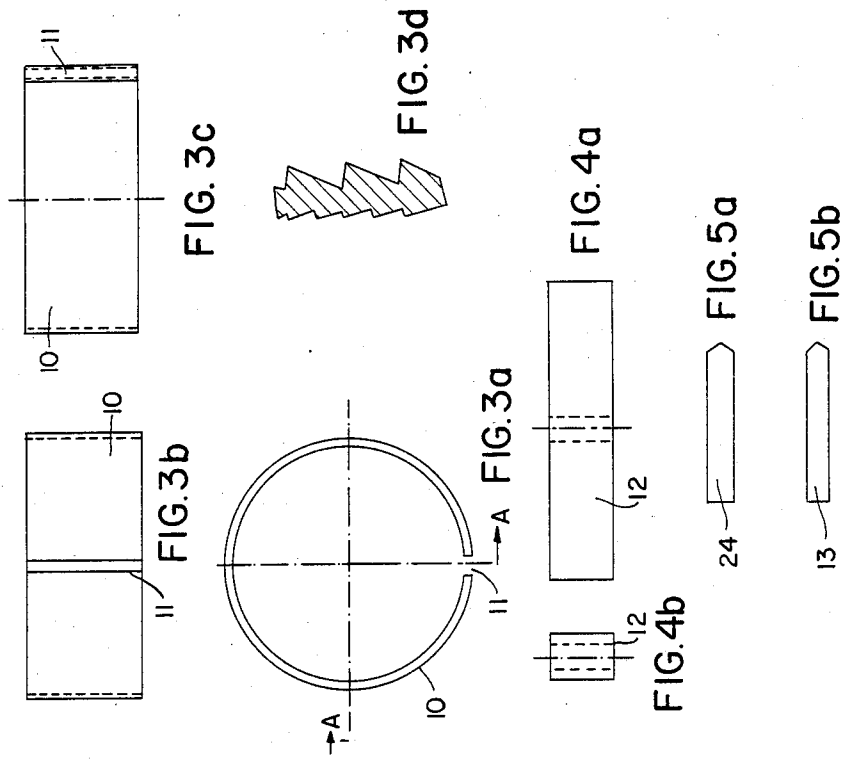

FIG. 2a

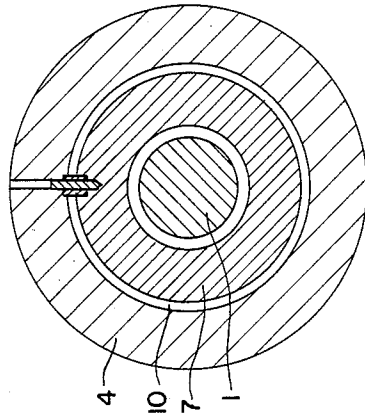
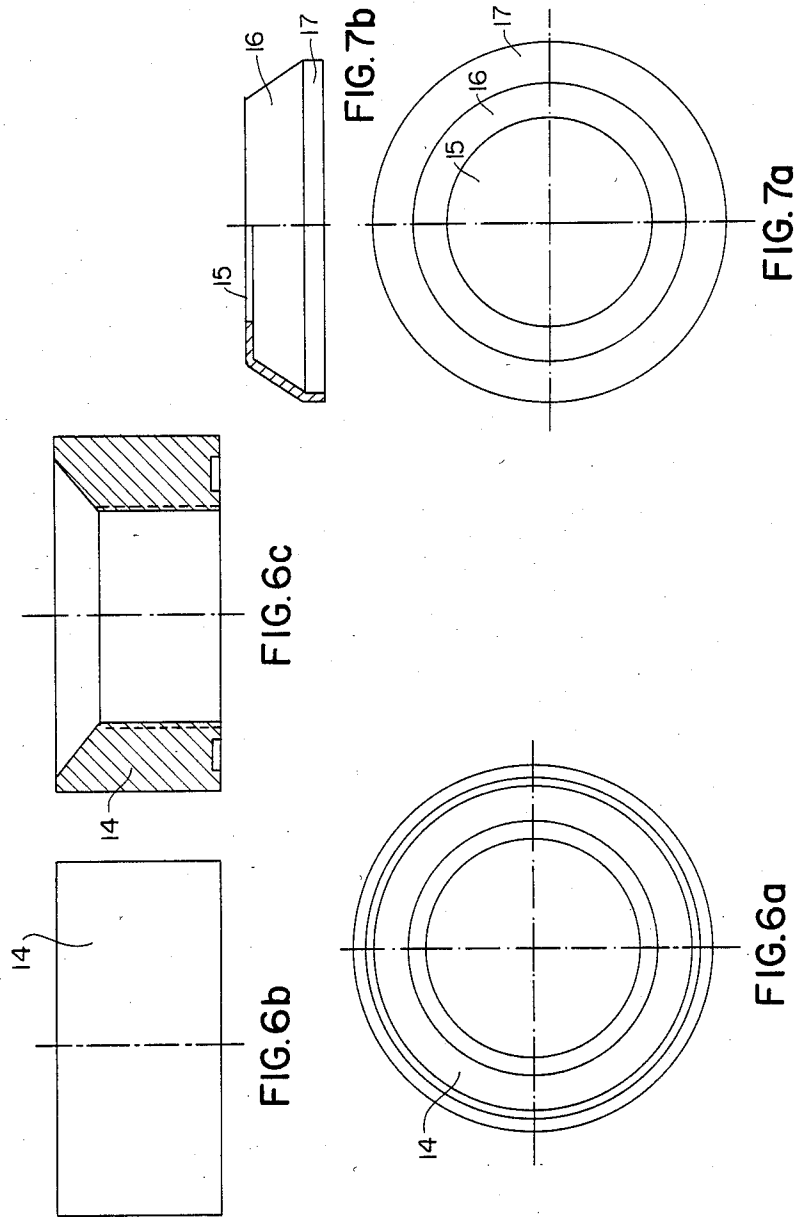
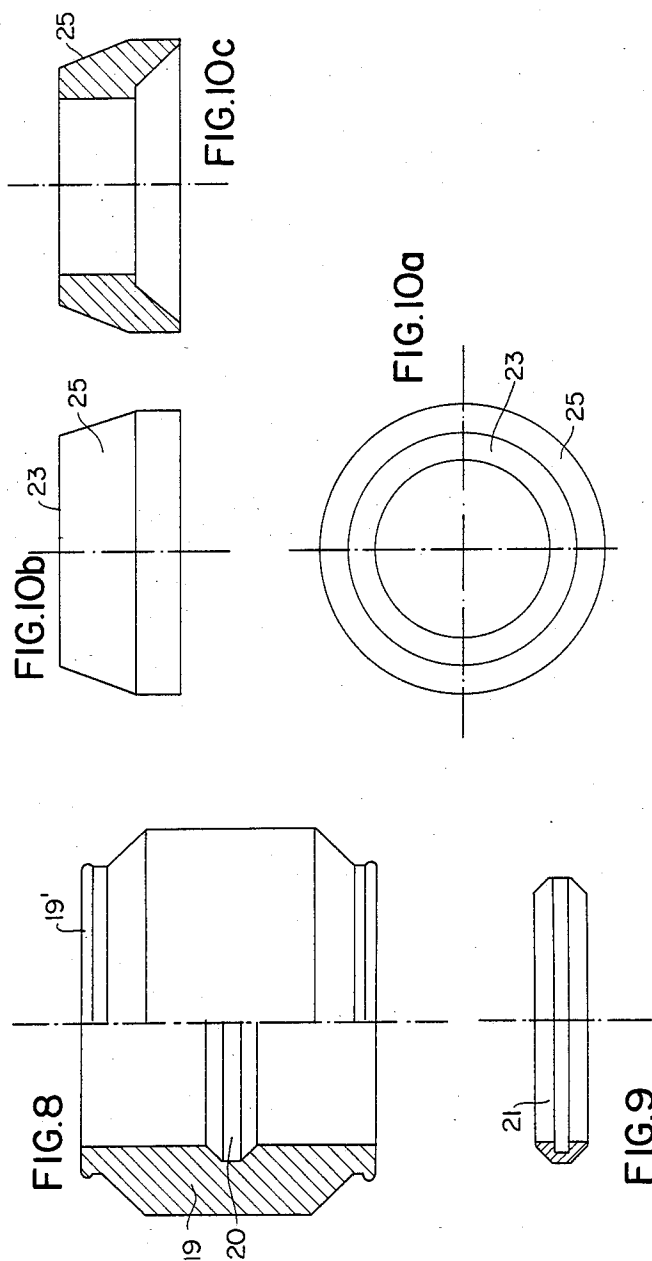

FIG. 2





Explore Litigation Insights

Docket Alarm provides insights to develop a more informed litigation strategy and the peace of mind of knowing you're on top of things.

Real-Time Litigation Alerts



Keep your litigation team up-to-date with **real-time alerts** and advanced team management tools built for the enterprise, all while greatly reducing PACER spend.

Our comprehensive service means we can handle Federal, State, and Administrative courts across the country.

Advanced Docket Research



With over 230 million records, Docket Alarm's cloud-native docket research platform finds what other services can't. Coverage includes Federal, State, plus PTAB, TTAB, ITC and NLRB decisions, all in one place.

Identify arguments that have been successful in the past with full text, pinpoint searching. Link to case law cited within any court document via Fastcase.

Analytics At Your Fingertips



Learn what happened the last time a particular judge, opposing counsel or company faced cases similar to yours.

Advanced out-of-the-box PTAB and TTAB analytics are always at your fingertips.

API

Docket Alarm offers a powerful API (application programming interface) to developers that want to integrate case filings into their apps.

LAW FIRMS

Build custom dashboards for your attorneys and clients with live data direct from the court.

Automate many repetitive legal tasks like conflict checks, document management, and marketing.

FINANCIAL INSTITUTIONS

Litigation and bankruptcy checks for companies and debtors.

E-DISCOVERY AND LEGAL VENDORS

Sync your system to PACER to automate legal marketing.