



US005776141A

United States Patent [19]

[11] Patent Number: **5,776,141**

Klein et al.

[45] Date of Patent: **Jul. 7, 1998**

- [54] **METHOD AND APPARATUS FOR INTRALUMINAL PROSTHESIS DELIVERY**
- [75] Inventors: **Enrique J. Klein; Aaron V. Kaplan; Mark Clifford**, all of Los Altos; **Martin Overbeek-Bloem**, Palo Alto, all of Calif.
- [73] Assignee: **LocalMed, Inc.**, Palo Alto, Calif.
- [21] Appl. No.: **704,801**
- [22] Filed: **Aug. 26, 1996**

5,242,399	9/1993	Lau et al.	604/104
5,344,426	9/1994	Lau et al.	606/198
5,360,401	11/1994	Turnland et al.	604/96
5,360,443	11/1994	Barone et al.	623/1
5,382,261	1/1995	Palmaz	606/158
5,409,495	4/1995	Osborn	606/108
5,443,500	8/1995	Sigwart	623/1
5,445,646	8/1995	Euteneuer et al.	606/198
5,507,768	4/1996	Lau et al.	606/198
5,534,007	7/1996	St. Germain et al.	606/108
5,545,209	8/1996	Roberts et al.	623/1
5,549,563	8/1996	Kronner	606/164
5,571,086	11/1996	Kaplan et al.	604/108
5,591,222	1/1997	Susawa et al.	623/1
5,620,457	4/1997	Pinchasik et al.	606/194

Related U.S. Application Data

- [60] Provisional application No. 60/002,847 Aug. 28, 1995.
- [51] Int. Cl.⁶ **A61F 11/00**
- [52] U.S. Cl. **606/108; 606/195; 606/198**
- [58] Field of Search 606/108, 191, 606/192, 190, 195, 194

FOREIGN PATENT DOCUMENTS

0 533 960	3/1993	European Pat. Off.
WO 95/11055	4/1995	WIPO
WO 96/33677	10/1996	WIPO

Primary Examiner—Robert A. Hafer
Assistant Examiner—Justine R. Yu
Attorney, Agent, or Firm—Townsend and Townsend and Crew LLP

[56] References Cited

U.S. PATENT DOCUMENTS

4,292,974	10/1981	Fogarty et al.	128/344
4,323,071	4/1982	Simpson et al.	128/343
4,665,918	5/1987	Garza et al.	623/1
4,733,665	3/1988	Palmaz	128/343
4,762,129	8/1988	Bonzel	128/344
4,775,371	10/1988	Mueller, Jr.	604/280
4,776,337	10/1988	Palmaz	128/343
4,839,623	6/1989	Schonstedt et al.	336/213
4,877,030	10/1989	Beck et al.	128/343
4,950,227	8/1990	Savinet Al	606/192
5,014,089	5/1991	Sakashita et al.	355/251
5,019,090	5/1991	Pinchuk	606/194
5,026,377	6/1991	Burton et al.	606/108
5,102,417	4/1992	Palmaz	606/195
5,108,416	4/1992	Ryan et al.	606/191
5,123,917	6/1992	Lee	623/1
5,158,548	10/1992	Lau et al.	604/96
5,163,952	11/1992	Froix	623/1
5,195,984	3/1993	Schatz	606/195
5,219,355	6/1993	Parodi et al.	606/191

ABSTRACT

A catheter for use in combination with a balloon angioplasty catheter for delivering stents and other intraluminal prostheses comprises a tubular catheter body having a radially expandible portion. The stent is disposed over the radially expandible portion, and structure is provided for retaining the stent on the tubular body prior to deployment. The retaining structure may be active, i.e., requiring the user to retract retaining elements, such as axial members, sheaths, or the like. Alternatively, the retaining structure may be passive, wherein balloon expansion results in release of the prosthesis from the retaining structure. Particular methods for fluoroscopically positioning stents using such delivery catheters, for delivering two or more stents using such delivery catheters, and for overexpanding the ends of the stents for anchoring them in place, are also described.

23 Claims, 22 Drawing Sheets

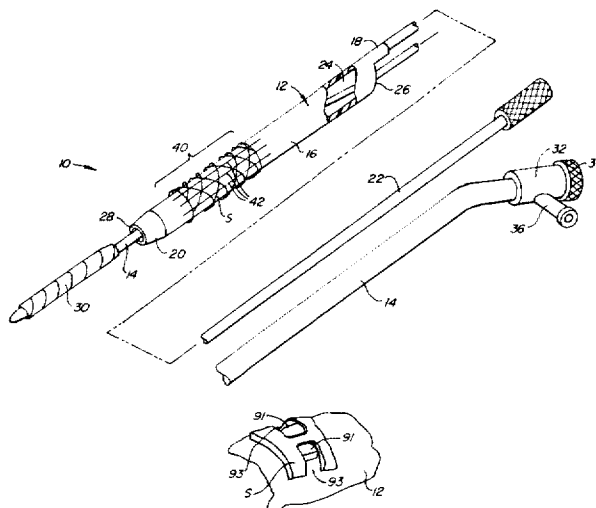

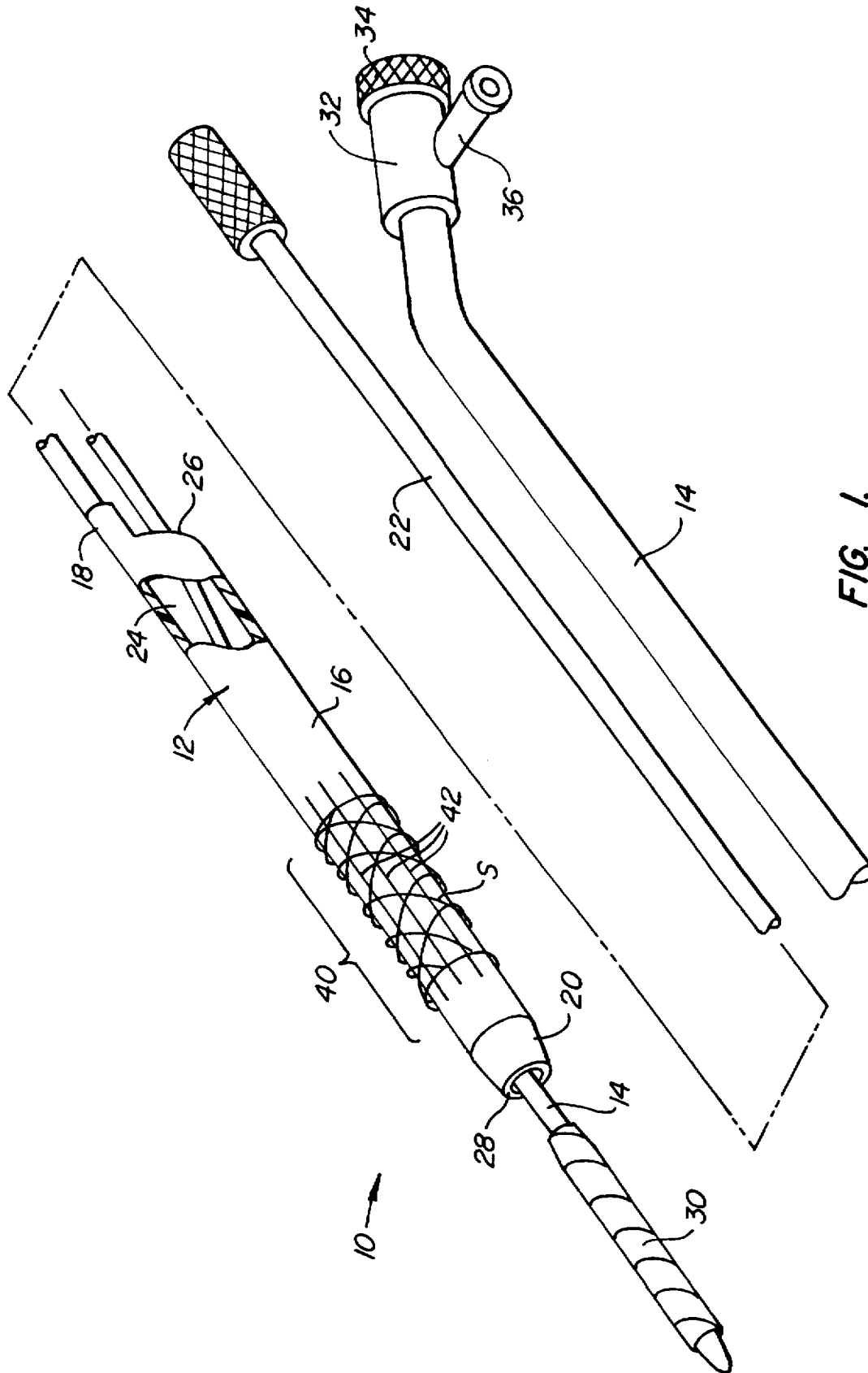

FIG. 1.

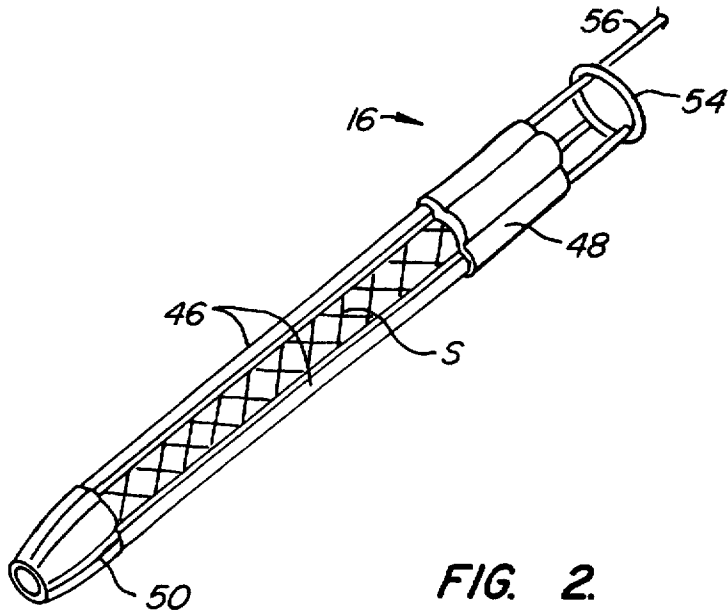

FIG. 2.

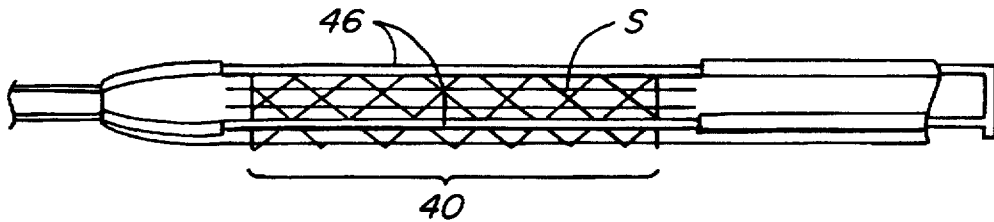

FIG. 3.

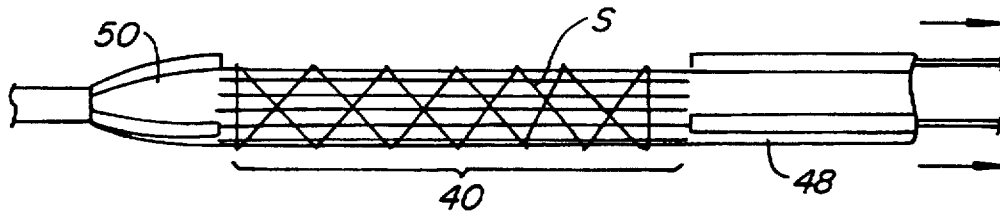

FIG. 4.

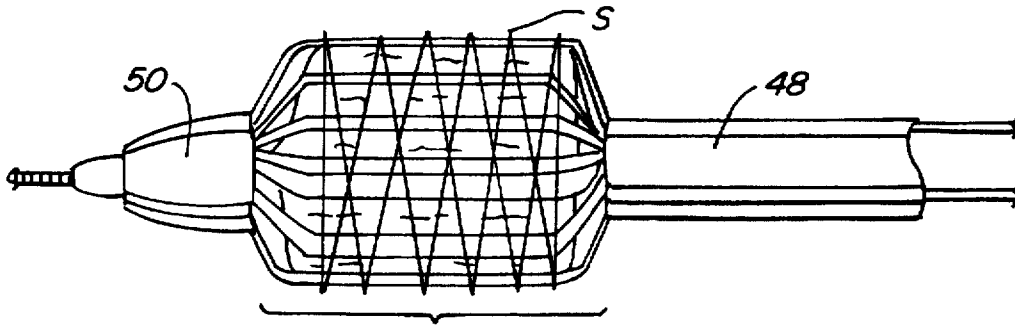

FIG. 5.

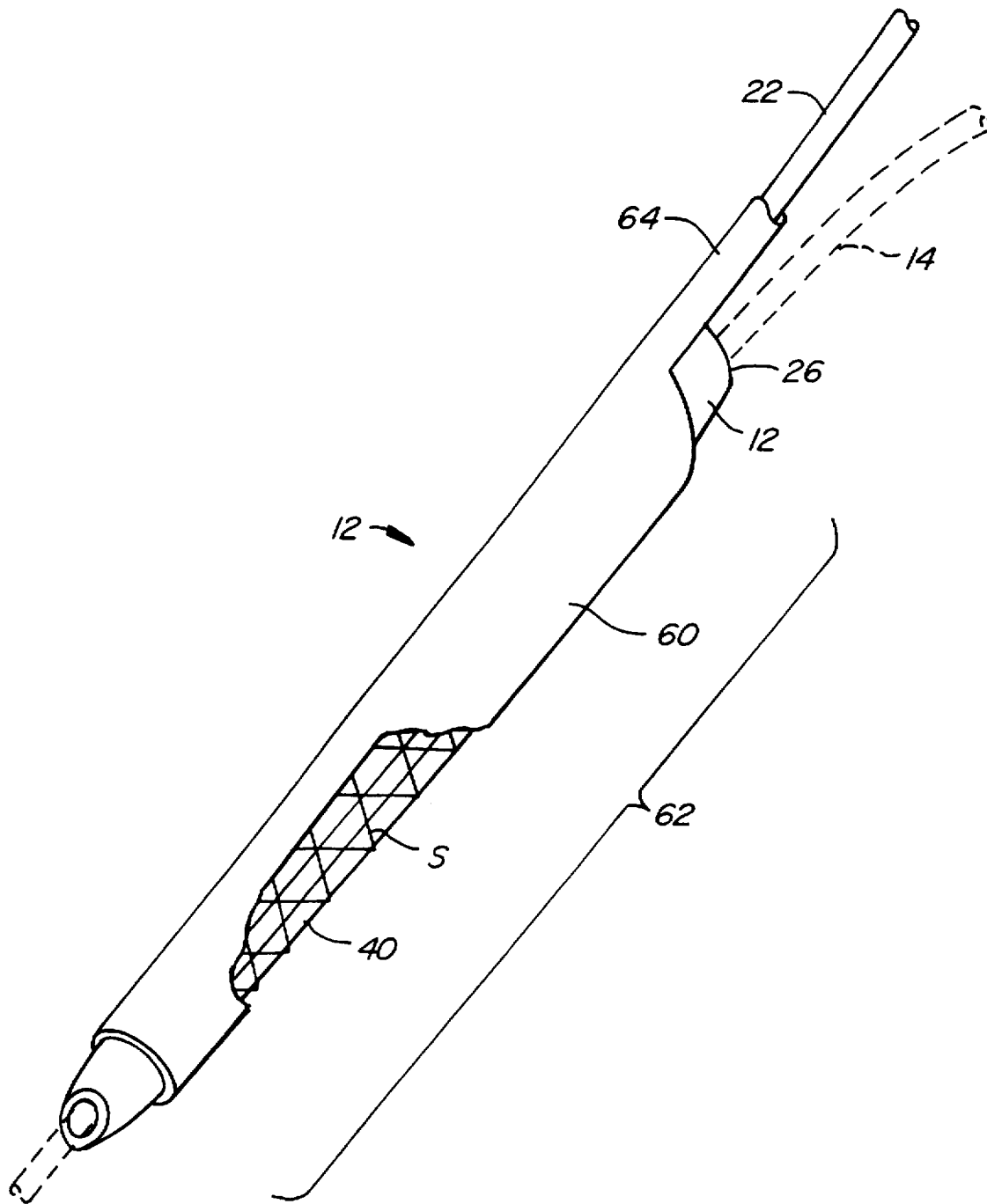

FIG. 6.

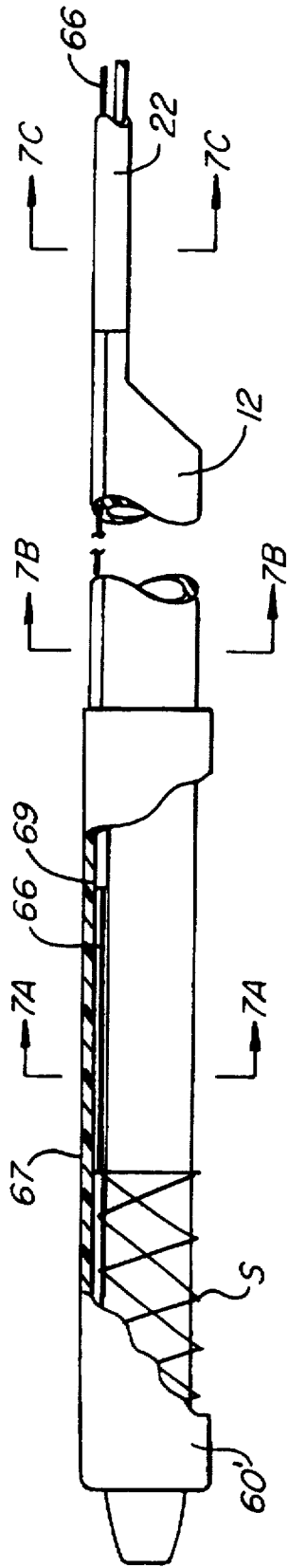

FIG. 7.

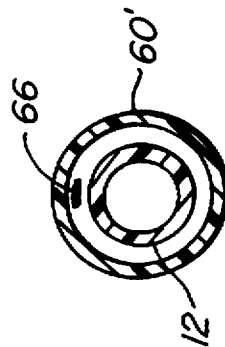

FIG. 7A.

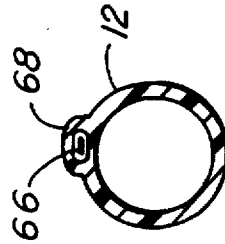

FIG. 7B.



FIG. 7C.

Explore Litigation Insights

Docket Alarm provides insights to develop a more informed litigation strategy and the peace of mind of knowing you're on top of things.

Real-Time Litigation Alerts



Keep your litigation team up-to-date with **real-time alerts** and advanced team management tools built for the enterprise, all while greatly reducing PACER spend.

Our comprehensive service means we can handle Federal, State, and Administrative courts across the country.

Advanced Docket Research



With over 230 million records, Docket Alarm's cloud-native docket research platform finds what other services can't. Coverage includes Federal, State, plus PTAB, TTAB, ITC and NLRB decisions, all in one place.

Identify arguments that have been successful in the past with full text, pinpoint searching. Link to case law cited within any court document via Fastcase.

Analytics At Your Fingertips



Learn what happened the last time a particular judge, opposing counsel or company faced cases similar to yours.

Advanced out-of-the-box PTAB and TTAB analytics are always at your fingertips.

API

Docket Alarm offers a powerful API (application programming interface) to developers that want to integrate case filings into their apps.

LAW FIRMS

Build custom dashboards for your attorneys and clients with live data direct from the court.

Automate many repetitive legal tasks like conflict checks, document management, and marketing.

FINANCIAL INSTITUTIONS

Litigation and bankruptcy checks for companies and debtors.

E-DISCOVERY AND LEGAL VENDORS

Sync your system to PACER to automate legal marketing.